

Wireless Music Center + Station WACS5

Read Me First!

Quick start guide

- A** Connect/Setup
- B** Enjoy
- C** FAQ



PHILIPS

GB

What's in the box

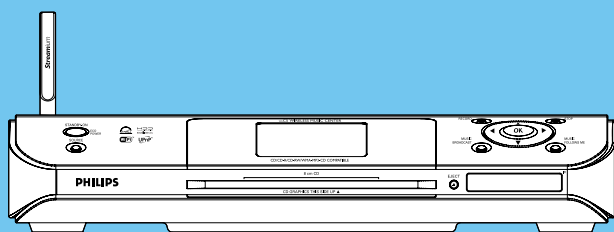

Wireless Music Center WAC5



Center's remote control
4xAAA batteries



for
Center

Audio cables



Wireless Music
Station WAS5



Station's stand

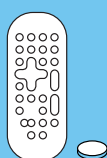

Station's remote control
1xCR2025 battery

for
Station

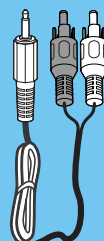

Audio cables

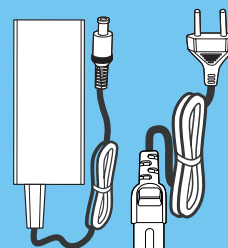

Station's AC adaptor



PC installer

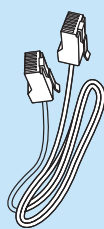

1 x Ethernet cable

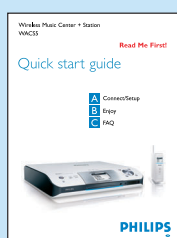

Quick start guide

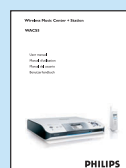

User manual



Connect to your PC

Before using the remote control:

- Remove the protective plastic tab from the Station's remote control
- Insert 4 AAA batteries into Center's remote control as shown



Station's remote control

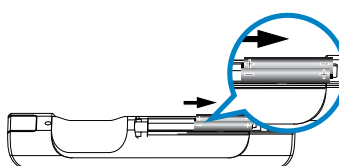
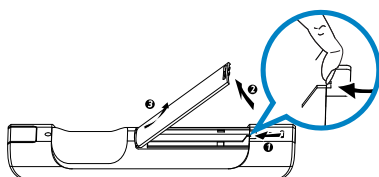

Center's remote control

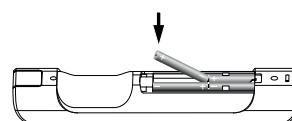

A

Connect/Setup

Set up Wi-Fi connection between Center and Station

Before starting the Wi-Fi connection, check your Center and Station are away from the source of interference, for example: plasma TVs, microwave ovens, DECT phones, bluetooth devices, cordless phones and other Wi-Fi products.

1

The first time you set up the Wi-Fi connection, place **WAC5 Center** and **WAS5 Station** side by side on a flat and firm surface

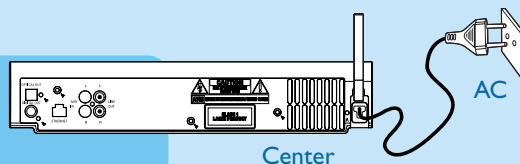

2

Connect WACS5 to power supply, **first** the Center and then the Station

Center/Station:

- The screen lights up. Auto installation/connection starts
- You will enter **HD** (Harddisk) mode when the installation/connection is finished

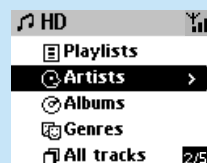
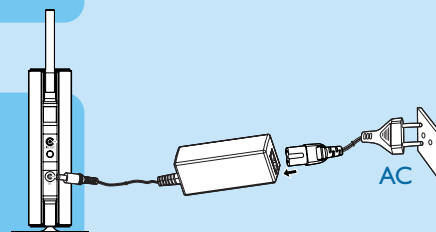

(HD stands for Harddisk mode)

3

Relocate Center and Station as desired: **plug and stream***

- Simply unplug your Center or Station and power them up in different rooms.
- You will be able to stream the harddisk music between Center and Station

IMPORTANT!

- Turn off the wireless router nearby if there is difficulty in connecting your Center and Station.
 - Avoid thick walls. Separating your Center and Station by 2 or more walls may cause poor streaming connection.
 - For better Wi-Fi reception, you can turn the Wi-Fi antenna, or adjust the location of your Center and Station.
- : indicates maximum reception; : indicates minimum reception
- To connect more Stations to your WAC5 Center, see **User Manual, HD: Station management**.

* Streaming is the process describing data is pulled between places, which can be multiple places.

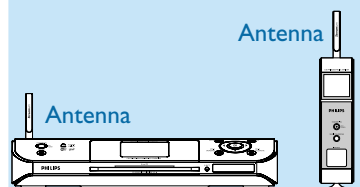

A Connect/Setup

Connect to audio systems

You can easily connect **WACS5** to your existing home audio systems, such as audio/video receivers, home theatre systems, mini/micro systems, multi-media speaker boxes (with built-in amplifier) and audio amplifiers.

1

Connect Center to an audio system:

- Insert the red plug of the red/white audio cables (supplied) to the red socket **LINE OUT R** and the white plug to the white socket **LINE OUT L**
- Connect the other end of the audio cables to the **AUX IN** (or **AUDIO IN**) terminals of the additional appliance, red plug to the red socket **AUX IN R** and white plug to the white socket **AUX IN L**

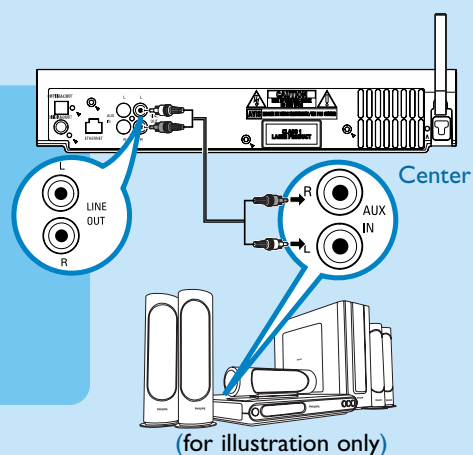

2

Connect Station to another audio system:

- Insert the one-plug end of the audio cable (supplied) to **LINE OUT**
- Connect the two-plug end of the audio cables to the **AUX IN** (or **AUDIO IN**) terminals of the additional appliance, red plug to the red socket **AUX IN R** and white plug to the white socket **AUX IN L**

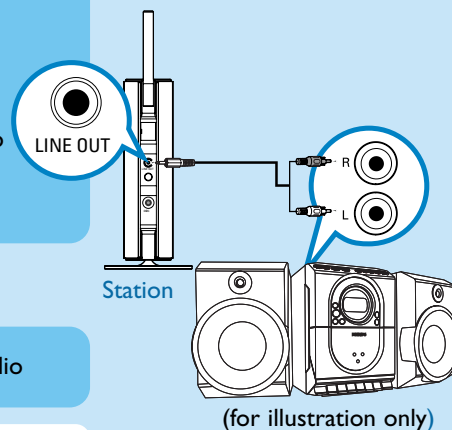

3

To listen to music playback, select **AUX** mode in the connected audio systems

IMPORTANT!

- Never make or change connections with the power supply switched on.

Tips:

- WACS5 Center also provides the sound output **DIGITAL OUT** and **OPTICAL OUT**, see the **Installation** chapter in **User Manual**.
- WACS5 Station is equipped with a stand. To mount the stand onto your Station,
 - Align the supplied stand to the slot at Station's bottom
 - Insert the stand into the slot firmly (**once inserted, the stand is undetachable**)

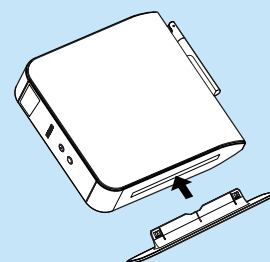

B Enjoy

Play HD

On WAC5 Center's 80GB* hard disk, you can centrally store up to 1,500 audio CDs. On a connected WAS5 Station, you can play all the music stored on the Center.

1

Press **STANDBY ON** to switch on the **Center** or **Station**

2

On the **Center**, press **SOURCE** to select **HD** source (or press **HARDDISK** on the remote control)

3

Use the navigation controls **▲▼◀▶** to select your playback options (*Demo tracks are stored under **All tracks***)

4

Press **OK** (or **▶**) to start playback

5

To change your playback options,
 a. Press **◀** once or more to enter previous option lists
 b. Use the navigation controls **▲▼◀▶** to select
 c. Press **OK** or **▶** to confirm

6

To stop playback, press **STOP / ■**

Tips:

- Center's remote control can be also used for some other Philips' wireless music systems, which provide sound and tuner features unavailable in WACS5. Such sound/tuner keys will not work with WACS5.
- Avoid placing your Center or Station close to the plasma TV. It may result in improper display on your Center's remote control.

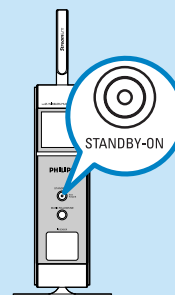
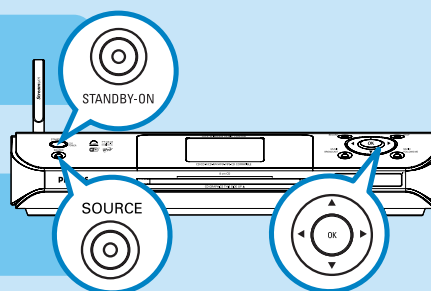

(**HD** is the only source on Station)

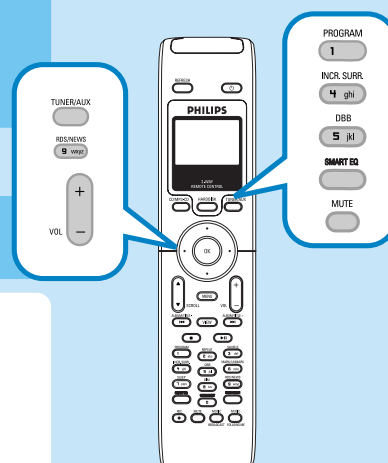

* Actual free space is 69GB or less, due to the buffer partition for MP3 compression, firmware, music CD database and demo tracks stored.

B

Build music library on Center

You can store up to 1,500 audio CDs on **Center's** 80GB harddisk by **ripping audio CDs, Importing MP3/WMA tracks from PC or Recording from external source**

Ripping audio CDs

1

Insert an audio CD into **Center's** CD loader, CD graphic printed side facing up

- **Reading CD** appears
- List of CD tracks appears

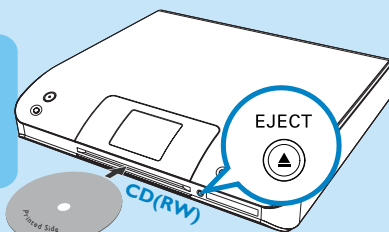

2

In the screen of track list, press **RECORD**

- List of track checkboxes appears

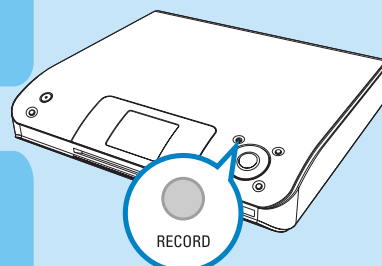

3

To start recording the whole CD, press **RECORD**

*(To rip part of the CD, press **OK** to select/deselect the tracks to be recorded)*

- **CD-Rec** appears. Display shows the album name of the track being recorded (**write down the album name for your convenience**)
- Center will return to **CD** mode when ripping is finished
(All the functions are available to you at this time)



4

To rip another CD, repeat the **Step 1-3** above

(Up to 8 CDs can be ripped consecutively)

Importing MP3/WMA from your PC

See the manual **Connect to your PC**

Recording from External source

A maximum of 3-hour recording can be made from the external source (recorded tracks under the album **AUX**). See **User manual, HD: Build music library on Center**



2005 © Koninklijke Philips Electronics N.V.

All rights reserved.

3141 075 20551 GB

www.philips.com



Be responsible
Respect copyrights

B

To find your ripped tracks

After MP3 conversion is completed, you can find and playback all the ripped tracks in **Albums**.

1

Select **HD** source

2

In **Albums**, use the navigation controls ▲▼◀▶ to find the album of recorded tracks

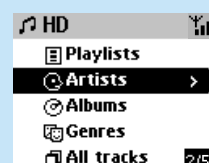

IMPORTANT!

- It takes some time to convert the ripped tracks to MP3 files.
- If power failure occurs during the conversion, you will lose all the ripped tracks.
- To learn more about CD ripping, see **User Manual**.
- You can edit the track information using **Philips Digital Media Manager (DMM)**. For details, see the manual **Connect to your PC**.

Play CDs (on Center only)

For playback on the Center you can use:

- All pre-recorded audio CDs
- All finalized audio CDR and CDRW discs
- MP3 & WMA-CDs (CD-R/CD-RW with MP3/WMA files)

1

Insert a CD into **Center**'s CD loader, CD graphic printed side facing up

2

Use the navigation controls ▲▼◀▶ to select a track or album.

3

To start playback, press **OK**

4

To stop playback, press **STOP** / ■

5

To remove the CD, press **EJECT**

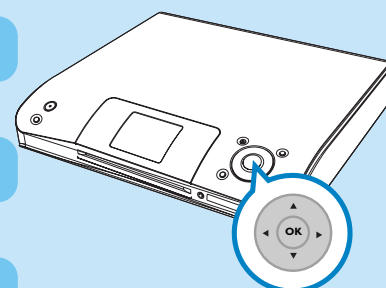
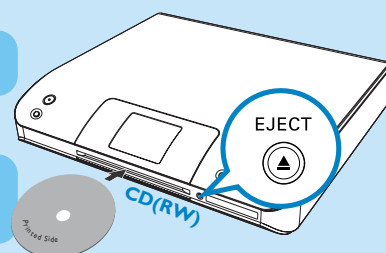

B

Stream between Center and Station

With WACS5 Center and Station, you will have the freedom to enjoy or share your favorite music around your home.

MUSIC FOLLOWS ME

While playing music in HD(Harddisk) mode, move the music playback with you, from **Center** to **Station** or from **Station** to **Center**.

1

On the source unit (Center or Station), where the music is playing

Press **MUSIC FOLLOWS ME** to activate

- The  icon appears

2

On the destination unit (Center or Station), where the music will continue

Press **MUSIC FOLLOWS ME**

- Selected music continues on the destination unit
- On the source unit, the music stops. The  icon disappears

Tips:

- Check you have switched the destination unit on or to Standby mode.
- Always press **MUSIC FOLLOWS ME** on the source unit before pressing **MUSIC FOLLOWS ME** on the destination unit.
- **MUSIC FOLLOWS ME** will be automatically deactivated if you do not press **MUSIC FOLLOWS ME** on the destination unit within 5 minutes

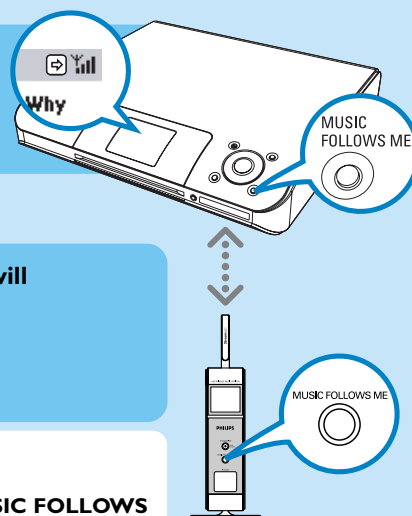

MUSIC BROADCAST

While playing music in HD(Harddisk) mode, broadcast music from **Center** to **Station(s)**.

1

On Center

Press **MUSIC BROADCAST** to activate

- The  icon appears on Center and Station. 5-second countdown starts

2

On Center and Station(s)

- Selected music starts to play simultaneously

Tips:

- Check you have switched the Station(s) on or to standby mode.
- **To broadcast again**
Before you press **MUSIC BROADCAST**, check if you need to deactivate any earlier broadcasting. If the icon  is still active in Center or Station's display. Press **STOP/■** on **Center**. Then, follow the above steps 1-2.
- During **MUSIC BROADCAST**, other functions are unavailable
- For a station to exit **MUSIC BROADCAST**, press **STOP / ■** on **Station**.

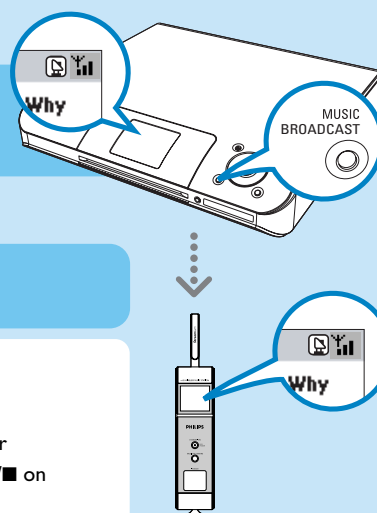



FAQ

Most Frequently Asked Questions

About the Environment

Q: Is there a maximum distance of transmission between the Music Center and the Music Stations for effective streaming?

A: Yes. The maximum distance of Wi-Fi transmission for the system is 250m measured in open space. However in a home environment there are inevitable solid obstacles such as walls and doors, which may reduce the effective transmission distance significantly to approximately 50-100m. Try re-positioning the sets if you experience transmission problems.

Q: Do I need a computer and home network to use the WACS5?

A: No. Your WACS5 is designed to work independently of the computer. You can convert your CDs into MP3s on the Music Center, and stream the music to your Music Stations without any computer or home networking structure.

Q: Would my neighbours be able to access the music stored on my Music Center if they also have the Philips Music Station?

A: No. Every Music Station has a unique encryption code that has to be recognized by the Music Center during the installation process.

About Ripping/Track Information

Q: What does "ripping" mean and what functions can I use while ripping is in progress?

A: Ripping is the process by which a CD track is converted into the compressed MP3 format which is then stored on the Music Center's internal hard disk for playback and music streaming. In the Music Center "ripping" takes two steps: first, it reads the CD content and store it temporarily on the hard disk; second, it converts this temporary CD content into the MP3 format - a process called "background encoding". It takes 1 hour to convert 1 hour of CD music. Make sure you do not choose the "Eco Standby" mode or unplug your Music Center from the electrical socket during the conversion.

Q: Do I need to immediately update the CDDB database stored in the Music Center straight after bringing it home?

A: No. There is already a massive CD-tracks database pre-stored in the Music Center, which should match most of the CDs released within the last six months.

Q: Does Philips provide CDDB database updates?

A: Yes. We provide quarterly updates of the CDDB database through our website at <http://www.philips.com/support>. Simply download the file, burn it on a CD-ROM and follow the step by step procedure to complete the update.



About Music Management

Q: What is Philips Digital Media Manager (DMM)?

A: The main function of the Philips Digital Media Manager is to collect MP3 tracks you have on your PC and transfer them to the Music Center. In addition it provides a one-stop solution to help you manage and organize your MP3 digital music contents such as create playlists, rename tracks and playlist contents as well as CDDDB update.

Q: How do I transfer the MP3 songs that I already have on my PC to my new Music Centre?

A: Once you have installed the Philips Digital Media Manager (DMM) and connected your PC to the Music Center with the supplied Ethernet cable, you can use this software to locate all the MP3 tracks on your PC and then just drag and drop them into the "device window" of DMM. Transfer of track will start automatically and the average time it takes to transfer one track is 4-6 seconds. Refer to the manual **Connect to your PC**.

Q: Is the Music Centre upgradeable?

A: Yes, both the Music Center and the Music Station are software upgradeable which means they are prepared for future function upgrades available. Check our website regularly for latest news on new features and improvements at <http://www.philips.com/support>

Need help?

www.philips.com/support
or
call our helpdesk

Country	Helpdesk	Tariff / min	Keep ready
österreich	0820 901115	€0,20	Das Kaufdatum, Modellnummer und Seriennummer
Belgique	070 253 010	€0,17	La date d'achat la référence et le numéro de série du produit
Canada	1-800-661-6162 (Francophone) 1-888-744-5477 (English / Spanish)	Free	Date of Purchase, Model number and Serial number
Danmark	3525 8761	Local tariff	Forbrugerens indkøbsdato, type/model-og serienummer
Suomi	09 2290 1908	Local tariff	Ostopäivä ja tarkka mallinnumero ja sarjanumero
France	08 9165 0006	€0,23	La date d'achat la référence et le numéro de série du produit
Deutschland	0180 5 007 532	€0,20	Das Kaufdatum, Modellnummer und Serial number
Ελλάδα	0 0800 3122 1223	Free	Την ημερομηνία αγοράς και Τον ακριβή κωδικό μοντέλου και Τον αριθμό σειράς του προϊόντος σας
Ireland	01 601 1161	Local tariff	Date of Purchase, Model number and Serial number
Italia	199 404 042	€0,21	La data di acquisto, numero di modello e numero di serie
Luxembourg	26 84 30 00	Local tariff	La date d'achat, la référence et le numéro de série du produit
Nederland	0900 0400 063	€0,20	De datum van aankoop, modelnummer en serienummer
Norge	2270 8250	Local tariff	Datoen da du kjøpte produktet & modellnummer & serienummeret
Portugal	2 1359 1440	Local tariff	A data de compra, número do modelo e número de série
España	902 888 785	€0,15	Fecha de compra e número del modelo e número de serie
Sweden	08 632 0016	Local tariff	Inköpsdatum, modellnummer och serienummer
Schweiz	02 2310 2116		Das Kaufdatum und Modellnummer und Seriennummer
UK	0906 1010 017	£0,15	Date of Purchase, Model number and Serial number
USA	1-888-744-5477	Free	Date of Purchase, Model number and Serial number