



EN Quick start guide

PHILIPS



1

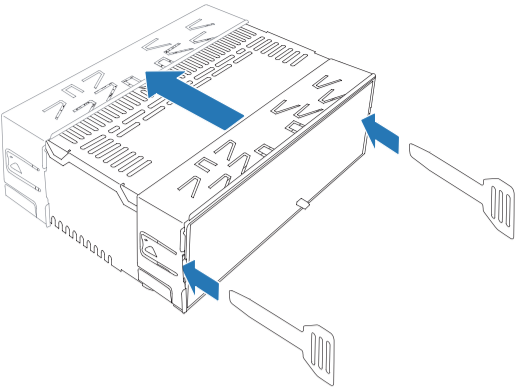

2

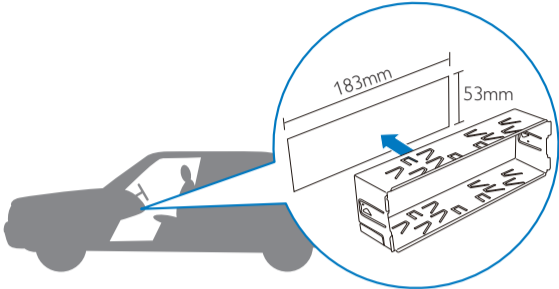

3

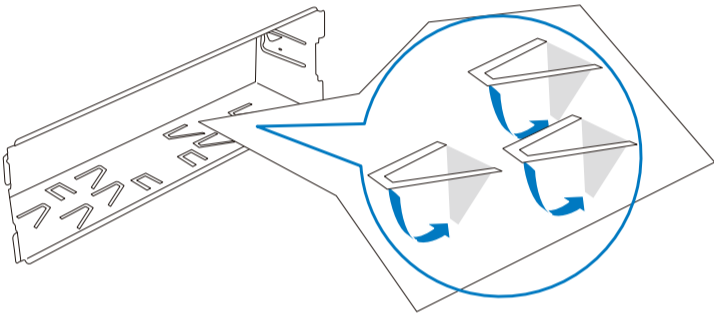

4

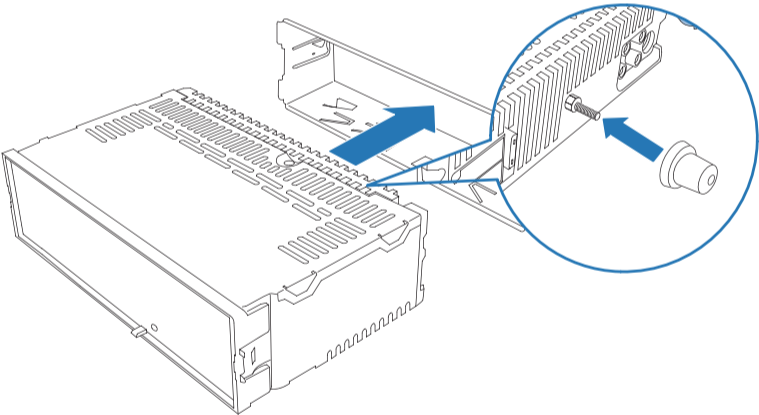

5

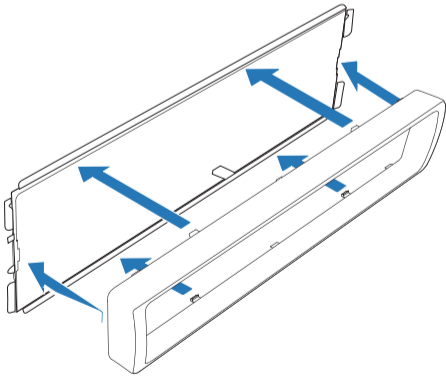

6

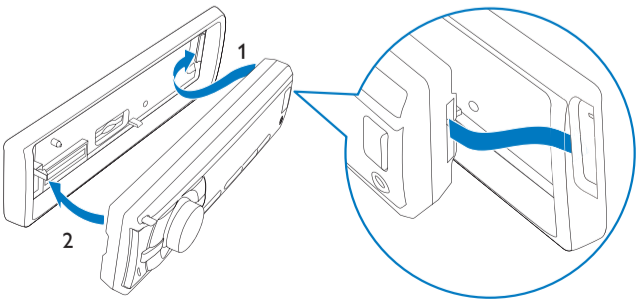

Quick start guide

What's in the box

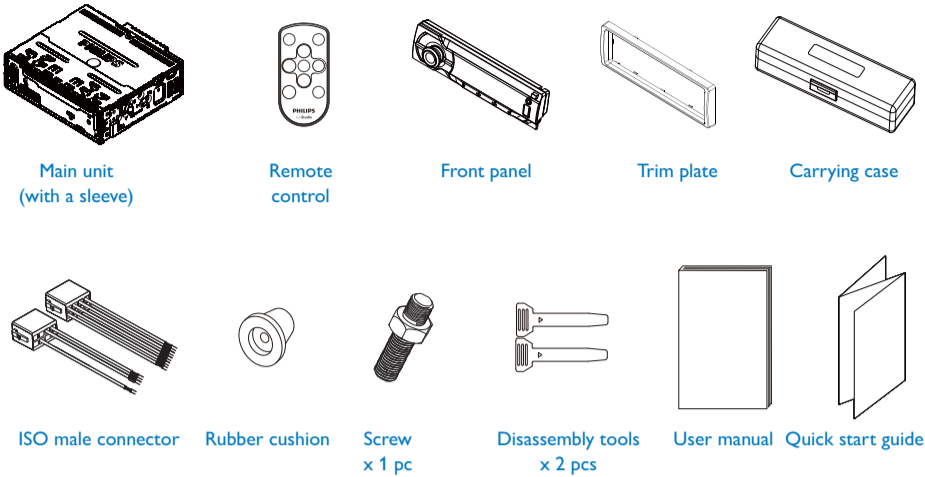

Connect wires: ISO male connectors

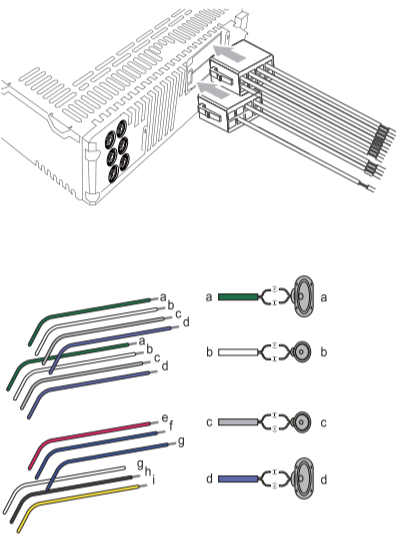

- 1

Connect the supplied male connector to the unit.
- 2

Check the car's wiring carefully and connect them to the supplied male connector:

1	Green/black strip	Left speaker (Rear)
2	White/black strip	Left speaker (Front)
3	Gray/black strip	Right speaker (Front)
4	Purple/black strip	Right speaker (Rear)
e	Red	Ignition key +12V DC when ON/ACC
f	Blue	Motor/electric antenna relay control lead
g	Blue/white	Amplifier replay control lead
h	Black	Ground
i	Yellow	To the +12V car battery which is energized at all times

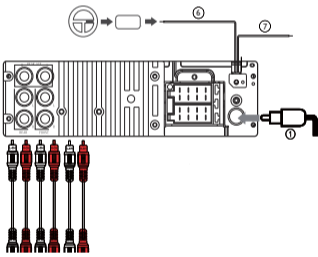

- 3

Connect the antenna and amplifier as illustrated, if applicable.
- | | Connector | Connect to |
|---|------------------------------|--------------------------|
| 1 | ANTENNA | Antenna |
| 2 | FRONT LINE OUT R (Socket) | Front right speaker |
| 3 | FRONT LINE OUT L (Socket) | Front left speaker |
| 4 | REAR LINE OUT R (Socket) | Rear right speaker |
| 5 | REAR LINE OUT L (Socket) | Rear left speaker |
| 6 | OE REMOTE (Purple) | OE Remote |
| 7 | TEL MUTING (Blue) | To cellular phone system |
| 8 | REAR AUX LINE OUT R (Socket) | Rear Aux right |
| 9 | REAR AUX LINE OUT L (Socket) | Rear Aux left |

Turn on

- To turn on the unit,
- Press **⏻**.
- To turn off the unit,
- press and hold **⏻** until the unit is turned off.

Select country/region

- 1

Press **⏻** to turn on the unit.
➡ **[SELECT OPERATING REGION]** is displayed.

- 2

Rotate **⌚** to select an option:
 - [USA]** (United States)
 - [LATIN]** (Latin America)
 - [EUROPE]** (Western Europe)
 - [RUS]** (Russia)
 - [M-EAST]** (Middle East)
 - [ASIA]** (Asia Pacific)
 - [JAP]** (Japan)
 - [AUST]** (Australia)
- 3

Press **⏻** to confirm.

Set clock

- 1

Press **MENU** repeatedly until current time is flashed.
- 2

Rotate **⌚** to set hour.
- 3

Press **⏻** to confirm.
- 4

Rotate **⌚** to set minute.
- 5

Press **⏻** to confirm.

Listen to radio

- 1

Press **SOURCE** repeatedly to select radio mode.
- 2

Press **BAND** or **▲** / **▼** repeatedly to select band: **[FM1]**, **[FM2]**, **[FM3]**, **[AM1]**, or **[AM2]**.
- 3

Press and hold **⏮** or **⏭** until the frequency digit is flashed.
- 4

Press **⏮** or **⏭** to tune to a radio station manually.
➡ The radio station is broadcast.
 - To search for a radio station automatically, press **⏮** or **⏭**.

Store stations automatically

- 1

In Radio mode, press and hold **DBB** until **[STORE - - -]** is displayed.
- 2

Press **⏻** to confirm.
➡ The six strongest stations of the selected band are saved in preset channel automatically.

Store stations manually

- 1

Tune to a station that you want to store.
- 2

Press a numeric button for 3 seconds.
➡ The station is saved in the selected channel.

Play from USB

- 1

Slide the USB socket cover marked **🔌** to the left.
- 2

Insert the USB device into the USB socket.
➡ The unit starts playing from the USB device automatically.

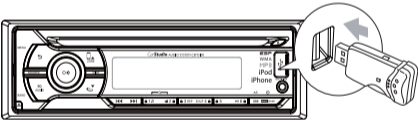

Insert a card

- 1

Press **⏮** to release the panel.
- 2

Insert the card into the card slot.
- 3

Close the front panel.
➡ The unit starts playing from the card automatically.

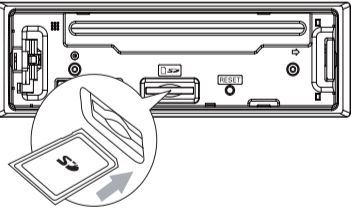

Reset

You can reset the unit to its default setting.

- 1

Detach the front panel.
- 2

Press the reset button by using a ball-point pen or a similar tool.
➡ Preset adjustments such as preset channels and sound adjustments are erased.

