

Philips Consumer Lifestyle  
A division of Philips Electronics North America Corporation  
P.O. Box 10313  
Stamford, CT 06904  
Phone: 1-888-PHILIPS (744-5477)

Meet Philips at the Internet  
<http://www.philips.com/welcome>

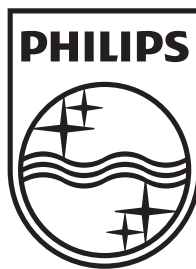

© 2011 Koninklijke Philips Electronics N.V.

All rights reserved.

PB9001\_37\_UM\_V3.2

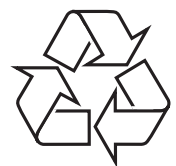

Register your product and get support at  
**www.philips.com/welcome**

PB9001



Thank you for choosing Philips.

### **Need help fast?**

Read your Quick Start Guide and/or User Manual first for quick tips that make using your Philips product more enjoyable.

If you have read your instructions and still need assistance, you may access our online help at

**www.philips.com/welcome**  
or call

**1-888-PHILIPS (744-5477)**

**while with your product.**

**(and Model / Serial number)**



Philips vous remercie de votre confiance.

### **Besoin d'une aide rapide?**

Le Guide rapide de début et Manuel de l'utilisateur regorgent d'astuces destinées à simplifier l'utilisation de votre produit Philips. Toutefois, si vous ne parvenez pas à résoudre votre problème, vous pouvez accéder à notre aide en ligne à l'adresse

**www.philips.com/welcome**  
ou formez le

**1-800-661-6162 (Francophone)**

**1-888-PHILIPS (744-5477) (English speaking)**

**Veillez à avoir votre produit à portée de main.**

**(et model / serial nombre)**



Gracias por escoger Philips

### **Necesita ayuda inmediata?**

Lea primero la Guía rápida del comienzo o el Manual del usuario, en donde encontrará consejos que le ayudarán a disfrutar plenamente de su producto Philips.

Si después de leerlo aún necesita ayuda, consulte nuestro servicio de asistencia en línea en

**www.philips.com/welcome**  
o llame al teléfono

**1-888-PHILIPS (744-5477)**

**y tenga a mano el producto.**

**(y número de model / serial)**



---

EN User manual

---

ES Manual del usuario

---

FR Mode d'emploi

# PHILIPS

# Canada

## English:

This digital apparatus does not exceed the Class B limits for radio noise emissions from digital apparatus as set out in the Radio Interference Regulations of the Canadian Department of Communications. This Class B digital apparatus complies with Canadian ICES-003.

## Français:

Cet appareil numérique n'émet pas de bruits radioélectriques dépassant les limites applicables aux appareils numériques de Classe B prescrites dans le Règlement sur le Brouillage Radioélectrique édicté par le Ministère des Communications du Canada. Cet appareil numérique de la classe B est conforme à la norme NMB-003 du Canada.

**The set complies with the FCC-Rules, Part 15 and with 21 CFR 1040.10.  
Operation is subject to the following two conditions:**

1. This device may not cause harmful interference, and
2. This device must accept any interference received, including interference that may cause undesired operation.

**L'appareil est conforme à la réglementation FCC, section 15, et à la norme 21 CFR 1040.10. Son utilisation est soumise à deux conditions :**

1. L'appareil ne doit pas provoquer d'interférences nuisibles, et
2. L'appareil doit supporter les interférences reçues, y compris les interférences empêchant son fonctionnement correct.

# Contents

<b>1</b>	<b>Important</b>	<b>7</b>
	Important Safety Instructions	7
	Hearing safety	9
	Notice	10
	Trademark notice	12
<b>2</b>	<b>Your portable Blu-ray disc player</b>	<b>14</b>
	What's in the box	14
	Overview of the main unit	15
	Overview of remote control	17
<b>3</b>	<b>Get started</b>	<b>19</b>
	Prepare the remote control	19
	Charge the battery	19
	Connect a TV	21
<b>4</b>	<b>Use your portable Blu-ray disc player</b>	<b>22</b>
	Turn on	22
	Play a disc	24
	Play media files via USB	24
	Basic play control	25
	Video, audio and picture options	26
<b>5</b>	<b>Use your portable Blu-ray disc player</b>	<b>29</b>
	DivX videos	29
	BonusView on Blu-ray	30
	Set up a network	30
	BD-Live on Blu-ray	31
	Use Philips EasyLink	32

<b>6</b>	<b>Change settings</b>	<b>34</b>
	Picture	35
	Sound	35
	Network	36
	Preference	36
	Advanced options	38
	LCD screen	39
<b>7</b>	<b>Update software</b>	<b>40</b>
	Update software via the Internet	40
	Update software via USB	40
<b>8</b>	<b>Specifications</b>	<b>41</b>
<b>9</b>	<b>Troubleshooting</b>	<b>43</b>

**Register online at [www.philips.com/welcome](http://www.philips.com/welcome) today to  
get the very most from your purchase.**

Registering your model with PHILIPS makes you eligible for all of the valuable benefits listed below, so don't miss out. Register online at [www.philips.com/welcome](http://www.philips.com/welcome) to ensure:

### **\*Product Safety Notification**

By registering your product, you'll receive notification - directly from the manufacturer.

### **\*Additional Benefits**

Registering your product guarantees that you'll receive all of the privileges to which you're entitled, including special money-saving offers.

## **PHILIPS**

***Congratulations on your purchase,  
and welcome to the "family!"***

### **Dear PHILIPS product owner:**

Thank you for your confidence in PHILIPS. You've selected one of the best-built, best-backed products available today. We'll do everything in our power to keep you happy with your purchase for many years to come.

As a member of the PHILIPS "family," you're entitled to protection by one of the most comprehensive warranties in the industry. What's more, your purchase guarantees you'll receive all the information and special offers for which you qualify, plus easy access to accessories from our convenient home shopping network.

Most importantly, you can count on our uncompromising commitment to your total satisfaction.

All of this is our way of saying welcome - and thanks for investing in a PHILIPS product.

**P.S. To get the most from your PHILIPS purchase, be sure to register online at:**

**[www.philips.com/welcome](http://www.philips.com/welcome)**

### *Know these **safety** symbols*



This "bolt of lightning" indicates uninsulated material within your unit may cause an electrical shock. For the safety of everyone in your household, please do not remove product covering.

The "exclamation point" calls attention to features for which you should read the enclosed literature closely to prevent operating and maintenance problems.

**WARNING:** To reduce the risk of fire or electric shock, this apparatus should not be exposed to rain or moisture and objects filled with liquids, such as vases, should not be placed on this apparatus.

**CAUTION:** To prevent electric shock, match wide blade of plug to wide slot, fully insert.

**ATTENTION:** Pour éviter les chocs électriques, introduire la lame la plus large de la fiche dans la borne correspondante de la prise et pousser jusqu'au fond.

### **For Customer Use**

Enter below the Serial No. which is located on the rear of the cabinet. Retain this information for future reference.

Model No. \_\_\_\_\_

Serial No. \_\_\_\_\_

**PHILIPS**

Visit our World Wide Web Site at <http://www.philips.com/welcome>

## PHILIPS LIMITED WARRANTY ONE (1) YEAR

### WARRANTY COVERAGE:

PHILIPS warranty obligation is limited to the terms set forth below.

### WHO IS COVERED:

Philips warrants the product to the original purchaser or the person receiving the product as a gift against defects in materials and workmanship as based on the date of original purchase ("Warranty Period") from an Authorized Dealer. The original sales receipt showing the product name and the purchase date from an authorized retailer is considered such proof.

### WHAT IS COVERED:

The Philips warranty covers new products if a defect in material or workmanship occurs and a valid claim is received by Philips within the Warranty Period. At its option, Philips will either (1) repair the product at no charge, using new or refurbished replacement parts, or (2) exchange the product with a product that is new or which has been manufactured from new, or serviceable used parts and is at least functionally equivalent or most comparable to the original product in Philips current inventory, or (3) refund the original purchase price of the product.

Philips warrants replacement products or parts provided under this warranty against defects in materials and workmanship from the date of the replacement or repair for ninety (90) days or for the remaining portion of the original product's warranty, whichever provides longer coverage for you. When a product or part is exchanged, any replacement item becomes your property and the replaced item becomes Philips' property. When a refund is given, your product becomes Philips' property.

**Note: Any product sold and identified as refurbished or renewed carries a ninety (90) day limited warranty.**

**Replacement product can only be sent if all warranty requirements are met. Failure to follow all requirements can result in delay.**

### WHAT IS NOT COVERED - EXCLUSIONS AND LIMITATIONS:

This Limited Warranty applies only to the new products manufactured by or for Philips that can be identified by the trademark, trade name, or logo affixed to it. This Limited Warranty does not apply to any non-Philips hardware product or any software, even if packaged or sold with the product. Non-Philips manufacturers, suppliers, or publishers may provide a separate warranty for their own products packaged with the bundled product.

Philips is not liable for any damage to or loss of any programs, data, or other information stored on any media contained within the product, or any non-Philips product or part not covered by this warranty. Recovery or reinstallation of programs, data or other information is not covered under this Limited Warranty.

This warranty does not apply (a) to damage caused by accident, abuse, misuse, neglect, misapplication, or non-Philips product, (b) to damage caused by service performed by anyone other than Philips or Philips Authorized Service Location, (c) to a product or a part that has been modified without the written permission of

Philips, or (d) if any Philips serial number has been removed or defaced, or (e) product, accessories or consumables sold "AS IS" without warranty of any kind by including refurbished Philips product sold "AS IS" by some retailers.

### This Limited Warranty does not cover:

- Shipping charges to return defective product to Philips.
- Labor charges for installation or setup of the product, adjustment of customer controls on the product, and installation or repair of antenna/signal source systems outside of the product.
- Product repair and/or part replacement because of improper installation or maintenance, connections to improper voltage supply, power line surge, lightning damage, retained images or screen markings resulting from viewing fixed stationary content for extended periods, product cosmetic appearance items due to normal wear and tear, unauthorized repair or other cause not within the control of Philips.
- Damage or claims for products not being available for use, or for lost data or lost software.
- Damage from mishandled shipments or transit accidents when returning product to Philips.
- A product that requires modification or adaptation to enable it to operate in any country other than the country for which it was designed, manufactured, approved and/or authorized, or repair of products damaged by these modifications.
- A product used for commercial or institutional purposes (including but not limited to rental purposes).
- Product lost in shipment and no signature verification receipt can be provided.
- Failure to operate per Owner's Manual.

### TO OBTAIN ASSISTANCE IN THE U.S.A., PUERTO RICO, OR U.S. VIRGIN ISLANDS...

Contact Philips Customer Care Center at:  
1-888-PHILIPS (1-888-744-5477)

### TO OBTAIN ASSISTANCE IN CANADA...

1-800-661-6162 (French Speaking)  
1-888-PHILIPS (1-888-744-5477) - (English or Spanish Speaking)

REPAIR OR REPLACEMENT AS PROVIDED UNDER THIS WARRANTY IS THE EXCLUSIVE REMEDY FOR THE CONSUMER. PHILIPS SHALL NOT BE LIABLE FOR ANY INCIDENTAL OR CONSEQUENTIAL DAMAGES FOR BREACH OF ANY EXPRESS OR IMPLIED WARRANTY ON THIS PRODUCT. EXCEPT TO THE EXTENT PROHIBITED BY APPLICABLE LAW, ANY IMPLIED WARRANTY OF MERCHANTABILITY OR FITNESS FOR A PARTICULAR PURPOSE ON THIS PRODUCT IS LIMITED IN DURATION TO THE DURATION OF THIS WARRANTY.

Some states do not allow the exclusions or limitation of incidental or consequential damages, or allow limitations on how long an implied warranty lasts, so the above limitations or exclusions may not apply to you.

*This warranty gives you specific legal rights. You may have other rights which vary from state/province to state/province.*

Philips, P.O. Box 10313 Stamford, CT 06904

3140 035 50201

# 1 Important

## Important Safety Instructions

- ① Read these instructions.
- ② Keep these instructions.
- ③ Heed all warnings.
- ④ Follow all instructions.
- ⑤ Do not use this apparatus near water.
- ⑥ Clean only with dry cloth.
- ⑦ Do not block any ventilation openings. Install in accordance with the manufacturer's instructions.
- ⑧ Do not install near any heat sources such as radiators, heat registers, stoves, or other apparatus (including amplifiers) that produce heat.
- ⑨ For countries with a polarized mains, do not defeat the safety purpose of the polarized or grounding-type plug. A polarized plug has two blades with one wider than the other. A grounding type plug has two blades and a third grounding prong. The wide blade or the third prong are provided for your safety. If the provided plug does not fit into your outlet, consult an electrician for replacement of the obsolete outlet.

Caution: To prevent electric shock, match the wide blade of the plug to the wide slot, fully insert.

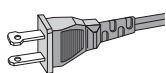

- ⑩ Protect the power cord from being walked on or pinched, particularly at plugs, convenience receptacles, and the point where they exit from the apparatus.
- ⑪ Only use attachments/accessories specified by the manufacturer.
- ⑫ Use only with the cart, stand, tripod, bracket, or table specified by the manufacturer or sold with the apparatus. When a cart is used, use caution when moving the cart/apparatus combination to avoid injury from tip-over.





- ⑬ Unplug this apparatus during lightning storms or when unused for long periods of time.
- ⑭ Refer all servicing to qualified service personnel. Servicing is required when the apparatus has been damaged in any way, such as power-supply cord or plug is damaged, liquid has been spilled or objects have fallen into the apparatus, the apparatus has been exposed to rain or moisture, does not operate normally, or has been dropped.
- ⑮ Battery usage **CAUTION** – To prevent battery leakage which may result in bodily injury, property damage, or damage to the unit:
  - Install all batteries correctly, + and - as marked on the unit.
  - Do not mix batteries (old and new or carbon and alkaline, etc.).
  - Remove batteries when the unit is not used for a long time.
- ⑯ Batteries (battery pack or batteries installed) shall not be exposed to excessive heat such as sunshine, fire or the like.
- ⑰ Apparatus shall not be exposed to dripping or splashing.
- ⑱ Do not place any sources of danger on the apparatus (e.g. liquid filled objects, lighted candles).
- ⑲ This product may contain lead and mercury. Disposal of these materials may be regulated due to environmental considerations. For disposal or recycling information, please contact your local authorities or the Electronic Industries Alliance: [www.eiae.org](http://www.eiae.org).
- ⑳ Where the MAINS plug or an appliance coupler is used as the disconnect device, the disconnect device shall remain readily operable.



#### Caution

- Use of controls or adjustments or performance of procedures other than herein may result in hazardous radiation exposure or other unsafe operation.



## Warning

- Never remove the casing of this apparatus.
- Never lubricate any part of this apparatus.
- Never place this apparatus on other electrical equipment.
- Keep this apparatus away from direct sunlight, naked flames or heat.
- Never look into the laser beam inside this apparatus.
- Ensure that you always have easy access to the power cord, plug or adaptor to disconnect this apparatus from the power.

---

## Hearing safety

### Listen at a moderate volume.

- Using headphones at a high volume can impair your hearing. This product can produce sounds in decibel ranges that may cause hearing loss for a normal person, even for exposure less than a minute. The higher decibel ranges are offered for those that may have already experienced some hearing loss.
- Sound can be deceiving. Over time your hearing 'comfort level' adapts to higher volumes of sound. So after prolonged listening, what sounds 'normal' can actually be loud and harmful to your hearing. To guard against this, set your volume to a safe level before your hearing adapts and leave it there.

### To establish a safe volume level:

- Set your volume control at a low setting.
- Slowly increase the sound until you can hear it comfortably and clearly, without distortion.

### Listen for reasonable periods of time:

- Prolonged exposure to sound, even at normally 'safe' levels, can also cause hearing loss.
- Be sure to use your equipment reasonably and take appropriate breaks.

### Be sure to observe the following guidelines when using your headphones.

- Listen at reasonable volumes for reasonable periods of time.
- Be careful not to adjust the volume as your hearing adapts.
- Do not turn up the volume so high that you can't hear what's around you.

- You should use caution or temporarily discontinue use in potentially hazardous situations. Do not use headphones while operating a motorized vehicle, cycling, skateboarding, etc.; it may create a traffic hazard and is illegal in many areas.

---

## Notice



This product complies with the radio interference requirements of the European Community.

Any changes or modifications made to this device that are not expressly approved by Philips Consumer Lifestyle may void the user's authority to operate the equipment.



Your product is designed and manufactured with high quality materials and components, which can be recycled and reused.

When you see the crossed-out wheel bin symbol attached to a product, it means the product is covered by the European Directive 2002/96/EC:

### Notice for the USA

**This equipment has been tested and found to comply with the limits for a Class B digital device, pursuant to part 15 of the FCC Rules.** These limits are designed to provide reasonable protection against harmful interference in a residential installation. This equipment generates, uses, and can radiate radio frequency energy and, if not installed and used in accordance with the instruction manual, may cause harmful interference to radio communications.

However, there is no guarantee that interference will not occur in a particular installation. If this equipment does cause harmful interference to radio or television reception, which can be determined by turning the equipment off and on, the user is encouraged to try to correct the interference by one or more of the following measures:

- Relocate the receiving antenna.
- Increase the separation between equipment and receiver.

- Connect the equipment into an outlet on a circuit different from that to which the receiver is connected.
- Consult the dealer or an experienced radio/TV technician for help.

### Environmental information

All unnecessary packaging has been omitted. We have tried to make the packaging easy to separate into three materials: cardboard (box), polystyrene foam (buffer) and polyethylene (bags, protective foam sheet.)

Your system consists of materials which can be recycled and reused if disassembled by a specialized company. Please observe the local regulations regarding the disposal of packaging materials, exhausted batteries and old equipment.

---

## Disposal of your old product and batteries

Your product is designed and manufactured with high quality materials and components, which can be recycled and reused.

Never dispose of your product with other household waste. Please inform yourself about the local rules on the separate collection of electrical and electronic products and batteries. The correct disposal of these products helps prevent potentially negative consequences on the environment and human health.

Your product contains batteries, which cannot be disposed of with normal household waste.

Please inform yourself about the local rules on separate collection of batteries. The correct disposal of batteries helps prevent potentially negative consequences on the environment and human health.

Please visit [www.recycle.philips.com](http://www.recycle.philips.com) for additional information on a recycling center in your area.



### Caution

- Removal of the built-in battery invalidates the warranty and may destroy the product.

Always bring your product to a professional to remove the built-in battery.

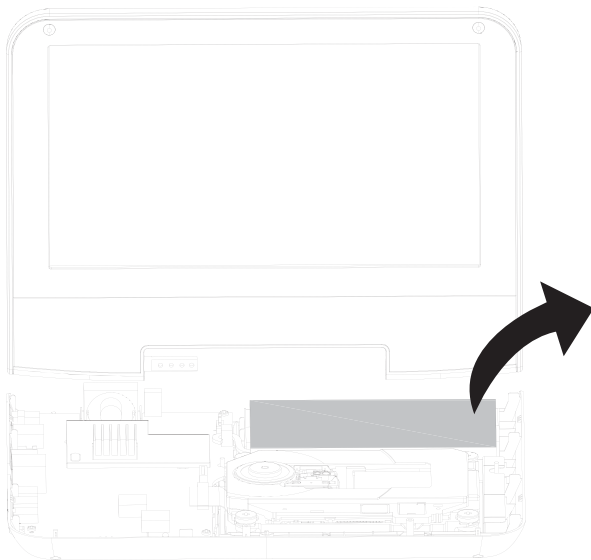

The making of unauthorized copies of copy-protected material, including computer programs, files, broadcasts and sound recordings, may be an infringement of copyrights and constitute a criminal offence. This equipment should not be used for such purposes.

This item incorporates copy protection technology that is protected by U.S. patents and other intellectual property rights of Rovi Corporation. Reverse engineering and disassembly are prohibited.

Recording and playback of material might require consent. See Copyright Act 1956 and The Performer's Protection Acts 1958 to 1972.

**This apparatus includes this label:**



---

## Trademark notice



'Blu-ray Disc' and 'Blu-ray Disc' logo are trademarks.



HDMI, the HDMI logo, and High-Definition Multimedia Interface are trademarks or registered trademarks of HDMI licensing LLC in the United States and other countries.



Manufactured under license from Dolby Laboratories. Dolby and the double-D symbol are trademarks of Dolby Laboratories.



Manufactured under license under U.S. Patent #'s: 5,451,942; 5,956,674; 5,974,380; 5,978,762; 6,226,616; 6,487,535; 7,212,872; 7,333,929; 7,392,195; 7,272,567 & other U.S. and worldwide patents issued & pending. DTS and the Symbol are registered trademarks, & DTS-HD, DTS-HD Master Audio, and the DTS logos are trademarks of DTS, Inc. Product includes software. © DTS, Inc. All Rights Reserved.



ABOUT DIVX VIDEO: DivX® is a digital video format created by DivX, Inc. This is an official DivX Certified® device that plays DivX video. Visit [divx.com](http://divx.com) for more information and software tools to convert your files into DivX video.

ABOUT DIVX VIDEO-ON-DEMAND: This DivX Certified® device must be registered in order to play purchased DivX Video-on-Demand (VOD) movies. To obtain your registration code, locate the DivX VOD section in your device setup menu. Go to [vod.divx.com](http://vod.divx.com) for more information on how to complete your registration.

DivX®, DivX Certified®, DivX Plus™ HD and associated logos are registered trademarks of DivX, Inc. and are used under license.

DivX Certified® to play DivX® and DivX Plus™ HD (H.264/MKV) video up to 1080p HD including premium content.



### **BONUSVIEW™**

'BD LIVE' and 'BONUSVIEW' are trademarks of Blu-ray Disc Association.



'AVCHD' and 'AVCHD' logo are trademarks of Matsushita Electric Industrial Co., Ltd and Sony Corporation.



'DVD Video' is a trademark of DVD Format/Logo Licensing Corporation. Windows Media and the Windows logo are trademarks, or registered trademarks of Microsoft Corporation in the United States and/or other countries.

## **2 Your portable Blu-ray disc player**

Congratulations on your purchase, and welcome to Philips! To fully benefit from the support that Philips offers, register your product at [www.philips.com/welcome](http://www.philips.com/welcome).

---

### **What's in the box**

Check and identify the contents of your package:





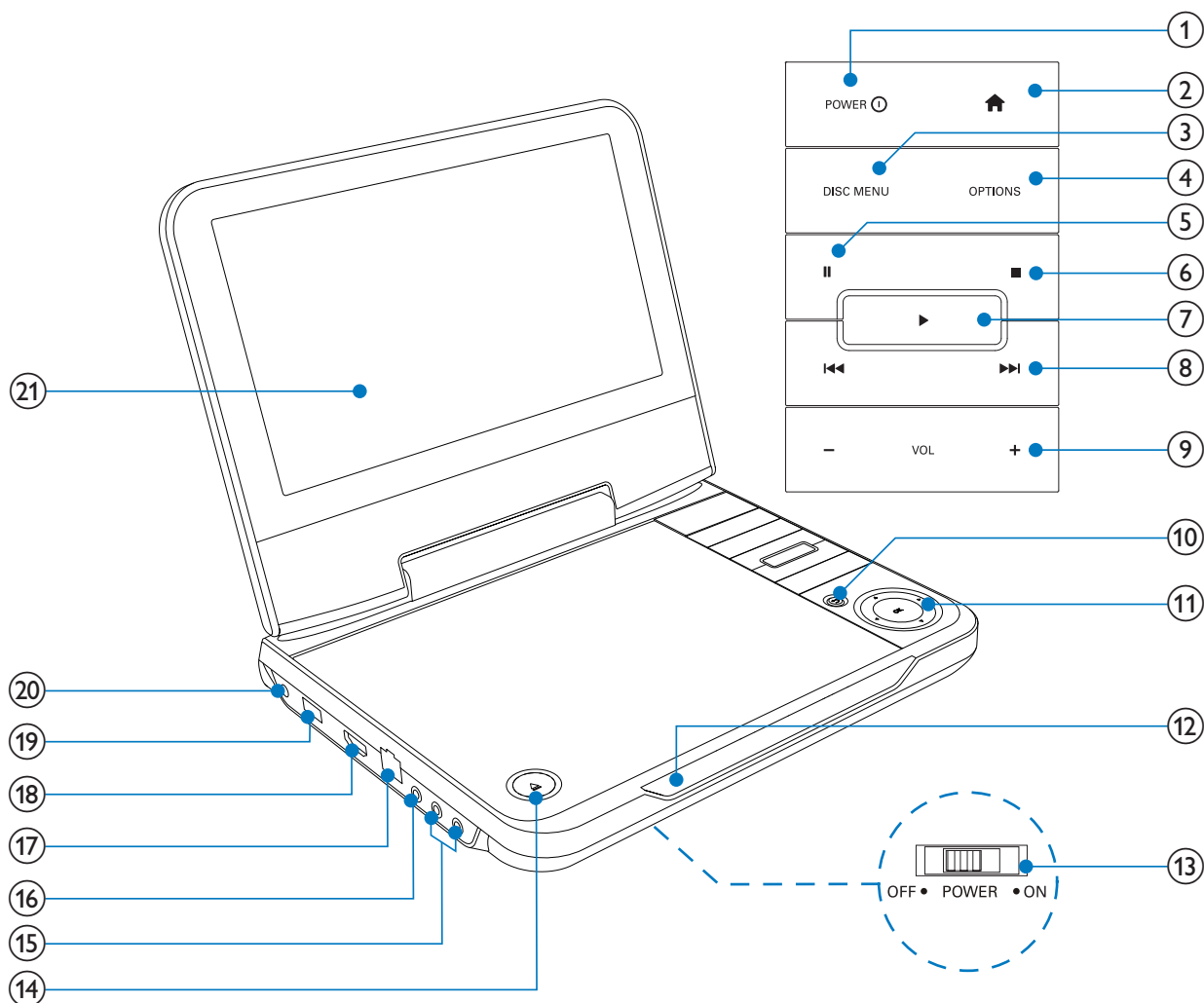

- Portable Blu-ray disc player x 1
- AC power adapter (SP-03A1202000-U) x 1
- Car adaptor x 1
- Remote control x 1
- AV adapter cable x 1
- Carry bag x 1
- User manual x 1
- Quick start guide x 1

# Overview of the main unit



- ① **POWER**
  - Turn on this player or switch to standby mode.
- ② **Home icon**
  - Access or exit the home menu.
- ③ **DISC MENU**
  - **Blu-ray disc:** Access or exit the pop-up menu.
  - **DVD:** Access or exit the disc menu.
- ④ **OPTIONS**
  - Access options for the current activity or selection.
- ⑤ **Pause icon**
  - Pause play.
- ⑥ **Stop icon**
  - Stop play.







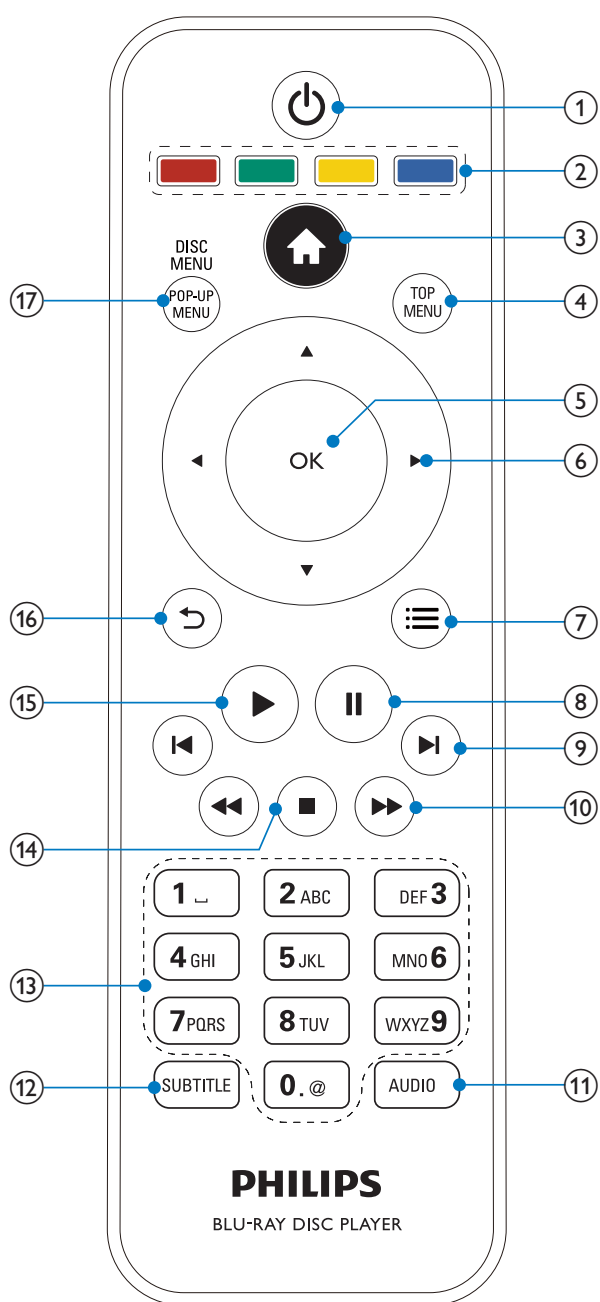



- ⑦ 
  - Start or resume play.
- ⑧ 
  - Skip to the previous or next title, chapter, or track.
- ⑨ **- VOL +**
  - Increase or decrease volume.
- ⑩  **BACK**
  - Return to a previous menu.
- ⑪ 
  - Navigate through the menus.
- OK**
  - Confirm an entry or selection.
- ⑫ **①/IR**
  - Power indicator/Charging indicator/Remote control sensor
- ⑬ **OFF•POWER•ON**
  - Power on/off this player.
- ⑭ 
  - Open the disc cover.
- ⑮ 
  - Headphone jack.
- ⑯ **AV OUT**
  - Audio/video output jack.
- ⑰ **LAN**
  - Ethernet port.
- ⑱ **HDMI**
  - HDMI output jack.
- ⑲ 
  - USB socket.
- ⑳ **DC IN**
  - Power supply socket.
- ㉑ **LCD screen**

# Overview of remote control



- ①
  - Switch this player to standby mode.
- ② **Color buttons**
  - **Blu-ray disc:** Select tasks or options.
- ③
  - Access the home menu.

- ④ **TOP MENU**
  - **Blu-ray disc:** Display the top menu.
  - **DVD:** Display the title menu.
- ⑤ **OK**
  - Confirm an entry or selection.
- ⑥ 
  - Navigate the menus.
- ⑦ 
  - Access options for the current activity or selection.
- ⑧ 
  - Pause play.
- ⑨ 
  - Skip to the previous or next title, chapter, or track.
- ⑩ 
  - Search backward or forward.
- ⑪ **AUDIO**
  - Select an audio language on a disc.
- ⑫ **SUBTITLE**
  - Select a subtitle language on a disc.
- ⑬ **Alphanumeric buttons**
  - Select an item to play.
  - Enter values.
- ⑭ 
  - Stop play.
- ⑮ 
  - Start or resume play.
- ⑯ 
  - Return to a previous menu.
- ⑰ **DISC MENU / POP-UP MENU**
  - **Blu-ray disc:** Access or exit the pop-up menu.
  - **DVD:** Access or exit the disc menu.

## 3 Get started

### Prepare the remote control

- 1 Press and push the battery compartment to slide it open (see “1” in the illustration).
- 2 Insert two AAA batteries with correct polarity (+/-) as indicated.
- 3 Push and slide back the battery compartment (see “3” in the illustration).

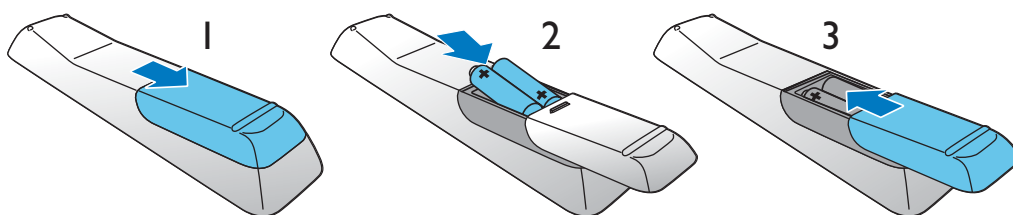

#### Note

- If you are not going to use the remote control for a long time, remove the batteries.
- Do not mix batteries (old and new or carbon and alkaline, etc.).
- Batteries contain chemical substances, so they should be disposed of properly.

### Charge the battery



#### Caution

- Risk of product damage. Ensure that the power supply voltage corresponds to the voltage printed on the bottom of the player.
- Use only the supplied AC adaptor to charge the battery.
- Danger of explosion if battery is incorrectly replaced. Replace only with the same or equivalent type.



#### Note

- The type plate is located on the bottom of the player.

To fast charge the battery,

- 1 Slide the **OFF•POWER•ON** switch to **OFF** position.

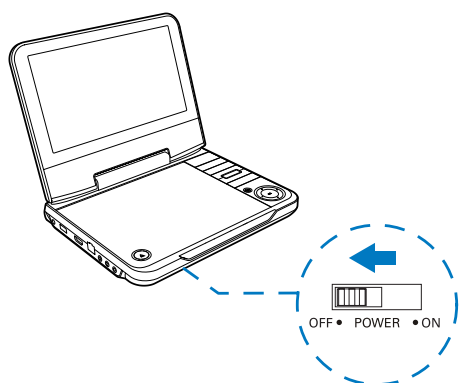

- 2 Connect the supplied AC adaptor to:

- **DC IN** jack on the player.
- Power outlet.

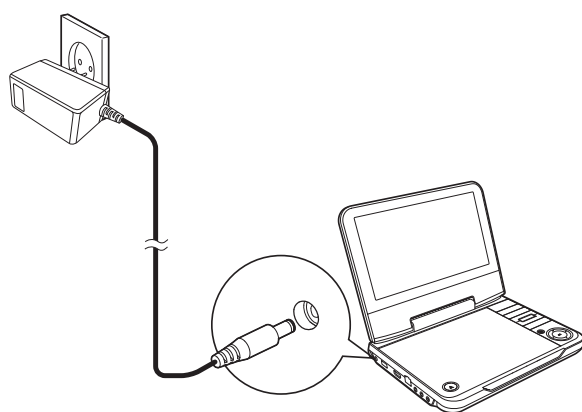

- The **CHR** indicator turns on (red).
- When the battery is fully charged, the **CHR** indicator turns off.

You can also charge the battery during play.

- 1 To charge the battery, connect the supplied AC adaptor to:
  - **DC IN** jack on the player.
  - Power outlet.

# Connect a TV



## Caution

- Turn off your player before connecting it to a TV.

You can connect the player to your TV to enjoy Blue-ray disc movies.

## Use an AV cable

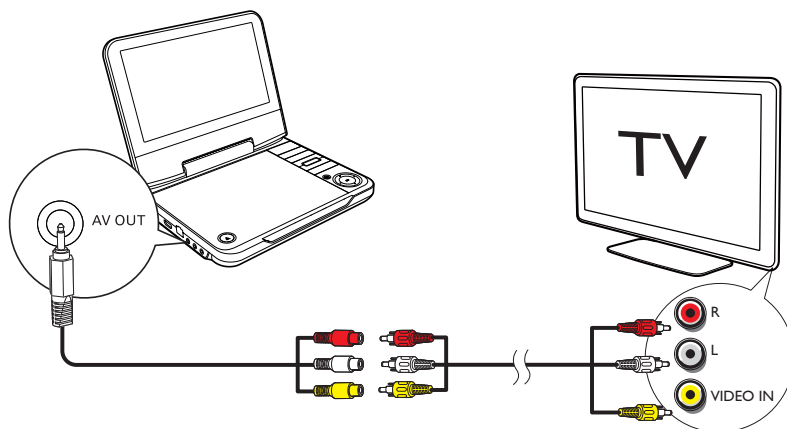

- 1 Insert the supplied AV adaptor cable into the **AV OUT** jack of this player.
- 2 Connect a AV cable (not supplied) to:
  - the audio/video jacks of your TV.
  - the audio/video terminals of the AV adaptor cable.
- 3 Match the colors of the AV cable with the jacks:
  - the yellow cable is for the video jack
  - the red/white cable is for the audio jacks.
- 4 Turn on the player and your TV.
- 5 Find the AV input source on your TV (For details, refer to the user manual of your TV).

---

## Use an HDMI cable

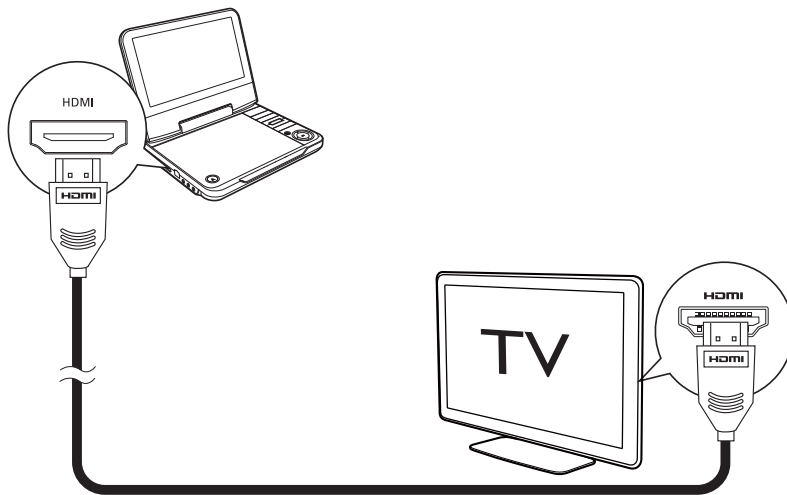

- 1 Connect the HDMI cable (not supplied) to:
  - the **HDMI** jack of this player.
  - the HDMI jack of your TV.
- 2 Turn on the player and your TV.
- 3 Find the HDMI input source on your TV (For details, refer to the user manual of your TV).

## 4 Use your portable Blu-ray disc player

---

### Turn on

---

#### For first-time use:

- 1 To turn on the battery switch, slide the **OFF•POWER•ON** switch to the **ON** position.

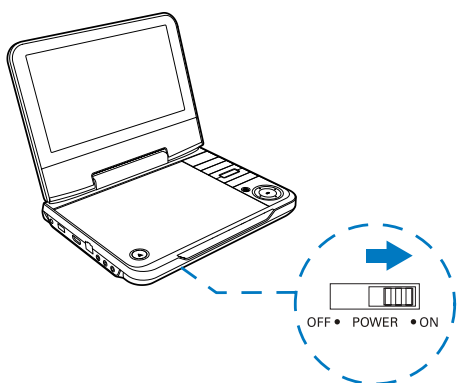

## For normal use:

- 1 To turn on the player, press **POWER** on the player.

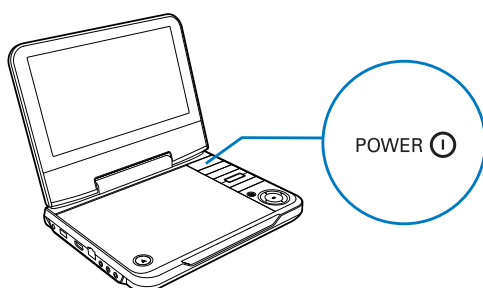

↳ The ① indicator turns on (green).

## To switch the player to standby, press **POWER** on the player.

- You can also press and hold  on the RC for three seconds, and then release it.
- The ① indicator turns off.



### Note

- If you do not intend to use this player for a long time, slide the **OFF•POWER•ON** switch to the **OFF** position to protect the battery from exhaustion.



---

## Play a disc



### Caution

- Risk of damage to the player! During play, never move the unit.
- Never put any object other than a disc into the disc compartment.
- Never look at the laser beam inside the player.
- Never play discs with accessories such as disc stabilizer rings or disc treatment sheets.

- 1 Press the  button on the player to open the disc cover.
- 2 Place a disc into the tray with the label side up.

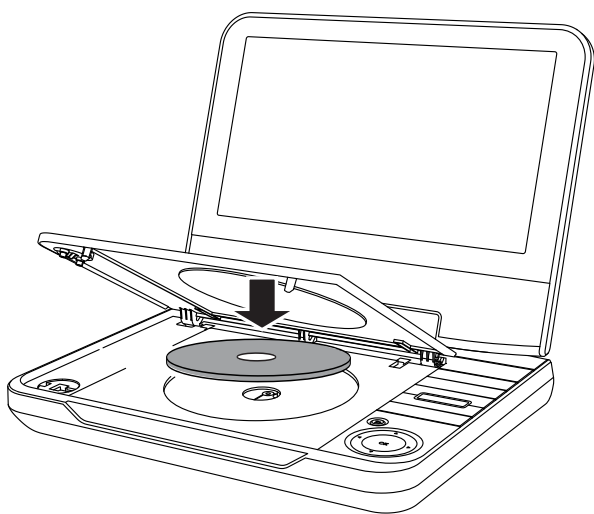

- 3 Close the disc cover.  
↳ The player starts playing automatically.

---

## Play media files via USB

To play picture, music, and video files from a USB storage device,

- 1 Connect the USB storage device to the  (USB) jack.

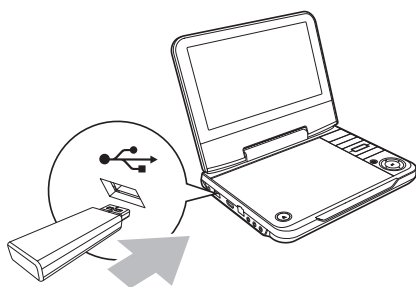

- 2 Press **⬆**, and select **[browse USB]**.  
 ↳ The file browser is displayed.

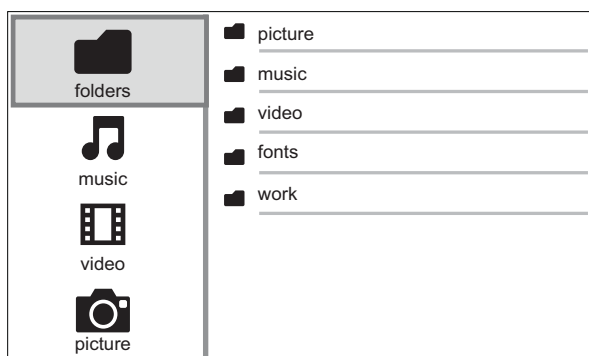

- ↳ To find music files, go to **[music]**.
- ↳ To find video files, go to **[video]**.
- ↳ To find picture files, go to **[pictures]**.
- ↳ To browse media files in the folder structure mode, go to **[folders]**.

- 3 Press **▲▼◀▶** to select a media file and press **OK** to play.

## Basic play control

Follow the instructions to control your play .

Button	Action
▶	Start or resume play.
	Pause play. Press repeatedly to slow forward frame by frame.
■	Stop play.

⏮ / ⏭	Skip to the previous or next track, chapter or file.
⏮⏮ / ⏭⏭	Fast backward or forward. Press repeatedly to change the search speed.
AUDIO	Select an audio language.
SUBTITLE	Select a subtitle language.
DISC MENU / POP-UP MENU	Access or exit the disc menu.
TOP MENU	Access the main menu of a video disc.
Color buttons	Select tasks or options for Blu-ray discs.
▲▼◀▶	Navigate the menus.
OK	Confirm a selection or entry.
↶	Return to a previous menu.
≡	Access more options during play.

## Video, audio and picture options

You can specify options for video or picture play from a disc or a USB storage device.

### Video options

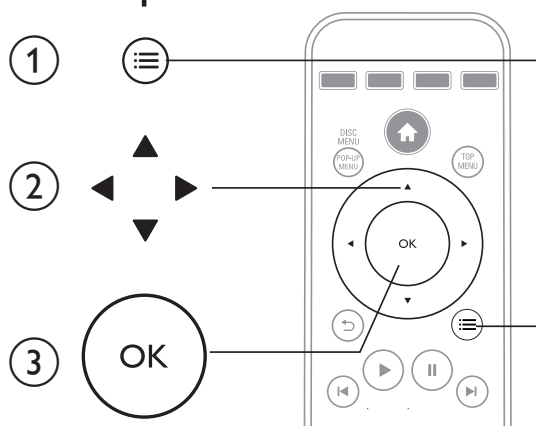

Access more options during video play.

- **[Audio Language]:** Select an audio language.
- **[Subtitle Language]:** Select a subtitle language.

- **[Subtitle Shift]**: Change the subtitle position on the screen. Press ▲ ▼ to change the subtitle position.
- **[Info]**: Display play information.
- **[Character Set]**: Select a character set that supports the DivX video subtitle (only for DivX videos).
- **[Time Search]**: Skip to a specific time via the numeric buttons on the remote control.
- **[2nd Audio Language]**: Select the second audio language (only for Blu-ray discs that support BonusView).
- **[2nd Subtitle Language]**: Select the second subtitle language (only for Blu-ray discs that support BonusView).
- **[Titles]**: Select a title.
- **[Chapters]**: Select a chapter.
- **[Angle List]**: Select a camera angle.
- **[Menus]**: Display a disc menu.
- **[PIP Selection]**: Display a picture-in-picture window.
- **[Zoom]**: Zoom into a video picture. Press ◀ ▶ to zoom in or zoom out.
- **[Repeat]**: Repeat a chapter or title.
- **[Repeat A-B]**: Repeat a specific section within a chapter for repeat play, or turn off repeat mode.
- **[Picture Settings]**: Select a predefined color setting.
- **[LCD Setup]**: Adjust the LCD screen settings.
- **[Setup]**: Access the setup menu.



#### Note

- Available video options depend on the video source.

---

## Picture options

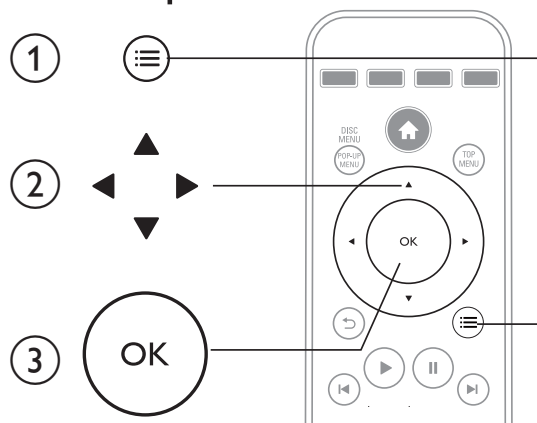

Access more options during a slideshow.

- **[Rotate +90]**: Rotate a picture 90 degrees clockwise.
- **[Rotate -90]**: Rotate a picture 90 degrees counter-clockwise.
- **[Zoom]**: Zoom into a picture. Press ◀▶ to zoom in or zoom out.
- **[Info]**: Display picture information.
- **[Duration per slide]**: Set a display interval for a slideshow.
- **[Slide Animation]**: Select a transition effect for a slideshow.
- **[Picture Settings]**: Select a predefined color setting.
- **[Repeat]**: Repeat a selected folder.
- **[LCD Setup]**: Adjust the LCD screen settings.
- **[Setup]**: Access the setup menu.

---

## Audio options

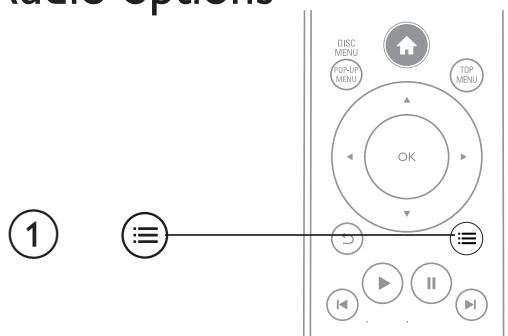

Press ≡ repeatedly to select an play option.

- Repeat the current track.
- Repeat all the tracks on the disc or folder.
- Play audio tracks in a random loop.
- Turn off a repeat mode.

## 5 Use your portable Blu-ray disc player

### DivX videos

You can play DivX videos from a disc or a USB storage device.

#### VOD code for DivX

Before you purchase DivX videos and play them on this player, register this player on [www.divx.com](http://www.divx.com) using the DivX VOD code.

- To display the DivX VOD code,
- 1 press **HOME**, and select **[Setup]**.
  - 2 Select **[Advanced]** > **[DivX® VOD Code]**.

#### DivX subtitles

Press **SUBTITLE** to select a language.

- If the DivX subtitle is incorrect, change the character set that supports the subtitle.
  - To select a character set,
- 1 Press **[Menu]**, and select **[Character Set]**.

Character set	Languages
<b>[Standard]</b>	English, Irish, Danish, Estonian, Finnish, French, German, Italian, Portuguese, Luxembourgish, Norwegian (Bokmål and Nynorsk), Spanish, Swedish, Turkish
<b>[Central Europe]</b>	Polish, Czech, Slovak, Albanian, Hungarian, Slovene, Croatian, Serbian (Latin script), Romanian
<b>[Cyrillic]</b>	Belarusian, Bulgarian, Ukrainian, Macedonian, Russian, Serbian
<b>[Greek]</b>	Greek

## Note

- To play DivX DRM protected files from a USB storage device, connect this player to a TV through HDMI.
- To use the subtitles, make sure that the subtitle file has the same name as the DivX video file name. For example, if the DivX video file is named “movie.avi”, save the subtitle file as “movie.srt”, or “movie.sub”.
- This player can play subtitle files in the following formats: .srt, .sub, .txt, .ssa, and .smi.

---

## BonusView on Blu-ray

View special content (such as commentaries) in a small screen window.

This feature is only applicable to Blu-ray discs compatible with BonusView (also known as picture in picture).

- 1 During play, press .  
↳ The options menu is displayed.
- 2 Select **[PIP Selection] > [PIP]**, and press **OK**.  
↳ PIP options [1]/[2] depend on the video contents.  
↳ The secondary video window is displayed.
- 3 Select **[2nd Audio Language]** or **[2nd Subtitle Language]**, and press **OK**.

---

## Set up a network

You can access the following services through the Internet:

- BD-Live: access online bonus features (applicable to Blu-ray discs that are BD-Live enabled)
  - Update software: update the software of this player.
- To set up a network,

- 1 Connect this player to
  - **LAN** port.
  - LAN port on a router with Internet connection.

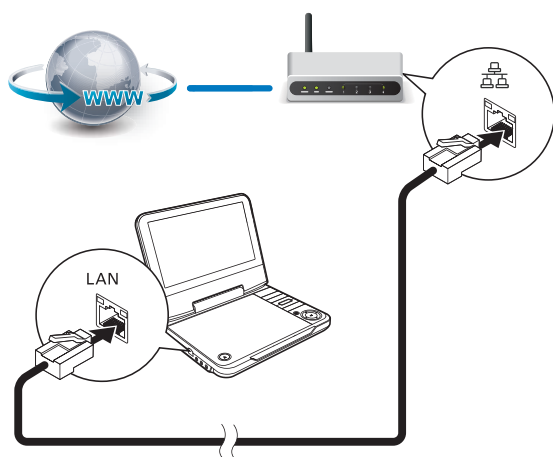

## 2 Perform the network installation.

- 1), Press **⬆**, and select **[Setup]**.
- 2), Select **[Network Setup] > [Network Installation]**.
- 3), Follow the on-screen instructions to complete the network setup.



### Caution

- Before you connect to a network, familiarize yourself with the network router, media server software for DLNA, and networking principles. If necessary, read documentation accompanying network components. Philips is not responsible for lost, damaged or corrupt data.

## BD-Live on Blu-ray

You can access exclusive online services, such as movie trailers, games, ringtones and other bonus contents.

- 1 Prepare the Internet connection and set up a network (see “Set up a network”).
- 2 Connect a USB storage device to the  (USB) jack of this player.
  - A USB storage device is used to store the downloaded BD-Live content.
- 3 Play a disc that is BD-Live enabled.
- 4 On the disc menu, select the BD-Live icon, and press **OK**.



↳ BD-Live starts loading.

**5** On the BD-Live interface, select an item to access.



#### Note

- This feature is only applicable to Blu-ray discs that are BD-Live enabled.
- BD-Live services vary from discs and countries.
- When you use BD-Live, data on the disc and this player are accessed by the content provider
- Use a USB storage device with at least 1GB of free space to store the download.

To delete the downloaded BD-Live content,

- 1** Press **⬆**, and select **[Setup]**.
- 2** Select **[Advanced]** > **[Clear memory]**.

---

## Use Philips EasyLink

This player supports Philips EasyLink which uses the HDMI CEC (Consumer Electronics Control) protocol. You can use a single remote control to control EasyLink compliant devices that are connected through HDMI.

- 1** Connect the HDMI CEC compliant devices through HDMI, and turn on the HDMI CEC operations on the TV and other connected devices (see the user manual of the TV or other devices for details).
- 2** Press **⬆**.
- 3** Select **[Setup]** > **[EasyLink Setup]**.
- 4** Select **[On]** under the options:
  - **[EasyLink]** > **[On]**
  - **[One Touch Play]** > **[On]**
  - **[One Touch Standby]** > **[On]**

Video Setup	EasyLink	● On
Audio Setup	One Touch Play	● On
Network Setup	One Touch Standby	● On
<b>EasyLink Setup</b>		
Preference		
Advanced		
LCD Setup		

- EasyLink function is turned on.

---

### One Touch Play

When you play a disc with this player, the connected HDMI CEC TV automatically switches to the HDMI input channel.

---

### One Touch Standby

When you switch a connected device (for example TV) to the standby mode with its own remote control, this player switches to the standby mode automatically.

---



#### Note

- Philips does not guarantee 100% interoperability with all HDMI CEC devices.

## 6 Change settings

You can change the settings of this player in the setup menu.

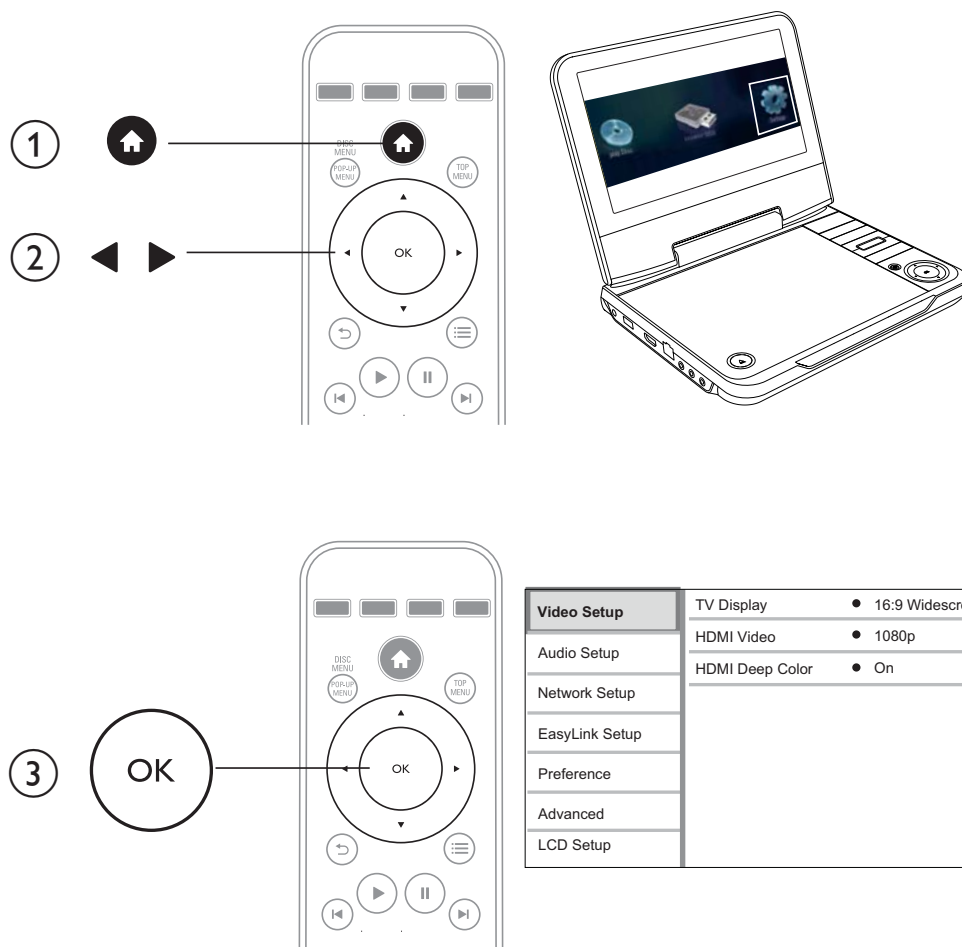

### Note

- You cannot change a menu option that is grayed out.
- To return to the previous menu, press ↶.
- To exit the menu, press 🏠.

## Picture

<b>Video Setup</b>	TV Display	● 16:9 Widescreen
Audio Setup	HDMI Video	● 1080p
Network Setup	HDMI Deep Color	● On
EasyLink Setup		
Preference		
Advanced		
LCD Setup		

**[TV Display]:** Select a picture display format to fit your TV screen.

**[HDMI Video]:** Select an HDMI video resolution.

**[HDMI Deep Color]:** Display colors with more shades and hues when the video content is recorded in Deep Color mode and the TV supports this feature.



### Note

- For settings related to HDMI, you need to connect this player to your TV through HDMI.
- For the composite connection (via the **AV OUT** jack), select a video resolution of 480i/576i or 480p/576p under **[HDMI Video]** to enable video output.

## Sound

Video Setup	Night Mode	● Auto
<b>Audio Setup</b>	Neo 6	● Off
Network Setup	HDMI Audio	● Auto
EasyLink Setup		
Preference		
Advanced		
LCD Setup		

**[Night Mode]:** Equalize loud sound and soft sound. Enable this feature to watch movies at a low volume at night.

[**Neo 6**]: Enable or disable a surround sound effect which is converted from DTS 2.0 channel audio.

[**HDMI Audio**]: Set an HDMI audio format when this player is connected through HDMI.

 **Note**

- For settings related to HDMI, the TV must be connected through HDMI.
- Night mode is only available for Dolby encoded DVD and Blu-ray discs.

## Network

Video Setup	Network Installation ●
Audio Setup	View Network Settings ●
<b>Network Setup</b>	
EasyLink Setup	
Preference	
Advanced	
LCD Setup	

[**Network Installation**]: Start network installation to connect the player to the network.

[**View Network Settings**]: Display the current network status.

## Preference

Video Setup	Menu Language ● English
Audio Setup	Audio ● English (ENG)
	Subtitle ● English (ENG)
Network Setup	Disc Menu ● Chinese (CHI)
EasyLink Setup	Parental Control ● Off
<b>Preference</b>	Screen Saver ● On
Advanced	Change Password ●
LCD Setup	VCD PBC ● On

**[Menu language]:** Select a language for the onscreen menu .

**[Audio]:** Select an audio language for video.

**[Subtitle]:** Select a subtitle language for video.

**[Disc Menu]:** Select a menu language for a video disc.

**[Parental Control]:** Set the rating level to a disc. Restrict the play of a disc to children. These discs must be recorded with rating levels.



#### Note

- Input “0000” to access the restriction options. To play all discs without rating restrictions, select level “8”.

**[Screen Saver]:** Enable or disable the screen saver function. If enabled, the screen saver is activated after 10 minutes of inactivity (for example, in pause or stop mode).

**[Change Password]:** Set a password to play a restricted disc. Input “0000” if you do not have a password or if you forgot your password.

**[VCD PBC]:** Display or skip the content menu for VCD and SVCD.

**[Sleep Timer]:** Enable a countdown timer to switch this player to standby mode after a specific period of time.



#### Note

- If your preferred language is not available for disc language, audio or subtitle, you can select **[Other]** from the menu options and input 4-digit language code which can be found at the back of this user manual.
- If you select a language which is not available on a disc, this player uses the default language of the disc.

## Advanced options

Video Setup	BD-Live Security	● Off
Audio Setup	Software Update	●
Network Setup	Clear memory	●
EasyLink Setup	DivX® VOD Code	●
Preference	Version Info.	●
Advanced	Restore default setting	●
LCD Setup		

**[BD-Live Security]:** Restrict or allow access to BD-Live (only for non-commercial, users-created Blu-Live discs).

**[Software Update]:** Select to update software from a network or from USB storage device.

**[Clear memory]:** Delete the downloaded BD-Live content on the USB storage device.

**[DivX® VOD Code]:** Display the DivX® registration code or the deregistration code for this player.

**[Version Info.]:** Display the software version of this player.

**[Restore default settings]:** Reset this player to the default settings made at the factory.

### Note

- You cannot restrict Internet access on commercial Blu-ray discs.
- Before you purchase DivX videos and play them on this player, register this player on [www.divx.com](http://www.divx.com) with the DivX VOD code.
- You cannot reset a parental control setting to the default value.

## LCD screen

Video Setup	Brightness	20
Audio Setup	Contrast	● 15
Network Setup	Colour	● 17
EasyLink Setup	Hue	● 0
Preference	Screen	● Full Screen
Advanced		
LCD Setup		

**[Brightness]:** Set the brightness level of the LCD screen.

**[Contrast]:** Set the contrast level of the LCD screen.

**[Colour]:** Set the saturation level of the LCD screen.

**[Hue]:** Set the hue level of the LCD screen.

**[Screen]:** Set the aspect ratio of the LCD screen.



# 7 Update software

Before you update the software of this player, check the current software version:

- 1 Press , and select **[Setup]**.
- 2 Select **[Advanced]** > **[Version Info.]**, and press **OK**.  
↳ The software version information is displayed.



---

## Update software via the Internet

- 1 Connect the player to the Internet (see “Set up a network”).
- 2 Press , and select **[Setup]**.
- 3 Select **[Advanced]** > **[Software Update]** > **[Network]**.  
↳ If an upgrade media is detected, you are prompted to start the update.
- 4 Follow the instructions on the screen to update the software.

---

## Update software via USB

- 1 Check the latest software version on [www.philips.com/support](http://www.philips.com/support).
  - Search for your model and click on “Software and drivers”.
- 2 Download the software into a USB storage device.
  - ① **Unzip the download, and make sure that the unzipped folder is named “UPG\_ALL”.**
  - ② **Put the “UPG\_ALL” folder in the root directory.**
- 3 Connect the USB storage device to the  (USB) jack on this player.
- 4 Press , and select **[Setup]**.
- 5 Select **[Advanced]** > **[Software Update]** > **[USB]**.  
↳ If an upgrade media is detected, you are prompted to start the update.
- 6 Follow the instructions on the screen to update the software.



### Caution

- Do not turn off the power or remove the USB storage device when the software update is in progress because you might damage this player.

# 8 Specifications





## Note

- Specifications are subject to change without notice

## Region code

This player can play discs with the following region codes.

DVD	Blu-ray	Countries
 		U.S.A and Canada

## Playable media

- BD-Video
- DVD-Video, DVD+R/+RW, DVD-R/-RW, DVD+R/-R DL (Dual Layer)
- VCD/SVCD
- Audio CD, CD-R/CD-RW, MP3 media, WMA media, JPEG files
- DivX Plus HD media, MKV media
- USB storage device

## File format

- Video: .avi, .divx, .mp4, .mkv
- Audio: .mp3, .wma, .wav
- Picture: .jpg, .gif, .png

## Video

- Signal system: PAL / NTSC
- Composite video output: 1 Vp-p (75 ohm)
- HDMI output 480i, 480p, 576i, 576p, 720p, 1080i, 1080p, 1080p24

## Audio

- HDMI output
- Sampling frequency:
  - MP3: 32 kHz, 44.1 kHz, 48 kHz
  - WMA: 44.1 kHz, 48 kHz
- Constant bit rate:
  - MP3: 112 kbps - 320 kbps
  - WMA: 48 kbps - 192 kbps

## USB

- Compatibility: Hi-Speed USB (2.0)
- Class support: USB Mass Storage Class (UMS)
- File system: FAT16, FAT32
- Support HDD (a portable hard drive disc): an external power source may be needed.

## Main unit

- Power supply rating: AC 100-240V~, 50 Hz
- Power consumption: 10 W
- Power consumption in standby mode: < 0.25 W
- Dimensions: 240 × 200 × 47.2 (mm)
- Net Weight: 1.35 kg

## Laser Specification

- Laser Type (Diode): AlGaInN (BD), AlGaInP (DVD/CD)
- Wave length: 440-410nm (BD), 650-663nm (DVD), 770-800nm (CD)
- Output power: 20mW (BD), 7mW (DVD), 7mW (CD)

## 9 Troubleshooting



### Warning

- Risk of electric shock. Never remove the casing of the player.

To keep the warranty valid, never try to repair the player yourself.

If you have problems using this player, check the following points before you request service. If you still have a problem, register your player and get support at [www.philips.com/welcome](http://www.philips.com/welcome).

If you contact Philips, you will be asked for the model and serial number of this player. The model number and serial number are on the back of this player. Write the numbers here:

Model No. \_\_\_\_\_

Serial No. \_\_\_\_\_

---

### Main unit

#### The buttons on this player do not work.

- Disconnect this player from the power supply for a few minutes, and then reconnect.

#### No power

- Ensure that both plugs of the mains cord are properly connected.
- Ensure that there is power at the car cigarette lighter or AC outlet.

#### The player feels warm

- When the player is in use for a long period of time, its surface will be heated. This is normal.

---

### Picture

#### No picture.

- Make sure that the TV is switched to the correct source input for this player.

**No picture on HDMI connection.**

- Make sure that the HDMI cable is not faulty. If it is faulty, replace with a new HDMI cable.
- On the remote control, press  and then press “731” (numeric buttons) to recover picture display. Or wait for 10 seconds for auto recovery.
- If this player is connected to an unauthorized display device with an HDMI cable, the audio and video signals may not be output.

**The disc does not play high-definition video.**

- Make sure that the disc contains high-definition video.
- Make sure that the TV supports high-definition video.

**Distorted picture**

- Clean the disc. With a clean, soft, lint-free cloth, wipe the disc outwards from the center.
- Make sure that the video output format of the disc is compatible with the TV.
- Change the video output format to match your TV or program.
- The LCD is manufactured using high precision technology. You may, however, see tiny black points and/or bright points (red, blue, green) that continuously appear on the LCD. This is a normal result of the manufacturing process and does not indicate a malfunction.

---

**Sound****No audio output from the TV.**

- Make sure that the audio cables are connected to the audio input of the TV.
- Make sure that the TV is switched to the correct source input for this player.

**No audio output from the loudspeakers of the external audio device (home theater or amplifier).**

- Make sure that the audio cables are connected to the audio input of the audio device.
- Switch the external audio device to the correct audio source input.

**No sound on HDMI connection.**

- You may not hear any sound from the HDMI output if the connected device is non-HDCP compliant or only DVI-compatible.

---

**Play****Cannot play a disc.**

- Clean the disc.
- Make sure that the disc is correctly loaded.
- Make sure that this player supports the disc. See “Product specifications”.
- Make sure that this player supports the region code of the DVD or BD.
- For DVD±RW or DVD±R, make sure that the disc is finalized.

**Cannot play DivX video files.**

- Make sure that the DivX video file is complete.
- Make sure that the video file name extension is correct.
- To play DivX DRM protected files from a USB storage device, connect this player to a TV through HDMI.

**DivX subtitles do not display correctly.**

- Make sure that the subtitle file has the same name as the DivX video file.
- Make sure that the subtitle file has an extension name supported by this player (.srt, .sub, .txt, .ssa, or smi).

**Cannot read the contents of a connected USB storage.**

- Make sure that the format of the USB storage device is compatible with this player.
- Make sure that the file system on the USB storage device is supported by this player.
- For a portable hard drive disc (HDD), an external power source may be needed.

**‘No entry’ or ‘x’ sign appears on the TV.**

- The operation is not possible.

**EasyLink feature does not work.**

- Make sure that this player is connected to the Philips brand EasyLink TV, and the EasyLink option is turned on (see “Use your Blu-ray disc/ DVD player” > “Use Philips EasyLink”).

**Cannot access BD-Live features.**

- Make sure that this player is connected to the network (see “Use your Blu-ray disc/ DVD player” > “Set up a network”).
- Make sure that the network installation is made (see “Use your Blu-ray disc/ DVD player” > “Set up a network”).
- Make sure that the Blu-ray disc supports BD-Live features.
- Clear memory storage (see “Change settings” > “Advanced options (BD-Live security, clear memory...)”).

# Language code

Abkhazian	6566	Inupiaq	7375	Pushto	8083
Afar	6565	Irish	7165	Russian	8285
Afrikaans	6570	Íslenska	7383	Quechua	8185
Amharic	6577	Italiano	7384	Raeto-Romance	8277
Arabic	6582	Ivrit	7269	Romanian	8279
Armenian	7289	Japanese	7465	Rundi	8278
Assamese	6583	Javanese	7486	Samoan	8377
Avestan	6569	Kalaallisut	7576	Sango	8371
Aymara	6589	Kannada	7578	Sanskrit	8365
Azerhijani	6590	Kashmiri	7583	Sardinian	8367
Bahasa Melayu	7783	Kazakh	7575	Serbian	8382
Bashkir	6665	Kernewek	7587	Shona	8378
Belarusian	6669	Khmer	7577	Shqip	8381
Bengali	6678	Kinyarwanda	8287	Sindhi	8368
Bihari	6672	Kirghiz	7589	Sinhalese	8373
Bislama	6673	Komi	7586	Slovensky	8373
Bokmål, Norwegian	7866	Korean	7579	Slovenian	8376
Bosanski	6683	Kuanyama; Kwanyama	7574	Somali	8379
Brezhoneg	6682	Kurdish	7585	Sotho; Southern	8384
Bulgarian	6671	Lao	7679	South Ndebele	7882
Burmese	7789	Latina	7665	Sundanese	8385
Castellano, Español	6983	Latvian	7686	Suomi	7073
Catalán	6765	Letzeburgesch;	7666	Swahili	8387
Chamorro	6772	Limburgan; Limburger	7673	Swati	8383
Chechen	6769	Lingala	7678	Svenska	8386
Chewa; Chichewa; Nyanja	7889	Lithuanian	7684	Tagalog	8476
中文	9072	Luxembourgish;	7666	Tahitian	8489
Chuang; Zhuang	9065	Macedonian	7775	Tajik	8471
Church Slavic; Slavonic	6785	Malagasy	7771	Tamil	8465
Chuvash	6786	Magyar	7285	Tatar	8484
Corsican	6779	Malayalam	7776	Telugu	8469
Česky	6783	Maltese	7784	Thai	8472
Dansk	6865	Manx	7186	Tibetan	6679
Deutsch	6869	Maori	7773	Tigrinya	8473
Dzongkha	6890	Marathi	7782	Tonga (Tonga Islands)	8479
English	6978	Marshallese	7772	Tsonga	8483
Esperanto	6979	Moldavian	7779	Tswana	8478
Estonian	6984	Mongolian	7778	Türkçe	8482
Euskara	6985	Nauru	7865	Turkmen	8475
Ελληνικά	6976	Navaho; Navajo	7886	Twi	8487
Faroese	7079	Ndebele, North	7868	Uighur	8571
Français	7082	Ndebele, South	7882	Ukrainian	8575
Frysk	7089	Ndonga	7871	Urdu	8582
Fijian	7074	Nederlands	7876	Uzbek	8590
Gaelic; Scottish Gaelic	7168	Nepali	7869	Vietnamese	8673
Gallegan	7176	Norsk	7879	Volapuk	8679
Georgian	7565	Northern Sami	8369	Walloon	8765
Gikuyu; Kikuyu	7573	North Ndebele	7868	Welsh	6789
Guarani	7178	Norwegian Nynorsk;	7878	Wolof	8779
Gujarati	7185	Occitan; Provençal	7967	Xhosa	8872
Hausa	7265	Old Bulgarian; Old Slavonic	6785	Yiddish	8973
Herero	7290	Oriya	7982	Yoruba	8979
Hindi	7273	Oromo	7977	Zulu	9085
Hiri Motu	7279	Ossetian; Ossetic	7983		
Hrwatski	6779	Pali	8073		
Ido	7379	Panjabi	8065		
Interlingua (International)	7365	Persian	7065		
Interlingue	7365	Polski	8076		
Inuktitut	7385	Português	8084		