



AJ2000



Quick start guide

PHILIPS

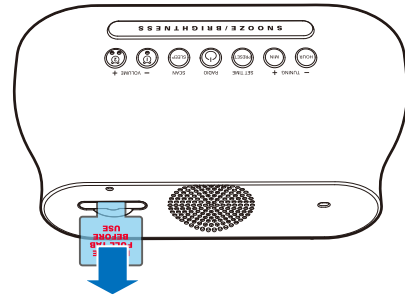

For first-time use, remove the protective tab to activate the battery.

Note:

- You can only use AC power as power supply. The battery can only back up clock and alarm settings.

1

2

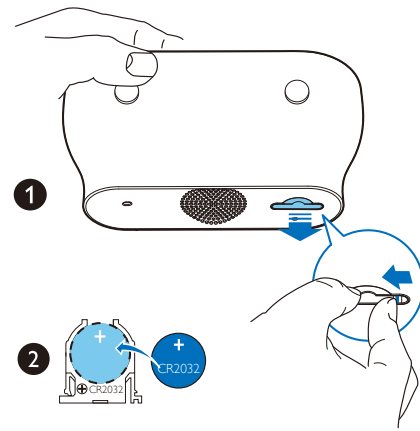

To replace the battery:

- Push the clip to the left and pull out the battery tray.
- Insert 1 x CR2032 battery as illustrated.

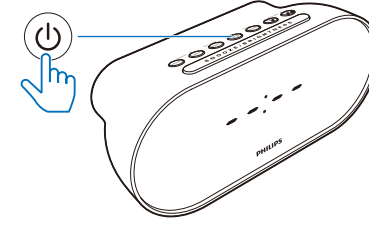
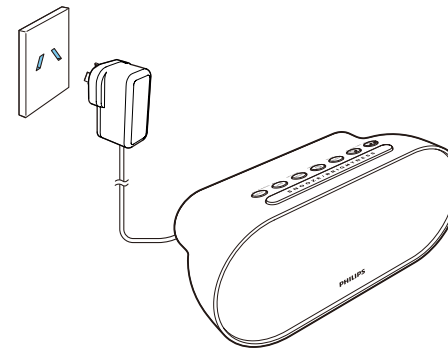

(STANDBY) ↔ FM

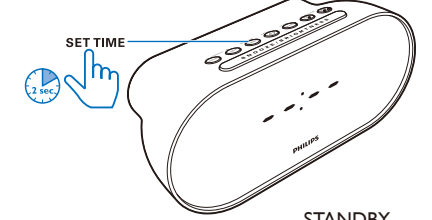

1

2

3

4

5

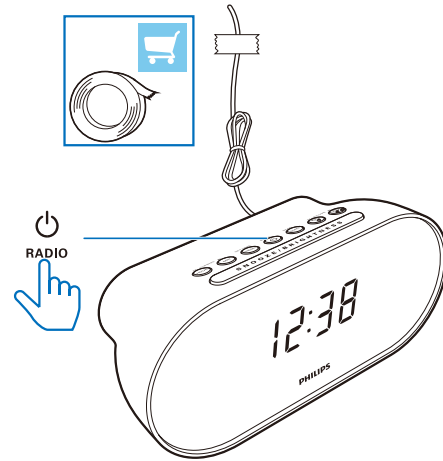
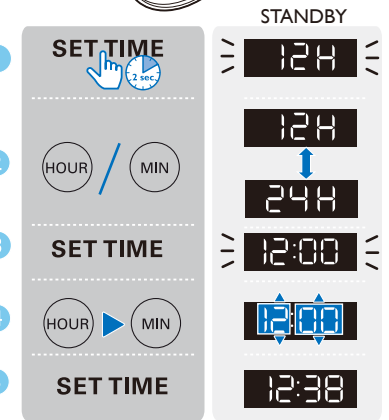

- Fully extend and adjust the position of the pig-tail antenna until you find the best reception.
- Fix the antenna as illustrated.

Tune to radio stations

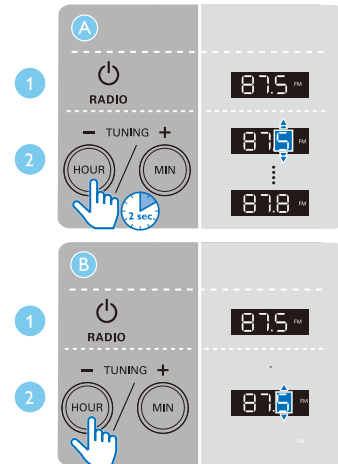

Store radio stations automatically

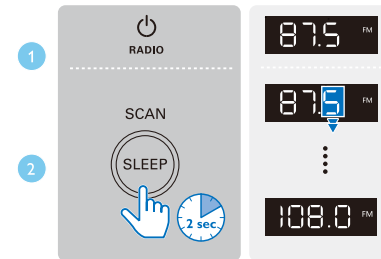

Store radio stations manually

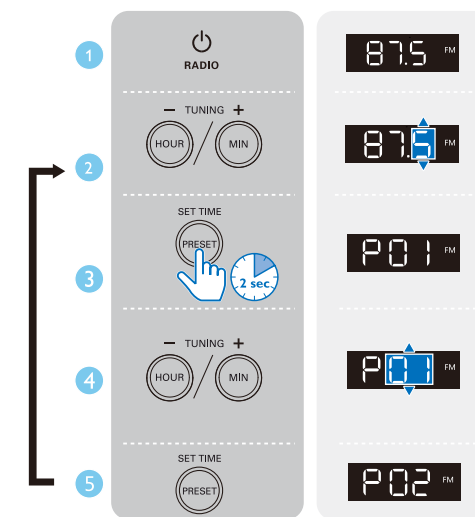

Select a preset radio station

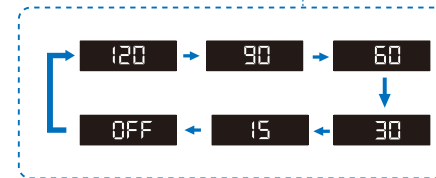
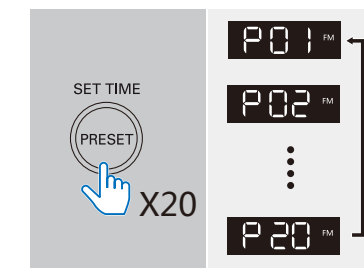

- Press **SLEEP** repeatedly to select a time period (in minutes).
- The product switches to standby mode automatically after the preset period.
 - When **[OFF]** is displayed, the sleep timer is deactivated.



This product has been manufactured by, and is sold under the responsibility of Gibson Innovations Ltd., and Gibson Innovations Ltd. is the warrantor in relation to this product. Philips and the Philips Shield Emblem are registered trademarks of Koninklijke Philips N.V. and are used under license.



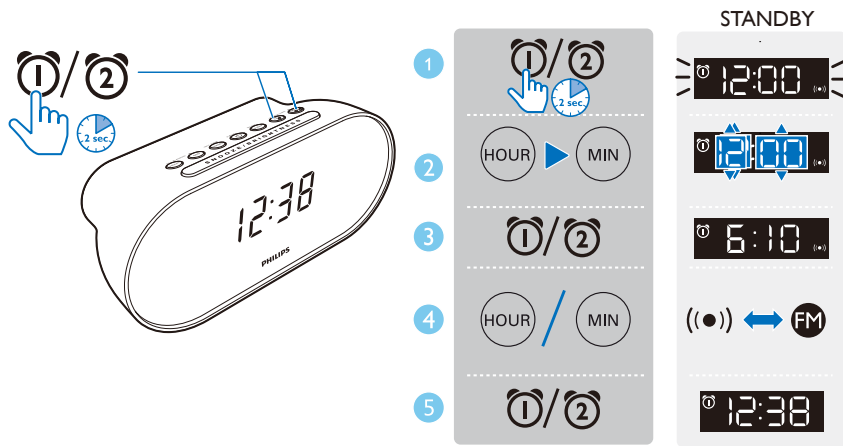

- Note:**
- Make sure that you have set the clock correctly.
 - You can select buzzer or your last listened FM station as alarm source. The alarm volume is not adjustable, but will go up gradually to gently wake you up.

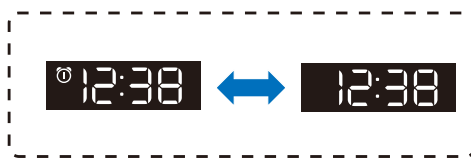
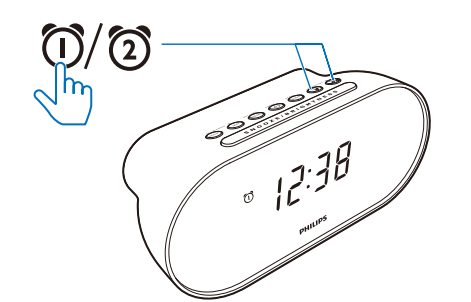

Press 1 or 2 repeatedly to activate or deactivate the alarm timer.

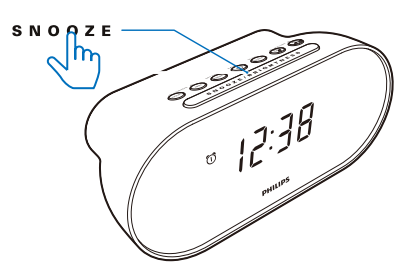

When the alarm goes off, press SNOOZE. The alarm snoozes and repeats ringing nine minutes later.

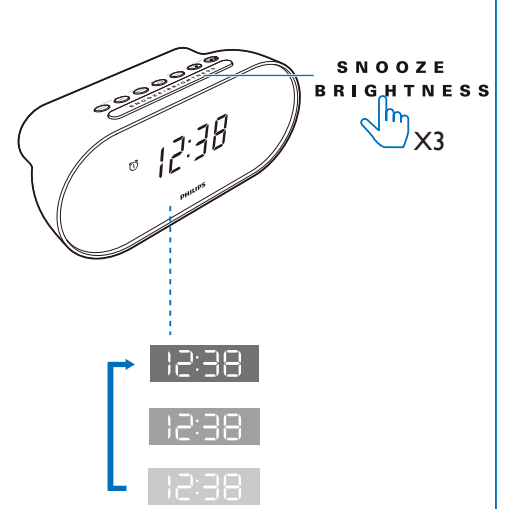

PHILIPS

Warranty against Defects

In this warranty:
We or us means Gibson Innovations ABN 531 651 059 75, and our contact details are set out at the end of this warranty;
You means the purchaser or the original end-user of the Goods;
Supplier means the authorised distributor or retailer of the Goods that sold you the Goods in Australia or New Zealand; and
Goods means the product or equipment which was accompanied by this warranty and purchased in Australia or New Zealand.

If you require assistance with the operation of the product, its features or specifications please call the Philips Consumer Care Centre on 1300 850 633 in Australia or 0800 639 953 in New Zealand.

Australia: Our Goods come with guarantees that cannot be excluded under the Australian Consumer Law. You are entitled to a replacement or refund for a major failure and for compensation for any other reasonably foreseeable loss or damage. You are also entitled to have the Goods repaired or replaced if the goods fail to be of acceptable quality and the failure does not amount to a major failure. This is not a complete statement of your legal rights as a consumer.

New Zealand: Our Goods come with guarantees that cannot be excluded under the Consumer Guarantees Act 1993. This guarantee applies in addition to the conditions and guarantees implied by that legislation.

Additional Warranty: In addition to the rights and remedies that you have under the Australian Consumer Law, Consumer Guarantees Act of New Zealand or any other applicable law, we provide the following warranty against defects:

1. If, during the first **12 months** from their date of purchase from the Supplier (**Warranty Period**), the Goods prove defective by reason of improper workmanship or materials and none of your statutory rights or remedies apply, we will repair or replace the Goods without charge.
2. We do not have to repair or replace the Goods under this Additional Warranty if the Goods have been used for a commercial purpose; misused, improperly or inappropriately installed, operated or repaired; abused; damaged; or not maintained in accordance with the manufacturer's instructions.
3. Even when we do not have to repair or replace the Goods, we may decide to do so anyway. In some cases, we may decide to substitute the Goods with a similar alternative product of our choosing. All such decisions are at our absolute discretion.
4. All such repaired, replaced or substituted Goods continue to receive the benefit of this Additional Warranty for the time remaining on the original Warranty Period.
5. This Additional Warranty is limited to repair, replacement or substitution only. As far as the law permits, we will not be liable for any loss or damage caused to property or persons arising from any cause whatsoever.
6. In order to claim under this Additional Warranty you must telephone us on 1300 850 633 in Australia or 0800 639 953 in New Zealand within the Warranty Period. You will be asked for details of the Goods, a description of the defect and your personal details. Upon accepting your claim, we shall assist you with either returning the Goods to the Supplier for replacement or to the most convenient Philips Authorised Service Centre for your Goods to be repaired. In some case we may require that you return to the Goods to us (at the address below) for repair, replacement or substitution.
 - * All returned Goods must be accompanied by satisfactory proof of purchase which clearly indicates the name and address of the Supplier, the date and place of purchase and identifies product. It is best to provide a legible and unmodified receipt or sales invoice.
 - * You must bear any expense for return of the Goods or otherwise associated with making your claim under this Additional Warranty.
7. This warranty is only valid and enforceable in Australia and New Zealand.

Contact us or the place of purchase for further details.

Australia
 Gibson Innovations
 305/4 Columbia Court,
 Baulkham Hills, NSW, 2153

New Zealand

Consumer Care: 1300 850 633
E-mail: PhilipsSound_APAC@gibson.com
Website: www.philips.com/support

Consumer Care: 0800 639 953
Email: PhilipsSound_APAC@gibson.com
Website: www.philips.com/support

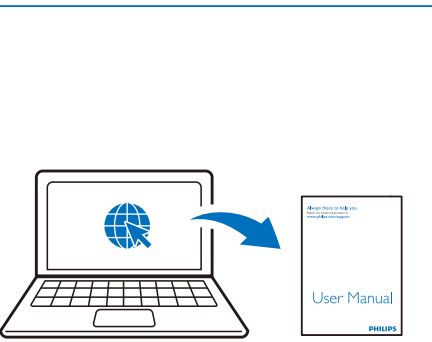
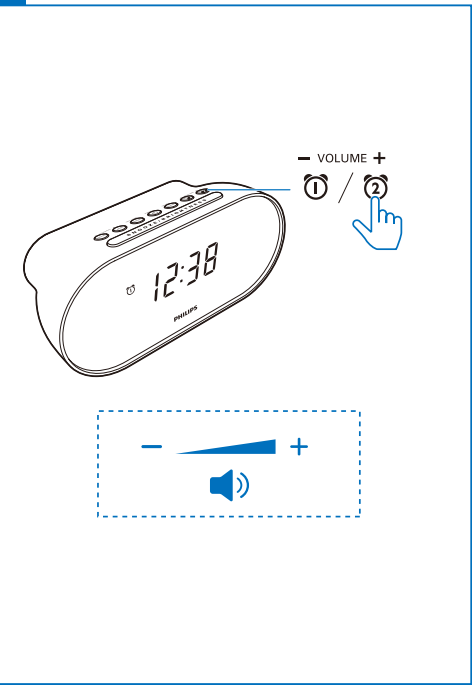

www.philips.com/support

1 Safety

- Make sure that there is enough free space around the clock radio for ventilation.
- Only use attachments/accessories specified by the manufacturer.
- Use only power supplies listed in the user manual.
- Unplug this clock radio during lightning storms or when unused for long periods of time.
- Battery usage CAUTION – To prevent battery leakage which may result in bodily injury, property damage, or damage to the clock radio:
 - Install the battery correctly, + and - as marked on the clock radio.
 - Remove the battery when the clock radio is not used for a long time.
 - The battery shall not be exposed to excessive heat such as sunshine, fire or the like.
- The clock radio shall not be exposed to dripping or splashing.
- Do not place any sources of danger on the clock radio (e.g. liquid filled objects, lighted candles).
- Where the plug of the Direct Plug-in Adapter is used as the disconnect device, the disconnect device shall remain readily operable.

Risk of swallowing batteries!

- The device may contain a coin/button type battery, which can potentially be swallowed. Keep the battery out of reach of children at all times! If swallowed, the battery can cause serious injury or death. Severe internal burns can occur within two hours of ingestion.
- If you suspect that a battery has been swallowed or placed inside any part of the body, seek immediate medical attention.

- When you change the batteries, always keep all new and used batteries out of reach of children. Make sure that the battery compartment is completely secure after you replace the battery.
- If the battery compartment cannot be completely secured, discontinue use of the product. Keep out of reach of children and contact the manufacturer.

Note

- The type plate is located on the bottom of the product.

2 Notice

Any changes or modifications made to this device that are not expressly approved by Gibson Innovations may void the user's authority to operate the equipment.

Disposal of your old product

Your product is designed and manufactured with high quality materials and components, which can be recycled and reused.



Do not throw away the product with the normal household waste at the end of its life, but hand it in at an official collection point or recycling. By doing this, you help to preserve the environment.

3 Specifications

Rated Output Power	0.7W RMS @ 10% THD
Acoustic Frequency Response	250 Hz - 13 kHz
Speaker Driver	1 x 1.5", 8 Ω
Tuner Frequency Range	FM: 87.5 - 108 MHz
Number of Preset Stations	20
Power Supply (Power Adapter)	Brand name: PHILIPS; Model: GQ05-050050-AA; Input: 100-240V~, 50/60 Hz, 0.3 A Max; Output: DC 5V, 500 mA;
Battery	1 x CR2032 battery for time/alarm backup
Standby Power Consumption	<1 W
Dimensions - Main Unit (W x H x D)	185 x 85 x 81 mm
Weight - Main Unit	0.3 kg