

Register your product and get support at
www.philips.com/welcome

CTS4000



EN	Compact Theatre System (CinemaOne)	5
ES LA	Compact Theatre System (CinemaOne)	40
PT BR	Compact Theatre System (CinemaOne)	77

PHILIPS

Es necesario que lea cuidadosamente su instructivo de manejo.



Descripción: Reproductor de Disco de Video Digital
Modelo: CTS4000
Alimentación: 100-240V; 50-60 Hz
Consumo: 22 W
Importador: Philips Mexicana, S.A. de C.V.
Domicilio: Av. La Palma No. 6,
Col. San Fernando, La Herradura
Huixquilucan, Edo de Mexico
C.P. 52784, Mexico
Localidad y Tel.: Tel. 52 69 90 00
Exportador: Philips Electronics HK, Ltd.
País de Origen: China

Nº de Serie: _____

LEA CUIDADOSAMENTE ESTE INSTRUCTIVO
ANTES DE USAR SU APARATO.

AVISO IMPORTANTE

Philips Mexicana, S.A. de C.V. no se hace responsable por daños o desperfectos causados por:

- *Maltrato, descuido o mal uso, presencia de insectos o roedores (cucarachas, ratones etc.).*
- *Cuando el aparato no haya sido operado de acuerdo con el instructivo del uso, fuera de los valores nominales y tolerancias de las tensiones (voltaje), frecuencia (ciclaje) de alimentación eléctrica y las características que deben reunir las instalaciones auxiliares.*
- *Por fenómenos naturales tales como: temblores, inundaciones, incendios, descargas electricas, rayos etc. o delitos causados por terceros (choques asaltos, riñas, etc.).*

“Evite o uso prolongado do aparelho com volume superior a 85 decibéis pois isto poderá prejudicar a sua audição.”

Nível de Decibéis	Exemplos
30	Biblioteca silenciosa, sussurros leves
40	Sala de estar, refrigerador, quarto longe do trânsito
50	Trânsito leve, conversa normal, escritório silencioso
60	Ar condicionado a uma distância de 6 m, máquina de costura
70	Aspirador de pó, secador de cabelo, restaurante ruidoso
80	Tráfego médio de cidade, coletor de lixo, alarme de despertador a uma distância de 60 cm
OS RUÍDOS ABAIXO PODEM SER PERIGOSOS EM CASO DE EXPOSIÇÃO CONSTANTE	
90	Metrô, motocicleta, tráfego de caminhão, cortador de grama
100	Caminhão de lixo, serra elétrica, furadeira pneumática
120	Show de banda de rock em frente às caixas acústicas, trovão
140	Tiro de arma de fogo, avião a jato
180	Lançamento de foguete



Manufactured under license from Dolby Laboratories. Dolby, Pro Logic, and the double-D symbol are registered trademarks of Dolby Laboratories.



Manufactured under license under U.S. Patent #'s: 5,451,942; 5,956,674; 5,974,380; 5,978,762; 6,487,535 & other U.S. and worldwide patents issued & pending. DTS and DTS Digital Surround are registered trademarks and the DTS logos and Symbol are trademarks of DTS, Inc. © 1996-2007 DTS, Inc. All Rights Reserved.



DivX, DivX Ultra Certified, and associated logos are trademarks of DivX, Inc. and are used under license.

Official DivX® Ultra Certified product.

Plays all versions of DivX® video (including DivX® 6) with enhanced playback of DivX® media files and the DivX® Media Format.



Windows Media and the Windows logo are trademarks, or registered trademarks of Microsoft Corporation in the United States and/ or other countries.

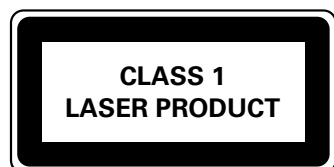

HDMI, and HDMI logo and High-Definition Multimedia Interface are trademarks or registered trademarks of HDMI licensing LLC.



The USB-IF Logos are trademarks of Universal Serial Bus Implementers Forum, Inc.



iPod is a trademark of Apple Computer, Inc., registered in the U.S. and other countries.



ENERGY STAR and the ENERGY STAR mark are registered U.S. marks

LASER

- | | |
|-------------------|---|
| • Type | Semiconductor laser
GaAlAs |
| • Wave length | 645 - 660 nm (DVD)
770 - 800 nm (CD) |
| • Output Power | 6 mW (DVD)
7 mW (VCD/CD) |
| • Beam divergence | 60 degrees |

Contents

1 Important	6
Safety and important notice	6
2 Your product	7
Features highlight	7
Product overview	8
3 Connect	11
Place the unit	11
Connect video cables	12
Connect to the power outlet	13
Connect audio cables/other devices	14
4 Get started	16
Prepare the remote control	16
Find the correct viewing channel	17
Select menu display language	17
Select a play source	18
5 Play	19
Play from disc	19
Play video	20
Play music	23
Play photo	24
Play from USB device	25
Play from portable media player	26
Play from iPod	26
6 Adjust sound	28
Control the volume	28
Select a preset sound effect	28
7 Adjust settings	29
General setup	29
Audio setup	30
Video setup	31
Preference Setup	33
8 Additional information	35
Update software	35
Care	35
Specifications	36
9 Troubleshooting	37
10 Glossary	39

1 Important

Safety and important notice

Warning!

Risk of fire or electric shock!

- Ensure that air can circulate freely through the ventilation holes on this unit. Allow at least 5~10 cm clearance around the unit.
- Never place this unit, remote control or batteries near naked flames or other heat sources, including direct sunlight.
- Never place this unit on other electrical equipment.
- Keep away from this unit during lightning storms.
- Never remove the casing of this unit. Please leave all maintenance work to qualified personnel.
- Keep this unit away from water, moisture and liquid-filled objects.

Caution!

- Remove batteries if they are exhausted or if the remote control is not to be used for a long time.
- Do not mix batteries (old and new or carbon and alkaline, etc.).
- Batteries contain chemical substances, they should be disposed of properly.
- Visible and invisible laser radiation when open. Avoid exposure to beam.
- Where the MAINS plug or an appliance coupler is used as the disconnect device, the disconnect device shall remain readily operable.

Recycle notice



This electronic equipment contains a large number of materials that can be recycled or reused if disassembled by a specialised company. If you are disposing of an old machine, please take it to a recycling centre. Please observe the local regulations regarding disposal of packaging materials, exhausted batteries and old equipment.

Please inform yourself about the local separate collection system for electrical and electronic products. Please act according to your local rules and do not dispose your old products with your normal household waste. The correct disposal of your old product will help to prevent potential negative consequences for the environment and human health.

Copyright notice

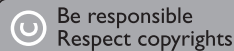

This product incorporates copyright protection technology that is protected by method claims of certain U.S. patents and other intellectual property rights owned by Macrovision Corporation and other rights owners. Use of this copyright protection technology must be authorised by Macrovision Corporation, and is intended for home and other limited viewing uses only unless otherwise authorised by Macrovision Corporation. Reverse engineering or disassembly is prohibited.

2 Your product

Congratulations on your purchase, and welcome to Philips! To fully benefit from the support that Philips offers, register your product at www.philips.com/welcome.

This Compact Theatre System (CinemaOne) is designed to complement your home perfectly. Enjoy the excellent sound and picture quality.

Features highlight

Video upscaling to 1080p

You can now watch the DVDs in the highest picture quality available for your HDTV. This Compact Theatre System offers full high-definition video playback up to 1080p resolution for an amazing viewing experience. A highly detailed picture and increased sharpness delivers a more true-to-life picture.

USB direct and MP3 link

Simply plug your USB device into the USB socket to play your MP3/WMA/JPEG/DivX files; or plug your portable media player to the MP3 LINK socket to enjoy the music play in superb sound quality.

Sync the audio output with the video play

This Compact Theatre System provides you the feature of delaying the audio output if the video signals that go directly to the TV is slower than the audio streams.

Region codes

DVD movies are usually not released at the same time in all regions of the world, thus all DVD players are programmed to a specific region code.

Countries	DVD region code
Latin America	 

Product overview

Main unit

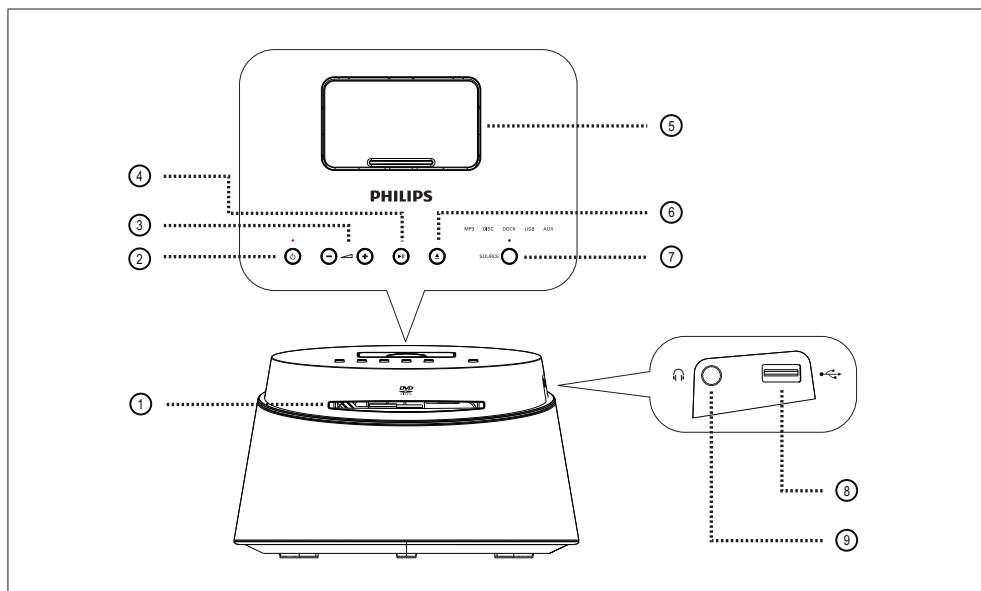

① Disc compartment

② (Standby-on)

- Turn on this unit or turn off to standby mode.

③ (Volume)

- Adjust the volume level.

④ (Play/Pause)

- Start or pause disc play.

⑤ Docking Station

- To connect iPod.

⑥ (Open/Close)

- Open or close the disc compartment.

⑦ SOURCE

- Select a play media:
MP3, DISC, DOCK, USB, AUX.



Note

- The following connections are located at the left side panel of the unit.

⑧ (USB) socket

- To connect USB storage device.

⑨ (Phones) socket

- To connect headphone.

Remote control

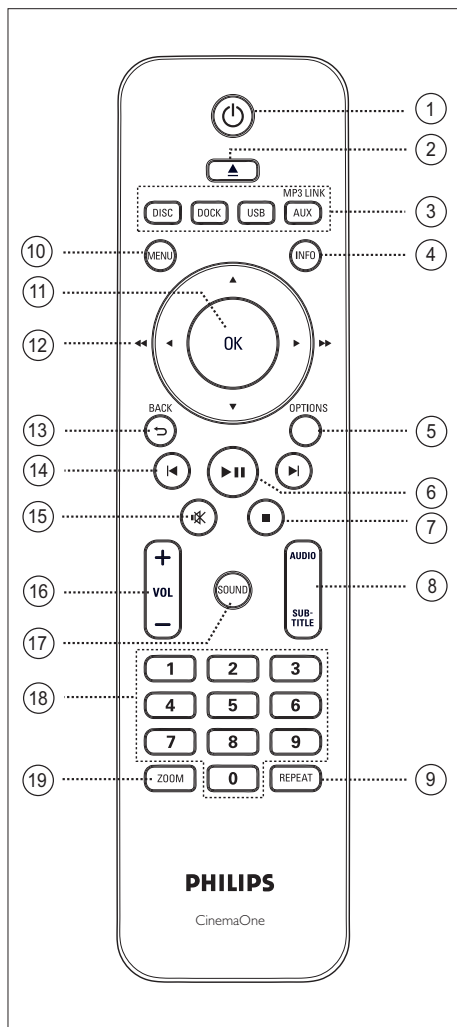

- ① **⏻ (Standby-On)**
 - Turn on this unit or turn off to standby mode.
- ② **▲ (Open/Close)**
 - Open or close the disc compartment.
- ③ **Source buttons**
 - **DISC:** switch to DISC mode.
 - **DOCK:** switch to the iPod in the dock.
 - **USB:** switch to USB mode.
 - **AUX / MP3 LINK:** switch to device that is connected to the AUX or MP3 LINK socket.
- ④ **INFO**
 - Display the current status or disc information.
 - Display photo files in 12 thumbnails view.
- ⑤ **OPTIONS**
 - Access or exit Options menu (this menu provides various setting options).
- ⑥ **▶|| (Play/Pause)**
 - Start or pause disc play.
- ⑦ **■ (Stop)**
 - Stop disc play.
- ⑧ **AUDIO/SUBTITLE**
 - Select an audio language/channel.
 - Select DVD or DivX subtitle language.
- ⑨ **REPEAT**
 - Select various repeat or shuffle modes; turns off repeat or shuffle mode.

⑩ MENU

- For DVD, go to title menu.
- For VCD version 2.0 or SVCD with PBC turned on: return to the menu during playback.

⑪ OK

- Confirm an entry or selection.

⑫ Cursor buttons (▲▼◀▶)

- Navigate through the on-screen menu.
- Press left or right for fast forward and backward search.

⑬ BACK ↵

- Return to the previous display menu.

⑭ ◀ / ▶ (Previous/Next)

- Skip to the previous or next title/ chapter/track.

⑮ 🔇 (Mute)

- Mute or restore the volume.

⑯ VOL + –

- Adjust the volume level.

⑰ SOUND

- Select a predefined sound effect.

⑱ Numeric buttons

- Enter a preset number or item to play.

⑲ ZOOM

- Zoom in or out the picture on the TV.

3 Connect

This section describes the basic connections required for this Compact Theatre System (CinemaOne) before it can be used.

Basic connections:

- Connect video cables
- Connect to power outlet

Optional connections:

- Connect audio cables
 - Connect audio from TV
 - Connect audio from cable box/recorder/game console
- Connect other devices
 - Connect portable media player
 - Connect USB device
 - Connect iPod

Place the unit

- For optimum performance, place this unit on a table.
- Never place this unit in an enclosed cabinet.
- Install this unit near the AC outlet where the AC power plug can be easily reached.

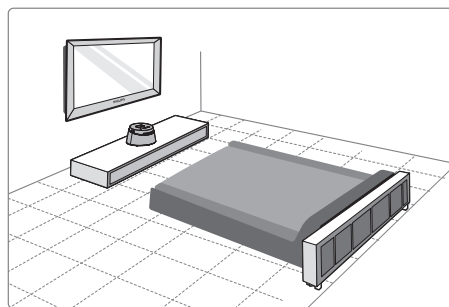

- 1 Place this Compact Theatre System near to the TV.



Note

- Refer to the type plate at the rear or bottom of the product for identification and supply ratings.
- Before you make or change any connections, ensure that all the devices are disconnected from the power outlet.



Note

- To avoid magnetic interference or unwanted noise, never place this unit too close to any radiation devices.

Connect video cables

This section describes how to connect this Compact Theatre System to your TV so to enable viewing of disc play.

Select the best video connection that your TV can support.

- **Option 1:** Connect to the HDMI socket (for a HDMI, DVI or HDCP-compliant TV).
- **Option 2:** Connect to the Video (CVBS) socket (for a standard TV).



Note

- You must connect this unit directly to a TV.

Before you connect

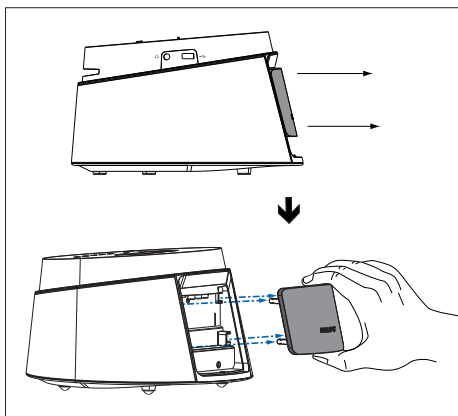

- 1 Remove the rear cover from this unit.
- 2 Connect the cables to the corresponding sockets.
- 3 Attach the rear cover.

Option 1: Connect to the HDMI socket

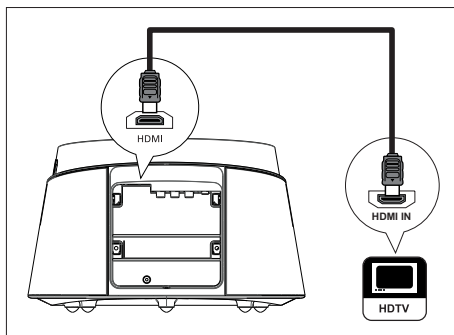

- 1 Connect an HDMI cable (supplied) from the **HDMI** socket on this unit to the HDMI IN socket on your TV.



Note

- The HDMI connector is only compatible with HDMI compliant TVs and DVI-TVs.



Tips

- To optimise the video output, see chapter 'Adjust settings' > [**Video Setup**] > [**HDMI Setup**] for details.
- Use a HDMI/DVI adaptor in case your TV has only a DVI connection. An extra audio connection is needed to complete this connection.
- To route the audio from your TV to this Compact Theatre System, connect an audio cable from the audio input on this unit to the audio output on your TV.
- This type of connections provides best picture quality.

Option 2: Connect to the Video (CVBS) socket

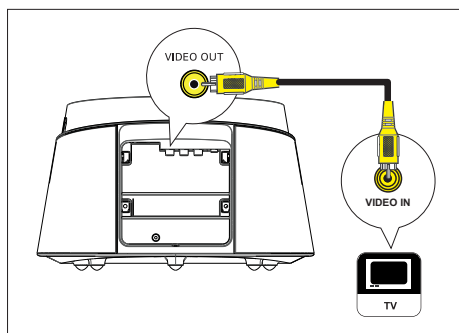

- 1 Connect a composite video cable (supplied) from the **VIDEO OUT** socket on this unit to the video input socket on your TV.



Tips

- The video input socket on your TV may be labelled as A/V IN, VIDEO IN, COMPOSITE or BASEBAND.
- This type of connections provide standard picture quality.

Connect to the power outlet

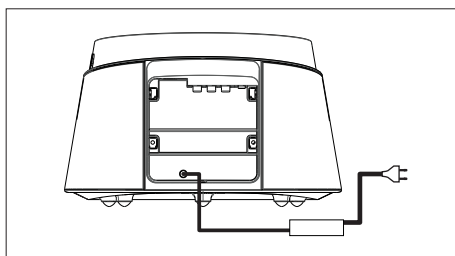

- 1 Connect the power adaptor and power cord from this unit to the power outlet.

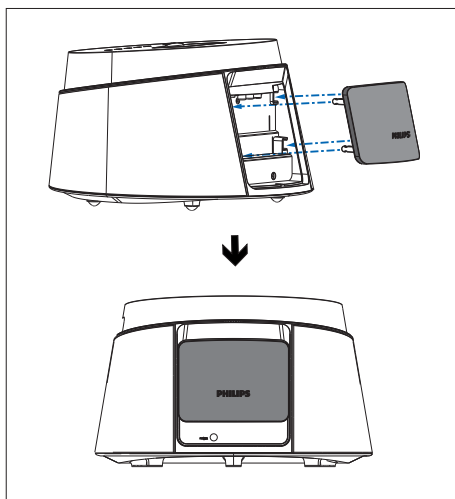

- 2 When all the required connections are complete, attach the rear cover and you are ready to enjoy this Compact Theatre System.

Connect audio cables/other devices

This section describes how you can route the sound from other devices to this Compact Theatre System in order to enjoy sound output or audio play with surround capabilities.

Connect audio from TV

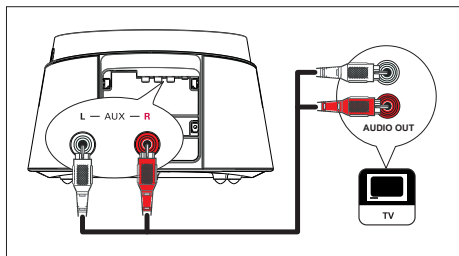

- 1 Connect an audio cable (not supplied) from the **AUX L/R** sockets on this unit to the **AUDIO OUT** sockets on your TV.

Note

- To listen to the audio output from this connection, press **AUX / MP3 LINK** repeatedly until 'AUX' is displayed on the display panel.

Connect audio from cable box/ recorder/game console

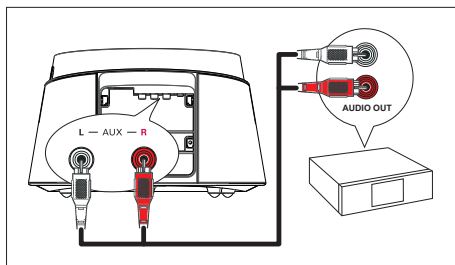

- 1 Connect an audio cable (not supplied) from the **AUX L/R** sockets on this unit to the **AUDIO OUT** sockets on the device.

Note

- To listen to the audio output from this connection, press **AUX / MP3 LINK** repeatedly until 'AUX' is displayed on the display panel.

Connect portable media player

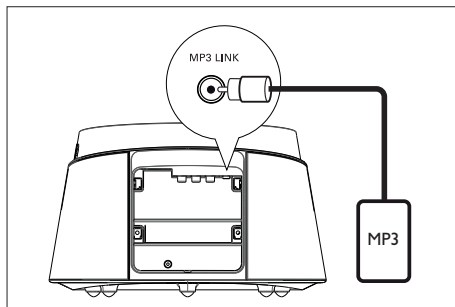

- 1 Connect a 3.5mm stereo audio cable (supplied) from the **MP3 LINK** socket on this unit to the phone socket on your portable media player (such as MP3 player).

**Note**

- To listen to the audio output from this connection, press **AUX / MP3 LINK** repeatedly until 'MP3' is displayed on the display panel.

Connect USB device

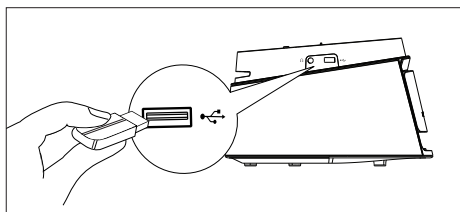

- 1 Connect the USB device to  (USB) socket on this unit.

**Note**

- This Compact Theatre System can only play/view MP3, WMA, WMV, DivX (Ultra) or JPEG files that are stored on the USB device.
- To listen to the audio output from this connection, press **USB**.

iPod Dock

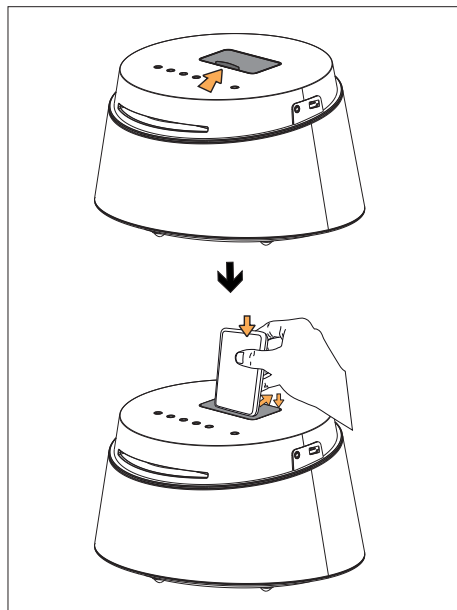

- 1 Slide open the lid of the docking station.
- 2 Dock the iPod.
 - Push back the rear support to dock into position.
- 3 To view videos from iPod, switch to the corresponding channel on your TV.

**Note**

- To listen to the audio output from this connection, press **DOCK**.

4 Get started

Prepare the remote control

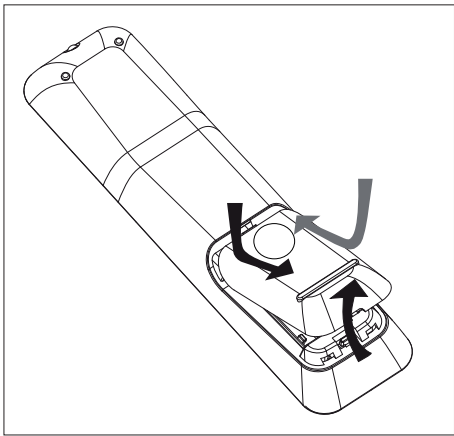

- 1 Push to open the battery compartment cover.
- 2 Insert two batteries type R03 or AAA. Match the indications (+ -) inside the battery compartment.
- 3 Close the cover.

Note

- If you are not going to use the remote control for a long time, remove the batteries.

Control a play source

- 1 Select the source you wish to control by pressing the **MP3**, **DISC**, **DOCK**, **USB**, **AUX** button.
- 2 Then select the desired function (for example **◀**, **▶**).

Navigate through the menu

- 1 Point the remote control directly at the remote sensor on this unit and select the desired function.

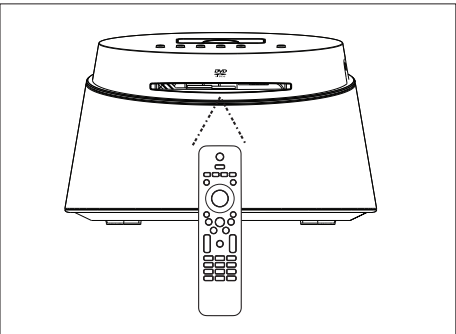

- 2 Use the following buttons on the remote control to navigate through the on-screen menus.

Button	Action
	Move up or down.
	Move left or right.
	Confirm a selection.
	Enter numbers.

Find the correct viewing channel

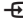
- 1 Press  to turn on the Compact Theatre System.
- 2 Press **DISC** to switch to disc mode.
- 3 Turn on the TV and switch it to the correct video-in channel.
 - You may go to the lowest channel on your TV, then press the Channel Down button on your TV's remote control until you see the Video In channel.
 - You may press  button repeatedly on your TV's remote control.
 - Usually this channel is between the lowest and highest channels and may be called FRONT, A/V IN, VIDEO, etc..





Tips

- See TV's user manual on how to select the correct input on your TV.

Select menu display language

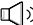
- 1 Press **DISC**.
- 2 Press **OPTIONS**.
↳ [**General Setup**] menu is displayed.
- 3 Press **►**.
- 4 Press **▲▼** to select [**OSD Language**] in the menu, then press **►**.

General Setup		
	Disc Lock	Auto
	OSD Language	English
	Screen Saver	Port.do Brasil
	Sleep Timer	Espanol
	DivX(R) VOD Code	
		

- The language options are different depending on your country or region. It may not correspond to the illustration shown here.

- 5 Press **▲▼** to select a language, then press **OK**.



Tips

- To set the default language for DVD audio and disc menu, see chapter 'Adjust settings' - [**Preference Setup**] for details.

Select a play source

On the main unit

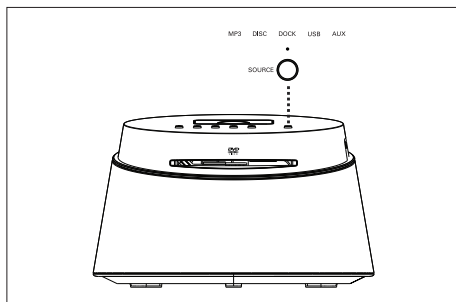

- 1 Press **SOURCE** button repeatedly to select: **DISC** > **DOCK** > **USB** > **AUX** > **MP3** > **DISC** ...

On the remote control

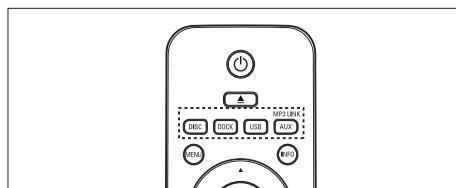

- Press **DISC** to switch to DISC mode.
- Press **DOCK** to switch to iPod mode.
- Press **USB** to switch to USB mode.
- Press **AUX / MP3 LINK** repeatedly to listen to the audio output from the external device.

5 Play

Play from disc

Playable discs

	DVD Video <ul style="list-style-type: none">• Region 2 (Europe)• Region 5 (Russia)
	DVD±RW (DVD Rewritable)
	DVD±R (DVD Recordable)
	DVD+R DL (DVD+R Double Layer)
	CD-RW (CD-Rewritable)
	CD-R (CD-Recordable)
	Audio CD (Compact Disc Digital Audio)
	Video CD <ul style="list-style-type: none">• Formats 1.0, 1.1, 2.0
	Super Video CD

Note

- DVDs and DVD players are designed with regional restrictions. Ensure that the DVD video you play is for the same region zone as your player (indicated on its rear).
- This unit can support playback of the following file formats: MP3/WMA/WMV/ JPEG/DivX.

Play a disc

! Caution!

- Never place any objects other than discs into the disc compartment.
- Never touch the disc optical lens inside the disc compartment.

- 1 Insert a disc with its label facing up.
 - For double-sided disc, load the side to play faces out.
 - To view disc play, turn on the TV to the correct viewing channel for this Compact Theatre System.
- 2 To stop disc play, press ■.

* Tips

- If the password entry menu is displayed, you have to enter the 4-digit password before it can be played.
- Screen saver displays automatically if the disc play is stopped for about 15 minutes. To deactivate the screen saver, press **DISC**.
- This unit automatically switches to standby mode if you do not press any buttons within 30 minutes after a disc has stopped playing.

Play video



Note

- For video disc, playback always resumes from the point where it was last stopped. To start playback from the beginning, press **◀** while the message is displayed.

Control a title

- 1 Play a title.
- 2 Use the remote control to control the title.

Button	Action
	Pause/ resume play.
	Stop play.
	Jump to the next title/chapter.
	Return to the beginning of the current title/chapter or jump to the previous title/chapter.
	Search backward/ forward. <ul style="list-style-type: none">• To change search speed, press this button repeatedly.
	Slow motion reverse/ forward play. <ul style="list-style-type: none">• To change play speed, press this button repeatedly.• For VCD, only forward play is possible.

Change video play

- 1 Play a title.
- 2 Use the remote control to change the video play.

Button	Action
	Change audio language. <ul style="list-style-type: none">• Only applicable to discs with multiple audio language or channel.
	Change subtitle language. <ul style="list-style-type: none">• Only applicable to discs with multiple subtitle language.
	Toggle through various repeat/ shuffle play mode; or turn off repeat mode. <ul style="list-style-type: none">• Repeat options vary depending on the disc type.• For VCDs, repeat play is only possible if the PBC mode is turned off.
	Zoom in/out. <ul style="list-style-type: none">• To pan through the zoomed image, press the cursor buttons.
	Display current play status. <ul style="list-style-type: none">• You can change the video play options here without interrupting disc play.

Access DVD menu

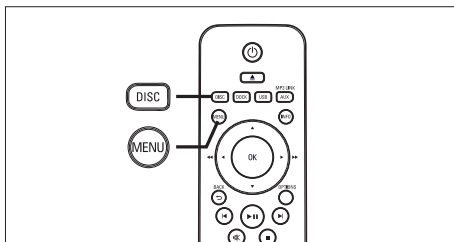

- 1 Press **DISC** to access disc main menu.
- 2 Select a play option, then press **OK**.
 - In some menus, press **number buttons** to input your selection.
 - To return to the title menu during playback, press **MENU**.

Access VCD menu or preview menu

The PBC (Playback Control) for VCD is turned on by default in the factory. When you load in a VCD, the contents menu is displayed.

- 1 Press **▲▼** to select a play option, then press **OK** to start play.
 - If PBC is off, it skips the menu and starts play from the first title.
 - During playback, you can press **MENU** to return to the menu (if the PBC mode is on).
- 2 To preview the contents of the disc, press **DISC**.
 - To exit the menu, press **DISC**.

Select Digest Type:

Track Digest
Disc Interval
Track Interval

[Track Digest]

It plays the first few seconds of each track in a disc.

[Disc Interval]

It divides the total disc time by six and plays the first few seconds of these intervals.

[Track Interval]

It divides the current track by six and plays the first few seconds of these intervals.

- This option is not available in stop mode.

- 3 Select a preview play option, then press **OK**.



Tips

- The default setting for PBC is on. To change the default setting, see chapter 'Adjust settings' - [**Preference Setup**] > [**PBC**] for details.

Quick skip play to a specific time

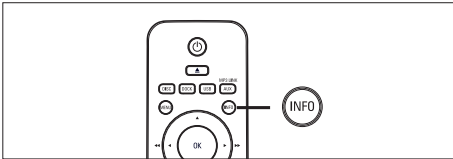

- 1 During playback, press **INFO**.
↳ The disc status menu is displayed.
- 2 Select the current elapsed playing time in the menu, then press **OK**.
 - [**TT Time**] (title time)
 - [**CH Time**] (chapter time)
 - [**Disc Time**] (disc time)
 - [**Track Time**] (track time)
- 3 Press the **number buttons** to change the time where you want to skip to, then press **OK**.

Play DivX® video

DivX video is a digital media format that retains high quality despite a high rate of compression. This unit is DivX® Certified so that you can enjoy DivX video.

- 1 Insert a disc or USB that contains the DivX videos.
- 2 Press **DISC** or **USB**.
↳ A contents menu is displayed.
- 3 Select a title to play, then press **▶||**.
- 4 Use the remote control to control the title.

Button	Action
	Change audio language/track.
	Change subtitle language.
	Stop play. <ul style="list-style-type: none">• For DivX Ultra video, press this button again to display the contents menu.
	Display DivX Ultra video information.

Note

- Only those DivX videos that were rented or purchased using the DivX registration code of this unit can be played (see chapter 'Adjust settings' > [**General Setup**] > [**DivX(R) VOD Code**] for details).
- If the subtitle does not appear correctly, change the subtitle language (see chapter 'Adjust settings' - [**Preference Setup**] > [**DivX Subtitle**] for details).
- The subtitle can only be displayed up to an average of 45 characters.
- This unit can play DivX video files that are up to 4GB in size.

Play music



Note

- For some commercial audio discs, playback may resume from the point where it was last stopped. To start play from first track, press **◀**.

Control a track

- 1 Play a track.
- 2 Use the remote control to control the track.

Button	Action
	Pause/ resume play.
	Stop play.
	Jump to the next track.
	Return to the beginning of the current track or jump to the previous track.
	Direct input the track number.
	Search backward/ forward. <ul style="list-style-type: none"> To change search speed, press this button repeatedly.
	Toggle through various repeat/shuffle play mode; or turn off repeat mode. <ul style="list-style-type: none"> Repeat options vary depending on the disc type.

Play MP3/WMA music

MP3/WMA is a type of highly compressed audio file (files with .mp3 or .wma extensions).

- 1 Insert a disc or USB that contains the MP3/WMA music.
- 2 Press **DISC** or **USB**.
 - ↳ A contents menu is displayed.
- 3 Select a folder, then press **OK**.
- 4 Select a track to play, then press **▶▶**.
 - To return to the main menu, press **▲** until 'Previous' folder is selected, then press **OK**.



Note

- For CDs recorded in multiple sessions, only the first session is played.
- This unit does not support MP3PRO audio format.
- If any special characters are present in the MP3 track name (ID3) or album name, it might not be displayed correctly on the screen because these characters are not supported.
- Some WMA is protected by Digital Rights Management (DRM), it cannot be played on this unit.
- Folders/files exceed the supported limit of this unit will not be displayed or played.



Tips

- To display the data disc contents without folders, see chapter 'Adjust settings' - **[Preference Setup]** > **[MP3/JPEG Nav]** for details.

Play photo

Play photos as slideshow

This unit can play JPEG photos (files with .jpeg or .jpg extensions).

- 1 Insert a disc or USB that contains the JPEG photos.
- 2 Press **DISC** or **USB**.
 - ↳ For a Kodak disc, the slideshow begins automatically.
 - ↳ For a JPEG disc, the photo menu is displayed.
- 3 Select the folder/album you want to play.
 - To preview the photos in the folder/album, press **INFO**.



- To go to previous or next screen display, press **◀** / **▶**.
 - To select a photo, press the cursor buttons.
 - To display the selected photo only, press **OK**.
- 4 Press **▶||** to start slideshow play.
 - To return to the menu, press **MENU**.

Note

- It may require longer time to display the disc content on the TV due to the large number of songs/photos compiled onto one disc.
- If the JPEG photo is not recorded with an 'exif' type file, the actual thumbnail picture will not be shown on the display. It will be replaced with a 'blue mountain' thumbnail picture.
- This unit can only display digital camera pictures according to the JPEG-EXIF format, typically used by almost all digital cameras. It cannot display Motion JPEG and pictures in formats other than JPEG, or sound clips associated with pictures.
- Folders/files exceed the supported limit of this unit will not be displayed or played.

Control photo play

- 1 Play photo slideshow.
- 2 Use the remote control to control the photo.

Button	Action
◀	Skip to the previous photo.
▶	Skip to the next photo.
▲	Rotate the photo clockwise.
▼	Rotate the photo counter-clockwise.
ZOOM	Zoom in/ out. <ul style="list-style-type: none">• Play will pause while in zoom mode.
■	Stop play.

Play musical slideshow

Play MP3/WMA music files and JPEG photo files simultaneously to create musical slideshow. The MP3/WMA and JPEG files must be stored on the same disc or USB device.

- 1 Play MP3/WMA music.
- 2 Navigate to the photo folder/album and press **▶||** to start slideshow play.
 - ↳ Slideshow begins and continues till the end of the photo folder or album.
 - ↳ Audio continues to play till the end of the disc.
 - To return to the menu, press **MENU**.
- 3 To stop slideshow play, press **■**.
- 4 To stop music play, press **■** again.

Play from USB device

This unit plays/views MP3, WMA, WMV, DivX (Ultra) or JPEG files on the following USB devices:

- digital camera that complies with the PTP standard
- flash drive
- memory card reader
- HDD (external power source needed)

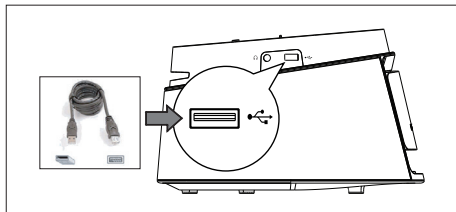

- 1 Connect a USB storage device to the **⚡ (USB)** socket.
- 2 Press **USB**.
 - ↳ A contents menu is displayed.
- 3 Select a file to play, then press **▶||**.
 - For more information, see chapters 'Play music, Play photo, Play video' for details.
- 4 To stop play, press **■** or remove the USB device.



Tips

- If the device does not fit into the USB socket, connect it through a USB extension cable.
- If a multiple USB card reader is used, only one of the connected USB drive contents can be accessed.
- If a USB HDD is used, ensure that an auxiliary power cord is connected to the USB HDD for proper operations.
- Digital cameras that use PTP protocol or require additional programme installation when connected to a PC are not supported.

Play from portable media

Simply connect your portable media player (e.g. MP3 player) to this unit to enjoy superb sound quality from your music collections.

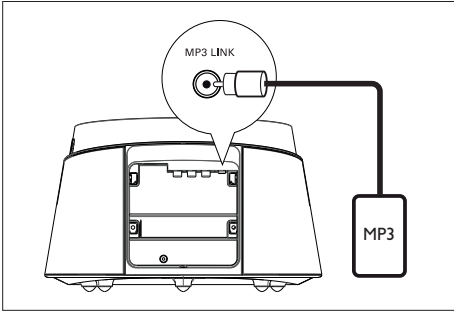

- 1 Connect a 3.5mm stereo audio cable (supplied) from the **MP3 LINK** socket on this unit to the 'headphone' socket on your portable media player.
- 2 Press **AUX / MP3 LINK** repeatedly until 'MP3' is displayed.
- 3 Start play on your portable media player.
 - See chapter 'Adjust Sound' to enhance the audio output.
- 4 To stop play, press **STOP** button on your portable media player.

Note

- Control playback is only possible on your portable media player.
- Stop play on the portable media player before you switch to other play media/source.

Play from iPod

Simply connect your iPod to the docking station to enjoy your iPod play through this Compact Theatre System.

List of supported iPod range:

iPod mini	iPod nano 1st gen
iPod touch	iPod nano 2nd gen
iPod classic	iPod nano 3rd gen
iPod mini 2nd gen	iPod 5th gen
iPod with colour display	

Note

- Refer to Philips website for latest updates on the supported iPod range.

Control iPod music

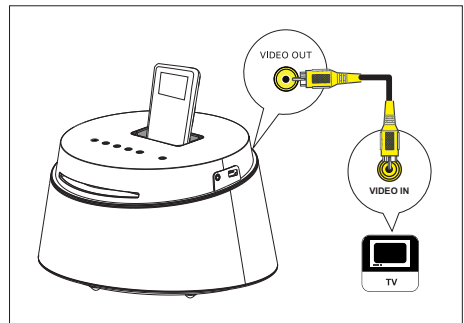

- 1 Push to open the lid of the docking station
- 2 Dock your iPod to the docking station and turn it on.
- 3 Press **DOCK**.
 - It may require longer time to authenticate the compatibility of certain iPod range.

- 4 Start play on your iPod.
 - To view iPod video play, connect a video cable from the docking station to your TV and turn on 'TV ON' setting in your iPod.
- 5 During playback, you can use the remote control to control the music play.





Tips

- While in iPod mode, the battery of your iPod will be charged.
- In extended play mode, control of iPod play is only possible through the contents displayed on your TV using this Compact Theatre's remote control.

Button	Action
	Change the volume level.
	Select a predefined sound effect.
	Go to the previous/ next track.
	Search backward/ forward.
	Pause/resume play.
	<p>Switch to 'Extended Control mode' to enable control of your iPod play through the contents displayed on TV.</p> <ul style="list-style-type: none"> • Control buttons on iPod have no function in this mode. • Press this button again to return to simple play mode.
	<p>Toggle through various repeat/shuffle play mode; or turn off repeat mode.</p> <ul style="list-style-type: none"> • This option is only available in 'Extended Control mode'.

6 Adjust sound

Control the volume

- 1 Press **VOL +** **—** to increase or decrease the volume level.
- To mute the volume, press .
 - To restore the volume, press  again or press the volume button.

Select a preset sound effect

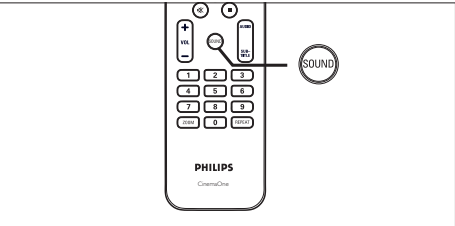





- 1 Press **SOUND** repeatedly to select a sound effect that most suits the video or music you play.

Video / Music	Descriptions
ACTION / ROCK	Enhanced low and high range for great sounding movie effects and atmosphere. Great for action movies and rock/pop music.
CONCERT / CLASSIC	Flat and pure sound mode. Ideal for listening to classical music and watching live concert DVDs.
GAMING / PARTY	Slightly enhanced low range and strong mid range ideal for party music and video gaming.
NEWS	Enhanced mid range for clear vocals/speech.



7 Adjust settings

This section describes the various setting options of this unit.

Symbol	Options
	[General Setup]
	[Audio Setup]
	[Video Setup]
	[Preference Setup]

General setup

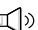
- 1 Press **OPTIONS**.
↳ [**General Setup**] menu is displayed.
- 2 Press **►**.
- 3 Select an option, then press **OK**.

General Setup	
	Disc Lock
	OSD Language
	Screen Saver
	Sleep Timer
	DivX(R) VOD Code
	

- See the explanations of the above options in the following pages.
- 4 Select a setting, then press **OK**.
 - To return to the previous menu, press **BACK**.
 - To exit the menu, press **OPTIONS**.

[Disc Lock]

Set play restriction for a specific discs. Before you start, place the disc in the disc compartment (maximum 40 discs can be locked).

- [**Lock**] – restrict access to the current disc. The next time you want to play this disc or unlock it, you need to enter the password.
- [**Unlock**] – all discs can be played.



Tips

- To set or change your password, go to [**Preference Setup**] > [**Password**].

[OSD Language]

Select the default on-screen menu language.

[Screen Saver]

Turn off or on the screen saver mode. It helps to protect the TV screen from being damaged due to over exposure to a static image for too long.

- [**On**] – set the screen saver to appear after 15 minutes of inactivity (for example, in pause or stop mode).
- [**Off**] – disable screen saver mode.

[Sleep Timer]

Switch to standby automatically after the preset time.

- [**Off**] – disable sleep mode.
- [**15, 30, 45, 60 mins**] – select the count down time before it switches to standby.

[DivX(R) VOD Code]

Display the DivX® registration code.







Tips

- Enter this unit's DivX registration code when you rent or purchase video from www.divx.com/vod. The DivX videos rented or purchased through the DivX® VOD (Video On Demand) service can be played only on the device to which it is registered.

Audio setup

- 1 Press **OPTIONS**.
↳ [**General Setup**] menu is displayed.
- 2 Press ▼ to select  [**Audio Setup**], then press ►.
- 3 Select an option, then press **OK**.

Audio Setup		
	HDMI Audio	
	Audio Sync	
	Night Mode	
	CD Upsampling	
		
		

- See the explanations of the above options in the following pages.
- 4 Select a setting, then press **OK**.
 - To return to the previous menu, press **BACK**.
 - To exit the menu, press **OPTIONS**.

[HDMI Audio]

When you connect this unit and TV with HDMI cable, select the audio output setting for this connection.

- [**On**] – the sound is output through both your TV and this speaker system. If the audio format on the disc is not supported, it will be downmixed to two-channel sound (linear-PCM).
- [**Off**] – disable audio output from your TV. The sound is only output through this speaker system.

[Audio Sync]

Set the default delay time for audio output when you play a video disc.

- 1. To start, press **OK**.
- 2. Press ◀▶ to set the delay time.
- 3. Press **OK** to confirm and exit.

[Night Mode]

Make loud sound level softer and soft sound level louder so that you can watch the DVD movies at a low volume, without disturbing others.





Note

- This setting is only applicable to Dolby Digital encoded DVD.
 - [**On**] – for quiet viewing at night (DVDs only).
 - [**Off**] – enjoy surround sound with a full dynamic range.
- ## [CD Upsampling]
- Convert the music CD to a higher sampling rate using sophisticated digital signal processing for better sound quality.
- [**Off**] – turn off CD-upsampling.
 - [**On**] – convert the sampling rate of the CDs twice as high as the original rate.

Video setup

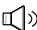
- 1 Press **OPTIONS**.
↳ [**General Setup**] menu is displayed.
- 2 Press ▼ to select  [**Video Setup**], then press ►.
- 3 Select an option, then press **OK**.

Video Setup	
	TV Type
	TV Display
	Picture Setting
	HDMI Setup
	Closed Caption
	

- See the explanations of the above options in the following pages.
- 4 Select a setting, then press **OK**.
 - To return to the previous menu, press **BACK**.
 - To exit the menu, press **OPTIONS**.

[TV Type]

If the video does not appear correctly, change the setting. By default, this setting matches the most common setting for TVs in your country.

- [**PAL**] – for PAL-system TV.
- [**NTSC**] – for NTSC-system TV.
- [**Multi**] – for TV that is compatible with both PAL and NTSC.

[TV Display]

Select the screen format according to how you want the picture to appear on your TV.

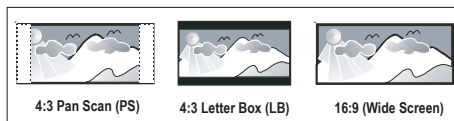

- [**4:3 Pan Scan**] – for standard TV, a full-height screen display with the sides trimmed.
- [**4:3 Letter Box**] – for standard TV, a 'wide-screen' display with black bars on the top and bottom.
- [**16:9 Wide Screen**] – for wide-screen TV (frame ratio 16:9).

[Picture Setting]

Select a predefined set of picture colour settings or customise your personal setting.

- [**Standard**] – original colour setting.
- [**Bright**] – vibrant colour setting.
- [**Soft**] – warm colour setting.
- [**Personal**] – customise the colour setting. Set the level of brightness, contrast, tint and colour saturation in the menu, then press **OK**.

[HDMI Setup]

When you connect this unit and TV with HDMI cable, select the best HDMI setup that your TV can support.

- **[Wide Screen Format]** – define the wide screen format for disc play.

Options	Descriptions
[Superwide]	Centre position of the screen is stretched less than the side. This setting is only applicable if the video resolution is set to 720p or 1080i/p.
[4:3 Pillar Box]	No stretching of the picture. Black bars are displayed on both sides of the screen.
[Off]	Picture will be displayed according to the format of the disc.



Note

- This setting is only available if you have set the **[TV Display]** setting to **[16:9 Wide Screen]**.

- **[HDMI Video]** – select a video resolution that is compatible with your TV display capability.

Options	Descriptions
[Auto]	It detects and selects the best supported video resolution automatically.
[480p, 576p, 720p, 1080i, 1080p]	Select a video resolution that best supported by your TV. See your TVs manual for details.



Note

- If the setting is not compatible with your TV, a blank screen appears. Wait for 15 seconds for auto recover or switch to its default mode as follows:
1) Press **▲**. 2) Press **◀**. 3) Press **ZOOM**.



[Closed Caption]

Turn on or off display captions.

- **[On]** – show the sound effects in subtitle. Only applicable to disc with Closed Caption information included and your TV supports this feature.
- **[Off]** – disable closed caption.

Preference Setup

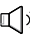
- 1 Press **OPTIONS**.
↳ [**General Setup**] menu is displayed.
- 2 Press ▼ to select  [**Preference Setup**], then press ►.
- 3 Select an option, then press **OK**.

Preference Setup	
	Audio
	Subtitle
	Disc Menu
	Parental
	PBC
	MP3/JPEG Nav
	Password
	DivX Subtitle ▼

- See the explanations of the above options in the following pages.
- 4 Select a setting, then press **OK**.
 - To return to the previous menu, press **BACK**.
 - To exit the menu, press **OPTIONS**.

[Audio]

Select the default audio language for DVDs.

[Subtitle]

Select the default subtitle language for DVDs.

[Disc Menu]

Select the menu language for DVDs.

Note

- If the language you have set is not available on the disc, the disc uses its own default language.
- For some DVDs, the subtitle/audio language can only be changed from the disc menu.
- To select the languages that are not listed in the menu, select [**Others**]. Then check the Language Code list at the back of this user manual and enter the respective 4-digit language code.

[Parental]

Restrict access to DVDs that are unsuitable for your children. These types of DVDs must be recorded with ratings.

1. To start, press **OK**.
2. Select a rating level in the menu, then press **OK**.
3. Press the **number buttons** to enter your 4-digit password.

Note

- Rated DVDs above the level you set in [**Parental**] require a password to be played.
- The ratings are country-dependent. To allow all discs to play, select '8'.
- Some DVDs have ratings printed on them but are not recorded with ratings. This function has no effect on such DVDs.

Tips

- To set or change your password, go to [**Preference Setup**] > [**Password**].

[PBC]

For VCDs/SVCDs recorded with PBC (playback control), you can access the disc content through an interactive menu.

- [**On**] – an index menu is displayed when you load a disc for play.
- [**Off**] – skip the menu and start play from the first title.

[MP3/JPEG Nav]

Turn off or on MP3/WMA folder display when you play a media that contains MP3/WMA files.

- [**With Menu**] – display the folders of MP3/WMA files.
- [**Without Menu**] – display all the files.

[Password]

Follow the instructions on the TV to set or change the password for locked discs and play restricted DVDs.

Change Password	
Old Password	<input type="text"/>
New Password	<input type="text"/>
Confirm PWD	<input type="text"/>
<input type="button" value="OK"/>	

1. Press the **number buttons** to enter '0000' or your last set 4-digit password at [**Old Password**] field.
2. Enter the new password at [**New Password**] field.
3. Enter the new password again at [**Confirm PWD**] field.
4. Press **OK** to exit the menu.



Note

- If you forget your 4-digit password, enter '0000' before you set a new password.

[DivX Subtitle]

Select a character set that supports the DivX subtitle.

[Standard]	English, Irish, Danish, Estonian, Finnish, French, German, Italian, Portuguese, Luxembourgish, Norwegian (Bokmål and Nynorsk), Spanish, Swedish, Turkish
[Central Europe]	Polish, Czech, Slovak, Albanian, Hungarian, Slovene, Croatian, Serbian (Latin script), Romanian
[Cyrillic]	Belarusian, Bulgarian, Ukrainian, Macedonian, Russian, Serbian
[Greek]	Greek
[Hebrew]	Hebrew



Note

- Ensure that the subtitle file has the exact same file name as the movie file. If for example the filename of the movie is 'Movie.avi', then you will need to name the text file 'Movie.sub' or 'Movie.srt'.

[Version info]

Display the software version of this unit.



Tips

- This information is required when you want to find out if a newest software version is available at the Philips website that you may download and install on this unit.

[Default]

Reset all the settings of this unit to factory default, except for [**Disc Lock**], [**Password**] and [**Parental**] settings.





8 Additional information

Update software

Philips provides software updates to ensure that this unit is compatible with the newest formats.

To check for updates, compare the current software version of this unit with the latest software version available at the Philips website.

- 1 Press **OPTIONS**.

Preference Setup	
	Disc Menu ▲
	Parental
	PBC
	MP3/JPEG Nav
	Password
	DivX Subtitle
	Version Info
	Default

- 2 Select [**Preference Setup**] > [**Version Info**], then press **OK**.
- 3 Write down the version number, then press **OPTIONS** to exit the menu.
- 4 Go to www.philips.com/support to check the latest software version available for this unit.
- 5 If the latest software version is higher than the software version of this unit, download it and store onto a CD-R or USB flash drive.

- 6 Insert the CD-R or USB flash drive to this Compact Theatre System.
- 7 Press **DISC** or **USB**, then follow the instruction on the TV to confirm update operation.

Note

- Do not remove the CD-R or USB when software updating is in progress.

- 8 Once software update is complete, this unit turns off to standby automatically.

Note

- We recommend that you disconnect the power cord for a few seconds and connect again to reboot the system.

Care

Caution!

- Never use solvents such as benzene, thinner, cleaners available commercially, or anti-static sprays intended for discs.

Clean discs

Wipe the disc with a micro fibre cleaning cloth from the centre to the edge in a straight line movement.

Clean main unit screen

Wipe the screen surface with a micro fibre cleaning cloth.

Specifications



Note

- Specification and design are subject to change without notice.

Accessories supplied

- Quick Start Guide
- Remote control and batteries
- Composite video cable (yellow)
- HDMI cable
- 3.5mm stereo audio cable (for MP3 LINK)
- Round-to-Flat pin adaptor
- Power adaptor
- Power cable
- Micro fibre cleaning cloth

Amplifier

- Total output power (Compact Theatre): 40W RMS (10% THD)
- Frequency response: 180 Hz~18 kHz / ± 3 dB
- Signal-to-noise ratio: > 60 dB (A-weighted)
- Input sensitivity
 - AUX: 500 mV
 - MP3 LINK: 500 mV

Disc

- Laser Type: Semiconductor
- Disc diameter: 12cm / 8cm
- Video decoding: MPEG1/ MPEG2 / DivX / DivX Ultra
- Video DAC: 12 bits, 108 MHz
- Signal system: PAL / NTSC
- Video S/N: 56 dB
- Audio DAC: 24 bits / 96 kHz
- Frequency response:
 - 4 Hz - 20 kHz (44.1 kHz)
 - 4 Hz - 22 kHz (48 kHz)
 - 4 Hz - 44 kHz (96 kHz)
- PCM: IEC 60958
- Dolby Digital, DTS: IEC60958, IEC61937

USB

- Compatibility: Hi-Speed USB (2.0)
- Class support: UMS (USB Mass Storage Class)

Main Unit

- Power supply: 100-240V; 50-60 Hz
- Power consumption: 22 W
- Standby power consumption: < 1 W
- System: Bass Reflex System
- Impedance: 8 ohm
- Speaker drivers: 165 mm (6 1/2") woofer
- Frequency response: 55 Hz - 150 Hz
- Dimensions (WxHxD): 273 x 172 x 273 (mm)
- Weight: 2.6 kg

9 Troubleshooting



Warning!

- Risk of electric shock. Never remove the casing of this unit.

To keep the warranty valid, never try to repair the system yourself.

If you encounter problems when using this unit, check the following points before requesting service. If the problem remains unsolved, register your product and get support at www.philips.com/welcome.

Main unit

The buttons on this unit do not work.

- Disconnect this unit from the power outlet for a few minutes, then connect again.

Picture

No picture.

- See TV's manual for correct video input channel selection. Change the TV channel until you see the DVD screen.
- Press **DISC**.
- If this happens when you change the TV type setting, you have to switch to its default mode:
 1. Press **▲**.
 2. Press **◀**.
 3. Press **SUBTITLE**.

No picture on HDMI connection.

- Check if the HDMI cable is faulty. Replace a new HDMI cable.
- If this happens when you change the HDMI video resolution, you have to switch to its default mode:
 1. Press **▲**.
 2. Press **◀**.
 3. Press **ZOOM**.

Sound

No sound.

- Ensure that the audio cables are connected and press the correct input source (for example, AUX/MP3 LINK, USB) to select the device you want to play.

No sound on HDMI connection.

- You may not hear any sound from the HDMI output if the connected device is non-HDCP compliant or only DVI-compatible.
- Ensure that the [**HDMI Audio**] setting is turned on.

No sound from TV programme.

- Connect an audio cable from the AUDIO input on this unit to the AUDIO output on your TV. Then press **AUX/MP3 LINK** repeatedly to select the corresponding audio input source.

Play

DivX video files cannot be played.

- Ensure that the DivX file is encoded according to the 'Home Theatre Profile' with the DivX encoder.
- Ensure that the DivX video file is complete.

The aspect ratio of the screen is not aligned with the TV display setting.

- The aspect ratio is fixed on the DVD.

DivX subtitle are not displayed correctly.

- Ensure that the subtitle file name is the same as the movie file name.
- Select the correct character set.
 1. Press **OPTIONS**.
 2. Press **►**, then select [**DivX Subtitle**] in the menu.
 3. Select the character set that supports the subtitle.

The contents of the USB flash drive cannot be read.

- The USB flash drive format is not compatible with this unit.
- Drive is formatted with different file system which is not supported by this unit (e.g. NTFS).
- Maximum size of memory supported is 160GB.

10 Glossary

Aspect ratio

Aspect ratio refers to the length to height ratio of TV screens. The ratio of a standard TV is 4:3, while the ratio of a high-definition or wide TV is 16:9. The letter box allows you to enjoy a picture with a wider perspective on a standard 4:3 screen.

DivX

The DivX code is a patent-pending, MPEG-4 based video compression technology, developed by DivX Networks, Inc., that can shrink digital video to sizes small enough to be transported over the internet, while maintaining high visual quality.

Dolby Digital

A surround sound system developed by Dolby Laboratories containing up to six channels of digital audio.

HDMI

High-Definition Multimedia Interface (HDMI) is a high-speed digital interface that can transmit uncompressed high definition video and digital multichannel audio. It delivers high quality picture and sound quality, completely free from noise. HDMI is fully backward-compatible with DVI.

As required by the HDMI standard, connecting to HDMI or DVI products without HDCP (High-bandwidth Digital Content Protection) will result in no Video or Audio output.

HDCP

High-bandwidth Digital Content Protection is a specification that provides a secure transmission of digital contents between different devices (to prevent unauthorised copyright).

JPEG

A very common digital still picture format. A still-picture data compression system proposed by the Joint Photographic Expert Group, which features small decrease in image quality in spite of its high compression ratio. Files are recognised by their file extension 'JPG or JPEG'.

MP3

A file format with a sound data compression system. 'MP3' is the abbreviation of Motion Picture Experts Group 1 (or MPEG-1) Audio Layer3. By using the MP3 format, one CD-R or CD-RW can contain about 10 times more data than a regular CD. Files are recognised by their file extension '.MP3'.

MPEG

Motion Picture Experts Group. A collection of compression systems for digital audio and video.

PBC

Playback Control. A system of navigating a Video CD/Super VCD through on-screen menus recorded onto the disc. You can enjoy interactive playback and searching.

PCM

Pulse Code Modulation. A digital audio encoding system.

WMA

Windows Media™ Audio. Refers to an audio compression technology developed by Microsoft Corporation. WMA data can be encoded by using Windows Media Player version 9 or Windows Media Player for Windows XP. Files are recognised by their file extension 'WMA'.

Language code

Abkhazian	6566	Inupiaq	7375	Pushto	8083
Afar	6565	Irish	7165	Russian	8285
Afrikaans	6570	Íslenska	7383	Quechua	8185
Amharic	6577	Italiano	7384	Raeto-Romance	8277
Arabic	6582	Ivrit	7269	Romanian	8279
Armenian	7289	Japanese	7465	Rundi	8278
Assamese	6583	Javanese	7486	Samoa	8377
Avestan	6569	Kalaallisut	7576	Sango	8371
Aymara	6589	Kannada	7578	Sanskrit	8365
Azerhajani	6590	Kashmiri	7583	Sardinian	8367
Bahasa Melayu	7783	Kazakh	7575	Serbian	8382
Bashkir	6665	Kernewek	7587	Shona	8378
Belarusian	6669	Khmer	7577	Shqip	8381
Bengali	6678	Kinyarwanda	8287	Sindhi	8368
Bihari	6672	Kirghiz	7589	Sinhalese	8373
Bislama	6673	Komi	7586	Slovensky	8373
Bokmål, Norwegian	7866	Korean	7579	Slovenian	8376
Bosanski	6683	Kuanyama; Kwanyama	7574	Somali	8379
Brezhoneg	6682	Kurdish	7585	Sotho; Southern	8384
Bulgarian	6671	Lao	7679	South Ndebele	7882
Burmese	7789	Latina	7665	Sundanese	8385
Castellano, Español	6983	Latvian	7686	Suomi	7073
Catalán	6765	Letzeburgesch;	7666	Swahili	8387
Chamorro	6772	Limbungan; Limburger	7673	Swati	8383
Chechen	6769	Lingala	7678	Svenska	8386
Chewa; Chichewa; Nyanja	7889	Lithuanian	7684	Tagalog	8476
中文	9072	Luxembourgish;	7666	Tahitian	8489
Chuang; Zhuang	9065	Macedonian	7775	Tajik	8471
Church Slav; Slavonic	6785	Malagasy	7771	Tamil	8465
Chuvash	6786	Magyar	7285	Tatar	8484
Corsican	6779	Malayalam	7776	Telugu	8469
Česky	6783	Maltese	7784	Thai	8472
Dansk	6865	Manx	7186	Tibetan	6679
Deutsch	6869	Maori	7773	Tigrinya	8473
Dzongkha	6890	Marathi	7782	Tonga (Tonga Islands)	8479
English	6978	Marshallese	7772	Tsonga	8483
Esperanto	6979	Moldavian	7779	Tswana	8478
Estonian	6984	Mongolian	7778	Türkçe	8482
Euskara	6985	Nauru	7865	Turkmen	8475
Ελληνικά	6976	Navaho; Navajo	7886	Twí	8487
Faroes	7079	Ndebele, North	7868	Uighur	8571
Français	7082	Ndebele, South	7882	Ukrainian	8575
Frysk	7089	Ndonga	7871	Urdu	8582
Fijian	7074	Nederlands	7876	Uzbek	8590
Gaelic; Scottish Gaelic	7168	Nepali	7869	Vietnamese	8673
Gallegan	7176	Norsk	7879	Volapuk	8679
Georgian	7565	Northern Sami	8369	Walloon	8765
Gikuyu; Kikuyu	7573	North Ndebele	7868	Welsh	6789
Guarani	7178	Norwegian Nynorsk;	7878	Wolof	8779
Gujarati	7185	Occitan; Provençal	7967	Xhosa	8872
Hausa	7265	Old Bulgarian; Old Slavonic	6785	Yiddish	8973
Herero	7290	Oriya	7982	Yoruba	8979
Hindi	7273	Oromo	7977	Zulu	9085
Hiri Motu	7279	Ossetian; Ossetic	7983		
Hrvatski	6779	Pali	8073		
Ido	7379	Panjabi	8065		
Interlingua (International)	7365	Persian	7065		
Interlingue	7365	Polski	8076		
Inuktitut	7385	Português	8084		

POLIZA DE GARANTIA

ESTA POLIZA ES GRATUITA

Este aparato ha sido cuidadosamente diseñado y se ha fabricado con los mejores materiales bajo un estricto control de calidad, garantizando su buen funcionamiento por los periodos establecidos según el aparato (ver lista en la parte inferior) **a partir de la entrega del aparato al consumidor.**

Esta póliza incluye la reparación o reposición gratuita de cualquier parte o componente que eventualmente fallase y la mano de obra necesaria para su reparación, así como los gastos de transportación razonablemente erogados dentro de nuestros centros de servicio, misma que se hará efectiva en cualquiera de nuestros centros de servicio autorizados en el país.

Si su aparato llegase a requerir de nuestro servicio de garantía, acuda al centro de servicio más cercano a su domicilio, de tener alguna duda por favor llame a nuestro **CENTRO DE INFORMACIÓN AL CLIENTE LADA** sin costo en toda la republica al **01 800 504 62 00** en donde con gusto le indicaremos el centro de servicio autorizado más cercano a su domicilio.

PHILIPS MEXICANA S.A. de C.V. a través de sus centros de servicio autorizados **reparará y devolverá a usted su aparato en un plazo no mayor a 20 días hábiles,** contados a partir de la fecha de ingreso, impresa en la orden de servicio de cualquiera de nuestros centros de servicio autorizados.

La garantía de esta póliza cubre cualquier desperfecto o daño eventualmente ocasionado por los trabajos de reparación y/o traslado del aparato en el interior de nuestros centros de servicio autorizados.

Esta póliza sólo tendrá validez, si está debidamente requisitada, sellada por la casa vendedora, en caso de extravío de esta póliza, podrá hacer efectiva su garantía con la presentación de su factura de compra.

ESTA POLIZA NO SE HARA EFECTIVA EN LOS SIGUIENTES CASOS:

- Cuando el aparato sea utilizado en condiciones distintas a las normales.
- Cuando el aparato no haya sido operado de acuerdo con el instructivo de uso que se le acompaña.
- Cuando la causa de la falla o mal funcionamiento sea consecuencia de una reparación inadecuada o alteración producida por personas no autorizadas por PHILIPS MEXICANA S.A. de C.V.

PERIODOS DE GARANTIA

36 MESES.- Monitores para computadora.

12 MESES.- Televisores con y sin reproductor de video digital DVD, videocassetteras, reproductores de discos de video digital DVD, reproductores de disco de video digital con pantalla incluida, grabadores reproductores de disco de video digital DVD, grabadores reproductores de disco compacto, Radiograbadoras con y sin reproductor de disco compacto, reproductores de disco compacto portátil, video proyectores (excepto la lámpara) , cámaras de video, decodificadores de señal (IRD), televisores para hotel, sistemas de observación, televisores de proyección, teléfonos celulares, pagers, minisistemas de audio, minisistemas de audio con reproductor de disco de video digital integrado, microsistemas de audio, sistemas de cine en casa, sistemas reproductores de disco de video digital, equipos modulares, sintoamplificadores, facsimils, LNB, antenas de recepción de satélite, DVD ROM, CDR ROM y CDRW ROM para computadora.

6 MESES.- reproductores de cassette portátil, radio relojes, radios A.M./F.M., reproductores de audio digital MP3 (Internet), auto estéreos, teléfonos, teléfonos inalámbricos, cámaras digitales.

3 MESES.- Accesorios, controles remotos, bocinas, cintas para fax y para cámaras de videoconferencia, micrófonos, audifonos.

PHILIPS

Philips Mexicana, S.A. de C.V.

Producto Importado por: Philips Mexicana, S.A. de C.V.

Av. La Palma No.6
Cot. San Fernando La Herradura
Huixquilucan, Edo. de México, C.P. 52784
Tel. 52 69 90 00

Centro de Información al Cliente Información General

LADA SIN COSTO PARA TODA LA REPUBLICA
01 800 504 62 00
CORREO ELECTRONICO
philips@merkafon.com

MODELO _____ No. DE SERIE _____
La presente garantía contará a partir de: DÍA _____ MES _____ AÑO _____

En caso que en su producto presente alguna falla, acuda al centro de servicio más cercano a su domicilio (según listado de talleres anexo) y en caso de tener alguna duda o pregunta por favor llame a nuestro Centro de información al Cliente, en donde con gusto le atenderemos en todo lo relativo a:

- * Servicio de sus aparatos Philips
- * Información de productos y Talleres Autorizados Philips
- * Asesoría en el manejo e instalación de su producto Philips
- * Información en donde puede adquirir productos y accesorios Philips

Para hacer efectiva la garantía de su producto, es necesario presentar esta póliza debidamente requisitada o de lo contrario, presentar su factura de compra.

CENTROS DE SERVICIO AUTORIZADOS PHILIPS EN LAS PRINCIPALES CIUDADES

NOTA: Los Centros que tengan (S) solo proporcionan Servicio y los que tengan (SR) venden refacciones, accesorios y proporcionan Servicio

CIUDAD	LADA	TELEFONO	CORREO ELECTRONICO		CIUDAD	LADA	TELEFONO	CORREO ELECTRONICO	
ACAPULCO, GRO	744	483-32-96	serproas@yahoo.com.mx	S	MEXICO, D. F. NORTE ZONA	55	55-67-19-92 55-67-22-56	chyr_electronica@yahoo.com.mx	S
AGUASCALIENTES, AGS	449	915-51-81	jimsaele@hotmail.com	S	MEXICO, D. F. ORIENTE ZONA	55	57-58-89-37	cnoguedam@terra.com.mx	S
CAMPECHE, CAMP.	981	816 25 75	oreza@hotmail.com	S	MEXICO, D. F. PONIENTE ZONA	55	58 12 44 12	raulnortz@avantel.net	S
CANCUN, Q. ROO.	998	984 18 74	gamma Cancun@webtelmex.net.mx	S	MONTERREY, N.L.	818	375-16-17 400-54-03	mossa@prodigy.net.mx	S
CD. JUAREZ, CHIH	656	618-21-28 623-46-20	teleservicio@prodigy.net.mx	S	MORELIA, MICH	443	312-93-17	multiservicios_profesionales_de_zamorara@msn.com	S
CD. OBREGON, SON	644	412-41-51 416-20-93	mena747@prodigy.net.mx	S	NEZAHUALCOYOTL, EDO. MEX	55	57-33-34-98	vicentequintero@prodigy.net.mx	S
CD. VICTORIA, TAMPIS	834	315-66-03 312-51-83	eeil_smiller@yahoo.com.mx	S	OAXACA, OAX	951	516-47-37	elfrancisco@prodigy.net.mx	S
COLIMA, COL	312	314-03-01	tv_antenas@hotmail.com	S	ORIZABA, VER	272	724 38 53	barreda_electronicas@hotmail.com	S
CUERNAVACA, MOR	777	313-00-49 313-90-92	centroserviciohertz@hotmail.com	S	PACHUCA, HGO	771	714-15-81	zarateel@hotmail.com	S
CULIACAN, SIN	667	716-15-10	stereovox@cdn.megared.net.mx	S	POZA RICA, VER	782	824 47 82	sonydigital@prodigy.net.mx	S
CHIHUAHUA, CHIH	614	421-59-30 421-63-61	comercialdomestica@hotmail.com	S	PUEBLA, PUE	222	246-77-64 231-63-77	rascon12@prodigy.net.mx	S
CHILPANCIINGO, GRO.	747	471 72 73	ingelec_gro@hotmail.com	S	QUERETARO, QRO	442	216-10-09		S
DURANGO, DGO	618	825-00-05	evsurdpo@yahoo.com	S	SALTILLO, COAH	844	415 35 80	electronicadigital_07@hotmail.com	S
GUADALAJARA, JAL	33	36-15-72-62 36-16-83-27	www.Leecon.com.mx	S	SAN LUIS POTOSI, S.L.P	444	815-34-07	centro_serviciosp@prodigy.net.mx	S
HERMOSILLO, SON	662	210-54-95 210-05-86	manuelw@prodigy.net.mx	S	SATELITE, EDO. MEX	55	55 62 59 73	missus_satellite@hotmail.com	S
IRAPUATO, GTO	462	626-51-10	tv_gase@hotmail.com	S	TAMPICO, TAMPIS	833	214 13 60	electromovie@prodigy.net.mx	S
LA PAZ, B.C.S	612	122-95-99	cenalfa@prodigy.net.mx	S	TEPIC, NAY	311	212-66-93	spe_tn@hotmail.co	S
LEON, GTO	477	770-26-99	tec ESPECIALIZADOS@hotmail.com	S	TIJUANA, B.C.N	664	621-22-15	www.eg1@telnor.net	S
MATAMOROS, TAMPIS	868	813-50-13	digitalelectronica@comunicable.net	S	TOLUCA, EDO. MEX	722	214-83-09		S
MAZATLAN, SIN	669	982-42-21	e_santel@hotmail.com	S	TOLUCA, EDO. MEX	722	213 62 94		S
MERIDA, YUC	999	928-59-05	evia2@prodigy.net.mx	S	TORREON, COAH	871	732-49-49	jomar02@prodigy.net.mx	S
MEXICALI, B.C.N	686	561-98-08 561-88-18	bajatelectronicas@aol.com	S	TUXTLA GUTIERREZ, CHIS	961	618-19-08	kvidec@prodigy.net.mx	S
MEXICO D.F. ZONA ARAZON	55	57 94 06 34	philipservicio@hotmail.com	S	URUAPAN, MICH	452	524-08-38 524-37-78	rosaliaq@nich1.telmex.net.mx	S
MEXICO D.F. ZONA CENTRO	55	55 21 60 07	unitelex@yahoo.com.mx	SR	VERACRUZ, VER	229	932-78-23 932-44-44	antza@ver.megared.net.mx	S
MEXICO, D. F. ZONA SUR	55	55-36-71-03 55-36-25-75	centrodeservicioelectronico@hotmail.com	S	VILLAHERMOSA, TAB	993	314-31-36 314-51-67	villatec@intrassur.net.mx	S
MEXICO, D. F. ZONA NORTE	55	53 69 30 21	tissaser@prodigy.net.mx	S	ZACATECAS, ZAC.	492	922 31 63	sertecmur@hotmail.com	S

Para mayor referencia de Talleres de Servicio Autorizados en otras ciudades comunicarse al 01 800 504 62 00 (lada sin costo)

Validez de la garantía

Todos los productos de la línea de audio y video Philips, se registrarán por un año de garantía internacional (365 días), salvo para Chile donde los productos de las líneas CD Portable y RCR CD, los cuales se rigen por 6 meses de garantía (182 días)

Condiciones de la garantía

Esta garantía perderá su validez si:

- El defecto es causado por uso incorrecto o en desacuerdo con el manual de instrucciones
- El aparato sea modificado, violado por una persona no autorizada por Philips
- El producto esté funcionando con un suministro de energía (red eléctrica, batería, etc.) de características diferentes a las recomendadas en el manual de instrucciones
- El número de serie que identifica el producto se encuentre de forma adulterada.

Están excluidos de garantía,

- Los defectos que se generen debido al incumplimiento del manual de instrucciones del producto
- Los casos fortuitos o de la fuerza mayor, como aquellos causados por agentes de la naturaleza y accidentes, descargas eléctricas, señales de transmisión débiles.
- Los defectos que se generen debido al uso de los productos en servicios no doméstico/residencial regulares o en desacuerdo con el uso recomendado
- Daños ocasionados por fluctuaciones de voltajes, voltaje fuera de norma o por causas fuera de Philips, como cortocircuitos en los bafles o parlantes.
- En las ciudades en donde no existe el taller autorizado del servicio de Philips, los costos del transporte del aparato y/o el técnico autorizado, corren por cuenta del cliente.
- La garantía no será válida si el producto necesita modificaciones o adaptaciones para que funcione en otro país que no es aquél para el cual fue mercadeado.

El único documento válido para hacer efectiva la garantía de los productos, es la Factura o Boleta de compra del consumidor final.

Aquellos productos que hayan sido adquiridos en otros países y que no estén en el rango normal del país donde se efectuará la reparación, dicha prestación de servicio tomará mas tiempo de lo normal ya que es necesario pedir las partes/piezas al centro de producción correspondiente.

Centros de información

Líneas de atención al consumidor

Chile: 600-7445477

Colombia: 01-800-700-7445

Costa Rica: 0800-506-7445

Ecuador: 1-800-10-1045

El Salvador: 800-6024

Guatemala: 1-800-299-0007

Panamá: 800-8300

Peru: 0800-00100

Rep. Dominicana: 1-800-751-2673

Venezuela: 0800-100-4888

LISTA DE SERVIÇO AUTORIZADO - BRASIL

ACRE	CRUZEIRO DO SUL	68-33224432	BARRA S FRANCISCO	27-37562245	BELO HORIZONTE	31-32252762	PORTO TROMBETAS	93-35491606
	RIO BRANCO	68-32217642	CASTELO	28-35420482	BELO HORIZONTE	31-32254066	SANTAREM	93-35235322
	RIO BRANCO	68-32217642	COLATINA	27-37222288	BELO HORIZONTE	31-34420944		
		68-32249116	GUARAPARI	27-33614355	BELO HORIZONTE	31-34181919		
ALAGOAS	ARAPIRACA	82-52223267	LINHARES	27-33710148	BELO HORIZONTE	31-32957700	PARAIBA	83-32121288
	MACEIO	82-32417237	S GABRIEL DA PALHA	27-37271153	BELO HORIZONTE	31-34491800	CAMPINA GRANDE	83-36423273
	PALMEIRA DOS INDIOS	82-4213452	SAO PATELUS	27-37633806	BELO HORIZONTE	31-21027373	GUARABIRA	83-2711159
	UNIAO DOS PALMARES	82-32811305	VILA VELHA	27-32891233	BETIM	31-35322088	JOAO PESSOA	83-24469689
			VITORIA	27-32233899	BOM DESPACHO	37-35212906	JOAO PESSOA	83-24460443
AMAPA	MACAPA	96-2175934	GOIAS		BOM DESPACHO	37-35222511	JOAO PESSOA	83-32210460
	SANTANA	96-2811800	ANAPOLIS	62-3243562	CARANINGOLA	32-37412017	NOVA FLORESTA	83-3741014
			CACU	64-6561811	CASIA	35-35412293	SAPE	83-2832479
			CALDAS NOVAS	64-6532878	CONGONHAS	31-37311638	SOLANEA	83-36312141
AMAZONAS	MANAUS	92-36333035	CATALAO	64-4412786	CONS LAFAIETE	31-37637784		
	MANAUS	92-36633366	FORMOSA	61-6318166	CONTAGEM	31-33912994	PARANA	
	MANAUS	92-32324252	GOIANIA	62-32919095	CONTAGEM	31-33953461	AMPERE	46-5471605
			GOIANIA	62-32292908	CORONEL FABRICIANO	31-38411804	ANTONINA	41-34321782
			GOIATUBA	64-34952272	CURVELO	38-37213009	APUCARANA	43-34225306
BAHIA	ALAGOINHAS	75-4211128	INHUMAS	63-5111840	DIVINOPOLIS	37-32212353	ARAPONGAS	42-2753723
	BARREIRAS	77-36117592	IPAMERI	42-4511184	FORMICA	37-33214177	ASSIS CHATEAUBRIAND	45-5285181
	BOM JESUS DA LAPA	77-4814335	ITAPUANGA	62-3551484	FRUTAL	42-45432529	BANDERANTES	43-5421711
	BRUMADOU	77-34412381	ITUMBIAIRA	64-34310837	GOV. VALADARES	32-32716650	CAMPO MOURAO	44-35238970
	CAETITE	77-34541183	JUSSARA	62-3731806	GUAXUIPE	35-35513891	CASCAMEL	45-32254005
	CAMACARI	71-36218288	LUZIANA	61-6422819	GUAXUIPE	35-35514124	CIANORTE	44-2929284
	CICERO DANTAS	75-32782767	MENEIROS	64-64618259	ITABIRA	31-38321628	CURITIBA	41-33344764
	CRUZ DAS ALMAS	75-6212839	PIRES DO RIO	64-4611133	ITAJUBA	35-36211315	CURITIBA	41-32543491
	ESPLANADA	75-4271454	RIALMA	62-3971320	ITAPECERICA	37-32411326	FOZ DO IGUAU	45-35233029
	EUNAPOLIS	73-2815181	RIO VERDE	64-36210173	ITAPECERICA	37-33411326	FOZ DO IGUAU	45-35234115
	FEIRA DE SANTANA	75-32233882	TRINDADE	62-5051505	ITALUNA	37-32414268	FRANCISCO BELTRAO	46-35233230
	GANDU	73-2511427	URUCU	62-3571285	ITUATUBA	34-32682131	GUARAJUAVA	42-36235325
	ILHEUS	73-3254164	MARANHAO		JOAO MONLEVADE	31-38512909	IBAITI	43-5461142
	IRECE	73-3215995	ACAILANDIA	99-35381889	JOAO PINHEIRO	38-35611327	IBIPORA	42-5281863
	ITABERABA	73-3617777	BACABAL	99-36212794	JUIZ DE FORA	32-30842584	IRATI	42-34221337
	ITAPETINGA	77-2613003	BALSAS	99-5410113	JUIZ DE FORA	32-32155154	LAPA	41-36222410
	JACOBINA	74-36211323	CAROLINA	98-7311335	LAGOA DA PRATA	32-32155154	LOANDIA	44-4252053
	JEQUIE	73-35254141	CAXIAS	98-4711364	LAVRAS	35-38319188	LODINDRIA	43-33241002
	JUAZEIRO	74-36116456	CHAPADINHA	99-36611277	MANHUAU	35-5712419	MANGABEIRA	44-32344620
CEARA	LAURO DE FREITAS	71-3784021	CODO	99-36612942	MONTE CARMELO	34-38422082	MEDIANEIRA	45-32642580
	MURITIBA	75-4241908	CODO	99-36612942	MONTE SANTO DE MINAS	35-35911888	PALEIRA	42-2523006
	PAULO AFONSO	75-32811439	CODOLHO NETO	98-34731351	MONTES CLAROS	38-32218925	PARANAGUA	41-34225804
	POCOES	77-4311890	IMPERATRIZ	99-35244969	MURIAE	32-37224334	PATO BRANCO	46-32242786
	RIBEIRA DO POMBAL	75-2761853	PEDREIRAS	99-36431515	MUZAMBINO	35-5712419	PONTA GROSSA	42-32226590
	SALVADOR	71-32473659	PRESIDENTE DUTRA	98-4711364	NANJUAU	32-36212165	RIO NEGRO	47-36450351
	SALVADOR	71-2675000	SANTA INES	98-36537553	NOVA LIMA	31-35412026	ROLANDIA	43-2561947
	SALVADOR	71-33072070	SAO JOSE DE RIBAMAR	98-2241581	OLIVEIRA	37-33314444	S J DO PNHAIAS	41-32822522
	SALVADOR	71-33556233	SAO LUIS	98-32323236	PARA DE MINAS	37-32316369	S MIGUEL DO IGUAU	45-5651429
	SANTO AMARO	74-5413413	SAO LUIS	98-32323236	PARA DE MINAS	37-32321975	SANTA FE	44-2471147
	SENHOR DO BONFIM	75-32611794	MATO GROSSO		PARACATU	38-36711250	SAO JORGE D'OESTE	46-3341305
	SERRINHA	75-32611794	ALTA FLORESTA	66-35212460	PASSOS	35-35214342	STO ANTONIO PLATINA	43-35341809
	STO ANTONIO JESUS	75-36314470	ALTO ARAGUAIA	66-4011726	PATOS DE MINAS	34-38225588	TELEMACO BORBA	42-32726044
	TEIXEIRA DE FREITAS	73-3011660	BARRA DO GARGAS	66-4011726	PATROCINIO	34-38311531	TOLEDO	45-25222471
	VALENICA	75-4413730	CIUIABA	65-36230421	PITANGUI	37-32716232	UMUARAMA	44-36231233
	VITORIA DA CONQUISTA	77-34241183	LUCAS DO RIO VERDE	65-5491333	PUMHI	37-33714632		
CEARA	BREJO SANTO	88-5310133	PONTES E LACERDA	65-2662236	POCOS DE CALDAS	35-37121866	PERNAMBUCO	81-37261918
	CRATEUS	88-6910019	PRIMAVERA DO LESTE	66-4981682	POCOS DE CALDAS	35-37224448	BEL DO JARDIM	81-35211823
	CRATO	88-5212501	RONDONOPOLIS	66-4233888	PONTE NOVA	31-38717486	CABO STO AGOSTINHO	81-35211823
	FORTALEZA	85-32875506	SINOP	66-5314592	PULSO ALEGRE	35-34212120	CAMARAGIBE	81-34581246
	FORTALEZA	85-40088555	TANGARA DA SERRA	65-3261431	S SEBASTIAO PARAISO	35-35313094	CARUARU	81-37220235
	IBIAPINA	88-36531223	VARZEA GRANDE	65-6826502	SANTOS DUMONT	32-32516369	FLORESTA	81-8771274
	IGUATU	88-35810125	MATO GROSSO DO SUL		SAO JOAO DEL REI	32-33718306	GARANHUNS	87-37611090
	ITAPPOCA	88-6312030	AMAMBAI	67-4811543	STO ANTONIO MONTE	37-32811258	GARANHUNS	87-37610085
	JUAZEIRO DO NORTE	88-3512667	CAMPO GRANDE	67-33242804	TEOFILO OTONI	33-35225831	PAULISTA	81-34331142
	LIMODRO DO NORTE	88-4231938	CAMPO GRANDE	67-3831540	TIMOTEO	31-38482728	RECIFE	81-21622111
	OROS	88-5842127	CAMPO GRANDE	67-33213898	UBA	32-35323626	RECIFE	81-34656042
	SOBRAL	88-36110605	DOURADOS	67-4217117	UBERABA	34-33332520	RECIFE	81-34629090
	TIANGUA	88-36713336	INHIERPA	67-4421244	UBERLANDIA	34-32123636	SALGUEIRO	87-38716309
	UBAJARA	88-6341233	NAVIRA	67-4612486	UBERLANDIA	34-32360767	SERRA TALHADA	87-38311401
			NOVA ANDRADINA	67-4413851	VARGINHA	35-2227889		
			PONTA PORA	67-4314313	VARZEA DA PALMA	38-37311548	PIAU	
			RIO BRILHANTE	67-4527950	VAZANTE	34-38131420	CAMPO MAIOR	86-32521376
			TRES LAGOAS	67-5212007	VICOSA	31-38918000	FLORIANO	89-5221154
DISTRITO FEDERAL	BRASILIA	61-32269898	MINAS GERAIS		PARA		OEIRAS	89-4621066
	BRASILIA	61-33016666	ALFENAS	35-32927104	ABATETUBA	91-37521272	PARNABA	86-3222877
	GAMA	61-5564840	ALMENARA	37-7211234	BELEM	91-32690400	PICOS	89-4221444
			ANDRADAS	35-37312970	BELEM	91-32421090	PICOS	89-4351533
ESPÍRITO SANTO	ALCERES	28-35526349	ARAXA	34-36611132	CAPANEMA	91-34621100	TERESINA	86-32213535
	ARACRUZ	27-32541251	ARAXA	34-36611132	CASTANHAL	91-37215052	TERESINA	86-32230825
	BAIXO GANDU	27-37212142	ARCOIS	37-35313455	ITATUBA	93-5181545	TERESINA	86-32214618
			BAMBUI	37-34311473	ITATUBA	93-5181545		
RIO DE JANEIRO	BELFORD ROXO	21-27616060	BARBACENA	32-33310283	PARAGOMINAS	31-30107778		

LISTA DE SERVIÇO AUTORIZADO - BRASIL

CABO FRIO	22-26451819	SAO BORJA	55-34311859	ROTUCATU	14-38821081	SAO PAULO	11-32222311
CAMPOS GOYTACAZES	22-27221499	SAO FCO DE PAULA	54-2441466	ROTUCATU	14-38155044	SAO ROQUE	11-47842509
CANTAGALO	22-25555303	SAO GABRIEL	55-2325833	CAMPINAS	19-32361999	SAO VICENTE	13-34628031
DUQUE DE CAXIAS	21-27711508	SAO JOSE DO OURO	54-3521216	CAMPINAS	19-32544819	SOROCABA	15-32241170
ITAOCARA	22-38612740	SAO LUIZ GONZAGA	55-33521365	CAMPINAS	19-32336498	SOROCABA	15-32241170
ITAPERUNA	22-38220605	SAO MARCOS	54-2911462	CAMPINAS	19-37372500	STA BARBARA D OESTE	19-34631211
MACAE	22-27626235	SOBRADINHO	51-37421409	CAMPO LIMPO PAULISTA	11-40392000	TABOAO DA SERRA	11-47871480
MACAE	22-27591358	STA CRUZ DO SUL	51-37155454	CAMPOS DO JORDAO	12-36622142	TAQUARATINGA	16-32524039
MAGE	21-26330605	STA CRUZ DO SUL	51-37153048	CATANDUVA	17-35232524	TAUBATE	12-36219080
NITEROI	21-26201517	TAPEJARA	54-3442353	CERQUILHO	15-32842121	TUPIA	14-34629596
NOVA FRIBURGO	22-25227692	TAPERAA	54-3851160	CRUZEIRO	12-31433859	VINHEDO	19-38765310
NOVA IGUAÇU	21-26675663	TAQUARI	51-6531291	DIADENA	11-40430669	VOTUPORANGA	17-34215726
PETROPOLIS	24-22312737	TORRES	51-6641940	DRACENA	18-38212479		
RESSENDE	24-33530101	TRES DE MAIO	55-33532101	FERNANDOPOLIS	17-34423921	SERGEIPE	
RIO DE JANEIRO	21-25894622	TRES DE MAIO	55-33538727	FRANCA	16-37232889	ARACAJU	79-32119764
RIO DE JANEIRO	21-25892030	URUGUAIANA	55-34121791	FRANCO DA ROCHA	11-44492608	ARACAJU	79-32176080
RIO DE JANEIRO	21-25097136	VACARIA	54-2311396	GUARUJA	13-33582942	ESTANCIA	79-52223235
RIO DE JANEIRO	21-24315426	VENANCIO AIRES	51-37411443	GUARULHOS	11-64513576	ITAIBAUNA	79-43130231
RIO DE JANEIRO	21-31579290	VERA CRUZ	51-37181350	GUARULHOS	11-64431153	LAGARTO	79-43216256
RIO DE JANEIRO	21-33916353			IGARAPAVA	16-31724600		
RIO DE JANEIRO	21-22367814	RONDÔNIA		INDAIA TUBA	19-38753831	TOCANTINS	
RIO DE JANEIRO	21-31592187	ARQUELHES	69-33353491	ITAPETNINGA	15-322710936	ARAGUANA	63-4212857
RIO DE JANEIRO	21-38675252	CACAO	69-4431415	ITAPIRA	19-38633802	ARAGUANA	63-41118198
RIO DE JANEIRO	21-25714999	CEREJEIRAS	69-33422251	ITARARE	15-35327243	GUARAI	63-34641590
RIO DE JANEIRO	21-24451123	GUAJARA-MIRIM	69-35414430	ITU	11-40231088	GURUPI	63-35110338
RIO DE JANEIRO	21-27013214	JI- PARANA	69-34211891	ITUVERAVA	16-7293365	GURUPI	63-33214470
SAO GONCALO	21-27439467	PORTO VELHO	69-4421178	JABOTICABAL	16-32021580		
TERESOPOLIS	24-22555687	ROLIM DE MOURA	69-4421178	JALES	17-36324479		
TRES RIOS	24-22521388	VILHENA	69-33233231	JAU	14-36222117		
				JUNDIAI	11-45862182		
RIO GRANDE DO NORTE		RORAIMA		LEME	19-35713528		
CAICO	84-4171844	BOA VISTA	95-32249605	LIMEIRA	19-34413179		
MOSSORO	84-33147809	BOA VISTA	95-6233456	MARILIA	14-34547437		
NATAL	84-32231249			MATAO	16-33821046		
NATAL	84-32123345	SANTA CATARINA		MAUA	11-45145233		
PAU DOS FERROS	84-3512334	BLUMENHAUS	47-3227742	MOGI DAS CRUZES	11-47941814		
		CANOINHAS	47-6223615	MOGI-GUAÇU	19-38181711		
		CANOINHAS	47-6223615	MOGI-MIRIM	19-38624401		
RIO GRANDE DO SUL		CAPINZAL	49-35552266	OLIMPIA	17-2812184		
AGUDO	55-2651036	CHAFECO	49-33223304	OSASCO	11-36837343		
ALEGRETE	55-34221969	CHAFECO	49-33221144	OURINHOS	14-33225457		
BAGE	53-32411295	CONCORDIA	49-34423704	PIRACICABA	19-34340454		
BENTO GONCALVES	54-45226824	CRIVILHA	48-34373155	PIRASSUNINGA	19-35614091		
CANAGUA	51-36711486	CLUNHA-PORA	49-4460243	PORTO FERREIRA	19-35812441		
CAMPINAS DO SUL	54-3661300	CURITIBANOS	49-32410851	PRES PRUDENTE	18-2225168		
CANELA	54-32821551	DESCANSO	49-36230245	PRES EPITACIO	18-2814184		
CAPOA DA CANOA	51-6652638	FLORIANOPOLIS	48-32254149	PRES PRUDENTE	18-22117943		
CARAZINHO	54-3203292	INDAIAL	47-33332325	PROMISSAO	14-35411696		
CAXIAS DO SUL	54-32153107	IPORA DO OESTE	49-36341289	RIBEIRAO PRETO	16-36106989		
CAXIAS DO SUL	54-2268020	ITAIOPOIS	47-6222282	RIBEIRAO PRETO	16-36368156		
CERRO LARGO	55-33591973	ITAJAI	47-33444777	RIBEIRAO PRETO	16-36107553		
CORONEL BICACO	55-35571397	JARAGUA DO SUL	47-33722050	RIO CLARO	19-35348543		
ERECHIM	54-3211933	JOACABA	49-35220418	S BERNARDO CAMPO	11-41257000		
ESTANCIA VELHA	51-35612142	JOINVILLE	47-34331146	S BERNARDO CAMPO	11-43681788		
FARROUPILHA	54-32683603	LAGES	49-2232355	S CAETANO DO SUL	11-4214334		
FAXINAL DO SOTURNO	55-32631150	LAGES	49-32244114	S JOAO BOA VISTA	19-36232990		
FLORES DA CUNHA	54-2922625	LAGUNA	48-36461221	S JOSE CAMPOS	12-39239508		
FREDERICO WESTPHALEN	55-37441850	LAURO MULLER	48-443202	S JOSE DO RIO PARDO	19-36085760		
GETULIO VARGAS	54-3411888	MARAVILHA	46-640052	S JOSE RIO PRETO	17-32325680		
GIRUA	55-33611754	PINHALZINHO	497-661014	S JOSE RIO PRETO	17-2352381		
GRAVATAI	51-4882830	PORTO UNIAO	42-35232839	SALTO	11-40296563		
HORIZONTINA	55-35371680	RIO DO SUL	47-5211920	SANTO ANDRE	11-49905288		
IBIRAIARAS	54-3551359	SAO MIGUEL D OESTE	49-36220626	SANTOS	13-32272947		
IJUI	55-33327766	SEARA	49-4521034	SANTOS	13-32847339		
IMBE	51-36272704	SOMBRIJO	48-3313225	SAO CARLOS	16-33614913		
LAJEADO	51-37145155	TAIO	478-620576	SAO JOSE DO CAMPOS	12-39122728		
MARAU	54-33424571	TUBARAO	48-6224448	SAO JOSE RIO PRETO	17-2355241		
MONTENEGRO	51-6324187	TUBARAO	48-6261651	SAO PAULO	11-2964622		
NONOAI	54-3621126	TURVO	48-5250373	SAO PAULO	11-67036116		
NOVA PRATA	54-32421328	URUSSANGA	484-651137	SAO PAULO	11-69791184		
NOVO HAMBURGO	51-33823191	VIGERIA	49-35660378	SAO PAULO	11-38659897		
OSORIO	51-36435224	XANXERE	49-4333026	SAO PAULO	11-42356667		
PALMEIRA MISSOES	55-37421407			SAO PAULO	11-69545517		
PANAMBI	55-33753488	SÃO PAULO		SAO PAULO	11-36726766		
PASSO FUNDO	54-33111104	AGUAS DE LINDOIA	19-38241524	SAO PAULO	11-66940101		
PELOTAS	53-32223633	AMERICANA	19-34062914	SAO PAULO	11-32077111		
PORTO ALEGRE	51-32226941	ANAPOLIS	19-38072674	SAO PAULO	11-39757996		
PORTO ALEGRE	51-32256653	ARACATUBA	18-36218775	SAO PAULO	11-62976464		
PORTO ALEGRE	51-32268834	ARARAQUARA	16-33368710	SAO PAULO	11-56679695		
RIO GRANDE	53-32322311	ATIBAIA	11-44118145	SAO PAULO	11-38751333		
SANTA DO LIVRAMENTO	55-32411899	AVARE	14-37322142	SAO PAULO	11-55321515		
SANTA MARIA	55-32222335	BARRETOS	17-33222742	SAO PAULO	11-62809411		
SANTA ROSA	55-35121991	BATAIAS	16-37614455	SAO PAULO	11-32217317		
SANTA VITORIA DA PALMAR	53-32633992	BAURU	14-32239551	SAO PAULO	11-37714709		
SANTO ANGELO	55-33131183	BIRIGUI	18-36424011	SAO PAULO	11-25770899		
SANTO AUGUSTO	55-37811511						

CERTIFICADO DE GARANTIA NO BRASIL

Este aparelho é garantido pela Philips da Amazônia Indústria Eletrônica Ltda., por um período superior ao estabelecido por lei. Porém, para que a garantia tenha validade, é imprescindível que, além deste certificado, seja apresentada a nota fiscal de compra do produto.

A Philips da Amazônia Indústria Eletrônica Ltda. assegura ao proprietário consumidor deste aparelho as seguintes garantias, a partir da data de entrega do produto, conforme expresso na nota fiscal de compra, que passa a fazer parte deste certificado:

**Garantia para rádios e reprodutores de CD portáteis
(sem caixa acústica destacável): 180 dias**

Garantia para os demais produtos da marca Philips: 365 dias.

Esta garantia perderá sua validade se:

- O defeito apresentado for ocasionado por uso indevido ou em desacordo com o seu manual de instruções.
- O produto for alterado, violado ou consertado por pessoa não autorizada pela Philips.
- O produto for ligado a fonte de energia (rede elétrica, pilhas, bateria, etc.) de características diferentes das recomendadas no manual de instruções e/ou no produto.
- O número de série que identifica o produto estiver de alguma forma adulterado ou rasurado.

Estão excluídos desta garantia defeitos decorrentes do descumprimento do manual de instruções do produto, de casos fortuitos ou de força maior; bem como aqueles causados por agentes da natureza e acidentes. Excluem-se igualmente desta garantia defeitos decorrentes do uso dos produtos em serviços não doméstico/residencial regular ou em desacordo com o uso recomendado. **ESTÃO EXCLUÍDAS DA GARANTIA ADICIONAL AS PILHAS OU BATERIAS FORNECIDAS JUNTO COM O CONTROLE REMOTO.**

Nos municípios onde não exista oficina autorizada de serviço Philips, as despesas de transporte do aparelho e/ou do técnico autorizado, correm por conta do Sr. Consumidor requerente do serviço.

A garantia não será válida se o produto necessitar de modificações ou adaptações para habilitá-lo a operar em qualquer outro país que não aquele para o qual foi designado, fabricado, aprovado e/ou autorizado, ou ter sofrido qualquer dano decorrente deste tipo de modificação.

Philips da Amazônia Indústria Eletrônica Ltda.

Dentro do Brasil, para informações adicionais sobre o produto ou para eventual necessidade de utilização da rede de oficinas autorizadas, ligue para o Centro de Informações ao Consumidor (CIC). Em São Paulo - Capital e demais localidades com DDD 011 - tel. 2121-0203, nas demais localidades e estados - tel. 0800 701 02 03 (discagem direta gratuita), ou escreva para Caixa Postal: nº 21.315 - CEP04602-970 - São Paulo - SP, ou envie um e-mail para: cic@philips.com.br
Horário de atendimento: de segunda à sexta-feira, das 08:00 às 20:00 h; aos sábados das 08:00 às 13:00h.

Para atendimento fora do Brasil, contate a Philips local ou a:
Philips Consumer Service
Beukenlaan 2
5651 CD Eindhoven
The Netherlands

Certificado de Garantía en Argentina

Artefacto:

Modelo:

**Fabricante/Importador: Philips Argentina S.A.
y/o Fábrica Austral de Productos Eléctricos S.A.
Dirección: Vedia 3892 - Buenos Aires
Fecha de Venta:**

	Nro. de serie
--	----------------------

Firma y sello de la casa vendedora.

PHILIPS ARGENTINA S.A. en adelante denominada “la empresa”, garantiza al comprador de este artefacto por el término de (1) año a partir de la fecha de adquisición, el normal funcionamiento contra cualquier defecto de fabricación y/o vicio de material, y se compromete a reparar el mismo —sin cargo alguno para el adquirente— cuando el mismo fallare en situaciones normales de uso y bajo las condiciones que a continuación se detallan:

1. Este certificado de garantía es válido únicamente en la Republica Argentina. El certificado debe ser completado por la casa vendedora y ser presentado por el usuario conjuntamente con la factura original de compra.
2. Serán causas de anulación de esta garantía en los casos que corresponda:
 - 2.1. Uso impropio o distinto del uso doméstico.
 - 2.2. Exceso o caídas de tensión eléctrica que impliquen uso en condiciones anormales.
 - 2.3. Instalación y/o uso en condiciones distintas a las marcadas en el “Manual de instalación y uso” que se adjunta a esta garantía.
 - 2.4. Cualquier intervención al artefacto por terceros no autorizados por la empresa.
3. La garantía carecerá de validez si se observare lo siguiente:
 - 3.1. Enmiendas o raspaduras en los datos del certificado de garantía o factura.
 - 3.2. Falta de factura original de compra que detalle tipo de artefacto, modelo, número de serie y fecha que coincida con los del encabezamiento del presente certificado.
4. No están cubiertos por esta garantía los siguientes casos:
 - 4.1. Los daños ocasionados al exterior del gabinete.
 - 4.2. Las roturas, golpes, caídas o rayaduras causadas por traslados.
 - 4.3. Los daños o fallas ocasionados por deficiencias, sobretensiones, descargas o interrupciones del circuito de alimentación eléctrica o rayos, deficiencias en la instalación eléctrica del domicilio del usuario o conexión del artefacto a redes que no sean las especificadas en el Manual de Uso del mismo.
 - 4.4. Las fallas, daños, roturas o desgastes producidos por el maltrato o uso indebido del artefacto y/o causadas por inundaciones, incendios, terremotos, tormentas eléctricas, golpes o accidentes de cualquier naturaleza.
 - 4.5. Las fallas o daños ocasionados en desperfectos en la línea telefónica.
 - 4.6. Las fallas producidas por una mala recepción ocasionada en el uso de una antena deficiente o en señales de transmisión débiles.
5. Las condiciones de instalación y uso del artefacto se encuentran detalladas en el Manual de Uso del mismo.
6. La empresa no asume responsabilidad alguna por los daños personales o a la propiedad al usuario o a terceros que pudieran causar la mala instalación o uso indebido del artefacto, incluyendo en este último caso a la falta de mantenimiento.
7. En caso de falla, el usuario deberá requerir la reparación a la empresa a través del Service Oficial y/o Talleres Autorizados más próximos a su domicilio y cuyo listado se acompaña al presente. La empresa a segura al usuario la reparación y/o reposición de piezas para su correcto funcionamiento en un plazo no mayor a 30 días contados a partir de la fecha de solicitud de reparación, salvo caso fortuito o fuerza mayor.

8. Toda intervención del servicio técnico realizada a pedido del usuario dentro del plazo de garantía, que no fuera originada por falla o defecto alguno cubierto por este certificado, deberá ser abonado por el interesado de acuerdo a la tarifa vigente.
9. El presente certificado anula cualquier otra garantía implícita o explícita, por la cual y expresamente no autorizamos a ninguna otra persona, sociedad o asociación a asumir por nuestra cuenta ninguna responsabilidad con respecto a nuestros productos.
10. En caso de que durante el período de vigencia de esta garantía el artefacto deba ser trasladado a las Delegaciones Oficiales y/o Talleres Autorizados de Service para su reparación, el transporte será realizado por la empresa y serán a su cargo los gastos de flete y seguros y cualquier otro que deba realizarse para su ejecución.



PHILIPS

Red de Talleres Autorizados en Argentina

CAPITAL FEDERAL

ATTENDANCE S.A.

- Av. Monroe 3351 (C1430BKA) Cap. Fed.
- Tel.: 4545-5574/0704 ó 6775-1300
- Ventas de Repuestos y Accesorios
- Tel.: 4545-0854

DIG TRONIC

- Av. San Martín 1762 (C1416CRS) Cap. Fed.
- Tel.: 4583-1501

ELECTARG S.R.L.

- Av. Córdoba 1357 (C1055AAD) Cap. Fed.
- Ventas de Repuestos y Accesorios
- Tel.: 4811-1050

Caabillito Electarg J. M. Moreno 287 4903-6967/6854/8983

BUENOS AIRES

Azul	Herlein Raúl Horacio	Av. 25 de Mayo 1227	(02281) 428719
Bahía Blanca	Neutron	Soler 535	(0291) 4535329
Bragado	Yacovino Juan J.	San Martín 2141	(02342) 424147
Campana	Electricidad Krautor	Lavalle 415	(03489) 432919
Chivilcoy	Fama	Coronel Suárez 110	(02346) 424129
Junín	Junín Service	Alsina 537	(02362) 442754
La Plata	Da Tos e Hijos	Calle 68 N° 1532	(0221) 4516021
La Plata	Service Técnico La Plata	Av. 51 N° 1051 esq. 16	(0221) 4108155
Mar de Ajó	Tauro Electrónica	Catamarca 14	(02257) 421750
Mar del Plata	Central Service	Olazábal 2249	(0223) 4721639/4729367
Mar del Plata	Service Integral	Diag. Pueyrredón 3229	(0223) 4945633
Necochea	Electrónica Camejo	Calle 63 N° 1745	(02262) 426134
Pehuajó	Calcagni Carlos Alberto	Zubiría 794	(02396) 472665
Pergamino	ACV Sistemas	Dr. Alem 758	(02477) 421177
Pergamino	El Service	Juan B. Justo 1931	(02477) 418000

San Nicolás	Servitec	Bv. Alvarez 148	(03461) 454729/429578
San Pedro	Electrónica Menisale	Mitre 1695	(03329) 425523
Tandil	Lazzarini Oscar Rafael	Pellegrini 524	(02293) 442167
Trenque Lauquen	Labruno Electrónica	Av. San Martín 426	(02392) 423248
Tres Arroyos	Saini Fabián y Sergio	Av. Belgrano 562	(02983) 427369
Zárate	Electrónica Spinozzi	Ituzaingó 1030	(03487) 427353

GRAN BUENOS AIRES

Avellaneda	Casa Torres S.A.	Av. Mitre 2559	4255-5854
Florencio Varela	Casa Torres S.A.	San Martín 2574	4255-5854
Gregorio de Laferrere	Electrónica Alvarez	Honorio Luque 6084	4626-1322
Lomas de Zamora	Attendance S.A. Lomas	Laprida 485	4292-8900
Merlo	Argentónica S.H.	Pte. Cúmpora 2175	(0220) 4837177/4829934
Moreno	Argentónica S.H.	Bm. Mitre 2977 loc.2	(0237) 4639500
Morón	Servotronic	Ntra. Sra. del Buen Vajje 1222	4627-5656
Olivos	Appliance	Av. Libertador 2684	4794-7700
Quilmes	Casa Torres S.A.	E. Ríos esq. Gran Canaria	4255-5854
Ramos Mejía	Electarg S.R.L. Suc.	Belgrano 224	4656-0619
San Miguel	Servotronic San Miguel	Belgrano 999	4664-4131
Villa Ballester	Servotronic	J. Hernández 3101	4767-2515/4768-5249

CATAMARCA

Catamarca	Omicron Central de Serv.	San Martín 225	(03833) 427235
-----------	--------------------------	----------------	----------------

CHACO

Resistencia	Freschi Jorge Oscar	Av. Avalos 320	(03722) 426030
-------------	---------------------	----------------	----------------

CHUBUT

Comodoro Rivadavia	C.A.S. S.R.L.	Alem 145	(0297) 4442629
Trelew	Fagtron Electrónica	Brasil 253	(02965) 427073

CORDOBA

Córdoba Capital	Servelco S.R.L.	Pje. E. Marsilla 635	(0351) 4724008/4732024
Rio Cuarto	Maurutto Victor G.	Bv. Almafuerite 487	(0358) 4660204
Rio Cuarto	Capaldi Abel	Paunero 832	(0358) 4623003
Rio Tercero	Service Omega	Homero Manzi 149	(03571) 423330
San Francisco	Acuña Walter Electrónica	M. Moreno 360	(03564) 425367
Villa María	Grasso Electrónica	Bv. Alvear 541	(0353) 4521366
Villa María	Vanguard Sist. Electrónicos	México 421	(0353) 4532951

