



User manual



Register your product and get support at
www.philips.com/support

Contents

1 Important	2	7 Product specifications	18
Safety	2		
Care for your product	3		
Care of the environment	3	8 Troubleshooting	19
Help and support	3		
2 Your product	4		
Main unit	4		
Remote control	5		
Connectors	6		
Wireless subwoofer	6		
3 Connect	7		
Placement	7		
Pair up with the subwoofer	8		
Connect audio from TV	8		
Connect audio from other devices	10		
Connect digital devices through HDMI	11		
4 Use your product	11		
Set clock	11		
Auto standby	12		
Adjust the volume	12		
Dolby Atmos®	12		
Choose your sound	13		
Play audio through Bluetooth	14		
Connect Bluetooth via NFC	15		
MP3 player	15		
USB storage devices	15		
Set display brightness	16		
Apply factory settings	16		
5 Update software	17		
Check software version	17		
Update software via USB	17		
6 Wall mount	18		

1 Important

Read and understand all instructions before you use your product. If damage is caused by failure to follow instructions, the warranty does not apply.

Safety

Risk of electric shock or fire!

- Before you make or change any connections, make sure that all devices are disconnected from the power outlet.
- Never expose the product and accessories to rain or water. Never place liquid containers, such as vases, near the product. If liquids are spilt on or into the product, disconnect it from the power outlet immediately. Contact Consumer Care to have the product checked before use.
- Never place the product and accessories near naked flames or other heat sources, including direct sunlight.
- Never insert objects into the ventilation slots or other openings on the product.
- Where the mains plug or an appliance coupler is used as the disconnect device, the disconnect device shall remain readily operable.
- Batteries (battery pack or batteries installed) shall not be exposed to excessive heat such as sunshine, fire or the like.
- Disconnect the product from the power outlet before lightning storms.

- When you disconnect the power cord, always pull the plug, never the cable.
- Use the product in tropical and/or moderate climates.

Risk of short circuit or fire!

- For identification and supply ratings, see the type plate at the back or bottom of the product.
- Before you connect the product to the power outlet, ensure that the power voltage matches the value printed on the back or bottom of the product. Never connect the product to the power outlet if the voltage is different.

Risk of injury or damage to this product!

- For wall mounting, this product must be securely attached to the wall in accordance with the installation instructions. Use only the supplied wall mount bracket (if available). Improper wall mounting may result in accident, injury or damage. If you have any query, contact Consumer Care in your country.
- Never place the product or any objects on power cords or on other electrical equipment.
- If the product is transported in temperatures below 5°C, unpack the product and wait until its temperature matches room temperature before connecting it to the power outlet.
- Parts of this product can be made of glass. Handle with care to avoid injury and damage.

Risk of overheating!

- Never install this product in a confined space. Always leave a space of at least four inches around the product for ventilation. Ensure curtains or other objects never cover the ventilation slots on the product.

Risk of contamination!

- Do not mix batteries (old and new or carbon and alkaline, etc.).
- Danger of explosion if batteries are incorrectly replaced. Replace only with the same or equivalent type.
- Remove batteries if they are exhausted or if the remote control is not to be used for a long time.
- Batteries contain chemical substances, they should be disposed of properly.

Risk of swallowing batteries!

- The product/remote control may contain a coin/button type battery, which can be swallowed. Keep the battery out of reach of children at all times! If swallowed, the battery can cause serious injury or death. Severe internal burns can occur within two hours of ingestion.
- If you suspect that a battery has been swallowed or placed inside any part of the body, seek immediate medical attention.
- When you change the batteries, always keep all new and used batteries out of reach of children. Ensure that the battery compartment is completely secure after you replace the battery.
- If the battery compartment cannot be completely secured, discontinue use of the product. Keep out of reach of children and contact the manufacturer.



This is CLASS II apparatus with double insulation, and no protective earth provided.

~

AC voltage



Use only the power supplies listed in the user manual.

Care for your product

Use only microfiber cloth to clean the product.

Care of the environment

Disposal of your old product



Your product is designed and manufactured with high quality materials and components, which can be recycled and reused. Do not throw away the product with the normal household waste at the end of its life, but hand it in at an official collection point or recycling. By doing this, you help to preserve the environment.

Help and support

For extensive online support, visit www.philips.com/support to:

- download the user manual and the quick start guide
- watch video tutorials (available only for selected models)
- find answers to frequently answered questions (FAQs)
- email us a question

- chat with our support representative.

Follow the instructions on the website to select your language, and then enter your product model number.

Alternatively, you can contact Consumer Care in your country. Before you contact, note down the model number and serial number of your product. You can find this information on the back or bottom of your product.



2 Your product

Congratulations on your purchase, and welcome to Philips! To fully benefit from the support that Philips offers (e.g. notification of product software upgrade), register your product at www.philips.com/welcome.

Main unit

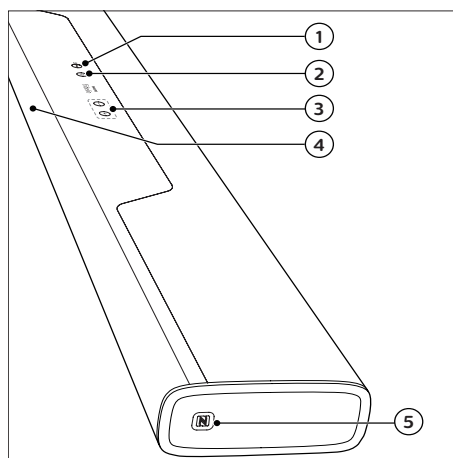
This section includes an overview of the main unit.



- ① 
 - Switch this product on or to standby.
 - When this product is in standby, the standby indicator turns red.
- ② 
 - Select an input source for this product.
- ③ **+/- (Volume)**
 - Increase or decrease volume.

④ Display panel

⑤ NFC tag

Tap the NFC-enabled device on the tag for Bluetooth connection.

Remote control

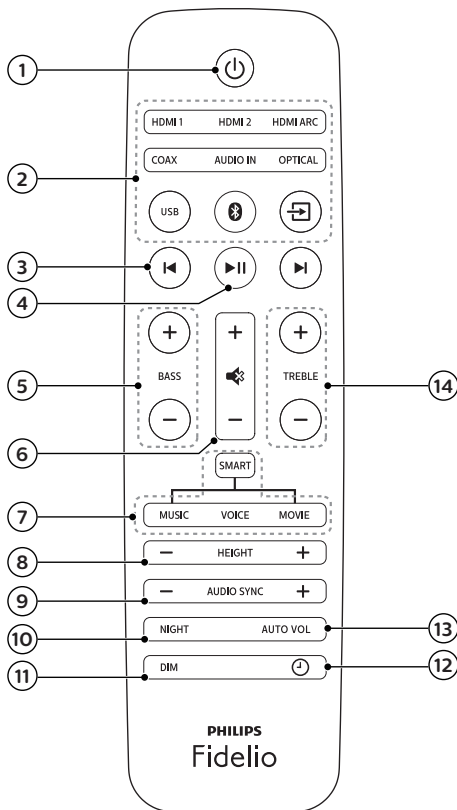

This section includes an overview of the remote control.



①

Switch this product on or to standby.

② Source buttons

- **HDMI ARC:** Switch your source to HDMI ARC connection.
- **HDMI 1:** Switch your source to the HDMI IN 1 connection.
- **HDMI 2:** Switch your source to the HDMI IN 2 connection.
- **COAX:** Switch your audio source to the coaxial connection.
- **OPTICAL:** Switch your audio source to the optical connection.
- **AUDIO IN:** Toggle audio source between AUX and AUDIO IN connection (3.5mm jack).
- **USB:** Switch to USB mode.
- : Switch to Bluetooth mode.
- : Select an input source for this product.

③

Skip to the previous or next track in USB and Bluetooth mode.

④

Start, pause or resume play in USB and Bluetooth mode.

⑤ BASS +/-

Increase or decrease bass.

⑥ Volume control

- +/-: Increase or decrease volume.
- : Mute or restore volume.

⑦ Sound mode control

- **SMART:** Automatically select a predefined sound mode to suit your video or music.
- **MUSIC:** Select stereo sound mode.
- **VOICE:** Select voice clarity sound mode.
- **MOVIE:** Select surround sound mode.

⑧ HEIGHT +/-

Select a height effect level for Dolby Atmos.

- ⑨ **AUDIO SYNC +/-**
Increase or decrease audio delay.
- ⑩ **NIGHT**
Turn night mode on or off.
- ⑪ **DIM**
Set the brightness of the display panel for this product.
- ⑫ **CLOCK**
Set clock or display clock.
- ⑬ **AUTO VOL.**
Turn auto volume on or off.
- ⑭ **TREBLE +/-**
Increase or decrease treble.

Connectors

This section includes an overview of the connectors available on this product.

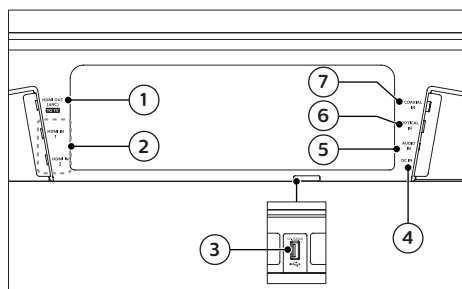

- ① **HDMI OUT (ARC) - TO TV**
Connect to the HDMI input on the TV.
- ② **HDMI IN1 / HDMI IN2**
Connect to the HDMI output on a digital device.
- ③ **USB**
 - Connect to a USB storage device for audio media play.
 - Upgrade software of this product.

- ④ **DC IN**
Connect to the power supply.
- ⑤ **AUDIO IN**
Connect to an audio output on a device via AUDIO IN or AUX source (by pressing repeatedly **AUDIO IN** on the remote control).
- ⑥ **OPTICAL IN**
Connect to an optical audio output on the TV or a digital device.
- ⑦ **COAXIAL IN**
Connect to a coaxial audio output on the TV or a digital device.

Wireless subwoofer

This product comes with a wireless subwoofer.

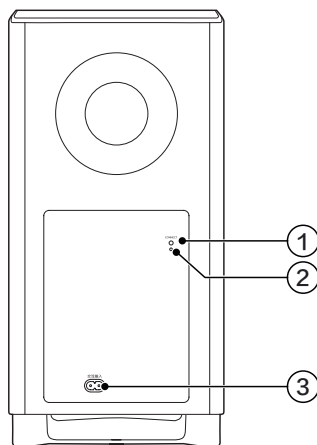

- ① **Connect (connect)**
Press to enter the pairing mode for the subwoofer.
- ② **Subwoofer indicator**
 - During wireless pairing between the subwoofer and the main

unit, the indicator blinks white quickly.

- When the pairing succeeds, the indicator lights up white.
- When the pairing fails, the indicator blinks white slowly.
- When wireless connection is disconnected for 1 minute, the indicator turns off.

③ 交流输入

Connect to the power supply.

3 Connect

This section helps you connect this product to a TV and other devices. For information about the basic connections of this product and accessories, see the quick start guide.



Note

- For identification and supply ratings, see the type plate at the back or bottom of the product.
- Before you make or change any connections, make sure that all devices are disconnected from the power outlet.

Placement

Place the subwoofer at least 1 meter (3 feet) away from the main unit, and 10 centimeters (4 inches) away from the wall.

For best results, place your subwoofer as shown below.

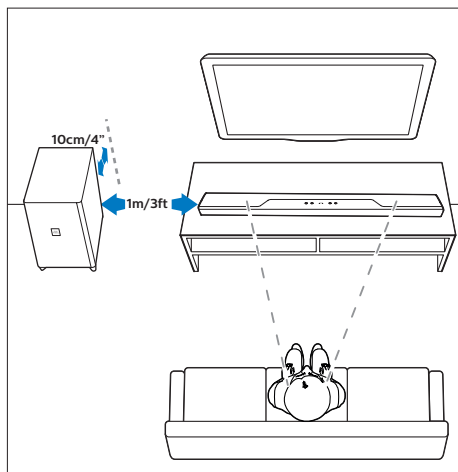

Pair up with the subwoofer

The wireless subwoofer automatically pairs up with the main unit for wireless connection when you turn on the main unit and the subwoofer.

If no audio from the wireless subwoofer can be heard, manually pair up the subwoofer.

- 1 Turn on the main unit and the subwoofer.
 - ↳ If the connection to the main unit is lost, the indicator on the subwoofer blinks white slowly.
- 2 Press the **CONNECT** (connect) button on the subwoofer to enter the pairing mode.
 - ↳ The indicator on the subwoofer blinks white quickly.
- 3 In HDMI ARC mode (press **HDMI ARC**), on the remote control, within six seconds, press **⏮** twice then **Volume +** once, and then hold down **BASS +**.
 - ↳ If the pairing succeeds, the indicator on the subwoofer lights up white.
 - ↳ If the pairing fails, the indicator on the subwoofer blinks white slowly.
- 4 If the pairing fails, repeat the steps above.



Note

- If the wireless dis-connection or pairing up lasts 1 minute, the subwoofer automatically switches to standby and the LED on the subwoofer turns off.

Connect audio from TV

Connect this product to a TV. You can listen to audio from TV programs through the speakers of this product.

Option 1: Connect to TV through HDMI (ARC)

Best quality audio

This product supports HDMI with Audio Return Channel (ARC). With the ARC feature, you can hear the TV audio through this product by using a single HDMI cable.

What you need

- A High Speed HDMI Cable.
- Your TV supports both HDMI ARC and HDMI-CEC (see the TV user manual for details).
- For some TV models, enable the external speaker output from the TV setting menu (see the TV user manual for details).

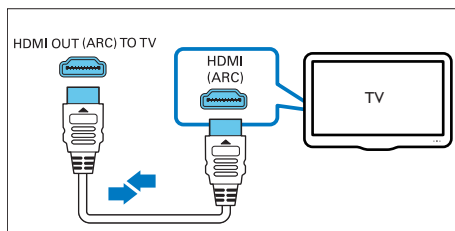

- 1 Using a High Speed HDMI cable, connect the **HDMI OUT (ARC) - TO TV** connector on this product to the **HDMI ARC** connector on the TV.
 - The **HDMI ARC** connector on the TV might be labeled differently. For details, see the TV user manual.

- 2 On your TV, turn on HDMI-CEC operations.
 - For HDMI-CEC issues on your TV, see the TV user manual to make sure that the HDMI-CEC setup is correct, or contact the TV manufacturer if needed.
- 3 Press **HDMI ARC** on the remote control of this product to enable the HDMI ARC connection.



Note

- 100% interoperability with all HDMI-CEC devices is not guaranteed.
- If your TV is not HDMI ARC compliant, connect an audio cable to hear the TV audio through this product.

Option 2: Connect to TV through optical cable

Best quality audio

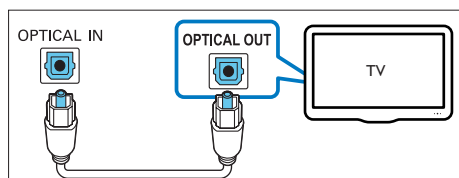

- 1 Using an optical cable, connect the **OPTICAL IN** connector on this product to the optical output on the TV.
 - The digital optical output on the TV might be labeled **OPTICAL OUT**, **SPDIF** or **SPDIF OUT**.
- 2 Press **OPTICAL** on the remote control of this product to enable the optical connection.

Option 3: Connect to TV through coaxial cable

Best quality audio

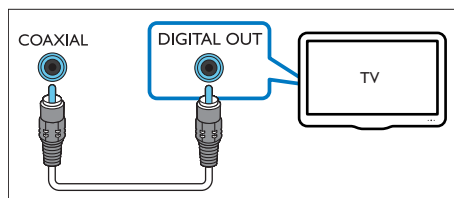

- 1 Using a coaxial cable, connect the **COAXIAL IN** connector on this product to the coaxial output on the TV.
 - The digital coaxial output on the TV might be labeled **COAXIAL/DIGITAL OUT** or **DIGITAL AUDIO OUT**.
- 2 Press **COAX** on the remote control of this product to enable the coaxial connection.

Option 4: Connect to TV through analog audio cables

Basic quality audio

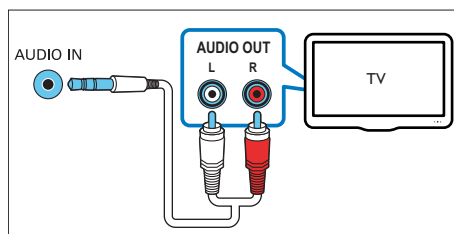

- 1 Using an analog cable, connect the **AUDIO IN** (3.5mm jack) on this product to the analog audio output (red and white) on the TV.
 - The analog audio output on the external device might be labeled **AUDIO OUT**.

- 2 Press repeatedly **AUDIO IN** on the remote control until **AUX** is displayed on the display panel.

Connect audio from other devices

You may also play audio from other devices through the speakers of this product.

Option 1: Connect to other device through optical cable

Best quality audio

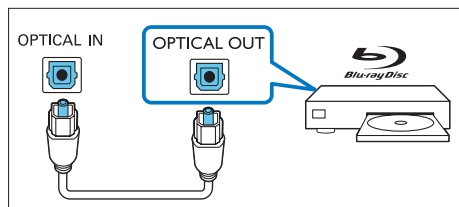

- 1 Using an optical cable, connect the **OPTICAL IN** connector on this product to the optical output on the external device.
 - The digital optical output on the external device might be labeled **OPTICAL OUT**, **SPDIF** or **SPDIF OUT**.
- 2 Press **OPTICAL** on the remote control of this product to enable the optical connection.

Option 2: Connect to other device through coaxial cable

Best quality audio

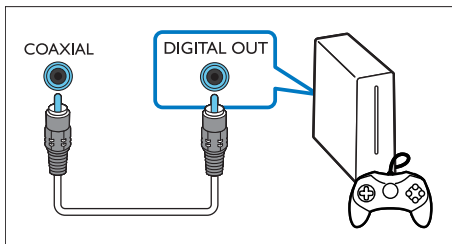

- 1 Using a coaxial cable, connect the **COAXIAL** connector on this product to the coaxial output on the external device.
 - The digital coaxial output on the external device might be labeled **COAXIAL/DIGITAL OUT** or **DIGITAL AUDIO OUT**.
- 2 Press **COAX** on the remote control of this product to enable the coaxial connection..

Option 3: Connect to other device through analog audio cables

Basic quality audio

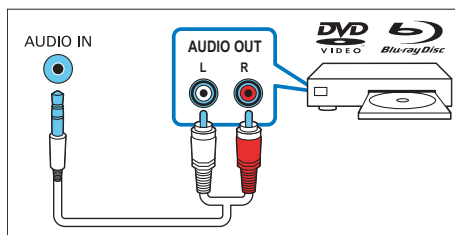

- 1 Using an analog cable, connect the **AUDIO IN** (3.5mm jack) on this product to the analog audio output (red and white) on the external device.
 - The analog audio output on the external device might be labeled **AUDIO OUT**.

- 2 Press repeatedly **AUDIO IN** on the remote control until **AUX** is displayed on the display panel.

Connect digital devices through HDMI

Connect a digital device such as a set-top box, DVD/Blu-ray player, or games console to this product through a single HDMI connection. When you connect the devices in this way and play a file or game, the

- video is automatically displayed on your TV, and
- audio is automatically played on this product.

- 1 Using a High Speed HDMI cable, connect the **HDMI OUT** connector on your digital device to the **HDMI IN 1/2** on this product.
- 2 Using a High Speed HDMI cable, connect the **HDMI OUT (ARC) - TO TV** connector on this product to the **HDMI** connector on the TV.
 - On your TV and the connected device, turn on HDMI-CEC controls (if available). For details, see the user manual of the TV and the device.
- 3 Press **HDMI 1/2** on the remote control of this product to enable the HDMI IN connection.
 - If the TV is not HDMI-CEC compliant, select the correct video input on your TV.

4 Use your product

This section helps you use this product to play media from a wide range of sources.

Before you start

- Make the necessary connections described in Quick start guide and User manual.
- Switch this product to the correct source for the other devices.

Set clock

Through clock setting, you may select a type of standby (ECO standby without clock display, or normal standby with clock display).

- 1 Switch this product to standby (press ϕ).
 ↳ ---:-- (or clock) is displayed.
- 2 Press and hold \odot to activate the clock setting mode.
 ↳ --:-- blinks.
- 3 Press **Volume +/-** to select 12 hour or 24 hour format, then press \odot to confirm.
 - If 12 hour format is selected, then select AM or PM for display.
 ↳ The hour digits begin to blink.
- 4 Press **Volume +/-** to set the hour, then press \odot to confirm.
 ↳ The minute digits begin to blink.
- 5 Press **Volume +/-** to set the minute, then press \odot to confirm.
 ↳ ECO begins to blink.

- 6 Press **Volume +/-** to select “ECO” or “CLOCK”, then press  to confirm.
- If you select “ECO”, in standby, the clock is displayed for 1 minute then the display is switched off.
 - If you select “CLOCK”, in standby, the clock is always displayed.

View clock

- 1 In ECO standby or operation mode, press .
- In ECO standby mode, the clock is displayed for 1 minute, then the display is switched off.
 - In operation mode, the clock is displayed 5 seconds, then the display is switched to the current source information.



Note

- If AC power is disconnected, the clock time can only be retained for 24 hours.
- Extreme room temperature affects clock accuracy.

Auto standby

When playing media from a connected device, this product automatically switches to standby after 15 minutes of button inactivity and no audio/video play from a connected device.

Adjust the volume

- 1 Press **Volume +/-** to increase or decrease a volume level.
- To mute sound, press .
 - To restore the sound, press  again or press **Volume +/-**.

Dolby Atmos®

In addition to horizontal distribution of 5-channel audio, this product also has built-in Dolby Atmos enabled speakers as additional audio channels to generate overhead distribution of audio for powerful delivery of 3D sound immersion and greater reality.

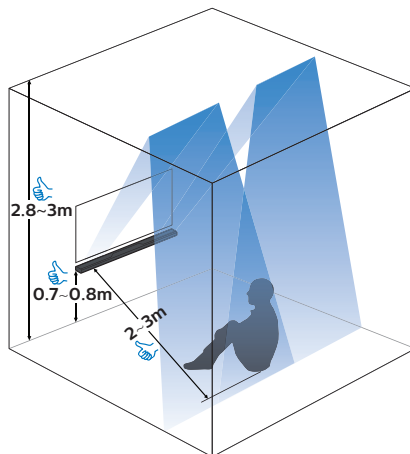

Optimal setup for Dolby Atmos sound

- Place this product at a height of 0.7m - 0.8m.
- Ceiling height is 2.8m - 3m.
- Listening distance from this product is 2m - 3m.
- Ceiling is not made of sound absorbent material.
- Preferably no protrusive objects (such as lighting and decorations) are on the ceiling.

Best Dolby Atmos effects may achieve through the following two use cases.

From your Blu-ray disc player:

- Movie with Dolby Atmos.
- Your Blu-ray disc player is connected to this product via **HDMI IN 1/2** connector.

- On your Blu-ray disc player, enable bitstream/raw audio format for HDMI sound output.
- A high speed HDMI cable.

From your TV:

- Movie with Dolby Atmos.
- Your TV supports Dolby Atmos bitstream/raw output.
- Your TV is connected to this product via **HDMI ARC** connector.
- A high speed HDMI cable.



Note

- For details on how to connect your Blu-ray disc player to this product via **HDMI IN 1/2** connector, see "Connect" > "Connect digital devices through HDMI" in the user manual.

Enjoy Dolby Atmos sound

- 1 Press **HEIGHT +/-** to select a height surround effects level to best suit your personal taste according to your environment.
 - **OFF**: no height effect.
 - **HEIGHT LOW**: small height effect.
 - **HEIGHT MEDIUM**: medium height effect.
 - **HEIGHT HIGH**: big height effect.



Note

- For non-HDMI connections (such as use of USB, Bluetooth, OPTICAL and COAXIAL), only limited height surround effects are generated.

Choose your sound

This section helps you choose the ideal sound for your video or music.

Sound mode

Select predefined sound modes to suit your video or music.

- Press **MOVIE** to create a surround listening experience. Ideal for watching movie.
- Press **MUSIC** to create two-channel or multi-channel stereo. Ideal for listening to music.
- Press **VOICE** to create sound effect which makes human voice more clear and outstanding for listening.
- Press **SMART** to automatically select a predefined sound mode (**MOVIE**, **MUSIC** or **VOICE**) based on input audio content to optimize audio performance.

Equalizer

Change the high frequency (treble) and low frequency (bass) settings of this product.

- 1 Press **TREBLE +/-** or **BASS +/-** to change the frequency.

Synchronize video and sound

If the audio and video are not synchronized, delay the audio to match the video.

- 1 Press **AUDIO SYNC +/-** to synchronize the audio with the video.

Auto volume

Turn the auto volume on to keep the volume constant when you switch to a different source.

It also compresses the sound dynamics, increasing the volume for quiet scenes and decreasing the volume for loud scenes.

- 1 Press **AUTO VOL.** to turn auto volume on or off.
 - ➔ When auto volume is turned on, **ON AUTO VOLUME** scrolls once on the display panel.
 - ➔ When auto volume is turned off, **OFF AUTO VOLUME** scrolls once on the display panel.

Night mode

For quiet listening, night mode decreases the volume of loud sounds when audio is played. Night mode is only available for Dolby Digital soundtracks.

- 1 Press **NIGHT** to turn night mode on or off.
 - When night mode is turned on, **ON NIGHT** scrolls once on the display panel.
 - When night mode is turned off, **OFF NIGHT** scrolls once on the display panel.



Note

- If you turn on auto volume, night mode (if activated) will be automatically turned off, and vice versa.

Play audio through Bluetooth

Through Bluetooth, connect this product with your Bluetooth device (such as an iPad, iPhone, iPod touch, Android phone, or laptop), and then you can listen to the audio files stored on the device through the speakers of this product.

What you need

- A Bluetooth device which supports Bluetooth profile A2DP, AVRCP and with Bluetooth version as 3.0.
- The maximum operational range between this product and a Bluetooth device is approximately 10 meters (30 feet).

- 1 Press **0** on the remote control to switch this product to Bluetooth mode.
 - ➔ **BT** is displayed on the display panel, blinking.
- 2 On the Bluetooth device, switch on Bluetooth, search for and select **Fidelio B8** to start connection (see the user manual of the Bluetooth device on how to enable Bluetooth).
 - ➔ During connection, **BT** on the display panel blinks.
- 3 Wait until this product beeps.
 - ➔ When the Bluetooth connection succeeds, **BT** is displayed on the display panel.
 - ➔ If the connection fails, **BT** on the display panel blinks continuously.
- 4 Select and play audio files or music on your Bluetooth device.
 - During play, if a call is coming, music play is paused.
 - If your Bluetooth device supports AVRCP profile, on the remote control you can press **◀** / **▶** to skip to a track, or press **▶||** to pause/resume play.
- 5 To exit Bluetooth, select other source.
 - When your switch back to Bluetooth mode, Bluetooth connection remains active.

Note

- The music streaming may be interrupted by obstacles between the device and this product, such as wall, metallic casing that covers the device, or other devices nearby that operate in the same frequency.
- If you want to connect this product with another Bluetooth device, press and hold **Ⓚ** on the remote control to disconnect the currently connected Bluetooth device.

Connect Bluetooth via NFC

NFC (Near Field Communication) is a technology that enables short-range wireless communication between NFC-enabled devices, such as mobile phones.

What you need

- A Bluetooth device with NFC function.
- For pairing, tap the NFC device on the **NFC** tag of this product.

- 1 Enable NFC on the Bluetooth device (see the device's user manual for details).
- 2 Tap the NFC device onto the **NFC** tag of this product until this product beeps.
 - ↳ When the Bluetooth connection succeeds, **BT** is displayed on the display panel.
 - ↳ If the connection fails, **BT** on the display panel blinks continuously.
- 3 Select and play audio files or music on your NFC device.
 - To break the connection, tap again the NFC device onto the NFC tag on this product.

MP3 player

Connect your MP3 player to play your audio files or music.

What you need

- An MP3 player.
- A 3.5mm stereo audio cable.

- 1 Using the 3.5mm stereo audio cable, connect the MP3 player to the **AUDIO IN** connector on this product.
- 2 Press repeatedly **AUDIO IN** on the remote control until **AUDIO IN** is displayed on the display panel.
- 3 Press the buttons on the MP3 player to select and play audio files or music.

USB storage devices

Enjoy audio on a USB storage device, such as an MP3 player and USB flash memory, etc.

What you need

- A USB storage device that is formatted for FAT16 or FAT32 file systems, and complies with the Mass Storage Class.
- An MP3 file on a USB storage device.

- 1 Connect a USB storage device to this product.
- 2 Press **USB** on the remote control.
- 3 Use the remote control to control play.
 - Press **▶||** to start, pause or resume play.
 - Press **◀/▶** to skip to the previous or next track.

- During USB play, press **USB** to select one of the following play modes.
 - **ALL RPT**: repeat all the tracks in one folder.
 - **OFF RPT**: repeat mode is turned off.



Note

- Support a USB storage device up to 32GB.
- This product may not be compatible with certain types of USB storage device.
- If you use a USB extension cable, USB HUB, or USB multi-reader, the USB storage device may not be recognized.
- Digital camera PTP and MTP protocols are not supported.
- Do not remove the USB storage device while it is being read.
- DRM-protected music files (MP3) are not supported.
- Support a USB port: 5V ---, 500mA.

- 1 In HDMI ARC mode (press **HDMI ARC**), on the remote control, within six seconds, press  twice then **Volume -** once, and then hold down **BASS -**.
 - ↳ When the factory settings restore is complete, the product automatically switches off and restarts.

Set display brightness

You can press **DIM** repeatedly to select a different brightness level of the display panel on this product.

If you select **AUTO OFF**, LED message is switched off after 10 seconds of button inactivity.

Apply factory settings

In case of no response from this product , you can reset this product to the default settings programmed at the factory.

5 Update software

To get the best features and support, update your product with the latest software.

Check software version

In HDMI ARC mode (press **HDMI ARC**), on the remote control, within six seconds, press  twice then **TREBLE -** once, and then hold down **BASS -**.

- The software version number is displayed on the display panel.

Update software via USB



Caution

- Do not turn off the power or remove the USB flash drive when the software update is in progress because you might damage this product.

- 1 Check the latest software version on www.philips.com/support.
 - Search for your model and click on "Software and drivers".
- 2 Download the software into a USB flash drive.
 - ① Unzip the downloaded file, and make sure that the unzipped folder is named "UPG".
 - ② Put the "UPG" folder in the root directory.
- 3 Connect the USB flash drive to the **USB** connector on this product.

- 4 Switch this product to HDMI ARC source (press **HDMI ARC**).
- 5 On the remote control, within 6 seconds press  twice then **Volume +** once, and then hold down **MOVIE**.
 - "UPGRADE" (upgrade) is displayed briefly, then upgrade progress is indicated.
 - If a USB flash drive is not connected or invalid upgrade file is found, "ERROR" (error) is displayed on the display panel.
- 6 Wait until the upgrade is completed.
 - If the upgrade is complete, this product automatically turns off and on again.



Note

- The upgrade time may take around 8 minutes.

6 Wall mount

Note

- Before wall mounting, make sure the wall can support the weight of this product.
- For wall mounting, this product must be securely attached to the wall in accordance with the installation instructions. Improper wall mounting may result in accident, injury or damage. If you have any query, contact Consumer Care in your country.

Screw length/diameter

Depending on the type of wall mounting this product, make sure that you use screws of a suitable length and diameter.

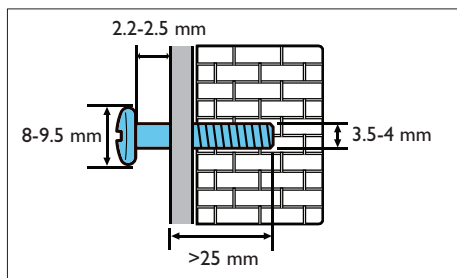

See the illustration in the quick start guide on how to wall mount this product.

- 1) Use the supplied paper template to mark two holes on the wall, then secure two suitable screws in the holes.
- 2) Fix the two supplied wall brackets on this product.
- 3) Hang this product on the wall.

7 Product specifications

Note

- Specifications and design are subject to change without notice.

Amplifier

- Total output power: 400W RMS (+/- 0.5 dB, 10% THD)
- Frequency response: 20 Hz-20 kHz / ± 3 dB
- Signal-to-noise ratio: > 65 dB (CCIR) / (A-weighted)
- Input sensitivity:
 - AUX: 1900 mV
 - AUDIO IN: 900 mV

Audio

- S/PDIF Digital audio input:
 - Coaxial: IEC 60958-3
 - Optical: TOSLINK

USB

- Compatibility: Hi-Speed USB (2.0)
- Class support: USB Mass Storage Class (MSC)
- File system: FAT16, FAT32
- Supports MP3 file format

Bluetooth

- Bluetooth profiles: A2DP, AVRCP
- Bluetooth version: 3.0

Main unit

- Power supply:
 - Model (Philips branded AC power adapter): DYS902-190473W
 - Input: 100-240 V~, 50/60 Hz 1.5 A
 - Output: 19V $\overline{\text{=}}$, 4.73A
- Standby without clock display: ≤ 0.5 W
- Standby with clock display: ≤ 1 W
- Dimensions (W x H x D): 1058 x 52 x 120 mm
- Weight: 3.65 kg
- **Built-in speakers**
 - 6 x silk tweeter (1", 3 ohm)
 - 2 x silk tweeter (0.8", 8 ohm)
 - 4 x racetrack woofer speaker (3.5" x 1", 16 ohm)
 - Centre channel: 2 x racetrack full-range speaker (3.5" x 1", 16 ohm)
 - Front/surround channel: 4 x racetrack woofer speaker (3.5" x 1", 8 ohm)

Subwoofer

- Power supply: 220-240 V~, 50-60 Hz
- Power consumption: 60 W
- Standby power consumption: ≤ 0.5 W
- Impedance: 3 ohm
- Speaker drivers: 1 x 8" subwoofer
- Dimensions (W x H x D): 240 x 510 x 302 mm
- Weight: 8.9 kg

Remote control batteries

- 2 x AAA-R03-1.5 V

8 Trouble-shooting



Warning

- Risk of electric shock. Never remove the casing of the product.

To keep the warranty valid, never try to repair the product yourself. If you have problems using this product, check the following points before you request service. If you still have a problem, get support at www.philips.com/support.

Main unit

The buttons on this product do not work.

- Disconnect this product from the power supply for a few minutes, then reconnect.

Sound

No sound from the speakers of this product.

- Connect the audio cable from this product to your TV or other devices. However, you do not need a separate audio connection when:
 - the product and TV are connected through **HDMI ARC** connection, or
 - a device is connected to the **HDMI IN** connector on this product.
- Reset this product to its factory settings.
- On the remote control, select the correct audio input.
- Make sure that this product is not muted.

No sound from the wireless subwoofer.

- Wirelessly connect the subwoofer to the main unit.

Distorted sound or echo.

- If you play audio from the TV through this product, make sure that the TV is muted.

Audio and video are not synchronized.

- Press **AUDIO SYNC +/-** to synchronize the audio with the video.

Error message is displayed on the display panel.

- When "ERROR" is displayed, it indicates that an input audio format is not supported.
- When "ARC" blinks, it indicates that the connected TV is not HDMI ARC compliant or an unsupported audio format is detected.

Bluetooth

A device cannot connect with this product.

- The device does not support the compatible profiles required for this product.
- You have not enabled the Bluetooth function of the device. See the user manual of the device on how to enable the function.
- The device is not correctly connected. Connect the device correctly.
- This product is already connected with another Bluetooth device. Disconnect the connected device, then try again.

Quality of audio play from a connected Bluetooth device is poor.

- The Bluetooth reception is poor. Move the device closer to this product, or remove any obstacle between the device and this product.

The connected Bluetooth device connects and disconnects constantly.

- The Bluetooth reception is poor. Move the device closer to this product, or remove any obstacle between the device and this product.
- Turn off Wi-Fi function on the Bluetooth device to avoid interference.
- For some Bluetooth, the Bluetooth connection can be deactivated automatically to save power. This does not indicate any malfunction of this product.

NFC

A device cannot connect with this product via NFC.

- Make sure that the device is supported by NFC.
- Make sure that NFC is enabled on the device (see the device's user manual for details).
- For pairing, tap the NFC device on the **NFC** tag of this product.

Dolby Atmos

Cannot achieve outstanding Dolby Atmos effects.

- For non-HDMI connections (such as use of USB, Bluetooth, OPTICAL and COAXIAL), limited height surround effects are generated. See the section of "Dolby Atmos" about how to achieve best Dolby Atmos effects.



Manufactured under license from Dolby Laboratories. Dolby, Dolby Atmos, and the double-D symbol are trademarks of Dolby Laboratories.



For DTS patents, see <http://patents.dts.com>. Manufactured under license from DTS Licensing Limited. DTS, the Symbol, & DTS and the Symbol together are registered trademarks, and DTS Digital Surround is a trademark of DTS, Inc. © DTS, Inc. All Rights Reserved.



The terms HDMI and HDMI High-Definition Multimedia Interface, and the HDMI Logo are trademarks or registered trademarks of HDMI Licensing LLC in the United States and other countries.



The Bluetooth® word mark and logos are registered trademarks owned by Bluetooth SIG, Inc. and any use of such marks by Gibson Innovations Limited is under license. Other trademarks and trade names are those of their respective owners.



The N Mark is a trademark or registered trademark of NFC Forum, Inc. in the United States and in other countries.



Qualcomm aptX is a product of Qualcomm Technologies International, Ltd. Qualcomm is a trademark of Qualcomm Incorporated, registered in the United States and other countries, used with permission. aptX is a trademark of Qualcomm Technologies International, Ltd., registered in the United States and other countries, used with permission.

产品中有害物质的名称及含量
Names and Contents of Hazardous Substances

部件名称 Name of the parts	有害物质 Hazardous Substance					
	铅 (Pb)	汞 (Hg)	镉 (Cd)	六价铬 (Cr (VI))	多溴联苯 (PBB)	多溴二苯醚 (PBDE)
Housing 外壳	○	○	○	○	○	○
Subwoofer 超重低音箱	×	○	○	○	○	○
Loudspeakers 喇叭单元	○	○	○	○	○	○
PWBs 电路板组件	×	○	○	○	○	○
Accessories (Remote control & cables) 附件（遥控器， 电源线，连接线）	×	○	○	○	○	○
Batteries in Remote Control (ZnC) 遥控器电池	×	○	○	○	○	○

本表格依据 SJ/T 11364 的规定编制。

The table is formulated according to SJ/T 11364.

○：表示该有害物质在该部件所有均质材料中的含量均在 GB/T 26572 规定的限量要求以下。

○： Indicates that this hazardous substance contained in all of the homogeneous materials for this part is below the limit requirement in GB/T 26572.

×：表示该有害物质至少在该部件的某一均质材料中的含量超出 GB/T 26572 规定的限量要求。

×： Indicates that this hazardous substance contained in at least one of the homogeneous materials used for this part is above the limit requirement in GB/T 26572.



环保使用期限 Environmental Protection Use Period

此标识指期限（十年），电子电气产品中的有害物质在正常使用的条件下不会发生外泄或突变，用户使用该电子电气产品不会对环境造成严重污染或对其人身、财产造成严重损害的期限。

This logo refers to the period (10 years) during which the hazardous substances in electronic and electrical products will not leak or mutate so that the use of these [substances] will not result in any severe environmental pollution, any bodily injury or damage to any assets.



Specifications are subject to change without notice

2017 © Gibson Innovations Limited. All rights reserved.

This product has been manufactured by, and is sold under the responsibility of WOOX Innovations (Shanghai) Commercial Company Ltd., and WOOX Innovations (Shanghai) Commercial Company Ltd., is the warrantor in relation to this product.

Philips and the Philips Shield Emblem are registered trademarks of Koninklijke Philips N.V. and are used under license.

B8_93_UM_V1.0

