



Philips izzy  
wireless multiroom  
speaker

Bluetooth®  
Sand



BM5C

## One tap to play music in every room

Philips izzy wireless multi-room speaker plays music wirelessly via Bluetooth. With a tap of button, up to 5 izzy speakers play music in every room at the same time effortlessly. Easy setup, no router, password or apps.

### Philips izzylink™ for multiroom music

- Play music in one room wirelessly via Bluetooth
- One tap to set up izzylink™, no router, no password, no apps
- Group up to 5 izzy with izzylink™ for multiroom enjoyment
- Change the master speaker in the group with just one tap

### Enrich your sound experience

- 2 x 2.5" drivers with bass port for room-filling sound

### Simplicity in use

- Stream all your music via izzylink™
- Wireless music streaming via Bluetooth

**PHILIPS**

# Highlights

## Play music in one room



Philips izzy speaker lets you stream all your favourite music from your phone, tablet or computer, no matter which music or radio app you use.

## izzylink™

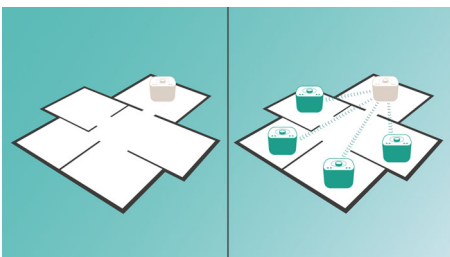

izzylink™ is a wireless technology that uses the IEEE 802.11n standard to enable the link-up of multiple speakers to form a wireless network. The network connects up to five speakers without the need of a router, Wi-Fi password, or any smart device mobile app to set it up. You can add izzy speakers to the network easily to enjoy music playing at the same time in different rooms. Each speaker can still be switched between single mode for individual use or group mode for multiroom music with one tap.

## One tap to set up izzylink™

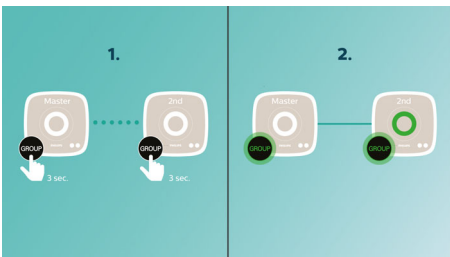

No router, no password, no apps needed for set up. Just long press the "GROUP" button on two

speakers to set up for the first time. Repeat to add a 3rd, 4th, or 5th speaker. Each long press of the "Group" button adds one new speaker at a time. Multiroom music has never been easier. Once complete, the izzylink™ network will be stored even when the speaker is unplugged.

## Switch the lead speaker easily

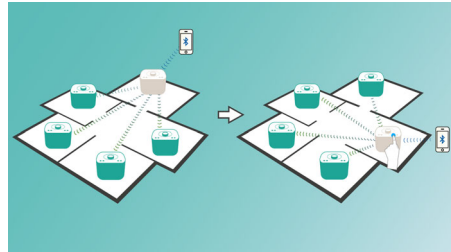

In each izzylink™ group, any individual speaker can be the master, streaming music to the others. When you want to take the lead to share your own music, press the Bluetooth button on the speaker in your room and share that music from your device instantly. Other speakers in the same izzylink™ group will play the same music at the same time, in sync. Sharing music with each other is that easy.

## 2 audiophile-grade drivers



Equipped with 2 x 2.5" audiophile-grade drivers, izzy multiroom speakers create powerful room-filling sound while bass ports expand low-frequencies, creating a truly immersive and dynamic experience.

# Specifications

## Compatibility

- Android tablets and smartphones: with Android 2.1 and Bluetooth 2.1 or above
- iPad: iPad 1, iPad 2, iPad Air, iPad Air 2, iPad mini, iPad mini 2, iPad mini 3, iPad with Retina display, new iPad
- iPhone: iPhone 3, iPhone 3GS, iPhone 4, iPhone 4S, iPhone 5, iPhone 5C, iPhone 5S, iPhone 6, iPhone 6 Plus, iPhone 6S
- iPod touch: 3rd generation or later
- other music devices: with Bluetooth 2.1 or above
- works with: most Bluetooth smartphones, music devices, tablets

## Loudspeakers

- Loudspeaker types: Integrated
- Built-in speakers: 2
- Speaker drivers: 2 x 5.72 cm (2.5") full-range drivers with bass port

## Convenience

- Volume control: Rotary

## Accessories

- Included accessories: World Wide Warranty leaflet, Quick install guide
- AC/DC adapter: 100-240 V

## Dimensions

- Product dimensions (WxDxH): 165 x 118 x 165 mm
- Packaging dimensions (WxDxH): 269 x 211 x 158 mm
- Product weight: 1.123 kg
- Weight incl. Packaging: 1.837 kg



Issue date 2016-03-22

Version: 5.0.4

12 NC: 8670 001 30614  
EAN: 48 95185 61753 4

© 2016 Koninklijke Philips N.V.  
All Rights reserved.

Specifications are subject to change without notice.  
Trademarks are the property of Koninklijke Philips N.V.  
or their respective owners.

[www.philips.com](http://www.philips.com)