

Micro Hi-Fi System

MCM177

Register your product and get support at
www.philips.com/welcome

User manual



PHILIPS

Important notes for users in the U.K.

Mains plug

This apparatus is fitted with an approved 13 Amp plug. To change a fuse in this type of plug proceed as follows:

- 1** Remove fuse cover and fuse.
- 2** Fix new fuse which should be a BS1362 3 Amp, A.S.T.A. or BSI approved type.
- 3** Refit the fuse cover:

If the fitted plug is not suitable for your socket outlets, it should be cut off and an appropriate plug fitted in its place.

If the mains plug contains a fuse, this should have a value of 3 Amp. If a plug without a fuse is used, the fuse at the distribution board should not be greater than 3 Amp.

Note: *The severed plug must be disposed of to avoid a possible shock hazard should it be inserted into a 13 Amp socket elsewhere.*

How to connect a plug

The wires in the mains lead are coloured with the following code: blue = neutral (N), brown = live (L).

- As these colours may not correspond with the colour markings identifying the terminals in your plug, proceed as follows:
 - Connect the blue wire to the terminal marked N or coloured black.
 - Connect the brown wire to the terminal marked L or coloured red.
 - Do not connect either wire to the earth terminal in the plug, marked E (or $\frac{1}{2}$) or coloured green (or green and yellow).

Before replacing the plug cover, make certain that the cord grip is clamped over the sheath of the lead - not simply over the two wires.

Copyright in the U.K.

Recording and playback of material may require consent. See Copyright Act 1956 and The Performer's Protection Acts 1958 to 1972.

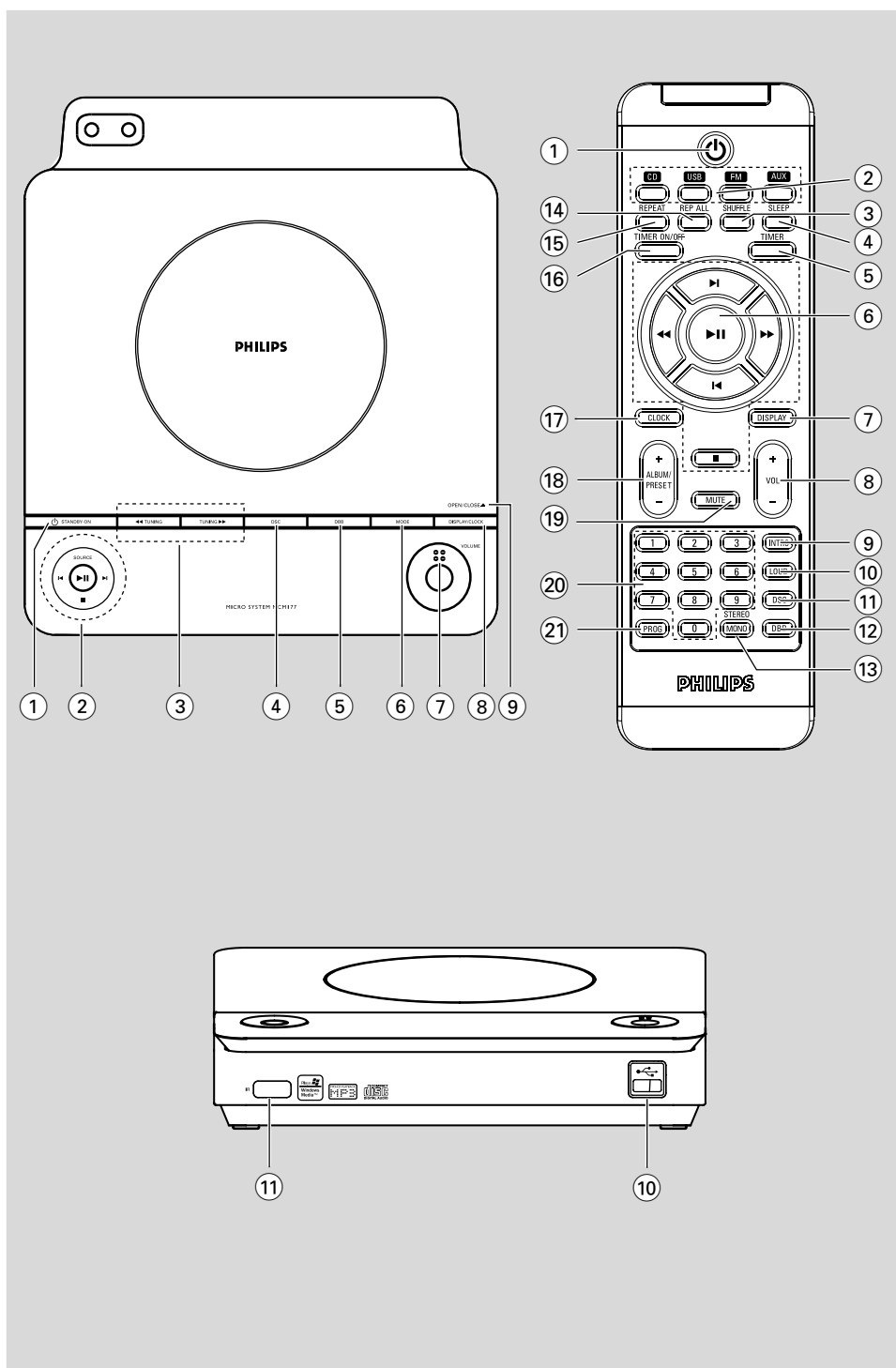

CAUTION

Use of controls or adjustments or performance of procedures other than herein may result in hazardous radiation exposure or other unsafe operation.

English	6
---------------	---

Contents

General Information

Supplied accessories	7
Environmental information	7
Safety information	7–8

Preparations

Rear connections	9–10
Inserting batteries into the remote control...	10

Controls

Controls on the system	11
Controls on the remote control	11–12

Basic Functions

Plug and play (for tuner installation)	13
Switching the system on	14
Adjusting volume and sound	14

CD/MP3 Operation

Loading a disc	15
Basic playback controls	15
Playing an MP3/WMA disc	15
Different play modes: Shuffle and Repeat	16
Programming track numbers	16
Reviewing the programme	16
Erasing the programme	16

Radio Reception

Tuning to radio stations	17
Programming radio stations	17
Automatic programming	
Manual programming	
Tuning to preset radio stations	17

USB Connection

Using USB connectivity	18–19
------------------------------	-------

AUX

Listening to an external source	19
---------------------------------------	----

Clock/Timer

Viewing the clock	20
Setting the clock	20
Setting the timer	20
Activating and deactivating TIMER	20
Activating and deactivating SLEEP	20

Specifications	21
----------------------	----

Maintenance	21
-------------------	----

Troubleshooting	22–23
-----------------------	-------

Congratulations on your purchase and welcome to Philips!

To fully benefit from the support that Philips offers, register your product at www.philips.com/welcome.

This product complies with the radio interference requirements of the European Community.

Supplied accessories

- 1 X certified AC/DC 18V adaptor
Brand name: PHILIPS,
Model: GFP451-1825BX-1 or AS450-180-AF250, Input: 100-240V~ 50-60Hz or 50/60Hz 1.2A, Output: 18.0V === 2.5A
- 2 speaker boxes
- remote control
- FM antenna

Environmental Information

All unnecessary packaging has been omitted. We have tried to make the packaging easy to separate into three materials: cardboard (box), polystyrene foam (buffer) and polyethylene (bags, protective foam sheet).

Your system consists of materials which can be recycled and reused if disassembled by a specialized company. Please observe the local regulations regarding the disposal of packaging materials, exhausted batteries and old equipment.

Disposal of your old product

Your product is designed and manufactured with high quality materials and components, which can be recycled and reused.



When this crossed-out wheeled bin symbol is attached to a product it means the product is covered by the European Directive 2002/96/EC

Please inform yourself about the local separate collection system for electrical and electronic products.

Please act according to your local rules and do not dispose of your old products with your normal household waste. The correct disposal of your old product will help prevent potential negative consequences for the environment and human health.

Safety Information

- Before operating the system, check that the operating voltage indicated on the typeplate (or the voltage indication beside the voltage selector) of your system is identical with the voltage of your local power supply. If not, please consult your dealer.
- Place the system on a flat, hard and stable surface.
- Where the MAINS plug or an appliance coupler is used as the disconnection device, the disconnection device shall remain readily operable.
- The apparatus shall not be exposed to dripping or splashing.
- Install the unit near the AC outlet and where the AC power plug can be easily reached.
- Place the system in a location with adequate ventilation to prevent internal heat build-up in your system. Allow at least 10 cm (4 inches) clearance from the rear and the top of the unit and 5 cm (2 inches) from each side.
- The ventilation should not be impeded by covering the ventilation openings with items, such as newspapers, table-cloths, curtains, etc.
- Do not expose the system, batteries or discs to excessive moisture, rain, sand or heat sources caused by heating equipment or direct sunlight.
- No naked flame sources, such as lighted candles, should be placed on the apparatus.
- No objects filled with liquids, such as vases, shall be placed on the apparatus.
- If the system is brought directly from a cold to a warm location, or is placed in a very damp room, moisture may condense on the lens of the disc unit inside the system. Should this occur, the CD player would not operate normally. Leave the power on for about one hour with no disc in the system until normal playback is possible.
- The mechanical parts of the set contain self-lubricating bearings and must not be oiled or lubricated.

General Information

- Batteries (battery pack or batteries installed) shall not be exposed to excessive heat such as sunshine, fire or the like.
- **When the system is switched to Standby mode, it is still consuming some power. To disconnect the system from the power supply completely, remove the AC power plug from the wall socket.**

Hearing Safety

Listen at a moderate volume.

- Using headphones at a high volume can impair your hearing. This product can produce sounds in decibel ranges that may cause hearing loss for a normal person, even for exposure less than a minute. The higher decibel ranges are offered for those that may have already experienced some hearing loss.
- Sound can be deceiving. Over time your hearing "comfort level" adapts to higher volumes of sound. So after prolonged listening, what sounds "normal" can actually be loud and harmful to your hearing. To guard against this, set your volume to a safe level before your hearing adapts and leave it there.

To establish a safe volume level:

- Set your volume control at a low setting.
- Slowly increase the sound until you can hear it comfortably and clearly, without distortion.

Listen for reasonable periods of time:

- Prolonged exposure to sound, even at normally "safe" levels, can also cause hearing loss.
- Be sure to use your equipment reasonably and take appropriate breaks.

Be sure to observe the following guidelines when using your headphones.

- Listen at reasonable volumes for reasonable periods of time.
- Be careful not to adjust the volume as your hearing adapts.
- Do not turn up the volume so high that you can't hear what's around you.
- You should use caution or temporarily discontinue use in potentially hazardous situations.
- Do not use headphones while operating a motorized vehicle, cycling, skateboarding, etc.; it may create a traffic hazard and is illegal in many areas.

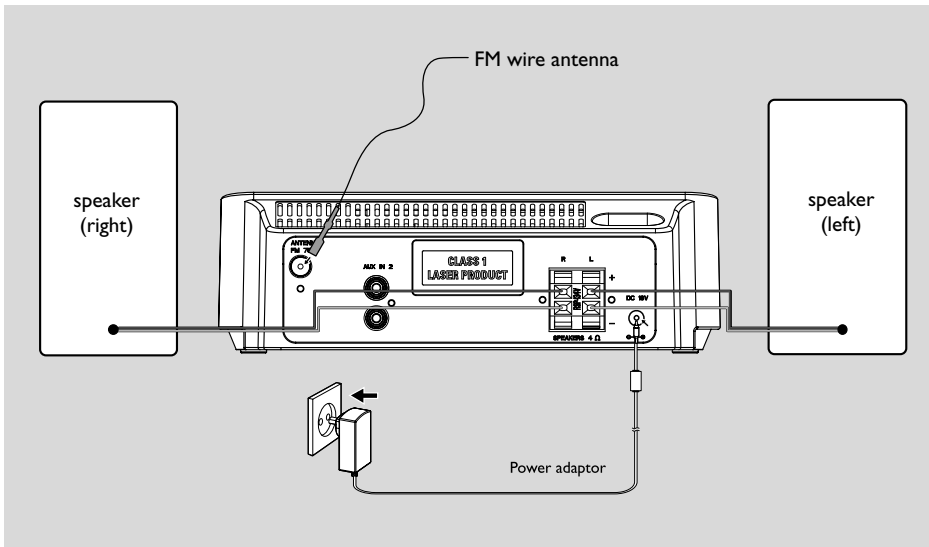

Rear connections

The type plate is located at the rear of the system.

A Power

- Before connecting the AC power cord to the wall outlet, ensure that all other connections have been made.

WARNING!

- **For optimal performance, use only the original power cable.**
- **Never make or change any connections with the power switched on.**

To avoid overheating of the system, a safety circuit has been built in. Therefore, your system may switch to Standby mode automatically under extreme conditions. If this happens, let the system cool down before reusing it (not available for all versions).

B Antenna Connection

FM Antenna

The wire antenna supplied can only be used to receive nearby stations. For better reception we recommend using a cable antenna system or an outdoor antenna.

- 1 Extend the wire antenna and fit it to FM ANTENNA as shown below.

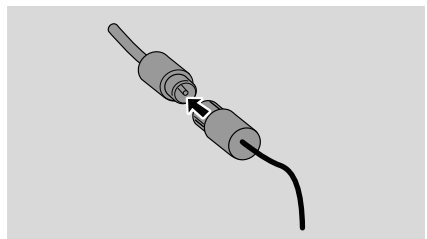

Note: If you are using a cable antenna system or an outdoor antenna, fit the antenna plug, instead of the wire antenna, to FM ANTENNA.

- 2 Move the antenna in different positions for optimal reception (as far away as possible from the TV/VCR or other radiation sources).
- 3 Fix the antenna's end to the wall.

Preparations

C Speakers Connection

Front Speakers

Connect the speaker wires to the SPEAKERS terminals, right speaker to "R" and left speaker to "L", coloured (marked) wire to "+" and black (unmarked) wire to "-".

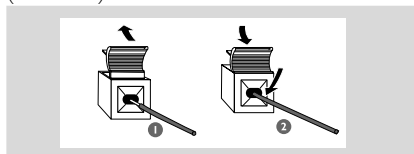

- Fully insert the stripped portion of the speaker wire into the terminal as shown.

Notes:

- For optimal sound performance, use the supplied speakers.
- Do not connect more than one speaker to any one pair of + / - speaker terminals.
- Do not connect speakers with an impedance lower than the speakers supplied. Please refer to the SPECIFICATIONS section of this manual.

Before using the remote control

- 1 Pull out the plastic protective sheet.
- 2 Select the source you wish to control by pressing one of the source select keys on the remote control (for example CD, FM).
- 3 Then select the desired function (for example ►, ◀, ▶).

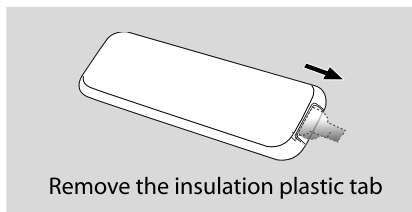

Replacing battery (lithium CR2025) into the remote control

- 1 Push to open the battery tray.
- 2 Replace a new battery according to the indicated polarity.
- 3 Push the battery tray back to close it.

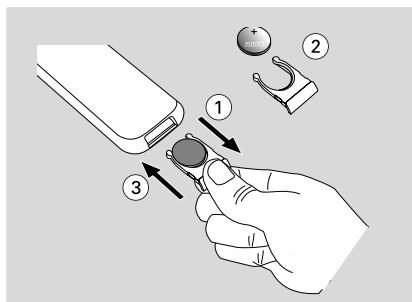

CAUTION!

- Remove battery if they are exhausted or will not be used for a long time.
- Batteries contain chemical substances, so they should be disposed of properly.

Controls (illustrations on page 3)

Controls on the system

① **STANDBY ON** (⏻)

- switches the system to standby/Eco-power standby/on.

② **SOURCE**

- selects the respective sound source for CD/USB/FM/AUX1/AUX2.
- switches on the system.

▶II starts or interrupts CD playback.

■ stops CD playback or erases a CD programme.

⏮/⏭

for radio selects a preset radio station.

for CD skips to the beginning of the current/previous/subsequent track.

for clock/timer adjusts the minutes for the clock/timer function

③ **TUNING** ⏮/⏭

for Tuner tunes to radio stations.

for CD fast searches back and forward within a track/CD.

for MP3/WMA selects an album.

for clock/timer adjusts the hours for the clock/timer function

④ **DSC** (Digital Sound Control)

- selects sound characteristics: POP/JAZZ CLASSIC/ROCK.

⑤ **DBB** (Dynamic Bass Boost)

- enhances the bass.

⑥ **MODE**

- to select various repeat modes or the shuffle play mode for a disc.

⑦ **VOLUME**

- adjusts the volume level.

⑧ **DISPLAY/CLOCK**

for CD displays the current track remaining time and total remaining time (or current album and track name and ID3 for MP3 disc) during playback.

for clock sets the clock function

⑨ **OPEN•CLOSE▲**

- opens/closes the CD door.

⑩ **USB port**

- connects to external USB mass storage device.

⑪ **IR SENSOR**

- infrared sensor for remote control.

AUX IN jack (located on the back panel)

- connects an external source (3.5 mm socket)

AUX IN 2 jacks (located on the back panel)

- connects an external source using audio cables (white/red)

HEADPHONE (located on the back panel)

- connects headphones

Controls on the remote control

① ⏻

- switches the system to standby/Eco-power standby/on.

② **Source buttons**

- selects the respective sound source for CD/USB/FM/AUX1/AUX2.
- switches on the system.

③ **SHUFFLE**

- plays CD/MP3 tracks in random order.

④ **SLEEP**

- activates/deactivates or selects the sleeper time.

⑤ **TIMER**

- enters time setting mode

⑥ ▶II starts or interrupts CD playback.

⏮/⏭

for CD skips to the beginning of the current/previous/subsequent track.

⏮/⏭

for Tuner tunes to radio stations.

for CD fast searches back and forward within a track/CD.

for clock/timer adjusts the hours for the clock/timer function

■ stops CD playback or erases a CD programme.

⑦ **DISPLAY**

for CD displays the current track remaining time and total remaining time (or current album and track name and ID3 for MP3 disc) during playback.

Controls *(illustrations on page 3)*

- ⑧ **VOLUME**
 - adjusts the volume level.
- ⑨ **INTRO**
 - plays first 10 seconds of each track in a disc/
USB/program in sequence
- ⑩ **LOUD**
 - enables or disables automatic loudness
adjustment.
- ⑪ **DSC** (Digital Sound Control)
 - selects sound characteristics: POP/JAZZ
CLASSIC/ROCK.
- ⑫ **DBB** (Dynamic Bass Boost)
 - enhances the bass.
- ⑬ **STEREO/MONO**
 - selects stereo or mono radio broadcast
- ⑭ **REP ALL**
 - repeats a disc/ all programmed tracks
(for MP3/WMA.....repeats a disc/an album/all
programmed tracks)
- ⑮ **REPEAT**
 - repeats a track
- ⑯ **TIMER ON/OFF**
 - activates/ deactivates timer function
- ⑰ **CLOCK**
 - sets the clock function.
- ⑱ **ALBUM/PRESET +/-**
 - for radio selects a preset radio station.
 - for MP3/WMA.....selects an album.
 - for clock/timer adjusts the minutes for the clock/
timer function
- ⑲ **MUTE**
 - interrupts and resumes sound reproduction
- ⑳ **Numeric Keypad (0-9)**
 - inputs a track number of the disc.
- ㉑ **PROG**
 - for CD programmes tracks and reviews
the programme.
 - for Tuner programmes tuner stations
manually or automatically.
 - for clock selects between 12 hour and 24
hour display

Basic Functions

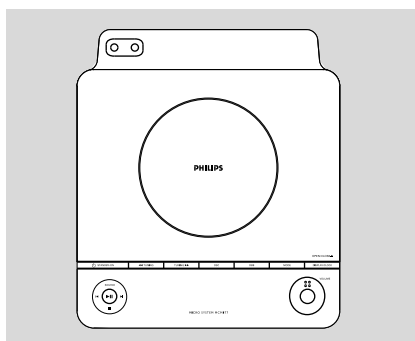

IMPORTANT:

Before you operate the system, complete the preparation procedures.

Plug and Play (for tuner installation)

Plug and Play allows you to store all available radio stations automatically.

First time setup/power up

- 1 When you turn on the main supply, "AUTO INSTALL - PLEASE PRESS PLAY, STOP CANCEL" is displayed.
- 2 Press ► || on the system to start installation.
 - "PLUG AND PLAY" "INSTALL" is displayed, followed by "TUNER" and "AUTO".
 - **PROG** starts flashing.
 - The system will automatically store the radio stations (FM only) with sufficient signal strength.
 - When all the available radio stations are stored or the memory for 40 presets are used, the last preset radio station will be played.

To reinstall Plug and Play

- 1 In standby mode, press and hold ► || on the system until "AUTO INSTALL - PLEASE PRESS PLAY, STOP CANCEL" is displayed.
- 2 Press ► || again to start installation.
 - All previously stored radio stations will be replaced.

To exit without storing the Plug and Play

- Press ■ on the system.
 - If you do not complete the Plug and Play installation, the function will be restarted when you next turn on the main supply again.

Notes:

- If no stereo frequency is detected during Plug and Play, "CHECK ANTENNA" will be displayed.

Basic Functions

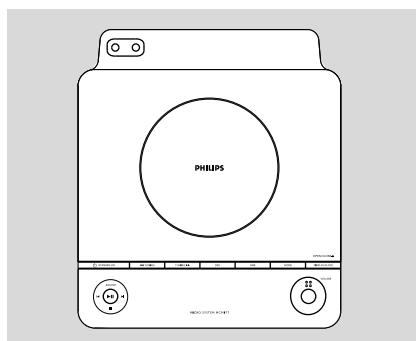

Switching the system on

- Press **STANDBY ON** or **SOURCE** (or  on the remote control).
→ The system will switch to the last selected source.
- Press **CD**, **USB**, **FM** or **AUX** on the remote control.
→ The system will switch to the selected source.

To switch the system to standby mode

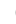
- Press **STANDBY ON** on the system (or  on the remote control).
→ The display displays clock time, or ---: --- is displayed if clock time is not set.
→ The volume level (up to a maximum volume level of 12 and up to a minimum level of 4), interactive sound settings, last selected source and tuner presets will be retained in the player's memory.

To switch the system to Eco-power standby mode

- Press and hold **STANDBY ON** ( on the remote control) for more than 2 seconds.
→ The display will go blank.
→ The Eco power light will be on.

Power-saving automatic standby

The power-saving feature automatically switches to standby 15 minutes after a CD/USB playback has ended and no control is operated.

Adjusting volume and sound

- 1 Turn the **VOLUME** control anti-clockwise to decrease or clockwise to increase volume on the system (or press **VOL -/+** on the remote control).
→ Display shows the volume level  and a number from 1-31.
- 2 Press **DSC** repeatedly to select the desired sound effect: **POP** / **JAZZ** / **CLASSIC** / **ROCK**.
- 3 Press **DBB** to switch bass enhancement on or off.
→ Display shows **DBB** if the DBB is activated.
- 4 Press **LOUD** on the remote control to enable/disable **LOUDNESS** feature.
- **LOUDNESS** feature enables the system to automatically increase the treble and bass sound effect at low volume (the higher the volume, the lower the treble and bass increase).
- 5 Press **MUTE** on the remote control to interrupt sound reproduction instantly.
→ Playback will continue without sound.
- To activate sound reproduction you can:
 - press **MUTE** again;
 - adjust the volume controls;
 - change source.

CD/MP3 Operation

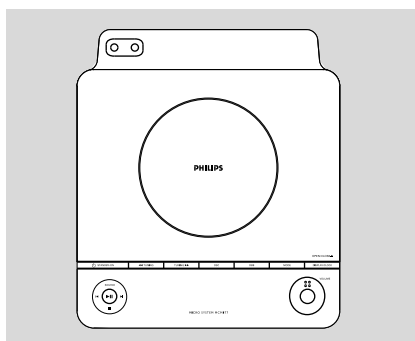

IMPORTANT:

The lens of the CD player should never be touched.

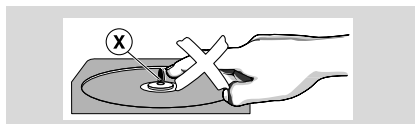

Loading a disc

This CD player plays Audio Discs including CD-Recordables, CD-Rewritables and MP3 CD.

- CD-ROM, CD-I, CDV, VCD, DVD or computer CDs, however, are not possible.
 - DRM-protected WMA disc is not supported.
- ① Select **CD** source.
 - ② Press **OPEN/CLOSE**▲ on the top of the system to open the CD compartment.
→ **OPEN** is displayed when you open the CD compartment.
 - ③ Insert a disc with the printed side facing up and press down on **OPEN/CLOSE**▲ to close the CD door.
→ **READING** is displayed as the CD player scans the contents of a disc, and then the total number of tracks and playing time (or the total number of albums and tracks for MP3 disc) are shown.

Basic playback controls

To play a disc

- Press **▶||** to start playback.
→ The current track number and elapsed playing time of the track are displayed during disc playback.

To select a different track

- Press **◀|▶** once or repeatedly until the desired track number appears in the display.

To find a passage within a track

- ① Press and hold down on **TUNING ◀|▶** (on the remote control **◀|▶**).
→ The disc is played at high speed and low volume.
- ② When you recognise the passage you want, release **TUNING ◀|▶** (on the remote control **◀|▶**).
→ Normal playback continues.

To playback the beginning of each track

- Press **INTRO** on the remote control to play first 10 seconds of each track in sequence.

To interrupt playback

- Press **▶||** during playback.
→ The display freezes and the elapsed playing time flashes when playback is interrupted.
→ To resume, press **▶||** again.

To stop playback

- Press **■**.

Notes: CD play will also stop when;

- the CD door is opened.
- the disc has reached the end.
- you select another source: **USB, FM or AUX**.
- you select standby.

Playing an MP3/WMA disc

- ① Load an MP3/WMA disc.
→ The disc reading time may exceed 10 seconds due to the large number of songs compiled into one disc.
→ "### XXXX" is displayed. ## is the total album number and XXX is the total track number.
- ② Press **TUNING ◀|▶** (or **ALBUM/PRESET +/-** on the remote control) to select a desired album.
- ③ Press **◀|▶** to select a desired track.
- ④ Press **▶||** to start playback.
- During playback, press **DISPLAY/CLOCK** to show the album name and ID3 information.

CD/MP3 Operation

Supported MP3 disc formats:

- ISO9660, Joliet, UDF 1.5
- Maximum title number: 999 (depending on filename length)
- Maximum album number: 99
- Supported sampling frequencies: 32 kHz, 44.1 kHz, 48 kHz
- Supported Bit-rates: 32~256 (kbps), variable bitrates

Different play modes: SHUFFLE and REPEAT

You can select and change the various play modes before or during playback. The play modes can also be combined with PROGRAMME.

SHUF tracks of the entire disc are played in random order

REP ALL repeats the entire disc/ programme

REP plays the current track continuously

REP ALB repeats all tracks in the current (for MP3/WMA only) album

- 1 To select your play mode, press **MODE** (or **SHUFFLE** or **REPEAT** or **REP ALL**) before or during playback until the display shows the desired function.
 - 2 Press **▶II** to start playback if in the STOP position.
→ If you have selected SHUFFLE, playback starts automatically.
 - 3 To return to normal playback, press **MODE** (or **SHUFFLE** or **REPEAT** or **REP ALL**) until the various SHUFFLE/ REPEAT modes are no longer displayed.
- You can also press **■** to cancel your play mode.

Note:

– The **SHUFFLE** and **REPEAT** functions cannot be used simultaneously.

Programming track numbers

Programme in the STOP position to select and store your disc tracks in the desired sequence. If you like, store any track more than once. Up to 40 tracks can be stored in the memory.

- 1 In the stop position, use the **◀/▶** to select your desired track number.
- For MP3, you may press **TUNING ◀◀/▶▶** (or **ALBUM/PRESET +/-** on the remote control) to select a desired album, then select your desired track.
- 2 Press **PROG** on the remote control to store.
→ Display: **PROG** flashes, and **PR** **□ I** is displayed briefly, then the selected track number (and the selected album number for MP3).
- 3 Repeat **steps 1-2** to select and store all desired tracks.
→ **PROGRAM FULL** is displayed if you attempt to to programme more than 40 tracks.
- 4 To start playback of your disc programme, press **▶II**.

Reviewing the programme

- Stop playback and press **PROG** on the remote control repeatedly.
- To exit review mode, press **■**.

Erasing the programme

You can erase the programme by:

- pressing **■** once in the STOP mode;
- pressing **■** twice during playback;
- opening the CD compartment;
→ **PROG** disappears from the display.

Radio Reception

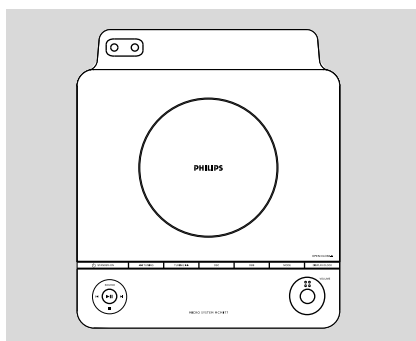

Tuning to radio stations

- 1 Press **SOURCE** on the set (or **FM** on the remote control) repeatedly until FM is displayed.
- 2 Press down on **TUNING ◀/▶** (or **◀/▶** on the remote control) and release the button.
→ The radio automatically tunes to a station with sufficient reception. Display indication during automatic tuning: SEARCH.
- 3 Repeat step 2 if necessary until you find the desired station.
- To tune to a weak station, press **TUNING ◀/▶** (or **◀/▶** on the remote control) briefly and repeatedly until you have found optimal reception.

Programming radio stations

You can store up to a total of 40 radio stations in the memory.

Automatic programming

Automatic programming will start with a chosen preset number: From this preset number upwards, former programmed radio stations will be overridden. The system will only programme stations which are not in the memory already.

- 1 Press **◀/▶** (or **ALBUM/PRESET +/-** on the remote control) to select the preset number where programming should start.

Note:

– If no preset number is selected, default is preset (1) and all your presets will be overridden.

- 2 Press **PROG** on the remote control for more than 2 seconds to activate programming.
→ **AUTO** is displayed and available stations are programmed in order of waveband reception strength. The first preset automatically stored will then be played.

Manual programming

- 1 Tune to your desired station (see Tuning to radio stations).
- 2 Press **PROG** on the remote control to activate programming.
→ **PROG** flashes in the display.
- 3 Press **◀/▶** (or **ALBUM/PRESET +/-** on the remote control) to allocate a number from 1 to 40 to this station.
- 4 Press **PROG** on the remote control again to confirm the setting.
→ **PROG** disappears, the preset number and the frequency of the preset station are shown.
- 5 Repeat the above four steps to store other stations.
- You can override a preset station by storing another frequency in its place.

Tuning to preset radio stations

- Press **◀/▶** (or **ALBUM/PRESET +/-** on the remote control) until the desired preset station is displayed.

USB Connection

Using USB connectivity

- MCM177 is fitted with a USB port in the front panel, offering a plug and play feature which allows you to play, from your MCM177, digital music and spoken contents stored on a USB mass storage device.
- Using a USB mass storage device, you can also enjoy all the features offered by MCM177 which are explained and instructed in the sections of disc operation.

Compatible USB mass storage devices

With the MCM177, you can use

- USB flash memory (USB 2.0 or USB 1.1)
- USB flash player (USB 2.0 or USB 1.1)
- USB device which requires driver installation under Windows XP is not supported.

Note:

– In some USB flash players (or memory devices), the stored contents are recorded using copyright protection technology. Such protected contents will be unplayable on any other devices (such as MCM204 device).

Supported formats:

- USB or memory file format FAT12, FAT16, FAT32 (sector size: 512 - 4096 bytes)
- MP3 bit rate (data rate): 32-320 kbps and variable bit rate
- WMA v9 or earlier
- Directory nesting up to a maximum of 8 levels
- Number of albums: maximum 99
- Number of tracks: maximum 800
- ID3 tag v2.0 or later
- File name in Unicode UTF8 (maximum length: 128 bytes)

The system will not play or support the following:

- Empty albums: an empty album is an album that does not contain MP3/WMA files, and will not be shown in the display.
- Non-supported file formats are skipped. This means that e.g.: Word documents .doc or MP3 files with extension. dlf are ignored and will not be played.
- AAC, WAV, PCM, NTFS audio files
- DRM protected WMA files
- WMA files in Lossless format

Playing a USB mass storage device

- 1 Make sure that your MCM177 is being powered on.
- 2 Plug a compatible USB mass storage device to MCM177's USB port marked . If needed, use a suitable USB cable to connect between the device and MCM177's USB port.
→ The device will automatically power on.
- 3 If the device is not powered on, turn on the power manually, then re-connect it.
- 3 Press **SOURCE** repeatedly (or **USB** on the remote) to enter USB mode.
→ **NO AUDIO** appears if no audio file is found in the USB device.
- 4 Press **▶||** on your MCM177 to start play.
- To use other playback features, see the section of CD/MP3 Operation.

Helpful hints:

- Make sure that file names of MP3 files end with .mp3. and the file names of WMA files end with .wma.
- For DRM protected WMA files, use Windows Media Player 10 (or later) for conversion. Visit www.microsoft.com for details about Windows Media Player and WM DRM (Windows Media Digital Rights Management).
- For USB device playing, if the display shows "OL", it means that the USB device is electrically overloading MCM177. You need to change a USB device.

INFORMATION REGARDING USB DIRECT:

1. *Compatibility of the USB connection on this micro system:*
 - a) *This micro system supports most USB Mass storage devices (MSD) that these devices are compliant to the USB MSD standards.*
 - i) *Most common Mass storage class devices are flash drives, memory sticks, jump drives and etc.*
 - ii) *If you see a "Disc Drive" showing up on your computer after you have plugged the mass storage device into your computer, most likely it is MSD compliant and it will work with this micro system.*
 - b) *If your Mass storage device requires a battery/power source, please make sure you have a fresh battery in it or charge the USB device first and then plug it into the micro system again.*
2. *Supported Music type:*
 - a) *This device only supports unprotected music with file extension: .mp3 .wma*
 - b) *Music bought from on-line music stores are not supported because they are secured by Digital Rights Management protection (DRM).*
 - c) *File name extensions that ended with the following are not supported: .wav; .m4a; .m4p; .mp4; .aac and etc.*
3. *No Direct connection can be made from a Computer USB port to the micro system even you have either or both mp3 or wma file in your computer.*

Listening to an external source

You can listen to the sound of the connected external device through your system's speakers.

Using AUX IN (3.5 mm jack)

- ① Use a cinch cable (not supplied) to connect **AUX IN** jack of the main unit (3.5 mm, located on the back panel) to an AUDIO OUT or headphone jack on an external equipment (such as CD player, or VCR).
- ② Press **SOURCE** (or **AUX** on the remote control) repeatedly until "AUX 1" is displayed.

Using AUX IN 2 (white/red jacks)

- ① Use the audio cables (white/red, not supplied) to connect **AUX IN 2 (L/R)** jacks of the main unit (located on the back panel) to the corresponding AUDIO OUT jacks on an external device (such as TV or VCR).
- ② Press **SOURCE** (or **AUX** on the remote control) repeatedly until "AUX 2" is displayed.

Clock/Timer

Viewing clock

- The clock (if it is set) is shown in normal standby mode.

To view the clock in any sound source (CD or FM for example)

- Press briefly **DISPLAY/CLOCK** (or **CLOCK** on the remote control).

Setting the clock

- 1 In standby mode, press and hold **DISPLAY/CLOCK** on the set (or **CLOCK** on the remote control) for 2 seconds.
→ 12 hour or 24 hour mode is displayed.
- 2 Press **PROG** to select between 12 hour and 24 hour display.
→ The clock digits flash.
- 3 Press **TUNING** ◀/▶ (or ◀/▶ on the remote control) to set the hours.
- 4 Press ◀/▶ on the set (or **ALBUM/PRESET** +/- on the remote control) to set the minutes.
- 5 Press **DISPLAY/CLOCK** (or **CLOCK** on the remote control) to confirm the time.

Setting the timer

- The system can be used as an alarm clock, whereby the CD or FM or USB is switched on at a set time. The clock time needs to be set first before the timer can be used.
- 1 In standby mode, press and hold **TIMER** about 2 seconds on the remote control.
 - 2 Press **SOURCE** (or **CD/USB/FM** on the remote control) to select sound source.
 - 3 Press **TIMER** to confirm your desired mode.
→ The clock digits flash.
 - 4 Press **TUNING** ◀/▶ (or ◀/▶ on the remote control) to set the hours.
 - 5 Press ◀/▶ on the set (or **ALBUM/PRESET** +/- on the remote control) to set the minutes.

- 6 Press **TIMER** to confirm the time.
→ The timer is now set and activated.

Notes:

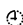

- Timer is not available in AUX mode.
- If CD source is selected and no disc is in the CD tray or the disc has an error, FM will be selected automatically.
- If USB source is selected and no compatible USB device is plugged, FM will be selected automatically.

Activating and deactivating TIMER

- In standby or during playback, press **TIMER ON/OFF** once.
→ Display shows  if activated, and disappears if deactivated.

Activating and deactivating SLEEP

The sleep timer enables the system to switch off by itself after a set period of time.

- Press **SLEEP** on the remote control once or more.
→ Display shows **zzZ** and one of the sleep time options in sequence: 60, 45, 30, 15, 0, 60... if you have selected a time.
- To deactivate, press **SLEEP** on the remote control once or more until "  " is shown, or press **STANDBY ON** on the system (or  on the remote control).
→ **zzZ** disappears from the display.

Specifications

AMPLIFIER

Output power 2 x 10W RMS
 Signal-to-noise ratio ≥ 60 dBA (IEC)
 Frequency response 125 – 16000 Hz
 Impedance loudspeakers 4Ω

CD PLAYER

Frequency range 125 – 16000 Hz
 Signal-to-noise ratio 65 dBA

TUNER

FM wave range 87.5 – 108 MHz
 Sensitivity at 75 Ω
 – FM 26 dB sensitivity 20 μ V
 Total harmonic distortion $\leq 5\%$

SPEAKERS

Bass reflex system
 Dimensions (w x h x d) . 160 x 250 x 180 (mm)

GENERAL INFORMATION

AC Power 100 – 240 V, 50/60 Hz
 Dimensions (w x h x d) 232 x 85 x 275 (mm)
 Weight (with speakers) approx. 5 kg
 Power consumption
 Active 30 W
 Standby < 5 W
 Eco Power Standby < 1 W

Specifications and external appearance are subject to change without notice.

Maintenance

Cleaning the Cabinet

- Use a soft cloth slightly moistened with a mild detergent solution. Do not use a solution containing alcohol, spirits, ammonia or abrasives.

Cleaning Discs

- When a disc becomes dirty, clean it with a cleaning cloth. Wipe the disc from the centre out.
- Do not use solvents such as benzene, thinner, commercially available cleaners, or antistatic spray intended for analogue records.



Cleaning the disc lens

- After prolonged use, dirt or dust may accumulate at the disc lens. To ensure good playback quality, clean the disc lens with Philips CD Lens Cleaner or any commercially available cleaner. Follow the instructions supplied with cleaner.

Troubleshooting

WARNING

Under no circumstances should you try to repair the system yourself, as this will invalidate the warranty. Do not open the system as there is a risk of electric shock.

If a fault occurs, first check the points listed below before taking the system for repair. If you are unable to remedy a problem by following these hints, consult your dealer or Philips for help.

Problem	Solution
"NO DISC" is displayed.	<ul style="list-style-type: none"> ✓ Insert a disc. ✓ Check if the disc is inserted upside down. ✓ Wait until the moisture condensation at the lens has cleared. ✓ Replace or clean the disc, see "Maintenance". ✓ Use a finalized CD-RW or a correct MP3-CD format disc.
Radio reception is poor.	<ul style="list-style-type: none"> ✓ If the signal is too weak, adjust the antenna or connect an external antenna for better reception. ✓ Increase the distance between the Mini HiFi System and your TV or VCR.
The system does not react when buttons are pressed.	<ul style="list-style-type: none"> ✓ Remove and reconnect the AC power plug and switch on the system again.
Sound cannot be heard or is of poor quality.	<ul style="list-style-type: none"> ✓ Adjust the volume. ✓ Disconnect the headphones. ✓ Check that the speakers are connected correctly. ✓ Check if the stripped speaker wire is clamped. ✓ Make sure the MP3-CD was recorded within 32-256 kbps bit rate with sampling frequencies at 48 kHz, 44.1 kHz or 32 kHz.
The left and right sound outputs are reversed.	<ul style="list-style-type: none"> ✓ Check the speaker connections and location.

Problem	Solution
The remote control does not function properly.	<ul style="list-style-type: none"> ✓ Select the source (CD or FM, for example) before pressing the function button (▶, ◀, ▶). ✓ Reduce the distance between the remote control and the system. ✓ Insert the batteries with their polarities (+/- signs) aligned as indicated. ✓ Replace the batteries. ✓ Point the remote control directly towards the IR sensor.
The time is not working.	<ul style="list-style-type: none"> ✓ Set the clock correctly. ✓ Press TIMER ON/OFF to switch on the timer. ✓ If recording or tape dubbing is in progress, stop recording.
The Clock/Timer setting is erased.	<ul style="list-style-type: none"> ✓ Power has been interrupted or the power cord has been disconnected. Reset the clock/timer.
The USB device doesn't play on my MCM177	<ul style="list-style-type: none"> ✓ It is not set in the USB mode. Select USB mode. ✓ The device is not securely connected to MCM177's USB port. Re-connect the device, and make sure that the device is powered on. ✓ The device is not supported by MCM177, or the audio file format stored on the device is not supported by MCM177. Use a compatible device/ playable audio file format.

Meet Philips at the Internet
<http://www.philips.com>

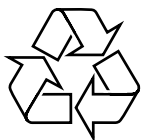

MCM177

