

3 Enjoy

Start disc play

- 1 Insert a disc with its label facing out.

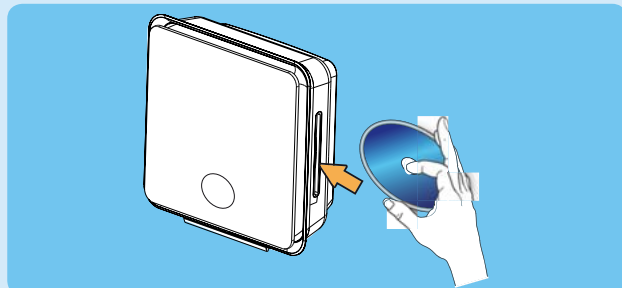

- 2 Disc play starts. If not, touch the ►|| symbol on the screen.

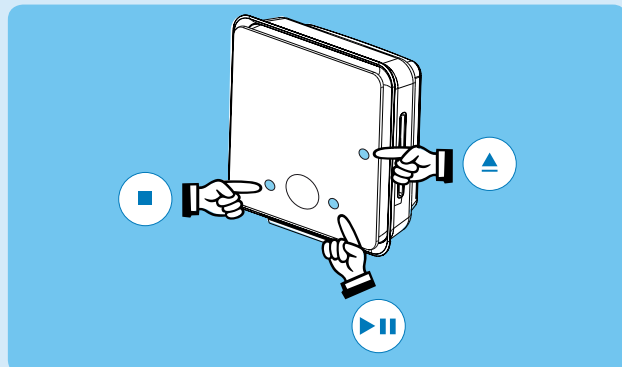

- Control buttons on the main unit are operated through touch screen display.
- If the disc menu is displayed on the TV, use cursor buttons on the remote control to select an option in the menu, then press **OK**.
- 3 Press ■ to stop play.
- 4 Press ▲ to eject the disc.

Note When you press ►||, playback resumes from where it was last stopped. To start playback from the beginning, press ◀ while the message is displayed.

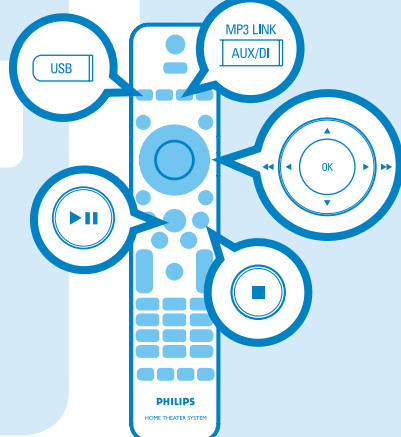

Play other supported devices

USB device

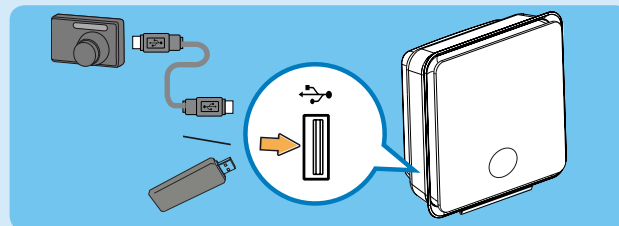

- 1 Insert your USB device to (USB) socket.
- 2 Press **USB** to switch to 'USB' mode.
- 3 Select a file to play, then press ►||.
- 4 To stop play, press ■ or remove the USB device.

Other portable media player

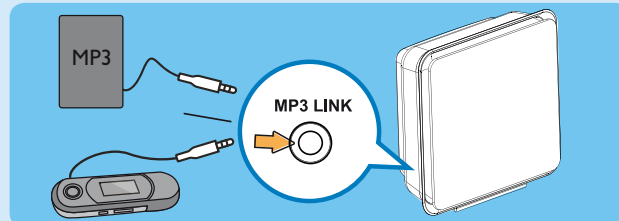

- 1 Connect a 3.5mm stereo audio cable (supplied) from the MP3 LINK socket to the headphone output socket on your portable media player.
- 2 Press **AUX/DI/MP3 LINK** repeatedly until 'MP3 LINK' is displayed.
- 3 Press **PLAY** on your portable media player.

Need help?

User Manual
See the user manual that came with your Philips DVD Home Theatre System.

Be responsible
Respect copyrights



2008 © Philips Consumer Lifestyle
All rights reserved.
I2nc: 3139 245 30971
sgpip_832/ap-eng

Register your product and get support at
www.philips.com/welcome

HTS9810



- 1 Connect
- 2 Set up
- 3 Enjoy

Quick Start Guide

What's in the box?



PHILIPS

1 Connect

Basic connection

A Placement

Proper speakers system placement is important to ensure optimum sound performance.

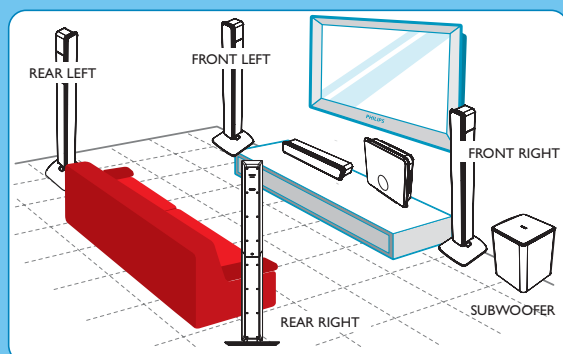

B Connect to TV

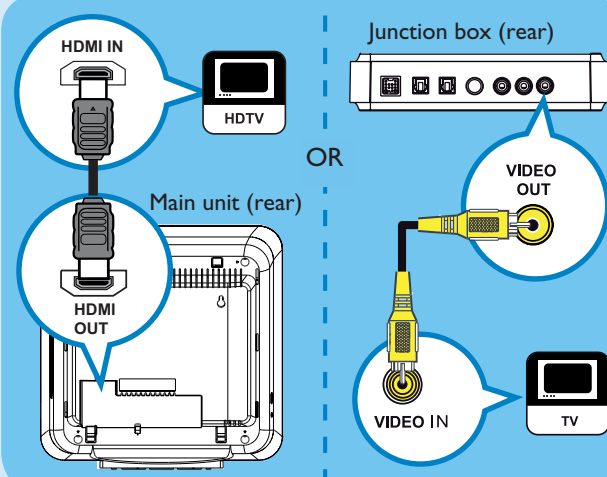

If your TV supports HDMI

- 1 Remove the main unit cover by pushing it upwards and outwards.
- 2 Connect the HDMI cable from the HDMI OUT socket to the HDMI IN socket on your TV.

Note HDMI connection does not support audio output from your TV to this unit, a separate audio connection is required.

If your TV supports composite video

- 1 Connect a composite video cable from the VIDEO OUT socket on the junction box to the VIDEO IN socket on your TV.

Note Refer to the accompanying user manual for other possible video connections.

C Connect speakers

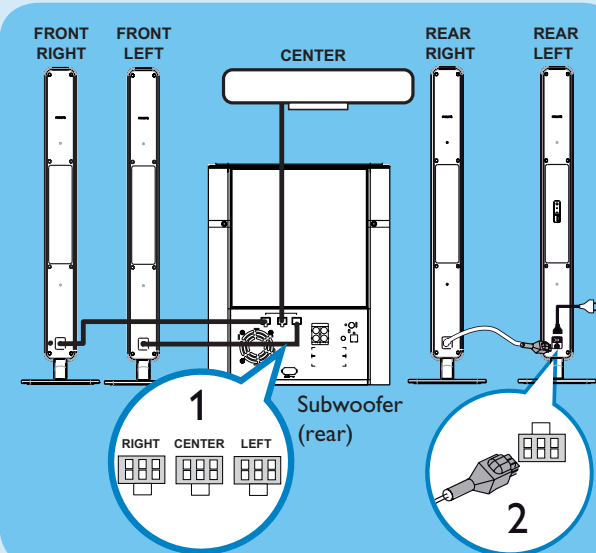

- 1 Connect the FRONT LEFT, FRONT RIGHT and CENTER speakers to the matching sockets on the subwoofer.
- 2 Connect the REAR RIGHT speaker cable to the REAR LEFT speaker socket, then connect the power cable to the AC power outlet.

D Connect main unit, junction box and subwoofer

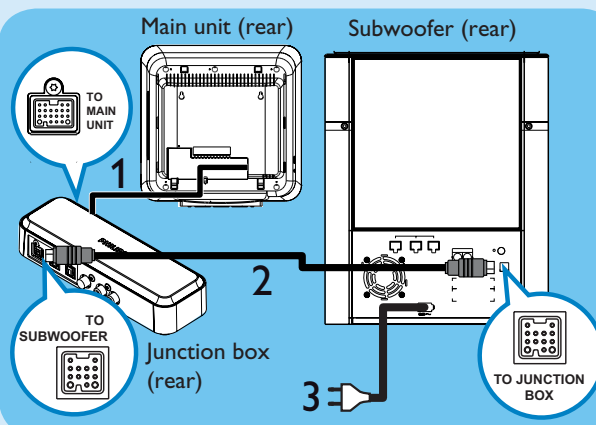

- 1 Unwind the DC cable from the main unit and connect it to the TO MAIN UNIT on the junction box.
- 2 Connect interconnect cable between TO SUBWOOFER socket on the junction box and TO JUNCTION BOX socket on the subwoofer.
- 3 Connect the power cable from subwoofer to the AC power outlet.

2 Set up

A Find the viewing channel

- 1 Press to turn on this DVD Home Theatre unit.
- 2 Turn on the TV. Use the TV's remote control to select the correct viewing channel.

Note To search for the correct viewing channel, press the Channel Down button on the TV's remote control repeatedly (or AV, SELECT, button) until you see the Video In channel.

B Start Ambisound setup

When you turn on this DVD Home Theatre unit for the first time, follow the instructions on the TV to complete the setup.

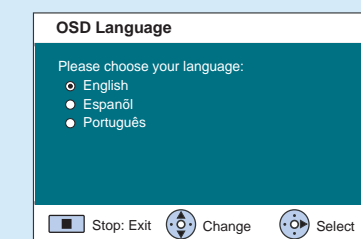

- 1 Select a language for on-screen display, then press .
- 2 [Welcome] message is displayed, press to continue.
- 3 [Room Acoustics] message is displayed, select the type of walls that surround your room, then press to select.
- 4 [Rear Speaker Placement] message is displayed, select the placement of the rear speakers in your room, then press to select.
- 5 When [Complete] screen is displayed, press to exit.

Note Refer to the accompanying user manual for other setup options.

Optional connection

A Connect audio output from TV (for EasyLink control)

To hear the TV audio through this DVD Home Theatre unit, connect an audio cable (not supplied) from the AUDIO IN-AUX1 sockets to the AUDIO OUT sockets on your TV.

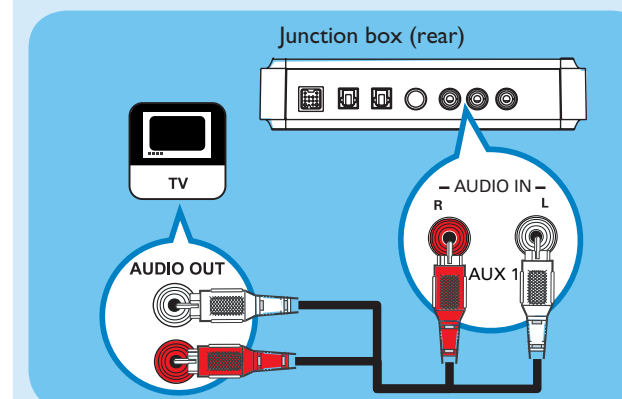

Note To listen to the audio output from this connection, press **AUX/DI/MP3 LINK** repeatedly until 'AUX1 INPUT' is displayed on the display panel.

B Connect radio antenna

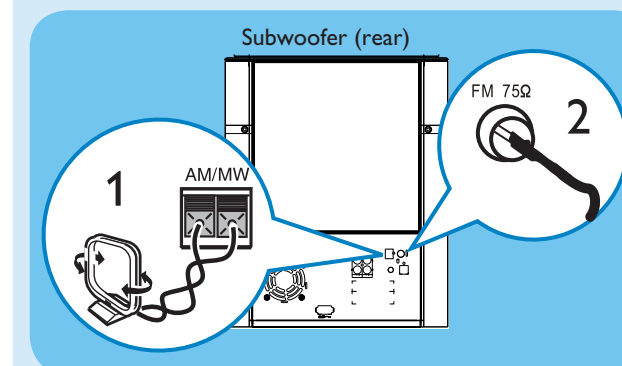

- 1 Connect the AM/MW loop antenna to the AM/MW socket. Place it on a shelf, or attach it to a stand or wall.
- 2 Connect the FM antenna to the inner pin of the FM 75 Ω socket (for some models, it has been connected in the factory). Extend the wire for optimum reception.