

Always there to help you

Register your product and get support at
www.philips.com/welcome

ORD2105



User manual

PHILIPS

Contents

1	Safety	3
	Important Safety Instructions	3
2	Your clock radio	5
	Introduction	5
	What's in the box	5
3	Get started	6
	Connect power	6
	Set the clock	6
	Adjust brightness	7
4	Use the alarm timer	8
	Set an alarm	8
	Activate/deactivate the alarm timer	8
	Snooze the alarm	8
	Stop the alarm	8
5	Use the dock	9
	Compatible iPod/iPhone models	9
	Enjoy audio	9
6	Listen to radio	10
7	Play from an external device	11
8	Use the sleep timer	12
9	Adjust volume	13
10	Product information	14
	General information	14
	Tuner (FM)	14
	Amplifier	14
11	Troubleshooting	15
12	Notice	16
	Compliance	16
	Care of the environment	16
	Trademark notice	16
	Copyright	

Register online at www.philips.com/welcome today to
get the very most from your purchase.

Registering your model with PHILIPS makes you eligible for all of the valuable benefits listed below, so don't miss out. Register online at www.philips.com/welcome to ensure:

*Product Safety Notification

By registering your product, you'll receive notification - directly from the manufacturer.

*Additional Benefits

Registering your product guarantees that you'll receive all of the privileges to which you're entitled, including special money-saving offers.

PHILIPS

*Congratulations on your purchase,
and welcome to the "family!"*

Dear PHILIPS product owner:

Thank you for your confidence in PHILIPS. You've selected one of the best-built, best-backed products available today. We'll do everything in our power to keep you happy with your purchase for many years to come.

As a member of the PHILIPS "family," you're entitled to protection by one of the most comprehensive warranties in the industry. What's more, your purchase guarantees you'll receive all the information and special offers for which you qualify, plus easy access to accessories from our convenient home shopping network.

Most importantly, you can count on our uncompromising commitment to your total satisfaction.

All of this is our way of saying welcome - and thanks for investing in a PHILIPS product.

P.S. To get the most from your PHILIPS purchase, be sure to register online at:

www.philips.com/welcome

Know these
safety symbols



 This "bolt of lightning" indicates uninsulated material within your unit may cause an electrical shock. For the safety of everyone in your household, please do not remove product covering.

 The "exclamation point" calls attention to features for which you should read the enclosed literature closely to prevent operating and maintenance problems.

WARNING: To reduce the risk of fire or electric shock, this apparatus should not be exposed to rain or moisture and objects filled with liquids, such as vases, should not be placed on this apparatus.

CAUTION: To prevent electric shock, match wide blade of plug to wide slot, fully insert.

ATTENTION: Pour éviter les chocs électriques, introduire la lame la plus large de la fiche dans la borne correspondante de la prise et pousser jusqu'au fond.

For Customer Use

Enter below the Serial No. which is located on the rear of the cabinet. Retain this information for future reference.

Model No. _____

Serial No. _____

PHILIPS

Visit our World Wide Web Site at <http://www.philips.com/welcome>

1 Safety

Read and understand all instructions before you use this product. If damage is caused by failure to follow the instructions, the warranty does not apply.



This 'bolt of lightning' indicates uninsulated material within your unit may cause an electrical shock. For the safety of everyone in your household, please do not remove product covering.

The 'exclamation point' calls attention to features for which you should read the enclosed literature closely to prevent operating and maintenance problems.

WARNING: To reduce the risk of fire or electric shock, this apparatus should not be exposed to rain or moisture and objects filled with liquids, such as vases, should not be placed on this apparatus.

CAUTION: To prevent electric shock, match wide blade of plug to wide slot, fully insert.

Important Safety Instructions

- 1 Read these instructions.
- 2 Keep these instructions.
- 3 Heed all warnings.
- 4 Follow all instructions.
- 5 Do not use this apparatus near water.
- 6 Clean only with dry cloth.

- 7 Do not block any ventilation openings. Install in accordance with the manufacturer's instructions.
- 8 Do not install near any heat sources such as radiators, heat registers, stoves, or other apparatus (including amplifiers) that produce heat.
- 9 Protect the power cord from being walked on or pinched, particularly at plugs, convenience receptacles, and the point where they exit from the apparatus.
- 10 Only use attachments/accessories specified by the manufacturer.
- 11 Use only with the cart, stand, tripod, bracket, or table specified by the manufacturer or sold with the apparatus. When a cart is used, use caution when moving the cart/apparatus combination to avoid injury from tip-over.



- 12 Unplug this apparatus during lightning storms or when unused for long periods of time.
- 13 Refer all servicing to qualified service personnel. Servicing is required when the apparatus has been damaged in any way, such as power-supply cord or plug is damaged, liquid has been spilled or objects have fallen into the apparatus, the apparatus has been exposed to rain or moisture, does not operate normally, or has been dropped.
- 14 Apparatus shall not be exposed to dripping or splashing.
- 15 Do not place any sources of danger on the apparatus (e.g. liquid filled objects, lighted candles).

- ⑩ This product may contain lead and mercury. Disposal of these materials may be regulated due to environmental considerations. For disposal or recycling information, please contact your local authorities or the Electronic Industries Alliance: www.eiae.org.
- ⑪ Where the plug of the Direct Plug-in Adapter is used as the disconnect device, the disconnect device shall remain readily operable.



Warning

- Never remove the casing of this apparatus.
- Never lubricate any part of this apparatus.
- Never place this apparatus on other electrical equipment.
- Ensure that you always have easy access to the power cord, plug or adaptor to disconnect this apparatus from the power.

Risk of overheating! Never install this apparatus in a confined space. Always leave a space of at least four inches around this apparatus for ventilation. Ensure curtains or other objects never cover the ventilation slots on this apparatus.



Note

- The rated input voltage and current is printed on the power adaptor. The model number and serial number are printed on the bottom of the main unit.

2 Your clock radio

Congratulations on your purchase, and welcome to Philips! To fully benefit from the support that Philips offers, register your product at www.philips.com/welcome.

Introduction

With this product, you can:

- enjoy audio from an iPod/iPhone or external device,
- charge your iPod/iPhone,
- listen to FM radio stations, and
- gently wake up to different alarm sources.

What's in the box

Check and identify the contents of the package:

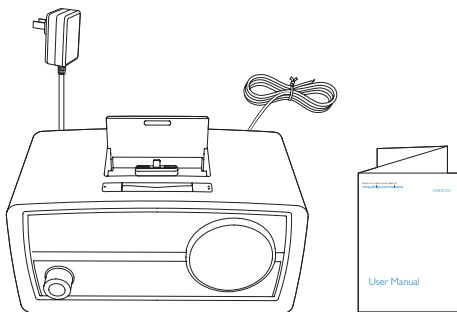

3 Get started

Always follow the instructions in this chapter in sequence.

Connect power

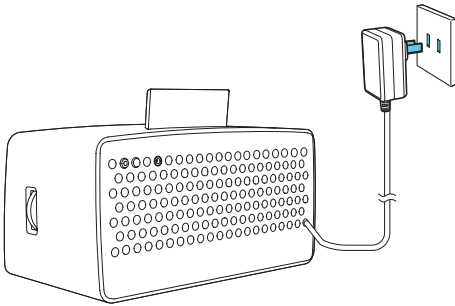

Connect the power adaptor to the AC power outlet.

- ↳ The product is switched to standby mode with the clock (if set) displayed.
- To select a source or switch the product back to standby mode, press the knob repeatedly.
- If no audio input is transferred from the iPod/iPhone or external device over 15 minutes, the product switches to standby mode automatically.

Set the clock

Note

- To manually set the clock, switch the product to standby mode first.

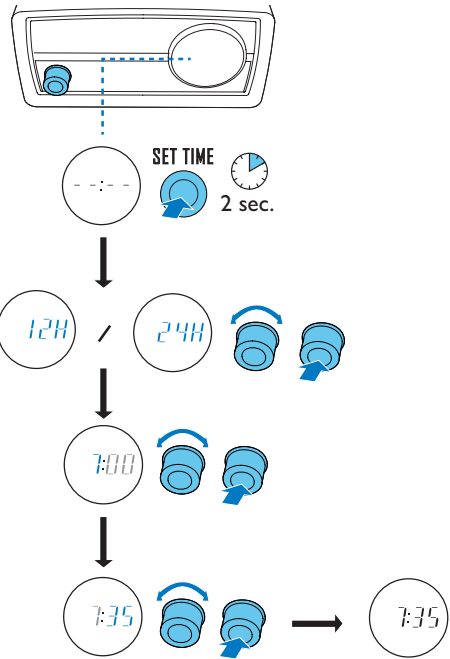

- 1 In standby mode, press and hold **SET TIME** on the back of the product for two seconds.
↳ **[12H]** (12-hour time format) or **[24H]** (24-hour time format) begins to blink.
- 2 Rotate the knob to select a time format, and then press the knob to confirm.
↳ The hour digits begin to blink.
- 3 Rotate the knob to set the hour, and then press the knob to confirm.
↳ The minute digits begin to blink.
- 4 Rotate the knob to set the minute, and then press the knob to confirm.
↳ The set clock is displayed.

Tip

- The product synchronizes its clock with iPod/iPhone automatically when the iPod/iPhone is docked and recognized.

Adjust brightness

Press **BRIGHTNESS** repeatedly to adjust the brightness of the display panel: high, medium, or low.



4 Use the alarm timer

Set an alarm

Note

- Make sure that you have set the clock correctly.

You can set two alarms.

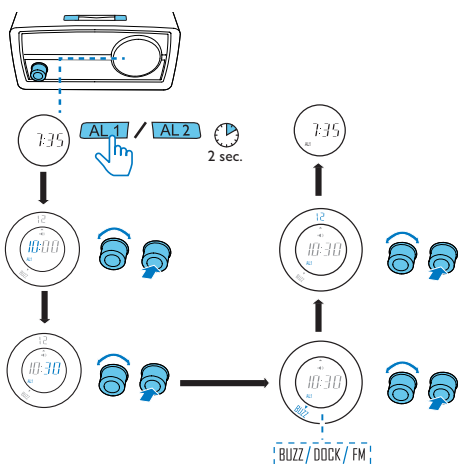

- 1 Press and hold **AL1/AL2** for more than two seconds to activate alarm setting mode.
 - ↳ The current alarm time (if set) is displayed.
 - ↳ The hour digits and alarm icon begin to blink.
- 2 Rotate the knob to set the hour.
- 3 Press the knob to confirm.
 - ↳ The minute digits blink.
- 4 Repeat steps 2-3 to set the minute, select an alarm source (**[BUZZ]**, **[DOCK]** or **[FM]**), and adjust the alarm volume.
 - ↳ The corresponding alarm icon lights up.

Note

- If iPod/iPhone is selected as alarm source, but no iPod/iPhone is connected, the device switches to buzzer instead.
- The gentle wake-up function is available for **[DOCK]** and **[FM]** source.

Activate/deactivate the alarm timer

- 1 Press **AL1** (or **AL2**) to view alarm settings.
- 2 Press **AL1** (or **AL2**) repeatedly to select **[ON]** or **[OFF]**.
 - **[ON]**: The alarm timer is activated.
 - **[OFF]**: The alarm timer is deactivated.
 - ↳ **AL1** (or **AL2**) is displayed when the alarm timer is activated.
 - ↳ **AL1** (or **AL2**) disappears when the alarm timer is deactivated.

Snooze the alarm

- When an alarm sounds, press **SNOOZE**.
 - ↳ The alarm repeats after 9 minutes.

Stop the alarm

- When an alarm sounds, press **AL1** (or **AL2**).
 - ↳ The alarm stops and then repeats at the same time of next day.

5 Use the dock

You can enjoy audio from a compatible iPod/iPhone through this product.

Compatible iPod/iPhone models

The product supports the following iPod and iPhone models.

Made for

- iPod touch (5th generation)
- iPod nano (7th generation)
- iPhone 5

Enjoy audio

- 1 Press the knob repeatedly to select [DOCK] mode.

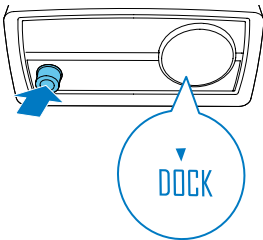

- 2 Connect your iPod/iPhone to the dock.

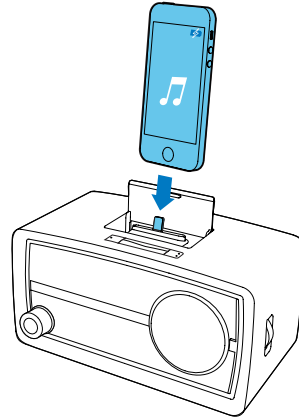

↳ The docked iPod/iPhone begins to charge automatically.

- 3 Play audio on the iPod/iPhone.

6 Listen to radio

Note

- Keep the unit away from other electronic devices to avoid radio interference.
- For better reception, do not place iPod/iPhone into the dock when you listen to the radio. Fully extend and adjust the position of the FM antenna.

- 1 Press the knob repeatedly to switch the source to **[FM]**.
- 2 Search for a radio station manually or automatically.

To search for a radio station manually:

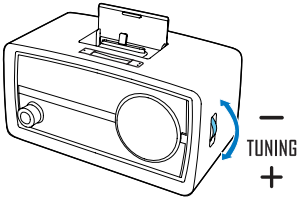

- Rotate **TUNING** until the frequency of target station is displayed.

To search for a radio station automatically:

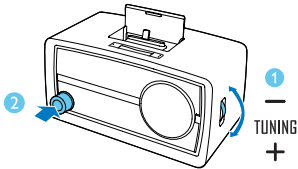

- Rotate **TUNING** and then press the knob within two seconds.
 - ↳ The radio tunes to a station with strong signals automatically.

7 Play from an external device

Note

- The product switches to **AUX** mode automatically when an audio input cable is connected.

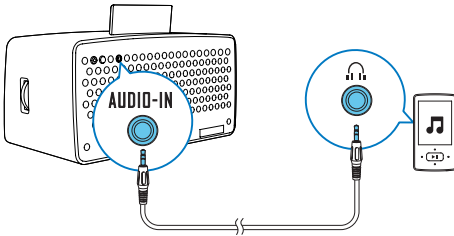

- 1 Connect an audio input cable with a 3.5-mm connector on both ends between
 - the **AUDIO IN** socket on the back of this product, and
 - the headphone socket of an external device.
- 2 Play audio on the external device (see the user manual of the device).

8 Use the sleep timer

Press **SLEEP** on the back of the product repeatedly to select a time period (in minutes).

- ↳ When the sleep timer is activated, **zZ** appears.
- ↳ After the set period, the product switches to standby mode.
- To deactivate the sleep timer, press **SLEEP** repeatedly until **[OFF]** (off) appears.

15 → 30 → 60 → 90 → 120



9 Adjust volume

During play, rotate the knob to adjust volume.



Note

- When an alarm sounds, you cannot adjust volume.

10 Product information



Note

- Product information is subject to change without prior notice.

Amplifier

Rated Output Power	4 W RMS
Signal to Noise Ratio	> 67 dBA
Total Harmonic Distortion	< 1%
Audio In (MP3 link)	0.6 V RMS 20 kohm

General information

AC power adaptor	Model No.: OH-1015A0592000U1-UL Brand name: Philips Input: 100-240 V~, 50/60Hz, 350 mA; Output: 5.9V \approx 2 A
Operation Power Consumption	12 W
Standby Power Consumption	< 2 W
Dimensions: - Main Unit (W x H x D)	245 x 123 x 122 mm
Weight: - Main Unit	1.1 kg

Tuner (FM)

Tuning range	87.5 - 108 MHz
Tuning grid	100 kHz
Sensitivity - Mono, 26 dB S/N Ratio - Stereo, 46 dB S/N Ratio	< 22 dBu < 43 dBu
Search Selectivity	> 28 dBf
Total Harmonic Distortion	< 2%
Signal to Noise Ratio	> 55 dB

11 Troubleshooting



Warning

- Never remove the casing of this device.

To keep the warranty valid, never try to repair the system yourself.

If you encounter problems when using this device, check the following points before requesting service. If the problem remains unsolved, go to the Philips Web page (www.philips.com/support). When you contact the Consumer Care, make sure that the product is nearby and the model number and serial number are available.

No power

- Ensure that the AC power plug of the unit is connected properly.
- Ensure that there is power at the AC outlet.

No sound

- Adjust the volume.

Poor radio reception

- Increase the distance between the unit and your TV or VCR.
- Fully extend the FM antenna.

Alarm does not work

- Set the clock/alarm correctly.

Clock/alarm setting erased

- Power has been interrupted or the power plug has been disconnected.
- Reset the clock/alarm.

12 Notice

Any changes or modifications made to this device that are not expressly approved by WOOX Innovations may void the user's authority to operate the equipment.

Compliance

Class II equipment symbol:



CLASS II apparatus with double insulation, and no protective earth provided.

This Class B digital apparatus complies with Canadian ICES-003.

This device complies with Part 15 of the FCC Rules. Operation is subject to the following two conditions:

- This device may not cause harmful interference, and
- This device must accept any interference received, including interference that may cause undesired operation.

This equipment has been tested and found to comply with the limits for a Class B digital device, pursuant to part 15 of the FCC Rules.

These limits are designed to provide reasonable protection against harmful interference in a residential installation. This equipment generates, uses, and can radiate radio frequency energy and, if not installed and used in accordance with the instruction manual, may cause harmful interference to radio communications. However, there is no guarantee that interference will not occur in a particular installation. If this equipment does cause harmful interference to radio or television reception, which can be determined by turning the equipment off and on, the user is encouraged

to try to correct the interference by one or more of the following measures:

- Relocate the receiving antenna.
- Increase the separation between equipment and receiver.
- Connect the equipment into an outlet on a circuit different from that to which the receiver is connected.
- Consult the dealer or an experienced radio/TV technician for help.

Care of the environment

Your product is designed and manufactured with high quality materials and components, which can be recycled and reused. Never dispose of your product with other household waste. Please inform yourself about the local rules on the separate collection of electrical and electronic products. The correct disposal of these products helps prevent potentially negative consequences on the environment and human health. Please visit www.recycle.philips.com for additional information on a recycling center in your area.

Environmental information

All unnecessary packaging has been omitted. We have tried to make the packaging easy to separate into three materials: cardboard (box), polystyrene foam (buffer) and polyethylene (bags, protective foam sheet.)

Your system consists of materials which can be recycled and reused if disassembled by a specialized company. Please observe the local regulations regarding the disposal of packaging materials, exhausted batteries and old equipment.

Trademark notice



"Made for iPod" and "Made for iPhone" mean that an electronic accessory has been designed to connect specifically to iPod or iPhone respectively, and has been certified by the developer to meet Apple performance standards. Apple is not responsible for the operation of this device or its compliance with safety and regulatory standards. Please note that the use of this accessory with iPod or iPhone may affect wireless performance. iPod and iPhone are trademarks of Apple Inc., registered in the U.S. and other countries.

Copyright

2014 © WOOX Innovations Limited. All rights reserved.

Philips and the Philips' Shield Emblem are registered trademarks of Koninklijke Philips N.V. and are used by WOOX Innovations Limited under license from Koninklijke Philips N.V." Specifications are subject to change without notice. WOOX reserves the right to change products at any time without being obliged to adjust earlier supplies accordingly.

P&F USA Inc.
PO Box 2248
Alpharetta, GA 30023-2248
Phone 1 866 309 0845

Meet Philips at the Internet
<http://www.philips.com/welcome>



2014 © WOOX Innovations Limited. All rights reserved.
This product was brought to the market by WOOX Innovations Limited or one of its affiliates, further referred to in this document as WOOX Innovations, and is the manufacturer of the product. P&F is the warrantor in relation to the product with which this booklet was packaged. Philips and the Philips Shield Emblem are registered trademarks of Koninklijke Philips N.V.

ORD2105_37_UM_V2.0

