

Always there to help you

始终如一地为您提供帮助

Register your product and get support at
在以下网址注册您的产品并获得支持

www.philips.com/welcome

SBM120



Quick start guide 快速启用指南

PHILIPS

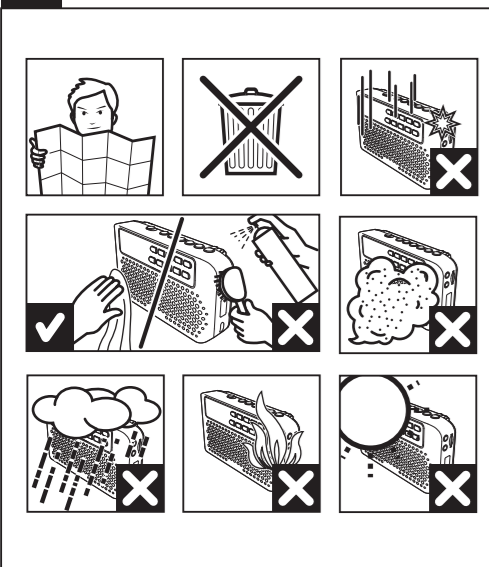

All registered and unregistered trademarks are property of their respective owners.
© 2012 Koninklijke Philips Electronics N.V.
All rights reserved.
SBM120_93_QSG_V1.0

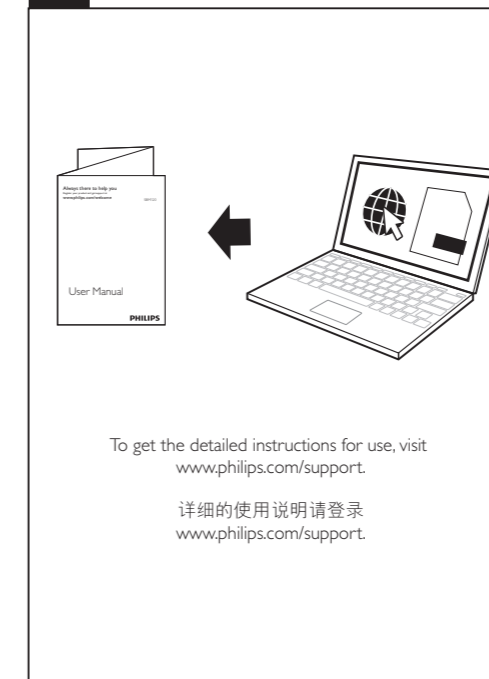
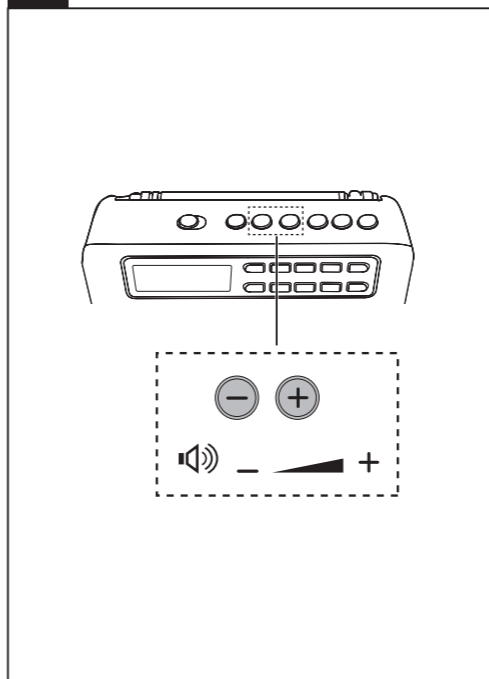
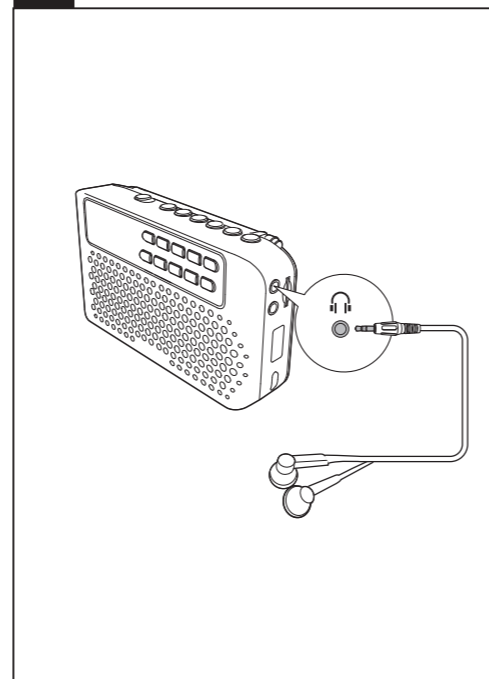
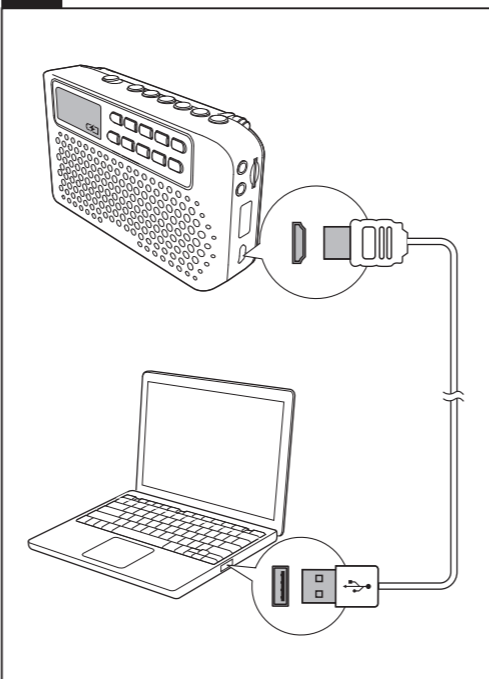
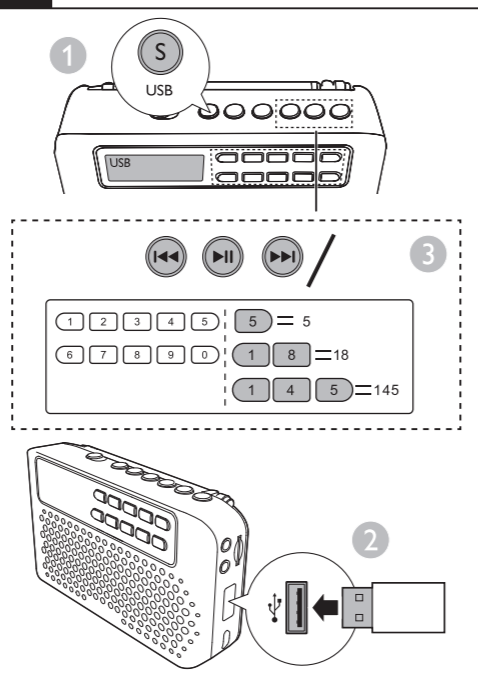
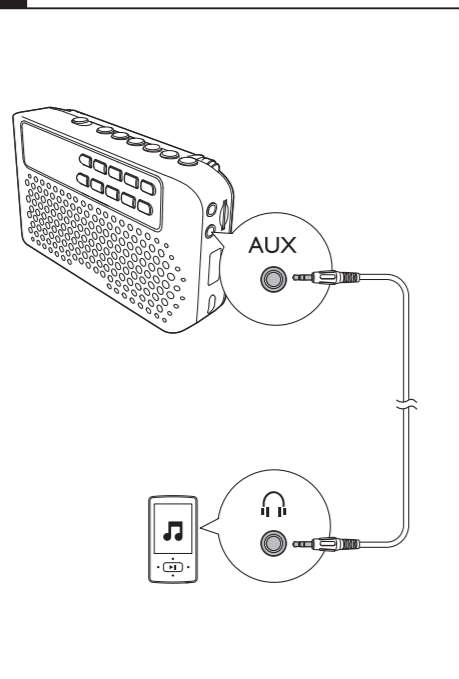
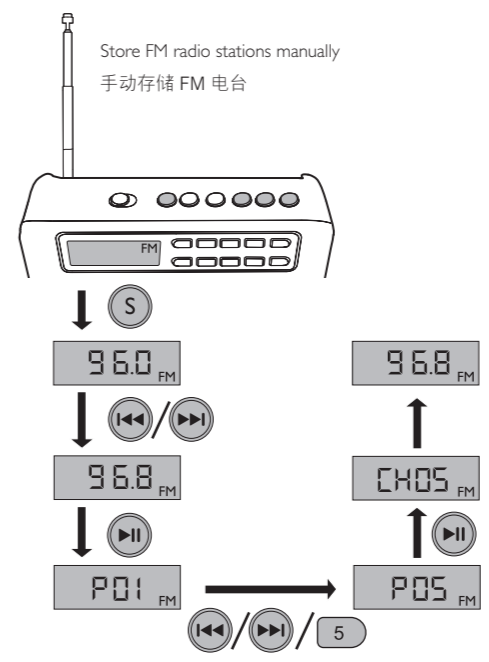
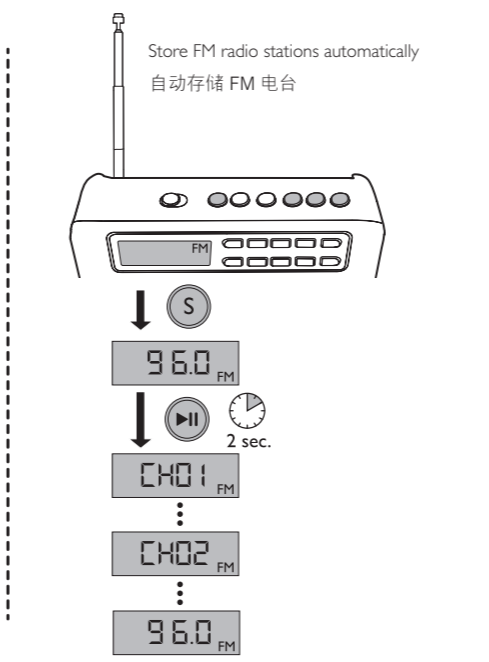
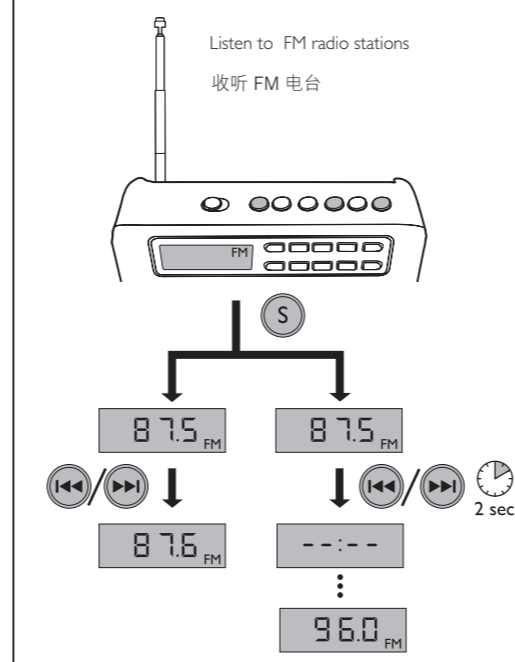
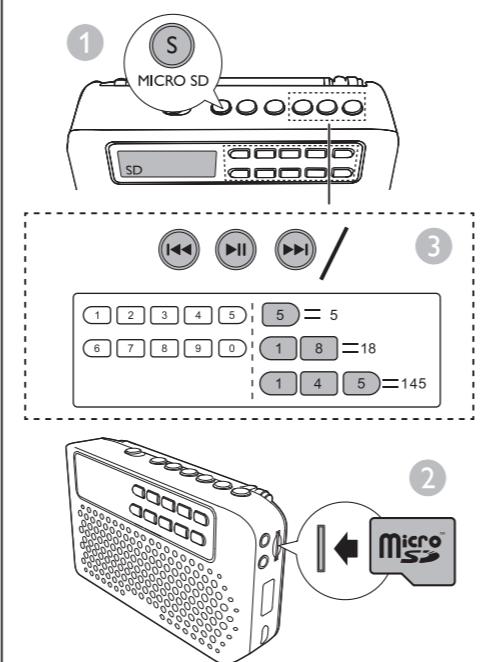
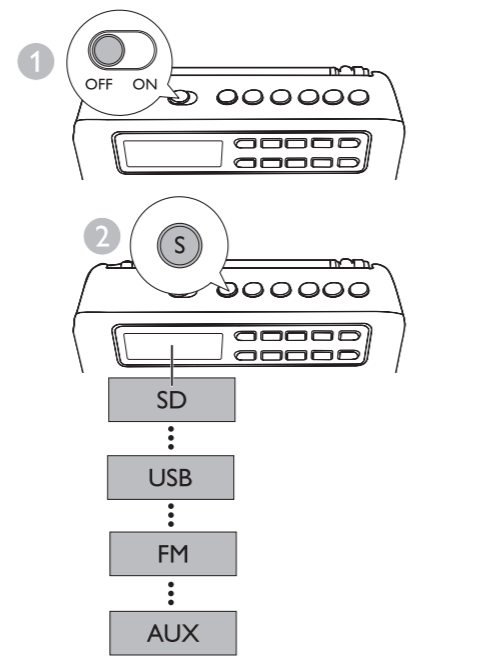
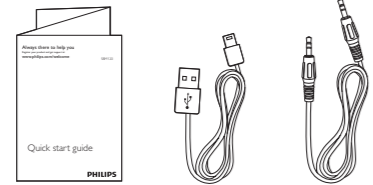
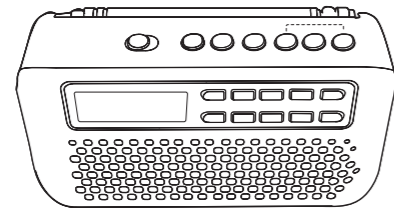

EN

1 Important

- Read these instructions.
- Heed all warnings.
- Follow all instructions.
- Do not use this apparatus near water.
- Do not install near any heat sources such as radiators, heat registers, stoves, or other apparatus (including amplifiers) that produce heat.
- Only use attachments/accessories specified by the manufacturer.
- Refer all servicing to qualified service personnel. Servicing is required when the apparatus has been damaged in any way, such as liquid has been spilled or objects have fallen into the apparatus, the apparatus has been exposed to rain or moisture, does not operate normally, or has been dropped.
- The battery shall not be exposed to excessive heat such as sunshine, fire or the like.
- Apparatus shall not be exposed to dripping or splashing.
- Do not place any sources of danger on the apparatus (e.g. liquid filled objects, lighted candles).
- The socket is used for connecting a USB device to play music, not for charging.

Hearing safety



Caution

- To prevent possible hearing damage, do not listen at high volume levels for long periods. Set the volume to a safe level. The louder the volume, the shorter is the safe listening time.

Be sure to observe the following guidelines when using your headphones.

- Listen at reasonable volumes for reasonable periods of time.
- Be careful not to adjust the volume continuously upwards as your hearing adapts.
- Do not turn up the volume so high that you can't hear what's around you.
- You should use caution or temporarily discontinue use in potentially hazardous situations.
- Excessive sound pressure from earphones and headphones can cause hearing loss.

Caution

- Removal of the built-in battery invalidates the warranty and may destroy the product.

Always bring your product to a professional to remove the built-in battery.

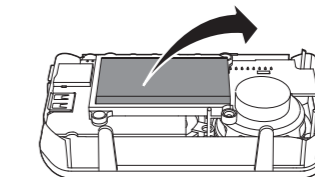

2 Notice

Any changes or modifications made to this device that are not expressly approved by Philips Consumer Lifestyle may void the user's authority to operate the equipment.

Disposal of your old product and batteries

Your product is designed and manufactured with high quality materials and components, which can be recycled and reused. Never dispose of your product with other household waste. Please inform yourself about the local rules on the separate collection of electrical and electronic products and batteries. The correct disposal of these products helps prevent potentially negative consequences on the environment and human health. Your product contains batteries, which cannot be disposed of with normal household waste. Please inform yourself about the local rules on separate collection of batteries. The correct disposal of batteries helps prevent potentially negative consequences on the environment and human health. Please visit www.recycle.philips.com for additional information on a recycling center in your area.

Environmental information

All unnecessary packaging has been omitted. We have tried to make the packaging easy to separate into three materials: cardboard (box), polystyrene foam (buffer) and polyethylene (bags, protective foam sheet). Your system consists of materials which can be recycled and reused if disassembled by a specialized company. Please observe the local regulations regarding the disposal of packaging materials, exhausted batteries and old equipment.

Note

- The type plate is located at the back of the apparatus.

3 Product information

Note

- Product information is subject to change without prior notice.

Specifications

Amplifier

Max Output Power	1.5 W
Signal to Noise Ratio	50 dBA
Aux Input	600mV RMS, 22 kohm

Tuner (FM)

Tuning Range	87.5-108 MHz
--------------	--------------

General information

Power Supply	5V \approx 0.6A
Built-in Battery	Lithium battery
Dimensions - Main Unit (W x H x D)	118 x 67 x 31 mm
Weight - Main Unit	0.15 kg

1 注意事项

- 阅读这些说明。
- 注意所有警告。
- 遵循所有说明。
- 不要在靠近水的地方使用本装置。
- 不要在任何热源附近安装，如散热器、蓄热器、炉具或其它发热设备（包括功放器）。
- 仅使用制造商指定的附件/配件。
- 所有维修应由合格的维修人员来执行。本装置有任何损坏时，如液体泼溅到或物体跌落到装置上，装置淋雨或受潮，无法正常运行，或者跌落，均需要进行维修。
- 不可将电池置于高温环境，如阳光直射处、明火或类似环境。
- 切勿将本装置置于漏水或溅水环境下。
- 不要将任何危险源放在本装置上（例如装有液体的物体、点燃的蜡烛）。
-  插孔仅用于连接U盘播放音乐，不能用于充电。

听力安全



！ 注意

- 为防止可能的听力受损，请勿长时间使用高音量收听。将音量设定至安全级别。音量越大，安全聆听的时间就越短。

使用耳机时请确保遵循以下准则。

- 在合理时间内以合理音量收听。
- 听力适应后，注意不要持续地调高音量。
- 请勿将音量调得太高，从而无法听见周围的声音。
- 在有潜在危险的情况下应谨慎使用或暂停使用。
- 耳机声压过大可导致听力受损。

！ 注意

- 拆卸内置电池将使保修失效，并可能损坏本产品。

务必让专业人员拆卸产品中的内置电池。

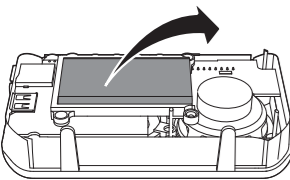

2 注意

如果用户未经 Philips 优质生活部门的明确许可而擅自对此设备进行更改或修改，则可能导致其无权操作此设备。

旧产品和电池的处理

本产品采用可回收利用的高性能材料和组件制造而成。

切勿将本产品与其它生活垃圾一起处理。请自行了解当地关于分类收集电子、电气产品及电池的规定。正确弃置这些产品有助于避免对环境和人体健康造成潜在的负面影响。本产品所含的电池不能与一般的生活垃圾一同弃置。请自行了解当地关于分类收集电池的规定。正确弃置电池有助于避免对环境和人类健康造成潜在的负面影响。关于您所在地区回收中心的更多信息，请访问 www.recycle.philips.com。

环境信息

已省去所有不必要的包装。我们努力使包装易于分为三种材料：纸板（盒）、泡沫塑料（缓冲物）和聚乙烯（袋、保护性泡沫片）。

您的系统包含可回收利用的材料（如果由专业公司拆卸）。请遵守当地有关包装材料、废电池和旧设备的处理的规定。

☰ 注

- 型号铭牌位于本设备的背部。

3 产品信息

☰ 注

- 产品信息如有更改，恕不另行通知。

部件名称 Name of the Parts	有毒有害物质或元素 Hazardous/toxic Substance					
	铅 (Pb, Lead)	汞 (Hg, Mercury)	镉 (Cd, cadmium)	六价铬(Chromium 6+)	多溴联苯 (PBB)	多溴二苯醚 (PBDE)
Housing 外壳	○	○	○	○	○	○
Loudspeakers 喇叭单元	○	○	○	○	○	○
PWBs 电路板组件	x	○	○	○	○	○
Accessories (cables) 附件（连接线）	x	○	○	○	○	○

○：表示该有毒有害物质在该部件所有均质材料中的含量均在SJ/T11363 - 2006 标准规定的限量要求以下。
○:Indicates that this toxic or hazardous substance contained in all of the homogeneous materials for this part is below the limit requirement in SJ/T11363 – 2006.

x：表示该有毒有害物质至少在该部件的某一均质材料中的含量超出SJ/T11363 – 2006 标准规定的限量要求。

X: Indicates that this toxic or hazardous substance contained in at least one of the homogeneous materials used for this part is above the limit requirement in SJ/T11363 - 2006.



环保使用期限 Environmental Protection Use Period

This logo refers to the period (10 years)

电子信息产品中含有的有毒有害物质或元素在正常使用的条件下不会发生外泄或突变，电子信息产品用户使用该电子信息产品不会对环境造成严重污染或对其人身、财产造成严重 损害的期限。

This logo refers to the period (10 years) during which the toxic or hazardous substances or elements contained in electronic information products will not leak or mutate so that the use of these [substances or elements] will not result in any severe environmental pollution, any bodily injury or damage to any assets.

规格

功放器

最大输出功率	1.5 瓦
信噪比	50 dBA
Aux 输入	600 毫伏 RMS, 22 千欧

调谐器 (FM)

调谐范围	87.5-108 兆赫
------	-------------

一般信息

电源	5 伏 \pm 0.6 安
内置电池	锂电池
尺寸 - 主装置 (宽 × 高 × 厚)	118 × 67 × 31 毫米
重量 - 主装置	0.15 千克

Service Service Service GUARANTEE

This guarantee card is valid in China.

This guarantee card should be retained by

The USER.

此保用卡在中国适用，用户请保留此卡。

This product is made of high quality material and great care has been taken in its manufacture. It is designed to give good performance provided it is properly operated and maintained.The product is sold subject to the understanding that if any defect in manufacture or material shall appear within 12 months from date of consumer sale, if any defect in main parts over 12 months, the warranty period is subject to country Consumer Law, Philips Consumer Lifestyle China Service will arrange for such defect to be rectified without charge under the following warranty items and conditions.
Warranty Terms and Conditions:

- The defect is not due to use of the product for other than domestic purposes, or an incorrect voltage, or use of improper accessories, or contrary to operating instructions, or to accidental damage (whether in transit or otherwise), misuse, neglect or inexpert repair, or incorrect installation, or accessories belonging to the product, transportation.
- Present this warranty card and sales invoice when demanding service from Philips authorized service centres;
- This guarantee card will be void if correction is made.
- This guarantee card is valid only when it is sealed by the dealer.

User's Name

用户姓名
Address :
地址
Tel. No :
电话
Post Code :
邮编

Model No :

型号
Serial No :
机身编号
Tel. No :
电话
Product Place :
产地

Company Seal :

购买商印章
Date of Purchase :
购买日期
Shop name and address :
购买商名称及地址
Tel. No/Post Code :
电话 / 邮编

Installation Registration 调试记录			
Purchase Date 购买日期	Installation Date 调试日期	Fix Content & Result 调试内容和结果	Technician 调试员
Remark: Fill in the table when install the set in the market 备注：在商场试机时，请将试机情况填写在表格内			



PHILIPS



No.

此产品是一件设计精良，有高品质元件制造之家庭电器，在正确使用及保养下应能正确地表现其优越性能。

自购买日期始，整机保修一年。关于主要部件保修期限，按照国家消法规定执行。

飞利浦优质生活服务部将按下列保用条例为持卡用户提供免费保修服务。

保用条例：

- 保用服务只限于一般正常使用下有效。一切人为损坏，例如接入不当电源，使用不当配件，不依说明书使用，因运输及其他意外而造成之损坏，非经本公司认可之维修和改装，错误使用或疏忽而造成损坏，不适当之安装或因天灾造成损坏等，保用服务立即失效。此保用服务并不包括附件， 辅助装置，运输费。
- 维修时请带上此卡及正本发票。
- 此卡若经涂改即作废。
- 此卡须经购买商号盖章为有效。
- 对不依照上述保用条例办理之用户，本公司对上述条例负解释权。

服务须知：

SERVICE INFORMATION:

For after-sales and maintenance service, please call service hot line 4008 800 008.

Any comments and enquiries during the service, please contact our Philips Consumer Lifestyle Service Offices.

Philips(China) Investment Co.,Ltd.

Consumer Care China Philips Consumer Lifestyle

Philips Innovation Campus Shanghai NO.1 Building, NO.10 ,Lane 888

Tian Lin Road Shanghai, P. R. C. 200233

Fax: +86 21 54452663

如需要此产品的售后服务，请拨打服务热线4008 800 008。

如在维修服务过程中有任何意见，

欢迎致函飞利浦优质生活服务办事处解决疑难。

飞利浦（中国）投资有限公司

飞利浦优质生活客户服务部

中国上海市田林路888弄10号 飞利浦创新科技园1号楼

邮政编码： 200233

传真： (021) 54452663

服务热线： 4008 800 008

(用户需承担本地通话费)

网址： //www.philips.com.cn



PHILIPS

Repair Registration 维修记录						
Claim Date 报修日期	Repair Date 修理日期	Defect Description 故障现象	Reason 故障原因	Fix Content 修理详情	Collection Date 取机日期	Technician 修理员

* Present this warranty card to register 修理时请出示此卡以便记录