

Register your product and get support at
www.philips.com/welcome

DCD322



EN	User manual	1	NL	Gebruiksaanwijzing	125
FR	Mode d'emploi	29	IT	Manuale utente	157
ES	Manual del usuario	61	SV	Användarhandbok	189
DE	Benutzerhandbuch	93	DA	Brugervejledning	217

PHILIPS

Italia

DICHIARAZIONE DI CONFORMITA'

Si dichiara che l'apparecchio DCD322 Philips risponde alle prescrizioni dell'art. 2 comma 1 del D.M. 28 Agosto 1995 n. 548.

Fatto a Eindhoven

Philips Consumer Electronics
Philips, Glaslaan 2
5616 JB Eindhoven, The Netherlands

Norge

Typeskilt finnes på apparatens underside.

Observer: Nettbryteren er sekundert innkoplet. Den innebygde nettdelen er derfor ikke frakoplet nettet så lenge apparatet er tilsluttet nettkontakten.

For å redusere faren for brann eller elektrisk støt, skal apparatet ikke utsettes for regn eller fuktighet.

Advarsel: Usynlig laserstråling ved åbning når sikkerhedsafbrydere er ude af funktion. Undgå utsættelse for stråling.

Bemærk: Netafbryderen er sekundært indkoblet og afbryder ikke strømmen fra nettet. Den indbyggede netdel er derfor tilsluttet til lysnettet så længe netstikket sidder i stikkontakten.

Luokan 1 laserlaite Varoitus!

Laitteen käyttäminen muulla kuin tässä käyttöohjeessa mainitulla tavalla saattaa altistaa käyttäjän turvallisuusluokan 1 ylittävälle näkymättömälle lasersäteilylle.

Oikeus muutoksiin varataan. Laite ei saa olla alttiina tippu- ja roiskevedelle. Huom. Toiminnanvalitsin on kytketty toisipuolelle, eikä se kytke laitetta irti sähköverkosta. Sisäänrakennettu verkkoosa on kytkettyä sähköverkkoon aina silloin, kun pistoke on pistorasiassa.

Huom. Toiminnanvalitsin on kytketty toisipuolelle, eikä se kytke laitetta irti sähköverkosta. Sisäänrakennettu verkko-osa on kytkettyä sähköverkkoon aina silloin, kun pistoke on pistorasiassa.

Contents

1 Important	2
Safety	2
Notice	3

2 Your DVD Micro Theater	5
Introduction	5
What's in the box	5
Overview of the main unit	6
Overview of the remote control	7

3 Connect	8
Place the unit	8
Connect speakers	8
Connect FM antenna	9
Connect audio cables	9
Connect video cables	10
Connect an external audio device (optional)	11
Connect power	12

4 Get started	12
Prepare the remote control	12
Turn on	13
Store radio stations automatically	13
Set clock	13
Adjust brightness of display panel	13
Find the correct viewing channel	13
Select the correct TV system	14
Change system menu language	14
Turn on Progressive Scan	14

5 Play	15
Play a disc	15
Play from USB or recored discs	15
Play control	16
Play options	17
Picture view options	18

6 Play iPhone/iPod	18
Compatible iPod/iPhone	18
Load the iPhone/iPod	18
Listen to the iPhone/iPod	19
Charge the iPhone/iPod	19
Remove the iPhone/iPod	19

7 Listen to radio	19
Tune to a radio station	19
Program radio stations automatically	19
Program radio stations manually	20
Tune to a preset radio station	20
Show RDS information	20

8 Adjust sound	21
Adjust volume level	21
Select a sound effect	21
Mute sound	21

9 Adjust settings	21
General setup	21
Audio setup	21
Video setup	22
Preferences	22

10 Other features	23
Activate demonstration mode	23
Set alarm timer	23
Set the sleep timer	24
Listen to an audio device	24
Listen through headphone	24

11 Product information	24
Specifications	24
Supported disc formats	25
USB playability information	26
RDS program types	26

12 Troubleshooting	27
---------------------------	----

1 Important

Safety

Know these safety symbols

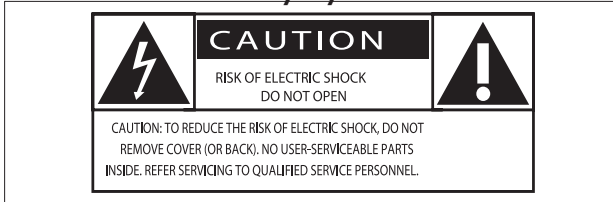

This 'bolt of lightning' indicates uninsulated material within your unit may cause an electrical shock. For the safety of everyone in your household, please do not remove product covering.

The 'exclamation point' calls attention to features for which you should read the enclosed literature closely to prevent operating and maintenance problems.

WARNING: To reduce the risk of fire or electric shock, this apparatus should not be exposed to rain or moisture and objects filled with liquids, such as vases, should not be placed on this apparatus.

CAUTION: To prevent electric shock, match wide blade of plug to wide slot, fully insert.

Important Safety Instructions

- ① Read these instructions.
- ② Keep these instructions.
- ③ Heed all warnings.
- ④ Follow all instructions.
- ⑤ Do not use this apparatus near water.
- ⑥ Clean only with dry cloth.
- ⑦ Do not block any ventilation openings. Install in accordance with the manufacturer's instructions.
- ⑧ Do not install near any heat sources such as radiators, heat registers, stoves,

or other apparatus (including amplifiers) that produce heat.

- ⑨ Protect the power cord from being walked on or pinched, particularly at plugs, convenience receptacles, and the point where they exit from the apparatus.
- ⑩ Only use attachments/accessories specified by the manufacturer.
- ⑪ Use only with the cart, stand, tripod, bracket, or table specified by the manufacturer or sold with the apparatus. When a cart is used, use caution when moving the cart/apparatus combination to avoid injury from tip-over.



- ⑫ Unplug this apparatus during lightning storms or when unused for long periods of time.
- ⑬ Refer all servicing to qualified service personnel. Servicing is required when the apparatus has been damaged in any way, such as power-supply cord or plug is damaged, liquid has been spilled or objects have fallen into the apparatus, the apparatus has been exposed to rain or moisture, does not operate normally, or has been dropped.
- ⑭ **Battery usage CAUTION** – To prevent battery leakage which may result in bodily injury, property damage, or damage to the unit:
 - Install all batteries correctly, + and - as marked on the unit.
 - Do not mix batteries (old and new or carbon and alkaline, etc.).
 - Remove batteries when the unit is not used for a long time.
- ⑮ Apparatus shall not be exposed to dripping or splashing.
- ⑯ Do not place any sources of danger on the apparatus (e.g. liquid filled objects, lighted candles).

- ⑰ **Where the MAINS plug or an appliance coupler is used as the disconnect device, the disconnect device shall remain readily operable.**

Risk of overheating! Never install this apparatus in a confined space. Always leave a space of at least four inches around this apparatus for ventilation. Ensure curtains or other objects never cover the ventilation slots on this apparatus.



Caution

- Use of controls or adjustments or performance of procedures other than herein may result in hazardous radiation exposure or other unsafe operation.



Warning

- Never remove the casing of this unit.
- Never lubricate any part of this unit.
- Place this unit on a flat, hard and stable surface.
- Never place this unit on other electrical equipment.
- Only use this unit indoors. Keep this unit away from water, moisture and liquid-filled objects.
- Keep this unit away from direct sunlight, naked flames or heat.
- Never look into the laser beam inside the unit.

Hearing safety

Listen at a moderate volume.

- Using headphones at a high volume can impair your hearing. This product can produce sounds in decibel ranges that may cause hearing loss for a normal person, even for exposure less than a minute. The higher decibel ranges are offered for those that may have already experienced some hearing loss.
- Sound can be deceiving. Over time your hearing 'comfort level' adapts to higher volumes of sound. So after prolonged listening, what sounds 'normal' can actually be loud and harmful to your hearing. To guard against this, set your volume to a safe level before your hearing adapts and leave it there.

To establish a safe volume level:

- Set your volume control at a low setting.
- Slowly increase the sound until you can hear it comfortably and clearly, without distortion.

Listen for reasonable periods of time:

- Prolonged exposure to sound, even at normally 'safe' levels, can also cause hearing loss.
- Be sure to use your equipment reasonably and take appropriate breaks.

Be sure to observe the following guidelines when using your headphones.

- Listen at reasonable volumes for reasonable periods of time.
- Be careful not to adjust the volume as your hearing adapts.
- Do not turn up the volume so high that you can't hear what's around you.
- You should use caution or temporarily discontinue use in potentially hazardous situations. Do not use headphones while operating a motorized vehicle, cycling, skateboarding, etc.; it may create a traffic hazard and is illegal in many areas.

Notice

Any changes or modifications made to this device that are not expressly approved by Philips Consumer Lifestyle may void the user's authority to operate the equipment.



This product complies with the radio interference requirements of the European Community.



Your product is designed and manufactured with high quality materials and components, which can be recycled and reused.



When this crossed-out wheeled bin symbol is attached to a product it means that the product is covered by the European Directive 2002/96/EC.

Please inform yourself about the local separate collection system for electrical and electronic products.

Please act according to your local rules and do not dispose of your old products with your normal household waste. Correct disposal of your old product helps to prevent potential negative consequences for the environment and human health.



Your product contains batteries covered by the European Directive 2006/66/EC, which cannot be disposed with normal household waste. Please inform yourself about the local rules on separate collection of batteries because correct disposal helps to prevent negative consequences for the environmental and human health.

Environmental information

All unnecessary packaging has been omitted. We have tried to make the packaging easy to separate into three materials: cardboard (box), polystyrene foam (buffer) and polyethylene (bags, protective foam sheet.)

Your system consists of materials which can be recycled and reused if disassembled by a specialized company. Please observe the local regulations regarding the disposal of packaging materials, exhausted batteries and old equipment.

Copyright notice



This item incorporates copy protection technology that is protected by U.S. patents and other intellectual property rights of Rovi Corporation. Reverse engineering and disassembly are prohibited.

Trademark notice



ABOUT DIVX VIDEO: DivX® is a digital video format created by DivX, Inc. This is an official DivX Certified device that plays DivX video. Visit www.divx.com for more information and software tools to convert your files into DivX video.

ABOUT DIVX VIDEO-ON-DEMAND: This DivX Certified® device must be registered in order to play DivX Video-on-Demand (VOD) content. To generate the registration code, locate the DivX VOD section in the device setup menu. Go to vod.divx.com with this code to complete the registration process and learn more about DivX VOD.

DivX®, DivX Certified® and associated logos are registered trademarks of DivX, Inc. and are used under license.



Manufactured under license from Dolby Laboratories. Dolby and the double-D symbol are trademarks of Dolby Laboratories.



'DVD Video' is a trademark of DVD Format/ Logo Licensing Corporation.

This apparatus includes this label:



Note

- The type plate is located on the bottom of the apparatus.

2 Your DVD Micro Theater

Congratulations on your purchase, and welcome to Philips! To fully benefit from the support that Philips offers, register your product at www.philips.com/welcome.

Introduction

With this apparatus, you can:

- Watch video from DVD/VCD/SVCD, iPhone/iPod, or USB storage devices
- Enjoy audio from discs, iPhone/iPod, or USB storage devices
- View pictures from discs or USB storage devices
- Listen to FM radio

You can enrich sound output with these sound effects:

- Dynamic Bass Boost (DBB)
- Digital Sound Control (DSC)
- Automatic loudness control (LOUDNESS)

The apparatus supports these media/disc formats:



You can play DVD discs marked with the following region code:

DVD region code	Countries
	Europe

What's in the box

Check and identify the contents of your package:

- Main unit
- 2 speakers
- Remote control with batteries
- Composite video cable (yellow)
- Power cord
- MP3 link cable (length: 60 cm)
- FM wire antenna
- User manual
- Quick start guide

Overview of the main unit

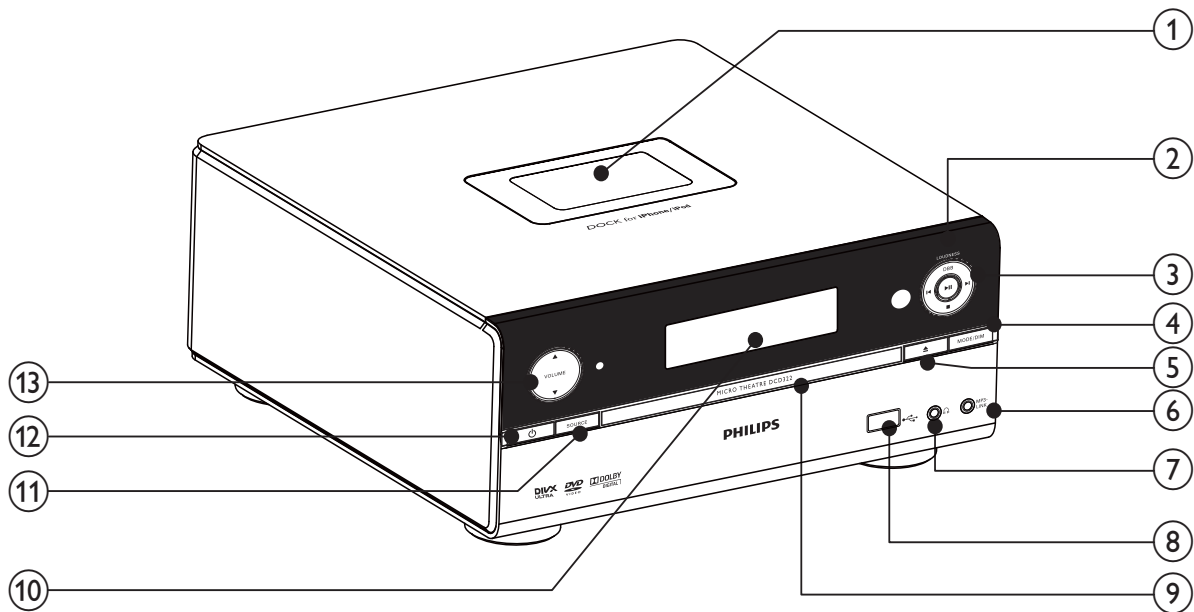

① Dock for iPod/iPhone

② DBB/LOUDNESS

- Turn on or off dynamic bass enhancement.
- Turn on or off automatic loudness control.

③ I◀▶

- Skip to the previous/next track, title, or chapter.
- Select a preset radio station.
- ▶||
- Start or pause play.
- ■
- Stop play.

④ MODE/DIM

- Select repeat/shuffle play modes.
- Select a brightness level for the display screen.

⑤ ▲

- Open or close the disc compartment.

⑥ MP3-LINK

- Jack for an external audio device.

⑦ 🎧

- Headphone socket.

⑧ 📶

- USB socket.

⑨ Disc compartment

⑩ Display panel

- Display current status.

⑪ SOURCE

- Select a source.

⑫ ⏻

- Turn on the apparatus or switch to the standby mode.

⑬ ▲ VOLUME ▼

- Adjust volume.
- Adjust time.

Overview of the remote control

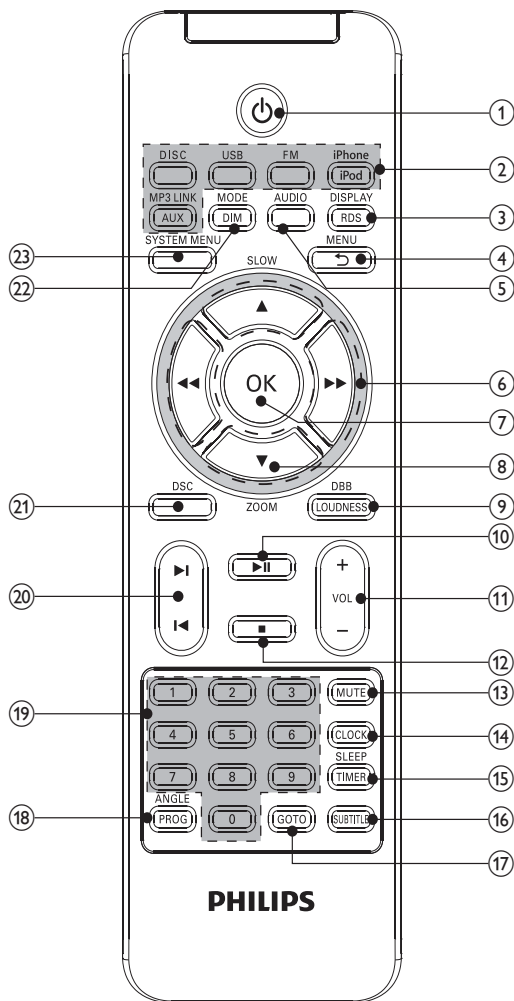

- ① **Power**
 - Turn on the apparatus or switch to the standby mode.
- ② **Source selection keys**
 - Select a source.
- ③ **DISPLAY/RDS**
 - Display play information on a connected TV.
 - For selected FM radio stations: display RDS information.
 - Synchronize clock with RDS.
- ④ **MENU/↶**
 - For video discs: access or exit the disc menu.

- For video discs with playback control(PBC): turn on/off PBC.
- Access or exit the menu of iPhone/iPod.
- Return to the previous menu.

⑤ AUDIO

- For VCD, select stereo, mono-left or mono-right channel.
- For DVD/DivX video, select an audio language.

⑥ ◀▶▶▶

- Search in a track or disc.
- For menus, navigate left/right.
- Tune to a radio station.
- Rotate a picture.

⑦ OK

- Confirm a selection.

⑧ ▲SLOW/▼ZOOM

- For menus: navigate up/down.
- Invert a picture.
- (▲SLOW) For video discs: select a slow play mode.
- (▼ZOOM) For video: zoom in/out.

⑨ DBB/LOUDNESS

- Turn on or off automatic loudness control.
- Turn on or off dynamic bass enhancement.

⑩ ▶||

- Start or pause play.

⑪ VOL +/-

- Adjust volume.
- Adjust time.

⑫ ■

- Stop play.

⑬ MUTE

- Mute or restore volume.

⑭ CLOCK

- Set the clock.
- View the clock.

⑮ SLEEP/TIMER

- Set the sleep timer.
- Set the alarm timer.

⑩⑥ SUBTITLE

- Select a subtitle language.

⑩⑦ GOTO

- During disc play, specify a position to start play.

⑩⑧ ANGLE/PROG

- Select a DVD camera angle.
- Program tracks.
- Program titles/chapters for DVD play.
- Program radio stations.

⑩⑨ Numeric keypad

- Select a title/chapter/track directly.

⑩⑩ ⏮⏭

- Skip to the previous/next track.
- Skip to the previous/next title or chapter.
- Select a preset radio station.

⑩⑪ DSC

- Select a preset sound setting.

⑩⑫ MODE/DIM

- Select repeat/shuffle play modes.
- Select a brightness level for the display screen.

⑩⑬ SYSTEM MENU

- Access or exit the system setup menu.

3 Connect

Place the unit

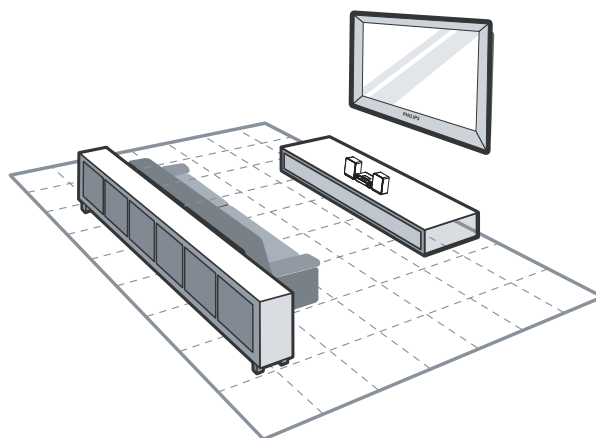

- 1 Place the unit near to the TV.
- 2 Place the left and right speakers at equal distance from the TV and at an angle of approximately 45 degrees from the listening position.

Note

- To avoid magnetic interference or unwanted noise, never place this apparatus and speakers too close to any radiation devices.
- Place this unit on top of a table or mount it on the wall.
- Never place this unit in an enclosed cabinet.
- Install this unit near the AC outlet where the AC power plug can be easily reached.

Connect speakers

Note

- For optimal sound, use the supplied speakers only.
- Connect only speakers with impedance that is the same or higher than the supplied speakers. Refer to the Specifications section of this manual.

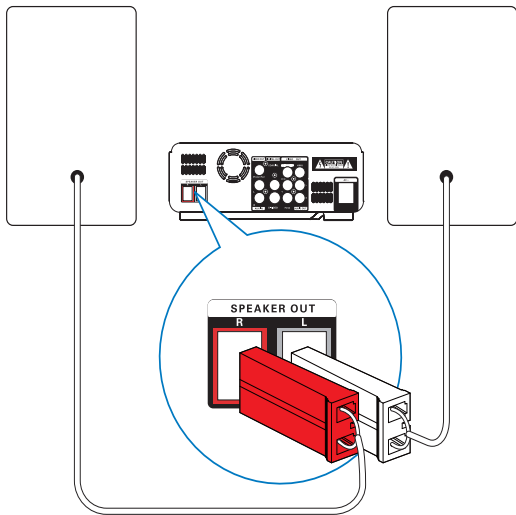

- 1 Insert the speaker plugs to **SPEAKER OUT (L and R)** sockets.
 - The red plug to **R**.
 - The white plug to **L**.

Connect FM antenna



Tip

- For optimal reception, fully extend and adjust the position of the antenna.
- For better FM stereo reception, connect an outdoor FM antenna to the **FM AERIAL** jack.
- The unit does not support MW radio reception.

- 1 Connect the supplied FM wire antenna to the **FM AERIAL** socket on the unit.

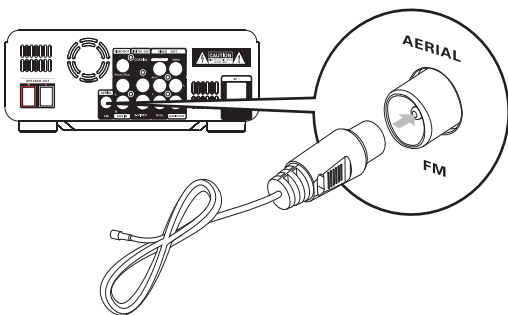

Connect audio cables

To hear audio from other audio devices as well as the accompanied speakers, select a preferred audio connection:

- **Option 1:** Connect through a coaxial cable
- **Option 2:** Connect through analog audio cables

Option 1: Connect through a coaxial cable

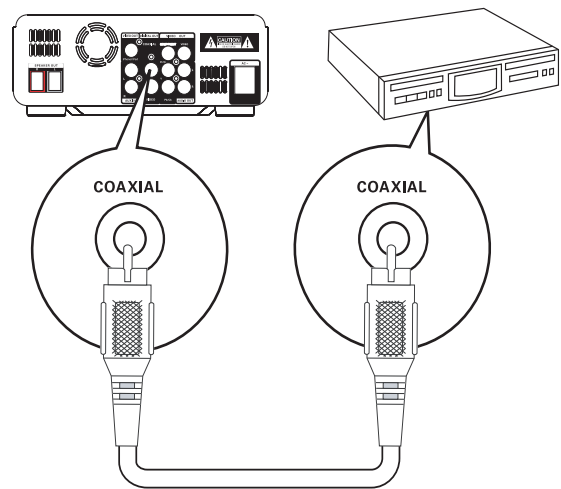

You can enjoy multi-channel surround sound from this apparatus when it is connected to a digital audio device.

- 1 Connect a coaxial cable (not supplied) to
 - the **COAXIAL** socket on this product.
 - the **COAXIAL/DIGITAL** input socket on the device.

Option 2: Connect through analog audio cables

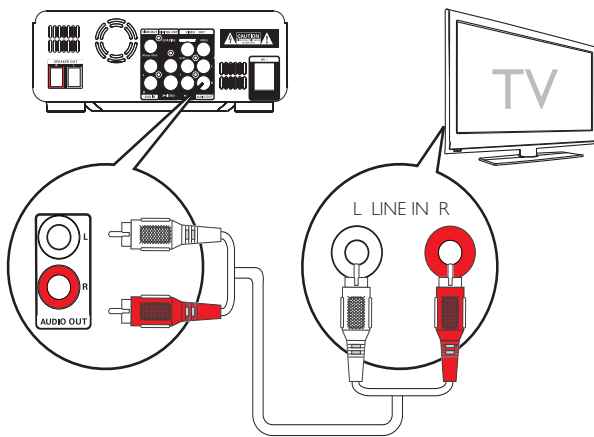

- 1 Connect an audio cable (red/white ends) to:
 - the **AUDIO OUT** (L and R) sockets on this unit.
 - the audio input sockets on the audio device.

Option 1: Connect through an S-Video cable

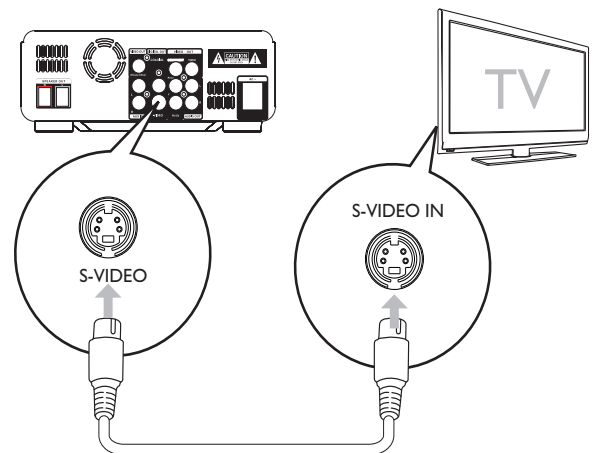

- 1 Connect an S-video cable (not supplied) to:
 - the **S-Video** socket on this unit.
 - the **S-Video** socket on the TV.

Connect video cables

You can select the best video connection that your TV supports.

- **Option 1:** Connect through an S-Video cable (for a standard TV).
- **Option 2:** Connect through a composite video (CVBS) cable (for a standard TV).
- **Option 3:** Connect through component video cables (for a standard TV or Progressive Scan TV).
- **Option 4:** Connect through the **iPhone/iPod** socket (for a standard TV).

Option 2: Connect through a composite video cable

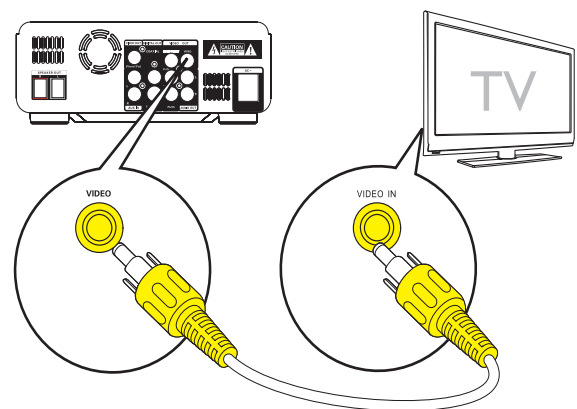

- 1 Connect the composite video cable (supplied) to:
 - the **VIDEO** socket on this unit.
 - the video input socket on the TV.

Option 3: Connect through component video cables

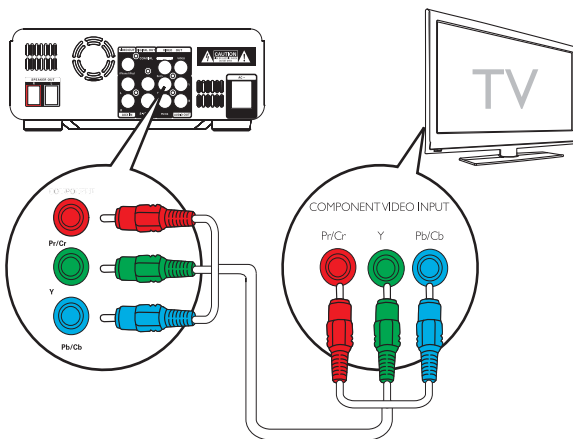

Note

- The progressive scan video quality is only available when a progressive scan TV is connected.
- If your TV does not support progressive scan, you cannot view the picture.
- For how to activate progressive scan on your TV, refer to the TV user manual.

Connect a progressive scan TV through component video for higher quality video.

- 1 Connect component video cables (red/blue/green - not supplied) to:
 - the **COMPONENT (Pr/Cr Pb/Cb Y)** sockets on this unit.
 - the component input sockets on the TV.

Option 4: Connect through the iPhone/iPod socket

You can view video files that are stored on your iPhone/iPod on your TV.

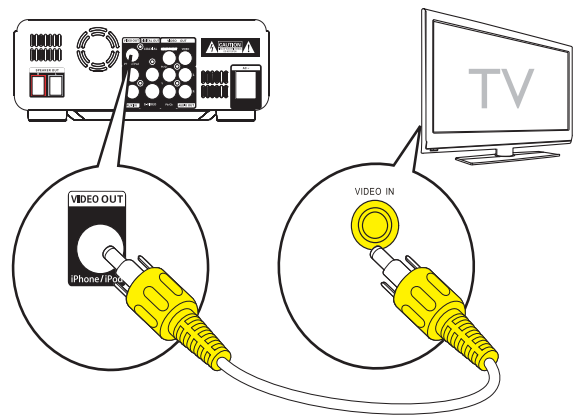

- 1 Connect a composite video cable to:
 - the **iPhone/iPod** socket on this unit.
 - the video input socket on the TV.

Note

- To play audio only through the speakers of this apparatus, mute the TV and other connected audio devices.
- See "Play iPhone/iPod" for how to control the play.
- See the user manual of your TV for how to select the correct viewing channel.

Connect an external audio device (optional)

You can also listen to an external audio device through this unit.

- **Option 1:** Connect through the **AUX IN** sockets
- **Option 2:** Connect through the **MP3-LINK** socket

Option 1: Connect through the AUX IN sockets

- 1 Connect audio cables (red/white) to:
 - the **AUX IN (L and R)** sockets on this unit.
 - the audio output sockets on the external audio device.

4 Get started

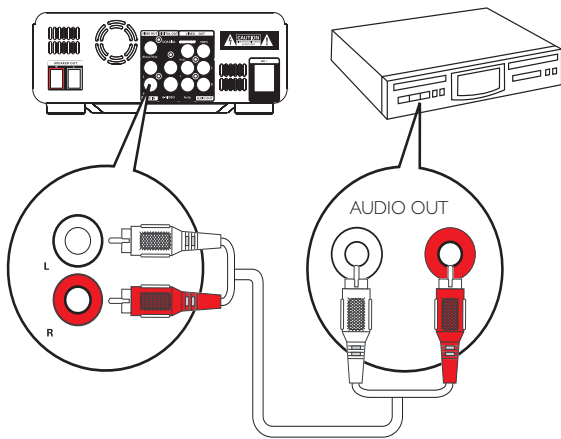

Option 2: Connect through the MP3-LINK socket

- 1 Connect an MP3 link cable to:
 - the **MP3-LINK** socket on this unit.
 - the headphone socket on the external audio device.

Connect power

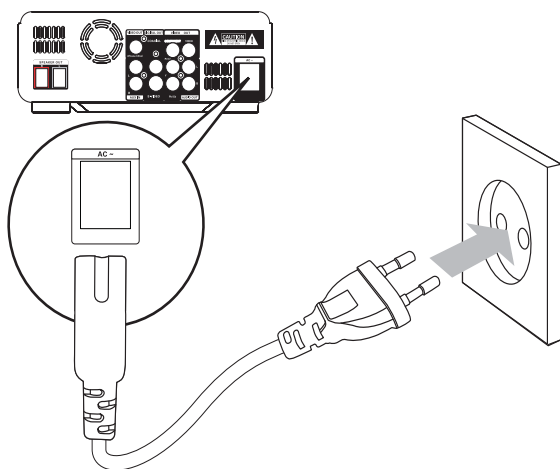

! Caution

- Risk of product damage! Ensure that the power supply voltage corresponds to the voltage printed on the back or the underside of the unit.
- Before connecting the AC power cord, ensure you have completed all other connections.

- 1 Connect the AC power cord to
 - the **AC ~** socket on this apparatus.
 - the wall power socket.

! Caution

- Use of controls or adjustments or performance of procedures other than herein may result in hazardous radiation exposure or other unsafe operation.

Always follow the instructions in this chapter in sequence.

If you contact Philips, you will be asked for the model and serial number of this apparatus. The model number and serial number are on the back of the apparatus. Write the numbers here:
Model No. _____
Serial No. _____

Prepare the remote control

! Caution

- Risk of explosion! Keep batteries away from heat, sunshine or fire. Never discard batteries in fire.

For first-time use:

- 1 Remove the protective tab to activate the remote control battery.

To replace the remote control batteries:

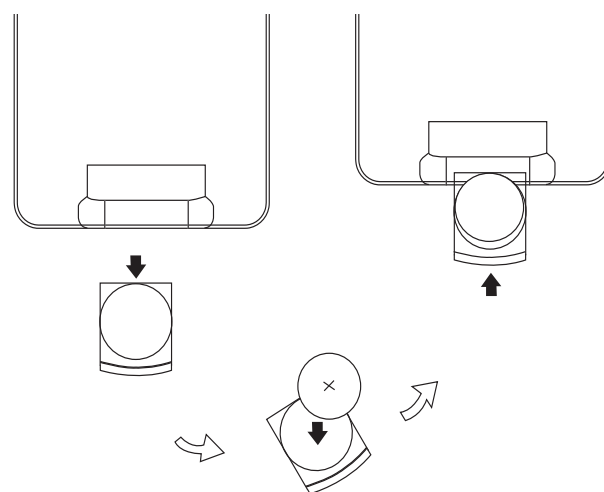

- 1 Open the battery compartment.

- 2 Insert one lithium CR2025 battery with correct polarity (+/-) as indicated.
- 3 Close the battery compartment.

Note

- Before you press any function button on the remote control, first select the correct source with the remote control instead of the main unit.
- If you are not going to use the remote control for a long time, remove the battery.

Turn on

- 1 Press **⏻**.
 - ↳ The unit switches to the last selected source.

Switch to standby mode

- 1 Press and hold **⏻** for over 3 seconds to switch the unit to Eco Power Standby mode.
 - ↳ The backlight on the display panel turns off.
 - ↳ The blue Eco Power indicator turns on.

To switch the unit to standby mode:

- 1 In Eco Power Standby mode, press and hold **⏻** for over 3 seconds.
 - ↳ The clock (if set) appears on the display panel.
 - ↳ The blue Eco Power indicator turns off.

Store radio stations automatically

If no radio stations are stored, the unit can store radio stations automatically.

- 1 Turn on the unit.
- 2 Press **SOURCE** repeatedly until **[TUNER]** is displayed.
 - ↳ **[AUTO INSTALL PRESS----PLAY KEY]** (press **▶||** to start the automatic installation) is displayed.

- 3 Press **▶||**.
 - ↳ The unit automatically stores radio stations with sufficient signal strength.
 - ↳ After all available radio stations are stored, the first stored radio station is broadcast automatically.

Set clock

- 1 In standby mode, press and hold **CLOCK** for over 2 seconds to activate the clock setting mode.
 - ↳ **[SET CLOCK]** scrolls on the display, and then **[24H MODE]** (24-hour time format) appears.
- 2 Press **VOL +/-** to select **[24H MODE]** or **[12H MODE]** (12-hour time format), and then press **CLOCK** to confirm.
 - ↳ The hour digits begin to blink.
- 3 Press **VOL +/-** to set the hour.
- 4 Press **CLOCK** to confirm.
 - ↳ The minute digits begin to blink.
- 5 Press **VOL +/-** to set the minute.
- 6 Press **CLOCK** to confirm.

Adjust brightness of display panel

- 1 In standby mode, press **MODE/DIM** repeatedly to select different brightness levels.

Find the correct viewing channel

- 1 Press **⏻** to turn on the unit.
- 2 Press **DISC** to switch to disc mode.
- 3 Turn on the TV and switch to the correct video-in channel in one of the following ways:

- Go to the lowest channel on your TV, then press the Channel Down button until you see the blue screen.
- Press the source button repeatedly on the remote control of your TV.



Tip

- The video-in channel is between the lowest and highest channels and may be called FRONT, A/V IN, VIDEO etc. See the TV user manual on how to select the correct input on the TV.

Select the correct TV system

Change this setting if the video does not appear correctly. By default, this setting matches the most common setting for TVs in your country.

- 1 Press **SYSTEM MENU**.
- 2 Select **[Video Setup]**.
- 3 Select **[TV System]** and then press **▶▶**.
- 4 Select a setting and then press **OK**.
 - **[NTSC]** - For TV with NTSC color system.
 - **[PAL]** - For TV with PAL color system.
 - **[Multi]** - For TV that is compatible with both PAL and NTSC.
- 5 To exit the menu, press **SYSTEM MENU**.

Change system menu language

- 1 Press **SYSTEM MENU**.
- 2 Select **[General Setup]**.
- 3 Select **[OSD language]** and then press **▶▶**.
- 4 Select a setting and then press **OK**.
- 5 To exit the menu, press **SYSTEM MENU**.

Turn on Progressive Scan

Progressive scan displays twice the number of frames per seconds than interlaced scanning (ordinary TV system). With nearly double the number of lines, progressive scan offers higher picture resolution and quality.

Before you turn on this feature, ensure that:

- The TV supports progressive scan signals.
- You have connected this unit with the TV through component video.

- 1 Turn on the TV.
- 2 Ensure that the TV progressive scan mode is deactivated (see the TV user manual).
- 3 Switch the TV to the correct viewing channel for this unit.
- 4 Press **DISC**.
- 5 Press **SYSTEM MENU**.
- 6 Press **▲/▼** to select **[Video Setup]** in the menu, then press **▶▶**.
- 7 Select **[Component Video]**, then press **▶▶**.
- 8 Select **[P-Scan]**, then press **OK**.
↳ The progressive setup is complete.

5 Play



Caution

- Risk of damage to the unit! During play, never move the unit.

Play a disc



Caution

- Never look at the laser beam inside the unit.
- Risk of product damage! Never play discs with accessories such as disc stabilizer rings or disc treatment sheets.
- Never put any objects other than discs into the disc compartment.

- 1 Press **DISC** to select the DISC source.
- 2 Press **▲** on the front panel.
 - ↳ The disc tray opens.
- 3 Place a disc onto the tray and press **▲**.
 - ↳ Ensure that the label faces up.
- 4 Play starts automatically.
 - To stop play, press **■**.
 - To pause or resume play, press **▶||**.
 - To skip to the previous/next title/ chapter/track, press **◀▶**.

If play does not start automatically:

- 1 Select a title/chapter/track and then press **▶||**.



Tip

- To play a locked DVD, enter the 6-digit parental control password.

Use the disc menu

When you load a DVD/(S)VCD disc, a menu may be displayed on the TV screen.

To access or exit the menu manually:

- 1 Press **MENU/↵**.

For VCD with PlayBack Control (PBC) feature (version 2.0 only):

The PBC feature allows you to play VCD interactively according to the menu screen.

- 1 During play, press **MENU/↵** to enable/disable playback control.
 - ↳ When PBC is enabled, the menu screen is displayed.
 - ↳ When PBC is disabled, normal play is resumed.

Select an audio language

You can select an audio language for a DVD or DivX (Ultra) video.

- 1 During disc play, press **AUDIO**.
 - ↳ The language options appear. If the selected audio channels is unavailable, the default disc audio channel is used.



Note

- For some DVDs, the language can only be changed from the disc menu. Press **MENU/↵** to access the menu.

Select a subtitle language

You can select a subtitle language for a DVD or DivX (Ultra) video.

- 1 During play, press **SUBTITLE** repeatedly.



Note

- For some DVDs, the language can only be changed from the disc menu. Press **MENU/↵** to access the menu.

Play from USB or recorded discs

You can play DivX (Ultra)/MP3/WMA/ JPEG picture files copied onto a CD-R/RW, recordable DVD or USB storage device.

- 1 Select a source.
 - For a USB storage device, press **USB**.
 - For a disc, press **DISC**.
 - 2 Insert the USB storage device or disc.
 - ↳ The play starts automatically.
- To select a specified file for play,**
- 1 Press **■** to stop play.
 - 2 Press **▲/▼** to select a folder, and then press **OK** to confirm.
 - To return to the upper-level directory, press **▲/▼** to select **⏪...**, and then press **OK**.
 - 3 Press **▲/▼** to select a file from the folder.
 - 4 Press **▶||** to start play.
 - To pause or resume play, press **▶||**.
 - To skip to the previous/next file, press **⏪/⏩**.
 - To change the subtitle language during the play of a DivX (Ultra) video, press **SUBTITLE**.

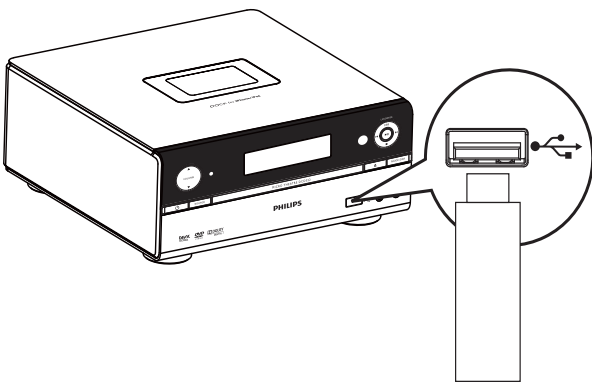

Note

- You can only play DivX (Ultra) videos rented or purchased through the DivX registration code of this unit.
- Subtitle files with the following filename extensions (.srt, .smi, .sub, .ssa, .ass) are supported but do not appear on the file navigation menu.
- The subtitle filename has to be the same as the file name of the video.

Play control

Select repeat/shuffle play options

- 1 During play, press **MODE/DIM** repeatedly to select a play option.
 - To resume normal play, press **MODE/DIM** repeatedly until no option is displayed.

Search forward/backward

- 1 During video/audio play, press **⏪/⏩** repeatedly to select a search speed.
 - To resume play at normal speed, press **▶||**.

Search by time or title/chapter/track number

- 1 During video/audio play, press **GOTO**.
- 2 Press **▲/▼** to select a field.
- 3 Enter the desired time or number.
 - For the time field, enter the play position in sequence of hour, minute and second.
 - For the title/chapter/track field, enter the title/chapter/track number.
- 4 Press **OK** to start play at the selected point.

Resume video play from last stopped point

Note

- This feature is only available for DVD/VCD play.

- 1 In stop mode and when the disc has not been removed, press **▶||**.

To cancel resume mode and stop play completely:

- 1 In stop mode, press **■**.

Play options

Program tracks

This function is only available for audio CDs and WMA/MP3/DivX (Ultra) files.

For an audio CD,

- 1 During play, press **■** twice.
The list of all tracks is displayed.
- 2 Press **▲/▼** to select a track.
- 3 Press **ANGLE/PROG**.
↳ **[Add to Program List]** (added to the program list) is displayed.
- 4 Repeat steps 2-3 to program more tracks.
- 5 Press **MENU/↵** to access the list of programmed tracks.
- 6 Press **▶||** to start play.
 - To switch between the list of all tracks and the list of programmed tracks during play, press **■** twice, and then press **MENU/↵** repeatedly.
 - To remove a programmed track from the list, access the list of programmed tracks, press **▲/▼** to select a track, and then press **ANGLE/PROG**.
 - To erase the program, remove all programmed tracks from the list.

For MP3/WMA/DivX (Ultra) files stored on a CD-R/RW, recordable DVD, or USB storage device,

- 1 During play, press **▲/▼** to select a track.
 - If a DivX (Ultra) file is played, press **■** to access the USB/disc directory first.
 - To return to the upper-level directory, press **▲/▼** to select **⏪...**, and then press **OK**.
- 2 Press **ANGLE/PROG**.
↳ **[Add to Program List]** (added to the program list) is displayed.

- 3 Repeat steps 1-2 to program more tracks.
 - You can program tracks in different formats in different folders.
- 4 Press **MENU/↵** to access the list of programmed tracks.
- 5 Press **▶||** to start play.
 - To switch between the USB/disc directory and the list of programmed tracks, press **MENU/↵** repeatedly.
 - To remove a programmed track from the list, access the list of programmed tracks, press **▲/▼** to select a track, and then press **ANGLE/PROG**.
 - To erase the program, remove all programmed tracks from the list.

Display play information

- 1 During play, press **DISPLAY/RDS** to display play information on the TV.

Zoom in/out image

- 1 During video play, press and hold **▼** (**ZOOM**) to zoom in/out the image.
 - When the image is zoomed in, you can press **◀▶▶/▲/▼** to pan through the image.

Slow-motion play

- 1 During video play, press **▲** (**SLOW**) to select a play speed.
 - ↳ The sound is muted.
 - To resume play at normal speed, press **▶||**.

Change camera angle

Some DVDs contain alternate scenes, such as scenes recorded from different camera angles. For such DVDs, you can select from the available alternate scenes.

- 1 During play, press **PROG/ANGLE** repeatedly to switch between camera angles.

Change the audio channel

Note

- This feature is only available for VCDs and DivX (Ultra) videos.

- 1 During play, press **AUDIO** repeatedly to select an audio channel available on the disc:
 - Mono Left
 - Mono Right
 - Stereo

Picture view options

Select a slide show play mode

You can view pictures as slide show in different play modes.

- 1 Press **MODE/DIM** repeatedly.

Rotate picture

- 1 During play, press **◀◀/▶▶/▲/▼** to rotate the picture anti-clockwise/clockwise.

6 Play iPhone/iPod

You can enjoy audio from iPhone/iPod through this unit.

Note

- The audio is only output through the supplied speakers.

Compatible iPod/iPhone

The unit supports the following iPod and iPhone models.



“**Made for iPod**” and “**Made for iPhone**” mean that an electronic accessory has been designed to connect specifically to iPod or iPhone respectively, and has been certified by the developer to meet Apple performance standards. Apple is not responsible for the operation of this device or its compliance with safety and regulatory standards. Please note that the use of this accessory with iPod or iPhone may affect wireless performance.

Made for

- iPod mini
- iPod touch (1st, 2nd, 3rd, and 4th generation)
- iPod nano (1st, 2nd, 3rd, 4th, 5th, and 6th generation)
- iPod 4G
- iPod 5G
- iPod classic
- iPhone
- iPhone 3G
- iPhone 3GS

Load the iPhone/iPod

- 1 Lift up the iPhone/iPod dock on top panel until you hear a click.

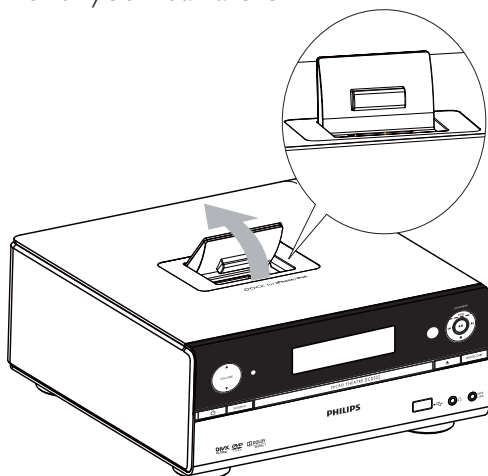

- 2 Place the iPhone/iPod in the dock.

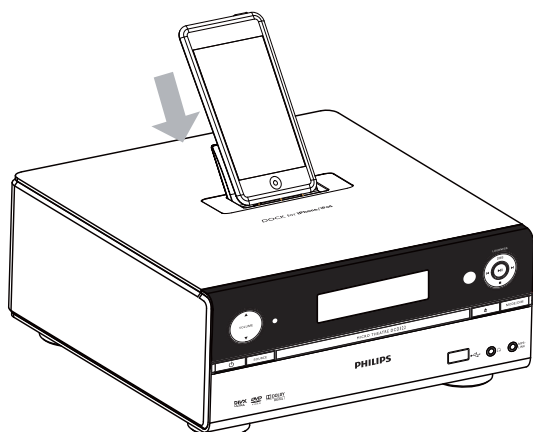

Listen to the iPhone/iPod

- 1 Press **iPhone/iPod** to select iPhone/iPod source.
- 2 Load your iPhone/iPod onto this apparatus.
- 3 Play the desired file on your iPhone/iPod.
 - To pause/resume play, press **▶||**.
 - To skip to a track, press **◀▶**.
 - To navigate the menu: press **MENU/↶** to access the menu, press **▲/▼** to select an item, and then press **OK** to confirm.

Charge the iPhone/iPod

When the unit is connected to power, the docked iPhone/iPod begins to charge.

Remove the iPhone/iPod

- 1 Pull the iPhone/iPod out of the dock.
- 2 Press down to hide the dock.

7 Listen to radio

The unit can automatically search and store radio stations (see “Get started” > “Store radio stations automatically”). You can also search and store radio stations manually.

Tune to a radio station

- 1 Press **FM**.
- 2 Press and hold **◀▶** for more than 2 seconds.
 - ↳ The radio tunes to a station with strong reception automatically.
- 3 Repeat step 2 to tune to more stations.
 - To tune to a weak station, press **◀▶** repeatedly until you find optimal reception.

Program radio stations automatically

Note

- You can program a maximum of 20 preset radio stations.

- 1 Press and hold **ANGLE/PROG** for 2 seconds to activate automatic programming.
 - ↳ **[AUTO]** (auto) is displayed briefly.
 - ↳ All available stations are programmed in the order of waveband reception strength.
 - ↳ The first programmed radio station is broadcast automatically.

Program radio stations manually

Note

- You can program a maximum of 20 preset radio stations.

- 1 Tune to a radio station.
- 2 Press **ANGLE/PROG** to activate programming.
- 3 Press **◀▶** to allocate a number from 1 to 20 to this radio station, then press **ANGLE/PROG** to confirm.
 - ↳ The preset number and the frequency of the preset station are displayed.
- 4 Repeat the previous steps to program other stations.

Note

- To overwrite a programmed station, store another station in its place.

Tune to a preset radio station

- 1 Press **◀▶** to select a preset number that you want.

Show RDS information

RDS (Radio Data System) is a service that allows FM stations to show additional information. If you tune to an RDS station, an RDS icon and the station name are displayed.

- 1 Tune to an RDS station.
- 2 Press **DISPLAY/RDS** repeatedly to scroll through the following information (if available):
 - ↳ Station name
 - ↳ Program type such as **[NEWS]** (news), **[SPORT]** (sport), **[POP M]** (pop music)...
 - ↳ Frequency

 Note

- There are definitions of RDS program types (see “Product information” > “RDS program types”).

Synchronize clock with RDS station

You can synchronize the clock time on the unit with an RDS station.

- 1 Tune to an RDS radio station that transmits time signals.
- 2 Press **DISPLAY/RDS** for over 2 seconds.
 - ↳ **[CT SYNC]** is displayed and the unit reads RDS time automatically.
 - ↳ If no time signal is received, **[NO CT]** is displayed.

 Note

- The accuracy of the transmitted time depends on the RDS station that transmits the time signal.

8 Adjust sound

Adjust volume level

- 1 During play, press **VOL +/-** to increase/decrease the volume level.

Select a sound effect

 Note

- You cannot use different sound effects at the same time.

Select a preset sound effect

- 1 During play, press **DSC** repeatedly to select:
 - **[FLAT]** (flat)
 - **[POP]** (pop)
 - **[JAZZ]** (jazz)
 - **[ROCK]** (rock)
 - **[CLASSIC]** (classic)

Enhance bass

The best DBB (Dynamic Bass Enhancement) setting is generated automatically for each DSC option. You can manually select the DBB setting that best suits your listening environment.

The feature of automatic loudness control (LOUDNESS) enables the system to increase the treble and bass sound effect at low volume levels automatically (the higher the volume, the lower the treble and bass increase).

- 1 During play, press **DBB/LOUDNESS** repeatedly to turn on/off the DBB or LOUDNESS feature.
 - **[DBB]**: The DBB feature is enabled.
 - **[LOUDNESS]**: The LOUDNESS feature is enabled.
 - **[FLAT]**: Both the DBB feature and the LOUDNESS feature are disabled.

Mute sound

- 1 During play, press **MUTE** to mute or restore sound.

9 Adjust settings

- 1 Press **SYSTEM MENU**.
- 2 Select a setup page.
- 3 Select an option and then press **▶▶**.
- 4 Select a setting and then press **OK**.
 - To return to the previous menu, press **◀◀**.
 - To exit the menu, press **SYSTEM MENU**.

General setup

On the **[General Setup]** page, you can set the following options:

[OSD language]

Select the preferred language for on-screen display.

[DivX® VOD Code]

Display the DivX® registration code.

[DivX Deactivation]

Deactivate the authorization to current user.

Note

- Enter this DivX registration code when you rent or purchase a video from <http://vod.divx.com/>. The DivX videos rented or purchased through the DivX® VOD (Video On Demand) service can be played only on the device to which it is registered.

Audio setup

On the **[Audio Setup]** page, you can set the following options:

[Digital Output]

Select audio formats supported by the connected device.

- **[Off]** – Turn off the digital output.

- **[PCM]** – If the connected device cannot decode multichannel audio, select this option.
- **[All]** – If the connected device supports multi-channel audio formats, select this option.

[Night Mode]

Make loud sound level softer and soft sound level louder so that you can watch the DVD movies at a low volume, without disturbing others.

- **[On]** – enjoy quiet viewing at night (DVDs only).
- **[Off]** – enjoy surround sound with its full dynamic range.

Video setup

On the **[Video Setup]** page, you can set the following options:

[TV System]

Change this setting if the video does not appear correctly. By default, this setting matches the most common setting for TVs in your country.

- **[NTSC]** - For TV with NTSC color system.
- **[PAL]** - For TV with PAL color system.
- **[Multi]** - For TV that is compatible with both PAL and NTSC.

[TV Display]

The TV format determines the aspect ratio of display according to the type of TV you have connected.



4:3 Pan Scan (PS)



4:3 Letter Box (LB)



16:9 (Wide Screen)

- **[4:3 Pan Scan]** – For 4:3 screen TV: full-height display with the trimmed sides.

- **[4:3 Letter Box]** – For 4:3 screen TV: wide-screen display with black bars on the top and bottom of the screen.
- **[Wide Screen]** – For wide-screen TV: display ratio 16:9.

[Picture Setting]

Customize picture color settings.

[Component Video]

Set the video output according to the video connection. If the composite connection is used, this setting is not required.

- **[S-VIDEO]** – If the S-Video connection is used, select this option.
- **[Interlaced]** – For ordinary TV: turn on the interlace mode.
- **[P-Scan]** – For progressive scan TV: turn on the progressive scan mode.

Preferences

On the **[Preferences]** page, you can set the following options:

[Audio]

Select the preferred audio language for disc play.

[Subtitle]

Select the preferred subtitle language for disc play.

[Disc Menu]

Select the preferred disc menu language.

Note

- If the language you have set is not available on the disc, the disc uses its own default language.
- For some discs, the subtitle/audio language can only be changed from the disc menu.

[DivX Subtitle]

Select a character set that supports the DivX subtitle.

Note

- Ensure that the subtitle file has the exact same file name as the movie file. If for example the file name of the movie is 'Movie.avi', then you will need to name the text file 'Movie.sub' or 'Movie.srt'.

[Parental Control]

Restrict access to discs that are unsuitable for children. These types of discs must be recorded with ratings.

- 1) Press **OK**.
- 2) Select a rating level, and then press **OK**.
- 3) Press the numeric keys to enter the password.

Note

- Rated discs above the level you set in **[Parental Control]** require a password to be played.
- The ratings are country-dependent. To allow all discs to play, select **[8. Adult]**.
- Some discs have ratings printed on them but are not recorded with ratings. This function has no effect on such discs.

[Password]

This setting allows you to change the password for parental control. The default password is '123456'.

- 1) Press the numeric keys to enter '123456' or your last set password at **[Old Password]** field.
- 2) Enter the new password at **[New Password]** field.
- 3) Enter the new password again at **[Confirm new password]** field.
- 4) Press **OK** to exit the menu.

Note

- If you forget the password, enter '123456' before you set a new password.

[Version Info]

Display the software version of this apparatus.

[Default]

Reset all the settings to factory default, except for the password and parental settings.

10 Other features

Activate demonstration mode

You can see an overview of all features.

- 1 In the standby mode with clock display (if set), press **■** on the main unit to activate the demonstration mode.
 - ↳ A demonstration of major available features starts.

To deactivate the demonstration mode:

- 1 Press **■** on the main unit again.

Set alarm timer

This unit can be used as an alarm clock. You can select CD, iPod/iPhone, FM or USB as alarm source.





Note

- Ensure that you have set the clock correctly.

- 1 In standby mode, press and hold **SLEEP/TIMER** until **[SET TIMER]** (set timer) scrolls on the display.
- 2 Press **SOURCE** repeatedly to select a source: CD, FM, USB, iPod/iPhone or iPod/iPhone playlist.
 - If iPod/iPhone playlist is selected as alarm source, you need create a playlist called "PHILIPS" in your iPod/iPhone.
 - If no playlist called "PHILIPS" is created in the iPod/iPhone or no track is stored in the playlist, the unit switches to iPod/iPhone alarm source.
- 3 Press **SLEEP/TIMER** to confirm.
 - ↳ The hour digits are displayed and begin to blink.
- 4 Press **VOL +/-** repeatedly to set hour, and then press **SLEEP/TIMER** again.
 - ↳ The minute digits are displayed and begin to blink.
- 5 Press **VOL +/-** to set minute, and then press **SLEEP/TIMER** to confirm.
- 6 Press **VOL +/-** to adjust volume, and then press **SLEEP/TIMER** to confirm.
 - ↳ A clock icon appears on the display.

Activate/deactivate alarm timer

- 1 In the standby mode, press **SLEEP/TIMER** repeatedly.
 - ↳ If timer is activated,  is displayed.
 - ↳ If timer is deactivated,  disappears on the display.



Tip

- Alarm timer is not available when the source is set as "MP3 LINK" or "AUX".
- If CD/USB/iPod/iPhone source is selected but no disc is placed or no USB/iPod/iPhone connected, the system switches to FM automatically.

Set the sleep timer

This apparatus can switch to standby automatically after a set period.

- 1 When the apparatus is turned on, press **SLEEP/TIMER** repeatedly to select a preset period (in minutes).
 - ↳ When sleep timer is activated,  is displayed.

To deactivate sleep timer

- 1 Press **SLEEP/TIMER** repeatedly until **[SLE OFF]** is displayed.

Listen to an audio device

You can listen to an audio device through this apparatus.

- 1 Ensure the external audio device is connected to this apparatus (see "Connect" > "Connect an external audio device").
- 2 Press **MP3 LINK/AUX** repeatedly to select the audio input through the **MP3-LINK** socket or **AUX IN (L and R)** sockets.
- 3 Start to play the device (see the device user manual).

Listen through headphone

- 1 Plug a headphone into the  socket.

11 Product information

Note

- Product information is subject to change without prior notice.

Specifications

Amplifier

Rated Output Power	2 X 30 W RMS
Frequency Response	40 Hz - 20000 Hz, ± 3 dB
Signal to Noise Ratio	> 65 dB
Aux Input	1 V RMS 20k ohm

Disc

Laser Type	Semiconductor
Disc Diameter	12 cm/8 cm
Video Decoding	MPEG-1 / MPEG-2 / DivX
Video DAC	12 Bits
Signal System	PAL / NTSC
Video Format	4:3 / 16:9
Video S/N	> 48 dB
Audio DAC	24 Bits / 96 kHz
Total Harmonic Distortion	< 0.8% (1 kHz)
Frequency Response	4 Hz - 20 kHz (44.1 kHz) 4 Hz - 22 kHz (48 kHz) 4 Hz - 24 kHz (96 kHz)
S/N Ratio	> 65 dBA

Tuner (FM)

Tuning Range	87.5 - 108MHz
Tuning grid	50KHz
Sensitivity - Mono, 26dB S/N Ratio	<22 dBf
Sensitivity - Stereo, 46dB S/N Ratio	<43 dBf
Search Selectivity	>28dBf
Total Harmonic Distortion	<2%
Signal to Noise Ratio	>55dB

Speakers

Speaker Impedance	6 ohm
Speaker Driver	3.5" woofer + 1" tweeter
Sensitivity	> 80 dB/m/W \pm 4dB/m/W

General information

AC power	220 - 230 V, 50 Hz
Operation Power Consumption	45 W
Eco Standby Power Consumption	< 1 W
Composite Video Output	1.0 Vp-p, 75 ohm
Coaxial Output	0.5 Vpp \pm 0.1 Vpp, 75 ohm
Headphone output	2 x 15 mW, 32 ohm
USB Direct	Version 2.0
Dimensions	
- Main Unit (W x H x D)	223 x 88 x 242 mm
- Speaker Box (W x H x D)	140 x 220 x 206 mm
Weight	
- With Packing	7.7 kg
- Main Unit	1.8 kg
- Speaker Box	2 x 1.95 kg

Supported disc formats

- Digital Video Discs (DVDs)
- Video CDs (VCDs)
- Super Video CDs (SVCDs)
- Digital Video Discs + Rewritable (DVD+RW)
- Compact Discs (CDs)
- Picture (Kodak, JPEG) files on CDR(W)
- DivX(R) disc on CD-R(W):
- DivX 3.11, 4.x and 5.x
- WMA

Supported MP3-CD formats:

- ISO 9660
- Max. title/album name: 12 characters
- Max. title number plus album: 255.
- Max. nested directory: 8 levels.
- Max. album number: 32.
- Max. MP3 track number: 999.
- Supported sampling frequencies for MP3 disc: 32 kHz, 44.1 kHz, 48 kHz.
- Supported Bit-rates of MP3 disc are: 32, 64, 96, 128, 192, 256 (kbps).
- The following formats are not supported:
 - Files like *.VMA, *.AAC, *.DLF, *.M3U,
 - *.PLS, *.WAV
 - Discs recorded in Joliet format

- Directory nesting up to a maximum of 8 levels
- Number of albums/ folders: maximum 99
- Number of tracks/titles: maximum 999
- ID3 tag v2.0 or later
- File name in Unicode UTF8 (maximum length: 128 bytes)

Unsupported formats:

- Empty albums: an empty album is an album that does not contain MP3/WMA files, and is not be shown in the display.
- Unsupported file formats are skipped. For example, Word documents (.doc) or MP3 files with extension .dlf are ignored and not played.
- AAC, WAV, PCM audio files
- DRM protected WMA files (.wav, .m4a, .m4p, .mp4, .aac)
- WMA files in Lossless format

USB playability information

Compatible USB devices:

- USB flash memory (USB 2.0 or USB1.1)
- USB flash players (USB 2.0 or USB1.1)
- memory cards (requires an additional card reader to work with this apparatus)

Supported formats:

- USB or memory file format FAT12, FAT16, FAT32 (sector size: 512 bytes)
- MP3 bit rate (data rate): 32-320 Kbps and variable bit rate
- WMA v9 or earlier

RDS program types

NO TYPE	No RDS programme type
NEWS	News services
AFFAIRS	Politics and current affairs
INFO	Special information programs
SPORT	Sports
EDUCATE	Education and advanced training
DRAMA	Radio plays and literature
CULTURE	Culture, religion and society
SCIENCE	Science
VARIED	Entertainment programs
POP M	Pop music
ROCK M	Rock music
MOR M	Light music
LIGHT M	Light classical music
CLASSICS	Classical music
OTHER M	Special music programs
WEATHER	Weather
FINANCE	Finance
CHILDREN	Children's programs
SOCIAL	Social Affairs
RELIGION	Religion
PHONE IN	Phone In
TRAVEL	Travel
LEISURE	Leisure
JAZZ	Jazz Music
COUNTRY	Country Music
NATION M	National Music
OLDIES	Oldies Music
FOLK M	Folk Music
DOCUMENT	Documentary
TES	Alarm Test
ALARM	Alarm

12 Troubleshooting



Caution

- Never remove the casing of this apparatus.

To keep the warranty valid, never try to repair the system yourself.

If you encounter problems when using this apparatus, check the following points before requesting service. If the problem remains unsolved, go to the Philips web site (www.Philips.com/support). When you contact Philips, ensure that your apparatus is nearby and the model number and serial number are available.

No power

- Ensure that the AC cord of the apparatus is connected properly.
- Ensure that there is power at the AC outlet.
- As a power-saving feature, the system switches off automatically 15 minutes after track play reaches the end and no control is operated.

No disc detected

- Insert a disc.
- Check if the disc is inserted upside down.
- Wait until the moisture condensation at the lens has cleared.
- Replace or clean the disc.
- Use a finalized CD or correct format disc.

No picture

- Check the video connection.
- Turn on the TV to the correct Video-In channel.
- Progressive scan is activated but the TV does not support progressive scan.

Black and white or distorted picture

- The disc does not match the TV color system standard (PAL/NTSC).
- Sometimes a slight picture distortion may appear. This is not a malfunction.
- Clean the disc.

- A distorted picture may appear during progressive scan setup.

The aspect ratio of the TV screen cannot be changed even though you have set the TV display format.

- The aspect ratio is fixed on the loaded DVD disc.
- The aspect ratio may not be changed for some TV systems.

No sound or poor sound

- Adjust the volume.
- Disconnect the headphones.
- Check that the speakers are connected correctly.
- Check if the stripped speaker wires are clamped.

Remote control does not work

- Before you press any function button, first select the correct source with the remote control instead of the main unit.
- Reduce the distance between the remote control and the unit.
- Insert the battery with its polarities (+/- signs) aligned as indicated.
- Replace the battery.
- Aim the remote control directly at the sensor on the front of the unit.

Disc does not play

- Insert a readable disc with the label side facing you.
- Check the disc type, color system and regional code. Check for any scratches or smudges on the disc.
- Press **SYSTEM MENU** to exit the system setup menu.
- Disable the password for parental control or change the rating level.
- Moisture has condensed inside the system. Remove the disc and leave the system turned on for about an hour. Disconnect and reconnect the AC power plug, and then turn on the system again.
- As a power-saving feature, the system turns off automatically 15 minutes after disc play reaches the end and no control is operated.

DivX video files cannot be played.

- Ensure that the DivX video file is complete.
- Ensure that the file extension is correct.
- Due to Digital Rights issue, the DRM-protected video files cannot be played through an analog video connection (e.g. composite, component and scart). Transfer the video content onto the Disc Media and play these files.

Poor radio reception

- Increase the distance between the apparatus and your TV or VCR.
- Fully extend the FM antenna.
- Connect an outdoor FM antenna instead.

Audio or subtitle languages cannot be set

- The disc is not recorded with sound or subtitles in multiple languages.
- The audio or subtitle language setting is prohibited on the disc.

Cannot display some files in USB device

- The number of folders or files in the USB device has exceeded a certain limit. This phenomenon is not a malfunction.
- The formats of these files are not supported.

USB device not supported

- The USB device is incompatible with the unit. Try another one.

Timer does not work

- Set the clock correctly.
- Switch on the timer.

Clock/timer setting erased

- Power has been interrupted or the power cord has been disconnected.
- Reset the clock/timer.

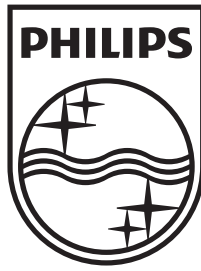

© 2011 Koninklijke Philips Electronics N.V.
All rights reserved.

DCD322_12_UM_Book 1_V4.0

