

3 Enjoy

Start disc playback

- 1 Insert a disc into the disc slot.
→ Make sure the disc label is facing out.

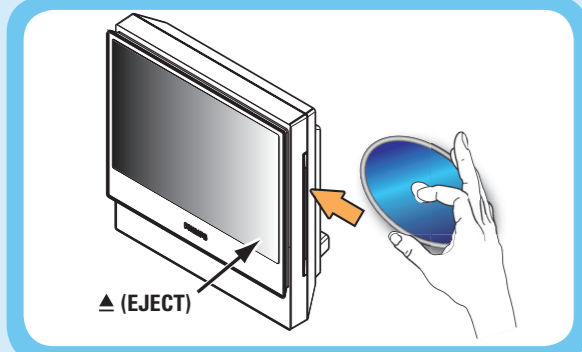

- 2 Playback will start automatically.
- 3 If the disc menu appears, use ▲▼ keys to select an option in the menu and press ► (PLAY) on the remote to start playback.
- 4 Press ◻ (STOP) to stop playback.

Note When you press the ► (PLAY) button again, the playback will resume from where it last stopped. To start playback from the beginning, press the ◻ (STOP) button twice to cancel the resume mode. Press ► (PLAY) to start playback.

- 5 To eject the disc, press and hold ◻ (STOP) or press ▲ (EJECT) on the DVD system panel.

Note You may also access the same functions by using the corresponding touch screen buttons on the DVD system panel.

Listen to radio

- 1 Press **SOURCE** on the remote control repeatedly to select the TUNER mode.
→ The display panel will show "AUTO INSTALL PRESS PLAY".

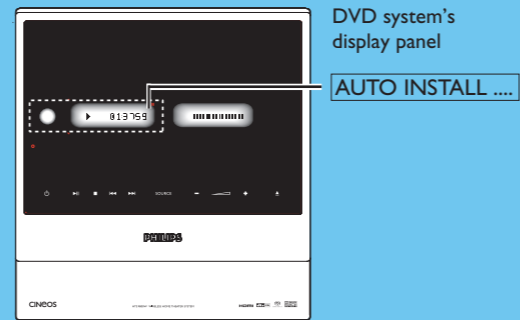

- 2 Press and hold ► (PLAY) on the remote control until "INSTALL TUNER" appears on the display panel.
→ All the available radio stations with strong signal strength will be stored automatically.
→ Once complete, the last tuned radio station will be played back.
- 3 Once complete, use ◀▶ keys to select a preset radio station.
- 4 To delete a preset radio station, press and hold ◻ (STOP) until "PRESET DELETED" appears.

Quick Start Guide



- 1 Connect
- 2 Set up
- 3 Enjoy

What's in the box?

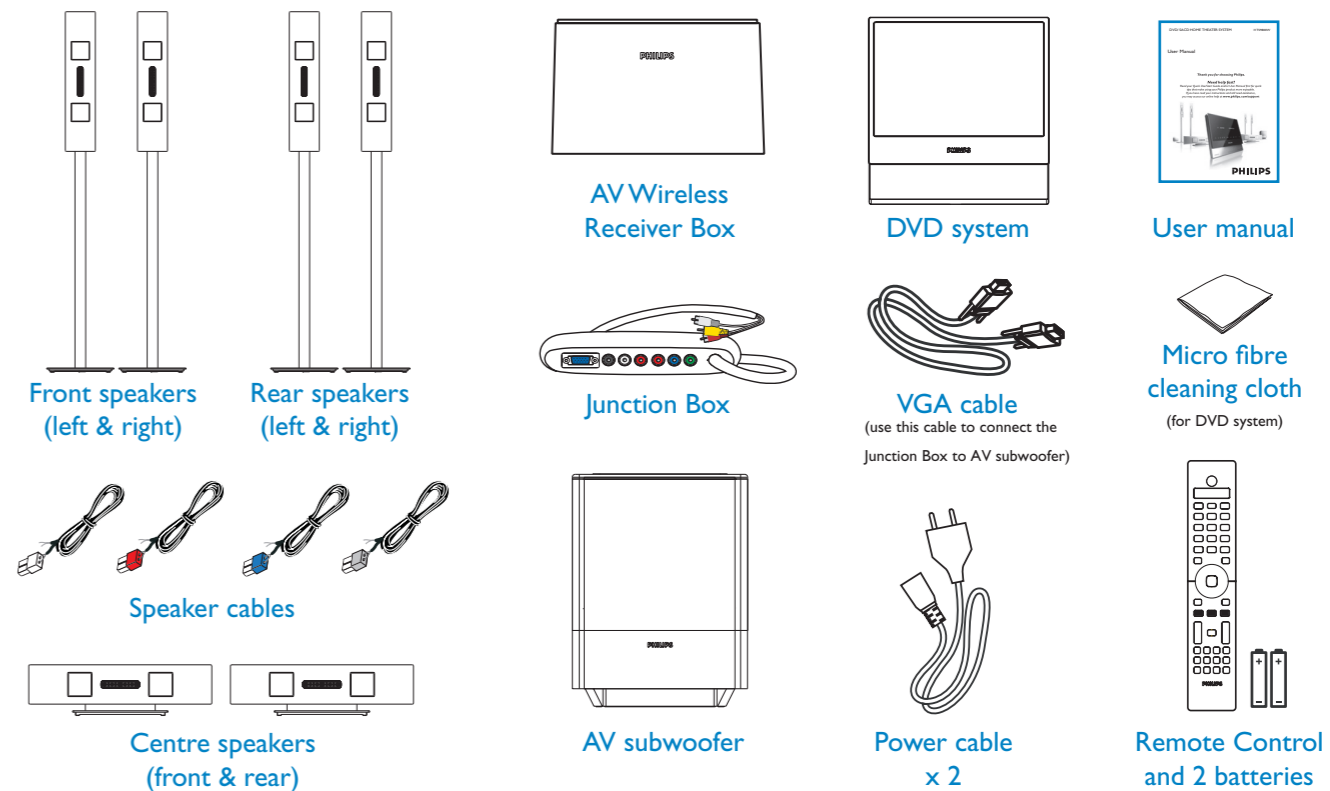

Need help?

User Manual

See the user manual that came with your Philips DVD/SACD Home Theater System.

Online

Go to www.philips.com/support.



2006 © Koninklijke Philips N.V.
All rights reserved.
12 NC 3139 245 23501
www.philips.com

PHILIPS

1 Connect

Placement and Connections

A Assemble the speakers

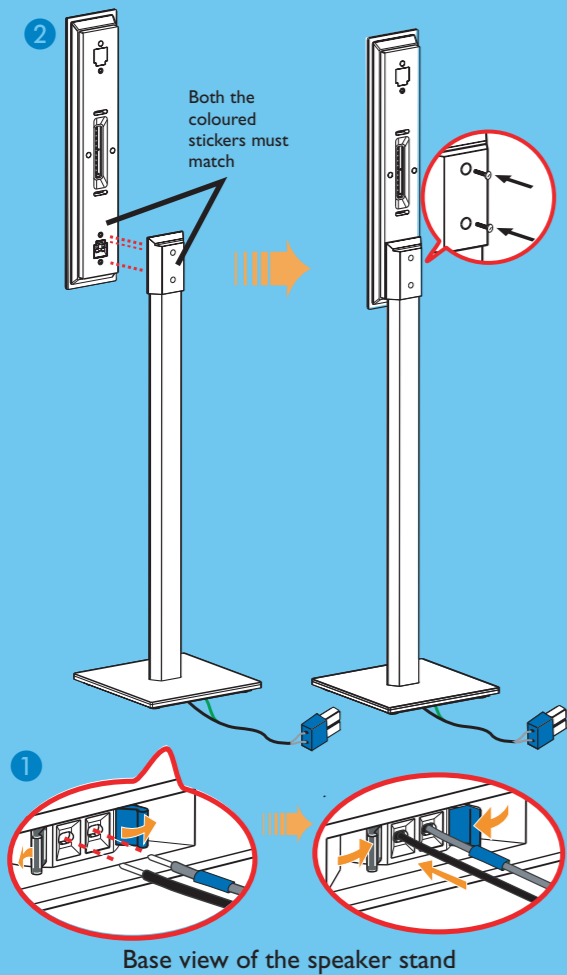

- 1 Connect the speaker stand with the supplied speaker wire. Match the colour of the speaker wire to the colour of the socket on the base of the speaker stand.
→ Hold down the socket tab while inserting the stripped portion of the speaker wire into the tab. Then, release the socket tab to lock the wire into position.
- 2 Match the coloured stickers on the rear of the speaker and the inside of the speaker stand. Position the speakers as shown and ensure the connectors fit. See the above illustration.
- 3 Secure the speaker stand with the supplied screws.

B Connect the front speakers and subwoofer

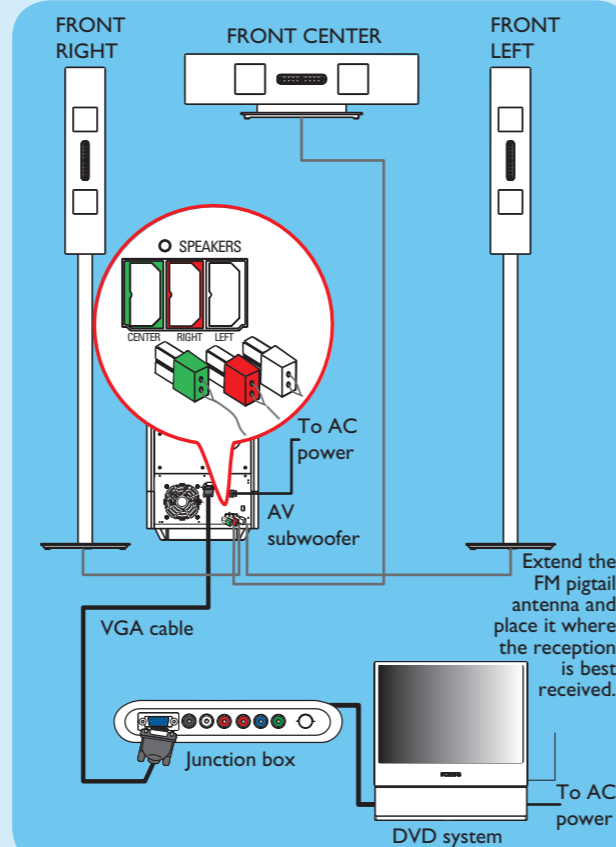

C Connect the rear speakers and AV wireless receiver box

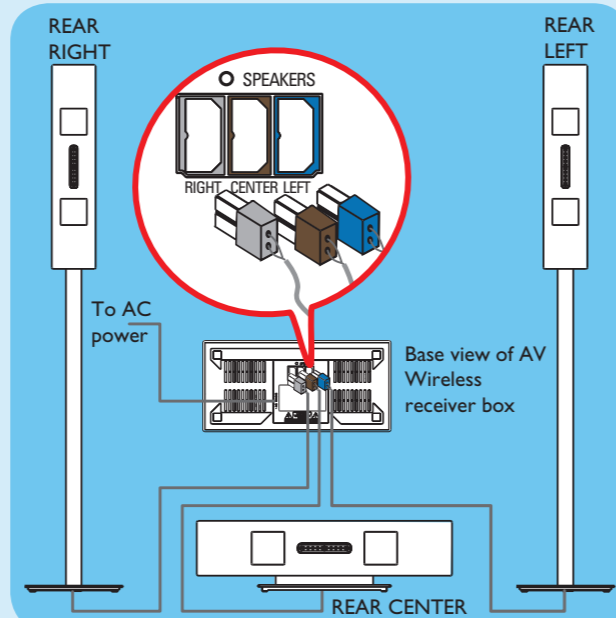

Note For optimal wireless performance, ensure that the AV wireless receiver box is not placed in an enclosed area.

D Position the speakers and subwoofer

Proper speakers and system placement is important to ensure optimum sound performance.

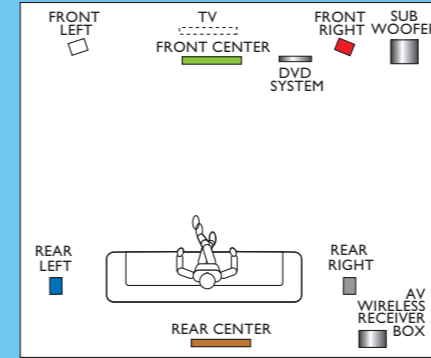

- 1 Place the FRONT CENTER speaker above or close to the TV.
- 2 Place the SUBWOOFER on the floor, at least one metre away from the TV.
- 3 Place the FRONT LEFT/RIGHT speakers at equal distances from the TV.
- 4 Place the REAR CENTER speaker at normal listening ear level.
- 5 Ensure the front of the AV Wireless Receiver box (with Philips logo) is facing towards the DVD system.

Note If there is an interference on your HTS9800W speakers or existing wireless network in your home, see the User Manual – “Troubleshooting”.

E Connect the Junction Box to the TV

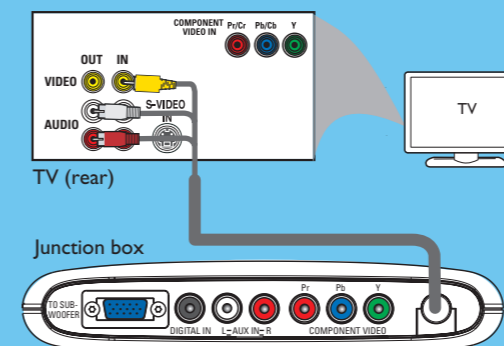

- Connect the audio/video cable from the Junction box to the AUDIO OUT/ VIDEO IN jacks on your TV.

2 Set up

A Finding the viewing channel

- 1 Press **SOURCE** on the remote control until “DISC” appears on the display panel.
- 2 Turn on the TV. Use the TV’s remote control to select the correct viewing channel for the DVD system.
You should see the blue DVD background on the TV.



Note To search for the correct viewing channel, press the CHANNEL DOWN button on the TV’s remote control repeatedly (or AV, SELECT button) until you see the blue DVD background.

B Select the display language on the screen

- 1 Press **SYSTEM MENU** on the remote.
- 2 Press to select { **General Setup Page** }.

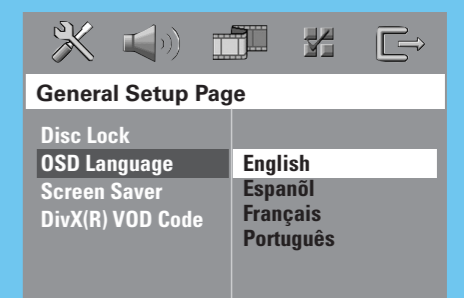

- 3 Use keys to select a language option in the menu and press **OK** to confirm.
- 4 Press **SYSTEM MENU** to exit.

Note The language selected here is only for the system menus that are shown on the TV while operating this DVD system, not for the DVD disc menu.

There are various system setup options (Audio Setup, Video Setup, Preference Setup) available on this DVD system. Refer to the accompanying user manual for more information.