

Register your product and get support at  
[www.philips.com/welcome](http://www.philips.com/welcome)

DC290



---

EN User manual 3

---

DA Brugervejledning 17

---

DE Benutzerhandbuch 31

---

ES Manual del usuario 47

---

FR Mode d'emploi 61

---

IT Manuale utente 77

---

NL Gebruiksaanwijzing 91

---

SV Användarhandbok 107

**PHILIPS**

# Contents

---

<b>1 Important</b>	<b>4</b>
Safety	4
Notice	5

---

<b>2 Your Docking Entertainment System</b>	<b>6</b>
Introduction	6
What's in the box	6
Overview of the main unit	7
Overview of the remote control	8

---

<b>3 Get started</b>	<b>9</b>
Install batteries	9
Connect power	10
Set time and date	10
Turn on	10

---

<b>4 Play</b>	<b>11</b>
Play from iPod/iPhone	11
Play from an external device	11

---

<b>5 Listen to radio</b>	<b>12</b>
Tune to a radio station	12
Program radio stations automatically	12
Program radio stations manually	12
Select a preset radio station	12

---

<b>6 Other features</b>	<b>13</b>
Set the alarm timer	13
Set the sleep timer	14
Adjust display brightness	14

---

<b>7 Adjust sound</b>	<b>14</b>
Adjust volume level	14
Mute sound	14
Select a preset sound effect	14
Enhance bass	14

---

---

<b>8 Product information</b>	<b>15</b>
Specifications	15

---

<b>9 Troubleshooting</b>	<b>16</b>
--------------------------	-----------

---

# 1 Important

## Safety

### Important Safety Instructions

- ① Read these instructions.
- ② Keep these instructions.
- ③ Heed all warnings.
- ④ Follow all instructions.
- ⑤ Do not use this apparatus near water.
- ⑥ Clean only with dry cloth.
- ⑦ Do not block any ventilation openings. Install in accordance with the manufacturer's instructions.
- ⑧ Do not install near any heat sources such as radiators, heat registers, stoves, or other apparatus (including amplifiers) that produce heat.
- ⑨ Protect the power cord from being walked on or pinched, particularly at plugs, convenience receptacles, and the point where they exit from the apparatus.
- ⑩ Only use attachments/accessories specified by the manufacturer.
- ⑪ Use only with the cart, stand, tripod, bracket, or table specified by the manufacturer or sold with the apparatus. When a cart is used, use caution when moving the cart/apparatus combination to avoid injury from tip-over.
- ⑫ Unplug this apparatus during lightning storms or when unused for long periods of time.
- ⑬ Refer all servicing to qualified service personnel. Servicing is required when the apparatus has been damaged in any way, such as power-supply cord or plug is damaged, liquid has been spilled or objects have fallen into the apparatus, the apparatus has been exposed to rain or moisture, does not operate normally, or has been dropped.
- ⑭ **Battery usage CAUTION** – To prevent battery leakage which may result in bodily injury, property damage, or damage to the unit:
  - Install all batteries correctly, + and - as marked on the unit.
  - Do not mix batteries (old and new or carbon and alkaline, etc.).
  - Remove batteries when the unit is not used for a long time.
- ⑮ Apparatus shall not be exposed to dripping or splashing.
- ⑯ Do not place any sources of danger on the apparatus (e.g. liquid filled objects, lighted candles).
- ⑰ Where the MAINS plug or an appliance coupler is used as the disconnect device, the disconnect device shall remain readily operable.



### Warning

- Never remove the casing of this apparatus.
- Never lubricate any part of this apparatus.
- Never place this apparatus on other electrical equipment.
- Keep this apparatus away from direct sunlight, naked flames or heat.
- Ensure that you always have easy access to the power cord, plug or adaptor to disconnect the apparatus from the power.

## Notice



This product complies with the radio interference requirements of the European Community.

Any changes or modifications made to this device that are not expressly approved by Philips Consumer Lifestyle may void the user's authority to operate the equipment.

## Recycling



Your product is designed and manufactured with high quality materials and components, which can be recycled and reused.

When you see the crossed-out wheel bin symbol attached to a product, it means the product is covered by the European Directive 2002/96/EC:



Never dispose of your product with other household waste. Please inform yourself about the local rules on the separate collection of electrical and electronic products. The correct disposal of your old product helps prevent potentially negative consequences on the environment and human health.

Your product contains batteries covered by the European Directive 2006/66/EC, which cannot be disposed of with normal household waste.



Please inform yourself about the local rules on separate collection of batteries. The correct disposal of batteries helps prevent potentially negative consequences on the environment and human health.

## Environmental information

All unnecessary packaging has been omitted. We have tried to make the packaging easy to separate into three materials: cardboard (box), polystyrene foam (buffer) and polyethylene (bags, protective foam sheet.)

Your system consists of materials which can be recycled and reused if disassembled by a specialized company. Please observe the local regulations regarding the disposal of packaging materials, exhausted batteries and old equipment.

## Norge

Typeskilt finnes på apparatens underside.

Observer: Nettbryteren er sekundert innkopleet. Den innebygde nettdelen er derfor ikke frakopleet nettet så lenge apparatet er tilsluttet nettkontakten.

For å redusere faren for brann eller elektrisk støt, skal apparatet ikke utsettes for regn eller fuktighet.

## 2 Your Docking Entertainment System

Congratulations on your purchase, and welcome to Philips! To fully benefit from the support that Philips offers, register your product at [www.philips.com/welcome](http://www.philips.com/welcome).

---

### Introduction

With this unit, you can enjoy audio from the iPod, iPhone, other audio devices, or the radio. The radio, iPod, or iPhone can be set as the alarm timer. You can set two alarm timers to go off at different time.

---

### What's in the box

Check and identify the contents of your package:

- Main unit
- Remote control
- 1 x MP3 link cable
- User manual
- Quick start guide

## Overview of the main unit

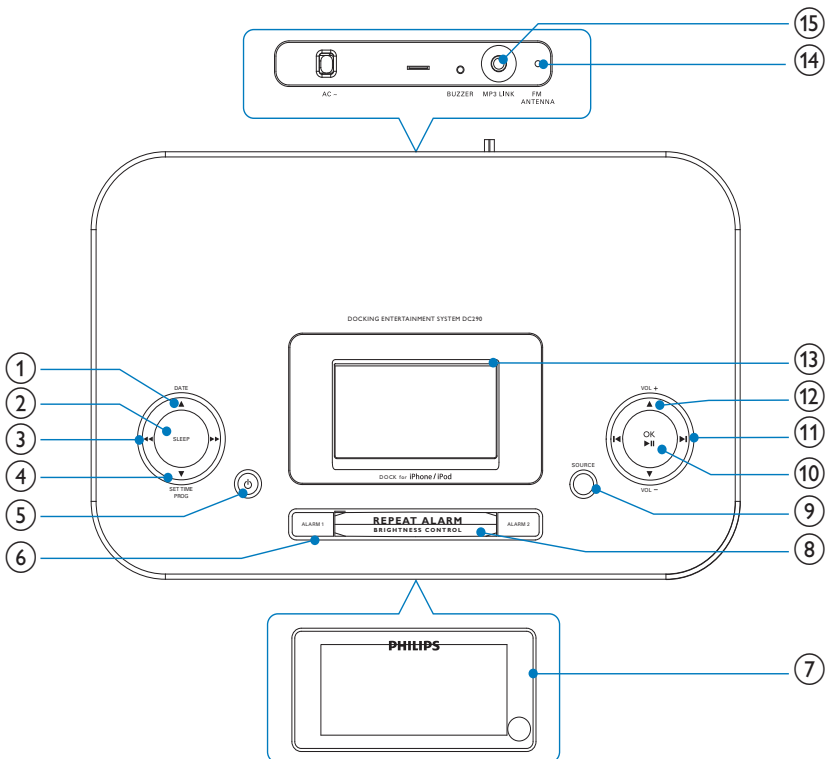

### ① ▲/DATE

- View the clock time and date.

### ② SLEEP

- Set the sleep timer.

### ③ ◀▶

- Search within an audio file.
- Tune to a radio station.

### ④ ▼/SET TIME/PROG

- Set the clock and date.
- Program radio stations.

### ⑤ ⏻

- Turn on the unit or switch to standby mode.
- Deactivate the sleep timer.
- Stop alarm.

### ⑥ ALM 1/ALM 2

- Set the alarm timer.
- Turn off the alarm tone.
- View alarm settings.

### ⑦ Display panel

- Show the current status.

### ⑧ REPEAT ALARM/BRIGHTNESS CONTROL

- Repeat the alarm.
- Adjust the display brightness.

### ⑨ SOURCE

- Select a source: iPod/iPhone, FM tuner or MP3 link.

### ⑩ OK/▶||

- Start or pause iPod/iPhone play.
- Confirm selection.

- ⑪ **⏮️▶️**
  - Skip to the previous/next audio file.
  - Select a preset radio station.
  - Adjust time.
- ⑫ **VOL +/-**
  - Adjust volume.
- ⑬ **Dock for iPod/iPhone**
  - Load an iPod/iPhone.
- ⑭ **FM antenna**
  - Improve FM reception.
- ⑮ **MP3-LINK**
  - Jack for an external audio device.

## Overview of the remote control

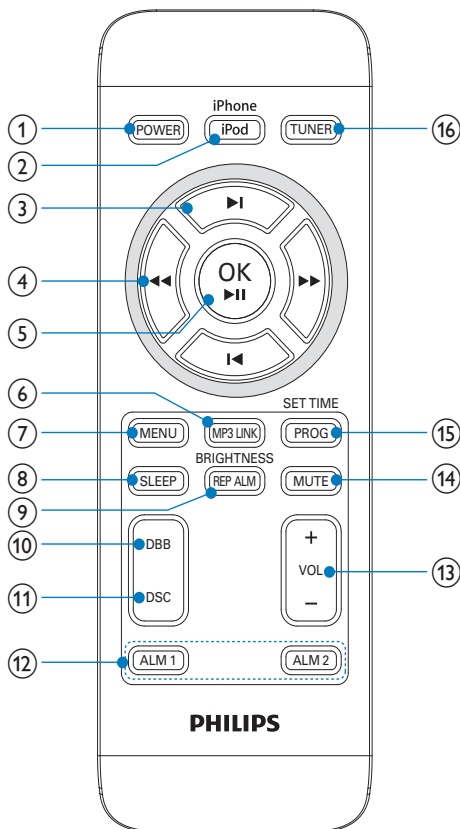

- ① **POWER**
  - Turn on the unit or switch to standby mode.
  - Stop alarm.
  - Deactivate the sleep timer.
- ② **iPhone/iPod**
  - Select iPhone or iPod source.

- 3 **⏮▶**
  - Skip to the previous/next audio file.
  - Select a preset radio station.
  - Navigate through the iPod/iPhone menu.
  - Adjust time.
- 4 **⏪▶▶**
  - Search within an audio file.
  - Tune to a radio station.
- 5 **OK/▶||**
  - Start or pause iPod/iPhone play.
  - Confirm selection.
- 6 **MP3 LINK**
  - Select external audio device source.
- 7 **MENU**
  - Select the iPhone/iPod menu.
- 8 **SLEEP**
  - Set the sleep timer.
- 9 **BRIGHTNESS/REP ALM**
  - Adjust the display brightness.
  - Repeat the alarm.
- 10 **DBB**
  - Turn on or off dynamic bass enhancement.
- 11 **DSC**
  - Select a preset sound setting.
- 12 **ALM 1/ALM 2**
  - Set the alarm timer.
  - Turn off the alarm tone.
  - View alarm settings.
- 13 **VOL +/-**
  - Adjust volume.
- 14 **MUTE**
  - Mute volume.
- 15 **SET TIME/PROG**
  - Set the clock and date.
  - Program radio stations.
- 16 **TUNER**
  - Select the tuner source.

## 3 Get started

### ! Caution

- Use of controls or adjustments or performance of procedures other than herein may result in hazardous radiation exposure or other unsafe operation.

Always follow the instructions in this chapter in sequence.

If you contact Philips, you will be asked for the model and serial number of this apparatus. The model number and serial number are on the rear of the apparatus. Write the numbers here:  
 Model No. \_\_\_\_\_  
 Serial No. \_\_\_\_\_

## Install batteries

### ≡ Note

- You can only use AC power as power supply. Batteries (not supplied) are for backup purpose.

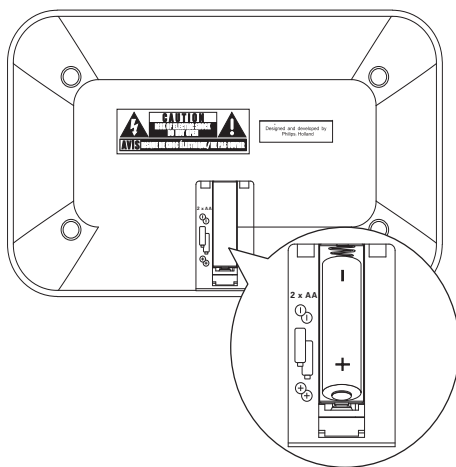



- 1 Open the battery compartment.
- 2 Insert 2 x R6/UM-3/AA size batteries with correct polarity (+/-) as indicated.
- 3 Close the battery compartment.

---

## Connect power

### ! Caution

- Risk of product damage! Ensure that the power voltage corresponds to the voltage printed on the back or underside of the apparatus.
- Risk of electric shock! When you unplug the AC power cord, always pull the plug from the socket. Never pull the cord.
- Before connecting the AC power cord, ensure you have completed all other connections.

### ☰ Note

- The type plate is located on the bottom of the main unit.

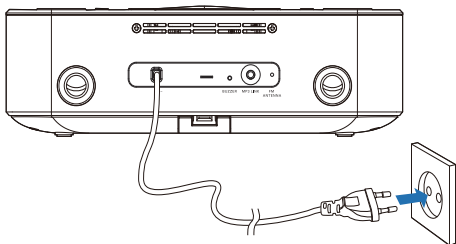

- 1 Connect the AC power cord to the wall outlet.

---

## Set time and date

- 1 In standby mode, press and hold **SET TIME/PROG** for 2 seconds.  
↳ [24 HR] begins to blink.
- 2 Press **OK/▶||** to select the 12/24 hour format.

- 3 Press **SET TIME/PROG** to confirm.  
↳ The hour digits begin to blink.
- 4 Press **◀|▶** to set the hour.
- 5 Press **SET TIME/PROG** to confirm.  
↳ The minute digits begin to blink.
- 6 Repeat steps 4-5 to set the minute, year, month, and day.

### ✱ Tip

- In 12 hour format, [MONTH--DAY] is displayed.
- in 24 hour format, [DAY--MONTH] is displayed.

---

## Turn on

- 1 Press **POWER**.  
↳ The unit switches to the last selected source.

---

## Switch to standby

- 1 Press **POWER** again to switch the unit to standby mode.  
↳ The time and date (if set) appear on the display panel.

## 4 Play

### Play from iPod/iPhone

You can enjoy audio from iPod/iPhone through this unit.

#### Compatible iPod/iPhone

Apple iPod and iPhone models with a 30-pin dock connector:

- iPod classic, iPod touch, iPod nano, iPod 5th generation (video), iPod with color display, iPod mini.
- iPhone, iPhone 3G, iPhone 3GS.

#### Listen to the iPod/iPhone

- 1 Lift up the iPhone/iPod dock on the top panel.

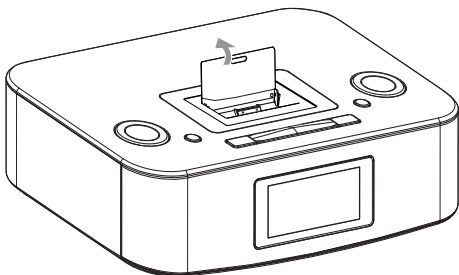

- 2 Place the iPhone/iPod into the dock.

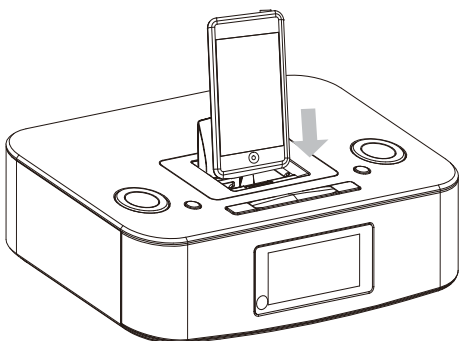

- 3 Press **iPhone/iPod** to select iPod/iPhone source.
  - ↳ The connected iPod/iPhone plays automatically.
    - To pause/resume play, press **OK/▶||**.
    - To skip to a track, press **◀▶**.
    - To search during play, press and hold **◀▶▶**, then release to resume normal play.
    - To go back to the previous iPod/iPhone menu, press **MENU**. To scroll through the menu, press **◀▶**. To confirm a selection, press **OK/▶||**.
      - ↳ If no key is pressed for more than 10 seconds, **OK/▶||** acts back as the play/pause key.

### Charge the iPod/iPhone

When the unit is connected to power, the docked iPod/iPhone begins to charge.



#### Tip

- For certain iPod models, it may take up to a minute before the charging indication appears.

### Play from an external device

You can also listen to an external audio device through this unit.

- 1 Press **MP3 LINK** to select the MP3 link source.
- 2 Connect the supplied MP3 link cable to:
  - the **MP3 LINK** jack (3.5mm) on the back of the unit.
  - the headphone jack on an external device.
- 3 Start to play the device (see the device user manual).

## 5 Listen to radio

### Note

- Only FM radio reception is available on this unit.

## Tune to a radio station

### Tip

- Position the antenna as far as possible from TV, VCR or other radiation source.

### Note

- For optimal reception, fully extend and adjust the position of the antenna.

- 1 Press **TUNER** to select FM tuner.
- 2 Press and hold **◀▶▶** for more than 2 seconds.
  - ↳ [Srch] (search) is displayed.
  - ↳ The radio tunes to a station with strong reception automatically.
- 3 Repeat step 2 to tune to more stations.
  - To tune to a weak station, press **◀▶▶** repeatedly until you find optimal reception.

## Program radio stations automatically

You can program a maximum of 20 preset radio stations.

- 1 In the tuner mode, press and hold **SET TIME/PROG** for more than 2 seconds to activate automatic program mode.
  - ↳ [AUTO] (auto) is displayed.
  - ↳ All available stations are programmed in the order of waveband reception strength.
  - ↳ The first programmed radio station is broadcast automatically.

## Program radio stations manually

You can program a maximum of 20 preset radio stations.

- 1 Tune to a radio station.
- 2 Press **SET TIME/PROG** to activate the program mode.
- 3 Press **◀▶▶** to select a number.
- 4 Press **SET TIME/PROG** to confirm.
- 5 Repeat the above steps to program other stations.

### Tip

- To overwrite a programmed station, store another station in its place.

## Select a preset radio station

- 1 Press **◀▶▶** to select a preset number.

## 6 Other features

### Set the alarm timer

You can set two alarms which go off at different time.

- 1 Ensure that you have set the clock correctly. (See "Get started - Set time and date".)
- 2 Press and hold **ALM 1** or **ALM 2** for 2 seconds.  
↳ [AL 1] or [AL 2] begin to blink.
- 3 Press **SOURCE** on the top panel to select an alarm sound source: iPod/iPhone, FM tuner, or buzzer.
- 4 Press **ALM 1** or **ALM 2**.  
↳ The hour digits begin to blink.
- 5 Press **◀/▶** repeatedly to set the hour.
- 6 Press **ALM 1** or **ALM 2** to confirm.  
↳ The minute digits begin to blink.
- 7 Repeat steps 5-6 to set the minute.
- 8 Repeat steps 5-6 to select whether to ring alarm the whole week, on weekdays, or at weekend.
- 9 Repeat steps 5-6 to set the alarm volume.

#### Tip

- If you set iPhone/iPod playlist as the sound source, you must create a playlist in iTunes called "PHILIPS" and import it to your iPhone/iPod.
- If no playlist is created in the iPod/iPhone or there is no song in the playlist, the unit will wake to songs in the iPod/iPhone.

### Activate and deactivate the alarm timer

- 1 Press **ALM 1** or **ALM 2** repeatedly to activate or deactivate the timer.  
↳ If the timer is activated, [**AL 1**] or [**AL 2**] is displayed.  
↳ If the timer is deactivated, [**AL1**] or [**AL2**] disappears.

### Repeat alarm

- 1 When the alarm rings, press **BRIGHTNESS/REP ALM**.  
↳ The alarm repeats ringing minutes later.

#### Tip

- You can press **◀/▶** to adjust the interval to repeat alarm.

### Stop alarm ring

- 1 When the alarm rings, press the corresponding **ALM 1** or **ALM 2**.  
↳ The alarm stops but the alarm settings remain.

### View the alarm settings

- 1 Press **ALM 1** or **ALM 2**.

---

## Set the sleep timer

This unit can switch to standby automatically after a set period of time.

- 1 Press **SLEEP** repeatedly to select a set period of time (in minutes).
  - ↳ When the sleep timer is activated, the display shows **zZ**, and the volume will gradually decrease in the last 5 minutes.

### To deactivate sleep timer

- 1 Press **SLEEP** repeatedly until **[OFF]** (off) is displayed.
  - ↳ When the sleep timer is deactivated, **zZ** disappears on the display.

---

## Adjust display brightness

- 1 Press **BRIGHTNESS/REP ALM** repeatedly to select different levels of display brightness.

---

# 7 Adjust sound

---

## Adjust volume level

- 1 During play, press **VOL +/-** to increase/decrease the volume level.

---

## Mute sound

- 1 During play, press **MUTE** to mute/unmute sound.

---

## Select a preset sound effect

- 1 During play, press **DSC** repeatedly to select:
  - **[POP]** (pop)
  - **[JAZZ]** (jazz)
  - **[CLAS]** (classic)
  - **[ROCK]** (rock)
  - **[FLAT]** (flat)

---

## Enhance bass

- 1 During play, press **DBB** to turn on or off dynamic bass enhancement.
  - ↳ If DBB is activated, **[DBB]** is displayed.

# 8 Product information



## Note

- Product information is subject to change without prior notice.

## General information

AC power	220V-230V~ 50Hz
Operation Power Consumption	7.5 W
Standby Power Consumption	<2 W
Dimensions	
- Main Unit (W x H x D)	263 x78 x 165 mm
Weight	
- With Packing	2.1 kg
- Main Unit	1.36 kg

## Specifications

### Amplifier

Rated Output Power	2 x 5 W RMS
Frequency Response	20 -20000 Hz, -3dB
Signal to Noise Ratio	>67 dB
Total Harmonic Distortion	<1%
Aux Input (MP3 link)	0.5 V RMS 20kohm

### Tuner

#### FM

Tuning Range	87.5 - 108 MHz
Tuning grid	50 KHz
Sensitivity	
- Mono, 26dB S/N Ratio	<22 dBu
- Stereo, 46dB S/N Ratio	<43 dBu
Search Selectivity	>28dBf
Total Harmonic Distortion	<2%
Signal to Noise Ratio	>55 dB

### Speakers

Speaker Impedance	4 ohm
Speaker Driver	2.25"
Sensitivity	>84dB/m/W

# 9 Troubleshooting



## Warning

- Never remove the casing of this apparatus.

To keep the warranty valid, never try to repair the system yourself.

If you encounter problems when using this apparatus, check the following points before requesting service. If the problem remains unsolved, go to the Philips web site ([www.philips.com/welcome](http://www.philips.com/welcome)). When you contact Philips, ensure that the apparatus is nearby and the model number and serial number are available.

### No power

- Ensure that the AC power plug of the unit is connected properly.
- Ensure that there is power at the AC outlet.
- Ensure that the batteries are inserted correctly.

### No sound

- Adjust the volume.

### No response from the unit

- Disconnect and reconnect the AC power plug, then turn on the unit again.

### Poor radio reception

- Increase the distance between the unit and your TV or VCR.
- Fully extend the FM antenna.

### Timer does not work

- Set the clock correctly.
- Switch on the timer.

### Clock/timer setting erased

- Power has been interrupted or the power plug has been disconnected.
- Reset the clock/timer.

