

Register your product and get support at
www.philips.com/welcome

MCM206



EN	User manual	3
DE	Benutzerhandbuch	21
EL	Εγχειρίδιο χρήσης	41
ES	Manual de usuario	61
FR	Mode d'emploi	81
NL	Gebruiksaanwijzing	101
PT	Manual do utilizador	121

PHILIPS

Contents

1 Important	4	8 Use more of your Micro System	17
Safety	4	Set the sleep timer	17
Notice	5	Set the alarm timer	17
		Listen through headphone	17
2 Your Micro System	7		
Introduction	7	9 Product information	18
What's in the box	7	Specifications	18
Overview of the main unit	8	Supported MP3 disc formats	18
Overview of the remote control	9	USB playability information	19
		Maintenance	19
3 Get started	11		
Connect speakers	11	10 Troubleshooting	20
Connect power	11		
Install remote control batteries	11		
Set clock	12		
Turn on	12		
4 Play	13		
Play disc	13		
Play from USB	13		
Listen to an external device	13		
5 Play options	14		
Repeat and random play	14		
Program tracks	14		
Display play information	14		
6 Listen to the radio	15		
Tune to a radio station	15		
Program radio stations automatically	15		
Program radio stations manually	15		
Select a preset radio station	15		
7 Adjust sound	16		
Adjust volume level	16		
Select a preset sound effect	16		
Enhance bass	16		
Mute sound	16		

1 Important

Safety

- ① Read these instructions.
- ② Keep these instructions.
- ③ Heed all warnings.
- ④ Follow all instructions.
- ⑤ Do not use this apparatus near water.
- ⑥ Clean only with dry cloth.
- ⑦ Do not block any ventilation openings. Install in accordance with the manufacturer's instructions.
- ⑧ Do not install near any heat sources such as radiators, heat registers, stoves, or other apparatus (including amplifiers) that produce heat.
- ⑩ Protect the power cord from being walked on or pinched, particularly at plugs, convenience receptacles, and the point where they exit from the apparatus.
- ⑩ Only use attachments/accessories specified by the manufacturer.
- ⑪ Use only with the cart, stand, tripod, bracket, or table specified by the manufacturer or sold with the apparatus. When a cart is used, use caution when moving the cart/apparatus combination to avoid injury from tip-over.
- ⑫ Unplug this apparatus during lightning storms or when unused for long periods of time.
- ⑬ Refer all servicing to qualified service personnel. Servicing is required when the apparatus has been damaged in any



way, such as power-supply cord or plug is damaged, liquid has been spilled or objects have fallen into the apparatus, the apparatus has been exposed to rain or moisture, does not operate normally, or has been dropped.

- ⑭ **Battery usage CAUTION** – To prevent battery leakage which may result in bodily injury, property damage, or damage to the apparatus:
 - Install all batteries correctly, + and - as marked on the apparatus.
 - Do not mix batteries (old and new or carbon and alkaline, etc.).
 - Remove batteries when the unit is not used for a long time.
 - The batteries shall not be exposed to excessive heat such as sunshine, fire or the like.
- ⑮ **Apparatus shall not be exposed to dripping or splashing.**
- ⑯ **Do not place any sources of danger on the apparatus (e.g. liquid filled objects, lighted candles).**
- ⑰ **Where the MAINS plug or an appliance coupler is used as the disconnect device, the disconnect device shall remain readily operable.**

Warning

- Never remove the casing of this apparatus.
- Never lubricate any part of this apparatus.
- Never place this apparatus on other electrical equipment.
- Keep this apparatus away from direct sunlight, naked flames or heat.
- Never look into the laser beam inside this apparatus.
- Ensure that you always have easy access to the power cord, plug or adaptor to disconnect this apparatus from the power.

Caution

- Use of controls or adjustments or performance of procedures other than herein may result in hazardous radiation exposure or other unsafe operation.

Hearing safety

Listen at a moderate volume.

- Using headphones at a high volume can impair your hearing. This product can produce sounds in decibel ranges that may cause hearing loss for a normal person, even for exposure less than a minute. The higher decibel ranges are offered for those that may have already experienced some hearing loss.
- Sound can be deceiving. Over time your hearing 'comfort level' adapts to higher volumes of sound. So after prolonged listening, what sounds 'normal' can actually be loud and harmful to your hearing. To guard against this, set your volume to a safe level before your hearing adapts and leave it there.

To establish a safe volume level:

- Set your volume control at a low setting.
- Slowly increase the sound until you can hear it comfortably and clearly, without distortion.

Listen for reasonable periods of time:

- Prolonged exposure to sound, even at normally 'safe' levels, can also cause hearing loss.
- Be sure to use your equipment reasonably and take appropriate breaks.

Be sure to observe the following guidelines when using your headphones.

- Listen at reasonable volumes for reasonable periods of time.
- Be careful not to adjust the volume as your hearing adapts.
- Do not turn up the volume so high that you can't hear what's around you.

- You should use caution or temporarily discontinue use in potentially hazardous situations. Do not use headphones while operating a motorized vehicle, cycling, skateboarding, etc.; it may create a traffic hazard and is illegal in many areas.

Notice

Any changes or modifications made to this device that are not expressly approved by Philips Consumer Lifestyle may void the user's authority to operate the equipment.



This item incorporates copy protection technology that is protected by U.S. patents and other intellectual property rights of Rovi Corporation. Reverse engineering and disassembly are prohibited.

Recording and playback of material might require consent. See Copyright Act 1956 and The Performer's Protection Acts 1958 to 1972.

This apparatus includes this label:



This product complies with the radio interference requirements of the European Community.



Any changes or modifications made to this device that are not expressly approved by Philips Consumer Lifestyle may void the user's authority to operate the equipment.

Recycling

Your product is designed and manufactured with high quality materials and components, which can be recycled and reused.



When this crossed-out wheeled bin symbol is attached to a product it means that the product is covered by the European Directive 2002/96/EC.



Please inform yourself about the local separate collection system for electrical and electronic products.

Please act according to your local rules and do not dispose of your old products with your normal household waste. Correct disposal of your old product helps to prevent potential negative consequences for the environment and human health.

Your product contains batteries covered by the European Directive 2006/66/EC, which cannot be disposed with normal household waste. Please inform yourself about the local rules



on separate collection of batteries because correct disposal helps to prevent negative consequences for the environmental and human health.

Environmental information

All unnecessary packaging has been omitted. We have tried to make the packaging easy to separate into three materials: cardboard (box), polystyrene foam (buffer) and polyethylene (bags, protective foam sheet.)

Your system consists of materials which can be recycled and reused if disassembled by a specialized company. Please observe the local regulations regarding the disposal of packaging materials, exhausted batteries and old equipment.

Norge

Typeskilt finnes på apparatens underside.

Observer: Nettbryteren er sekundært innkoplet. Den innebygde nettdelen er derfor ikke frakoplet nettet så lenge apparatet er tilsluttet nettkontakten.

For å redusere faren for brann eller elektrisk støt, skal apparatet ikke utsettes for regn eller fuktighet.

2 Your Micro System

Congratulations on your purchase, and welcome to Philips! To fully benefit from the support that Philips offers, register your product at www.Philips.com/welcome.

Introduction

With this apparatus, you can enjoy music from audio discs, external devices, and listen to radio stations.

The apparatus offers you multiple sound effect settings that enrich sound with Digital Sound Control (DSC) and Dynamic Bass Boost (DBB).

The apparatus supports the following media formats:



Note

- The type plate is located on the back of the apparatus.

What's in the box

Check and identify the contents of your package:

- Main unit
- Power adapter
- Loudspeaker boxes x 2
- Remote control
- MP3 link cable

Overview of the main unit

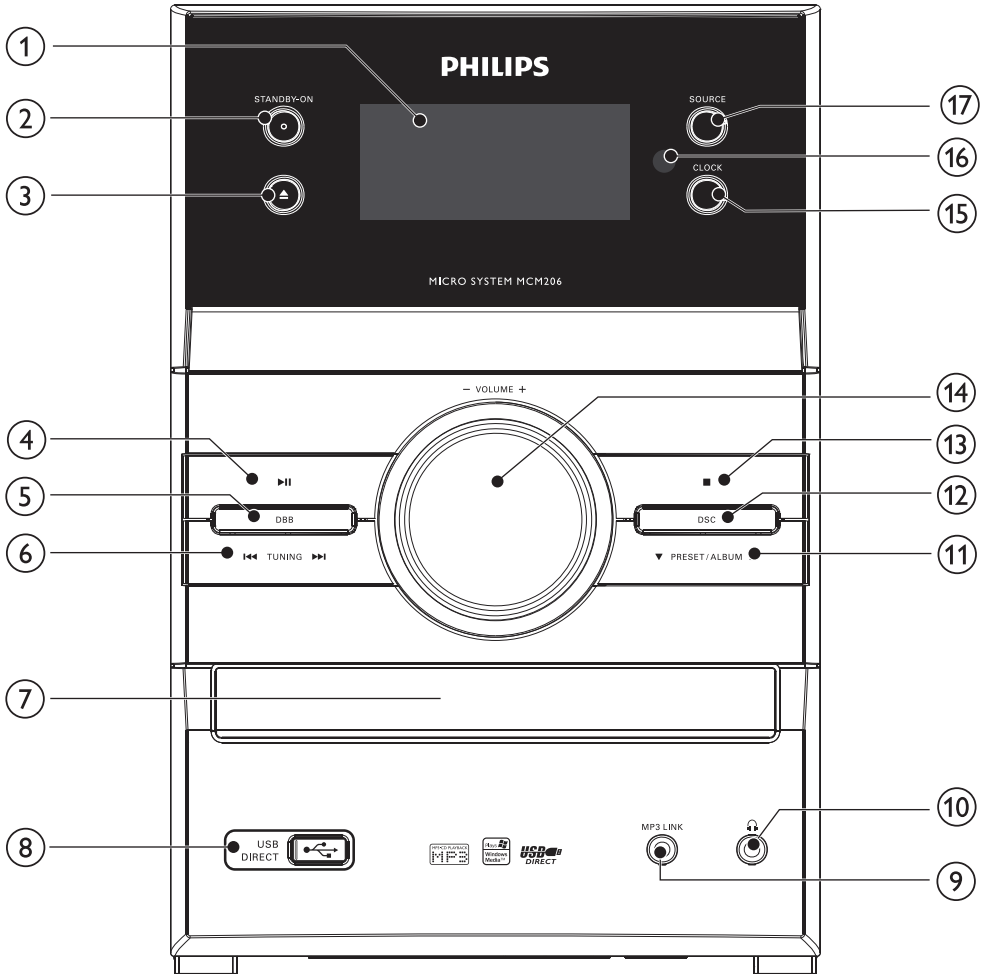

① Display panel

- Display current status.

② STANDBY-ON

- Turn on the apparatus; switch to standby mode.

③ ▲

- Open or close the disc compartment.

④ ►►



- Start or pause play.

⑤ DBB

- Turn on or off dynamic bass enhancement.

⑥ TUNING ◀◀▶▶

- Skip to the previous/next track.
- Tune to a radio station.

- Search within a track.
- ⑦ **Disc compartment**
- ⑧ 
- USB socket.
- ⑨ **MP3 LINK**
- Jack for an external audio device.
- ⑩ 
- Headphone socket.
- ⑪ **PRESET/ALBUM▲▼**
- Select a preset radio station.
 - Skip to the previous/next album.
- ⑫ **DSC**
- Select a preset sound setting.
- ⑬ 
- Stop play.
 - Erase a program.
- ⑭ **- VOLUME +**
- Adjust volume.
 - Adjust time.
- ⑮ **CLOCK**
- Set the clock.
 - View the clock.
- ⑯ **Remote control sensor**
- ⑰ **SOURCE**
- Select a source.

Overview of the remote control

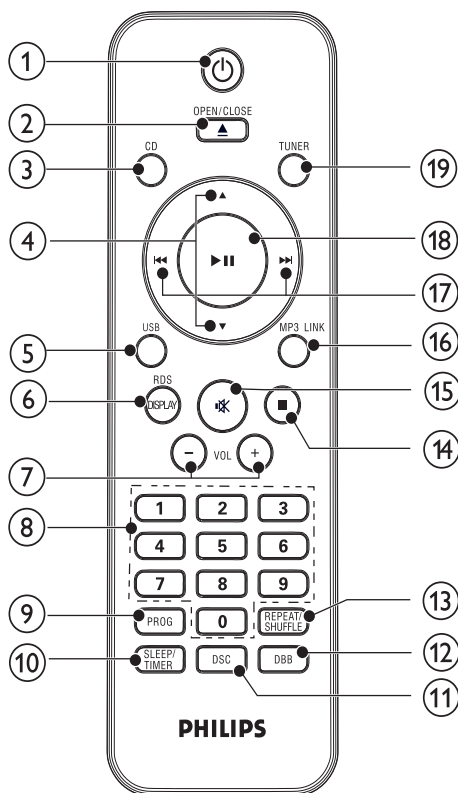

- ① 
- Switch to standby mode, or Eco Power standby mode.
- ② **OPEN/CLOSE**
- Open or close the disc compartment.
- ③ **CD**
- Select disc source.
- ④ **▲▼**
- Skip to the previous/next album.
 - Select a preset radio station.
- ⑤ **USB**
- Select USB device source.

- ⑥ **DISPLAY**
 - Select display information during play.
- ⑦ **VOL +/-**
 - Adjust volume.
 - Adjust time.
- ⑧ **Numeric keypad 0-9**
 - Select a preset radio station.
 - Select a track from a disc directly.
- ⑨ **PROG**
 - Program radio stations.
 - Program tracks.
- ⑩ **SLEEP/TIMER**
 - Set the sleep timer.
 - Set the alarm timer.
 - Activate or deactivate timer.
- ⑪ **DSC**
 - Select a preset sound setting.
- ⑫ **DBB**
 - Turn on or off dynamic bass enhancement.
- ⑬ **REPEAT/SHUFFLE**
 - Select repeat play modes.
 - Select shuffle play modes.
- ⑭ **■**
 - Stop play.
 - Erase a program.
- ⑮ **🔇**
 - Mute or restore volume.
- ⑯ **MP3 LINK**
 - Select external audio device source.
- ⑰ **⏮️⏪⏩⏭**
 - Tune to a radio station.
 - Skip to the previous/next track.
 - Search within a track.
- ⑱ **▶️⏸️**
 - Start or pause play.
- ⑲ **TUNER**
 - Select tuner source.

3 Get started

! Caution

- Use of controls or adjustments or performance of procedures other than herein may result in hazardous radiation exposure or other unsafe operation.

Always follow the instructions in this chapter in sequence.

If you contact Philips, you will be asked for the model and serial number of this apparatus. The model number and serial number are on the back of the apparatus. Write the numbers here:

Model No. _____

Serial No. _____

Connect speakers

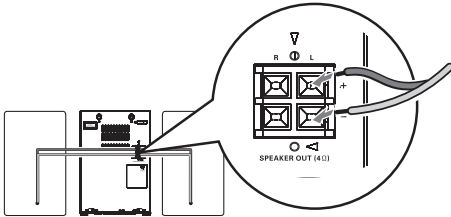

☰ Note

- Ensure that the colors of the speaker wires and terminals are matched.

- 1 Hold down the socket flap.
- 2 Insert the stripped part of the wire completely.
 - Insert the right speaker wires to "R", left speaker wires to "L".
 - Insert the red/blue wires to "+", black wires to "-".
- 3 Release the socket flap.

Connect power

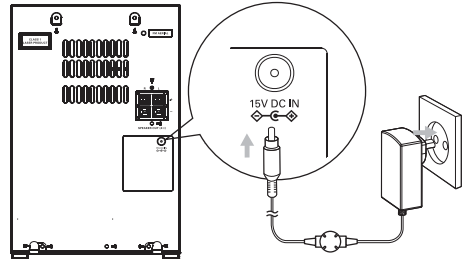

! Caution

- Risk of product damage! Ensure that the power supply voltage corresponds to the voltage printed on the back or the underside of the apparatus.
- Risk of electric shock! When you unplug the AC power cord, always pull the plug from the socket. Never pull the cord.
- Before connecting the AC power cord, ensure you have completed all other connections.

- 1 Connect the power adapter to
 - the **DC IN** jack on the rear of the main unit
 - the power socket.

Install remote control batteries

! Caution

- Risk of explosion! Keep batteries away from heat, sunshine or fire. Never discard batteries in fire.
- Risk of decreased battery life! Never mix different brands or types of batteries.
- Risk of product damage! When the remote control is not used for long periods, remove the batteries.

- 1 Open the battery compartment.
- 2 Insert 2 UM-4 AAA batteries with correct polarity (+/-) as indicated.

- 3 Close the battery compartment.

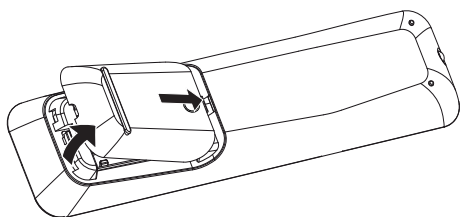

Set clock

- 1 In standby mode, press and hold **CLOCK** on the main unit to activate the clock setting mode.
- ↳ **[SET CLOCK]** (set clock) is displayed briefly. Then the hour digits are displayed and begin to blink.

Note

- In Eco Power Standby mode, press **CLOCK** to show clock first, then press and hold **CLOCK** to proceed clock setting.

- 2 Press **■** on the main unit repeatedly to select 12 hour or 24 hour format.
- 3 Turn **- VOLUME +** to set the hour.
- 4 Press **CLOCK** to confirm.
- ↳ The minute digits are displayed and begin to blink.
- 5 Turn **- VOLUME +** to set the minute.
- 6 Press **CLOCK** to confirm.

Turn on

- 1 Press **STANDBY-ON** on the main unit.
- ↳ The apparatus switches to the last selected source.

Switch to standby

- 1 Press **⏻** to switch the apparatus to standby mode.
- ↳ The backlight on the display panel is reduced.
 - ↳ The clock (if set) appears on the display panel.

To switch the apparatus to Eco Power

Standby mode:

- 1 In standby mode, press and hold **⏻** for more than 2 seconds.
- ↳ The backlight on the display panel turns off.

Note

- If no button is pressed over 15 minutes in Standby mode, the unit goes to Eco Power Standby mode automatically and the backlight on the display turns off.

4 Play

Play disc

- 1 Press **CD** to select the disc source.
- 2 Press **▲** to open the disc tray.
- 3 Insert a disc with the printed side facing up, then close the disc tray.
 - ↳ Play starts automatically.
 - To pause/resume play, press **▶||**.
 - To stop play, press **■**.
 - For MP3/WMA files: to select an album, press **▲▼**.
 - To skip to a track, press **◀◀▶▶**.
 - To search within a track, press and hold **◀◀▶▶**. Release to resume normal play.

Play from USB



Note

- Ensure that the USB device contains playable audio content.

- 1 Flip open the USB socket cover on the front panel.
- 2 Insert the USB plug of a USB device into the socket.

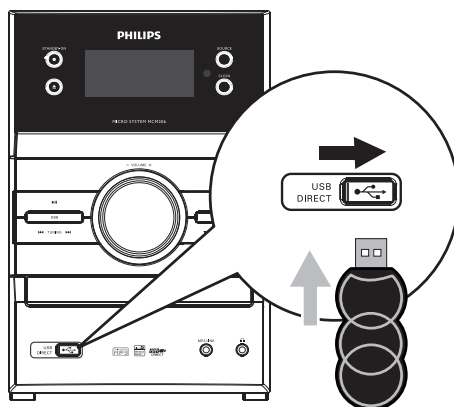

- 3 Press **USB** to select the USB source.
 - ↳ Play starts automatically.
 - To pause/resume play, press **▶||**.
 - To stop play, press **■**.
 - For MP3/WMA files: to select an album, press **▲▼**.
 - To skip to a track, press **◀◀▶▶**.
 - To search within a track, press and hold **◀◀▶▶**. Release to resume normal play.

Listen to an external device

You can also listen to an external audio device through this unit.

For an audio device with a headphone socket:

- 1 Press **MP3 LINK** to select the MP3 link source.
- 2 Connect the supplied MP3 link cable to
 - the **MP3 LINK** socket on this unit.
 - the headphone socket on an MP3 player.
- 3 Start to play the MP3 player. (See the user manual of the MP3 player)

5 Play options

Repeat and random play

- 1 Press **REPEAT/SHUFFLE** repeatedly to select:
 - **[REP]** (repeat): the current track is played repeatedly.
 - **[REP ALL]** (repeat all): all tracks are played repeatedly.
 - **[SHUF]** (shuffle): all tracks are played randomly.
 - **[SHUF REP ALL]** (repeat all randomly): all tracks are played repeatedly in random order.
- 2 To return to normal play, press **REPEAT/SHUFFLE** repeatedly until play mode is no longer displayed.

Program tracks

You can program a maximum of 20 tracks.

- 1 In CD/USB mode, at the stop position, press **PROG** to activate the program mode.
↳ **[PROG]** (program) blinks on the display.
- 2 For MP3/WMA tracks, press **▲▼** to select an album.
- 3 Press **◀▶** to select a track number, then press **PROG** to confirm.
- 4 Repeat steps 2 to 3 to program more tracks.
- 5 Press **▶||** to play the programmed tracks.
↳ During play, **[PROG]** (program) is displayed.
 - To erase the program, in the stop position, press **■**.
 - To review the program, in the stop position, press and hold **PROG** for more than 2 seconds.

Display play information

- 1 During play, press **DISPLAY/RDS** repeatedly to select different play information.

6 Listen to the radio

Tune to a radio station

Note

- For optimal reception, fully extend and adjust the position of the FM antenna.

- 1 Press **TUNER** to select the tuner source.
- 2 Press and hold **◀▶▶▶** for more than 2 seconds.
 - ↳ **[SEARCH]** (search) is displayed.
 - ↳ The radio tunes to a station with strong reception automatically.
- 3 Repeat step 2 to tune to more stations.
 - To tune to a weak station, press **◀▶▶▶** repeatedly until you find optimal reception.

Program radio stations automatically

Note

- You can program a maximum of 20 FM radio stations and 10 MW radio stations.

- 1 In tuner mode, press and hold **PROG** for 2 seconds to activate automatic program mode.
 - ↳ **[AUTO]** (auto) is displayed.
 - ↳ All available stations are programmed in the order of waveband reception strength.
 - ↳ The first programmed radio station is broadcast automatically.

Program radio stations manually

Note

- You can program a maximum of 20 FM radio stations and 10 MW radio stations.

- 1 Tune to a radio station.
- 2 Press **PROG** to activate program mode.
 - ↳ **[PROG]** (program) blinks on the display.
- 3 Press **▲▼** to allocate a number (1 to 20) to this radio station, then press **PROG** to confirm.
 - ↳ The preset number and the frequency of the preset station are displayed.
- 4 Repeat the above steps to program other stations.

Note

- To overwrite a programmed station, store another station in its place.

Select a preset radio station

- 1 In tuner mode, press **▲▼** to select a preset number.

7 Adjust sound

Adjust volume level

- 1 During play, press **VOL +/-** to increase/decrease the volume level.

Select a preset sound effect

- 1 During play, press **DSC** repeatedly to select:
 - **[POP]** (pop)
 - **[JAZZ]** (jazz)
 - **[CLASSIC]** (classic)
 - **[ROCK]** (rock)

Enhance bass

- 1 During play, press **DBB** to turn on or off dynamic bass enhancement.
↳ If DBB is activated, **[DBB]** is displayed.

Mute sound

- 1 During play, press **⏏** to mute/unmute sound.

8 Use more of your Micro System

Set the sleep timer

This unit can switch to standby automatically after a preset period of time.

- 1 When the unit is turned on, press **SLEEP/TIMER** repeatedly to select a set period of time (in minutes).
 - ↳ When sleep timer is activated, the display shows **zZ**.

To deactivate sleep timer

- 1 Press **SLEEP/TIMER** repeatedly until [**SLP OFF**] is displayed.
 - ↳ When sleep timer is deactivated, **zZ** disappears on the display.

Set the alarm timer

This unit can be used as an alarm clock. The DISC, TUNER or USB is activated to play at a preset time.

- 1 Ensure that you have set the clock correctly.
- 2 In standby mode, press and hold **SLEEP/TIMER** for more than 2 seconds.
- 3 Press **CD**, **TUNER** or **USB/MP3 LINK** to select a source.
- 4 Press **SLEEP/TIMER** to confirm.
 - ↳ The hour digits are displayed and begin to blink.
- 5 Press **VOL +/-** to set the hour.
- 6 Press **SLEEP/TIMER** to confirm.
 - ↳ The minute digits are displayed and begin to blink.
- 7 Press **VOL +/-** to set the minute.

- 8 Press **SLEEP/TIMER** to confirm.
 - ↳ The timer is set and activated.

Activate and deactivate the alarm timer

- 1 In standby mode, press **SLEEP/TIMER** repeatedly to activate or deactivate the timer.
 - ↳ If the timer is activated, the display shows **zZ**.
 - ↳ If the timer is deactivated, **zZ** disappears on the display.



Note

- If disc/USB device source is selected and the track cannot be played, tuner is activated automatically.

Listen through headphone

- 1 Plug a headphone into the  socket on the unit.

9 Product information



Note

- Product information is subject to change without prior notice.

Specifications

Amplifier

Rated Output Power	2X5W RMS
Frequency Response	60 - 16kHz, ± 3 dB
Signal to Noise Ratio	>62dB

Disc

Laser Type	Semiconductor
Disc Diameter	12cm/8cm
Support Disc	CD-DA, CD-R, CD-RW, MP3-CD, WMA-CD
Audio DAC	24Bits / 44.1kHz
Total Harmonic Distortion	<1%
Frequency Response	60Hz -16kHz
S/N Ratio	>62dBA

Tuner

Tuning Range	FM: 87.5 - 108MHz; MW: 531 - 1602kHz
Tuning grid	50 kHz (FM); 9 kHz (MW)
Total Harmonic Distortion	<3%
Signal to Noise Ratio	>50 dB

Speakers

Speaker Impedance	4ohm
-------------------	------

General information-Specs

Switching mode power supply	Model: GFP181T-1512-1 or GFP181DA-1512-1, Input: AC100-240V~, 50/60Hz, 0.35A Output: DC15V, 1.2A
Operation Power Consumption	26 W
Standby Power Consumption	<4 W
Eco Standby Power Consumption	<1 W
Dimensions	
- Main Unit (W x H x D)	152 x 232 x 222mm
- Speaker Box (W x H x D)	146 x 232 x 140mm
Weight	
- With Packing	5.03 kg
- Main Unit	1.64 kg
- Speaker Box	2.20 kg

Supported MP3 disc formats

- ISO9660, Joliet
- Maximum title number: 512 (depending on file name length)
- Maximum album number: 255
- Supported sampling frequencies: 32 kHz, 44.1kHz, 48 kHz
- Supported Bit-rates: 32~256 (kbps), variable bit rates

USB playability information

Compatible USB devices:

- USB flash memory (USB 2.0 or USB1.1)
- USB flash players (USB 2.0 or USB1.1)
- memory cards (requires an additional card reader to work with this apparatus)

Supported formats:

- USB or memory file format FAT12, FAT16, FAT32 (sector size: 512 bytes)
- MP3 bit rate (data rate): 32-320 Kbps and variable bit rate
- WMA v9 or earlier
- Directory nesting up to a maximum of 8 levels
- Number of albums/ folders: maximum 99
- Number of tracks/titles: maximum 999
- ID3 tag v2.0 - v2.4
- File name in Unicode UTF8 (maximum length: 128 bytes)

Unsupported formats:

- Empty albums: an empty album is an album that does not contain MP3/WMA files, and is not be shown in the display.
- Unsupported file formats are skipped. For example, Word documents (.doc) or MP3 files with extension .dlf are ignored and not played.
- AAC, WAV, PCM audio files
- DRM protected WMA files (.wav, .m4a, .m4p, .mp4, .aac)
- WMA files in Lossless format

Maintenance

Clean the cabinet

- Use a soft cloth slightly moistened with a mild detergent solution. Do not use a solution containing alcohol, spirits, ammonia or abrasives.

Clean discs

- When a disc becomes dirty, clean it with a cleaning cloth. Wipe the disc from the centre out.



- Do not use solvents such as benzene, thinner, commercially available cleaners, or antistatic spray intended for analogue records.

Clean the disc lens

- After prolonged use, dirt or dust may accumulate at the disc lens. To ensure good play quality, clean the disc lens with Philips CD lens cleaner or any commercially available cleaner. Follow the instructions supplied with cleaner.

10 Troubleshooting

Caution

- Never remove the casing of this apparatus.

To keep the warranty valid, never try to repair the system yourself.

If you encounter problems when using this apparatus, check the following points before requesting service. If the problem remains unsolved, go to the Philips web site (www.Philips.com/support). When you contact Philips, ensure that your apparatus is nearby and the model number and serial number are available.

No power

- Ensure that the AC power plug of the unit is connected properly.
- Ensure that there is power at the AC outlet.
- To save power, the system switches off automatically 15 minutes after track play reaches the end and no control is operated.

No sound or poor sound

- Adjust the volume.
- Check that the speakers are connected correctly.
- Check if the stripped speaker wires are clamped.

Left and right sound outputs reversed

- Check the speaker connections and location.

No response from the unit

- Disconnect and reconnect the AC power plug, then turn on the system again.
- As a power-saving feature, the unit switches off automatically 15 minutes after track play reaches the end and no control is operated.

Remote control does not work

- Before you press any function button, first select the correct source with the remote control instead of the main unit.
- Reduce the distance between the remote control and the unit.

- Insert the battery with its polarities (+/- signs) aligned as indicated.
- Replace the battery.
- Aim the remote control directly at the sensor on the front of the unit.

USB device not supported

- The USB device is incompatible with the apparatus. Try another one.

No disc detected

- Insert a disc.
- Check if the disc is inserted upside down.
- Wait until the moisture condensation at the lens has cleared.
- Replace or clean the disc.
- Use a finalized CD or correct format disc.

Poor radio reception

- Increase the distance between the unit and your TV or VCR.
- Fully extend the FM antenna.
- Connect an outdoor FM antenna instead.

Timer does not work

- Set the clock correctly.
- Switch on the timer.

Clock/timer setting erased

- Power has been interrupted or the power plug has been disconnected.
- Reset the clock/timer.

