

Mini Hi-Fi System

FWM196

Register your product and get support at
www.philips.com/welcome

User manual



PHILIPS

México



Es necesario que lea cuidadosamente su instructivo de manejo.

| | | |
|--|---|--|
| | PRECAUCIÓN - ADVERTENCIA | |
| | No abrir, riesgo de choque eléctrico | |
| | ATENCIÓN | |
| | Verifique que el voltaje de alimentación sea el requerido para su aparato | |
| Para evitar el riesgo de choque eléctrico, no quite la tapa. En caso de requerir servicio, dirijase al personal calificado. | | |

Descripción: **Minisistema de Audio**
Modelo : **FWM196/55**
Alimentación: **110-127 / 220-240V~; 50/60 Hz**
Consumo: **50W**
Importador: **Philips Mexicana, S.A. de C.V.**
Domicilio: **Av. La Palma No.6**
Col. San Fernando La Herradura
Huixquilucan
Localidad y Tel: **Edo. de México C.P. 52784**
Tel.52 69 90 00
Exportador: **Philips Electronics HK, Ltd.**
País de Origen: **China**
N° de Serie: _____

**LEA CUIDADOSAMENTE ESTE INSTRUCTIVO
ANTES DE USAR SU APARATO.**

AVISO IMPORTANTE

Philips Mexicana, S.A. de C.V. no se hace responsable por daños o desperfectos causados por:

- *Maltrato, descuido o mal uso, presencia de insectos o roedores (cucarachas, ratones etc.).*
- *Cuando el aparato no haya sido operado de acuerdo con el instructivo del uso, fuera de los valores nominales y tolerancias de las tensiones (voltaje), frecuencia (ciclaje) de alimentación eléctrica y las características que deben reunir las instalaciones auxiliares.*
- *Por fenómenos naturales tales como: temblores, inundaciones, incendios, descargas eléctricas, rayos etc. o delitos causados por terceros (choques asaltos, riñas, etc.).*

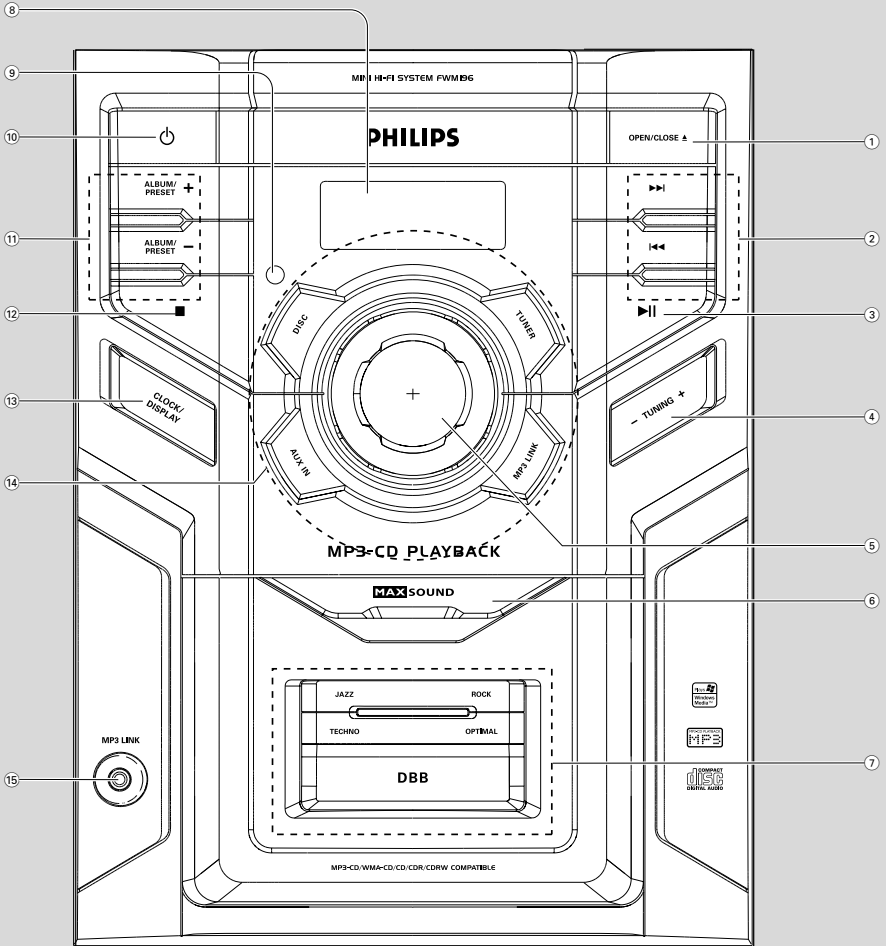

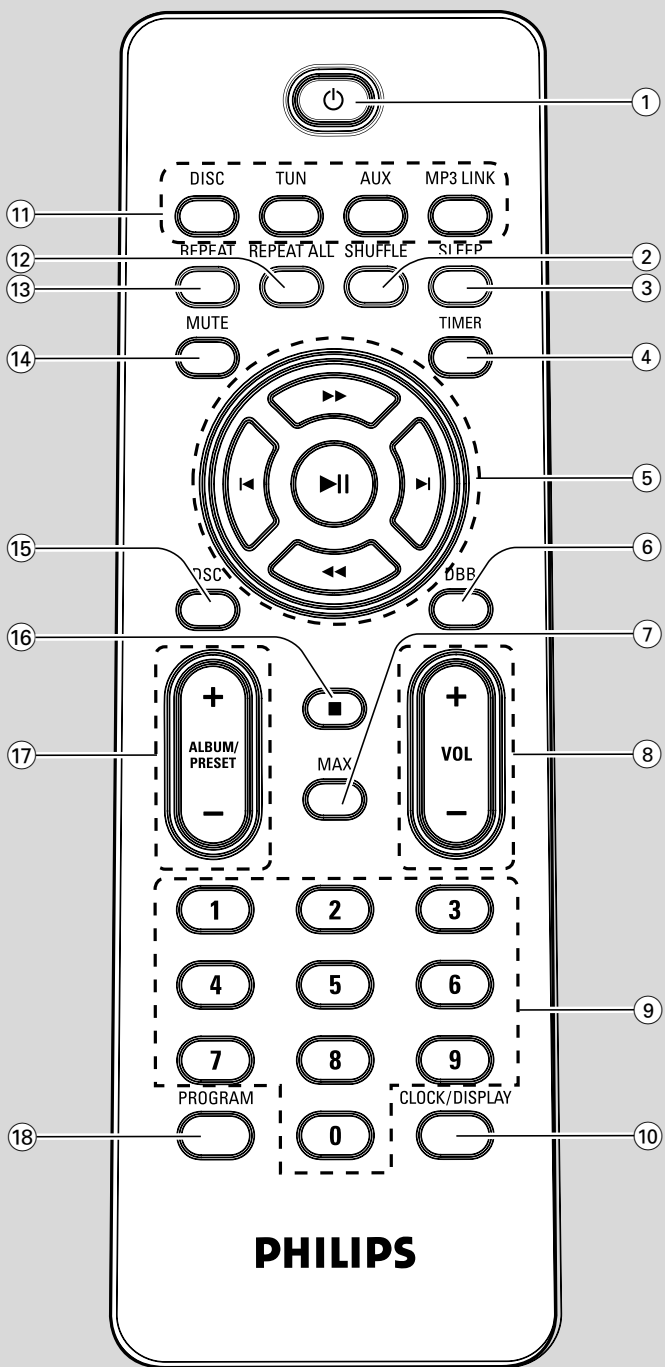

CAUTION

Use of controls or adjustments or performance of procedures other than herein may result in hazardous radiation exposure or other unsafe operation.

Contents

General Information

| | |
|---------------------------------|---|
| Supplied accessories | 7 |
| Environmental Information | 7 |
| Safety information | 7 |

Preparation

| | |
|--|---|
| Rear connections | 8 |
| Inserting batteries into the remote control .. | 9 |

Controls

| | |
|--------------------------------------|-------|
| Controls on the system | 10 |
| Controls on the remote control | 10-11 |

Basic Functions

| | |
|--------------------------------------|----|
| Switching the system on | 12 |
| Power-saving automatic standby | 12 |
| Adjusting volume and sound | 12 |

CD/MP3/WMA Operation

| | |
|--|-------|
| Playing a disc | 13 |
| Selecting a different track | 13 |
| Finding a passage within a track | 13 |
| Playing an MP3/WMA disc | 13-14 |
| Discs for playback | 14 |
| Different play modes: Shuffle and Repeat | 14 |
| Programming track numbers | 14 |
| Erasing the programme | 14 |

Radio Reception

| | |
|---------------------------------------|----|
| Tuning to radio stations | 15 |
| Programming radio stations | 15 |
| Tuning to preset radio stations | 15 |

External Sources

| | |
|--------------------------------|----|
| Using MP3 LINK | 16 |
| Using an external device | 16 |

Clock/Timer

| | |
|-------------------------------|----|
| Setting the clock | 17 |
| Setting the sleep timer | 17 |
| Setting the timer | 18 |

Specifications

| | |
|-------|----|
| | 19 |
|-------|----|

Maintenance

| | |
|-------|----|
| | 20 |
|-------|----|

Troubleshooting

| | |
|-------|-------|
| | 21-22 |
|-------|-------|

Congratulations on your purchase and welcome to Philips!

To fully benefit from the support that Philips offers, register your product at www.philips.com/welcome.

IMPORTANT!

PLEASE NOTE THAT THE VOLTAGE SELECTOR LOCATED AT THE REAR OF THIS SYSTEM IS PRESET AT 220V FROM THE FACTORY. FOR COUNTRIES THAT OPERATE AT 110V-127V, PLEASE ADJUST TO 110V-127V BEFORE YOU SWITCH ON THE SYSTEM.

Supplied accessories

- 2 speaker boxes
- remote control
- Audio cable (MP3 LINK)

Environmental Information

All unnecessary packaging has been omitted. We have tried to make the packaging easy to separate into three materials: cardboard (box), polystyrene foam (buffer) and polyethylene (bags, protective foam sheet).

Your system consists of materials which can be recycled and reused if disassembled by a specialized company. Please observe the local regulations regarding the disposal of packaging materials, exhausted batteries and old equipment.

Safety Information

- Before operating the system, check that the operating voltage indicated on the typeplate (or the voltage indication beside the voltage selector) of your system is identical with the voltage of your local power supply. If not, please consult your dealer.
- Place the system on a flat, hard and stable surface.
- Where the MAINS plug or an appliance coupler is used as the disconnect device, the disconnect device shall remain readily operable.
- Place the system in a location with adequate ventilation to prevent internal heat build-up in your system. Allow at least 10 cm (4 inches) clearance from the rear and the top of the unit and 5 cm (2 inches) from each side.
- The ventilation should not be impeded by covering the ventilation openings with items, such as newspapers, table-cloths, curtains, etc.
- Do not expose the system, batteries or discs to excessive moisture, rain, sand or heat sources caused by heating equipment or direct sunlight.
- No naked flame sources, such as lighted candles, should be placed on the apparatus.
- No objects filled with liquids, such as vases, shall be placed on the apparatus.
- The apparatus shall not be exposed to dripping or splashing.
- Install this unit near the AC outlet and where the AC power plug can be reached easily.
- If the system is brought directly from a cold to a warm location, or is placed in a very damp room, moisture may condense on the lens of the disc unit inside the system. Should this occur, the CD player would not operate normally. Leave the power on for about one hour with no disc in the system until normal playback is possible.
- The mechanical parts of the set contain self-lubricating bearings and must not be oiled or lubricated.
- Batteries (battery pack or batteries installed) shall not be exposed to excessive heat such as sunshine, fire or the like.
- **When the system is switched to Standby mode, it is still consuming some power. To disconnect the system from the power supply completely, remove the AC power plug from the wall socket.**

Preparations

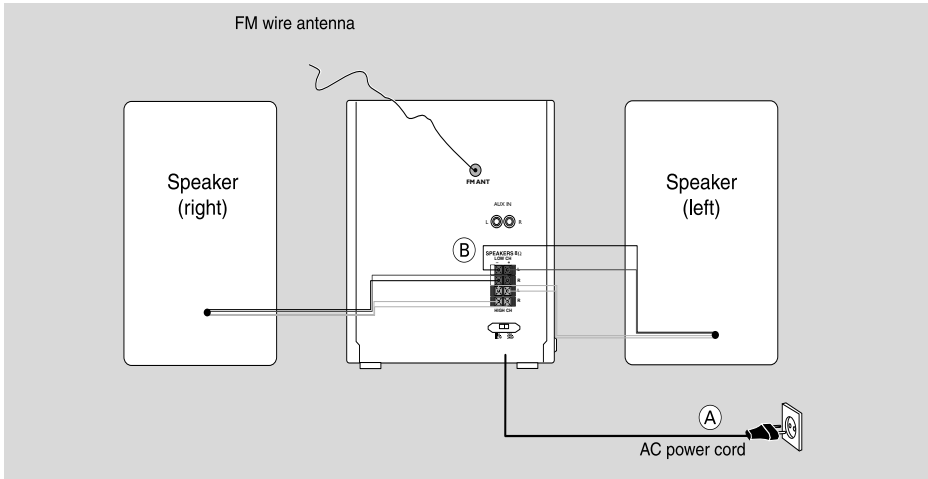

Rear connections

The type plate is located at the rear of the system.

(A) Power

- Before connecting the AC power cord to the wall outlet, ensure that all other connections have been made.
- If your system is equipped with a Voltage Selector; set the VOLTAGE SELECTOR to the local power line voltage.

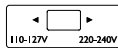

WARNING!

- For optimal performance, use only the original power cable.
- Never make or change any connections with the power switched on.

To avoid overheating of the system, a safety circuit has been built in. Therefore, your system may switch to Standby mode automatically under extreme conditions. If this happens, let the system cool down before reusing it (not available for all versions).

(B) Speakers Connection

Front Speakers

Connect the speaker wires to the SPEAKERS terminal, right speaker to "R" and left speaker to "L", red wires to "+" and black wires to "-" of the woofer connection terminals, blue wires to "+" and grey wires to "-" of the tweeter connection terminals.

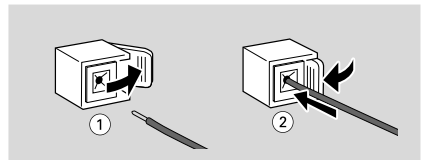

- Fully insert the stripped portion of the speaker wire into the terminal as shown.

Notes:

- For optimal sound performance, use the supplied speakers.
- Do not connect more than one speaker to any one pair of +/– speaker terminals.
- Do not connect speakers with an impedance lower than the speakers supplied. Please refer to the SPECIFICATIONS section of this manual.

Inserting batteries into the remote control

Insert two batteries type R03 or AAA into the remote control with the correct polarity as indicated by the "+" and "-" symbols inside the battery compartment.

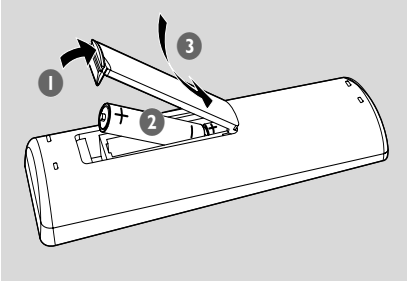

CAUTION!

- Remove batteries if they are exhausted or will not be used for a long time.
- Do not use old and new or different types of batteries in combination.
- Batteries contain chemical substances, so they should be disposed of properly.

Controls (illustrations on pages 3 and 4)

Controls on the system

- ① **OPEN/CLOSE**
 - open/close the CD compartment in DISC mode.
- ② **◀◀ / ▶▶**
 - skips to the beginning of a current track/ previous/ next track.
 - (press and hold) fast searches back and forward within a track/disc.
 - sets the hours and minutes for the clock and timer.
- ③ **▶||**
 - starts or pauses DISC playback.
- ④ **TUNING +/-**
 - tunes to a radio station.
- ⑤ **VOLUME**
 - adjusts the volume level.
- ⑥ **MAX SOUND**
 - to activate or deactivate the optimal mix of various sound features.
- ⑦ **DSC (Digital Sound Control) buttons**
 - selects sound characteristics: JAZZ, ROCK, TECHNO or OPTIMAL.

DBB (Dynamic Bass Boost)

 - turns the bass enhancement on/off.
- ⑧ **LCD Display**
 - shows the status of the system.
- ⑨ **iR SENSOR**
 - infrared sensor for remote control.
- ⑩ **⏻**
 - switches the system on or to normal standby mode.
- ⑪ **ALBUM/PRESET+/-**
 - for MP3-CD: selects albums.
 - selects preset radio stations.
- ⑫ **■**
 - stops DISC playback or erases a CD program.
- ⑬ **CLOCK/DISPLAY**
 - sets the clock.
 - views the clock.
- ⑭ **Source (DISC/TUNER/AUX IN/MP3 LINK)**
 - selects the respective sound source for DISC/TUNER/AUX IN/MP3 LINK.
- ⑮ **MP3 LINK**
 - 3.5mm audio input jack.

Controls on the remote control

- ① **⏻**
 - switches the system to standby mode.
- ② **SHUFFLE**
 - to play tracks in a random order.
- ③ **SLEEP**
 - activates/deactivates or selects the sleep time.
 - views the remaining sleep time.
- ④ **TIMER**
 - activates/deactivates the timer
 - reviews the timer time
- ⑤ **▶||**
 - starts or pauses DISC playback.

◀◀ / ▶▶

 - skips to the beginning of a current track/ previous/ next track.
 - sets the hours and minutes for the clock and timer.

◀◀ / ▶▶

 - (press and hold) fast searches back and forward within a track/disc.
 - tunes to radio stations.
- ⑥ **DBB (Dynamic Bass Boost)**
 - turns the bass enhancement on/off.
- ⑦ **MAX**
 - to activate or deactivate the optimal mix of various sound features.
- ⑧ **VOL +/-**
 - adjusts the volume level.
- ⑨ **Numeric Keypad (0-9)**
 - enters a track/album number.
 - selects exact preset radio station.
- ⑩ **CLOCK/DISPLAY**
 - sets the clock.
 - views the clock.
- ⑪ **Source (DISC/TUN/AUX/MP3 LINK)**
 - selects the respective sound source for DISC/TUNER/AUX/MP3 LINK.
- ⑫ **REPEAT ALL**
 - plays all tracks repeatedly.
- ⑬ **REPEAT**
 - plays a track repeatedly.
- ⑭ **MUTE**
 - switches playback sound off and on.

⑮ **DSC (Digital Sound Control)**

- selects sound characteristics: OPTIMAL, JAZZ, TECHNO or ROCK.

⑯ ■

- stops DISC playback or erases a program.

⑰ **ALBUM/PRESET+/-**

- selects preset radio stations.
- selects an album.

⑱ **PROGRAM**

- programs tracks and reviews the program.
- programs preset radio stations.

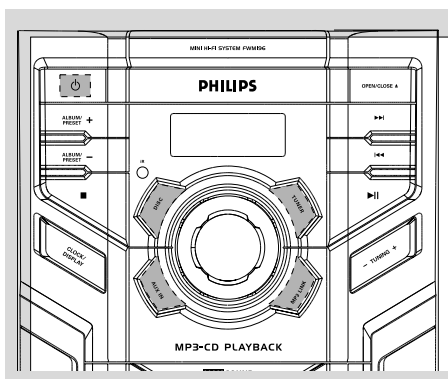

IMPORTANT:

Before you operate the system, complete the preparation procedures.

Switching the system on

- Press **⏻** on the main set.
→ The system will switch to the last selected source.
- Press **DISC, TUNER, AUX IN, or MP3 LINK LINK** (or **DISC, TUN, AUX, or MP3 LINK** on the remote control).
→ The system will switch to the selected source.

To switch the system to standby mode

- Press **⏻** (or **⏻** on the remote control).
→ The volume level (up to a maximum volume level of 15), interactive sound settings, last selected source and tuner presets will be retained in the player's memory.

Power-saving automatic standby

The power-saving feature automatically switches to standby 30 minutes after CD playback has ended and no control is operated.

Adjusting volume and sound

- 1 Adjust the **VOLUME** control knob or press **VOL+/-** on the remote control to increase or decrease volume.
→ Display shows the volume level *vol.* and a number from 0-40.
- 2 Press **DBB** to switch bass enhancement on or off.
→ Display shows: **DBB** if the DBB is activated.
- 3 Press **JAZZ, ROCK, TECHNO** or **OPTIMAL** on the system or press **DSC** on the remote control repeatedly to select the desired sound effect: **OPTIMAL, JAZZ, TECHNO** or **ROCK**.
→ The selected DSC is shown.
- To cancel the DSC setting, press **DSC** on the remote control repeatedly until the related DSC disappears.
- 4 Press **MUTE** on the remote control to stop sound playback instantly.
→ Playback will continue without sound and the display shows **MUTE**.
- To start sound playback you can:
 - press **MUTE** again;
 - adjust the volume controls.

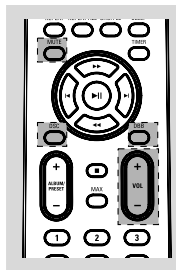

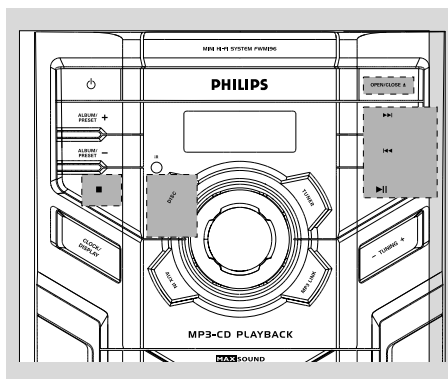

IMPORTANT:

The lens of the CD player should never be touched.

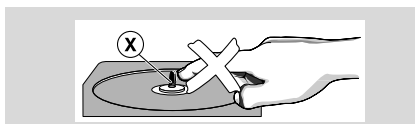

Playing a disc

This CD player plays Audio Discs including CD-Recordables, CD-Rewritables and MP3 CD.

- CD-ROM, CD-I, CDV, VCD, DVD or computer CDs, however, are not possible.
- 1 Press **DISC** to select **DISC** source.
 - 2 Press **OPEN/CLOSE** on the system to open the CD compartment.
→ *OPEN* is displayed when you open the CD compartment.
 - 3 Insert a disc with the printed side facing up and press **OPEN/CLOSE** to close the CD door.
→ *READ* is displayed as the CD player scans the contents of a disc, and then the total number of tracks and playing time (or the total number of albums and tracks for MP3 disc) are shown.
 - 4 Press **▶▶** to start playback.
→ The current track number and elapsed playing time of the track are displayed during disc playback.

- 5 To pause playback press **▶▶**. Press **▶▶** again to resume play.

→ The display freezes and the elapsed playing time flashes when playback is interrupted.

- 6 To stop disc playback, press **■**.

Note: CD playback will also stop when;

- the CD door is opened.
- the disc has reached the end.
- you select another source: **TUNER**, **MP3 LINK** or **AUX IN**.
- you select standby.

Selecting a different track

- Press **◀◀** or **▶▶** (**◀/▶** on the remote) once or repeatedly until the desired track number appears in the display.
- Press **▶▶** to start playback.

Finding a passage within a track

- 1 Press and hold down **◀◀** or **▶▶** (**◀◀/▶▶** on the remote).
→ The disc is played at high speed and low volume.
- 2 When you find the passage you want, release **◀◀** or **▶▶** (**◀◀/▶▶** on the remote).
→ Normal playback continues.

Playing an MP3/WMA disc

- 1 Load an MP3/WMA disc.
→ The disc reading time may exceed 10 seconds due to the large number of songs compiled into one disc.
→ "*xx* *앨범*" is displayed. *xx* is the total number of albums and *앨범* is the total number of tracks.
- 2 Press **PRESET/ALBUM+/-** to select a desired album.
- 3 Press **◀◀ / ▶▶** (**◀/▶** on the remote) to select a desired track.
→ The album number will change accordingly as you reach the first track of an album by pressing **◀◀** (**◀** on the remote) or the last track of an album by pressing **▶▶** (**▶** on the remote).
- 4 Press **▶▶** to start playback.

Discs for playback

This system can playback all digital audio CD, finalised digital audio CD-Recordable (CDR) discs and finalised digital audio CD-Rewritable (CDRW) discs.

MP3-CDs (CD-ROMs with MP3 tracks)



Supported MP3 disc formats:

- ISO9660, Joliet, UDF 1.5
- Maximum title number: 511 (depending on filename length)
- Maximum album number: 52
- Supported sampling frequencies: 32 kHz, 44.1 kHz, 48 kHz
- Supported Bit-rates: 32~256 (kbps), variable bitrates

Different play modes: SHUFFLE and REPEAT

You can select and change the various play modes before or during playback.

REPEAT plays the current track continuously

REPEAT ALL ... repeats the entire disc/programme

SHUFFLE plays the entire disc in random order

SHUFFLE and REPEAT ALL repeats the disc/programme continuously in random order

- 1 To select your play mode, press **REPEAT**, **REPEAT ALL** or **SHUFFLE** on the remote control before or during playback until the display shows the desired function.
 - 2 Press **▶II** to start playback if in the STOP position.
→ Playback will automatically start if you select SHUFFLE mode.
 - 3 To return to normal playback, press **REPEAT**, **REPEAT ALL** or **SHUFFLE** on the remote control until the various SHUFFLE/ REPEAT modes are no longer displayed.
- You can also press **■** to cancel your play mode.

Programming track numbers

Programme in the STOP position to select and store your disc tracks in the desired sequence. If you like, store any track more than once. Up to 20 tracks can be stored in the memory.

- 1 In the **STOP** position, press **PROGRAM** on the remote control to enter the programming mode.
→ **P - 1 : - -** is displayed and **PROG** flashes on the display.
- 2 Use **◀◀ / ▶▶** (**◀ / ▶** on the remote) to select your desired track number.
 - For MP3/WMA disc, press **ALBUM/PRESET** **+/-** and **◀◀ / ▶▶** (**◀ / ▶** on the remote) to select the desired album and title for programming.
→ The selected track number and **PROG** flash on the display panel.
- 3 Press **PROGRAM** on the remote control to confirm the track number to be stored.
- 4 Repeat steps **2-3** to select and store all desired tracks.
→ If you attempt to store more than 20 preset radio stations, "F L L L" is displayed.
- 5 To start playback of your disc programme, press **▶II**

Note:

- *If you wish, you can add further tracks to your current program.*

Erasing the programme

You can erase the programme by:

- pressing **■** once in the STOP mode;
- pressing **■** twice during playback;
- opening the CD compartment;
- selecting another sound source
→ **CL ERASE** appears on the display.

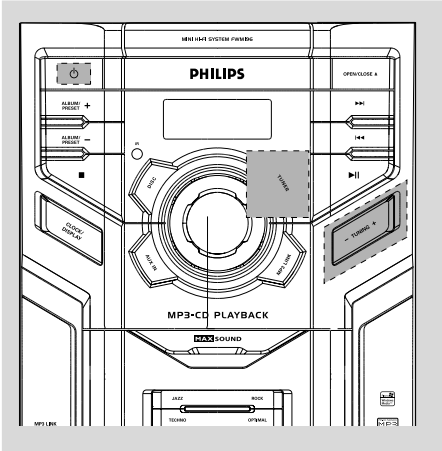

Tuning to radio stations

- 1 Press **TUNER** on the system or **TUN** on the remote control to select **TUNER** source.
- 2 Press **TUNER** on the system or **TUN** on the remote control once or more to select desired waveband: FM or MW (AM).
- 3 Press **TUNING+/-** (or **◀ / ▶** on the remote control) to tune to a desired radio frequency.
 - You can also press and hold **TUNING+/-** (or **◀ / ▶** on the remote control) for three seconds to search for a radio station.
 - *SERCH* is displayed.

Note:

– The system is equipped with a built-in MW(AM) antenna and a fixed FM antenna. For optimal MW(AM) reception, adjust the position of the main set until the strongest signal is found. For optimal FM reception, fully extend and adjust the position of the FM antenna until the strongest signal is found.

Programming radio stations

You can store up to 20 radio stations in the memory manually or automatically (Auto store).

Automatic programming

Press and hold **PROGRAM** on the remote control for more than three seconds to activate programming.

→ *AUTO* is displayed and available stations are programmed in order of waveband.

- To cancel the programming, press **■**.

Manual programming

- 1 Tune to your desired station (refer to “Tuning to radio stations”).
- 2 Press **PROGRAM** to activate programming.
 - *PI* is displayed and **PROG** flashes on the display.
- 3 Press **ALBUM/PRESET +/-** to allocate a preset number.
- 4 Press **PROGRAM** again to confirm the setting.
- 5 Repeat the above four steps to store other stations.
 - You can override a preset station by storing another frequency in its place.

Tuning to preset radio stations

- Press **ALBUM/PRESET +/-** until the desired preset station is displayed.

External Sources

Using MP3 LINK

- 1 Use the audio cable to connect the system's **MP3 LINK** jack (3.5 mm, located on the front panel) to the headphone jack or AUDIO OUT on an external device (such as an MP3 player, or CD player).
- 2 Press **MP3 LINK** to select MP3 LINK.
→ "MP3 LINK" is displayed.

Using an external device

- 1 Connect the system's AUX IN jacks to the AUDIO OUT jacks on another audio/visual device (such as a VCR, Laser Disc player or cassette desk).
- 2 Press **AUX IN** on the set or **AUX** on the remote control to select external equipment.
→ "AUX IN" is displayed.

Note:

- All the sound control features (DSC or DBB, for example) are available for selection.
- Refer to the operating instructions for the connected equipment for details.

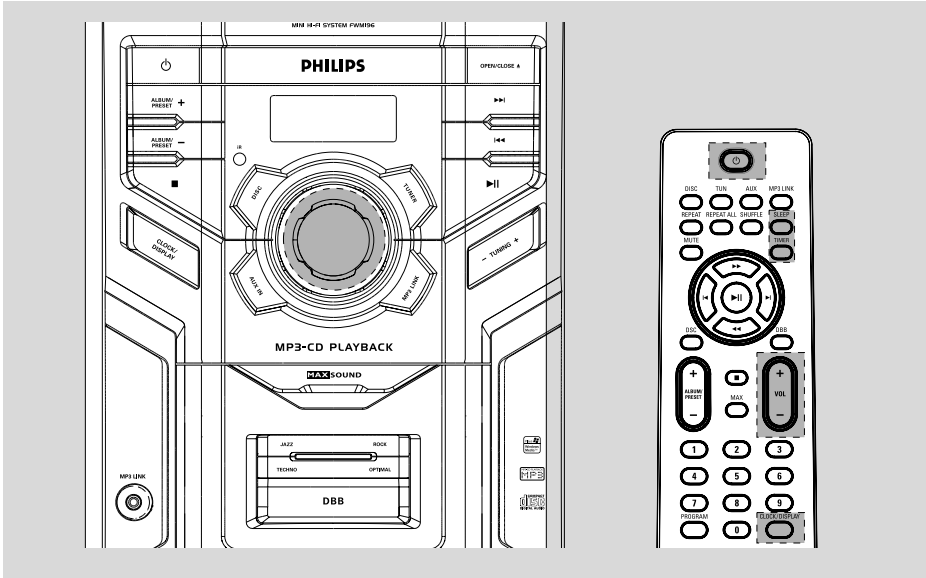

Setting the clock

- 1** In standby mode, press and hold **CLOCK/DISPLAY**.
→ The clock digits for the hours flash.
- 2** Press ◀◀ / ▶▶ on the system (or ◀ / ▶ on the remote) to set the hours.
- 3** Press **CLOCK/DISPLAY**.
→ The clock digits for the minutes flash.
- 4** Press ◀◀ / ▶▶ (or ◀ / ▶ on the remote) on the system to set the minutes.
- 5** Press **CLOCK/DISPLAY** to confirm the time.

To view the clock in active mode

- Press **CLOCK/DISPLAY**.

Note:

- If the clock has not been set, - : - - will be displayed.
- The clock cannot be set in MP3 LINK and AUX IN mode.

Setting the sleep timer

The sleep timer enables the system to switch off by itself after a set period of time.

- 1** In active mode, press **SLEEP** on the remote control repeatedly until the desired timer option appears.
→ Selections are as follows (time in minutes):
SLPOFF → *SLP 120* → *SLP 90* → *SLP 60*
→ *SLP 45* → *SLP 30* → *SLP 15* → *SLPOFF*
→ Display shows ⏻ if activated, and disappears if deactivated.
- 2** To cancel the sleep function, either press **SLEEP** on the remote control once or more until "*SLPOFF*" appears, or press ⏻ to switch to standby mode.

To check the remaining length of time after sleep timer is activated

- Press **SLEEP** once.

Setting the timer

- The system can switch on to DISC, TUNER, or MP3 LINK mode automatically at a preset time, serving as an alarm to wake you up.

IMPORTANT!

– **Before setting the timer, ensure that the clock is set correctly.**

– **The timer will always be switched on after it has been set.**

– **The volume of the timer will increase gradually from the minimum level to the last tuned volume level (If the last tuned volume level is less than 15, it will increase gradually from the minimum level to 15).**

- 1 Press **TIMER** on the remote control.
→ The clock digits for the hours flash.
- 2 Press **◀◀ / ▶▶** on the system (or **◀ / ▶** on the remote) to set the hours.
- 3 Press **TIMER** again.
→ The clock digits for the minutes flash.
- 4 Press **◀◀ / ▶▶** on the system (or **◀ / ▶** on the remote) to set the minutes.
- 5 Press **TIMER** to confirm the time.
→ The timer is now activated and display shows 

To deactivate the timer,

- Press **TIMER** once or more.
→  disappears if the timer is deactivated.

Notes:

- *When the preset time is reached, the last selected source will be played automatically.*
- *During timer setting, if no button is pressed within 6-7 seconds, the system will exit timer setting mode automatically.*
- *If remote control is used, timer/clock setting is available only in DISC and TUNER modes.*

AMPLIFIER

1 KHz
 (Low channel - both channels driven)
 20 W per channel (8 Ω)
 10 KHz
 (High channel - both channels driven)
 20 W per channel (8 Ω)
 Total output power 80 W
 Signal-to-noise ratio \geq 62 dBA (IEC)
 Frequency response 63 – 16000 Hz, \pm 3 dB

CD PLAYER

Frequency range 63 – 16000 Hz
 Signal-to-noise ratio 65 dBA

TUNER

FM wave range 87.5 – 108 MHz
 MW (AM) wave range 530 – 1700 kHz

SPEAKERS

2-way Bass Reflex System
 Impedance 8 Ω
 Woofer 1x100 mm
 Tweeter 1x50 mm
 Dimensions (w x h x d).....207 x 310 x 186 (mm)
 Weight 2.6 kg (each)

GENERAL

AC Power 110 – 127 / 220 – 240 V;
 50/60 Hz Switchable
 Power consumption
 Active 50 W
 Set dimensions (w x h x d)
 220 x 292 x 285 (mm)
 Weight (main unit) 3.83 kg
 Gross weight (including packaging) 10.4 kg

Specifications and external appearance are subject to change without notice.

Maintenance

Cleaning the Cabinet

- Use a soft cloth slightly moistened with a mild detergent solution. Do not use a solution containing alcohol, spirits, ammonia or abrasives.

Cleaning Discs

- When a disc becomes dirty, clean it with a cleaning cloth. Wipe the disc from the centre out.
- Do not use solvents such as benzene, thinner, commercially available cleaners, or antistatic spray intended for analogue records.



Cleaning the disc lens

- After prolonged use, dirt or dust may accumulate at the disc lens. To ensure good playback quality, clean the disc lens with Philips CD Lens Cleaner or any commercially available cleaner. Follow the instructions supplied with cleaner.

WARNING

Under no circumstances should you try to repair the system yourself, as this will invalidate the warranty. Do not open the system as there is a risk of electric shock.

If a fault occurs, first check the points listed below before taking the system for repair. If you are unable to remedy a problem by following these hints, consult your dealer or service centre.

Problem

Solution

CD OPERATION

"No disc" is displayed.

- Insert a disc.
- Check if the disc is inserted upside down.
- Wait until the moisture condensation at the lens has cleared.
- Replace or clean the disc, see "Maintenance".
- Use a finalised CD-RW, CD-R or MP3 CD.

RADIO RECEPTION

Radio reception is poor.

- Increase the distance between the Micro HiFi System and your TV or VCR.

GENERAL

The system does not react when buttons are pressed.

- Remove and reconnect the AC power plug and switch on the system again.

Sound cannot be heard or is of poor quality.

- Adjust the volume.
- Check that the speakers are connected correctly.
- Check if the stripped speaker wire is clamped.

The left and right sound outputs are reversed.

- Check the speaker connections and location.
-

Troubleshooting

The remote control does not function

- Reduce the distance between the remote control and the system.
 - Insert the batteries with their polarities (+/- signs) aligned as indicated.
 - Replace the batteries.
 - Point the remote control directly toward IR sensor on the front of the system.
-

The timer is not working.

- Set the clock correctly.
 - Press **TIMER** in standby mode to switch on the timer:
 - If a recording is in progress, stop the recording.
-

The Clock/Timer setting is erased.

- Power has been interrupted or the power cord has been disconnected. Reset the clock/timer.
-