

Second LCD screen

Register your product and get support at
www.philips.com/welcome

User manual

Manuel d'utilisation

Manual de usuario

Benutzerhandbuch



PHILIPS

English 4

Français 10

Español 15

Deutsch 21

English

Français

Español

Deutsch

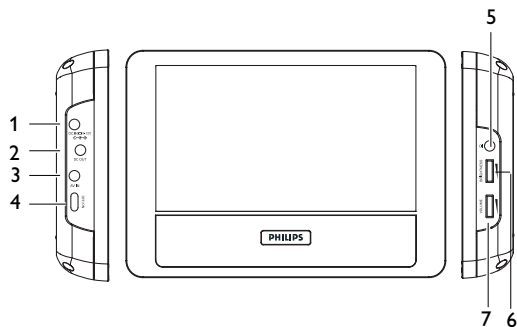

English

Congratulations on your purchase and welcome to Philips!

To fully benefit from the support that Philips offers, register your product at www.philips.com/welcome.

Content

- | | | | |
|----------|---|----------|------------------------|
| 1 | Control elements and functional components | 4 | Enjoyment |
| 1.1 | Left side of the player | 4.1 | Power on |
| 1.2 | Right side of the player | 4.2 | Volume control |
| 2 | General information | 4.3 | Screen brightness |
| 3 | Connection | 5 | Troubleshooting |
| 3.1 | Use in a car | 6 | Technical data |
| 3.2 | Use at home | | |
| 3.3 | Connect to headphone | | |
| 3.4 | Connect to camcorder | | |

1 Control elements and functional components

1.1 Left side of the player (see figure 1)

- | | |
|-----------------|----------------------------|
| 1 DC IN | DC power input jack |
| 2 DC OUT | DC power output jack |
| 3 AV IN | Audio/Video input |
| 4 ON/OFF | Switch the player on / off |

1.2 Right side of the player (see figure 1)

5 Headphone jack

6 **Brightness** Finetune the TFT screen brightness

7 **VOLUME** Volume control

2 General information

Power Sources

This unit operates on the supplied AC adaptor or car adaptor.

- Make sure that the input voltage of the AC adaptor is in line with the local voltage. Otherwise, the AC adaptor and unit may be damaged.
- Do not touch the AC adaptor with wet hands to prevent electric shock.
- When connecting with car power (cigarette lighter) adaptor, be sure the input voltage of the adaptor is identical with car voltage.
- Unplug the AC adaptor from the outlet or remove the battery pack when the unit is not used for long periods of time.
- Hold the plug to disconnect the AC adaptor. Do not pull the power cord.

Please always use supplied AC/DC adaptor (DSA-20R-12FEU, DVE)

Safety and maintenance

- Any service should be done by qualified service personnel.
- Unplug the AC adaptor to cut the power if liquid or objects get inside the unit.
- Take care not to drop the unit or subject it to strong shocks, which may cause malfunction.

Hearing Safety

Listen at a moderate volume.

- Using headphones at a high volume can impair your hearing. This product can produce sounds in decibel ranges that may cause hearing loss for a normal person, even for exposure less than a minute. The higher decibel ranges are offered for those that may have already experienced some hearing loss.
- Sound can be deceiving. Over time your hearing “comfort level” adapts to higher volumes of sound. So after prolonged listening, what sounds “normal” can actually be loud and harmful to your hearing. To guard against this, set your volume to a safe level before your hearing adapts and leave it there.

To establish a safe volume level:

- Set your volume control at a low setting.
- Slowly increase the sound until you can hear it comfortably and clearly, without distortion.

Listen for reasonable periods of time:

- Prolonged exposure to sound, even at normally “safe” levels, can also cause hearing loss.
- Be sure to use your equipment reasonably and take appropriate breaks.

Be sure to observe the following guidelines when using your headphones.

- Listen at reasonable volumes for reasonable periods of time.
- Be careful not to adjust the volume as your hearing adapts.
- Do not turn up the volume so high that you can't hear what's around you.
- You should use caution or temporarily discontinue use in potentially hazardous situations.



- Do not use headphones while operating a motorized vehicle, cycling, skateboarding, etc.; it may create a traffic hazard and is illegal in many areas.
- Important (for models with by-packed headphones): Philips guarantees compliance with the maximum sound power of its audio players as determined by relevant regulatory bodies only with the original model of provided headphones. In case this one needs replacement, we recommend that you contact your retailer to order a model identical to that of the original provided by Philips.
- Traffic safety: do not use while driving or cycling as you may cause an accident.
- Do not expose to excessive heat caused by heating equipment or direct sunlight.
- This product is not waterproof: do not allow your player to be submersed in water. Water entering the player may cause major damage.
- Do not use any cleaning agents containing alcohol, ammonia, benzene, or abrasives as these may harm the player.
- Apparatus shall not be exposed to dripping or splashing. Do not place any sources of danger on the apparatus (e.g. liquid filled objects, lighted candles)

When the player is in use for a long period of time, the surface will be heated. This is normal.

Environmental information

We have reduced the packaging to its minimum and made it easy to separate into mono materials: cardboard, PS, PE and PET. Your set consists of material which can be recycled if disassembled

by a specialized company. Please observe the local regulations to dispose of packaging, exhausted batteries and old equipment.

Copyright information

All other brand and product names are trademarks of their respective companies or organizations.

3 Connection

Make sure that the primary DVD player, secondary LCD screen and any other electrical equipment are switched off before connection.

3.1 Use in a car

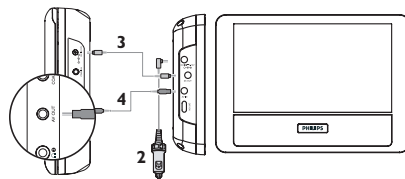

Primary DVD player

PAC132

- 1 Mount the devices to the headrest with the mounting kits.
- 2 Connect the power plug of the car adaptor to PAC132.
- 3 Connect the power source to the primary DVD player using the power cord.
- 4 Connect the audio/visual cable to the devices.

3.2 Use at home

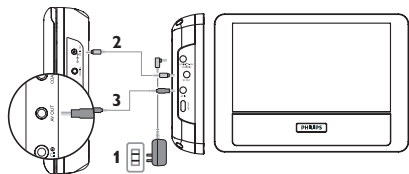

Primary DVD player PAC132

- 1 Connect the AC/DC power adaptor to PAC132.
- 2 Connect the power source to the primary DVD player using the power cord.
- 3 Connect the audio/visual cable to the devices.

3.3 Connect to headphone

Connect the headphones to the right side of the player for private listening.

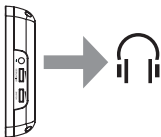

3.4 Connect to camcorder

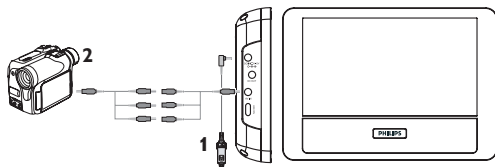

You can connect the player to your camcorder to view video on a bigger screen.

- 1 Connect PAC132 to the power source.
- 2 Connect the camcorder to PAC132 using the audio/video cable
You can adjust the volume and the brightness of the display screen during video playback.

4 Enjoyment

4.1 Power on

- 1 Power on the connected device, such as the primary DVD player, camcorder etc.
- 2 Power on PAC132
- 3 PAC132 will automatically playback the video content
- 4 Power off all the devices after viewing

4.2 Volume control

Adjust the volume control on the right side of the player.

4.3 Screen brightness

Use the rotary switch on the right side of the unit to finetune the TFT screen brightness.

5 Troubleshooting

If it appears that the DVD-Video player is faulty, first consult this checklist. It may be that something has been overlooked.

WARNING Under no circumstances should you try to repair the set yourself as this will invalidate the guarantee. If a fault occurs, first check the points listed, before taking the set for repair. If you are unable to solve a problem by following these hints, consult your dealer or service centre.

Symptom	Remedy
No sound	<ul style="list-style-type: none"> • Make sure that the LCD screen is switched on and is in the correct video mode. • Make sure that your system connection is properly connected. • Make sure the video source is correct.
No video	<ul style="list-style-type: none"> • Make sure all the connected devices are switched on. • Make sure that the system is properly connected. • Make sure that video playback has already started on the primary device, such as DVD player, camcorder. • Make sure that the video out function on the primary device has been activated.

6 Technical data

TFT screen size	7 inches
Weight	0.37 kg / 0.81 lb
Power supply	DC 9-12V, 2A
Power Consumption	≤ 20W
Operating temperature range	0 - 50°C (32 - 122°F)
Video system	NTSC / PAL / AUTO

PHILIPS reserves the right to make design and specification changes for product improvement without prior notice. Modifications not authorized by the manufacturer may void users authority to operate this device. All rights reserved.

Copyright information

The making of unauthorized copies of copy-protected material, including computer programmes, files, broadcasts and sound recordings, may be an infringement of copyrights and constitute a criminal offence. This equipment should not be used for such purposes.

Disposal of your old product



Your product is designed and manufactured with high quality materials and components, which can be recycled and reused.

When this crossed-out wheeled bin symbol is attached to a product, it means the product is covered by the European Directive 2002/96/EC.

Please be informed about the local separate collection system for electrical and electronic products.

Please act according to your local rules and do not dispose of your old product with your normal household waste. The correct disposal of your old product will help prevent potential negative consequences to the environment and human health.



Need help?

Online

Go to www.philips.com/support



Be responsible
Respect copyrights

© Royal Philips Electronics N.V. 2008

Meet Philips at the Internet

<http://www.philips.com>



Printed in China

PDCC-2008