

Always there to help you

Register your product and get support at
www.philips.com/welcome



OR7200



User manual

PHILIPS

Contents

1	Safety	2
----------	---------------	----------

2	What's in the box	3
----------	--------------------------	----------

3	Connect power	4
----------	----------------------	----------

4	Turn on	5
----------	----------------	----------

5	Set the clock	6
----------	----------------------	----------

6	Listen to FM radio stations	7
	Search for a radio station automatically	7
	Search for a radio station manually	7
	Store radio stations automatically	7
	Program radio stations manually	7
	Display RDS information	8
	Adjust FM settings	10

7	Listen to DAB radio stations	11
	For the first time use	11
	Program radio stations	11
	Display DAB information	12
	Use DAB menus	12

8	Use system menus	14
	Check the current software version	14
	Reset the product	14
	Upgrade the software	14

9	Listen to an external device	15
----------	-------------------------------------	-----------

10	Adjust the volume	16
-----------	--------------------------	-----------

11	Troubleshooting	17
-----------	------------------------	-----------

12	Product information	18
	Amplifier	18
	Tuner	18
	Speakers	18
	General information	18

13	Notice	19
	Compliance	19
	Care of the environment	19
	Copyright	19

Congratulations on your purchase, and welcome to Philips! To fully benefit from the support that Philips offers, register your product at www.philips.com/welcome.

1 Safety

Read and understand all instructions before you use this product. If damage is caused by failure to follow the instructions, the warranty does not apply.

Risk of electric shock or fire!

- Never expose the product and accessories to rain or water. Never place liquid containers, such as vases, near the product. If liquids are spilt on or into the product, disconnect it from the power outlet immediately. Contact the Consumer Care to have the product checked before use.
- Never place the product and accessories near naked flames or other heat sources, including direct sunlight.
- Never insert objects into the ventilation slots or other openings on the product.
- Where the mains plug or an appliance coupler is used as the disconnect device, the disconnect device shall remain readily operable.
- Disconnect the product from the power outlet before lightning storms.
- When you disconnect the power cord, always pull the plug, never the cable.

Risk of short circuit or fire!

- Before you connect the product to the power outlet, make sure that the power voltage matches the value printed on the back of the product. Never connect the product to the power outlet if the voltage is different.
- Never expose the product to rain, water, sunshine, or excessive heat.
- Avoid force coming onto power plugs. Loose power plugs can cause arcing or fire.

Risk of injury or damage to the product!

- This product shall not be exposed to dripping or splashing!
- Do not place any sources of danger on this product (e.g. liquid filled objects, lighted candles).
- Never place the product or any objects on power cords or on other electrical equipment.
- If the product is transported in temperatures below 5°C, unpack the product and wait until its temperature matches room temperature before connecting it to the power outlet.

Risk of overheating!

- Never install this product in a confined space. Always leave a space of at least four inches around the product for ventilation.
- Make sure that curtains or other objects never cover the ventilation slots on the product.



Note

- The type plate is located on the back of the product.

2 What's in the box

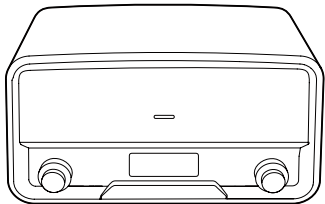

3 Connect power

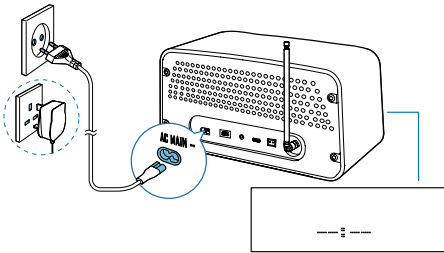

4 Turn on

Press the **POWER VOLUME** knob or turn the **SOURCE** knob.

- ↳ The product switches to the last selected source.
- To switch the product to standby mode, press the **POWER VOLUME** knob again.

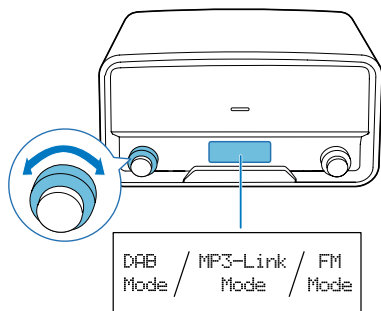

5 Set the clock

- 1 In standby mode, press and hold the **SELECT** knob for 2 seconds.
↳ 12-Hour (12-hour time format) or 24-Hour (24-hour time format) blinks.
- 2 Turn the **SELECT** knob to select a time format, and then press the **SELECT** knob to confirm.
↳ Hour digits blink.
- 3 Turn the **SELECT** knob to set the hour, and then press the **SELECT** knob to confirm.
↳ Minute digits blink.
- 4 Turn the **SELECT** knob to set the minute.
- 5 Press the **SELECT** knob to confirm.

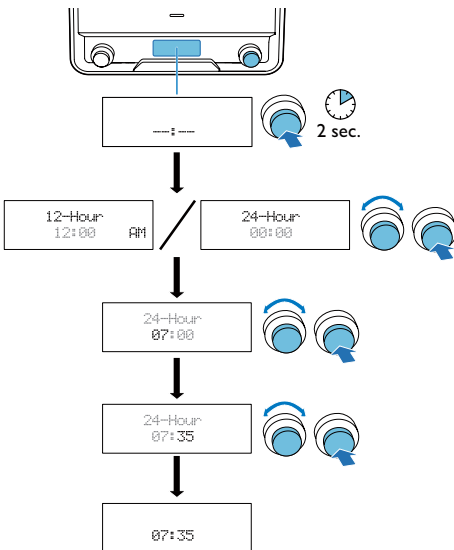

6 Listen to FM radio stations

- 1 Turn the **SOURCE** knob to switch the product to FM mode.
- 2 Search for radio stations automatically or manually.

Note

- For optimal reception, fully extend the antenna and adjust its position.
- You can store a maximum of 30 FM radio stations.

Search for a radio station automatically

Press **SCAN** to activate the auto search.

87.50MHz
Scanning...

- ↳ After a strong radio station is detected, the search stops and the radio station is broadcast.

Search for a radio station manually

Turn the **PRESET** knob until the frequency of target radio station is displayed.

Store radio stations automatically

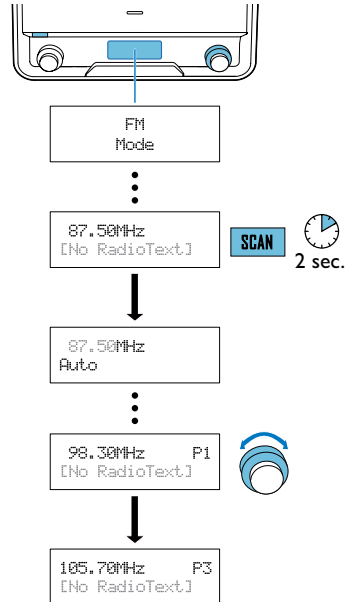

Press and hold **SCAN** to activate the auto search.

- ↳ After the search is complete, the first stored radio station is broadcast.
- To tune to a stored radio station, turn the **PRESET** knob until its frequency is displayed.

Program radio stations manually

- 1 Tune to a radio station.
- 2 Press the **PROGRAM** button to activate the programming.
- 3 Turn the **PRESET** knob to select a preset sequence number.
- 4 Press the **PRESET** knob to confirm.
↳ The radio station is stored with the selected sequence number.

- 5 Repeat steps 1-4 to program more radio stations.
- To tune to a preset radio station, turn the **PRESET** knob until its frequency is displayed.



Note

- If you store a radio station with the sequence number of another one, the earlier one is overwritten.

Display RDS information

Radio Data System (RDS) is a service that allows FM stations to transmit additional information. When you tune to an FM radio station that transmits RDS signals, the station name is displayed.

- 1 Tune to an RDS station.
- 2 Press **INFO** repeatedly to scroll through the following information (if available):
 - Radio text
 - Program type such as **[NEWS]** (news), **[SPORT]** (sport), **[POP M]** (pop music)...
 - Program service
 - Mono/Stereo
 - Time
 - Date

RDS program types

Program type	Description	Program type	Description
NEWS	News services	FINANCE	Finance
AFFAIRS	Politics and current affairs	CHILDREN	Children's programs
INFO	Special information programs	SOCIAL	Social affairs
SPORT	Sports	RELIGION	Religion
EDUCATE	Education and advanced training	PHONE IN	Phone in
DRAMA	Radio plays and literature	TRAVEL	Travel
CULTURE	Culture, religion and society	LEISURE	leisure
SCIENCE	Science	JAZZ	Jazz Music
VARIED	Entertainment programs	COUNTRY	Country Music
POP M	Pop music	NATION M	National Music
ROCK M	Rock music	OLDIES	Oldies Music
MOR M	Light music	FOLK M	Folk Music
LIGHT M	Light classical music	DOCUMENT	Documentary
CLASSICS	Classical music	TEST	Alarm Test
OTHER M	Special music programs	ALARM	Alarm
WEATHER	Weather		

Adjust FM settings

- 1 In FM mode, press **MENU** to access FM menus.
- 2 Turn the **SELECT** knob to toggle through the menus.

Scan setting

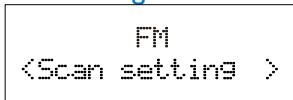

- 1 Press the **SELECT** knob to access sub-menus.
- 2 Turn the **SELECT** knob to select an option.
 - **Strong station**: Search for strong stations only.
 - **All stations**: Search for all stations no matter whether the signal strength of a station is strong or weak.
- 3 Press the **SELECT** knob to confirm the option.

Audio setting

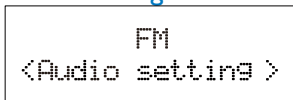

- 1 Press the **SELECT** knob to access sub-menus.
- 2 Turn the **SELECT** knob to select an option.
 - **Stereo allowed**: Allow stereo output even if the station transmits weak stereo audio signals.
 - **Forced mono**: Convert stereo signals to monophonic output even if the station transmits strong stereo audio signals.
- 3 Press the **SELECT** knob to confirm the option.

System menus



- 1 Press the **SELECT** knob to access system menus.
- 2 Turn the **SELECT** knob to select a sub-menu.
 - For details, refer to the section '**Use system menus**'.

7 Listen to DAB radio stations

Note

- For optimal reception, fully extend the antenna and adjust its position.
- You can program a maximum of 30 DAB radio stations.
- Check with local retailer or go to www.WorldDAB.org for applicable DAB radio frequencies in your area.

For the first time use

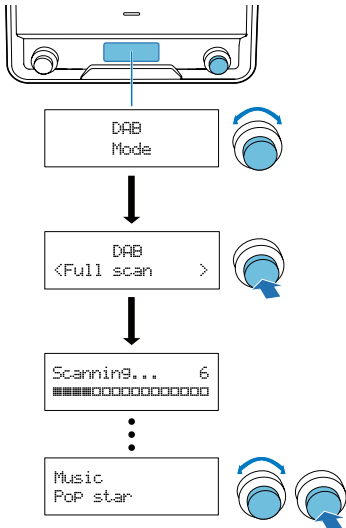

- 1 Turn the **SOURCE** knob to switch the product to DAB mode.
- 2 Turn the **SELECT** knob until the **[Full scan]** menu is displayed.
- 3 Press the **SELECT** knob to activate the automatic search.
 - ↳ This product automatically stores radio stations with sufficient signal strength.
 - ↳ After the search is complete, the first stored radio station is broadcast automatically.

- 4 Turn the **SELECT** knob to select a station, and then press the **SELECT** knob to start listening.

Tip

- You can re-scan to update the list of stored stations (see "Use DAB menus" > "Re-scan for stations").
- You can tune to a station manually (see "Use DAB menus" > "Tune to a station manually").

About special symbols

Some symbol may be displayed before the name of a station.

- H: The station is one of your 10 favorite stations.
- ?: The station is unavailable or inactive.
- >>: The station is a primary station with secondary service.
- <<: The station is a secondary station.

Program radio stations

- 1 Tune to a DAB radio station.
- 2 Press **PROGRAM** to activate the programming.
- 3 Turn the **SELECT** knob to select a preset sequence number.
- 4 Press the **SELECT** knob to confirm.
 - ↳ The radio station is stored with the selected sequence number.
- 5 Repeat steps 1-4 to program more radio stations.
 - To tune to a preset radio station, turn the **PRESET** knob until its frequency is displayed.

Note

- If you store a radio station with the sequence number of another one, the earlier one is overwritten.

Display DAB information

On the display of DAB broadcasting, the first line shows station name, and the second line shows the service information for the current station.

Press **INFO** repeatedly to cycle through the following information (if available).

- Dynamic label segment (DLS)
- Signal strength
- Program type (PTY)
- Ensemble name
- Frequency
- Signal error rate
- Bitrate codec
- Time
- Date

Use DAB menus

- 1 In DAB mode, press **MENU** to access the DAB menus.
- 2 Turn the **SELECT** knob to toggle through the menus.

Tune to a stored station

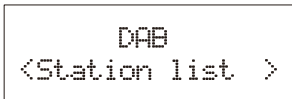

- 1 Press the **SELECT** knob to access the list of stored stations.
 - If no DAB station is stored, the product starts automatic search.
- 2 Turn the **SELECT** knob to select a station.
- 3 Press the **SELECT** knob to start listening.

Re-scan for stations

Full scan is used to perform a wide range search for DAB radio stations.



Press the **SELECT** knob to start scanning for available DAB stations.

- ↳ After the scanning is complete, the first detected station is broadcast.

Tune to a station manually

With this feature, you can tune to a specific channel/frequency manually. In addition to antenna orientation for better radio reception, the optimal reception can also be obtained with this feature.

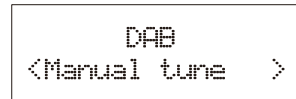

- 1 Press the **SELECT** knob to access the station list.
- 2 Turn the **SELECT** knob to select a station from 5A to 13F.



- 3 Press the **SELECT** knob to confirm the option.

DRC (Dynamic Range Control)

DRC adds or removes a degree of compensation for the differences in the dynamic range between radio stations.



- 1 Press the **SELECT** knob to access the sub-menu.
- 2 Turn the **SELECT** knob to select an option. (The asterisk behind the option indicates the current setting.)
 - DRC off : No compensation applied.
 - DRC low : Medium compensation applied.
 - DRC high : Maximum compensation applied.
- 3 Press the **SELECT** knob to confirm the option.

Remove invalid stations

This option lists active stations and removes any stations that are in the list but have no service in your area. In front of the station name of an invalid station, a question mark (?) is displayed.

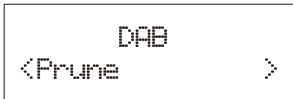

- 1 Press the **SELECT** knob to access the sub-menu.
- 2 Turn the **SELECT** knob to select an option.
 - <No> : Return to the previous menu.
 - <Yes> : Remove invalid stations from the station list.
- 3 Press the **SELECT** knob to confirm the option.

System menus



- 1 Press the **SELECT** knob to access system menus.
- 2 Turn the **SELECT** knob to select a sub-menu.
 - For details, refer to the section '**Use system menus**'.

8 Use system menus

Use the system menus to

- check the version of current software of this product,
- upgrade the software, and
- reset the product to factory default status.

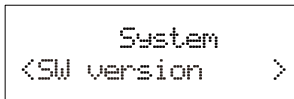

Check the current software version

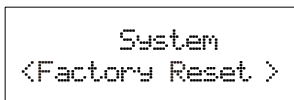

Press the  knob to display the version of current software.

Reset the product



- 1 Press the  knob to display the options.
- 2 Turn the  knob to select an option.
 - <No> : Return to the previous menu.
 - <Yes> : Reset the product to factory default status.
- 3 Press the  knob to confirm the option.

Upgrade the software

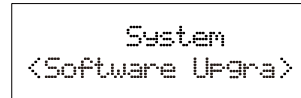

- 1 Go to www.philips.com/support.
- 2 Search for support information about this product with "**OR7200/10**" as the keyword.
 - ↳ When an upgrade packet is available, the link of "**Installation instructions**" under "**Software & drivers**" is accessible. The exact wording of link names may vary in different languages.
- 3 Click the link of "**Installation instructions**".
- 4 Read and understand the instructions on software upgrade.
- 5 Follow the instructions to complete the upgrade.

9 Listen to an external device

You can also listen to an external audio device, for example, MP3 player, through this product.

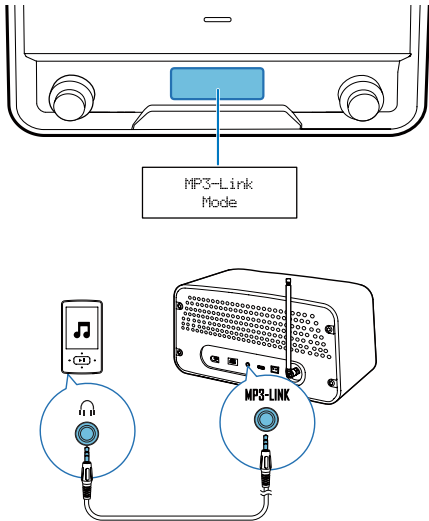

- 1 Turn the **SOURCE** knob to switch the product to MP3-Link mode.
- 2 Connect the audio input cable to
 - the **MP3-LINK** socket on the back panel of this product, and
 - the headphone jack on the external device.
- 3 Play the external device (refer to its user manual).

10 Adjust the volume

Turn the **POWER VOLUME** knob.

11 Troubleshooting



Warning

- Never remove the casing of this product.

To keep the warranty valid, never try to repair the product yourself.

If you encounter problems when using this device, check the following points before requesting service. If the problem remains unsolved, go to the Philips Web page (www.philips.com/support). When you contact the Consumer Care, make sure that the product is nearby and the model number and serial number are available.

No power

- Make sure that the AC power cord is properly connected.
- Make sure that there is power at the AC power outlet.

No sound

- Adjust the volume.
- In MP3-Link mode, make sure that the external audio device is not muted.

No response from the product

- Make sure that the power is available.
- Turn off the product, and then turn it on again.

Poor radio reception

- Due to the interference from other electrics or building obstacles, the signals become weak. Move the product to a place free of interference.
- Make sure that the antenna is fully extended. Adjust the position of the antenna.

Clock setting is erased.

- Power has been interrupted, or the AC power cord has been disconnected.
- Set the clock again.

12 Product information



Note

- Product information is subject to change without prior notice.

General information

AC Power Rating	220-240V~, 50 Hz
Operation Power Consumption	10W
Dimensions (Main Unit)	325 x 175 x 167 mm
Weight (Main Unit)	3.5 kg

Amplifier

Frequency Response	60 Hz - 16 kHz, ± 3 dB
Signal to Noise Ratio	> 65 dB
Aux Input	0.5 V RMS 20 kohm

Tuner

Tuning Range	FM: 87.50 - 108.00 MHz; DAB: 174.928-239.200 MHz
Tuning grid	50 kHz
DAB sensitivity (EN50248)	< -95 dbm
Total Harmonic Distortion	< 2%
Signal to Noise Ratio	> 50 dB
Number of preset radio stations	30 (FM), 30 (DAB)

Speakers

Speaker Impedance	4 ohm
Speaker Driver	2 X 3" full range
Sensitivity	>82 dB/m/W

13 Notice

Any changes or modifications made to this device that are not expressly approved by WOOX Innovations may void the user's authority to operate the equipment.

Compliance



This product complies with the radio interference requirements of the European Community.



This is CLASS II apparatus with double insulation, and no protective earth provided.

Care of the environment



Your product is designed and manufactured with high quality materials and components, which can be recycled and reused.



When this crossed-out wheeled bin symbol is attached to a product it means that the product is covered by the European Directive 2002/96/EC. Please inform yourself about the local separate collection system for electrical and electronic products.

Please act according to your local rules and do not dispose of your old products with your normal household waste.

Correct disposal of your old product helps to prevent potential negative consequences for the environment and human health.

Environmental information

All unnecessary packaging has been omitted. We have tried to make the packaging easy to separate into three materials: cardboard (box), polystyrene foam (buffer) and polyethylene (bags, protective foam sheet.)

Your system consists of materials which can be recycled and reused if disassembled by a specialized company. Please observe the local regulations regarding the disposal of packaging materials, exhausted batteries and old equipment.

Copyright

2014 © WOOX Innovations Limited. All rights reserved.

Philips and the Philips' Shield Emblem are registered trademarks of Koninklijke Philips N.V. and are used by WOOX Innovations Limited under license from Koninklijke Philips N.V.™

Specifications are subject to change without notice. WOOX reserves the right to change products at any time without being obliged to adjust earlier supplies accordingly.



2014 © WOOX Innovations Limited.

All rights reserved.

Philips and the Philips' Shield Emblem are registered trademarks of Koninklijke Philips N.V. and are used by WOOX Innovations Limited under license from Koninklijke Philips N.V.

OR7200_10_UM_V2.0

