

# Always there to help you

Register your product and get support at  
[www.philips.com/welcome](http://www.philips.com/welcome)

AZ100



## User manual

# PHILIPS



# Contents

<b>1</b>	<b>Important</b>	<b>2</b>
<b>2</b>	<b>Your CD Soundmachine</b>	<b>3</b>
	Introduction	3
	What's in the box	3
<b>3</b>	<b>Get started</b>	<b>4</b>
	Install batteries	4
	Connect power	4
<b>4</b>	<b>Use your CD Soundmachine</b>	<b>5</b>
	Play disc	5
	Listen to radio	5
	Listen to an external device	6
<b>5</b>	<b>Specifications</b>	<b>7</b>
<b>6</b>	<b>Troubleshooting</b>	<b>8</b>
<b>7</b>	<b>Notice</b>	<b>9</b>

# 1 Important



This 'bolt of lightning' indicates uninsulated material within the device may cause an electrical shock. For the safety of everyone in your household, please do not remove the covering.

The 'exclamation mark' calls attention to features for which you should read the enclosed literature closely to prevent operating and maintenance problems.

**WARNING:** To reduce the risk of fire or electric shock, the device should not be exposed to rain or moisture and objects filled with liquids, such as vases, should not be placed on the device.

**CAUTION:** To prevent electric shock, fully insert the plug. (For regions with polarized plugs: To prevent electric shock, match wide blade to wide slot.)

- Read these instructions.
- Follow all instructions.
- Do not block any ventilation openings. Install in accordance with the manufacturer's instructions. Do not install near any heat sources such as radiators, heat registers, stoves, or other apparatus (including amplifiers) that produce heat.
- Protect the power cord from being walked on or pinched, particularly at plugs, convenience receptacles, and the point where they exit from the device.
- Only use attachments/accessories specified by the manufacturer.
- Unplug this device during lightning storms or when unused for long periods of time.
- Refer all servicing to qualified service personnel. Servicing is required when the device has been damaged in any way, such as power-supply cord or plug is damaged,

liquid has been spilled or objects have fallen into the device, the device has been exposed to rain or moisture, does not operate normally, or has been dropped.

- Battery usage **CAUTION** – To prevent battery leakage which may result in bodily injury, property damage, or damage to the device:
  - Install all batteries correctly, + and - as marked on the device.
  - Do not mix batteries (old and new or carbon and alkaline, etc.).
  - Batteries (battery pack or batteries installed) shall not be exposed to excessive heat such as sunshine, fire or the like.
  - Remove batteries when the device is not used for a long time.
- The device shall not be exposed to dripping or splashing.
- Do not place any sources of danger on the device (e.g. liquid filled objects, lighted candles).
- Where the MAINS plug or an appliance coupler is used as the disconnect device, the disconnect device shall remain readily operable.



## Warning

- Never remove the casing of this device.
- Never lubricate any part of this device.
- Never place this device on other electrical equipment.
- Keep this device away from direct sunlight, naked flames or heat.
- Never look into the laser beam inside this device.
- Ensure that you always have easy access to the power cord, plug, or adaptor to disconnect this device from the power.



## Caution

- Use of controls or adjustments or performance of procedures other than herein may result in hazardous radiation exposure or other unsafe operation.

## 2 Your CD Soundmachine

Congratulations on your purchase and welcome to Philips! To fully benefit from the support that Philips offers, register your product at [www.philips.com](http://www.philips.com).

---

### Introduction

With this unit, you can:

- enjoy audio from discs and other external devices;
- listen to radio stations.

The unit supports the following media format:



---

### What's in the box

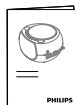
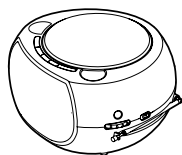

## 3 Get started

Always follow the instructions in this chapter in sequence.

### Install batteries

#### Note

- The batteries contain chemical substances, so they should be disposed of properly.

- 1 Open the battery compartment.
- 2 Insert 6 x 1.5 V R14/UM2/C CELL batteries (not supplied) with correct polarity (+/-) as indicated.®
- 3 Close the battery compartment.

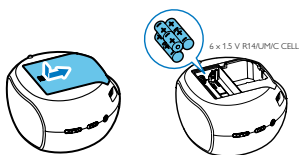

### Connect power

#### Caution

- Risk of product damage! Make sure that the power supply voltage corresponds to the voltage printed on the back or the underside of the device.
- Before connecting the AC power cord, make sure that you have completed all other connections.

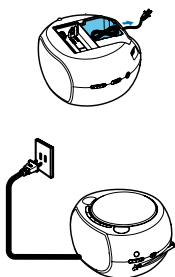

## 4 Use your CD Soundmachine

Congratulations on your purchase and welcome to Philips! To fully benefit from the support that Philips offers, register your product at [www.philips.com](http://www.philips.com).

### Play disc



#### Note

- You cannot play CDs encoded with copyright protection technologies.

You can play commercially available audio CDs:

- CD-Recordables (CD-R)
- CD-Rewritables (CD-RW)
- MP3-CDs
- WMA-CDs

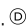
- 1 Open the disc compartment.
- 2 Insert a disc with the printed side facing up. 
- 3 Close the disc compartment.
- 4 Switch the **OFF•RADIO•CD** selector to **CD**.
  - To pause/resume play, press **▶II**.
  - To stop play, press **■**.



### Program tracks





#### Note

- You can program a maximum of 20 tracks.

- 1 In CD mode, when playback is stopped, press **PROG**.
- 2 Press **◀◀/▶▶** to select a track, and then press **PROG** to confirm.
- 3 Repeat steps 2 to program more tracks.
- 4 Press **▶II** to play the programmed tracks.
- 5 To erase the program, press **■**.

### Play control

	Repeat a track or all tracks.
	Play tracks randomly.
<b>PROG</b>	Program tracks.
<b>■</b>	Stop play or erase a program.
<b>▶II</b>	Start or pause play.
<b>◀◀/▶▶</b>	Skip to a track or search within play.
<b>-VOLUME+</b>	Adjust volume.

### Listen to radio



#### Note

- Position the antenna as far as possible from TV, VCR, or other radiation source.
- For optimal reception, fully extend and adjust the position of the antenna.

- 1 Switch the **OFF•RADIO•CD** selector to **RADIO**.
- 2 Switch the selector to **FM** or **MW**.
- 3 Rotate **TUNING** slowly to tune to a radio station. 

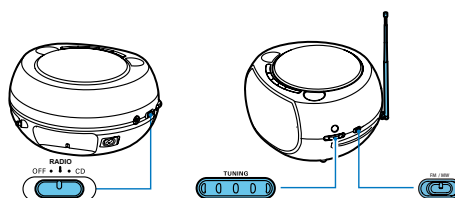

---

## Listen to an external device

You can listen to an external device through this device.

- 1** Switch the **OFF•RADIO•CD** control to **RADIO** or **CD** position.
- 2** Connect the MP3 link cable (not supplied) to:
  - **MP3-LINK** jack (3.5 mm) on the unit
  - the headphone jack on an external device
- 3** Start to play the device (see the device user manual).



## 5 Specifications

### Amplifier

Rated Output Power	2 X 1 W RMS
Frequency Response	80 Hz - 16 kHz, ± 3 dB
Signal to Noise Ratio	50 dB
MP3 Link Input	0.5 V RMS 20 kohm

### Discs

Laser Type	Semiconductor
Disc Diameter	12 cm/8 cm
Support Disc	CD-DA, CD-R, CD-RW
Audio DAC	24 Bits / 44.1 kHz
Total Harmonic Distortion	<1%
Frequency Response	60 Hz -16 kHz
S/N Ratio	55 dBA

### Tuner

Tuning Range	FM: 87.5-108 MHz
Total Harmonic Distortion	<3%
Signal to Noise Ratio	40 dB

### General information

AC power	110V~, 60 Hz
Operation Power Consumption	5 W
Batteries	9 V, 6 × 1.5 V R14/ UM2/C CELL
Dimensions: Main Unit (W × H × D)	245 × 131 × 212 mm
Weight	
- With Packing	1.5 kg
- Main Unit	1.1 kg

# 6 Troubleshooting



## Warning

- Never remove the casing of this device.

To keep the warranty valid, never try to repair the system yourself.

If you encounter problems when using this device, check the following points before requesting service. If the problem remains unsolved, go to the Philips Web page ([www.philips.com/support](http://www.philips.com/support)). When you contact Philips, make sure that the device is nearby and the model number and serial number are available.

### No power

- Make sure that the power plug of the unit is connected properly.
- Make sure that there is power at the AC outlet.
- Insert the batteries with their polarities (+/- signs) aligned as indicated.
- Replace the battery.

### No sound

- Adjust the volume.
- Make sure that the track played is of a compatible format.

### Display does not function properly./No reaction to operation of any of the controls.

- Disconnect the power cord.
- Connect the power cord after a few seconds.

### Cannot play disc

- Make sure that the disc label is inserted with the printed side facing up.
- Wipe the disc with fibre cleaning cloth from the centre to the edge in a straight line.
- This disc may be defective. Play another disc.
- Make sure that the CD is a finalized CD/CD-R/CD-RW.
- Make sure that the laser lens is clean.
- Make sure that the CD is not encoded with copyright protection technologies.

### The CD skips tracks

- Make sure that the CD is not damaged or dirty.
- Make sure that program/shuffle mode is deactivated.

## 7 Notice



### Note

- The type plate is located in the battery compartment.

Any changes or modifications made to this device that are not expressly approved by Philips Consumer Lifestyle may void the user's authority to operate the equipment.

Your product is designed and manufactured with high quality materials and components, which can be recycled and reused.

Never dispose of your product with other household waste. Please inform yourself about the local rules on the separate collection of electrical and electronic products and batteries. The correct disposal of these products helps prevent potentially negative consequences on the environment and human health.

Your product contains batteries, which cannot be disposed of with normal household waste. Please inform yourself about the local rules on separate collection of batteries. The correct disposal of batteries helps prevent potentially negative consequences on the environment and human health.

Please visit [www.recycle.philips.com](http://www.recycle.philips.com) for additional information on a recycling center in your area.

### Environmental information

All unnecessary packaging has been omitted. We have tried to make the packaging easy to separate into three materials: cardboard (box), polystyrene foam (buffer) and polyethylene (bags, protective foam sheet.)

Your system consists of materials which can be recycled and reused if disassembled by a specialized company. Please observe the local regulations regarding the disposal of packaging materials, exhausted batteries and old equipment.

**This apparatus includes this label:**

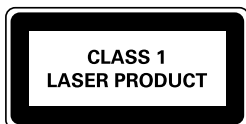



Specifications are subject to change without notice  
© 2012 Koninklijke Philips Electronics N.V.  
All rights reserved.

AZ100\_96\_UM\_V1.0

