

Register your product and get support at
www.philips.com/welcome

CTS4000



EN	Compact Theatre System (CinemaOne)	5
FR	Home Cinéma compact (CinemaOne)	43
ES	Sistema de cine en casa compacto (CinemaOne)	81
DE	Kompaktes Heimkinosystem (CinemaOne)	119
NL	Compact Theatre-systeem (CinemaOne)	159

PHILIPS

Important notes for users in U.K.

Mains plug

This apparatus is fitted with an approved 13 Amp plug. To change a fuse in this type of plug proceed as follows:

1. Remove fuse cover and fuse.
2. Fix new fuse which should be a BS1362 5 Amp, A.S.T.A. or BSI approved type.
3. Refit the fuse cover.

If the fitted plug is not suitable for your socket outlets, it should be cut off and an appropriate plug fitted in its place.

If the mains plug contains a fuse, this should have a value of 5 Amp. If a plug without a fuse is used, the fuse at the distribution board should not be greater than 5 Amp.

Note: The severed plug must be disposed off to avoid a possible shock hazard should it be inserted into a 13 Amp socket elsewhere.

How to connect a plug

The wires in the mains lead are coloured with the following code: blue = neutral (N), brown = live (L).

- As these colours may not correspond with the colour markings identifying the terminals in your plug, proceed as follows:
 - Connect the blue wire to the terminal marked N or coloured black.
 - Connect the brown wire to the terminal marked L or coloured red.
- Do not connect either wire to the earth terminal in the plug, marked E (or e) or coloured green (or green and yellow).

Before replacing the plug cover, make certain that the cord grip is clamped over the sheath of the lead - not simply over the two wires.

Copyright in the U.K.

Recording and playback of material may require consent. See Copyright Act 1956 and The Performer's Protection Acts 1958 to 1972.

Italia

DICHIARAZIONE DI CONFORMITA'

Si dichiara che l'apparecchio CTS4000, Philips risponde alle prescrizioni dell'art. 2 comma 1 del D.M. 28 Agosto 1995 n. 548.

Fatto a Eindhoven

Philips Consumer Electronics
Philips, Glaslaan 25616 JB Eindhoven,
The Netherlands

Norge

Typeskilt finnes på apparatens underside.

Observer: Nettbryteren er sekundert innkoplet. Den innebygde nettdelen er derfor ikke frakoplet nettet så lenge apparatet er tilsluttet nettkontakten.

For å redusere faren for brann eller elektrisk støt, skal apparatet ikke utsettes for regn eller fuktighet.

DK

Advarsel: Usynlig laserstråling ved åbning når sikkerhedsafbrydere er ude af funktion. Undgå udsættelse for stråling.

Bemærk: Netafbryderen er sekundært indkoblet og afbryder ikke strømmen fra nettet. Den indbyggede netdel er derfor tilsluttet til lysnettet så længe netstikket sidder i stikkontakten.

S

Klass 1 laserapparat

Varning! Om apparaten används på annat sätt än i denna bruksanvisning specificerats, kan användaren utsättas för osynlig laserstråling, som överskrider gränsen för laserklass 1.

Observera! Stömbrytaren är sekundärt kopplad och bryter inte strömmen från nätet. Den inbyggda nätdelen är därför ansluten till elnätet så länge stickproppen sitter i vägguttaget.

SF

Luokan 1 laserlaitte

Varoitus! Laitteen käyttäminen muulla kuin tässä käyttöohjeessa mainitulla tavalla saattaa altistaa käyttäjän turvallisuusluokan 1 ylittävälle näkymättömälle lasersäteilylle.

Oikeus muutoksiin varataan. Laitte ei saa olla alttiina tippu- ja roiskevedelle.

Huom. Toiminnanvalitsin on kytketty toisiopuolelle, eikä se kytke laitetta irti sähköverkosta. Sisäänrakennettu verkko-osa on kytkettynä sähköverkkoon aina silloin, kun pistoke on pistorasiassa.



Manufactured under license from Dolby Laboratories. Dolby, Pro Logic, and the double-D symbol are registered trademarks of Dolby Laboratories.



Manufactured under license under U.S. Patent #'s: 5,451,942; 5,956,674; 5,974,380; 5,978,762; 6,487,535 & other U.S. and worldwide patents issued & pending. DTS and DTS Digital Surround are registered trademarks and the DTS logos and Symbol are trademarks of DTS, Inc. © 1996-2007 DTS, Inc. All Rights Reserved.



DivX, DivX Ultra Certified, and associated logos are trademarks of DivX, Inc. and are used under license.

Official DivX® Ultra Certified product.

Plays all versions of DivX® video (including DivX® 6) with enhanced playback of DivX® media files and the DivX® Media Format.



Windows Media and the Windows logo are trademarks, or registered trademarks of Microsoft Corporation in the United States and/ or other countries.

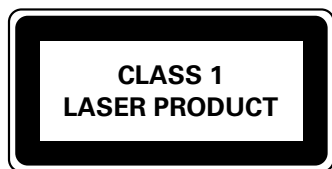

HDMI, and HDMI logo and High-Definition Multimedia Interface are trademarks or registered trademarks of HDMI licensing LLC.



The USB-IF Logos are trademarks of Universal Serial Bus Implementers Forum, Inc.



iPod is a trademark of Apple Computer, Inc., registered in the U.S. and other countries.



ENERGY STAR and the ENERGY STAR mark are registered U.S. marks

LASER	
• Type	Semiconductor laser GaAlAs
• Wave length	645 - 660 nm (DVD) 770 - 800 nm (CD)
• Output Power	6 mW (DVD) 7 mW (VCD/CD)
• Beam divergence	60 degrees

Contents

1 Important	6
Safety and important notice	6
2 Your product	8
Features highlight	8
Product overview	9
3 Connect	12
Place the unit	12
Connect video cables	13
Connect to the power outlet	15
Connect audio cables/other devices	15
4 Get started	18
Prepare the remote control	18
Find the correct viewing channel	19
Select menu display language	19
Select a play source	20
5 Play	21
Play from disc	21
Play video	22
Play music	25
Play photo	26
Play from USB device	27
Play from portable media player	28
Play from iPod	28
6 Adjust sound	30
Control the volume	30
Select a preset sound effect	30
7 Adjust settings	31
General setup	31
Audio setup	32
Video setup	33
Preference Setup	35
8 Additional information	38
Update software	38
Care	38
Specifications	39
9 Troubleshooting	40
10 Glossary	42

1 Important

Safety and important notice

Warning!

Risk of fire or electric shock!

- Ensure that air can circulate freely through the ventilation holes on this unit. Allow at least 5~10 cm clearance around the unit.
- Never place this unit, remote control or batteries near naked flames or other heat sources, including direct sunlight.
- Never place this unit on other electrical equipment.
- Keep away from this unit during lightning storms.
- Never remove the casing of this unit. Please leave all maintenance work to qualified personnel.
- Keep this unit away from water, moisture and liquid-filled objects.

Caution!

- Remove batteries if they are exhausted or if the remote control is not to be used for a long time.
- Do not mix batteries (old and new or carbon and alkaline, etc.).
- Batteries contain chemical substances, they should be disposed of properly.
- Visible and invisible laser radiation when open. Avoid exposure to beam.
- Where the MAINS plug or an appliance coupler is used as the disconnect device, the disconnect device shall remain readily operable.



This product complies with the radio interference requirements of the European Community. This product complies with the requirements of the following directives and guidelines: 2006/95/EC, 2004/108/EC.

Recycle notice



Your product is designed and manufactured with highly quality material and components, which can be recycled and reused. When this crossed-out wheeled bin symbol is attached to a product, it means the product is covered by the European Directive 2002/96/EC.

Please inform yourself about the local separate collection system for electrical and electronic products. Please act according to your local rules and do not dispose your old products with your normal household waste. The correct disposal of your old product will help to prevent potential negative consequences for the environment and human health.

Notes for battery disposal

Your product contains batteries covered by the European Directive 2006/66/EC, which cannot be disposed of with normal household waste.

Please inform yourself about the local rules on separate collection of batteries. The correct disposal of batteries helps prevent potentially negative consequences on the environment and human health.

Copyright notice



This product incorporates copyright protection technology that is protected by method claims of certain U.S. patents and other intellectual property rights owned by Macrovision Corporation and other rights owners. Use of this copyright protection technology must be authorised by Macrovision Corporation, and is intended for home and other limited viewing uses only unless otherwise authorised by Macrovision Corporation. Reverse engineering or disassembly is prohibited.

2 Your product

Congratulations on your purchase, and welcome to Philips! To fully benefit from the support that Philips offers, register your product at www.philips.com/welcome.

This Compact Theatre System (CinemaOne) is designed to complement your home perfectly. Enjoy the excellent sound and picture quality.

Features highlight

Video upscaling to 1080p

You can now watch the DVDs in the highest picture quality available for your HDTV. This Compact Theatre System offers full high-definition video playback up to 1080p resolution for an amazing viewing experience. A highly detailed picture and increased sharpness delivers a more true-to-life picture.

USB direct and MP3 link





Simply plug your USB device into the USB socket to play your MP3/WMA/JPEG/DivX files; or plug your portable media player to the MP3 LINK socket to enjoy the music play in superb sound quality.

Sync the audio output with the video play

This Compact Theatre System provides you the feature of delaying the audio output if the video signals that go directly to the TV is slower than the audio streams.

Region codes

DVD movies are usually not released at the same time in all regions of the world, thus all DVD players are programmed to a specific region code.

Countries	DVD region code
Europe	 
Russia	 

Product overview

Main unit

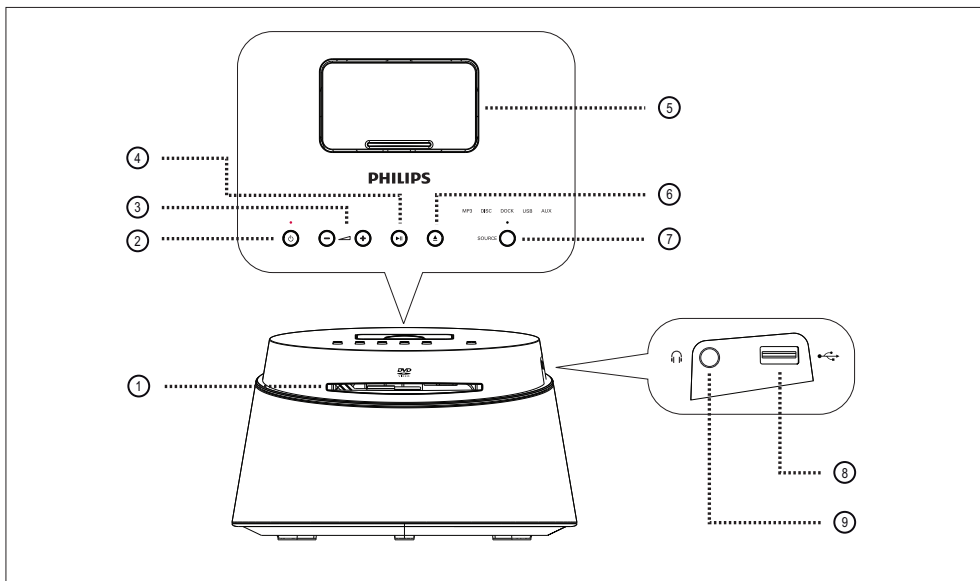

① Disc compartment

② (Standby-on)

- Turn on this unit or turn off to standby mode.

③ (Volume)

- Adjust the volume level.

④ (Play/Pause)

- Start or pause disc play.

⑤ Docking Station

- To connect iPod.

⑥ (Open/Close)

- Open or close the disc compartment.

⑦ SOURCE

- Select a play media:
MP3, DISC, DOCK, USB, AUX.

Note

- The following connections are located at the left side panel of the unit.

⑧ (USB) socket

- To connect USB storage device.

⑨ (Phones) socket

- To connect headphone.

Remote control

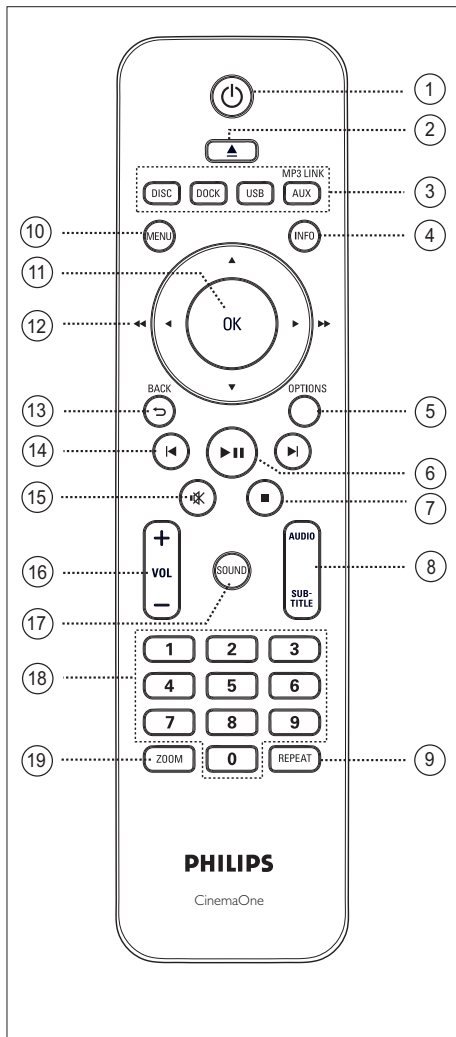

- ① **⏻** (Standby-On)
 - Turn on this unit or turn off to standby mode.
- ② **⏏** (Open/Close)
 - Open or close the disc compartment.
- ③ **Source buttons**
 - **DISC**: switch to DISC mode.
 - **DOCK**: switch to the iPod in the dock.
 - **USB**: switch to USB mode.
 - **AUX / MP3 LINK**: switch to device that is connected to the AUX or MP3 LINK socket.
- ④ **INFO**
 - Display the current status or disc information.
 - Display photo files in 12 thumbnails view.
- ⑤ **OPTIONS**
 - Access or exit Options menu (this menu provides various setting options).
- ⑥ **▶||** (Play/Pause)
 - Start or pause disc play.
- ⑦ **■** (Stop)
 - Stop disc play.
- ⑧ **AUDIO/SUBTITLE**
 - Select an audio language/channel.
 - Select DVD or DivX subtitle language.
- ⑨ **REPEAT**
 - Select various repeat or shuffle modes; turns off repeat or shuffle mode.

- ⑩ **MENU**
 - For DVD, go to title menu.
 - For VCD version 2.0 or SVCD with PBC turned on: return to the menu during playback.
- ⑪ **OK**
 - Confirm an entry or selection.
- ⑫ **Cursor buttons (▲▼◀▶)**
 - Navigate through the on-screen menu.
 - Press left or right for fast forward and backward search.
- ⑬ **BACK ↶**
 - Return to the previous display menu.
- ⑭ **◀ / ▶ (Previous/Next)**
 - Skip to the previous or next title/ chapter/track.
- ⑮ **🔇 (Mute)**
 - Mute or restore the volume.
- ⑯ **VOL + -**
 - Adjust the volume level.
- ⑰ **SOUND**
 - Select a predefined sound effect.
- ⑱ **Numeric buttons**
 - Enter a preset number or item to play.
- ⑲ **ZOOM**
 - Zoom in or out the picture on the TV.

3 Connect

This section describes the basic connections required for this Compact Theatre System (CinemaOne) before it can be used.

Basic connections:

- Connect video cables
- Connect to power outlet

Optional connections:

- Connect audio cables/other devices
 - Connect audio from TV
 - Connect audio from cable box/recorder/game console
 - Connect portable media player
 - Connect USB device
 - Connect iPod

Note

- Refer to the type plate at the rear or bottom of the product for identification and supply ratings.
- Before you make or change any connections, ensure that all the devices are disconnected from the power outlet.

Place the unit

- For optimum performance, place this unit on a table.
- Never place this unit in an enclosed cabinet.
- Install this unit near the AC outlet where the AC power plug can be easily reached.

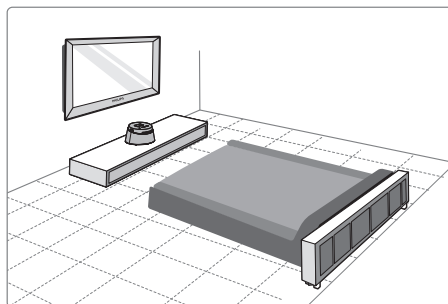

- 1 Place this Compact Theatre System near to the TV.

Note

- To avoid magnetic interference or unwanted noise, never place this unit too close to any radiation devices.

Connect video cables

This section describes how to connect this Compact Theatre System to your TV so to enable viewing of disc play.

Select the best video connection that your TV can support.

- **Option 1:** Connect to the HDMI socket (for a HDMI, DVI or HDCP-compliant TV).
- **Option 2:** Connect to the SCART socket (for a standard TV).
- **Option 3:** Connect to the Video (CVBS) socket (for a standard TV).



Note

- You must connect this unit directly to a TV.

Before you connect

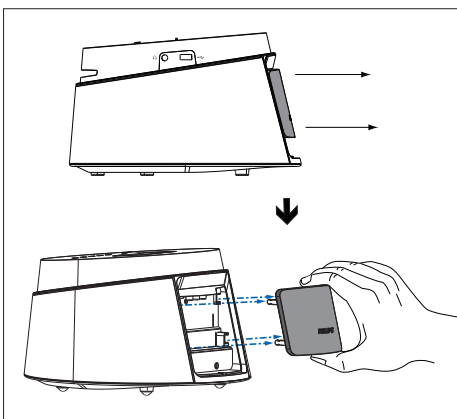

- 1 Remove the rear cover from this unit.
- 2 Connect the cables to the corresponding sockets.
- 3 Attach the rear cover.

Option 1: Connect to the HDMI socket

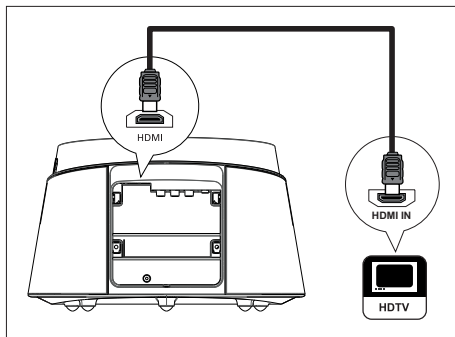

- 1 Connect a HDMI cable (supplied) from the **HDMI** socket on this unit to the **HDMI IN** socket on your TV.



Note

- The HDMI connector is only compatible with HDMI compliant TVs and DVI-TVs.



Tips

- To optimise the video output, see chapter 'Adjust settings' > [**Video Setup**] > [**HDMI Setup**] for details. .
- Use an HDMI/DVI adaptor in case your TV has only a DVI connection. An extra audio connection is needed to complete this connection.
- To route the audio from your TV to this Compact Theatre System, connect an audio cable from the audio input on this unit to the audio output on your TV.
- This type of connections provides best picture quality.

Option 2: Connect to the SCART socket

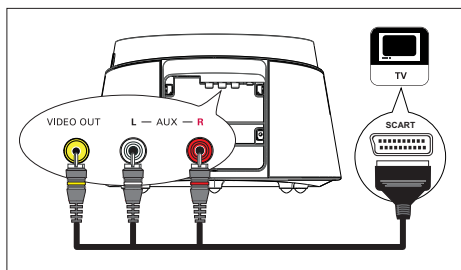

- 1 Connect the SCART converter cable (supplied) from the **VIDEO OUT**, **AUX L/R** sockets on this unit to the SCART input socket on your TV.

Option 3: Connect to the Video (CVBS) socket

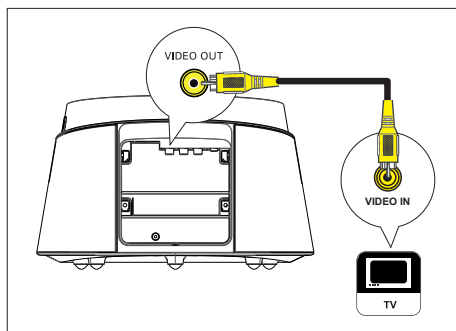

- 1 Connect a composite video cable (supplied) from the **VIDEO OUT** socket on this unit to the video input socket on your TV.

Tips

- The video input socket on your TV may be labelled as A/V IN, VIDEO IN, COMPOSITE or BASEBAND.
- This type of connections provide standard picture quality.

Connect to the power outlet

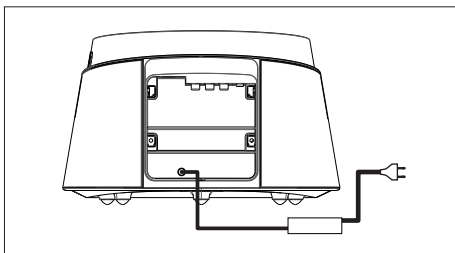

- 1 Connect the power adaptor and power cord from this unit to the power outlet.

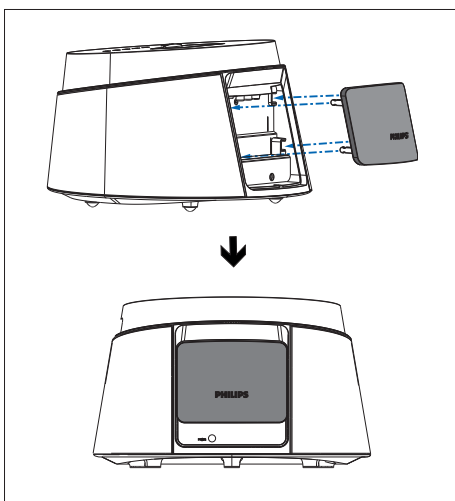

- 2 When all the required connections are complete, attach the rear cover and you are ready to enjoy this Compact Theatre System.

Connect audio cables/other devices

This section describes how you can route the sound from other devices to this Compact Theatre System in order to enjoy sound output or audio play with surround capabilities.

Connect audio from TV

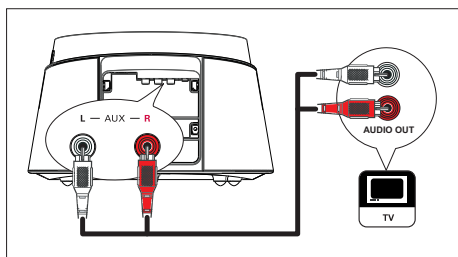

- 1 Connect an audio cable (not supplied) from the **AUX L/R** sockets on this unit to the **AUDIO OUT** sockets on your TV.

Note

- To listen to the audio output from this connection, press **AUX / MP3 LINK** repeatedly until 'AUX' is displayed on the display panel.

Connect audio from cable box/ recorder/game console

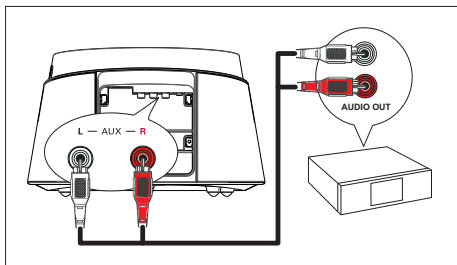

- 1 Connect an audio cable (not supplied) from the **AUX L/R** sockets on this unit to the **AUDIO OUT** sockets on the device.

Note

- To listen to the audio output from this connection, press **AUX / MP3 LINK** repeatedly until 'AUX' is displayed on the display panel.

Connect portable media player

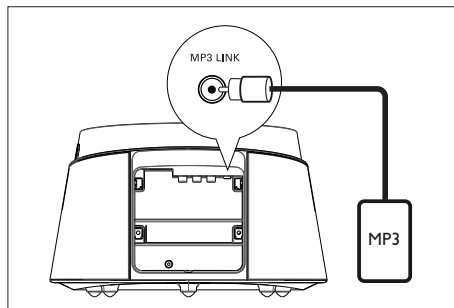

- 1 Connect a 3.5mm stereo audio cable (supplied) from the **MP3 LINK** socket on this unit to the phone socket on your portable media player (such as MP3 player).

Note

- To listen to the audio output from this connection, press **AUX / MP3 LINK** repeatedly until 'MP3' is displayed on the display panel.

Connect USB device

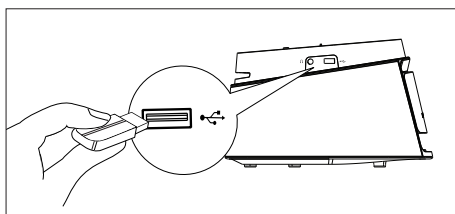

- 1 Connect the USB device to **USB** socket on this unit.

Note

- This Compact Theatre System can only play/view MP3, WMA, WMV, DivX (Ultra) or JPEG files that are stored on the USB device.
- To listen to the audio output from this connection, press **USB**.

iPod Dock

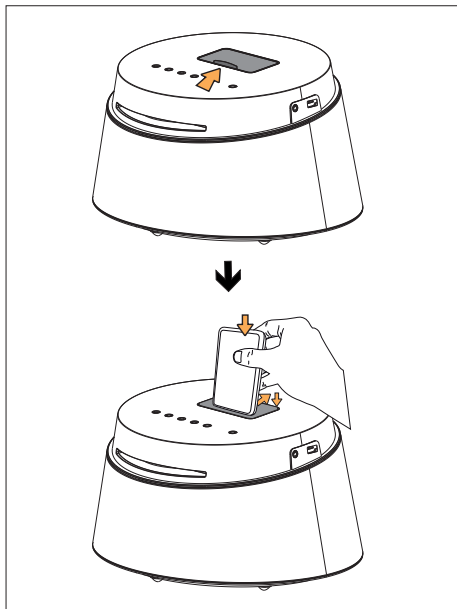

- 1 Slide open the lid of the docking station.
- 2 Dock the iPod.
 - Push back the rear support to dock into position.
- 3 To view videos from iPod, switch to the corresponding channel on your TV.



Note

- To listen to the audio output from this connection, press DOCK.

4 Get started

Prepare the remote control

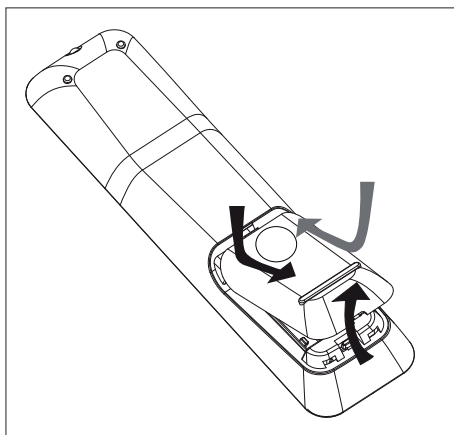

- 1 Push to open the battery compartment cover.
- 2 Insert two batteries type R03 or AAA. Match the indications (+ -) inside the battery compartment.
- 3 Close the cover.



Note

- If you are not going to use the remote control for a long time, remove the batteries.

Control a play source

- 1 Select the source you wish to control by pressing the **MP3, DISC, DOCK, USB, AUX** button.
- 2 Then select the desired function (for example **◀, ▶**).

Navigate through the menu

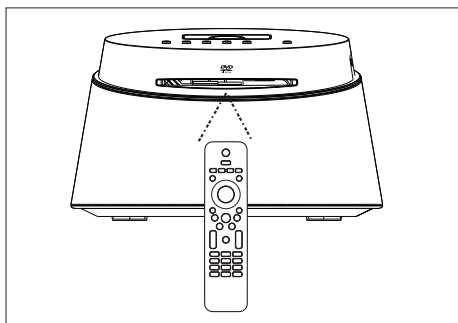

- 1 Point the remote control directly at the remote sensor on this unit and select the desired function.



- 2 Use the following buttons on the remote control to navigate through the on-screen menu.

Button	Action
▲ ▼	Move up or down.
◀ ▶	Move left or right.
○ OK	Confirm a selection.
1 2 3 4 5 6 7 8 9 0	Enter numbers.

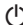
Find the correct viewing channel

- 1 Press  to turn on the Compact Theatre System.
- 2 Press **DISC** to switch to disc mode.
- 3 Turn on the TV and switch it to the correct video-in channel.
 - You may go to the lowest channel on your TV, then press the Channel Down button on your TV's remote control until you see the Video In channel.
 - You may press  button repeatedly on your TV's remote control.
 - Usually this channel is between the lowest and highest channels and may be called FRONT, A/V IN, VIDEO, etc..









Tips

- See TV's user manual on how to select the correct input on your TV.

Select menu display language

- 1 Press **DISC**.
- 2 Press **OPTIONS**.
↳ [**General Setup**] menu is displayed.
- 3 Press **▶**.
- 4 Press **▲▼** to select [**OSD Language**] in the menu, then press **▶**.

General Setup		
	Disc Lock	Auto
	OSD Language	English
	Screen Saver	Dansk
	Sleep Timer	Deutsch
	DivX(R) VOD Code	Español
		Français
		Italiano
		Nederlands ▼

- The language options are different depending on your country or region. It may not correspond to the illustration shown here.

- 5 Press **▲▼** to select a language, then press **OK**.



Tips

- To set the default language for DVD audio and disc menu, see chapter 'Adjust settings' - [**Preference Setup**] for details.

Select a play source

On the main unit

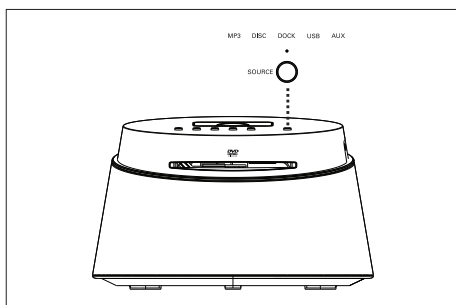

- 1 Press **SOURCE** button repeatedly to select: **DISC > DOCK > USB > AUX > MP3 > DISC ...**

On the remote control

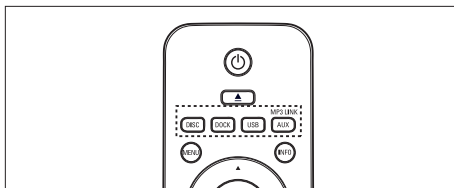

- Press **DISC** to switch to DISC mode.
- Press **DOCK** to switch to iPod mode.
- Press **USB** to switch to USB mode.
- Press **AUX / MP3 LINK** repeatedly to listen to the audio output from the external device.

5 Play

Play from disc

Playable discs

	DVD Video <ul style="list-style-type: none">• Region 2 (Europe)• Region 5 (Russia)
	DVD±RW (DVD Rewritable)
	DVD±R (DVD Recordable)
	DVD+R DL (DVD+R Double Layer)
	CD-RW (CD-Rewritable)
	CD-R (CD-Recordable)
	Audio CD (Compact Disc Digital Audio)
	Video CD <ul style="list-style-type: none">• Formats 1.0, 1.1, 2.0
	Super Video CD

Note

- DVDs and DVD players are designed with regional restrictions. Ensure that the DVD video you play is for the same region zone as your player (indicated on its rear).
- This unit can support playback of the following file formats: MP3/WMA/WMV/ JPEG/DivX.

Play a disc

! Caution!

- Never place any objects other than discs into the disc compartment.
- Never touch the disc optical lens inside the disc compartment.

- 1 Insert a disc with its label facing up.
 - For double-sided disc, load the side to play faces out.
 - To view disc play, turn on the TV to the correct viewing channel for this Compact Theatre System.
- 2 To stop disc play, press **■**.

* Tips

- If the password entry menu is displayed, you have to enter the 4-digit password before it can be played.
- Screen saver displays automatically if the disc play is stopped for about 15 minutes. To deactivate the screen saver, press **DISC**.
- This unit automatically switches to standby mode if you do not press any buttons within 30 minutes after a disc has stopped playing.

Play video



Note

- For video disc, playback always resumes from the point where it was last stopped. To start playback from the beginning, press **◀** while the message is displayed.

Control a title

- 1 Play a title.
- 2 Use the remote control to control the title.

Button	Action
	Pause/ resume play.
	Stop play.
	Jump to the next title/chapter.
	Return to the beginning of the current title/chapter or jump to the previous title/chapter.
	Search backward/ forward. <ul style="list-style-type: none">• To change search speed, press this button repeatedly.
	Slow motion reverse/ forward play. <ul style="list-style-type: none">• To change play speed, press this button repeatedly.• For VCD, only forward play is possible.

Change video play

- 1 Play a title.
- 2 Use the remote control to change the video play.

Button	Action
	Change audio language. <ul style="list-style-type: none">• Only applicable to discs with multiple audio language or channel.
	Change subtitle language. <ul style="list-style-type: none">• Only applicable to discs with multiple subtitle language.
	Toggle through various repeat/shuffle play mode; or turn off repeat mode. <ul style="list-style-type: none">• Repeat options vary depending on the disc type.• For VCDs, repeat play is only possible if the PBC mode is turned off.
	Zoom in/out. <ul style="list-style-type: none">• To pan through the zoomed image, press the cursor buttons.
	Display current play status. <ul style="list-style-type: none">• You can change the video play options here without interrupting disc play.

Access DVD menu

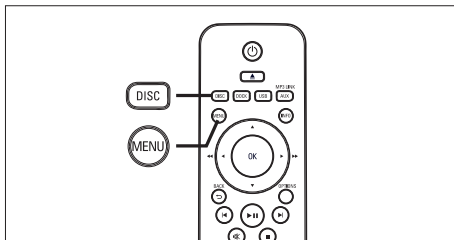

- 1 Press **DISC** to access disc main menu.
- 2 Select a play option, then press **OK**.
 - In some menus, press **number buttons** to input your selection.
 - To return to the title menu during playback, press **MENU**.

Access VCD menu or preview menu

The PBC (Playback Control) for VCD is turned on by default in the factory. When you load in a VCD, the contents menu is displayed.

- 1 Press **▲▼** to select a play option, then press **OK** to start play.
 - If PBC is off, it skips the menu and starts play from the first title.
 - During playback, you can press **MENU** to return to the menu (if the PBC mode is on).
- 2 To preview the contents of the disc, press **DISC**.
 - To exit the menu, press **DISC**.

Select Digest Type:

- Track Digest
- Disc Interval
- Track Interval

[Track Digest]

It plays the first few seconds of each track in a disc.

[Disc Interval]

It divides the total disc time by six and plays the first few seconds of these intervals.

[Track Interval]

It divides the current track by six and plays the first few seconds of these intervals.

- This option is not available in stop mode.

- 3 Select a preview play option, then press **OK**.



Tips

- The default setting for PBC is on. To change the default setting, see chapter 'Adjust settings' - [**Preference Setup**] > [**PBC**] for details.

Quick skip play to a specific time

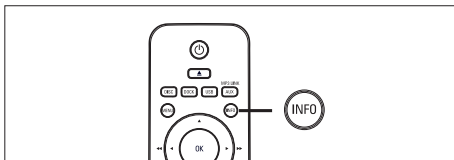





- 1 During playback, press **INFO**.
↳ The disc status menu is displayed.
- 2 Select the current elapsed playing time in the menu, then press **OK**.
 - [**TT Time**] (title time)
 - [**CH Time**] (chapter time)
 - [**Disc Time**] (disc time)
 - [**Track Time**] (track time)
- 3 Press the **number buttons** to change the time where you want to skip to, then press **OK**.

Play DivX® video

DivX video is a digital media format that retains high quality despite a high rate of compression. This unit is DivX® Certified so that you can enjoy DivX video.

- 1 Insert a disc or USB that contains the DivX videos.
- 2 Press **DISC** or **USB**.
↳ A contents menu is displayed.
- 3 Select a title to play, then press **▶||**.
- 4 Use the remote control to control the title.

Button	Action
	Change audio language/track.
	Change subtitle language.
	Stop play. <ul style="list-style-type: none">• For DivX Ultra video, press this button again to display the contents menu.
	Display DivX Ultra video information.

Note

- Only those DivX videos that were rented or purchased using the DivX registration code of this unit can be played (see chapter 'Adjust settings' > [**General Setup**] > [**DivX(R) VOD Code**] for details).
- If the subtitle does not appear correctly, change the subtitle language (see chapter 'Adjust settings' - [**Preference Setup**] > [**DivX Subtitle**] for details).
- The subtitle can only be displayed up to an average of 45 characters.
- This unit can play DivX video files that are up to 4GB in size.

Play music



Note

- For some commercial audio discs, playback may resume from the point where it was last stopped. To start play from first track, press **◀**.

Control a track

- 1 Play a track.
- 2 Use the remote control to control the track.

Button	Action
	Pause/ resume play.
	Stop play.
	Jump to the next track.
	Return to the beginning of the current track or jump to the previous track.
	Direct input the track number.
	Search backward/ forward. <ul style="list-style-type: none"> • To change search speed, press this button repeatedly.
	Toggle through various repeat/ shuffle play mode; or turn off repeat mode. <ul style="list-style-type: none"> • Repeat options vary depending on the disc type.

Play MP3/WMA music

MP3/WMA is a type of highly compressed audio file (files with .mp3 or .wma extensions).

- 1 Insert a disc or USB that contains the MP3/WMA music.
- 2 Press **DISC** or **USB**.
 - ↳ A contents menu is displayed.
- 3 Select a folder, then press **OK**.
- 4 Select a track to play, then press **▶||**.
 - To return to the main menu, press **▲** until 'Previous' folder is selected, then press **OK**.



Note

- For CDs recorded in multiple sessions, only the first session is played.
- This unit does not support MP3PRO audio format.
- If any special characters are present in the MP3 track name (ID3) or album name, it might not be displayed correctly on the screen because these characters are not supported.
- Some WMA is protected by Digital Rights Management (DRM), it cannot be played on this unit.
- Folders/files exceed the supported limit of this unit will not be displayed or played.



Tips

- To display the data disc contents without folders, see chapter 'Adjust settings' - [**Preference Setup**] > [**MP3/JPEG Nav**] for details.

Play photo

Play photos as slideshow

This unit can play JPEG photos (files with .jpg or .jpeg extensions).

- 1 Insert a disc or USB that contains the JPEG photos.
- 2 Press **DISC** or **USB**.
 - ↳ For a Kodak disc, the slideshow begins automatically.
 - ↳ For a JPEG disc, the photo menu is displayed.
- 3 Select the folder/album you want to play.
 - To preview the photos in the folder/album, press **INFO**.



- To go to previous or next screen display, press **◀** / **▶**.
 - To select a photo, press the cursor buttons.
 - To display the selected photo only, press **OK**.
- 4 Press **▶||** to start slideshow play.
 - To return to the menu, press **MENU**.

Note

- It may require longer time to display the disc content on the TV due to the large number of songs/photos compiled onto one disc.
- If the JPEG photo is not recorded with an 'exif' type file, the actual thumbnail picture will not be shown on the display. It will be replaced with a 'blue mountain' thumbnail picture.
- This unit can only display digital camera pictures according to the JPEG-EXIF format, typically used by almost all digital cameras. It cannot display Motion JPEG and pictures in formats other than JPEG, or sound clips associated with pictures.
- Folders/files exceed the supported limit of this unit will not be displayed or played.

Control photo play

- 1 Play photo slideshow.
- 2 Use the remote control to control the photo.

Button	Action
◀	Skip to the previous photo.
▶	Skip to the next photo.
▲	Rotate the photo clockwise.
▼	Rotate the photo counter-clockwise.
	Zoom in/ out. <ul style="list-style-type: none">• Play will pause while in zoom mode.
	Stop play.

Play musical slideshow

Play MP3/WMA music files and JPEG photo files simultaneously to create musical slideshow. The MP3/WMA and JPEG files must be stored on the same disc or USB device.

- 1 Play MP3/WMA music.
- 2 Navigate to the photo folder/album and press **▶||** to start slideshow play.
 - ↳ Slideshow begins and continues till the end of the photo folder or album.
 - ↳ Audio continues to play till the end of the disc.
 - To return to the menu, press **MENU**.
- 3 To stop slideshow play, press **■**.
- 4 To stop music play, press **■** again.

Play from USB device

This unit plays/views MP3, WMA, WMV, DivX (Ultra) or JPEG files on the following USB devices:

- digital camera that complies with the PTP standard
- flash drive
- memory card reader
- HDD (external power source needed)

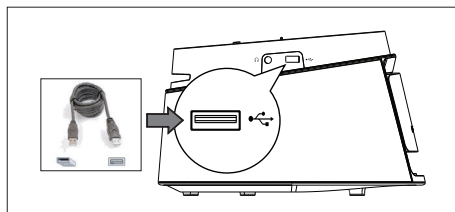

- 1 Connect a USB storage device to the **↔ (USB)** socket.
- 2 Press **USB**.
 - ↳ A contents menu is displayed.
- 3 Select a file to play, then press **▶||**.
 - For more information, see chapters 'Play music, Play photo, Play video' for details.
- 4 To stop play, press **■** or remove the USB device.

Tips

- If the device does not fit into the USB socket, connect it through a USB extension cable.
- If a multiple USB card reader is used, only one of the connected USB drive contents can be accessed.
- If a USB HDD is used, ensure that an auxiliary power cord is connected to the USB HDD for proper operations.
- Digital cameras that use PTP protocol or require additional programme installation when connected to a PC are not supported.

Play from portable media player

Simply connect your portable media player (e.g. MP3 player) to this unit to enjoy superb sound quality from your music collections.

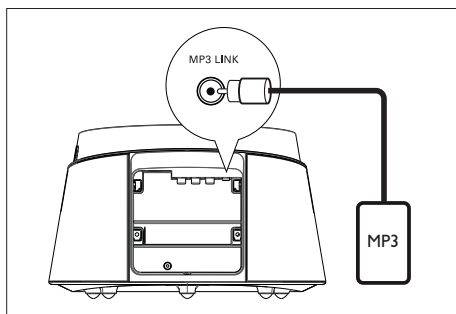

- 1 Connect a 3.5mm stereo audio cable (supplied) from the **MP3 LINK** socket on this unit to the 'headphone' socket on your portable media player.
- 2 Press **AUX / MP3 LINK** repeatedly until 'MP3' is displayed.
- 3 Start play on your portable media player.
 - See chapter 'Adjust Sound' to enhance the audio output.
- 4 To stop play, press **STOP** button on your portable media player.

Note

- Control playback is only possible on your portable media player.
- Stop play on the portable media player before you switch to other play media/source.

Play from iPod

Simply connect your iPod to the docking station to enjoy your iPod play through this Compact Theatre System.

List of supported iPod range:

iPod mini	iPod nano 1st gen
iPod touch	iPod nano 2nd gen
iPod classic	iPod nano 3rd gen
iPod mini 2nd gen	iPod 5th gen
iPod with colour display	

Note

- Refer to Philips website for latest updates on the supported iPod range.

Control iPod music

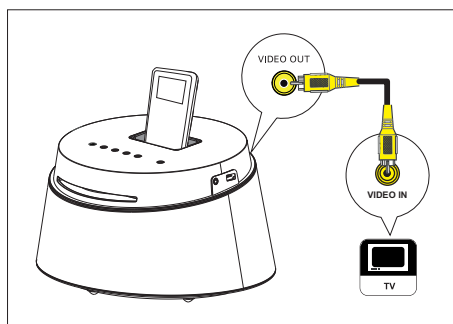







- 1 Push to open the lid of the docking station
- 2 Dock your iPod to the docking station and turn it on.
- 3 Press **DOCK**.
 - It may require longer time to authenticate the compatibility of certain iPod range.

- 4 Start play on your iPod.
- To view iPod video play, connect a video cable from the docking station to your TV and turn on 'TV ON' setting in your iPod.
- 5 During playback, you can use the remote control to control the music play.

 Tips

- While in iPod mode, the battery of your iPod will be charged.
- In extended play mode, control of iPod play is only possible through the contents displayed on your TV using this Compact Theatre's remote control.

Button	Action
	Change the volume level.
	Select a predefined sound effect.
	Go to the previous/ next track.
	Search backward/ forward.
	Pause/resume play.
	Switch to 'Extended Control mode' to enable control of your iPod play through the contents displayed on TV. <ul style="list-style-type: none"> Control buttons on iPod have no function in this mode. Press this button again to return to simple play mode.
	Toggle through various repeat/shuffle play mode; or turn off repeat mode. <ul style="list-style-type: none"> This option is only available in 'Extended Control mode'.

6 Adjust sound

Control the volume

- 1 Press **VOL +** **-** to increase or decrease the volume level.
 - To mute the volume, press **MUTE**.
 - To restore the volume, press **MUTE** again or press the volume button.

Select a preset sound effect

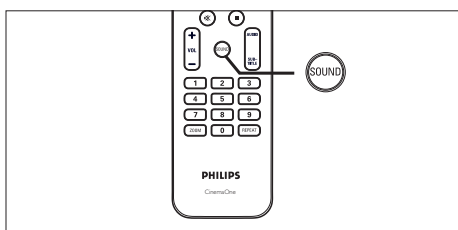





- 1 Press **SOUND** repeatedly to select a sound effect that most suits the video or music you play.

Video / Music	Descriptions
ACTION / ROCK	Enhanced low and high range for great sounding movie effects and atmosphere. Great for action movies and rock/pop music.
CONCERT / CLASSIC	Flat and pure sound mode. Ideal for listening to classical music and watching live concert DVDs.
GAMING / PARTY	Slightly enhanced low range and strong mid range ideal for party music and video gaming.
NEWS	Enhanced mid range for clear vocals/speech.



7 Adjust settings

This section describes the various setting options of this unit.

Symbol	Options
	[General Setup]
	[Audio Setup]
	[Video Setup]
	[Preference Setup]

General setup

- 1 Press **OPTIONS**.
↳ [**General Setup**] menu is displayed.
- 2 Press **▶**.
- 3 Select an option, then press **OK**.

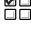
General Setup	
	Disc Lock
	OSD Language
	Screen Saver
	Sleep Timer
	DivX(R) VOD Code
	

- See the explanations of the above options in the following pages.
- 4 Select a setting, then press **OK**.
 - To return to the previous menu, press **BACK**.
 - To exit the menu, press **OPTIONS**.

[Disc Lock]

Set play restriction for a specific discs. Before you start, place the disc in the disc compartment (maximum 40 discs can be locked).

- [**Lock**] – restrict access to the current disc. The next time you want to play this disc or unlock it, you need to enter the password.
- [**Unlock**] – all discs can be played.



Tips

- To set or change your password, go to [**Preference Setup**] > [**Password**].

[OSD Language]

Select the default on-screen menu language.

[Screen Saver]

Turn off or on the screen saver mode. It helps to protect the TV screen from being damaged due to over exposure to a static image for too long.

- [**On**] – set the screen saver to appear after 15 minutes of inactivity (for example, in pause or stop mode).
- [**Off**] – disable screen saver mode.

[Sleep Timer]

Switch to standby automatically after the preset time.

- [**Off**] – disable sleep mode.
- [**15, 30, 45, 60 mins**] – select the count down time before it switches to standby.

[DivX(R) VOD Code]





Display the DivX® registration code.

Tips

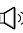
- Enter this unit's DivX registration code when you rent or purchase video from www.divx.com/vod. The DivX videos rented or purchased through the DivX® VOD (Video On Demand) service can be played only on the device to which it is registered.

Audio setup

- 1 Press **OPTIONS**.
↳ [**General Setup**] menu is displayed.
- 2 Press **▼** to select  [**Audio Setup**], then press **▶**.
- 3 Select an option, then press **OK**.

Audio Setup	
	HDMI Audio
	Audio Sync
	Night Mode
	CD Upsampling
	
	

- See the explanations of the above options in the following pages.
- 4 Select a setting, then press **OK**.
 - To return to the previous menu, press **BACK**.
 - To exit the menu, press **OPTIONS**.

[HDMI Audio]

When you connect this unit and TV with HDMI cable, select the audio output setting for this connection.

- **[On]** – the sound is output through both your TV and this speaker system. If the audio format on the disc is not supported, it will be downmixed to two-channel sound (linear-PCM).
- **[Off]** – disable audio output from your TV. The sound is only output through this speaker system.

[Audio Sync]

Set the default delay time for audio output when you play a video disc.

1. To start, press **OK**.
2. Press **◀ ▶** to set the delay time.
3. Press **OK** to confirm and exit.

[Night Mode]

Make loud sound level softer and soft sound level louder so that you can watch the DVD movies at a low volume, without disturbing others.



Note

- This setting is only applicable to Dolby Digital encoded DVD.

- **[On]** – for quiet viewing at night (DVDs only).
- **[Off]** – enjoy surround sound with a full dynamic range.

[CD Upsampling]

Convert the music CD to a higher sampling rate using sophisticated digital signal processing for better sound quality.

- **[Off]** – turn off CD-upsampling.
- **[On]** – convert the sampling rate of the CDs twice as high as the original rate.

Video setup

- 1 Press **OPTIONS**.
↳ **[General Setup]** menu is displayed.
- 2 Press **▼** to select **[Video Setup]**, then press **▶**.
- 3 Select an option, then press **OK**.

Video Setup	
	TV Type
	TV Display
	Picture Setting
	HDMI Setup
	Closed Caption
<input checked="" type="checkbox"/>	

- See the explanations of the above options in the following pages.
- 4 Select a setting, then press **OK**.
 - To return to the previous menu, press **BACK**.
 - To exit the menu, press **OPTIONS**.

[TV Type]

If the video does not appear correctly, change the setting. By default, this setting matches the most common setting for TVs in your country.

- [**PAL**] – for PAL-system TV.
- [**NTSC**] – for NTSC-system TV.
- [**Multi**] – for TV that is compatible with both PAL and NTSC.

[TV Display]

Select the screen format according to how you want the picture to appear on your TV.

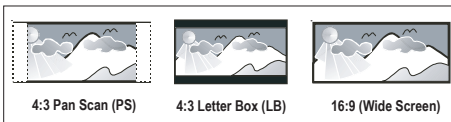

- [**4:3 Pan Scan**] – for standard TV, a full-height screen display with the sides trimmed.
- [**4:3 Letter Box**] – for standard TV, a 'wide-screen' display with black bars on the top and bottom.
- [**16:9 Wide Screen**] – for wide-screen TV (frame ratio 16:9).

[Picture Setting]

Select a predefined set of picture colour settings or customise your personal setting.

- [**Standard**] – original colour setting.
- [**Bright**] – vibrant colour setting.
- [**Soft**] – warm colour setting.
- [**Personal**] – customise the colour setting. Set the level of brightness, contrast, tint and colour saturation in the menu, then press **OK**.

[HDMI Setup]

When you connect this unit and TV with HDMI cable, select the best HDMI setup that your TV can support.

- [**Wide Screen Format**] – define the wide screen format for disc play.

Options	Descriptions
[Superwide]	Centre position of the screen is stretched less than the side. This setting is only applicable if the video resolution is set to 720p or 1080i/p.
[4:3 Pillar Box]	No stretching of the picture. Black bars are displayed on both sides of the screen.
[Off]	Picture will be displayed according to the format of the disc.

Note

- This setting is only available if you have set the [**TV Display**] setting to [**16:9 Wide Screen**].

- [**HDMI Video**] – select a video resolution that is compatible with your TV display capability.

Options	Descriptions
[Auto]	It detects and selects the best supported video resolution automatically.
[480p, 576p, 720p, 1080i, 1080p]	Select a video resolution that best supported by your TV. See your TVs manual for details.



Note

- If the setting is not compatible with your TV, a blank screen appears. Wait for 15 seconds for auto recover or switch to its default mode as follows:
1) Press **▲**. 2) Press **◀**. 3) Press **ZOOM**.

[Closed Caption]

Turn on or off display captions.

- **[On]** – show the sound effects in subtitle. Only applicable to disc with Closed Caption information included and your TV supports this feature.
- **[Off]** – disable closed caption.

Preference Setup

- 1 Press **OPTIONS**.
↳ [**General Setup**] menu is displayed.
- 2 Press **▼** to select [**Preference Setup**], then press **▶**.
- 3 Select an option, then press **OK**.

Preference Setup	
	Audio
	Subtitle
	Disc Menu
	Parental
	PBC
	MP3/JPEG Nav
	Password
	DivX Subtitle ▼

- See the explanations of the above options in the following pages.
- 4 Select a setting, then press **OK**.
 - To return to the previous menu, press **BACK**.
 - To exit the menu, press **OPTIONS**.

[Audio]

Select the default audio language for DVDs.

[Subtitle]

Select the default subtitle language for DVDs.

[Disc Menu]

Select the menu language for DVDs.



Note

- If the language you have set is not available on the disc, the disc uses its own default language.
- For some DVDs, the subtitle/audio language can only be changed from the disc menu.
- To select the languages that are not listed in the menu, select [**Others**]. Then check the Language Code list at the back of this user manual and enter the respective 4-digit language code.

[Parental]

Restrict access to DVDs that are unsuitable for your children. These types of DVDs must be recorded with ratings.

1. To start, press **OK**.
2. Select a rating level in the menu, then press **OK**.
3. Press the **number buttons** to enter your 4-digit password.



Note

- Rated DVDs above the level you set in [**Parental**] require a password to be played.
- The ratings are country-dependent. To allow all discs to play, select '8'.
- Some DVDs have ratings printed on them but are not recorded with ratings. This function has no effect on such DVDs.



Tips

- To set or change your password, go to [**Preference Setup**] > [**Password**].

[PBC]

For VCDs/SVCDs recorded with PBC (playback control), you can access the disc content through an interactive menu.

- [**On**] – an index menu is displayed when you load a disc for play.
- [**Off**] – skip the menu and start play from the first title.

[MP3/JPEG Nav]

Turn off or on MP3/WMA folder display when you play a media that contains MP3/WMA files.

- [**With Menu**] – display the folders of MP3/WMA files.
- [**Without Menu**] – display all the files.

[Password]

Follow the instructions on the TV to set or change the password for locked discs and play restricted DVDs.

Change Password	
Old Password	<input type="text"/>
New Password	<input type="text"/>
Confirm PWD	<input type="text"/>
	<input type="button" value="OK"/>

1. Press the **number buttons** to enter '0000' or your last set 4-digit password at [**Old Password**] field.
2. Enter the new password at [**New Password**] field.
3. Enter the new password again at [**Confirm PWD**] field.
4. Press **OK** to exit the menu.



Note

- If you forget your 4-digit password, enter '0000' before you set a new password.

[DivX Subtitle]

Select a character set that supports the DivX subtitle.

[Standard]	English, Irish, Danish, Estonian, Finnish, French, German, Italian, Portuguese, Luxembourgish, Norwegian (Bokmål and Nynorsk), Spanish, Swedish, Turkish
[Central Europe]	Polish, Czech, Slovak, Albanian, Hungarian, Slovene, Croatian, Serbian (Latin script), Romanian
[Cyrillic]	Belarusian, Bulgarian, Ukrainian, Macedonian, Russian, Serbian
[Greek]	Greek
[Hebrew]	Hebrew



Note

- Ensure that the subtitle file has the exact same file name as the movie file. If for example the filename of the movie is 'Movie.avi', then you will need to name the text file 'Movie.sub' or 'Movie.srt'.

[Version info]

Display the software version of this unit.



Tips

- This information is required when you want to find out if a newest software version is available at the Philips website that you may download and install on this unit.

[Default]

Reset all the settings of this unit to factory default, except for [**Disc Lock**], [**Password**] and [**Parental**] settings.



8 Additional information

Update software

Philips provides software updates to ensure that this unit is compatible with the newest formats.

To check for updates, compare the current software version of this unit with the latest software version available at the Philips website.

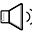
- 1 Press **OPTIONS**.

Preference Setup	
	Disc Menu ▲
	Parental
	PBC
	MP3/JPEG Nav
	Password
	DivX Subtitle
	Version Info
	Default

- 2 Select [**Preference Setup**] > [**Version Info**], then press **OK**.
- 3 Write down the version number, then press **OPTIONS** to exit the menu.
- 4 Go to www.philips.com/support to check the latest software version available for this unit.
- 5 If the latest software version is higher than the software version of this unit, download it and store onto a CD-R or USB flash drive.

- 6 Insert the CD-R or USB flash drive to this Compact Theatre System.
- 7 Press **DISC** or **USB**, then follow the instruction on the TV to confirm update operation.

Note

- Do not remove the CD-R or USB when software updating is in progress.

- 8 Once software update is complete, this unit turns off to standby automatically.

Note

- We recommend that you disconnect the power cord for a few seconds and connect again to reboot the system.

Care

Caution!

- Never use solvents such as benzene, thinner, cleaners available commercially, or anti-static sprays intended for discs.

Clean discs

Wipe the disc with a micro fibre cleaning cloth from the centre to the edge in a straight line movement.

Clean main unit screen

Wipe the screen surface with a micro fibre cleaning cloth.

Specifications



Note

- Specification and design are subject to change without notice.

Accessories supplied

- Quick Start Guide
- Remote control and batteries
- SCART converter cable
- Composite video cable (yellow)
- HDMI cable
- 3.5mm stereo audio cable (for MP3 LINK)
- Power adaptor
- Power cable
- Micro fibre cleaning cloth

Amplifier

- Total output power (Compact Theatre): 50W
- Frequency response: 180 Hz~18 kHz / ± 3 dB
- Signal-to-noise ratio: > 60 dB (A-weighted)
- Input sensitivity
 - AUX: 500 mV
 - MP3 LINK: 500 mV

Disc

- Laser Type: Semiconductor
- Disc diameter: 12cm / 8cm
- Video decoding: MPEG1 / MPEG2 / DivX / DivX Ultra
- Video DAC: 12 bits, 108 MHz
- Signal system: PAL / NTSC
- Video S/N: 56 dB
- Audio DAC: 24 bits / 96 kHz
- Frequency response:
 - 4 Hz - 20 kHz (44.1 kHz)
 - 4 Hz - 22 kHz (48 kHz)
 - 4 Hz - 44 kHz (96 kHz)
- PCM: IEC 60958
- Dolby Digital, DTS: IEC60958, IEC61937

USB

- Compatibility: Hi-Speed USB (2.0)
- Class support: UMS (USB Mass Storage Class)

Main Unit

- Power supply: 100-240V; 50-60 Hz
- Power consumption: 22 W
- Standby power consumption: < 1 W
- System: Bass Reflex System
- Impedance: 8 ohm
- Speaker drivers: 165 mm (6 1/2") woofer
- Frequency response: 55 Hz - 150 Hz
- Dimensions (WxHxD): 273 x 172 x 273 (mm)
- Weight: 2.6 kg

9 Troubleshooting

Warning!

- Risk of electric shock. Never remove the casing of this unit.

To keep the warranty valid, never try to repair the system yourself.

If you encounter problems when using this unit, check the following points before requesting service. If the problem remains unsolved, register your product and get support at www.philips.com/welcome.

Main unit

The buttons on this unit do not work.

- Disconnect this unit from the power outlet for a few minutes, then connect again.

Picture

No picture.

- See TV's manual for correct video input channel selection. Change the TV channel until you see the DVD screen.
- Press **DISC**.
- If this happens when you change the TV type setting, you have to switch to its default mode:
 1. Press **▲**.
 2. Press **◀**.
 3. Press **SUBTITLE**.

No picture on HDMI connection.

- Check if the HDMI cable is faulty. Replace a new HDMI cable.
- If this happens when you change the HDMI video resolution, you have to switch to its default mode:
 1. Press **▲**.
 2. Press **◀**.
 3. Press **ZOOM**.

Sound

- | | |
|-------------------------------------|---|
| No sound. | <ul style="list-style-type: none">• Ensure that the audio cables are connected and press the correct input source (for example, AUX/MP3 LINK, USB) to select the device you want to play. |
| No sound on HDMI connection. | <ul style="list-style-type: none">• You may not hear any sound from the HDMI output if the connected device is non-HDCP compliant or only DVI-compatible.• Ensure that the [HDMI Audio] setting is turned on. |
| No sound from TV programme. | <ul style="list-style-type: none">• Connect an audio cable from the AUDIO input on this unit to the AUDIO output on your TV. Then press AUX/MP3 LINK repeatedly to select the corresponding audio input source. |

Play

- | | |
|---|---|
| DivX video files cannot be played. | <ul style="list-style-type: none">• Ensure that the DivX file is encoded according to the 'Home Theatre Profile' with the DivX encoder.• Ensure that the DivX video file is complete. |
| The aspect ratio of the screen is not aligned with the TV display setting. | <ul style="list-style-type: none">• The aspect ratio is fixed on the DVD. |
| DivX subtitle are not displayed correctly. | <ul style="list-style-type: none">• Ensure that the subtitle file name is the same as the movie file name.• Select the correct character set.<ol style="list-style-type: none">1. Press OPTIONS.2. Press ▶, then select [DivX Subtitle] in the menu.3. Select the character set that supports the subtitle. |
| The contents of the USB flash drive cannot be read. | <ul style="list-style-type: none">• The USB flash drive format is not compatible with this unit.• Drive is formatted with different file system which is not supported by this unit (e.g. NTFS).• Maximum size of memory supported is 160GB. |

10 Glossary

Aspect ratio

Aspect ratio refers to the length to height ratio of TV screens. The ratio of a standard TV is 4:3, while the ratio of a high-definition or wide TV is 16:9. The letter box allows you to enjoy a picture with a wider perspective on a standard 4:3 screen.

DivX

The DivX code is a patent-pending, MPEG-4 based video compression technology, developed by DivX Networks, Inc., that can shrink digital video to sizes small enough to be transported over the internet, while maintaining high visual quality.

Dolby Digital

A surround sound system developed by Dolby Laboratories containing up to six channels of digital audio.

HDMI

High-Definition Multimedia Interface (HDMI) is a high-speed digital interface that can transmit uncompressed high definition video and digital multichannel audio. It delivers high quality picture and sound quality, completely free from noise. HDMI is fully backward-compatible with DVI.

As required by the HDMI standard, connecting to HDMI or DVI products without HDCP (High-bandwidth Digital Content Protection) will result in no Video or Audio output.

HDCP

High-bandwidth Digital Content Protection is a specification that provides a secure transmission of digital contents between different devices (to prevent unauthorised copyright).

JPEG

A very common digital still picture format. A still-picture data compression system proposed by the Joint Photographic Expert Group, which features small decrease in image quality in spite of its high compression ratio. Files are recognised by their file extension 'JPG or JPEG'.

MP3

A file format with a sound data compression system. 'MP3' is the abbreviation of Motion Picture Experts Group 1 (or MPEG-1) Audio Layer3. By using the MP3 format, one CD-R or CD-RW can contain about 10 times more data than a regular CD. Files are recognised by their file extension '.MP3'.

MPEG

Motion Picture Experts Group. A collection of compression systems for digital audio and video.

PBC

Playback Control. A system of navigating a Video CD/Super VCD through on-screen menus recorded onto the disc. You can enjoy interactive playback and searching.

PCM

Pulse Code Modulation. A digital audio encoding system.

WMA

Windows Media™ Audio. Refers to an audio compression technology developed by Microsoft Corporation. WMA data can be encoded by using Windows Media Player version 9 or Windows Media Player for Windows XP. Files are recognised by their file extension 'WMA'.

Language Code

Abkhazian	6566
Afar	6565
Afrikaans	6570
Amharic	6577
Arabic	6582
Armenian	7289
Assamese	6583
Avestan	6569
Aymara	6589
Azerbaijani	6590
Bahasa Melayu	7783
Bashkir	6665
Belarusian	6669
Bengali	6678
Bihari	6672
Bislama	6673
Bokmål, Norwegian	7866
Bosanski	6683
Brezhoneg	6682
Bulgarian	6671
Burmese	7789
Castellano, Español	6983
Catalán	6765
Chamorro	6772
Chechen	6769
Chewa; Chichewa; Nyanja	7889
中文	9072
Chuang; Zhuang	9065
Church Slavic; Slavonic	6785
Chuvash	6786
Corsican	6779
Česky	6783
Dansk	6865
Deutsch	6869
Dzongkha	6890
English	6978
Esperanto	6979
Estonian	6984
Euskara	6985
Ελληνικά	6976
Faroese	7079
Français	7082
Frysk	7089
Fijian	7074
Gaelic; Scottish Gaelic	7168
Gallegan	7176
Georgian	7565
Gikuyu; Kikuyu	7573
Guarani	7178
Gujarati	7185
Hausa	7265
Herero	7290
Hindi	7273
Hiri Motu	7279
Hrvatski	6779
Ido	7379
Interlingua (International)	7365
Interlingue	7365
Inuktitut	7385

Inupiaq	7375
Irish	7165
Íslenska	7383
Italiano	7384
Ivrit	7269
Japanese	7465
Javanese	7486
Kalaallisut	7576
Kannada	7578
Kashmiri	7583
Kazakh	7575
Kernewek	7587
Khmer	7577
Kinyarwanda	8287
Kirghiz	7589
Komi	7586
Korean	7579
Kuanyama; Kwanyama	7574
Kurdish	7585
Lao	7679
Latina	7665
Latvian	7686
Letzeburgesch;	7666
Limburgan; Limburger	7673
Lingala	7678
Lithuanian	7684
Luxembourgish;	7666
Macedonian	7775
Malagasy	7771
Magyar	7285
Malayalam	7776
Maltese	7784
Manx	7186
Maori	7773
Marathi	7782
Marshallese	7772
Moldavian	7779
Mongolian	7778
Nauru	7865
Navaho; Navajo	7886
Ndebele, North	7868
Ndebele, South	7882
Ndonga	7871
Nederlands	7876
Nepali	7869
Norsk	7879
Northern Sami	8369
North Ndebele	7868
Norwegian Nynorsk;	7878
Occitan; Provençal	7967
Old Bulgarian; Old Slavonic	6785
Oriya	7982
Oromo	7977
Ossetian; Ossetic	7983
Pali	8073
Panjabi	8065
Persian	7065
Polski	8076
Português	8084

Pusho	8083
Russian	8285
Quechua	8185
Raeto-Romance	8277
Romanian	8279
Rundi	8278
Samoan	8377
Sango	8371
Sanskrit	8365
Sardinian	8367
Serbian	8382
Shona	8378
Shqip	8381
Sindhi	8368
Sinhalese	8373
Slovensky	8373
Slovenian	8376
Somali	8379
Sotho; Southern	8384
South Ndebele	7882
Sundanese	8385
Suomi	7073
Swahili	8387
Swati	8383
Svenska	8386
Tagalog	8465
Tahitian	8489
Tajik	8471
Tamil	8465
Tatar	8484
Telugu	8469
Thai	8472
Tibetan	6679
Tigrinya	8473
Tonga (Tonga Islands)	8479
Tsonga	8483
Tswana	8478
Türkçe	8482
Turkmen	8475
Twi	8487
Uighur	8571
Ukrainian	8575
Urdu	8582
Uzbek	8590
Vietnamese	8673
Volapuk	8679
Walloon	8765
Welsh	6789
Wolof	8779
Xhosa	8872
Yiddish	8973
Yoruba	8979
Zulu	9085

