

Wireless Music Center + Station
WACS700

Read Me First!

Quick start guide

A

Connect/Setup

B

Enjoy

C

FAQ



PHILIPS

GB

What's in the box



Wireless music center WAC 700



Wireless music station WAS 700



Center's remote control
4xAAA batteries



Station's remote control
1xCR2025 batteries



Quick start guide



User manual



Connect to your PC



PC installer



2 x FM wire antenna



1 x Ethernet cable

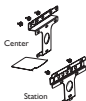

2 x Mounting kit
for center & station

Before using the remote control:

- Remove the protective plastic tab from the Station's remote control
- Insert 4 AAA batteries into Center's remote control as shown

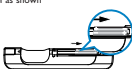

Center's remote control



Station's remote control

A

Connect/Setup

Set up Wi-Fi connection between Center and Station

1

The first time you set up the Wi-Fi connection, place WAC700 **Center** and WAS700 **Station** side by side on a flat and firm surface.

2

Connect WACS700 to power supply, **first** the Center and **then** the Station

- Center/Station:
- The screen lights up
 - Auto installation/connection starts
 - When the installation/connection is completed, both Center & Station will enter **HD**(Harddisk) mode (see screen illustration at the right)

(Make sure you have powered up the Center before powering up Station)



Center

AC

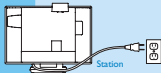

Station

AC



HD mode (Harddisk)

3

Finally, to relocate Center and Station as you desire:

- Simply unplug your Center or Station and power them up in different rooms
- You will be able to playback music stored in the **HD** to both the Center and the Station

IMPORTANT!

- Avoid thick walls. Separating your Center and Station by 2 or more walls may cause poor streaming connection.
- Keep your Center and Station away from the source of interference, for example: plasma TVs, microwave ovens, DECT phones, bluetooth devices, cordless phones, other Wi-Fi products.
- For best streaming connection, adjust the location of your Center and Station according to the reception status of Wi-Fi signals

📶 : indicates maximum reception; 📶 : indicates minimum reception

- For wall mounting, please refer to the **User Manual, Appendix: How to mount your Center and Station onto walls.** You may need assistance from the qualified service personnel.

B

Enjoy

Play Harddisk (HD)

On the WAC700 Music Center's 40GB* hard disk, you can store up to 750 audio CDs centrally.

Philips has preloaded 6 demo tracks in the Playlist 00000WA and 6 music tracks in the Playlist_001 - Playlist_004.

1

Press **STANDBY ON** to switch on the **Center** or **Station**



2

Press **SOURCE** once or more to select **HD** source (or press **HARDDISK** or **Center** on the remote control)



3

Press the navigation controls **▲▼◀▶** to select playback options: e.g. by "Playlist" **▶**, "Playlis_001" **▼**, **OK**



4

Press **OK** (or **▶**) to start playback

5

To change your playback options,

- press **◀** to enter the previous option lists
- Use the navigation controls **▲▼◀▶** to select
- Press **OK** or **▶** to confirm

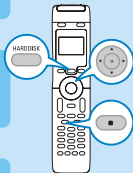

6

To stop playback, press **STOP / ■**

* Available storage space for music is around 33GB, due to capacity reserved for system purpose

Stream between Center and Station

Up to 5 WAS700 Stations can be connected to WAC700 Center at the same time. Music can be streamed from the Center to all the Stations via its WiFi link. Your family will be able to enjoy and share music with ease from different parts of your house.

MUSIC FOLLOWS ME

As you move around at home, your music can move together with you, either from **Center** to **Station** or from **Station** to **Center**.

1

On the **first** unit (**Center** or **Station**), while music is playing from the HD (Harddisk)

Press **MUSIC FOLLOWS ME** to activate function

- The  icon appears



2

Move to the **second** unit (**Center** or **Station**), you will find the icon  on display (limited for 5 minutes)

If the second unit is on standby, press **STANDBY ON** to turn it on and select **SOURCE** to HD mode

Press **MUSIC FOLLOWS ME** to take up the music

- Music playback from the first unit will now stop and continue on the second unit.
- The  icon disappears

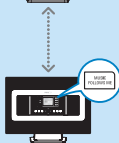

3

To stop **MUSIC FOLLOWS ME**, press **STOP** on the second unit

IMPORTANT!

- Check you have selected HD for Center and Station.
- You must press **MUSIC FOLLOWS ME** on the first unit before pressing **MUSIC FOLLOWS ME** on the second unit.

MUSIC BROADCAST

MUSIC BROADCAST allows you to broadcast music from **Center** to all connected **Station(s)**.

1

On Center

While music is playing from the HD (Harddisk) in the Music Center, press **MUSIC BROADCAST** to activate.

- The  icon appears on the Center. The Station will now synchronize with the Center.



2

On Center and Station

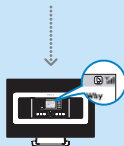

- The selected music will be played at both the center and the station after 15-20 seconds



3

To stop **MUSIC BROADCAST**, press **STOP** on **Center**.

Tips:

- Check you have selected HD for Center and Station.
- For a station to exit **MUSIC BROADCAST**, press **STOP** /  on Station.
- To broadcast again
Before you press **MUSIC BROADCAST**, please check if an earlier broadcasting is still active.
If the icon  is displayed, press **STOP** on Center.
- During broadcasting, there may be slight playback delay between the Center and the Station.

B

Build music library on Center

You can store up to 750 audio CDs on **Center's** 40GB harddisk by ripping CDs and converting into MP3 files.

Ripping CDs

1

Insert a CD into the **Center's** CD loader, with the printed graphics facing you

- **Reading CD** appears
- **Audio CD**: List of tracks appears
- **For CD recorded with MP3/WMA music files**: List of file folders appears. To enter a track list, press **▶** on a highlighted file folder



2

While the list of music tracks is on display, press **RECORD**.

- List of tracks and checkboxes ☐ appears for all tracks.



3

Use the navigation controls **▲** or **▼** and **▶** to highlight particular tracks, press **MARK • UNMARK** to select or deselect the tracks for recording

- Press and hold **MARK • UNMARK** to select/deselect all displayed tracks at once.



4

Your center is pre-set to CD ripping at 4 time speed and best quality. In case there is difficulty to read a particular CD, please try a lower recording speed. You can also select to use a lower quality in case of voice only content (see the **User Manual, HD: Building music library on Center** for details)

5

To start recording, press **RECORD** or **OK**

- **CD-Rec** appears. Display shows the track and album name of the track being recorded.



6

To stop recording, press **STOP**

IMPORTANT!

- It takes some time to convert the ripped tracks into MP3 files. If power failure occurs during the conversion, you will lose all the tracks not converted yet.

To find your ripped tracks

After MP3 conversion is completed, you can find and playback the ripped tracks from the HD under **Albums**.

1

Press **SOURCE** to select **HD** mode

2

In **Albums**, use the navigation controls ▲ ▼ ◀ ▶ to find the album of recorded tracks

Recording from Radio or External source

A maximum of 3-hour recording can be made from the radio or external source. See **User manual, HD: Build music library on Center**

Importing from your PC

See the manual **Connect to your PC**

Play CDs (on Center only)

You can playback the following

- All audio CDs
- All CDs containing WMA, MP3 files

Note: CDR, CDRW discs must be finalized first.

Discs with "Digital Rights Management" cannot be played.

1

Insert a CD into the **Center's** CD loader, with the the printed graphics side facing you

2

Use the navigation controls ▲▼◀▶ to select a track or a folder

3

To start playback, press **OK** (▶)

4

To stop playback, press **STOP**

5

To remove the CD, press **EJECT**

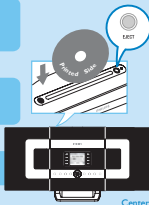

Listen to FM Radio

1

Connect the supplied FM wire antenna to your Center and Station (see **User manual, Installation**)

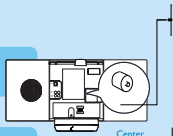

2

Press **SOURCE** until the Center or Station enters **Radio** mode. (on the remote control, press **TUNER/AUX** once or more)

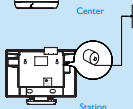

3

To pre-store available radio stations:

- press **MENU**
 - Use the navigation controls **▲** or **▼** and **▶** to select and activate **Autostore radio** function.
- Display shows: **Autostore Please wait...** When autostore is completed, the first autostore preset station will then automatically play



4

- Press **◀** to enter the list of presets
- Use the navigation controls **▲** or **▼** and **▶** to select your desired station

To find out more about product features and how to activate them please read the supplied manual:

- User manual:** for further details and also troubleshooting
- Connect to your PC:** to connect to your PC, set up networks, transfer and manage your music collection using the **Philips Digital Media Manager** (supplied)



2006 © Koninklijke Philips Electronics N.V.
All rights reserved.
3141 075 21261
www.philips.com



connectedplanet



Be responsible
Respect copyrights



FAQ

Most Frequently Asked Questions

About the Environment

Q: Is there a maximum distance of transmission between the Music Center and the Music Stations for effective streaming?

A: Yes. The maximum distance of Wi-Fi transmission for the system is 250m measured in open space. However in a home environment there are inevitable solid obstacles such as walls and doors, which may reduce the effective transmission distance significantly to approximately 50-100m. Try re-position the sets if you experience transmission problems.

Q: Do I need a computer and home network to use the WACS700?

A: No. Your WACS700 is designed to work independently of the computer. You can convert your CDs into MP3s on the Music Center, and stream the music to your Music Stations without any computer or home networking structure.

Q: Would my neighbours be able to access the music stored on my Music Center if they also have the Philips Music Station?

A: No. Every Music Station has a unique encryption code that has to be recognized by the Music Center during the installation process.

About Ripping/Track Information

Q: What does it mean by "ripping" and what functions can I use while ripping is in progress?

A: Ripping is the process by which a CD track is converted into compressed MP3 format which is then stored on the Music Center's internal hard disk for playback and music streaming. In the Music Center "ripping" takes two steps: first, it reads the CD content and store it temporarily on the hard disk; second, it converts this temporary CD content into the MP3 format - a process called "background encoding". Switch Center to ECO POWER (power-saving mode) before removing its power plug from the wall outlet.

Q: Do I need to immediately update the CDDB database stored in the Music Center straight after bringing it home?

A: No. There is already a massive CD-tracks database pre-stored in the Music Center, which should match most of the CDs released within the last six months.

Q: Does Philips provide CDDB database updates?

A: Yes. We provide quarterly updates of the CDDB database through our website at <http://www.philips.com/support>. Simply download the file, burn it on a CD-ROM and follow the step by step procedure to complete the update.

About Music Management

Q: What is Philips Digital Media Manager (DMM)?

A: The main function of the Philips Digital Media Manager is to collect MP3 tracks you have on your PC and transfer them to the Music Center. In addition it provides a one-stop solution to help you manage and organize your MP3 digital music contents such as create playlists, rename tracks and playlist contents as well as CDDB update.

Q: How do I transfer the MP3 songs that I already have on my PC to my new Music Center?

A: Once you have installed the Philips Digital Media Manager (DMM) and connected your PC to the Music Center with the supplied Ethernet cable, you can use this software to locate all the MP3 tracks on your PC and then just drag and drop them into the "device window" of DMM. Transfer of track will start automatically and the average time it takes to transfer one track is 4-6 seconds. Refer to the manual **Connect to your PC**

Q: Is the Music Center upgradeable?

A: Yes, both the Music Center and the Music Station are software upgradeable which means they are prepared for future function upgrades should they become available. Check our website regularly for latest news on new features and improvements at <http://www.philips.com/support>

Need help?

www.philips.com/support
or
call our helpdesk

| Country | Helpdesk | Tariff / min | Keep ready |
|-------------|--|--------------|--|
| österreich | 0820 901115 | €0,20 | Das Kaufdatum, Modellnummer und Seriennummer |
| Belgique | 070 253 010 | €0,17 | La date d'achat la référence et le numéro de série du produit |
| Canada | 1-800-661-6162 (Francophone) 1-888-744-5477 (English / Spanish) | Free | Date of Purchase, Model number and Serial number |
| Danmark | 3525 8761 | Local tariff | Forbrugeren's indkøbsdato, type/model-og serienummer |
| Suomi | 09 2290 1908 | Local tariff | Ostopaivä ja tarkka mallinnumero ja sarjanumero |
| France | 08 9165 0006 | €0,23 | La date d'achat la référence et le numéro de série du produit |
| Deutschland | 0180 5 007 532 | €0,20 | Das Kaufdatum, Modellnummer und Seriennummer |
| Ελλάδα | 0 0800 3122 1223 | Free | Την ημερομηνία αγοράς και τον ακριβή κωδικό μοντέλου και τον αριθμό σειράς του προϊόντος σας |
| Ireland | 01 601 1161 | Local tariff | Date of Purchase, Model number and Serial number |
| Italia | 199 404 042 | €0,21 | La data di acquisto, numero di modello e numero di serie |
| Luxembourg | 26 84 30 00 | Local tariff | La date d'achat, la référence et le numéro de série du produit |
| Nederland | 0900 0400 063 | €0,20 | De datum van aankoop, modelnummer en serienummer |
| Norge | 2270 8250 | Local tariff | Datoen da du kjøpte produktet & modellnummer & serienummeret |
| Portugal | 2 1359 1440 | Local tariff | A data de compra, número do modelo e número de série |
| España | 902 888 785 | €0,15 | Fecha de compra e número del modelo e número de serie |
| Sweden | 08 632 0016 | Local tariff | Inköpsdatum, modellnummer och serienummer |
| Schweiz | 02 2310 2116 | | Das Kaufdatum und Modellnummer und Seriennummer |
| UK | 0906 1010 017 | £0,15 | Date of Purchase, Model number and Serial number |
| USA | 1-888-744-5477 | Free | Date of Purchase, Model number and Serial number |