

Always there to help you

Register your product and get support at
www.philips.com/support

AZ100B
AZ100C
AZ100W



Quick Start Guide

快速入門指南

PHILIPS



Specifications are subject to change without notice.
This product has been manufactured by, and is sold under the responsibility of Gibson Innovations Ltd., and Gibson Innovations Ltd. is the warrantor in relation to this product.
Philips and the Philips Shield Emblem are registered trademarks of Koninklijke Philips N.V. and are used under license.

AZ100_96_QSG_V4.0

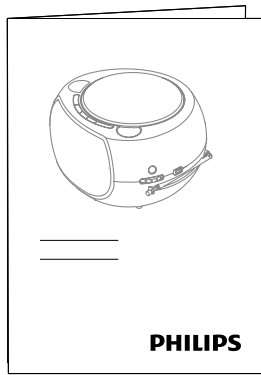
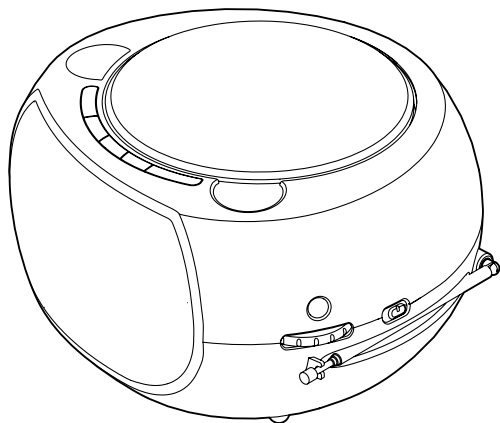

Before using your product, read all accompanying safety information.
To get the detailed instructions for use, visit www.philips.com/support.
在使用產品之前，請先閱讀所有隨附的安全資訊。
詳盡的使用說明請登錄www.philips.com/support。

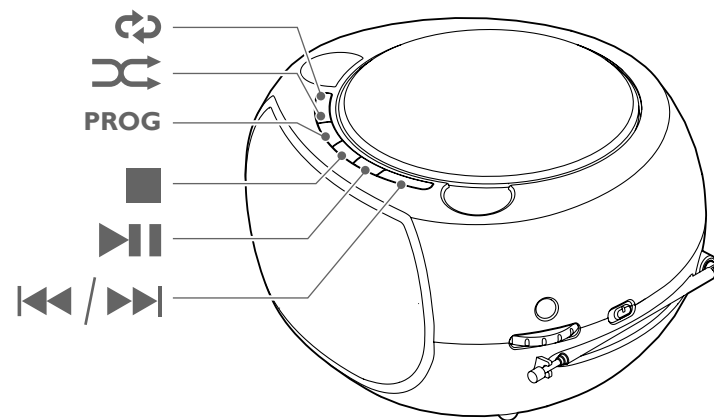
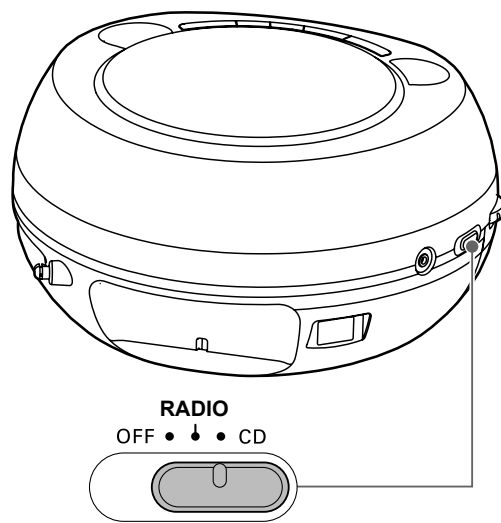
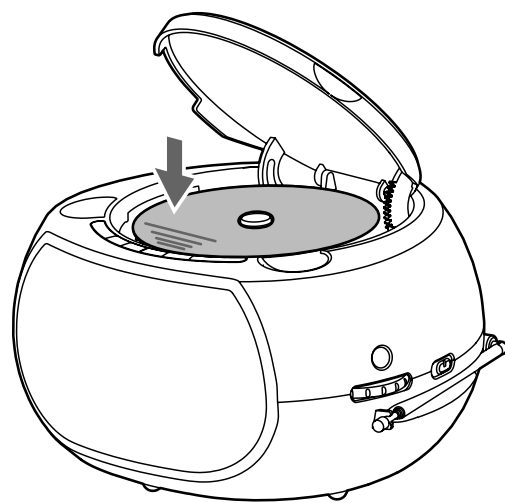
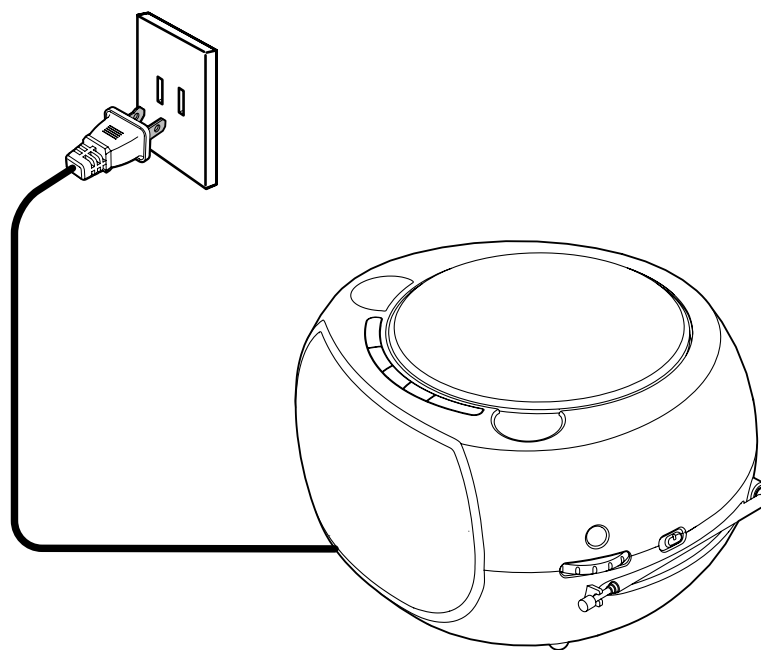
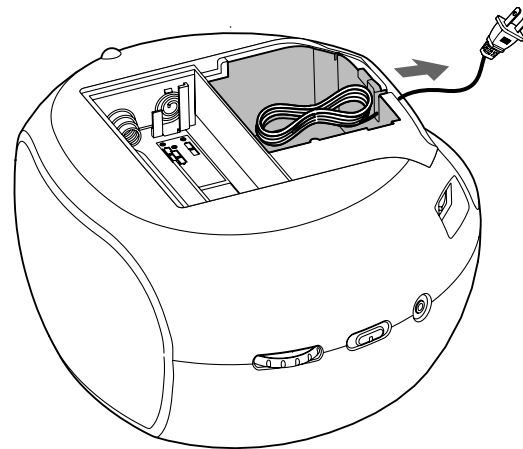
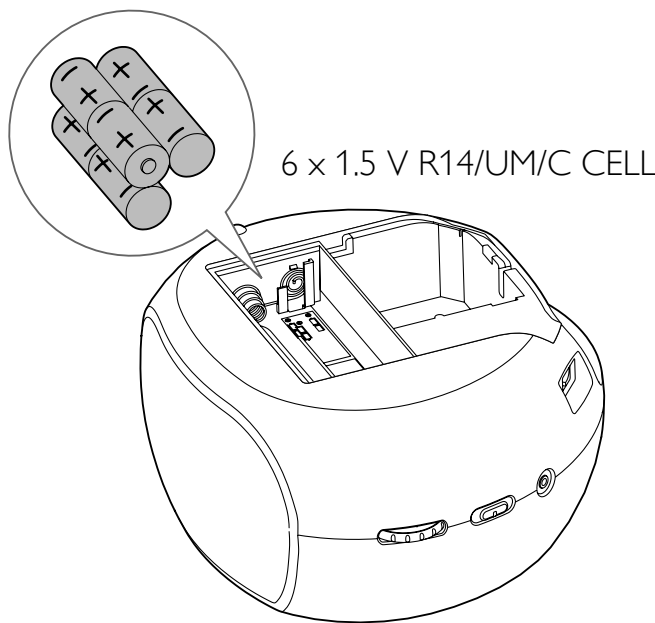
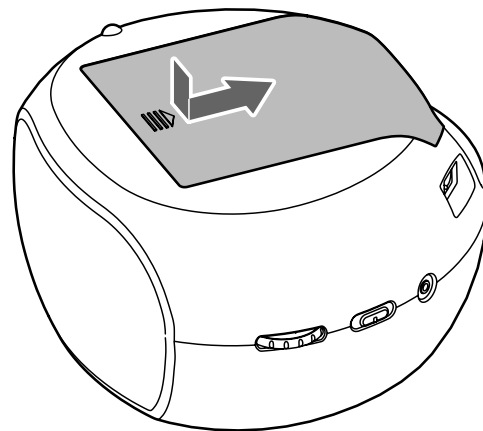

PROG

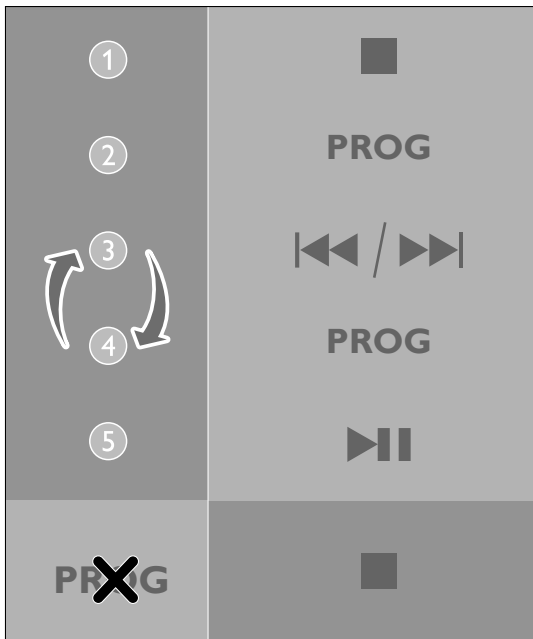
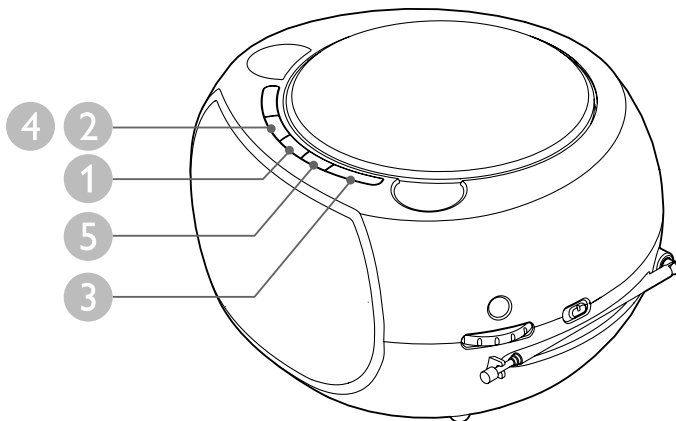

	EN	Repeat a track or all tracks
	ZH-TW	重複播放單一或所有曲目
	EN	Play tracks randomly
	ZH-TW	隨機播放曲目
PROG	EN	Program tracks
	ZH-TW	編排曲目
	EN	Stop play or erase a program
	ZH-TW	停止播放或清除編排
	EN	Pause or start play
	ZH-TW	開始或暫停播放
	EN	Skip to a track or search within play
	ZH-TW	跳至曲目或在播放內進行搜尋

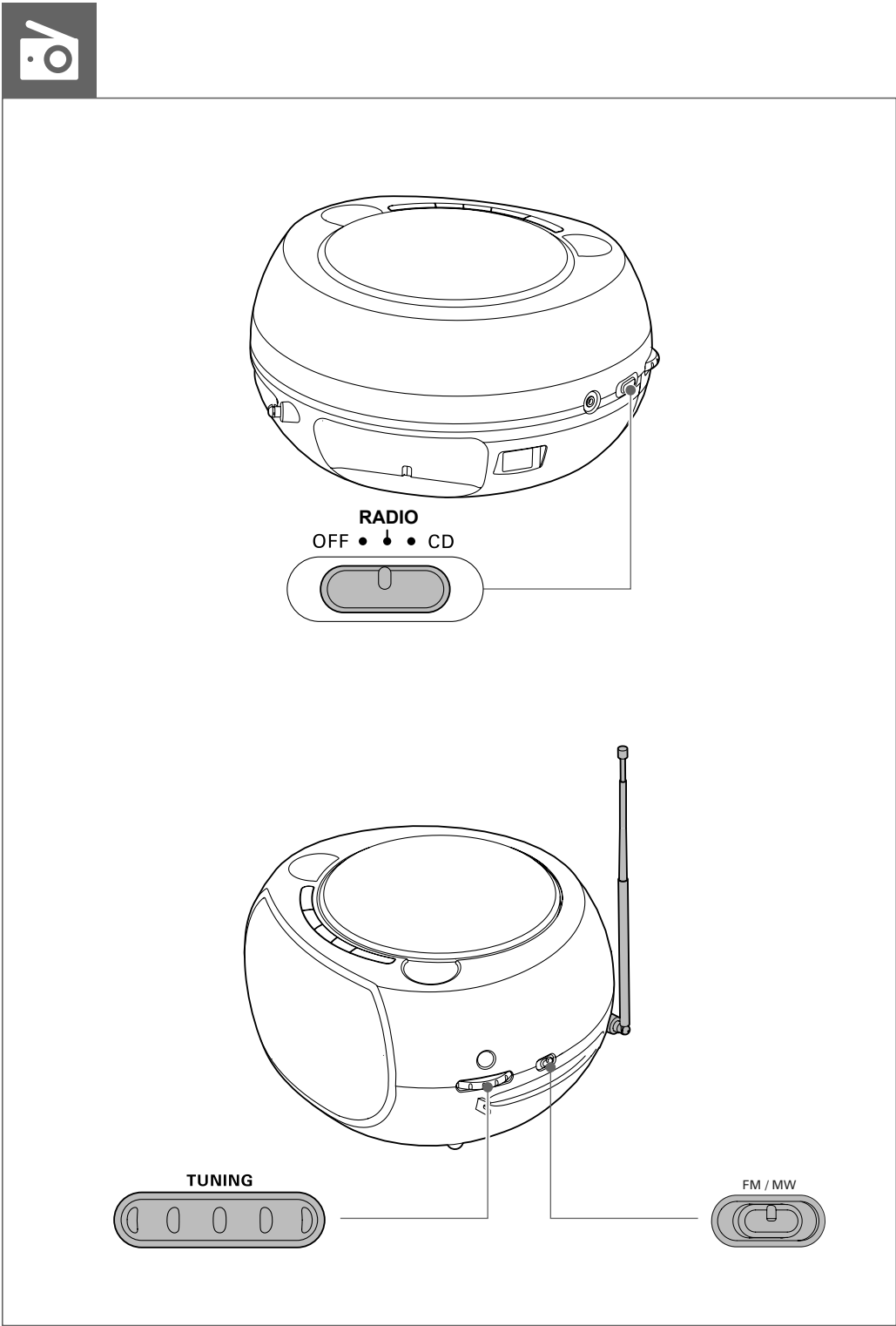

EN

1 Important



- This 'bolt of lightning' indicates uninsulated material within the device may cause an electrical shock. For the safety of everyone in your household, please do not remove the covering. The 'exclamation mark' calls attention to features for which you should read the enclosed literature closely to prevent operating and maintenance problems.
- WARNING:** To reduce the risk of fire or electric shock, the device should not be exposed to rain or moisture and objects filled with liquids, such as vases, should not be placed on the device.
- CAUTION:** To prevent electric shock, fully insert the plug. (For regions with polarized plugs: To prevent electric shock, match wide blade to wide slot.)
- Read these instructions.
 - Follow all instructions.
 - Do not block any ventilation openings. Install in accordance with the manufacturer's instructions. Do not install near any heat sources such as radiators, heat registers, stoves, or other apparatus (including amplifiers) that produce heat.
 - Protect the power cord from being walked on or pinched, particularly at plugs, convenience receptacles, and the point where they exit from the device
 - Only use attachments/accessories specified by the manufacturer.
 - Unplug this device during lightning storms or when unused for long periods of time.
 - Refer all servicing to qualified service personnel. Servicing is required when the device has been damaged in any way, such as power-supply cord or plug is damaged, liquid has been spilled or objects have fallen into the device, the device has been exposed to rain or moisture, does not operate normally, or has been dropped.
 - Battery usage **CAUTION** – To prevent battery leakage which may result in bodily injury, property damage, or damage to the device:
 - Install all batteries correctly, + and - as marked on the device.
 - Do not mix batteries (old and new or carbon and alkaline, etc.).
 - The batteries shall not be exposed to excessive heat such as sunshine, fire or the like.
 - Remove batteries when the device is not used for a long time.
 - The device shall not be exposed to dripping or splashing.
 - Do not place any sources of danger on the device (e.g. liquid filled objects, lighted candles).
 - Where the MAINS plug or an appliance coupler is used as the disconnect device, the disconnect device shall remain readily operable.

Warning

- Never remove the casing of this device.
- Never lubricate any part of this device.
- Never place this device on other electrical equipment.
- Keep this device away from direct sunlight, naked flames or heat.
- Never look into the laser beam inside this device.
- Ensure that you always have easy access to the power cord, plug, or adaptor to disconnect this device from the power.

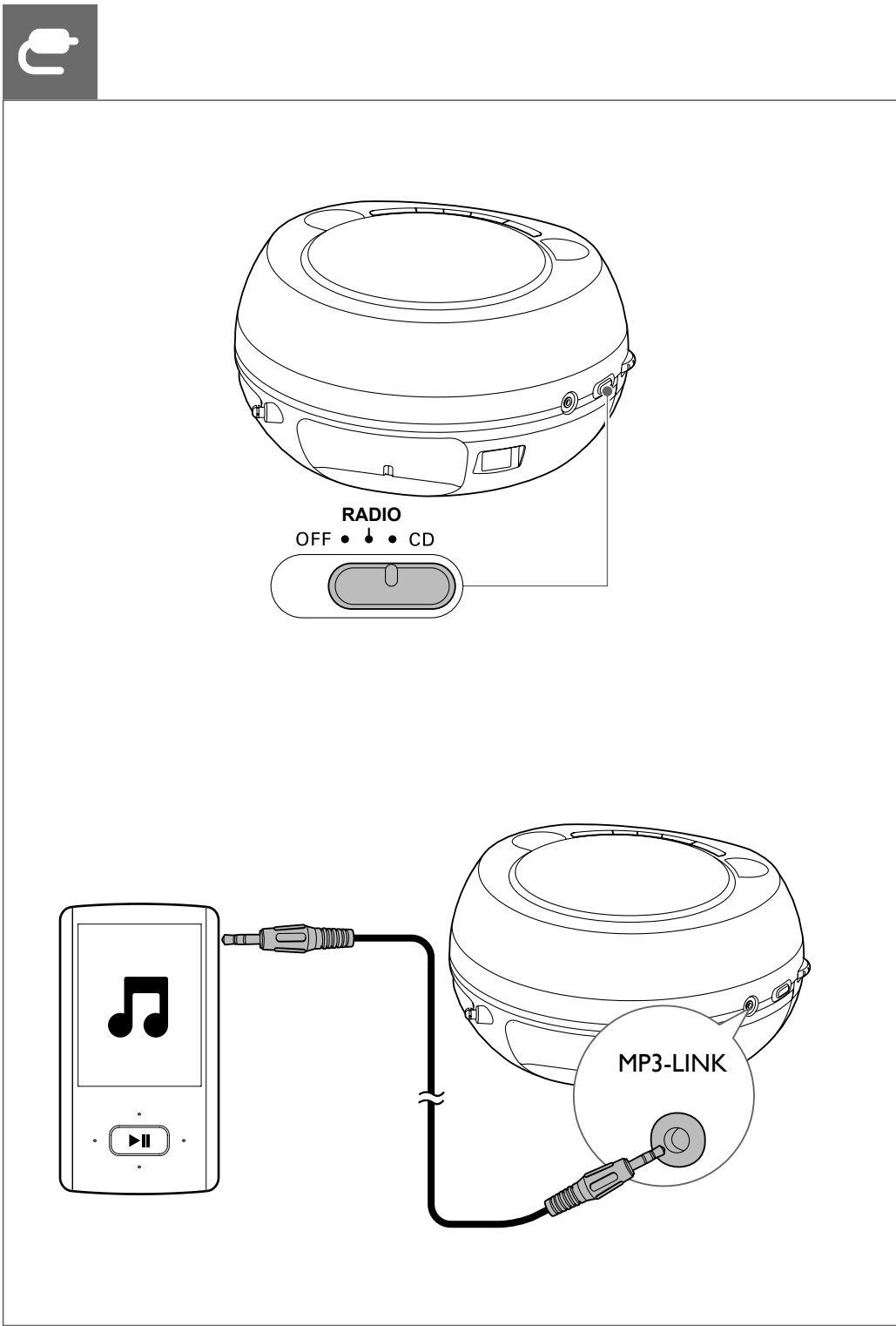

Caution

- Use of controls or adjustments or performance of procedures other than herein may result in hazardous laser exposure or other unsafe operation.

2 Notice

Any changes or modifications made to this device that are not expressly approved by Gibson Innovations may void the user's authority to operate the equipment. Your product is designed and manufactured with high quality materials and components, which can be recycled and reused. Never dispose of your product with other household waste. Please inform yourself about the local rules on the separate collection of electrical and electronic products and batteries. The correct disposal of these products helps prevent potentially negative consequences on the environment and human health. Your product contains batteries, which cannot be disposed of with normal household waste. Please inform yourself about the local rules on separate collection of batteries. The correct disposal of batteries helps prevent potentially negative consequences on the environment and human health. Please visit www.recycle.philips.com for additional information on a recycling center in your area.

Environmental information

All unnecessary packaging has been omitted. We have tried to make the packaging easy to separate into three materials: cardboard (box), polystyrene foam (buffer) and polyethylene (bags, protective foam sheet). Your system consists of materials which can be recycled and reused if disassembled by a specialized company. Please observe the local regulations regarding the disposal of packaging materials, exhausted batteries and old equipment.

This apparatus includes this label:



Note

- The type plate is located on the bottom of the apparatus.

General information

AC power	110V ~, 60 Hz
Operation Power Consumption	8 W
Batteries	9V, 6 x 1.5 V R14/UM2/C CELL
Dimensions	
- Main Unit (W x H x D)	245 x 212 x 131 mm
Weight	
- With Packing	1.5 kg
- Main Unit	1.1 kg

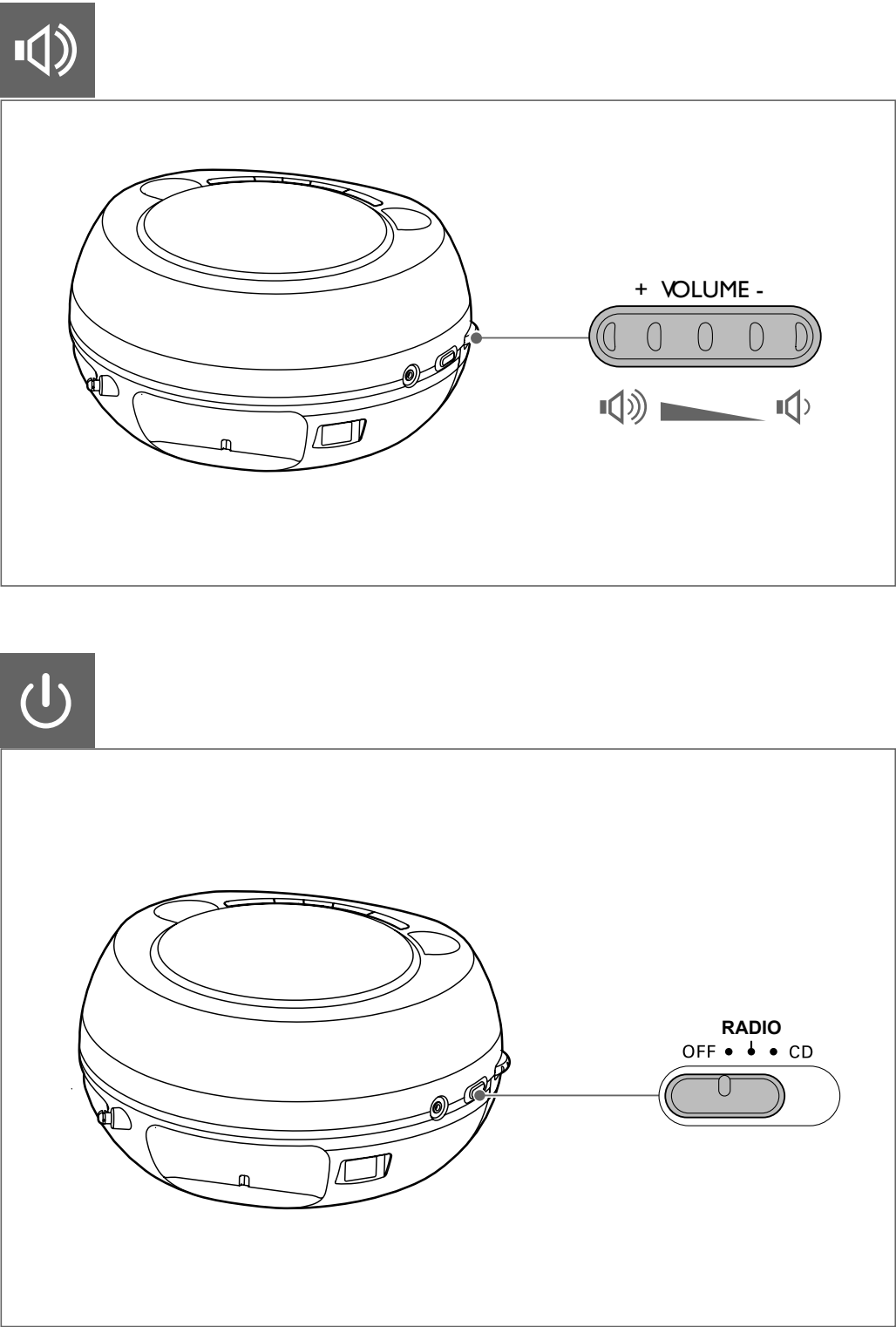

ZH-TW

1 重要事項

了解這些安全符號



- 此「閃電」表示裝置內部的非絕緣材質可能導致電擊。為保障家中所有人員的安全，請勿拆卸外殼。
- 對於以「驚嘆號」提醒您注意的功能，應仔細閱讀隨附的說明文字，避免發生操作及維修問題。
- 警告：**為降低火災與觸電的危險，您應避免讓本裝置暴露於雨水或濕氣中，並且請勿在本裝置上放置花瓶等裝有液體之物品。
- 注意：**若要防止觸電，請完全地插入插頭。(使用具極性指示之插頭的地區：若要防止觸電，請將較寬的接腳插入較寬的插孔。)
- 閱讀這些指示
 - 遵循所有指示。
 - 請勿阻塞任何通風口。請勿將本產品安裝在接近熱源處，例如暖器裝置、暖氣孔、火爐或其他會生熱的產品 (包括擴大機)。
 - 妥善保護電源線，避免踩踏或夾壓，尤其是插頭、便利插座，以及電源線與裝置的連接處。
 - 僅使用原廠指定的附件/配件。
 - 如遇雷雨或長時間不使用時，請將裝置的插頭拔除。
 - 所有維修服務應委託合格的服務人員處理。當本裝置因故障損壞時 (例如電源線或插頭損壞、液體潑濺、物品掉入裝置內部、裝置淋到雨或受潮、無法正常運作或摔落等)，都必須進行維修。
 - 電池使用注意事項 – 為防止電池滲漏導致人身傷害、財物受損或裝置損壞：
 - 請依照裝置上標示的 + 與 - 極正確安裝所有電池。
 - 請勿混用電池 (新舊混用或碳鹼性電池混用等)。
 - 電池請勿暴露在過度的熱源下，例如日照或火焰等。
 - 若裝置長時間不使用時，請將電池取出。
 - 請勿將裝置置於滴水或澆水的環境。
 - 請勿在裝置上放置危險物品 (如盛裝液體的容器、點燃的蠟燭等)。
 - 當電源插頭或電器連接器作為中斷連接裝置時，中斷連接裝置應保持隨時可操作。

警告

- 請勿打開裝置外殼。
- 請勿在本裝置的任何部位使用潤滑油。
- 請勿將本裝置放置在其他電器上。
- 請勿讓本裝置直接曝曬於陽光下，或靠近未隔離的火爐或熱源。
- 請勿直視本裝置內的雷射光。
- 請確保電源線、插頭或變壓器位於容易取得的地方，以便在中斷裝置電源。

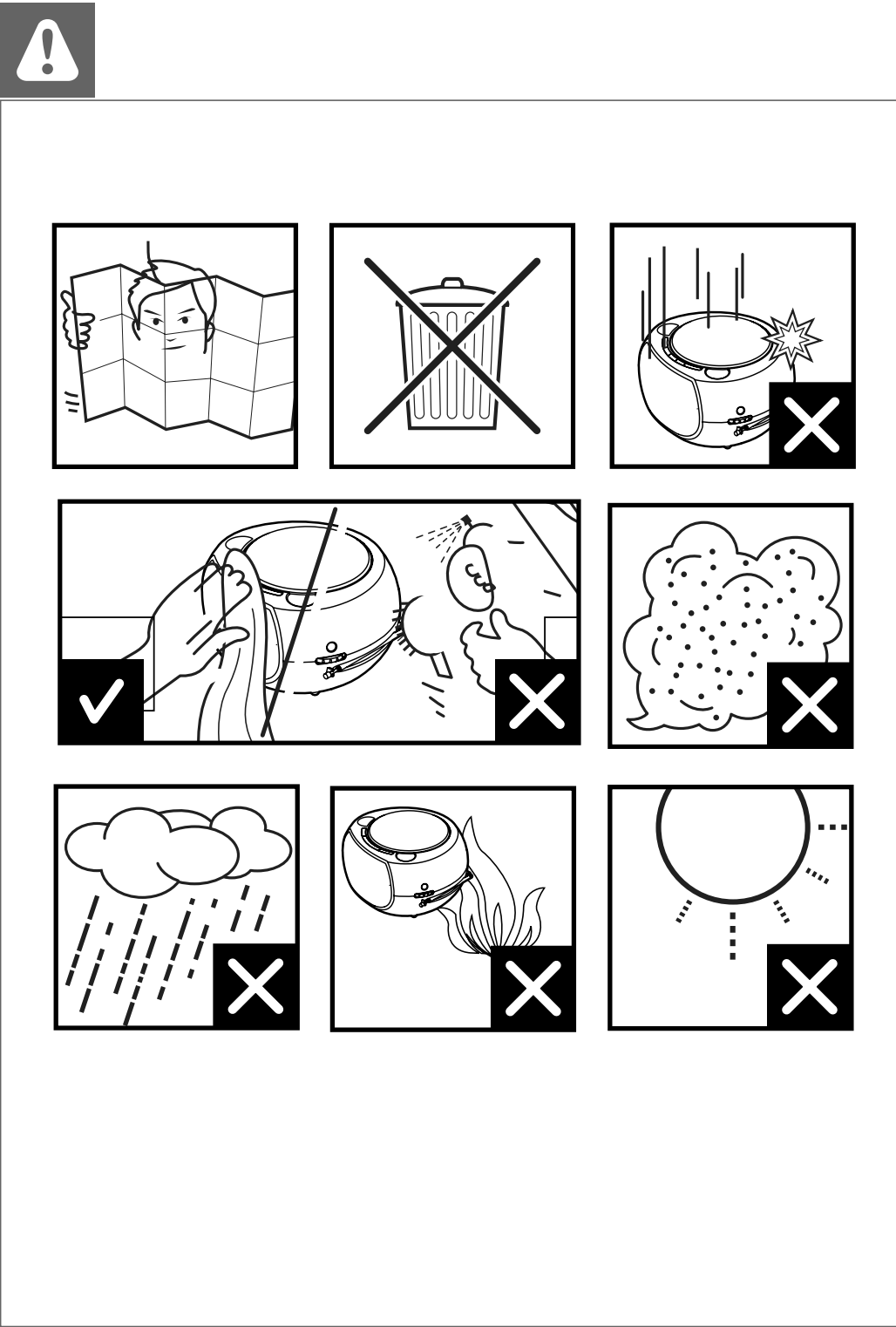

注意

- 使用本手冊以外的方法來控制、調校或不按順序操作，可能會導致雷射照射或其它危險。

2 注意

未經 Gibson Innovations 明確允許而對裝置進行的任何變更或修改可能會導致用戶喪失使用設備的權限。

您的產品是使用高品質材質和元件所設計製造，可回收和重複使用。請勿將您的產品與其他家用廢棄物共同丟棄。請瞭解當地電器、電子產品及電池的垃圾分類相關法規。正確處理這些產品有助於避免對環境和人類健康帶來負面影響。

您的產品內含不能作為一般家庭廢棄物處理的電池。

請了解當地有關電池的垃圾分類相關法規。正確處理廢棄電池有助於避免對環境和人類健康帶來負面影響。

請造訪 www.recycle.philips.com，以取得您當地回收中心的詳細資訊。

環境保護資訊

所有非必要之包裝材料均已捨棄。我們嘗試讓包裝可以輕易折解成三種材質：厚紙板 (外盒)、聚苯乙烯泡棉 (防震) 以及聚乙烯 (包裝袋、保護性泡棉膠紙)。

產品本身含有可回收並重複使用的材質，但是需由專業公司拆解。請根據各地法規丟棄包裝材料、廢電池和舊機器。

本產品包含此標籤：



備註

- 機型牌位於產品底部。

一般資訊

AC 電源	110V ~, 60 Hz
操作耗電量	8 W
電池	9V, 6 x 1.5 V R14/UM2/C CELL
尺寸	
- 主裝置 (寬 x 高 x 深)	245 x 212 x 131 公釐
重量	
- 含包裝	1.5 公斤
- 主裝置	1.1 公斤