

# Quick start guide



Step A *Connect*

Step B *Setup*

Step C *Enjoy*

## What's in the Box?

You should find these items upon opening the box.

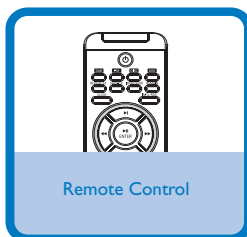
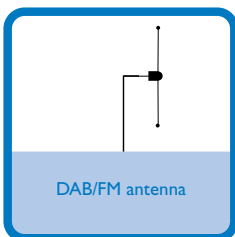

Pull out the plastic protective sheet before use.

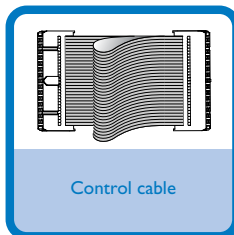
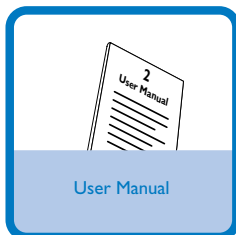
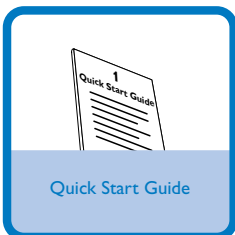
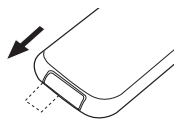

## Step A *Connect*

1

Connect the speaker cables.

3

Connect the control cable.

2

Connect the DAB/FM antenna.

4

Connect the power cord of the system.

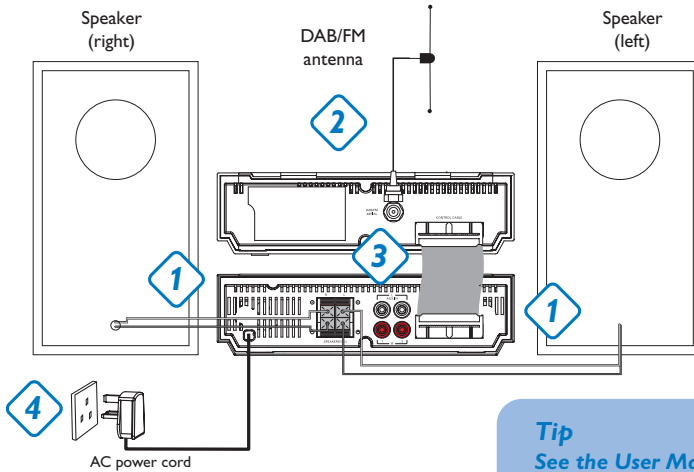

### Tip

See the User Manual for how to connect other equipment to this system.

## Step B *Setup*

1

In standby mode, press and hold **CLOCK** on the remote.

2

When the hour digits flash, turn **VOLUME +/-** on the system or press **VOL +/-** on the remote to set the hours.

3

Press **CLOCK** again and the minute digits flash. Then turn **VOLUME +/-** on the system or press **VOL +/-** on the remote to set the minutes.

4

Press **CLOCK** again to confirm the time setting.

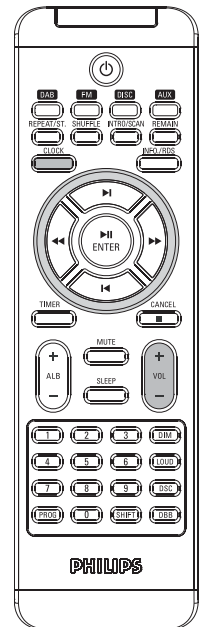

## Playing a disc

- 1 Press **SOURCE** on the top of the system to select DISC or press **DISC** on the remote.
- 2 Press **OPEN-CLOSE** to open the CD compartment.
- 3 Insert a disc with the printed side facing up. Press **OPEN-CLOSE** again to close the compartment.
- 4 Playback will start automatically. If not press **ENTER/▶ II**.
- 5 To stop playback, press **CANCEL/■**.

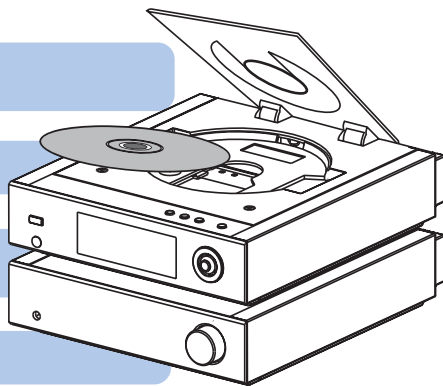

### Tip

See the User Manual for detailed playback operations.

## Tuning to DAB stations

- 1 Press **SOURCE** on the top of the system to select DAB (or press **DAB** on the remote) to start automatic search for available DAB stations.
- 2 Press and hold **INTRO/SCAN** to scan all band III frequencies.
- 3 At the completion of full scan, press the control knob on the front panel of the system to the left or right (corresponding to ◀◀/▶▶) or press ◀◀/▶▶ on the remote to select your desired DAB channels backward/forward.
- 4 Press **ENTER/▶ II** to confirm and tune to your selected channel.

### Tips

- If the reception is poor, hang up one end of the T-shape DAB/IFM antenna and keep the other end at horizontal angle to it.
- See the User Manuals for detailed instructions on DAB operations.

