

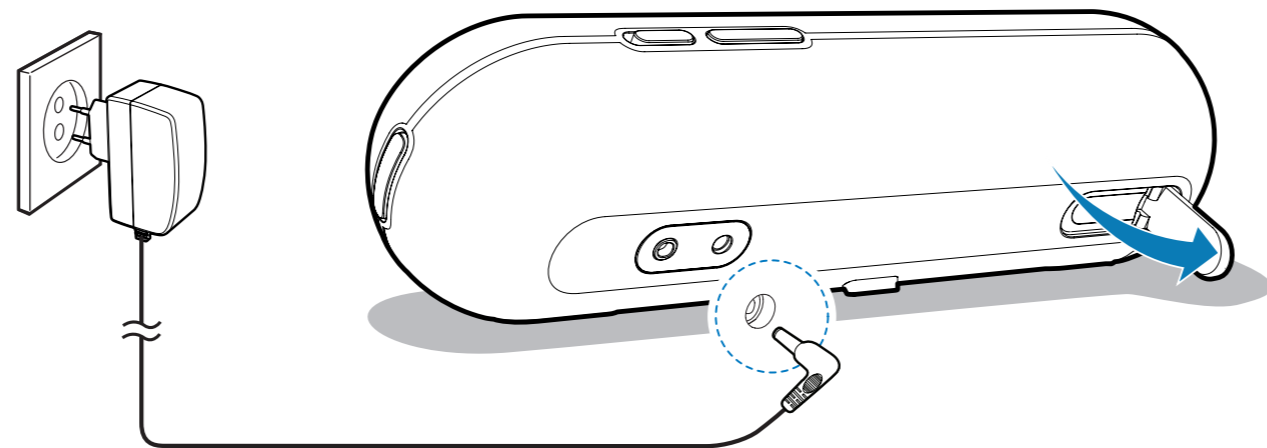

Hızlı Başlangıç Kılavuzu Türkçe

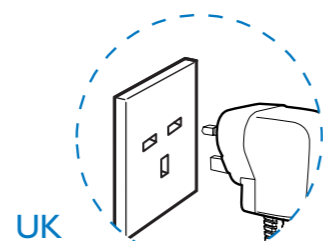

PHILIPS

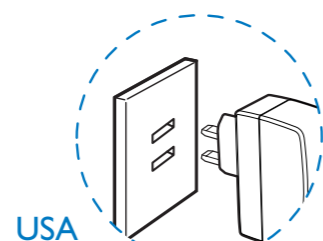
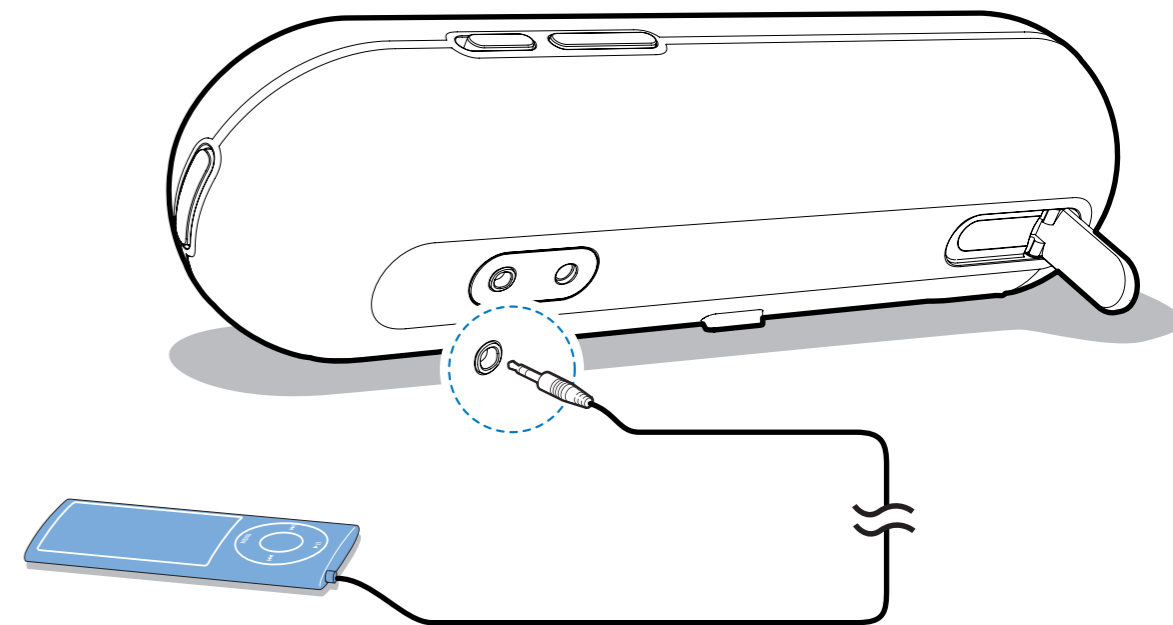
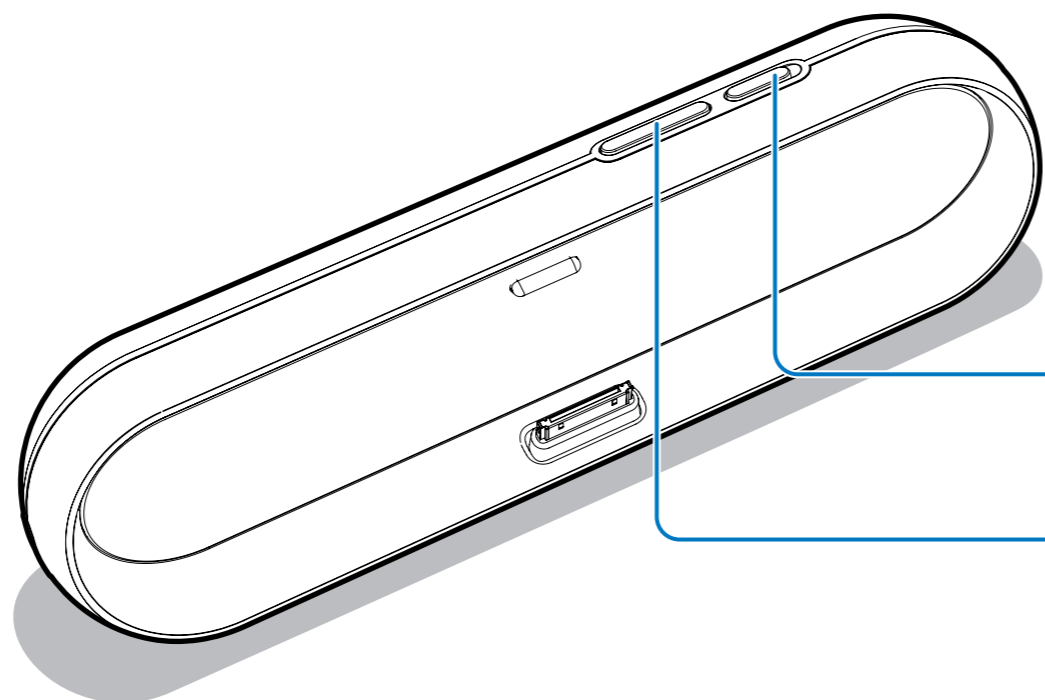
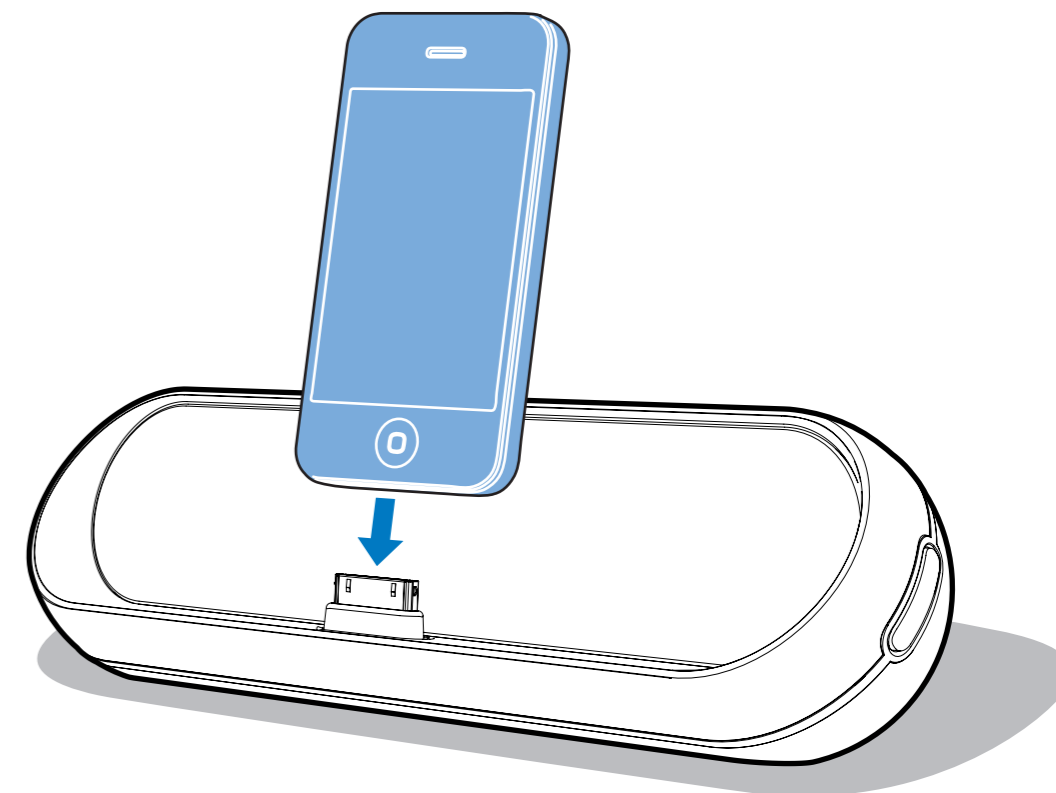

Be responsible
Respect copyrights



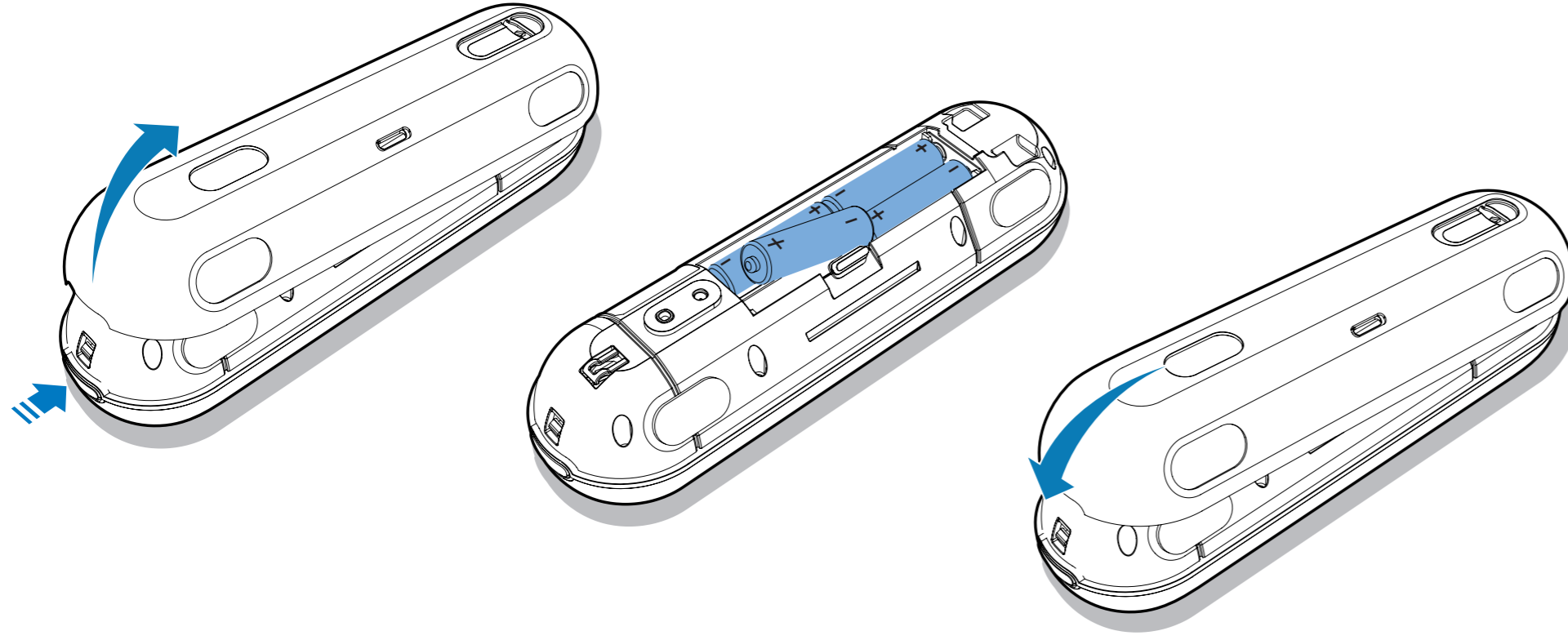

iPod touch(1G,2G,3G,4G)



iPhone, iPhone 3G, iPhone 3GS



iPhone 4



iPod nano 1G



iPod nano 2G



iPod nano 3G



iPod nano 4G



iPod nano 5G



iPod nano 6G

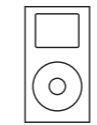

iPod mini

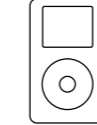

iPod (4G,5G)

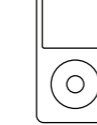

iPod classic

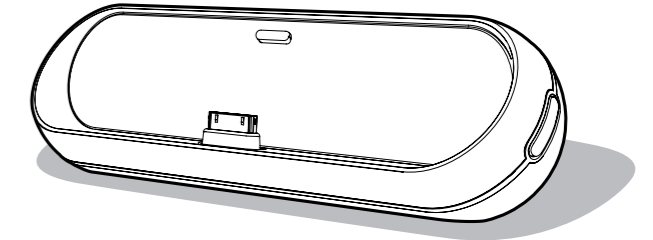

← Türkçe Özellikler

Amplifikatör

Nominal Çıkış Gücü
Sinyal-Gürültü Oranı
AUX IN

2X2 W RMS
75 dB
0,7 V RMS 10 kohm

Genel bilgiler

AC gücü (güç adaptörü)

CPS012A050200V/B/U/C/S/*
(Philips), Giriş: 100-240V~50/60Hz
0,4A, Çıkış: 5V == 2,0A; Y12FE-
050-2000G/B/U/C/S (Philips), Giriş:
100-240V~50-60Hz 0,35A, Çıkış:
5V == 2000mA; Y18DE-050-2000
(Philips), Giriş: 100-240V~50-60Hz
0,5A, Çıkış: 5V == 2000mA

Çalışır Durumdaki Güç Tüketimi
Boyutlar - Ana Ünite (G x Y x D)
Ağırlık - Ana Ünite

<10W
230 x 65 x 50 mm
0,29 kg

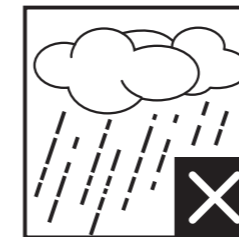
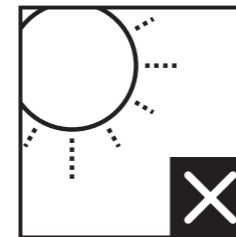
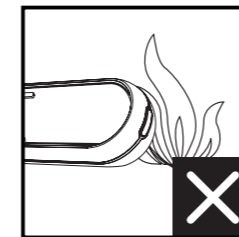
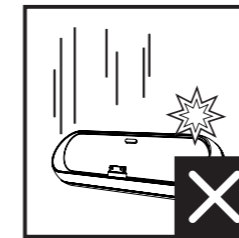
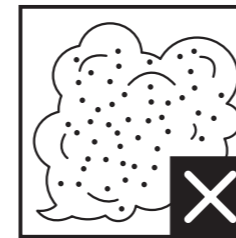
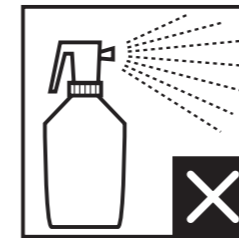
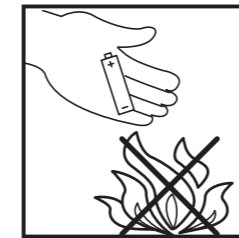
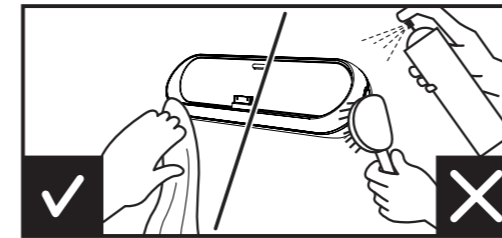
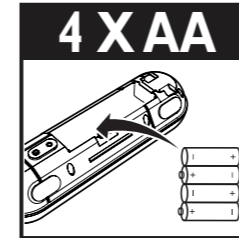
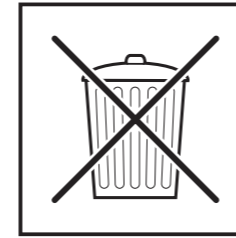
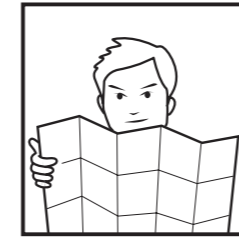

TR

Ürününüzü kullanmadan önce, birlikte verilen tüm güvenlik bilgilerini okuyun.

Yardım mı gerekiyor? Çevrimiçi yardım
www.philips.com/support