



Philips BeNear  
Cordless phone

### 1000-series

1.6" display/ amber backlight  
Speakerphone



CD1911B

## Bringing people closer

### Talk handsfree

Our clever design gives you great sound reproduction without having to hold the CD1911B/DE cordless phone to your ear – so you can talk handsfree. With simple installation and a user-friendly menu, a great chat has never been easier.

#### Crystal clear sound

- Advanced sound testing & tuning for superb voice quality
- Parametric Equalizer delivers pure and clear sound
- Acoustic echo cancellation keeps your conversation echo-free
- Handset speakerphone allows you to talk handsfree
- Optimized antenna layout for great reception in any room

#### Nice and simple

- Easy to read, 4.1cm (1.6") dot-matrix display
- Ultimate convenience through easy setup
- Save up to 50 favorite contacts in your phonebook
- Up to 16 hours of talk time

#### Eco-conscious product

- Zero power emission when ECO+ mode is activated
- Low power consumption: < 0,6W in stand-by mode
- Up to 95% reduction of emitted radiation in charging mode

Cordless phone  
1000-series 1.6" display/ amber backlight, Speakerphone

## Highlights

### 4.1cm(1.6") dot-matrix display

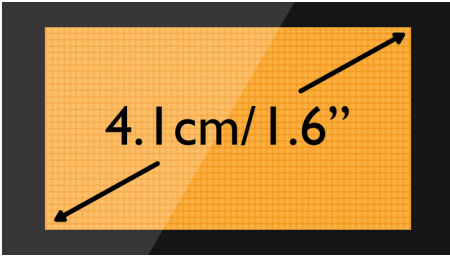

Easy to read, 4.1cm (1.6") dot-matrix display

### 50-name phone book



Always have the phone numbers of your loved ones available: Save up to 50 names in your phonebook.

### Acoustic echo cancellation

No more of those annoying echoes when you are talking on the phone. With our acoustic echo cancellation, you always get a clear, undisturbed connection.

### Advanced sound testing



We test the sound quality of our DECT phones the same way as high-end headphone manufacturers do. Using an advanced ear

simulator, we can accurately re-create the way people actually hear. This helps our acoustic engineers to measure and fine-tune things like frequency response, distortion and overall hearing perception, to create perfect voice reproduction for both handset and handsfree modes.

### Easy setup

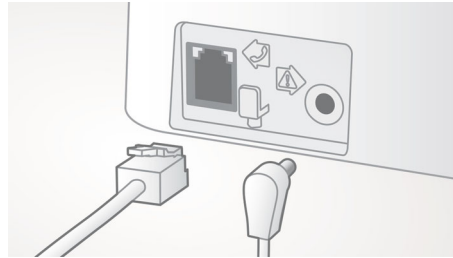

Ultimate convenience through easy set up. Simplified installation - Plug & Play product

### ECO+ mode

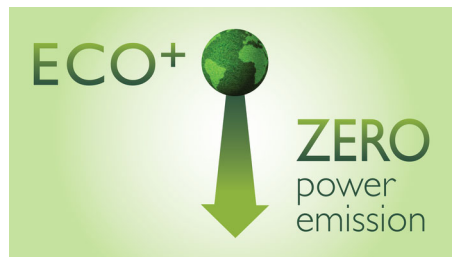

The ultimate mode to save transmitting power.

### Handset speakerphone



Handsfree mode uses a built-in loud speaker to amplify the voice of the caller, allowing you to

CD1911B/DE

simply multitask.

### Less radiation while charging

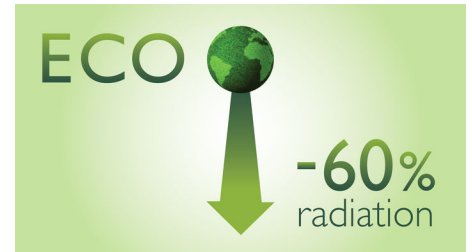

Up to 95% reduction of emitted radiation in charging mode

### Low power consumption: < 0.6 W



Philips phones are energy efficient and are designed to be respectful to the environment. Now the power consumed in stand-by mode is less than < 0.6 W.



### Philips Green Logo

Philips Green Products can reduce costs, energy consumption and CO2 emissions. How? They offer a significant environmental improvement in one or more of the Philips Green Focal Areas – Energy efficiency, Packaging, Hazardous substances, Weight, Recycling and disposal and Lifetime reliability.

# Specifications

## Sound

- Volume control on handset
- Ringtones on handset: 10 polyphonic

## Picture/Display

- Display size: 4.1 cm / 1.6"
- Display type: 1-line dot matrix + 2 line icons
- Backlight: Yes
- Backlight color: Amber

## Convenience

- Speakerphone - talk handsfree
- Menu structure in the handset: List Menu
- Signal strength indicator: 3- bar indicator
- Battery level indicator: 3- bar battery icon
- Date / Time display
- Base Station keys: Paging key
- Battery charge indication
- Signal strength indication
- Programmable hot keys: Key 1 and 2
- Auto hang up
- Key tone on/off
- Call Management: Call Waiting\*, Caller ID\*, Microphone mute, Missed Calls, Received Calls
- Multi base capability: 1
- Multi handset capability: Up to 4
- Intercom - multiple handsets
- Line cord length: 1.8m
- Power cord length: 1.8m

- Charge time: 8 hours
- Up to 16 hrs talk time
- Up to 250 hrs standby time
- Range: Open field <300m; in door <50m

## Memory Capacity

- Phonebook: 50 names and numbers
- Redial List Capacity: 10 entries
- Call log entries: 20 entries
- Phonebook store in the base

## Power

- Battery Capacity: 650 mAh
- Battery type: AAA NiMH Rechargeable
- Mains power: AC 100-240V ~50/60Hz
- Power Consumption: < 0.6 W

## Security

- Transmission encryption : Yes

## Network Features

- Compatible: GAP

## SAR Value

- Philips handsets: <0.1 W/kg

## Eco Design

- EcoMode: automatic
- Full ECO Mode (NEMO)



Issue date 2019-06-02

Version: 4.1.5

12 NC: 8670 000 80199  
EAN: 87 12581 61513 0

© 2019 Koninklijke Philips N.V.  
All Rights reserved.

Specifications are subject to change without notice.  
Trademarks are the property of Koninklijke Philips N.V.  
or their respective owners.

[www.philips.com](http://www.philips.com)