

Register your product and get support at
www.philips.com/welcome

MCD712



EN User manual

ZH-CN 用户手册

PHILIPS

Contents

1 Important	5	5 Play	19
Safety	5	Play a disc	19
Hearing safety	6	Use the disc menu	19
Notice	7	Select an audio language	19
		Select a subtitle language	19
2 Your DVD Micro Theater	9	Play from USB	20
Introduction	9	Play DivX video	20
What's in the box	9	Play MP3/WMA/picture files	20
Overview of the main unit	10	Play control	21
Overview of the remote control	11	Select repeat/shuffle play options	21
		Repeat A-B (DVD/VCD/CD/MP3/WMA)	21
3 Connect	13	Search forward/backward	21
Place the unit	13	Search by time or chapter/track number	21
Connect speakers	13	Resume video play from last stopped point	21
Connect FM antenna	13	Play options	21
Connect TV	14	Display play information	21
Connect video cables	14	Program	21
Option 1: Connect through component video	14	Zoom in/out image	22
Option 2: Connect through S-Video	14	Slow-motion play	22
Option 3: Connect through composite video	14	Change the audio channel	22
Connect audio cables	15	Select a camera angle	22
Connect power	15	Picture view options	22
		Preview pictures	22
4 Get started	16	Select a slide show play mode	22
Prepare the remote control	16	Rotate picture	22
Set clock	16		
Turn on	16	6 Adjust settings	23
Switch to standby mode	16	General setup	23
Find the correct viewing channel	16	Audio setup	23
Select the correct TV system	17	Video setup	24
Change system menu language	17	Preference setup	24
Turn on Progressive Scan	17		
Turn off progressive scan manually	17	7 Tune to FM radio stations	26
		Program radio stations automatically	26
		Program radio stations manually	26
		Tune to a preset radio station	26

8	Adjust volume level and sound effect	27
	Adjust volume level	27
	Select a sound effect	27
	Select a preset sound effect	27
	Enhance bass	27
	Select automatic loudness control	27
	Mute sound	27
	Listen through headphone	27

9	Other features	28
	Activate demonstration mode	28
	Adjust brightness of display panel	28
	Set the alarm timer	28
	Set the sleep timer	28
	Connect other devices	28
	Listen to an audio player	28
	Record to a digital recorder	29

10	Product information	30
	Specifications	30
	Amplifier	30
	Disc	30
	Tuner (FM)	30
	Speakers	30
	General information	30
	Supported disc formats	31
	USB playability information	31

11	Troubleshooting	32
-----------	------------------------	----

1 Important

Safety

Know these safety symbols

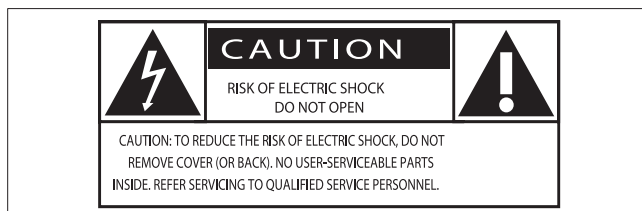

This 'bolt of lightning' indicates uninsulated material within your unit may cause an electrical shock. For the safety of everyone in your household, please do not remove product covering.

The 'exclamation point' calls attention to features for which you should read the enclosed literature closely to prevent operating and maintenance problems.

WARNING: To reduce the risk of fire or electric shock, this apparatus should not be exposed to rain or moisture and objects filled with liquids, such as vases, should not be placed on this apparatus.

CAUTION: To prevent electric shock, match wide blade of plug to wide slot, fully insert.

- ① Read these instructions.
- ② Keep these instructions.
- ③ Heed all warnings.
- ④ Follow all instructions.
- ⑤ Do not use this apparatus near water.
- ⑥ Clean only with dry cloth.

- ⑦ Do not block any ventilation openings. Install in accordance with the manufacturer's instructions.
- ⑧ Do not install near any heat sources such as radiators, heat registers, stoves, or other apparatus (including amplifiers) that produce heat.
- ⑨ For countries with a polarized mains, do not defeat the safety purpose of the polarized or grounding-type plug. A polarized plug has two blades with one wider than the other. A grounding type plug has two blades and a third grounding prong. The wide blade or the third prong is provided for your safety. If the provided plug does not fit into your outlet, consult an electrician for replacement of the obsolete outlet.
Caution: To prevent electric shock, match the wide blade of the plug to the wide slot, fully insert.

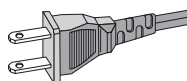

- ⑩ Protect the power cord from being walked on or pinched, particularly at plugs, convenience receptacles, and the point where they exit from the apparatus.
- ⑪ Only use attachments/accessories specified by the manufacturer.
- ⑫ Use only with the cart, stand, tripod, bracket, or table specified by the manufacturer or sold with the apparatus. When a cart is used, use caution when moving the cart/apparatus combination to avoid injury from tip-over.



⑬ Unplug this apparatus during lightning storms or when unused for long periods of time.

⑭ Refer all servicing to qualified service personnel. Servicing is required when the apparatus has been damaged in any way, such as power-supply cord or plug is damaged, liquid has been spilled or objects have fallen into the apparatus, the apparatus has been exposed to rain or moisture, does not operate normally, or has been dropped.

⑮ **Battery usage CAUTION – To prevent battery leakage which may result in bodily injury, property damage, or damage to the apparatus:**

- Install all batteries correctly, + and - as marked on the apparatus.
- Do not mix batteries (old and new or carbon and alkaline, etc.).
- Remove batteries when the unit is not used for a long time.

⑯ The batteries shall not be exposed to excessive heat such as sunshine, fire or the like.

⑰ Apparatus shall not be exposed to dripping or splashing.

⑱ Do not place any sources of danger on the apparatus (e.g. liquid filled objects, lighted candles).

⑲ This product may contain lead and mercury. Disposal of these materials may be regulated due to environmental considerations. For disposal or recycling information, please contact your local authorities or the Electronic Industries Alliance: www.eiae.org.

Caution

- Use of controls or adjustments or performance of procedures other than herein may result in hazardous radiation exposure or other unsafe operation.

Warning

- Where the MAINS plug or an appliance coupler is used as the disconnect device, the disconnect device shall remain readily operable.

Warning

- Never remove the casing of this unit.
- Never lubricate any part of this unit.
- Place this unit on a flat, hard and stable surface.
- Never place this unit on other electrical equipment.
- Only use this unit indoors. Keep this unit away from water, moisture and liquid-filled objects.
- Keep this unit away from direct sunlight, naked flames or heat.
- Never look into the laser beam inside the unit.

Hearing safety

Listen at a moderate volume.

- Using headphones at a high volume can impair your hearing. This product can produce sounds in decibel ranges that may cause hearing loss for a normal person, even for exposure less than a minute. The higher decibel ranges are offered for those that may have already experienced some hearing loss.
- Sound can be deceiving. Over time your hearing 'comfort level' adapts to higher volumes of sound. So after prolonged listening, what sounds 'normal' can actually be loud and harmful to your hearing. To guard against this, set your volume to a safe level before your hearing adapts and leave it there.

To establish a safe volume level:

- Set your volume control at a low setting.
- Slowly increase the sound until you can hear it comfortably and clearly, without distortion.

Listen for reasonable periods of time:

- Prolonged exposure to sound, even at normally 'safe' levels, can also cause hearing loss.

- Be sure to use your equipment reasonably and take appropriate breaks.

Be sure to observe the following guidelines when using your headphones.

- Listen at reasonable volumes for reasonable periods of time.
- Be careful not to adjust the volume as your hearing adapts.
- Do not turn up the volume so high that you can't hear what's around you.
- You should use caution or temporarily discontinue use in potentially hazardous situations. Do not use headphones while operating a motorized vehicle, cycling, skateboarding, etc.; it may create a traffic hazard and is illegal in many areas.

Notice

Any changes or modifications made to this device that are not expressly approved by Philips Consumer Lifestyle may void the user's authority to operate the equipment.



Your product is designed and manufactured with high quality materials and components, which can be recycled and reused.



When this crossed-out wheeled bin symbol is attached to a product it means that the product is covered by the European Directive 2002/96/EC.

Please inform yourself about the local separate collection system for electrical and electronic products.

Please act according to your local rules and do not dispose of your old products with your normal household waste. Correct disposal of your old product helps to prevent potential negative consequences for the environment and human health.



Your product contains batteries covered by the European Directive 2006/66/EC, which cannot be disposed with normal household waste. Please inform yourself about the local rules on separate collection of batteries because correct disposal helps to prevent negative consequences for the environmental and human health.

Environmental information

All unnecessary packaging has been omitted. We have tried to make the packaging easy to separate into three materials: cardboard (box), polystyrene foam (buffer) and polyethylene (bags, protective foam sheet.)

Your system consists of materials which can be recycled and reused if disassembled by a specialized company. Please observe the local regulations regarding the disposal of packaging materials, exhausted batteries and old equipment.



**Be responsible
Respect copyrights**

The making of unauthorized copies of copy-protected material, including computer programs, files, broadcasts and sound recordings, may be an infringement of copyrights and constitute a criminal offence. This equipment should not be used for such purposes.



'DVD Video' is a trademark of DVD Format/ Logo Licensing Corporation.



Official DivX® Certified product. Plays all versions of DivX® video (including DivX® 6) with standard playback of DivX® media files.



Manufactured under license from Dolby Laboratories. Dolby and the double-D symbol are trademarks of Dolby Laboratories.

This apparatus includes this label:



Note

- The type plate is located on the bottom of the apparatus.

2 Your DVD Micro Theater

Congratulations on your purchase, and welcome to Philips! To fully benefit from the support that Philips offers, register your product at www.Philips.com/welcome.

Introduction

With this unit, you can:

- watch video from DVD/VCD/SVCD or USB devices
- enjoy audio from discs or USB devices
- view pictures from discs or USB devices
- Listen to FM radio

You can enrich sound output with these sound effects:

- Digital Sound Control (DSC)
- Dynamic Bass Boost (DBB)
- Bass/treble enhancement

The unit supports these media/disc formats:



You can play DVD discs with the following region codes:

DVD region code	Countries
 	China

What's in the box

Check and identify the contents of your package:

- Main unit
- 2 speakers
- Remote control with battery
- Composite video cable (yellow)
- FM wire antenna
- User manual
- Quick start guide

Overview of the main unit

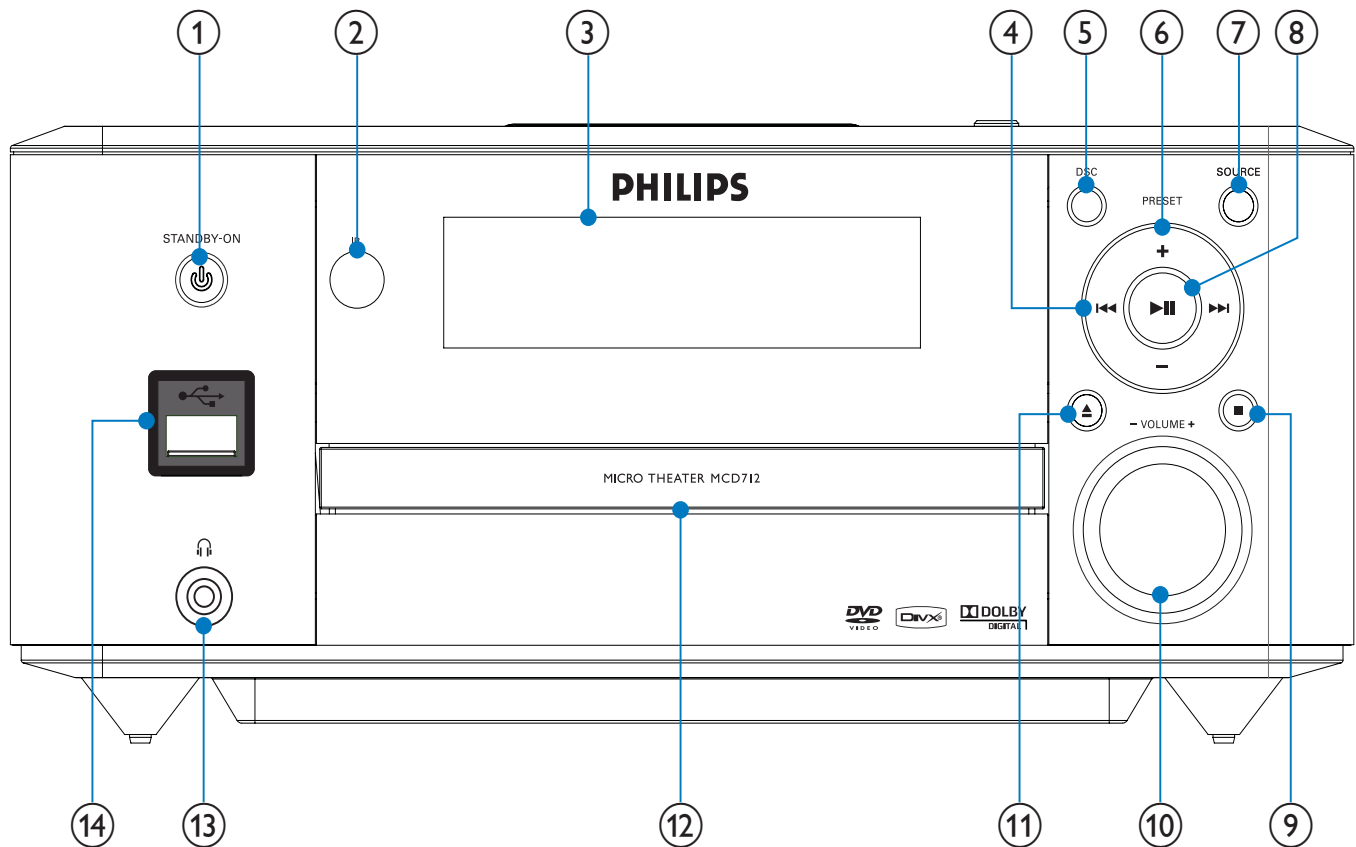

① **STANDBY-ON**

- Turn on the apparatus; switch to standby mode.

② **Remote control sensor**

③ **Display panel**

- Display current status.

④ **⏮/⏭**

- Skip to the previous/next track.
- Search within a track.
- Skip to the previous/next title or chapter.
- Tune to a radio station.

⑤ **DSC**

- Select a preset sound setting.

⑥ **PRESET +/-**

- Select a preset radio station.

⑦ **SOURCE**

- Select a source.

⑧ **⏸**

- Start or pause play.

⑨ **■**

- Stop play.
- Erase a program.
- In demo mode, activate or deactivate demonstration.

⑩ **VOLUME +/-**

- Adjust volume.
- Adjust time.
- During timer setting, select a source.

⑪ **⬆**

- Open or close the disc compartment.

⑫ **Disc compartment**

⑬ **🎧**

- Headphone socket.

⑭ **🔌**

- USB socket.

Overview of the remote control

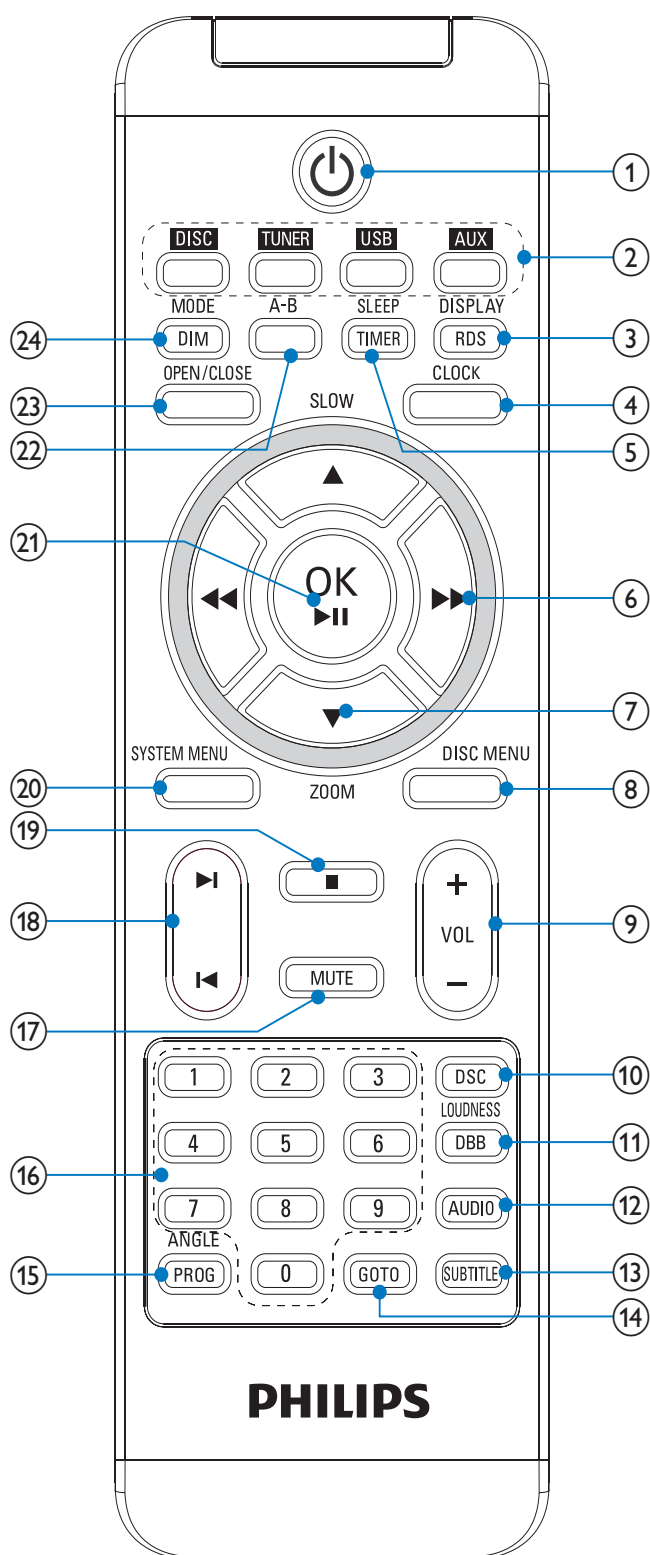

③ DISPLAY/RDS (RDS function unavailable for this version)

- Display play information on a connected TV.

④ CLOCK

- Set the clock.

⑤ SLEEP/TIMER

- Set the sleep timer.
- Set the alarm timer.

⑥ ◀▶

- Search within a track.
- Tune to a radio station.
- For menus, navigate left/right.
- Move an enlarged picture left/right.
- Rotate or invert pictures.

⑦ ▲SLOW/▼ZOOM

- For menus, navigate up/down.
- Rotate or invert pictures.
- (▲SLOW) For video: select a slow play mode.
- (▼ZOOM) For video: zoom in/out.

⑧ DISC MENU

- For video discs: access or exit the disc menu.
- For video discs with playback control (PBC): turn on/off PBC.

⑨ VOL +/-

- Adjust volume.
- Adjust time.
- During timer setting, select a source.

⑩ DSC

- Select a preset sound setting.

⑪ LOUDNESS/DBB

- Turn on or off automatic loudness adjustment.
- Turn on or off dynamic bass enhancement.

⑫ AUDIO

- For VCD, select stereo, mono-left or mono-right channel.
- For DVD/DivX video, select an audio language.

① ⏻

- Turn on the apparatus; switch to standby mode.

② Source selection keys

- Select a source.

- ⑬ **SUBTITLE**
 - Select a subtitle language.
- ⑭ **GOTO**
 - During disc play, specify a position to start play.
- ⑮ **ANGLE/PROG**
 - Select a DVD camera angle.
 - Program tracks.
 - Program titles/chapters for DVD play.
 - Program radio stations.
- ⑯ **Numeric keypad**
 - Select a title/chapter/track directly.
- ⑰ **MUTE**
 - Mute or restore volume.
- ⑱ **⏮/⏭**
 - Skip to the previous/next track.
 - Skip to the previous/next title or chapter.
 - Select a preset radio station.
- ⑲ **■**
 - Stop play.
 - Erase a program.
- ⑳ **SYSTEM MENU**
 - Access or exit the system setup menu.
- ㉑ **OK / ⏸**
 - Confirm a selection.
 - Start or pause play.
- ㉒ **A-B**
 - Repeat a specific section within a track/disc.
- ㉓ **OPEN/CLOSE**
 - Open or close the disc compartment.
- ㉔ **MODE/DIM**
 - Select repeat play modes.
 - Select shuffle play modes.
 - Select a brightness level for the display screen.

3 Connect

Place the unit

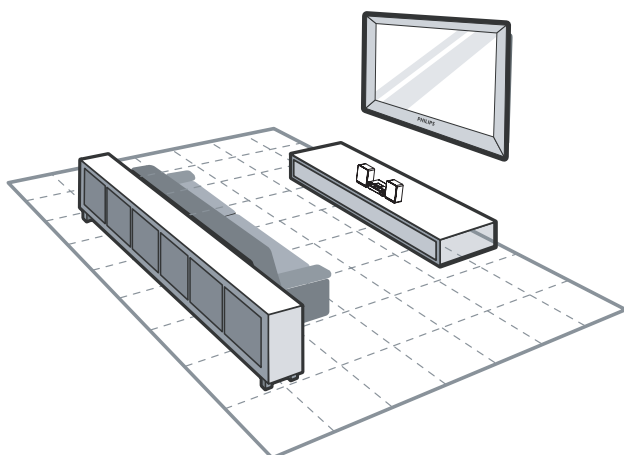

- 1 Place the unit near to the TV.
- 2 Place the left and right speakers at equal distance from the TV and at an angle of approximately 45 degrees from the listening position.



Note

- To avoid magnetic interference or unwanted noise, never place this apparatus and speakers too close to any radiation devices.
- Never place this unit in an enclosed cabinet.
- Install this unit near the AC outlet where the AC power plug can be easily reached.

Connect speakers



Note

- Ensure that the colors of the speaker wires and terminals are matched.
- For optimal sound, use the supplied speakers only.
- Connect only speakers with impedance that is the same or higher than the supplied speakers. Refer to the Specifications section of this manual.

- 1 Hold down the socket flap.

- 2 Insert the stripped part of the wire completely.
 - Insert the right speaker wires to "R", left speaker wires to "L".
 - Insert the red wires to "+", black wires to "-".

- 3 Release the socket flap.

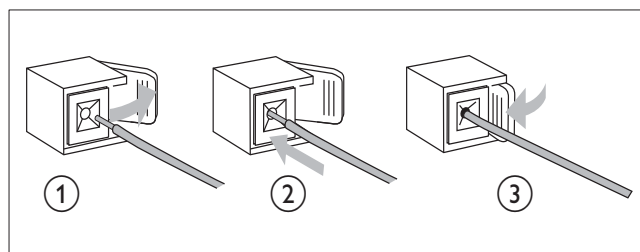

Connect FM antenna

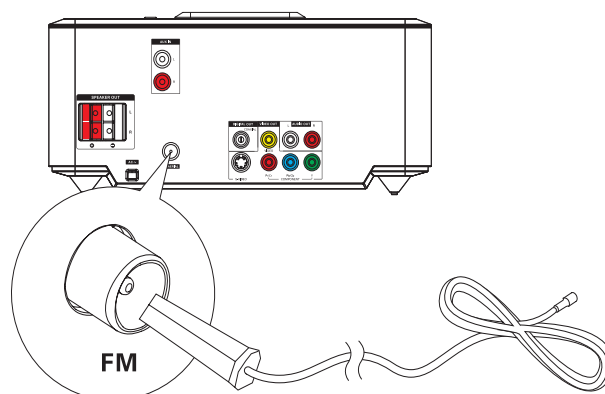

Tip

- For optimal reception, fully extend and adjust the position of the antenna.
- For better FM stereo reception, connect an outdoor FM antenna to the **FM AERIAL** jack.
- The unit does not support MW radio reception.

- 1 Connect the supplied FM wire antenna to the **FM AERIAL** socket on the unit.

Connect TV

Connect video cables

With this connection, you can watch video from the unit on the TV screen.

You can select the best video connection that your TV supports.

- Option 1: connect through component video (for a standard TV or Progressive Scan TV).
- Option 2: connect through S-Video (for a standard TV).
- Option 3: connect through composite video (CVBS) (for a standard TV).

Option 1: Connect through component video

Connect a progressive scan TV through component video for higher quality video.

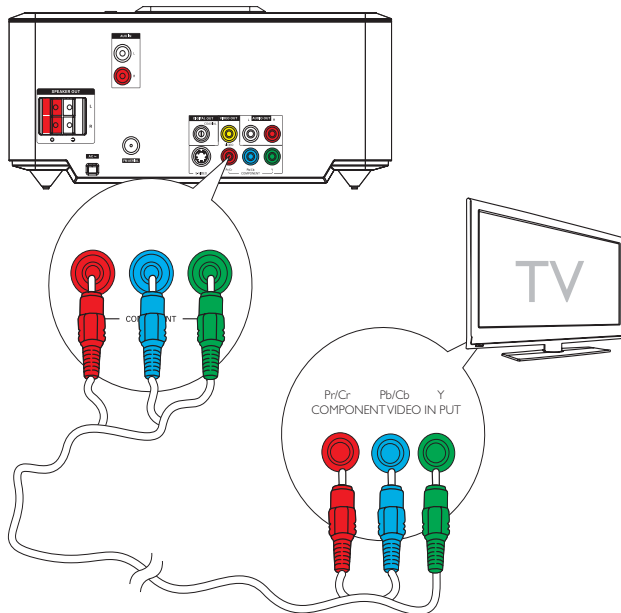

Note

- The progressive scan video quality is only available when a progressive scan TV is connected.
- If your TV does not support progressive scan, you cannot view the picture.
- For how to activate progressive scan on your TV, refer to the TV user manual.

Connect a progressive scan TV through component video for higher quality video.

- 1 Connect component video cables (red/blue/green - not supplied) to:
 - the **VIDEO OUT (Pr/Cr Pb/Cb Y)** sockets on this unit.
 - the component input sockets on the TV.

Option 2: Connect through S-Video

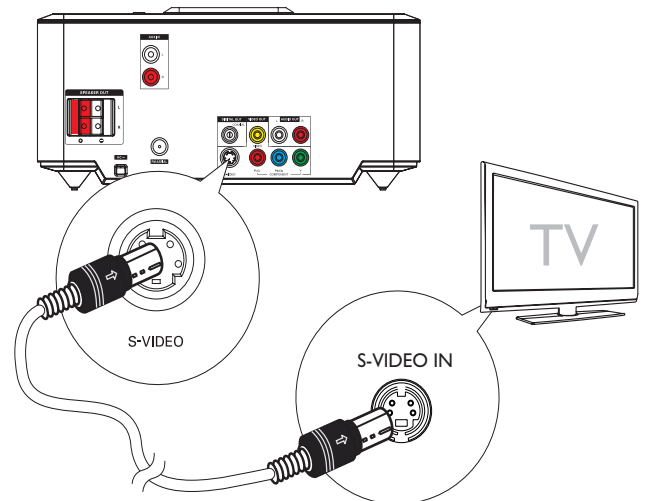

- 1 Connect an S-video cable (not supplied) to:
 - the **S-Video** socket on this unit.
 - the **S-Video** socket on the TV.

Option 3: Connect through composite video

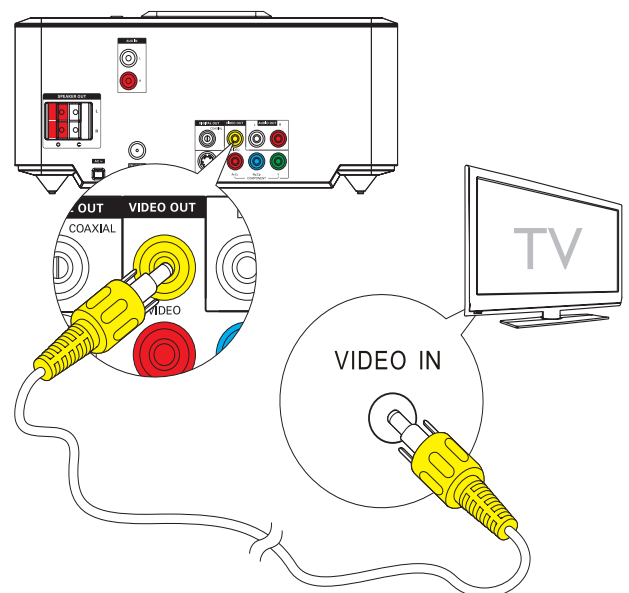

- 1 Connect the supplied composite video cable to:
 - the **VIDEO OUT** socket on this unit.
 - the video input socket on the TV.

Connect audio cables

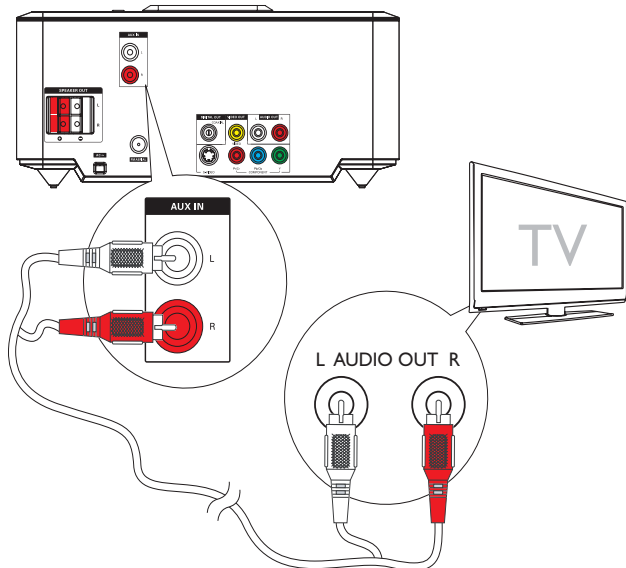

- 1 To play sound from the TV through this unit, connect audio cables (red/white - not supplied) to:
 - the **AUX IN L/R** sockets on this unit.
 - the audio output sockets on the TV.

Connect power

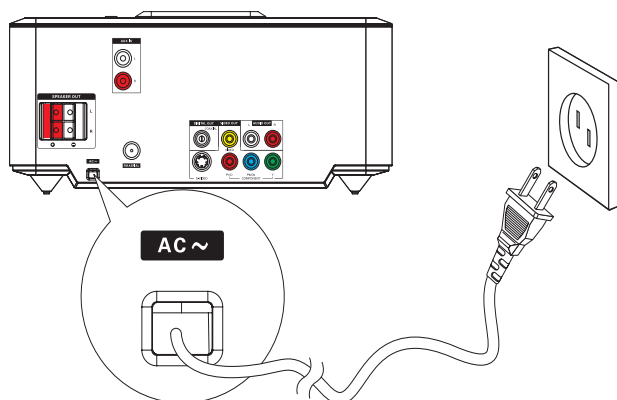

Caution

- Risk of product damage! Ensure that the power supply voltage corresponds to the voltage printed on the back or the underside of the unit.
- Before connecting the AC power cord, ensure you have completed all other connections.

- 1 Connect the AC power cord to the wall socket.

4 Get started



Caution

- Use of controls or adjustments or performance of procedures other than herein may result in hazardous radiation exposure or other unsafe operation.

Always follow the instructions in this chapter in sequence.

If you contact Philips, you will be asked for the model and serial number of this apparatus. The model number and serial number are on the bottom of the apparatus. Write the numbers here:

Model No. _____

Serial No. _____

Prepare the remote control



Caution

- Risk of explosion! Keep batteries away from heat, sunshine or fire. Never discard batteries in fire.

For first-time use:

- 1 Remove the protective tab to activate the remote control battery.

To replace the remote control batteries:

- 1 Open the battery compartment.
- 2 Insert one lithium CR2025 battery with correct polarity (+/-) as indicated.
- 3 Close the battery compartment.



Note

- Before you press any function button on the remote control, first select the correct source with the remote control.
- If you are not going to use the remote control for a long time, remove the battery.

Set clock

- 1 In the standby mode, press and hold **CLOCK** to activate the clock setting mode.
 - ↳ The hour digits are displayed and begin to blink.
- 2 Press **+VOL -** to set the hour, then press **CLOCK** again.
 - ↳ The minute digits are displayed and begin to blink.
- 3 Press **+VOL -** to set the minute.
- 4 Press **CLOCK** to confirm the clock setting.

Turn on

- 1 Press **⏻**.
 - ↳ The unit switches to the last selected source.

Switch to standby mode

- 1 Press **⏻** again.
 - ↳ The clock (if set) appears on the display panel.

Find the correct viewing channel

- 1 Press **⏻** to turn on the unit.
- 2 Press **DISC** to switch to disc mode.
- 3 Turn on the TV and switch to the correct video-in channel in one of the following ways:
 - Go to the lowest channel on your TV, then press the Channel Down button until you see the Philips screen.
 - Press the source button repeatedly on the remote control of your TV.



Tip

- The video-in channel is between the lowest and highest channels and may be called FRONT, A/V IN, VIDEO etc. See the TV user manual on how to select the correct input on the TV.

Select the correct TV system

Change this setting if the video does not appear correctly. By default, this setting matches the most common setting for TVs in your country.

- 1 Press **SYSTEM MENU**.
- 2 Select **[Preference Page]**.
- 3 Select **[TV Type]** and then press **▶▶**.
- 4 Select a setting and then press **OK / ▶▶**.
 - **[PAL]** - For TV with PAL color system.
 - **[Auto]** - For TV that is compatible with both PAL and NTSC.
 - **[NTSC]** - For TV with NTSC color system.
- 5 To exit the menu, press **SYSTEM MENU**.



Note

- When the HDMI cable is connected, the **[TV Type]** option is unavailable.

Change system menu language

- 1 Press **SYSTEM MENU**.
- 2 Select **[General Setup Page]**.
- 3 Select **[OSD Language]** and then press **▶▶**.
- 4 Select a setting and then press **OK / ▶▶**.
- 5 To exit the menu, press **SYSTEM MENU**.

Turn on Progressive Scan

Progressive scan displays twice the number of frames per seconds than interlaced scanning (ordinary TV system). With nearly double the number of lines, progressive scan offers higher picture resolution and quality.

Before you turn on this feature, ensure that:

- The TV supports progressive scan signals.
- You have connected this unit with the TV through component video.

- 1 Turn on the TV.
- 2 Ensure that the TV progressive scan mode is deactivated (see the TV user manual).
- 3 Switch the TV to the correct viewing channel for this unit.
- 4 Press **DISC**.
- 5 Press **SYSTEM MENU**.
- 6 Press **◀▶▶** to select **[Video Setup Page]** in the menu, then press **▼**.
- 7 Select **[Component] > [Pr/Cr Pb/Cb Y]**, then press **OK / ▶▶**.
- 8 Select **[TV Mode] (TV Mode) > [Progressive]**, then press **OK / ▶▶**.
 - ↳ A warning message is displayed.
- 9 To proceed, select **[Ok]** and press **OK / ▶▶**.
 - ↳ The progressive setup is complete.



Note

- If a blank/distorted screen is displayed, wait for 15 seconds for auto recovery or turn off progressive scan manually.

- 10 Turn on the progressive scan mode on the TV.

Turn off progressive scan manually

- 1 Turn off the progressive scan mode on the TV.

- 2 Press **SYSTEM MENU** to exit the menu.
- 3 Press **DISC** followed by numeric key "1" to turn off the progressive scan mode on the unit.
 - ↳ The blue Philips DVD background screen is displayed.



Note

- In the progressive mode, if you press **DISC** followed by numeric key "1" during normal play, the progressive scan mode will be turned off on the unit.

5 Play



Note

- With some disc/file types, play may differ.

Play a disc



Caution

- Never look at the laser beam inside the unit.
- Risk of product damage! Never play discs with accessories such as disc stabilizer rings or disc treatment sheets.
- Never put any objects other than discs into the disc compartment.

- 1 Press **DISC** to select the DISC source.
- 2 Press **OPEN/CLOSE**.
↳ The disc tray opens.
- 3 Place a disc onto the tray and press **OPEN/CLOSE**.
↳ Ensure that the label faces up.
- 4 Play starts automatically.
 - To stop play, press **■**.
 - To pause or resume play, press **OK** / **▶II**.
 - To skip to the previous/next title/chapter/track, press **◀/▶I**.

If play does not start automatically:

 - Select a title/chapter/track and then press **OK** / **▶II**.



Tip

- To play a locked DVD, enter the 4-digit parental control password.

Use the disc menu

When you load a DVD/(S)VCD disc, a menu may be displayed on the TV screen.

To access or exit the menu manually:

- 1 Press **DISC MENU**.

For VCD with PlayBack Control (PBC) feature (version 2.0 only):

With the PBC feature, you can play VCD interactively according to the menu screen.

- 1 During play, press **DISC MENU** to enable/disable PBC.
 - ↳ When PBC is enabled, the menu screen is displayed.
 - ↳ When PBC is disabled, normal play is resumed.

Select an audio language

You can select an audio language on DVDs or DivX video.

- 1 During disc play, press **AUDIO**.
 - ↳ The language options appear. If the selected audio channels is unavailable, the default disc audio channel is used.



Note

- For some DVDs, the language can only be changed from the disc menu. Press **DISC MENU** to access the menu.

Select a subtitle language

You can select a subtitle language on DVDs or DivX® discs.

- During play, press **SUBTITLE**.



Tip

- For some DVDs, the language can only be changed from the disc menu. Press **DISC MENU** to access the menu.

Play from USB

Note

- Ensure that the USB device contains playable music, pictures or video.

- 1 Insert the USB device.

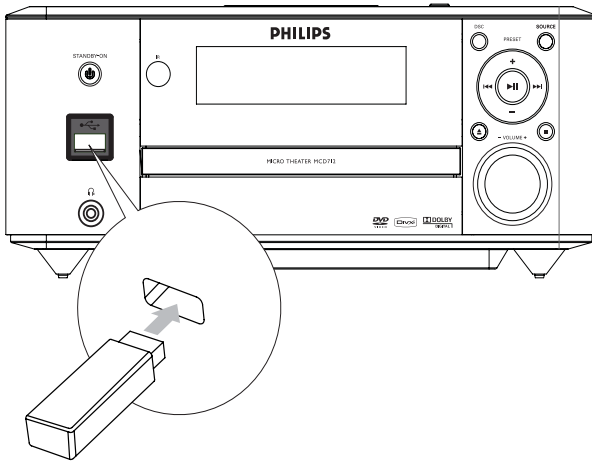

- 2 Press **USB** to select the USB source.
- 3 Press **DISC MENU** until the folder is displayed.
- 4 Press **▲/▼** to select a folder, then press **OK / ►||** to confirm.
- 5 Press **▲/▼** to select a file from the folder.
- 6 Press **OK / ►||** to start play.
 - To stop play, press **■**.
 - To pause or resume play, press **OK / ►||**.
 - To skip to the previous/next file, press **◀▶**.

Play DivX video

You can play DivX files copied onto a CD-R/RW, recordable DVD or USB device.

- 1 Insert a disc or connect a USB device.
- 2 Select a source:
 - For discs, press **DISC**.
 - For USB devices, press **USB**.

- 3 Select a file to play and press **OK / ►||**.
 - To stop play, press **■**.
 - To pause or resume play, press **OK / ►||**.
 - To change a subtitle language, press **SUBTITLE**.

Note

- You can only play DivX videos rented or purchased through the DivX registration code of this unit.
- Subtitle files with the following filename extensions (.srt, .smi, .sub, .ssa, .ass) are supported but do not appear on the file navigation menu.
- The subtitle filename has to be the same as the file name of the video.

Play MP3/WMA/picture files

You can play MP3/WMA/picture files copied onto a CD-R/RW, recordable DVD or USB device.

- 1 Insert a disc or connect a USB device.
- 2 Select a source:
 - For discs, press **DISC**.
 - For USB devices, press **USB**.
- 3 Press **DISC MENU** until the folder is displayed.
- 4 Press **▲/▼** to select a folder, then press **OK / ►||** to confirm.
- 5 Press **▲/▼** to select a file from the folder.
- 6 Press **OK / ►||** to start play.
 - To stop play, press **■**.
 - To pause or resume play, press **OK / ►||**.
 - To skip to the previous/next file, press **◀▶**.

Play control

Select repeat/shuffle play options

- 1 During play, press **MODE/DIM** repeatedly to select a repeat option or the shuffle play mode.
 - To resume normal play, press **MODE/DIM** repeatedly until no option is displayed.

Repeat A-B (DVD/VCD/CD/MP3/WMA)

- 1 During music or video play, press **A-B** at the start point.
- 2 Press **A-B** at the end point.
 - ↳ The selected section starts to play repeatedly.
 - To cancel repeat play, press **A-B** again.



Note

- The section A and B can be set only within the same track/title.

Search forward/backward

- 1 During play, press **◀▶** repeatedly to select a search speed.
 - To resume play at normal speed, press **OK / ▶▶**.

Search by time or chapter/track number

- 1 During video/audio play, press **GOTO** until a time field or chapter/track field is displayed.
 - For the time field, enter the play position in hours, minutes and seconds.
 - For the chapter/track field, enter the chapter/track.

- Play starts automatically at your selected point.

Resume video play from last stopped point



Note

- This feature is only available for DVD/VCD play.

- 1 In stop mode and when the disc has not been removed, press **OK / ▶▶**.

To cancel resume mode and stop play completely:

- 1 In stop mode, press **■**.

Play options

Display play information

- 1 During play, press **DISPLAY/RDS** repeatedly to display play information.

Program



Note

- You cannot program picture files/discs.

For video discs/audio CDs:

- 1 In stop mode, press **ANGLE/PROG** to access the program menu.
- 2 Enter the tracks/chapters to add to the program.
- 3 Repeat step 2 until the program is complete.
- 4 Select **[Start]**, then press **OK / ▶▶** to play the program.

For Divx/MP3/WMA files:

- 1 In stop mode, press **DISC MENU** until the file list is displayed.

- 2 Select a file, then press **ANGLE/PROG** to add the file to the program list.
- 3 Repeat steps 2 until the program is complete.
- 4 Press **OK / ►||** to play the program.

To delete a file from the [Program List]:

- 1 Press **DISC MENU** until the program list is displayed.
- 2 Select a file, then press **ANGLE/PROG** to delete the file from the program list.

Zoom in/out image

- 1 During video play, press **▼ (ZOOM)** repeatedly to zoom in/out the image.
 - When the image is zoomed in, you can press **◀▶** to pan through the image.

Slow-motion play

- 1 During video play, press **▲ (SLOW)** repeatedly to select a slow play option.
 - ↳ The sound is muted.
 - ↳ To resume play at normal speed, press **►||**.

Change the audio channel



Note

- This feature is only available for VCD/DivX play.

- 1 During play, press **AUDIO** repeatedly to select an audio channel available on the disc:
 - Mono Left
 - Mono Right
 - Stereo

Select a camera angle



Note

- This feature is only available for DVDs recorded with multiple camera angles.

- 1 During play, press **ANGLE/PROG** repeatedly to select a camera angle.

Picture view options

Preview pictures

- 1 During play, press **■**.
 - ↳ The thumbnails of 12 pictures are displayed.
- 2 Select one of the following:
 - a picture
 - the slide show option
 - the menu option
 - the next/previous page (if available)
- 3 Press **OK** to:
 - play the selected picture
 - start slide show of all pictures
 - enter the menu where each remote key function is explained
 - turn to the next/previous page (if available)

Select a slide show play mode

- 1 During play, press **ANGLE/PROG** repeatedly to select a slide-show play mode.

Rotate picture

- 1 During play, press **◀▶/▲/▼** to rotate the picture anti-clockwise/clockwise.

6 Adjust settings

- 1 Press **SYSTEM MENU**.
- 2 Select a setup page.
- 3 Select an option and then press **▶▶**.
- 4 Select a setting and then press **OK / ▶▶**.
 - To return to the previous menu, press **◀◀**.
 - To exit the menu, press **SYSTEM MENU**.

- **[On]** – Enable the screen saver.
- **[Off]** – Disable the screen saver.

[DIVX (R) VOD]

Display the DivX® registration code.



Tip

- Enter this DivX registration code when you rent or purchase video from <http://vod.divx.com/>. The DivX videos rented or purchased through the DivX® VOD (Video On Demand) service can be played only on the device to which it is registered.

General setup

On **[General Setup Page]**, you can set the following options:

[TV Display]

The TV format determines the aspect ratio of display according to the type of TV you have connected.



4:3 Pan Scan (PS)



4:3 Letter Box (LB)



16:9 (Wide Screen)

- **[4:3 Pan Scan]** – For 4:3 screen TV: full-height display with the trimmed sides.
- **[4:3 Letter Box]** – For 4:3 screen TV: wide-screen display with black bars on the top and bottom of the screen.
- **[16:9]** – For wide-screen TV: display ratio 16:9.

[OSD Language]

Select the preferred language for on-screen display.

[Screen Saver]

The screen saver protects the TV screen damage due to prolonged exposure to a static image.

Audio setup

On **[Audio Setup Page]**, you can set the following options:

[Digital Audio Setup] > [Digital Audio Setup Page] > [Digital Output]

Select audio formats supported by the connected device.

- **[Off]** – Turn off the digital output.
- **[All]** – If the connected device supports multi-channel audio formats, select this option.
- **[PCM Only]** – If the connected device cannot decode multichannel audio, select this option.

[Dolby Digital Setup] > [Dual Mono]

Select audio signals output to speakers.

- **[Stereo]** – Output multichannel sound signals to both speakers.
- **[L-Mono]** – Output left mono sound signals to both speakers.
- **[R-Mono]** – Output right mono sound signals to both speakers.

[3D] > [3D Processing Page] > [Reverb Mode]

Select a virtual surround sound mode.

[HDCD] > [HDCD Setup Page] > [Filter]

When you play a HDCD (High Definition Compatible Digital) disc, select the audio output cutoff frequency.

[Night Mode]

Make loud sound level softer and soft sound level louder so that you can watch the DVD movies at a low volume, without disturbing others.

- **[On]** – enjoy quiet viewing at night (DVDs only).
- **[Off]** – enjoy surround sound with its full dynamic range.

Video setup

On **[Video Setup Page]**, you can set the following options:

[Component]

Set the video output according to the video connection. If the composite connection is used, this setting is not required.

- **[S-Video]** – If the S-Video connection is used, select this option.
- **[Pr/Cr Pb/Cb Y]** – If the component connection is used, select this option.

[Picture Setting] > [Picture Setting Setup]

Customize picture color settings.

[TV Mode] (TV Mode)

Select the video output mode. To select the progressive scan mode, ensure that you have connected a progressive scan TV and set

[Component] to **[Pr/Cr Pb/Cb Y]**.

- **[Progressive]** – For progressive scan TV: turn on the progressive scan mode.
- **[Interlace]** – For ordinary TV: turn on the interlace mode.

Preference setup

On **[Preference Page]**, you can set the following options:

[TV Type]

Change this setting if the video does not appear correctly. By default, this setting matches the most common setting for TVs in your country.

- **[PAL]** – For TV with PAL color system.
- **[Auto]** – For TV that is compatible with both PAL and NTSC.
- **[NTSC]** – For TV with NTSC color system.

[Audio]

Select the preferred audio language for disc play.

[Subtitle]

Select the preferred subtitle language for disc play.

[Disc Menu]

Select the preferred disc menu language.



Note

- If the language you have set is not available on the disc, the disc uses its own default language.
- For some discs, the subtitle/audio language can only be changed from the disc menu.

[Parental]

Restricts access to discs that are unsuitable for children. These types of discs must be recorded with ratings.

Press **OK/▶II**.

Select a rating level, then press **OK/▶II**.

Press the numeric keys to enter the password.



Note

- Rated discs above the level you set in **[Parental]** require a password to be played.
- The ratings are country-dependent. To allow all discs to play, select **[8 Adult]**.
- Some discs have ratings printed on them but are not recorded with ratings. This function has no effect on such discs.



Tip

- You can set or change the password.

[Default]

Resets all the settings of this unit to factory default, except for the password and parental settings.

[Password Setup] > [Password Setup Page] > [Password Mode]

This setting allows you to enable/disable the password for parental control. If the password is enabled, when you play a prohibited disc, this 4-digit password is required.

- **[On]** - Enable the password for parental control.
- **[Off]** - Disable the password for parental control.

[Password Setup] > [Password Setup Page] > [Password]

You can change password here. The default password is 1234.

- **[Change]**

-
- 1) Press the numeric keys to enter '1234' or your last set password at **[Old Password]** field.
 - 2) Enter the new password at **[New Password]** field.
 - 3) Enter the new password again at **[Confirm PWD]** field.
 - 4) Press **OK/▶||** to exit the menu.
-

**Note**

- If you forget the password, enter '1234' before you set a new password.

7 Tune to FM radio stations

- 1 Ensure that you have connected and fully extended the supplied FM antenna.
 - 2 Press **TUNER**.
 - 3 Press and hold **◀◀▶▶**.
 - 4 When the frequency indication starts to change, release the button.
 - ↳ The FM tuner tunes to a station with strong reception automatically.
 - 5 Repeat steps 3-4 to tune to more stations.
- To tune to a weak station:**
Press **◀◀▶▶** repeatedly until you find optimal reception.

Program radio stations automatically

Note

- You can program a maximum of 20 preset radio stations.

- 1 Press **◀/▶** to select a preset number to start programing.
- 2 Press and hold **ANGLE/PROG** for 2 seconds to activate automatic programming.
 - ↳ **[AUTO]** (auto) is displayed briefly.
 - ↳ All available stations are programmed in the order of waveband reception strength.
 - ↳ The last programed radio station is broadcast automatically.

Program radio stations manually

Note

- You can program a maximum of 20 preset radio stations.

- 1 Tune to a radio station.
- 2 Press **ANGLE/PROG** to activate programming.
- 3 Press **◀/▶** to allocate a number from 1 to 20 to this radio station, then press **ANGLE/PROG** to confirm.
 - ↳ The preset number and the frequency of the preset station are displayed.
- 4 Repeat the above steps to program other stations.

Note

- To overwrite a programmed station, store another station in its place.

Tune to a preset radio station

- 1 Press **◀/▶** to select a preset number that you want.

Tip

- You can also use the numerical keypad to select a preset station directly.

8 Adjust volume level and sound effect

Adjust volume level

- 1 During play, press **VOL +/-** to increase/decrease the volume level.

Select a sound effect



Note

- You cannot use different sound effects at the same time.

Select a preset sound effect

- 1 During play, press **DSC** repeatedly to select:
 - **[ROCK]** (rock)
 - **[JAZZ]** (jazz)
 - **[POP]** (pop)
 - **[CLASSIC]** (classic)
 - **[FLAT]** (flat)

Enhance bass

- 1 To turn on bass enhancement, press **LOUDNESS/DBB** repeatedly during play until the DBB logo is displayed.
 - To turn off bass enhancement, press **LOUDNESS/DBB** repeatedly until the DBB logo disappears.

Select automatic loudness control

Automatic loudness control increases the treble and bass effect at low volume levels (the higher the volume, the lower the treble and bass levels).

- 1 To turn on automatic loudness control, press **LOUDNESS/DBB** during play until the loudness icon is displayed.
 - To turn off automatic loudness control, press **LOUDNESS/DBB** until the loudness icon disappears.

Mute sound

- 1 During play, press **MUTE** to mute/unmute sound.

Listen through headphone

- 1 Plug a headphone into the  socket on the unit.

9 Other features

Activate demonstration mode

You can see an overview of all features.

- 1 In standby mode, press **■** on the main unit to activate the demonstration mode.
 - ↳ A demonstration of major available features starts.

To deactivate the demonstration mode:

- 1 Press **■** on the main unit again.

Adjust brightness of display panel

- 1 In standby mode, press **MODE/DIM** repeatedly to select different levels of brightness for the display panel.

Set the alarm timer

- 1 Ensure that you have set the clock correctly.
- 2 In standby mode, press and hold **SLEEP/TIMER**.
 - ↳ The hour digits are displayed and begin to blink.
- 3 Press **+VOL -** to set the hour; then press **SLEEP/TIMER** again.
 - ↳ The minute digits are displayed and begin to blink.
- 4 Press **+VOL -** to set the minute.
- 5 Press **SLEEP/TIMER** to confirm.
 - ↳ **[OFF]** (off) begins to blink.
- 6 To activate the wake-up timer, press **+VOL -** to select **[ON]** (on) while **[OFF]** (off) is blinking.
 - ↳ A clock icon appears on the display.

- ↳ The unit turns on automatically at the set time and switches to the last selected source.
- ↳ To deactivate the alarm timer, select **[OFF]** (off) at step 6.

Set the sleep timer

- 1 When the unit is turned on, press **SLEEP/TIMER** repeatedly to select a set period of time (in minutes).
 - ↳ The unit turns off automatically after the set period of time.

Connect other devices

Listen to an audio player

You can listen to audio player with red/white audio output sockets through this unit.

- 1 Connect a red/white audio cable (not supplied) to the **AUX IN L/R** sockets and to the audio output sockets on the audio player.
- 2 Select the AUX source.
- 3 Start play on the audio player.

Record to a digital recorder

You can record audio from this unit to a digital recorder.

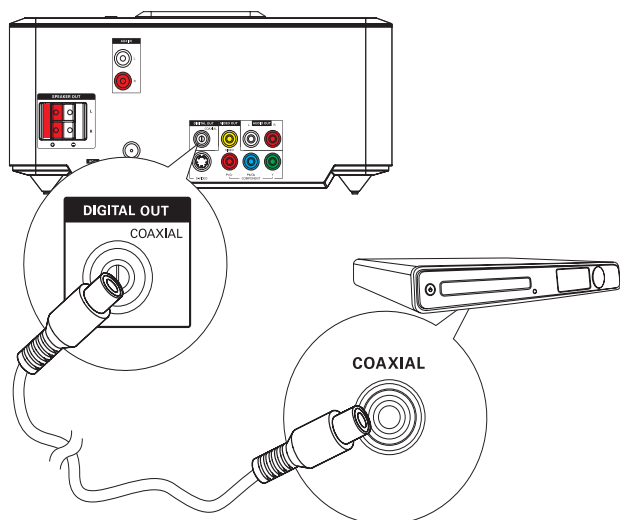

- 1 Connect a coaxial cable (not supplied) to:
 - the **COAXIAL** socket
 - the digital input socket on the digital recorder
- 2 Play audio to be recorded.
- 3 Begin to record on the digital recorder (see the digital recorder user manual).

10 Product information

Note

- Product information is subject to change without prior notice.

Specifications

Amplifier

Rated Output Power	2X50W RMS
Frequency Response	20 -20000 Hz, ± 3 dB
Signal to Noise Ratio	>65dB
Aux Input	500 mV RMS 20kohm

Disc

Laser Type	Semiconductor
Disc Diameter	12cm/8cm
Video Decoding	MPEG-1 / MPEG-2 / DivX
Video DAC	12Bits
Signal System	PAL / NTSC
Video Format	4:3 / 16:9
Video S/N	>48dB
Audio DAC	24Bits / 96kHz
Total Harmonic Distortion	<1% (1 kHz)
Frequency Response	4Hz - 20kHz (44.1kHz) 4Hz - 22kHz (48kHz) 4Hz - 24kHz (96kHz)
S/N Ratio	>65dBA

Tuner (FM)

Tuning Range	87.5 - 108MHz
Tuning grid	50KHz
Sensitivity - Mono, 26dB S/N Ratio	<22 dBf
Sensitivity - Stereo, 46dB S/N Ratio	>43 dBf
Search Selectivity	>28dBf
Total Harmonic Distortion	<3%
Signal to Noise Ratio	>55dB

Speakers

Speaker Impedance	2X4ohm
Speaker Driver, Base	5"
Speaker Driver, Tweeter	0.2"
Sensitivity	>80dB/m/W ± 4 dB/m/W

General information

AC power	220 V, 50 Hz
Operation Power Consumption	52W
Standby Power Consumption	<4W
Composite Video Output	1.0Vp-p, 75ohm
Coaxial Output	0.5Vpp \pm 0.1Vpp 75ohm
Headphone Output	2X15mW 32ohm
USB Direct	Version 2.0
Dimensions	
- Main Unit (W x H x D)	248 x 110 x 307mm
- Speaker Box (W x H x D)	170 x 270 x 220 mm
Weight	
- With Packing	11 kg
- Main Unit	2 kg
- Speaker Box	2 x 2.8 kg

Supported disc formats

- Digital Video Discs (DVDs)
- Video CDs (VCDs)
- SuperVideo CDs (SVCDs)
- Digital Video Discs + Rewritable (DVD+RW)
- Compact Discs (CDs)
- Picture (Kodak, JPEG) files on CDR(W)
- DivX(R) disc on CD-R(W):
- DivX 3.11, 4.x and 5.x
- WMA

Supported MP3-CD formats:

- ISO 9660
- Max. title/album name: 12 characters
- Max. title number plus album: 255.
- Max. nested directory: 8 levels.
- Max. album number: 32.
- Max. MP3 track number: 999.
- Supported sampling frequencies for MP3 disc: 32 kHz, 44.1 kHz, 48 kHz.
- Supported Bit-rates of MP3 disc are: 32, 64, 96, 128, 192, 256 (kbps).
- The following formats are not supported:
 - Files like *.VMA, *.AAC, *.DLF, *.M3U,
 - *.PLS, *.WAV
 - Non-English Album/Title name
 - Discs recorded in Joliet format
 - MP3 Pro and MP3 with ID3 tag

Supported formats:

- USB or memory file format FAT12, FAT16, FAT32 (sector size: 512 bytes)
- MP3 bit rate (data rate): 32-320 Kbps and variable bit rate
- WMA v9 or earlier
- Directory nesting up to a maximum of 8 levels
- Number of albums/ folders: maximum 99
- Number of tracks/titles: maximum 999
- ID3 tag v2.0 or later
- File name in Unicode UTF8 (maximum length: 128 bytes)

Unsupported formats:

- Empty albums: an empty album is an album that does not contain MP3/ WMA files, and is not be shown in the display.
- Unsupported file formats are skipped. For example, Word documents (.doc) or MP3 files with extension .dlf are ignored and not played.
- AAC, WAV, PCM audio files
- DRM protected WMA files (.wav, .m4a, .m4p, .mp4, .aac)
- WMA files in Lossless format

USB playability information

Compatible USB devices:

- USB flash memory (USB 2.0 or USB1.1)
- USB flash players (USB 2.0 or USB1.1)
- memory cards (requires an additional card reader to work with this apparatus)

11 Troubleshooting



Caution

- Never remove the casing of this unit.

To keep the warranty valid, never try to repair the system yourself.

If you encounter problems when using this unit, check the following points before requesting service. If the problem remains unsolved, go to the Philips web site (www.Philips.com/support). When you contact Philips, ensure that your unit is nearby and the model number and serial number are available.

No power

- Ensure that the AC cord of the apparatus is connected properly.
- Ensure that there is power at the AC outlet.
- As a power-saving feature, the system switches off automatically 15 minutes after track play reaches the end and no control is operated.

No disc detected

- Insert a disc.
- Check if the disc is inserted upside down.
- Wait until the moisture condensation at the lens has cleared.
- Replace or clean the disc.
- Use a finalized CD or correct format disc.

No picture

- Check the video connection.
- Turn on the TV to the correct Video-In channel.
- Progressive scan is activated but the TV does not support progressive scan.

Black and white or distorted picture

- The disc does not match the TV color system standard (PAL/NTSC).
- Sometimes a slight picture distortion may appear. This is not a malfunction.
- Clean the disc.

- A distorted picture may appear during progressive scan setup.

The aspect ratio of the TV screen cannot be changed even though you have set the TV display format.

- The aspect ratio is fixed on the loaded DVD disc.
- The aspect ratio may not be changed for some TV systems.

No sound or poor sound

- Adjust the volume.
- Disconnect the headphones.
- Check that the speakers are connected correctly.
- Check if the stripped speaker wires are clamped.

Remote control does not work

- Before you press any function button, first select the correct source with the remote control instead of the main unit.
- Reduce the distance between the remote control and the unit.
- Insert the battery with its polarities (+/- signs) aligned as indicated.
- Replace the battery.
- Aim the remote control directly at the sensor on the front of the unit.

Disc does not play

- Insert a readable disc and ensure that the label side faces up.
- Check the disc type, color system and regional code. Check for any scratches or smudges on the disc.
- Press **SYSTEM MENU** to exit the system setup menu.
- Disable the password for parental control or change the rating level.
- Moisture has condensed inside the system. Remove the disc and leave the system turned on for about an hour. Disconnect and reconnect the AC power plug, and then turn on the system again.
- As a power-saving feature, the system turns off automatically 15 minutes after disc play reaches the end and no control is operated.

Poor radio reception

- Increase the distance between the unit and your TV or VCR.
- Fully extend the FM antenna.
- Connect an outdoor FM antenna instead.

Unable to select Progressive Scan

- Ensure the video output mode is set to [Pr/Cr Pb/Cb Y].

Audio or subtitle languages cannot be set

- The disc is not recorded with sound or subtitles in multiple languages.
- The audio or subtitle language setting is prohibited on the disc.

Cannot display some files in USB device

- The number of folders or files in the USB device has exceeded a certain limit. This phenomenon is not a malfunction.
- The formats of these files are not supported.

USB device not supported

The USB device is incompatible with the unit. Try another one.

Timer does not work

- Set the clock correctly.
- Switch on the timer.

Clock/timer setting erased

- Power has been interrupted or the power cord has been disconnected.
- Reset the clock/timer.

部件名称 Name of the Parts	有毒有害物质或元素 Hazardous/toxic Substance					
	铅 (Pb, Lead)	汞 (Hg, Mercury)	镉 (Cd, cadmium)	六价铬 (Chromium 6+)	多溴联苯 (PBB)	多溴二苯醚 (PBDE)
Housing 外壳	○	○	○	○	○	○
DVD/CD loader DVD/CD 光盒	X	○	○	○	○	○
VFD Panel VFD面板	X	X	○	○	○	○
Loudspeakers 喇叭单元	○	○	○	○	○	○
PWBs 电路板组件	X	○	○	○	○	○
Accessories (Remote control & cables) 附件 (遥控器, 电 源线, 连接线)	X	○	○	○	○	○
Batteries in Remote Control (ZnC) 遥控器电池	X	○	○	○	○	○

○：表示该有毒有害物质在该部件所有均质材料中的含量均在SJ/T11363 - 2006 标准规定的限量要求以下。

○: Indicates that this toxic or hazardous substance contained in all of the homogeneous materials for this part is below the limit requirement in SJ/T11363 – 2006.

×：表示该有毒有害物质至少在该部件的某一均质材料中的含量超出SJ/T11363 – 2006 标准规定的限量要求。

X: Indicates that this toxic or hazardous substance contained in at least one of the homogeneous materials used for this part is above the limit requirement in SJ/T11363 - 2006.



环保使用期限 Environmental Protection Use Period

This logo refers to the period (10 years)

电子信息产品中含有的有毒有害物质或元素在正常使用的条件下不会发生外泄或突变，电子信息产品用户使用该电子信息产品不会对环境造成严重污染或对其人身、财产造成严重 损害的期限。

This logo refers to the period (10 years) during which the toxic or hazardous substances or elements contained in electronic information products will not leak or mutate so that the use of these [substances or elements] will not result in any severe environmental pollution, any bodily injury or damage to any assets.

