

Always there to help you

Register your product and get support at

www.philips.com/welcome

HMP7100

Question?
Contact
Philips



User manual

PHILIPS

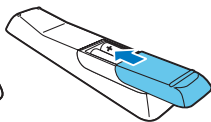
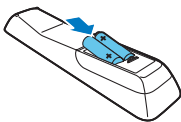
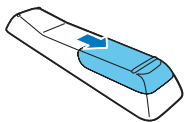
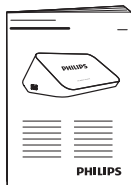
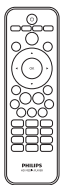



Switch on

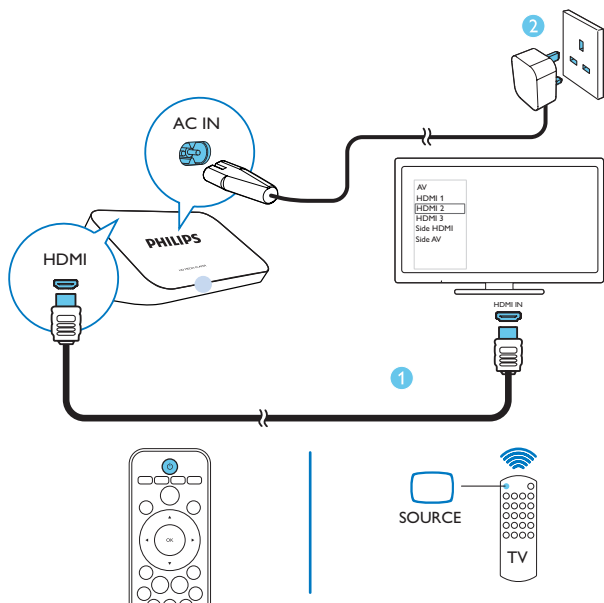

Press to switch on. The power indicator lights up white.
Press again to switch off. The power indicator lights up red.

On the remote control of the TV, use the source button to select the HDMI input connector of **HMP7100**.



Setup: Connect to your home network

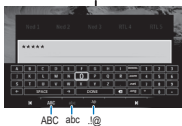
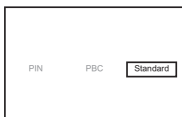
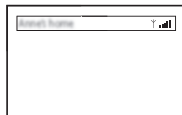
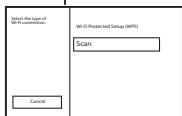
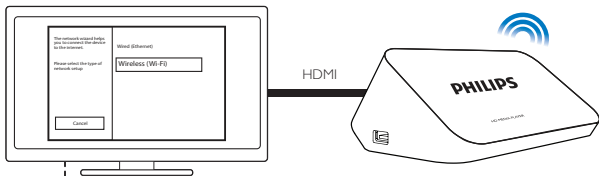

Connect through Wi-Fi

On the screen of initial setup, select **[Wireless (Wi-Fi)]**. Select **[Scan]** to search for networks in range. Select a network. Follow onscreen instructions to complete Wi-Fi connection.

- If you select **[Standard]**, enter the password to your network. On the remote control, press **◀▶** to select an input mode. To enter text, press **▲▼◀▶OK** to select a key on the onscreen keyboard. To complete text entry, select **DONE** on the onscreen keyboard.





Setup: Connect to your home network

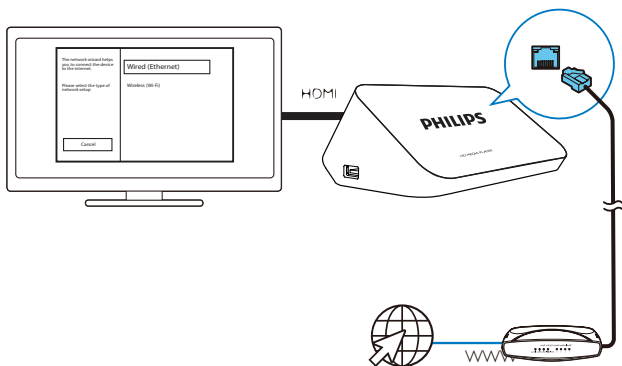

Connect through an Ethernet cable

On the screen of initial setup, select **Wired (Ethernet)**.



SmartTV: Play from online services

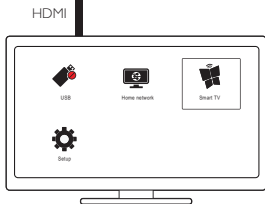
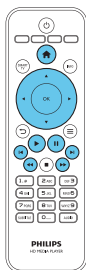

Next time you switch on **HMP7100, HMP7100** connects to the previously connected network. On the Home screen, changes to . Select .



Play from a USB storage device

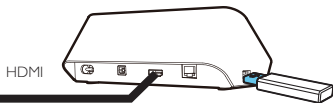
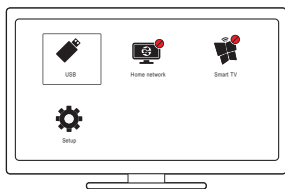

From the Home screen, select .

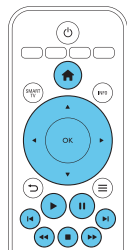



Play from a PC

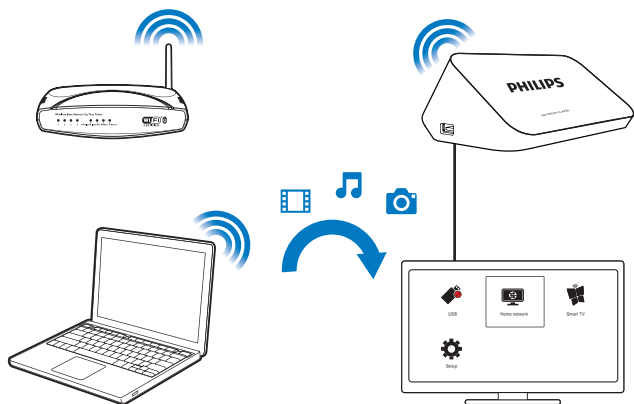

PC that runs the software of
DLNA media server

- 1 Connect your PC to the same network as **HMP7100**.
- 2 On **HMP7100**, select .



SimplyShare: Play from an iOS or Philips Android device

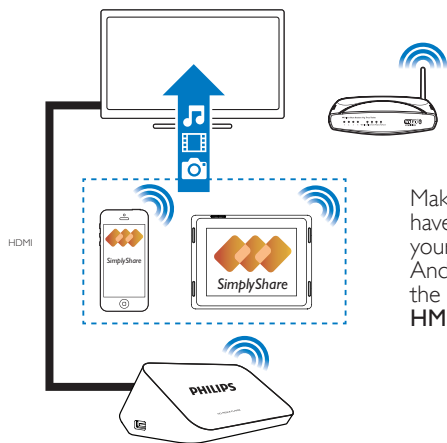

Make sure that you have connected your iOS or Philips Android device to the same network as **HMP7100**.

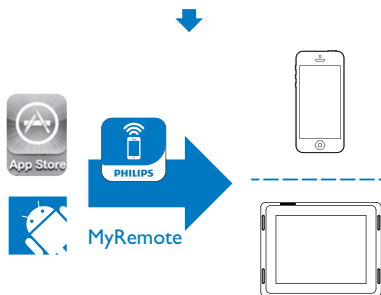

From **App Store** or **Google Play**, download the Philips **MyRemote** app to your device.



SimplyShare: Play from an iOS or Philips Android device



In **MyRemote**, select **SimplyShare**. Select the source of media, and then, select a media file to start play.



To use your iOS or Android device as remote control, select **Control**.

Contents

1 Trademark notice	11
---------------------------	----

2 Safety and notice	12
Safety	12
Compliance	14
Copyright	15
Care of the environment	15
Warranty	16

3 Basics	17
Connect	17
Switch on or off	17
Use the remote control	19
Enter text	20

4 First-time setup	21
Connect to your home network	21

5 Play	25
Play from online services	25
Play from your home network	27
Play from a USB storage device	31

6 Setup	33
Video	34
Audio	34
Network	35
Preference	35
Advanced	35

7 EasyLink	36
-------------------	----

8 Update the firmware of HMP7100	37
Update the firmware online	37
Update the firmware through a USB storage device	38

9 Troubleshooting	39
--------------------------	----

10 Specification	40
-------------------------	----

11 Written Offer	41
-------------------------	----

1 Trademark notice



The terms HDMI and HDMI High-Definition Multimedia Interface, and the HDMI Logo are trademarks or registered trademarks of HDMI Licensing LLC in the United States and other countries.



DivX®, DivX Certified®, DivX Plus® HD and associated logos are trademarks of Rovi Corporation or its subsidiaries and are used under license.

ABOUT DIVX PLUS® HD: DivX® is a digital video format created by DivX, Inc. This is an official DivX Certified® device that plays DivX video, including DivX® Plus HD video (H.264/MKV) up to 1080p and premium content. Visit www.divx.com for more information and software tools to convert your files into DivX video.

ABOUT DIVX VIDEO: DivX® is a digital video format created by DivX, LLC, a subsidiary of Rovi Corporation. This is an official DivX Certified® device that plays DivX video. Visit divx.com for more information and software tools to convert your files into DivX videos.

ABOUT DIVX VIDEO-ON-DEMAND: This DivX Certified® device must be registered in order to play purchased DivX Video-on-Demand (VOD) movies. To obtain your registration code, locate the DivX VOD section in your device setup menu. Go to vod.divx.com for more information on how to complete your registration.



Manufactured under license from Dolby Laboratories.
Dolby and the double-D symbol are trademarks of Dolby Laboratories.



Manufactured under license under U.S. Patent Nos: 5,956,674; 5,974,380; 6,487,535 & other U.S. and worldwide patents issued & pending. DTS, the Symbol, & DTS and the Symbol together are registered trademarks & DTS 2.0+Digital Out is a trademark of DTS, Inc. Product includes software. © DTS, Inc. All Rights Reserved.

2 Safety and notice

Read and understand all instructions before you use this product. If damage is caused by failure to follow the instructions, the warranty does not apply.

Safety

Important notes for users in the U.K.

Mains fuse

This information applies only to products with a UK mains plug.

This product is fitted with an approved non-molded plug. If you replace the fuse, use one with:

- the ratings shown on the plug,
- a BS 1362 approval, and
- the ASTA approval mark.

Contact your dealer if you are not sure about what type of fuse to use.

Caution: To conform with the EMC directive (2004/108/EC), do not detach the plug from the power cord.

How to connect a plug

The wires in the power cord are colored as follows: blue = neutral (N), brown = live (L).

If the colors do not correspond with the colors on your plug, identify the terminals in your plug as follows:

- 1 Connect the blue wire to the terminal marked N or colored black.
- 2 Connect the brown wire to the terminal marked L or colored red.
- 3 Do not connect either wire to the earth terminal in the plug, marked E (or e) or colored green (or green and yellow).

Before you replace the plug cover, make sure that the cord grip is clamped over the sheath of the cable and not just over the two wires in the cable.



This 'bolt of lightning' indicates uninsulated material within the device may cause an electrical shock. For the safety of everyone in your household, please do not remove the covering.



The 'exclamation mark' calls attention to features for which you should read the enclosed literature closely to prevent operating and maintenance problems.

WARNING: To reduce the risk of fire or electric shock, the device should not be exposed to rain or moisture and objects filled with liquids, such as vases, should not be placed on the device.

CAUTION: To prevent electric shock, fully insert the plug. (For regions with polarized plugs: To prevent electric shock, match wide blade to wide slot.)

- Only use attachments/accessories specified by the manufacturer.
- Use only power supplies listed in the user manual.
- The product shall not be exposed to dripping or splashing.
- Do not place any sources of danger on the product (e.g. liquid filled objects, lighted candles).
- Batteries (battery pack or batteries installed) shall not be exposed to excessive heat such as sunshine, fire or the like.
- Danger of explosion if battery is incorrectly replaced. Replace only with the same or equivalent type.

Modification of the product could result in hazardous radiation of EMC or other unsafe operation.



Warning

- Never remove the casing of this product.
- Never lubricate any part of this product.
- Never place this product on other electrical equipment.
- Keep this product away from direct sunlight, naked flames or heat.
- Ensure that you always have easy access to the power cord, plug or adaptor to disconnect the product from the power.
- Where the mains plug or an appliance coupler is used as the disconnect device, the disconnect device shall remain readily operable.

Compliance



This product complies with the radio interference requirements of the European Community.

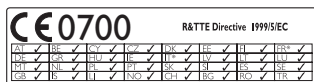

This product complies with the requirement of the 1999/5/EC directive.

Class II equipment symbol:



CLASS II apparatus with double insulation, and no protective earth provided.

Any changes or modifications made to this product that are not expressly approved by Philips Consumer Lifestyle may void the user's authority to operate the equipment.



- The type plate is located on the bottom of the product.

Copyright



Be responsible
Respect copyrights

This item incorporates copy protection technology that is protected by U.S. patents and other intellectual property rights of Rovi Corporation. Reverse engineering and disassembly are prohibited.

Copyright in the U.K.

- Recording and playback of material may require consent. See Copyright Act 1956 and The Performer's Protection Acts 1958 to 1972.

Specifications are subject to change without notice. Trademarks are the property of Koninklijke Philips Electronics N.V or their respective owners. Philips reserves the right to change products at any time without being obliged to adjust earlier supplies accordingly.

Care of the environment

Environmental information

All unnecessary packaging has been omitted. We have tried to make the packaging easy to separate into three materials: cardboard (box), polystyrene foam (buffer) and polyethylene (bags, protective foam sheet.)

Your system consists of materials which can be recycled and reused if disassembled by a specialized company. Please observe the local regulations regarding the disposal of packaging materials, and old equipment.



Your product is designed and manufactured with high quality materials and components, which can be recycled and reused.



When this crossed-out wheeled bin symbol is attached to a product it means that the product is covered by the European Directive 2002/96/EC.

Please inform yourself about the local separate collection system for electrical and electronic products.

Please act according to your local rules and do not dispose of your old products with your normal household waste. Correct disposal of your old product helps to prevent potential negative consequences for the environment and human health.



Your product contains batteries covered by the European Directive 2006/66/EC, which cannot be disposed with normal household waste. Please inform yourself about the local rules on separate collection of batteries because correct disposal helps to prevent negative consequences for the environmental and human health.

Warranty

- Never attempt to repair the product, this could lead to the risk of injury, damage to the product and will void your warranty.
- Use the product and accessories only as intended by the manufacturer. The caution sign printed on the back of the product indicates risk of electric shock.
- Never remove the cover of the product. Always contact Philips Customer Support for service or repairs.
- Any operation expressly prohibited in this manual, or any adjustments and assembly procedures not recommended or authorized in this manual shall void the warranty.

3 Basics

Connect

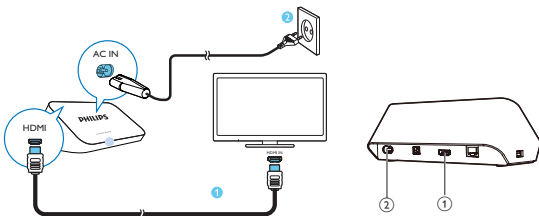

- ① **HDMI connector for audio/ video output**
 - Connects to a high-definition TV (HDTV) through an HDMI cable
- ② **Power connector**
 - Connects to power supply through the AC power cord

For high quality audio

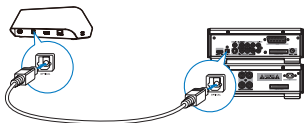

- Through **OPTICAL**, use a fiber optical cable to connect **HMP7100** to the **OPTICAL** or **SPDIF** input connector on an audio/video system.

Switch on or off

- 1 On **HMP7100**, press  on the remote control to switch on.
↳ The power indicator lights up white.



- 2 On the TV, switch to the input source of **HMP7100**:
- On the remote control of your TV, use the source button to select the input connector of **HMP7100**.

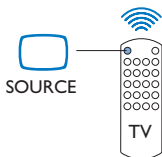
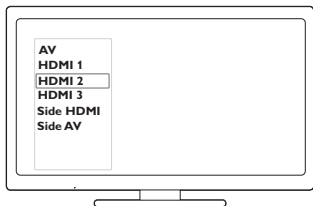

- 3 To switch **HMP7100** to standby mode, press  again on the remote control.
↳ The power indicator lights up red.

Auto standby

From the Home screen, switch on **[Auto standby]** in *** [Setup] > [Preference]**. If there is no button press or media play on **HMP7100** for 30 minutes, **HMP7100** switches to standby mode automatically.

Screen saver

From the Home screen, go to *** [Setup] > [Preference]** to switch on **[Screen saver]**.

If there is no button press or media play on **HMP7100** for 10 minutes, the screen saver is activated. To exit the screen saver, press any button on the remote control.

Use the remote control

Switch HMP7100 on or to standby mode

- Press 

Navigate between screens or through options



- Return to the Home screen



- Navigate through options

OK

- Confirm the option



- Back one level

View options menu for media play or file navigation

- Press 

Connect to online TV services

- Press **SMART TV** to go to the **SMART TV** portal

Color buttons (Red, Green, Yellow, Blue)

- Functional buttons in the **SMART TV** portal

Enter text or numbers

- Press the alphanumeric buttons repeatedly to enter numbers or letters
- Alternatively, press the text box to show the onscreen keyboard

Control the play



- Start or resume the play



- Pause the play



- Stop the play



- Skip to the previous/ next media file



- Press repeatedly to select a search speed



- Rotate a photo

INFO

- Display the information about current file during play

SUBTITLE

- Access subtitle options

AUDIO

- Access the options of audio languages
- Access the options of audio tracks

Enter text

Use the onscreen keyboard

With the onscreen keyboard, use the remote control to enter text.



Select input modes

- Press **◀** / **▶** on the remote control.
↳ On the onscreen keyboard, current input mode is highlighted.

ABC : English input in the upper case

abc : English input in the lower case

E@ : symbols

Enter text

- 1 On the remote control, press **▲**, **▼**, **◀**, **▶** to move to a key, press **OK** to select the letter or symbol.
- 2 On the onscreen keyboard, select the input options by using the remote control:
← / **→** : Move the cursor to the left or right.
<X> : Delete the entry before the cursor.
- 3 When the text entry is complete, select **DONE** on the onscreen keyboard to exit.



Tip

- To use the onscreen keyboard of different languages, go to [Setup] > [Preference] > [Keyboard layout] from the Home screen. You can select a language for the onscreen keyboard.

Use the alphanumeric buttons

- On the remote control, press the alphanumeric buttons repeatedly to enter text or numbers.

4 First-time setup

The first time you use **HMP7100**, do the following setup:

- Select the menu language on **HMP7100**;
- Select your country for the **SMART TV** portal;
- Connect **HMP7100** to your home network through Wi-Fi or an Ethernet cable.

To change your setup options,

- From the Home screen, go to [Setup].

Connect to your home network

Connect **HMP7100** to a router (Access Point) wirelessly or through an Ethernet cable. You can connect **HMP7100** to the network that is built around the router. To connect to the Internet, make sure that the router connects to the Internet directly and no dial-up is required on the computer.



Note

- If MAC address filtering is enabled on your router, add the MAC address of **HMP7100** to the list of allowed devices. To find the MAC address, go to > **[Advanced]** > **[Version information]** from the Home screen.

Connect wirelessly

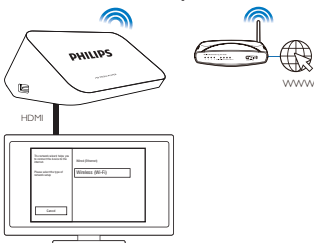

- 1 The first time you connect **HMP7100** to power, select **[Wireless (Wi-Fi)]** on the first-time setup page.
 - ↳ A pop-up screen is displayed for you to select connection options.
- 2 On the pop-up screen, select **[Scan]**.
 - ↳ You can find a list of networks in range.
 - To refresh the list of networks, select **[Rescan]**.
 - To manually enter the name and password of the network, select **[Manual entry]**.
- 3 Select your network.
- 4 Select your connection option: **PIN**, **PBC**, or **[Standard]**.
 - ↳ A message is displayed when the connection is complete.
 - ↳ Next time you switch on **HMP7100**, **HMP7100** connects to the previously connected network automatically.
 - ↳ When **HMP7100** is connected to Wi-Fi, changes to and changes to on the Home screen.

One-touch Wi-Fi Protected Setup (WPS)

HMP7100 supports Wi-Fi Protected Setup(WPS). You can quickly and securely connect **HMP7100** to a wireless router that also supports the WPS. You can select one of the two setup methods: **PBC (Push Button Configuration)**, or **PIN (Personal Identification Number)**.



Tip

- Wi-Fi Protected Setup(WPS) is a standard created by Wi-Fi Alliance for easy establishment of secure wireless home network.

PBC

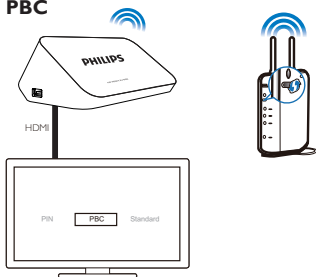

- 1 On the router, add **HMP7100**:
 - Consult the user manual of the router to learn how to add a WPS device to the router. For example:
press and hold the WPS push button.
↳ The router starts to search for **HMP7100**.
- 2 On **HMP7100**, select **PBC**.
 - ↳ On **HMP7100**, a message is displayed when the connection is complete.

PIN

- 1 Write down the PIN that is displayed on **HMP7100**.
- 2 On your PC, enter the PIN on the router setup page:
 - Consult the user manual of the router to learn how to enter the PIN of the router.
- 3 On **HMP7100**, select **PIN**.

Standard connection

- 1 On **HMP7100**, select **[Standard]**.
- 2 On the pop-up screen, enter the password to the network (see 'Enter text' on page 13).

Use an IP address that the router assigns automatically

- Select **[Auto (recommended)]**.
 - ↳ **HMP7100** starts to acquire an IP address.
 - ↳ A message is displayed when the connection is complete.



Tip

- If the DHCP (Dynamic Host Configuration Protocol) is unavailable or disabled on the router, manually enter the IP address of the player.

Enter the IP address manually

- 1 Get the IP address of the router:
 - Consult the user manual of the router; or
 - To check for the settings of the router, enter the IP address (for example, 192.168.1.1) in the web browser (for example, Internet Explorer) of the computer. Get the information in the setup page.
- 2 On **HMP7100**, select **[Manual (advanced)]**, and assign the IP address manually:
 - On the player, enter an IP address that allows the player to be in the same subnet as the router.
For example, if the router has
IP address: 192.168.1.1, Subnet mask: 255.255.255.000;
Then, enter the following on the player:
IP address: 192.168.1.XX (where XX denotes a number), Subnet mask:
255.255.255.000.
 - On the remote control, press ◀▶ to select the entry location; Press ▲ ▼ repeatedly to enter digits.

Connect through an Ethernet cable

- 1 Use an Ethernet cable to connect **HMP7100** to the router.

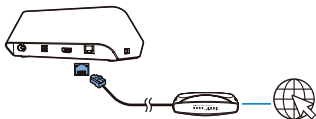

- 2 The first time you connect **HMP7100** to power, select **[Wired (Ethernet)]** on the first-time setup page.
↳ A pop-up screen is displayed for you to select connection options.
- 3 Select **[Auto (recommended)]** or **[Manual (advanced)]** to use auto IP or enter the IP address manually.
 - Refer to the standard wireless connection (see 'Standard connection' on page 17).

5 Play

On the HDTV, enjoy media play from

- the online services (through the **SMART TV** portal),
- a DLNA-compliant device on your home network, or
- a USB mass storage device.

Play from online services

Connect **HMP7100** to the Internet. You can enjoy online services on the HDTV.

Note

- Koninklijke Philips Electronics N.V. bears no responsibility for content provided by online service providers.

Play from the Smart TV portal

From the **SMART TV** portal, you can do the following:

- Access online services;
- Download apps from **App Gallery**;
- Browse Web pages through the web browser.

- 1** From the Home screen, go to .
↳ The **SMART TV** portal is displayed.

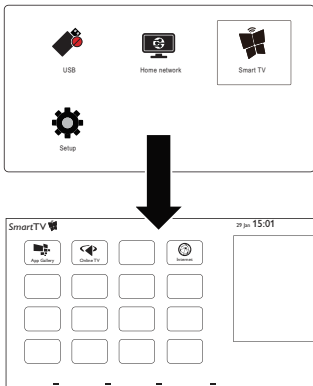

- 2** To navigate on the portal,
- press **▲**, **▼**, **◀**, **▶** and **OK** to select options;
 - press **↶** to go back one level;
 - press **🏠** to go to the Home screen.
- 3** To remove, move or lock apps on the portal,
- use the color buttons on the remote control as instructed at the base of the screen.

Set parental control to apps

In the **SMART TV** portal, you can do the following to lock apps:

- use the color buttons on the remote control as instructed at the base of the screen;
- The first time you launch the **SMART TV** portal, follow the onscreen instructions to set password to the apps with the rating of 18+.

Play from your home network

Connect HMP7100 to your home network through Wi-Fi or an Ethernet cable (see 'First-time setup' on page 15).

With **HMP7100**, you can play media from a DLNA-compliant device on the same network. In this way, you can enjoy the media play through the HDTV that you connect to **HMP7100**.

The DLNA-compliant device can be:

- an iOS device or Philips Android device that runs  **MyRemote**, such as iPhone, iPod touch, iPad, and Philips Android tablet;
- a computer or device that runs the software of DLNA media server, such as Windows Media Player 11 or later.

Play media from an iOS device or Philips Android device

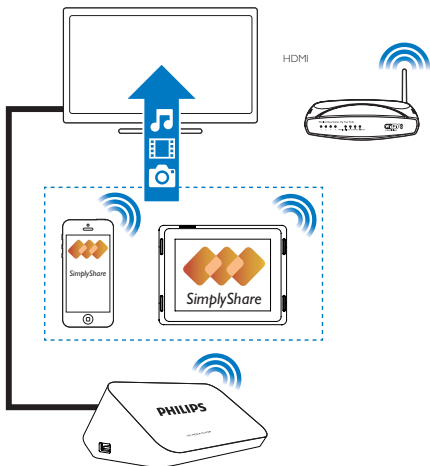

- 1 Make sure that you have connected your iOS device or Philips Android device to the same Wi-Fi network as **HMP7100**.

- 2 On your iOS device or Philips Android device, download  **MyRemote** from **App Store** or **Google Play**.
- 3 In  **MyRemote**, tap to select **SimplyShare**.

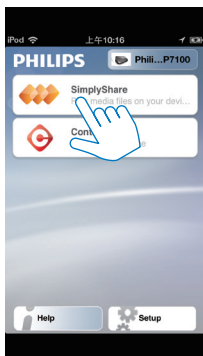

- 4 Select the source of media:
 - Select a connected device on your home network.

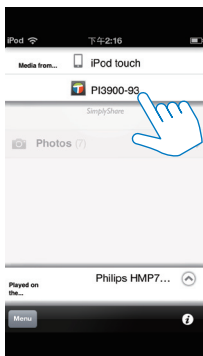

- ↳ You can find the music, photos, and videos that you store under the following folders on your Philips Android device: **Music**, **Pictures**, and **Videos**.
- ↳ You can also find the photos and videos that you take or record on the device.

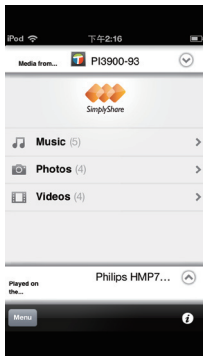

5 Select a media file to start play.

Use the iOS or Android device as remote control

With your iOS or Android device, you can control the media play on **HMP7100**.

1 In  **MyRemote**, select **Control**.

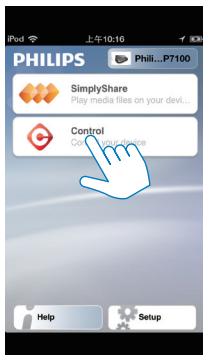



↳ The remote control buttons are displayed

2 Swipe left/ right to move to other pages of buttons.

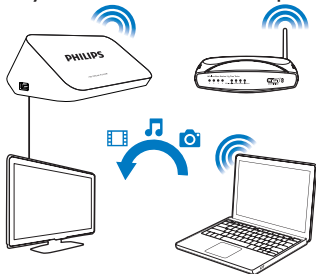

Play media files from a computer (DLNA)









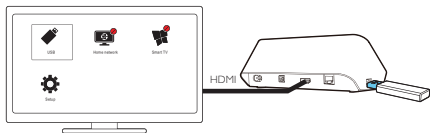

- 1 Make sure that you have connected **HMP7100** and the PC to the same network.
 - Make sure that the UPnP (Universal Play and Plug) function is enabled on the router.
- 2 On the PC, launch the software of DLNA media server. Enable the media sharing function.
For example, in Windows Media Player 11, do the following:
 - ① Select **Library > Media Sharing ...**
 - ② Select the check box next to **Share my media to:**
 - ↳ If **HMP7100** is detected, you can find the name of **HMP7100** in the device list.
 - ③ If necessary, select the player and click **Allow**.
- 3 On the Home screen of **HMP7100**, select 
 - Find media files on the servers.
- 4 Use the remote control to search for and play media files on **HMP7100**.





Play from a USB storage device

Through the HDTV, play media from a USB mass storage device that you connect to **HMP7100**.



- 1 Connect your USB mass storage device to  on **HMP7100**.
 - ↳ When the USB device is recognized by **HMP7100**,  changes to  on the Home screen.
- 2 Select .
 - ↳ Media files are sorted as follows:
 - : Display all the file folders.
 - : Display music files
 - : Display video files
 - : Display photo files
- 3 Select a file to start play.
 - To play DivX videos on this player, rent or purchase the DivX videos by using the DivX® registration code of this player. Go to  [Setup] > [Advanced] > [DivX® VOD Code] to get the code.
 - To use a separate subtitle file for DivX video play, do the following:
 - ① Name the subtitle file in the same way as you do with the DivX video file, with file extension names unchanged.
 - ② Save the subtitle file under the same directory as the DivX video file on the mass storage device.

Select play options

- 1 During play, press  **OPTIONS** on the remote control.
- 2 Press     to select an option. Press **OK** to confirm.

For videos,

[Info]: Display file information.

[Audio language]: Select an audio language.

[Subtitle language]: Select a subtitle language.

[Subtitle shift] (for DivX files with embedded subtitles): Manually change the position of subtitles on the TV screen.

[Titles]: Search within the video by title.

[Chapters]: Search within the video by chapter.

[Time search]: Search within the video by elapsed time.

[Zoom]: Zoom in the scene. Press ◀▶ to select your zoom options. To pan through the enlarged scene, press ▲, ▼, ◀▶.

[Repeat] > [File]: Repeat current file.

[Repeat] > [Folder]: Repeat all the files in current folder.

[Repeat] > [Off]: Switch off the repeat mode.

[Repeat A-B]: Repeat the selected section. During video play, select [Repeat A-B] at the start point A, and then, select [Repeat A-B] again at the end point B. The selected section start to play repeatedly.

[Picture settings]: Select color settings for the video display.

[Edition] (for Divx Plus HD files with different timelines): Select another timeline.

For photo slideshow,

[Info]: Display file information.

[Rotate +90]: Rotate the photo clockwise by 90 degrees.

[Rotate -90]: Rotate the photo counter-clockwise by 90 degrees.

[Zoom]: Zoom in the scene. Press ◀▶ to select your zoom options. To pan through the enlarged scene, press ▲, ▼, ◀▶.

[Duration per slide]: Select the play speed of photo slideshow.

[Slide animation]: Select the transition effects between photos.

[Picture settings]: Select color settings for the images.

[Repeat] > [Off]: Switch off the repeat mode.

[Repeat] > [Folder]: Repeat all the files in current folder.

For music,

During music play, press ≡ OPTIONS repeatedly to select play options:

🔄: Repeat current file.

🔄📁: Repeat all the files in current folder.

🔄🔀: Play all the files in random order.

6 Setup

You can change the setup options of HMP7100.

- 1 On the Home screen, select *** [Setup]**.
 - If necessary, press **⬆** on the remote control to go to the Home screen.
↳ The setup menu is displayed.
- 2 Press **▲, ▼, ◀, ▶** to select an option. Press **OK** to confirm the option.
 - Press **↶** to return to the upper-level menu.

Video

[TV display]: Select display aspect ratio

***[HDMI video]**: Select the video resolution that your TV supports. See your TV manual for details.

[HDMI Deep Color]: Display colors with more shades and hues when the video content is recorded in Deep Color mode and the TV supports this feature.

[Picture settings]: Select color settings for the video display.

[Watch 3D video]: Set the HDMI video output to 3D or 2D.



Note

- *If the video resolution is incompatible with your TV, you can see a blank screen. To recover the display, wait for 10 seconds.

Audio

[Night mode]: Equalize loud and soft sounds to play media at night (for Dolby Digital-encoded files).

[HDMI audio]: Select audio output for the HDMI connector.

[Digital audio]: Select audio output for the **OPTICAL** connector.

[PCM downsampling]: Set the sampling rate of the PCM audio from the **OPTICAL** connector.

Network

- In [Network installation], connect **HMP7100** to your home network.
[Wired (Ethernet)]: Connect to the network through an Ethernet cable.
[Wireless (Wi-Fi)]: Connect to a Wi-Fi network.
- In [View network settings], find the information about current network , such as the MAC address, and current IP address and subnet mask.
- In [View wireless settings], find the status of current Wi-Fi network.
- In [Clear Smart TV memory], clear the temporary files from the web browser of **SMART TV**.
- In [Name your Product:], edit how **HMP7100** is discovered by name in your home network.

Preference

[Menu language]: Select the language for onscreen menus.

[Keyboard layout]: Select the standard keyboard for the language that you use to enter text.

[Audio]: Select the audio language for videos.

[Subtitle]: Select the language for video subtitles.

[Screen saver]: Enable the screen saver when **HMP7100** is in the idle mode for 10 minutes, for example, in pause or stop mode. To exit the screen saver mode, press any key.

[Auto subtitle shift]: Allow to relocate the subtitles automatically on TVs that support the function. To manually relocate subtitles, select options on the video play screen (see 'Select play options' on page 27).

[Auto standby]: Switch **HMP7100** to standby mode when there is no button press or media play on **HMP7100** for 30 minutes.

[Fast wake up]: Start up **HMP7100** after a short time duration.

Advanced

[Downmix mode]: Select options for the two-channel audio output.

[DivX® VOD Code]: Find the DivX® Video-on-Demand code of **HMP7100** to register with DivX®.

[Netflix ESN]: Find the Electronic Serial Number (ESN) of **HMP7100** to register with Netflix.

[Deactivation]: Deactivate online services.

[Version information]: Find the information about the product, such as product name, software version, MAC address, **SimplyShare** activation code, and support site.

[Restore default settings]: Restore factory settings.

7 EasyLink

HMP7100 supports Philips EasyLink which uses the HDMI CEC (Consumer Electronics Control) protocol. You can use a single remote control to control EasyLink compliant devices that are connected through HDMI.

- 1 Through HDMI, connect **HMP7100** to a TV compliant with the HDMI CEC protocol.
- 2 On the TV, switch on the functions to allow HDMI CEC operations (Consult the user manual of the TV).
- 3 On **HMP7100**, switch on **[EasyLink]**.
 - On the Home screen, select **⚙ [Setup] > [EasyLink]**. Select **[On]**.
- 4 In **[EasyLink]**, you can select the following options:

[One Touch Play]

When you start play on **HMP7100**, the TV switches to the HDMI input channel automatically.

[One Touch Standby]

When you switch the TV to the standby mode, **HMP7100** switches to the standby mode automatically.



Note

- Philips does not guarantee 100% interoperability with all HDMI CEC devices.

8 Update the firmware of HMP7100

From the Home screen, go to . In the **SMART TV** portal, you can register with Club Philips. By doing so, you can get information about the product and software updates.

Before you update the firmware, check current the firmware version of **HMP7100**. Go to [Setup] > [Advanced] > [Version information].

Update the firmware online

- 1 Connect **HMP7100** to the Internet.
- 2 On the Home screen of **HMP7100**, go to > [Advanced]. Select [Software update] > [Network].
 - ↳ If a firmware update is detected, you are prompted to start the update.
- 3 Follow onscreen instructions to complete the update.
 - ↳ When the update is complete, **HMP7100** switches off automatically, and then switches on again.



Note

- Keep **HMP7100** powered on before the firmware update is complete.

Update the firmware through a USB storage device

- 1 On your computer, do the following:
 - ① Go to www.philips.com/support to find the latest firmware.
 - ② Search for your model and click on "Software and drivers".
 - ③ Download the firmware update.
 - ④ Under the root directory of a USB storage device, create a folder and name it as UPG_ALL. Save the firmware update file to the folder.

- 2 On **HMP7100**, do the following:
 - ① Connect the USB storage device.
 - ② On the Home screen, go to **⚙** > [Advanced]. Select [Software update]> [USB].
 - ↳ If a firmware update is detected, you are prompted to start the update.

- 3 Follow onscreen instructions to complete the update.
 - ↳ When the update is complete, **HMP7100** switches off automatically, and then switches on again.



Caution

- Keep **HMP7100** powered on and the storage device mounted before the firmware update is complete.

9 Troubleshooting

If you contact Philips, you will be asked for the model and serial number of this player. The model number and serial number are at the bottom of this player.

Write the numbers here:

Model No. _____

Serial No. _____

No picture.

- Refer to the TV user manual for how to select the correct video input channel

The contents of the USB storage device cannot be read.

- The format of this USB storage device is not supported.
- The supported memory size is 1TB maximum.
- Make sure that this player supports these files. (Refer to "Specifications" > "Playable media").

Subtitles are not displayed or not properly displayed.

- Make sure that the player supports the formats of the subtitles. (Refer to "Specifications" > "Subtitle support")
- To use a separate subtitle file for DivX video play, do the following:
 - ① Name the subtitle file in the same way as you do with the DivX video file, with file extension names unchanged.
 - ② Save the subtitle file under the same directory as the DivX video file on the mass storage device.
 - ③ Through the player, play the DivX video from a mass storage device.
- If you stream DivX video files through DLNA, the separate subtitle files are not supported.

10 Specification



Note

- Specification and design are subject to change without notice.

AC Power

- Input: 230 - 240 V~ 50Hz, 10 W
- Power consumption: < 10 W
- Power consumption in standby mode: < 0.5 W

USB connector

- Output: DC 5 V, 500 mA

Operating Temperature & Humidity

- 0°C to 35°C, 5% to 90% Humidity for all climates.

Storage Temperature & Humidity

- -40 °C to 70 °C, 5% to 95%

Supported formats:

- Video: MPEG 1/2/4(MPEG 4 Part 2), H.264,VC-1, WMV9, Divx HD, Divx Plus HD, Xvid, MKV, MPG, AVCHD, AVI, TS, M2TS, TP,VOB, DAT, MP4, MPEG, MOV (MPEG 4, H.264), ASF, FLV(640 × 480)
- Audio: Dolby digital, DTS, MPEG Audio, AAC, RA, OGG, MKA, ADPCM, AC3, WMA (V9), MP3, PCM, LPCM
- Picture: JPEG, JPG, PNG, GIF (unanimated GIF),JPEG in HD resolution, TIF, TIFF

HDD & USB support

- Compatibility: Hi-Speed USB (2.0)
- NTFS, FAT32, FAT, EXT-3
- USB MTP support, USB PTP support, USB MSC support

Subtitle support

- .srt, .sub, .smi, .ssa, .idx+.sub, ANSI

Video

- HDMI output: 480i, 480p, 576i, 576p, 720p, 1080i, 1080p/24 Hz, 1080p/50 Hz, 1080p/60 Hz

Audio

- HDMI output
- Optical output

Main Unit

- Dimensions (L x W x H): 178 x 57.5 x 91 mm
- Net Weight: 0.4 Kg

11 Written Offer

Philips Electronics Hong Kong Ltd. hereby offers to deliver, upon request, a copy of the complete corresponding source code for the copyrighted open source software packages used in this product for which such offer is requested by the respective licenses.

This offer is valid up to three years after product purchase to anyone in receipt of this information. To obtain source code, please contact open.source@philips.com. If you prefer not to use email or if you do not receive confirmation receipt within a week after mailing to this email address, please write to "Open Source Team, Philips Intellectual Property & Standards, P.O. Box 220, 5600 AE Eindhoven, The Netherlands." If you do not receive timely confirmation of your letter, please email to the email address above.

NOTICE

SOFTWARE END USER LICENSE AGREEMENT

THIS SOFTWARE END USER LICENSE AGREEMENT ("THIS AGREEMENT") IS A LEGAL AND BINDING AGREEMENT BETWEEN YOU (EITHER AN INDIVIDUAL OR ENTITY) AND PHILIPS CONSUMER LIFESTYLE B.V. A DUTCH LIMITED LIABILITY COMPANY, WITH ITS PRINCIPAL OFFICE AT HIGH TECH CAMPUS 37, 5656 AE EINDHOVEN, THE NETHERLANDS AND ITS SUBSIDIARY COMPANIES (INDIVIDUALLY AND COLLECTIVELY "PHILIPS"). THIS AGREEMENT GIVES YOU THE RIGHT TO USE CERTAIN SOFTWARE (THE "SOFTWARE") INCLUDING USER DOCUMENTATION IN ELECTRONIC FORM WHICH MAY HAVE BEEN PROVIDED SEPARATELY OR TOGETHER WITH A PHILIPS PRODUCT (THE "DEVICE") OR A PC. BY DOWNLOADING, INSTALLING OR OTHERWISE USING THE SOFTWARE, YOU ACCEPT AND AGREE TO BE BOUND BY ALL OF THE TERMS AND CONDITIONS OF THIS AGREEMENT. IF YOU DO NOT AGREE TO THESE TERMS AND CONDITIONS, DO NOT DOWNLOAD, INSTALL OR OTHERWISE USE THE SOFTWARE. IF YOU ACQUIRED THE SOFTWARE IN TANGIBLE MEDIA E.G. CD WITHOUT THE OPPORTUNITY TO REVIEW THIS LICENSE AND DO NOT ACCEPT THESE TERMS, YOU MAY RECEIVE A FULL REFUND OF THE AMOUNT, IF ANY, THAT YOU PAID FOR THE SOFTWARE IF YOU RETURN THE SOFTWARE UNUSED WITH PROOF OF PAYMENT WITHIN 30 DAYS FROM THE DATE OF PURCHASE.

- 1. Grant of License.** This Agreement grants you a non-exclusive, nontransferable, non-sub licensable license to install and use, on the Device or a PC, as applicable, one (1) copy of the specified version of the Software in object code format as set out in the user documentation solely for your personal use. The Software is "in use" when it is loaded into the temporary or permanent memory (i.e. RAM, hard disk, etc.) of the PC or the Device.

- 2. Ownership.** The Software is licensed and not sold to you. This Agreement grants you only the right to use the Software, but you do not acquire any rights, express or implied, in the Software other than those specified in this Agreement. Philips and its licensors retain all right, title, and interest in and to the Software, including all patents, copyrights, trade secrets, and other intellectual property rights incorporated therein. The Software is protected by copyright laws, international treaty provisions, and other intellectual property laws. Therefore, other than as expressly set forth herein, you may not copy the Software without prior written authorization of Philips, except that you may make one (1) copy of the Software for your back-up purposes only. You may not copy any printed materials accompanying the Software, nor print more than one (1) copy of any user documentation provided in electronic form, except that you may make one (1) copy of such printed materials for your back-up purposes only.
- 3. License Restrictions.** Except as provided otherwise herein, you shall not rent, lease, sublicense, sell, assign, loan, or otherwise transfer the Software. You shall not, and you shall not permit any third party, to reverse engineer, decompile, or disassemble the Software, except to the extent that applicable law expressly prohibits the foregoing restriction. You may not remove or destroy any product identification, copyright notices, or other proprietary markings or restrictions from the Software. All titles, trademarks, and copyright and restricted rights notices shall be reproduced on your back up copy of the Software. You may not modify or adapt the Software, merge the Software into another program or create derivative works based upon the Software.
- 4. Termination of certain functionality.** The Software may contain components of certain licensed software including software licensed from Microsoft Corporation (“Microsoft”) which implements Microsoft’s digital rights management technology for Windows Media. Content providers are using the digital rights management technology for Windows Media (“WM-DRM”) to protect the integrity of their content (“Secure Content”) so that their intellectual property, including copyright, in such content is not misappropriated. Your Device may also use WM-DRM software to transfer or play Secure Content (“WM-DRM Software”). If the security of such

WM-DRM Software is compromised, Microsoft may revoke (either on its own or upon the request of the owners of Secure Content ("Secure Content Owners")) the WM-DRM Software's right to acquire new licenses to copy, store, transfer, display and/or play Secure Content. Revocation does not alter the WM-DRM Software's ability to play unprotected content. A list of revoked WM-DRM Software is sent to your PC and/or your Device whenever you download a license for Secure Content. Microsoft may, in conjunction with such license, also download revocation lists onto your Device on behalf of Secure Content Owners, which may disable your Device's ability to copy, store, display, transfer, and/or play Secure Content. Secure Content Owners may also require you to upgrade some of the WM-DRM components distributed with this Software ("WM-DRM Upgrades") before accessing their content. When you attempt to play Secure Content, WM-DRM Software built by Microsoft will notify you that a WM-DRM Upgrade is required and then ask for your consent before the WM-DRM Upgrade is downloaded. WM-DRM Software built by Philips may do the same. If you decline the upgrade, you will not be able to access Secure Content that requires the WM-DRM Upgrade; however, you will still be able to access unprotected content and Secure Content that does not require the upgrade. WM-DRM features that access the Internet, such as acquiring new licenses and/or performing a required WM-DRM Upgrade, can be switched off. When these features are switched off, you will still be able to play Secure Content if you have a valid license for such content already stored on your Device. However, you will not be able to use certain of the WM-DRM Software features that require Internet access such as the ability to download content that requires the WM-DRM Upgrade. All title and intellectual property rights in and to the Secure Content is the property of the respective Secure Content owners and may be protected by applicable copyright or other intellectual property laws and treaties. This Agreement grants you no rights to use such Secure Content. **To summarize, if the Software contains Microsoft WM-DRM components – Secure Content you desire to download, copy, store, display, transfer, and/or play is protected by the Microsoft WM-DRM components of the Software. Microsoft, Secure Content Owners, or Secure Content distributors**

may deny you access, or restrict your access, to Secure Content even after you have paid for, and/or obtained, it. Neither your consent nor the consent or approval of Philips is necessary for any of them to deny, withhold or otherwise restrict your access to Secure Content. Philips does not guaranty that you will be able to download, copy, store, display, transfer, and/or play Secure Content.

5. **Open Source Software.** (a) This software may contain components that are subject to open-source terms, as stated in the documentation accompanying the Device. This Agreement does not apply to this software as such. (b) Your license rights under this Agreement do not include any right or license to use, distribute or create derivative works of the Software in any manner that would subject the Software to Open Source Terms. "Open Source Terms" means the terms of any license that directly or indirectly (1) create, or purport to create, obligations for Philips with respect to the Software and/or derivative works thereof; or (2) grant, or purport to grant, to any third party any rights or immunities under intellectual property or proprietary rights in the Software or derivative works thereof.
6. **Termination.** This Agreement shall be effective upon installation or first use of the Software and shall terminate (i) at the discretion of Philips, due to your failure to comply with any term of this Agreement; or (ii) upon destruction of all copies of the Software and related materials provided to you by Philips hereunder; Philips's rights and your obligations shall survive the termination of this Agreement.
7. **Upgrades.** Philips may, at its sole option, make upgrades to the Software available by general posting on a website or by any other means or methods. Such upgrades may be made available pursuant to the terms of this Agreement or the release of such upgrades to you may be subject to your acceptance of another agreement.
8. **Support Services.** Philips is not obligated to provide technical or other support ("Support Services") for the Software. If Philips does provide you with Support Services, these will be governed by separate terms to be agreed between you and Philips.

- 9. Limited Software Warranty.** Philips provides the Software 'as is' and without any warranty except that the Software will perform substantially in accordance with the documentation accompanying the Software for a period of one year after your first download, installation or use of the Software, whichever occurs first. Philips' entire liability and your exclusive remedy for breach of this warranty shall be, at Philips' option, either (i) return of the price paid by you for the Software (if any); or (b) repair or replacement of the Software that does not meet the warranty set forth herein and that is returned to Philips with a copy of your receipt. This limited warranty shall be void if failure of the Software has resulted from any accident, abuse, misuse or wrongful application. Any replacement Software will be warranted for the remainder of the original warranty period or thirty (30) days, whichever is longer. This limited warranty shall not apply to you if the Software was provided to you free of charge on an evaluation only basis.
- 10. NO OTHER WARRANTIES.** EXCEPT AS SET FORTH ABOVE, PHILIPS AND ITS LICENSORS DO NOT WARRANT THAT THE SOFTWARE WILL OPERATE ERROR FREE OR UNINTERRUPTED, OR WILL MEET YOUR REQUIREMENTS. YOU ASSUME ALL RESPONSIBILITIES FOR SELECTION OF THE SOFTWARE TO ACHIEVE YOUR INTENDED RESULTS, AND FOR THE INSTALLATION OF, USE OF, AND RESULTS OBTAINED FROM THE SOFTWARE. TO THE MAXIMUM EXTENT PERMITTED BY APPLICABLE LAW, PHILIPS AND ITS LICENSORS DISCLAIM ALL WARRANTIES AND CONDITIONS, WHETHER EXPRESS OR IMPLIED, INCLUDING BUT NOT LIMITED TO THE IMPLIED WARRANTIES OF MERCHANTABILITY, FITNESS FOR A PARTICULAR PURPOSE, AND ACCURACY OR COMPLETENESS OF RESULTS WITH RESPECT TO THE SOFTWARE AND THE ACCOMPANYING MATERIALS. THERE IS NO WARRANTY AGAINST INFRINGEMENT. PHILIPS DOES NOT WARRANT THAT YOU WILL BE ABLE TO DOWNLOAD, COPY, STORE, DISPLAY, TRANSFER, AND/OR PLAY SECURE CONTENT.
- 11. LIMITATION OF LIABILITY.** UNDER NO CIRCUMSTANCES WILL PHILIPS OR ITS LICENSORS BE LIABLE FOR ANY CONSEQUENTIAL, SPECIAL, INDIRECT, INCIDENTAL OR PUNITIVE DAMAGES

WHATSOEVER, INCLUDING, WITHOUT LIMITATION, DAMAGES FOR LOSS OF PROFITS OR REVENUES, BUSINESS INTERRUPTION, LOSS OF BUSINESS INFORMATION, LOSS OF DATA, LOSS OF USE OR OTHER PECUNIARY LOSS, EVEN IF PHILIPS OR ITS LICENSORS HAVE BEEN ADVISED OF THE POSSIBILITY OF SUCH DAMAGES. IN NO EVENT SHALL PHILIPS' OR ITS LICENSORS' AGGREGATE LIABILITY FOR DAMAGES ARISING OUT OF THIS AGREEMENT EXCEED THE GREATER OF THE PRICE ACTUALLY PAID BY YOU FOR THE SOFTWARE OR FIVE POUNDS STERLING (5.00).

12. **Trademarks.** Certain of the product and Philips names used in this Agreement, the Software, and the printed user documentation may constitute trademarks of the Philips, its licensors or other third parties. You are not authorized to use any such trademarks.
13. **Export Administration.** You agree that you will not directly or indirectly, export or re-export the Software to any country for which the United States Export Administration Act, or any similar United States law or regulation requires an export license or other U.S. Government approval, unless the appropriate export license or approval has first been obtained. By downloading or installing the Software you agree to abide by this Export provision.
14. **Governing law.** This Agreement is governed by the laws of your country of residence, without reference to its conflict of laws principles. Any dispute between you and Philips regarding this Agreement shall be subject to the non-exclusive jurisdiction of the courts of your country of residence.
15. **General.** This Agreement contains the entire agreement between you and Philips and supersedes any prior representation, undertaking or other communication or advertising with respect to the Software and user documentation. If any part of this Agreement is held invalid, the remainder of this Agreement will continue in full force and effect. This Agreement shall not prejudice the statutory rights of any party dealing as a consumer.

Philips Consumer Lifestyle B.V.

HK-1315-HMP7100#

(Document No. / Numéro du document)

PHILIPS

Year 2013

(Year, Month (yyyy/mm) in which the CE mark is affixed /
Année/mois (aaaa/mm) au cours de laquelle le marquage
CE a été apposé)

EUROPEAN DECLARATION OF CONFORMITY

(DECLARATION DE CONFORMITE CE)

We / Nous, PHILIPS CONSUMER LIFESTYLE B.V.

(Company name / Nom de l'entreprise)

TUSSENDIEPEN 4, 9206 AD DRACHTEN, THE NETHERLANDS

(address / adresse)

declare under our responsibility that the product(s):

(déclarons sous notre propre responsabilité que le(s) produit(s))

PHILIPS

(brand name, nom de la marque)

Home Media Player

(product description, description du produit)

HMP7100#/05, /12, /58

(*# can be A-W consist of different cabinet colour)

(Type version or model, référence ou modèle)

to which this declaration relates is in conformity with the following harmonized standards:

(auquel cette déclaration se rapporte, est conforme aux normes harmonisées suivantes)

(title, number and date of issue of the standard / titre, numéro et date de parution de la norme)

EN 60065:2002+A1(2006)+A11(2008)+A12(2011)

EN 55013:2001+A1(2003)+A2(2006)

EN 55020:2007+A11(2011)

EN 55022:2010

EN 55024:2010

EN301489-1 V1.9.2 (2011)

EN301489-17 V2.1.1 (2009)

EN300328 V1.7.1 (2006)

EN 61000-3-2:2006 + A1(2009)+A2(2009)

EN 61000-3-3:2008

EN50564:2011

EN62479:2010

EN50581:2012

following the provisions of :

(conformément aux exigences essentielles et autres dispositions pertinentes de:)

2006/95/EC (Low Voltage Directive)

1999/5/EC (R&TTE Directive)

2004/108/EC (EMC Directive)

2011/65/EU (Rohs Directive)

2009/125/EC (Eco Design) - EC/1275/2008

And are produced under a quality scheme at least in conformity with ISO 9001 or CENELEC Permanent Documents

(Et sont fabriqués conformément à une qualité au moins conforme à la norme ISO 9001 ou aux Documents Permanents CENELEC)

Only for Medical Devices and R&TTE products:

The Notified Body:

Dekra Certification B.V.
PHOENIX TESTLAB GmbH (0700)

performed:

CB test
R&TTE test

(L'Organisme Notifié)

(Name and number/ nom et numéro)

(a effectué)

(description of intervention / description de l'intervention)

and issued the certificate:

NL-26369 13-111539

(et a délivré le certificat)

(certificate number / numéro du certificat)

Drachten, Netherlands, April 15, 2013

(place, date / lieu, date)

A.Speelman, CL Compliance Manager

(signature, name and function / signature, nom et fonction)

Philips Consumer Lifestyle B.V.

template AMB 544-9056



Specifications are subject to change without notice
© 2013 Koninklijke Philips Electronics N.V.
All rights reserved.

HMP7100_05_UM_V1.0_WK1317.5



