



Philips
Wireless stereo speaker

Bluetooth® and NFC

USB port for charging
Rechargeable battery



SB365B

Stream your music and charge your smartphone

This speaker, SB365, delivers superb sound in great style. Stream music from your phone wirelessly over Bluetooth for effortless enjoyment. It also charges any smart device using USB.

Crystal clear sound

- Wireless music streaming via Bluetooth
- Bass Reflex Speaker System delivers a powerful, deeper bass

Advanced versatility

- USB port for charging other devices
- Built-in rechargeable battery for music playback anywhere

Simplicity in use

- Audio-in for easy connection to almost any electronic device
- One-Touch with NFC-enabled smartphones for Bluetooth pairing

PHILIPS

Highlights

Bass Reflex Speaker System

Bass Reflex Speaker System delivers a deep bass experience from a compact loudspeaker box system. It differs from a conventional loudspeaker box system in the addition of a bass pipe that is acoustically aligned to the woofer to optimize the low frequency roll-off of the system. The result is deeper controlled bass and lower distortion. The system works by resonating the air mass in the bass pipe to vibrate like a conventional woofer. Combined with the response of the woofer, the system extends the overall low frequency sounds to create a whole new dimension of deep bass.

Wireless music streaming

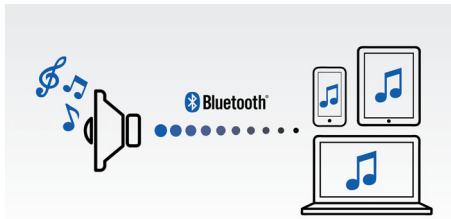

Bluetooth is a short range wireless communication technology that is both robust and energy-efficient. The technology allows easy wireless connection to iPod/iPhone/iPad or other Bluetooth devices, such as smartphones, tablets or even laptops. So you can enjoy your favorite music, sound from video or game music wireless on this speaker easily.

NFC technology

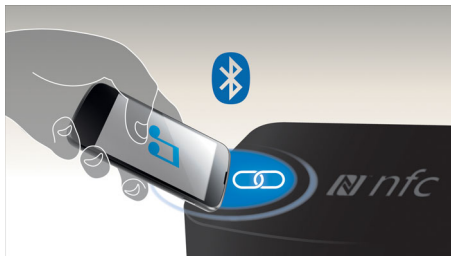

Pair Bluetooth devices easily with one-touch NFC (Near Field Communications) technology. Just tap the NFC enabled smartphone or tablet on the NFC area of a speaker to turn the speaker on, start Bluetooth pairing, and begin streaming music.

Built-in USB port



This speaker comes with a USB port, allowing you to conveniently charge your device. Simply connect your device with its USB cable to the back of the speaker.

Audio-in



Audio-in for easy connection to almost any electronic device

Built-in rechargeable battery

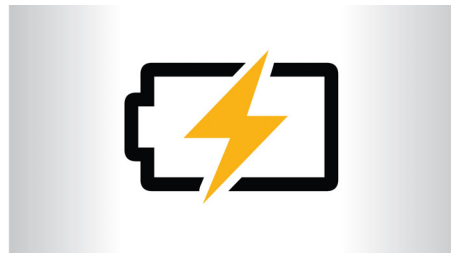

Play music out loud - anytime, anywhere. The built-in rechargeable battery lets you enjoy your personal music without the fuss of entangled power cords and the inconvenient search for an electrical outlet. Enjoy great music with the freedom of portability now.

Specifications

Compatibility

- iPad: iPad 4, iPad mini, new iPad, iPad 2, iPad 1, iPad Air, iPad Air 2, iPad mini 2, iPad mini 3, iPad with Retina display
- iPhone: iPhone 5S, iPhone 5C, iPhone 5, iPhone 4S, iPhone 4, iPhone 3GS, iPhone 3, iPhone 6, iPhone 6 Plus
- iPod touch: 3rd generation or later
- Android tablets & smartphones: with Android 2.1 and Bluetooth 2.1 or above
- work with: Bluetooth 4.0 and below
- other Bluetooth-enabled device

Sound

- Output power (RMS): 8W
- Sound System: Stereo
- Volume Control: Volume Control up/down

Connectivity

- Bluetooth version: 4.0
- Bluetooth profiles: A2DP, AVRCP
- Bluetooth range: Line of sight, 10M or 30FT
- Audio in (3.5mm)
- Connector: USB port for charging smartphones / tablets

Dimensions

- Weight incl. Packaging: 1.42 kg
- Packaging dimensions (WxDxH): 327 x 115 x 120 mm
- Product dimensions (WxDxH): 260 x 83 x 95 mm
- Product weight: 1.05 kg

Power

- Power supply: Battery, 100-240VAC, 50/60Hz
- Battery type: Lithium-ion (built-in)

Loudspeakers

- Speaker drivers: 2 x 2.5" full-range woofer



Issue date 2017-05-07

Version: 2.0.10

12 NC: 8670 001 26585
UPC: 8 89446 00035 1

© 2017 Koninklijke Philips N.V.
All Rights reserved.

Specifications are subject to change without notice.
Trademarks are the property of Koninklijke Philips N.V.
or their respective owners.

www.philips.com