

Philips SoClear
Cordless phone with
answering machine

5000-series

Champagne

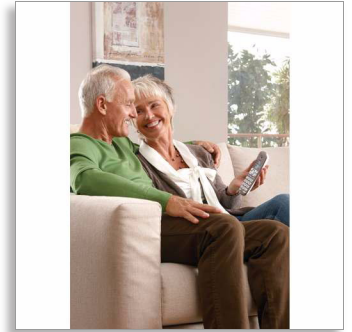

XL5952C

Comfortable and simple

Visual ringer, extra loud sound

Enjoy a clever visual ringer, so you can see incoming calls as well as hear them. And with extra loud sound capabilities for easy listening, oversized buttons for easy dialling and an in-built answering machine, it makes it all so simple.

Hear everything loud and clear

- Extra loud sound for clear voice reproduction
- Handset speakerphone allows you to talk hands-free
- Hearing aid compatible - reduces unwanted noise
- Optimised antenna layout for great reception in any room

Smart, simple and easy to use

- Up to a 60 min. message on your answering machine
- Large display and easy to read characters
- Visual ringer flashes to alert you of incoming calls
- Instantly call your loved ones via speed-dial keys
- Ultimate convenience through easy setup
- Up to 19 hours of talk time on a single charge

Eco-conscious product

- Zero power emission when ECO+ mode is activated
- Low power consumption: < 0.65 W in standby mode

PHILIPS
sense and simplicity

Highlights

Handset speakerphone



Hands-free mode uses a built-in loudspeaker to amplify the voice of the caller, allowing you to speak and listen during a call without holding the phone to your ear. This is especially useful if you want to share the call with others or simply multitask.

Low power consumption: < 0.65 W



Philips phones are energy efficient and are designed to be respectful to the environment. Now the power consumed in standby mode is less than < 0.65 W.

Optimised antenna layout



Our optimised antenna layout ensures strong and stable reception, even in areas of the house where cordless transmission is difficult. Now you can take a call wherever you are in the house, and enjoy a long, uninterrupted conversation even as you walk around.

Up to 60 min. recording



With up to 60 minutes of recording time, you'll never miss an important message.

ECO+ mode

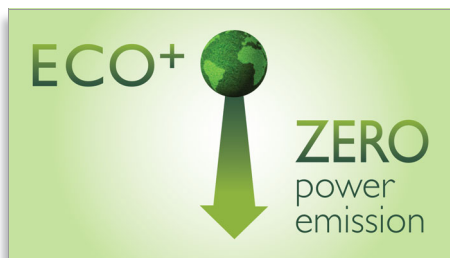

The ultimate mode to save transmitting power.

Easy setup

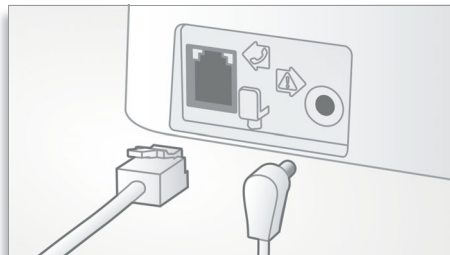

Ultimate convenience through easy set up. Simplified installation - Plug and Play product

Extra loud sound



Extra loud sound for clear voice reproduction

Hearing aid compatible



Hearing aid compatible - reduces unwanted noise

Instant calling



Instantly call your loved ones via speed-dial keys

Large, easy to read display

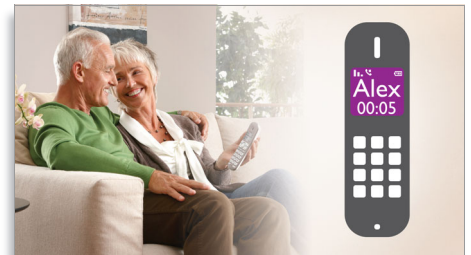

Large display and easy to read characters

Up to 19 hours of talk time



Up to 19 hours of talk time on a single charge

Specifications

Sound

- Hearing Aid Compatible
- Volume control on handset
- Ringtones on handset: 10 polyphonic with progressive ringtone volumes

Picture/Display

- Display size: 4.8 cm/1.9"
- Display type: FSTN — dot matrix
- Backlight: Yes
- Backlight colour: White

Answering Machine

- Recording time capacity: up to 60 minutes
- Pre-recorded OGM
- Message counter on base: Amber counter (2 x 7 segments)
- Answering machine control: from base and handset
- Loud speaker on base

Convenience

- Menu structure in the handset: List Menu
- Speakerphone — talk hands-free
- Personalisation: Silence mode
- Personalisation (ringtone): VIP ringtones for M1, M2 and M3
- Signal strength indicator: 3- bar indicator
- Battery level indicator: 3- bar battery icon
- Intercom — multiple handsets
- Date/Time display
- Alarm Clock
- Battery charge indication
- Programmable hot keys: Key 1 and 2, and M1/2/3
- Call Management: Call Waiting, Caller ID, Microphone mute, Missed Calls, Received Calls
- Key tone on/off
- Auto Registration
- Auto hang up
- Multi-base capability: 1

- Multi-handset capability: Up to 4
- Number of keys: 23
- Backlit keypad: White (flashing when the phone rings)
- Base Station keys: Paging key
- Up to 19 hrs talk time
- Up to 300 hrs standby time
- Charge time: 8 hours
- Line cord length: 1.8 m
- Power cord length: 1.8 m
- Range: Open field <300 m; indoor <50 m

Memory Capacity

- VIP Caller Identification
- Phonebook: 200 names and numbers + 2 direct access memories
- Redial List Capacity: 40 entries
- Call log entries: 100 entries
- Phonebook store in the base

Power

- Battery capacity: 650 mAh
- Battery type: AAA NiMH Rechargeable
- Mains power: AC 100-240 V ~50/60 Hz
- Power Consumption: < 0.65 W

Security

- Transmission encryption: Yes

Network Features

- Compatible: GAP

SAR Value

- Philips handsets: <0.1 W/kg

Eco Design

- EcoMode: automatic and manual
- Full ECO Mode (NEMO)



Issue date 2013-03-13

Version: 5.1.4

12 NC: 8670 000 80053
EAN: 87 12581 61426 3

© 2013 Koninklijke Philips Electronics N.V.
All Rights reserved.

Specifications are subject to change without notice.
Trademarks are the property of Koninklijke Philips
Electronics N.V. or their respective owners.

www.philips.com