



Philips  
Cordless phone

25 min answering machine  
1.6" display/amber backlight

**D1651B**



## Keep it simple

The Philips D165 Cordless Phone with a built-in answering machine packs essential functions in a fresh and engaging design. Excellent sound reproduction and easy plug-and-play lets you enjoy every conversation with great clarity and ease.

### Nice and simple

- Up to 25 minutes of messages on your answering machine
- Ultimate convenience through easy setup
- Textured back cover for non-slip grip
- Menu in multiple local languages
- Easy to read 1.6" (4.1 cm) display with backlight
- Up to 10 hours' talk time on a single charge
- Caller ID – so you always know who is calling\*

### Crystal clear sound

- The Parametric Equaliser delivers pure and clear sound
- Automatic Volume Control offsets unwanted volume variation
- Optimised antenna layout for great reception in any room
- Advanced sound testing and tuning for superb voice quality

### Eco-conscious product

- Low radiation and power consumption

# PHILIPS

# Highlights

## 4.1 cm (1.6") display

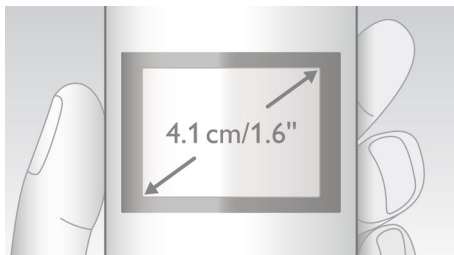

Easy to read 1.6" (4.1 cm) display with backlight

## Advanced sound testing

We test the sound quality of our DECT phones the same way as high-end headphone manufacturers do. Using an advanced ear simulator, we can accurately re-create the way people actually hear. This helps our acoustic engineers to measure and fine-tune things like frequency response, distortion and overall hearing perception, to create perfect voice reproduction.

## Automatic Volume Control

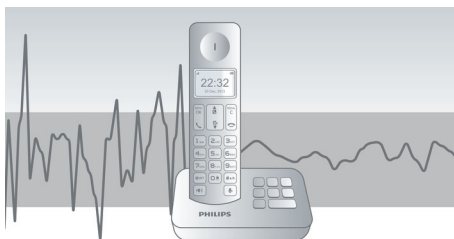

Automatic Volume Control offsets variations in sound signal, which can be caused by distance, signal strength or the caller's phone — so what you hear always remains consistent. Reducing the audio amplification for strong signals, and increasing it for weak ones, means you can enjoy a smooth conversation without unwanted sound volume variation.

## Caller ID\*



Sometimes it's good to know who's calling before you answer. And our Caller ID lets you keep track of who's on the other end of the line.

## Easy setup

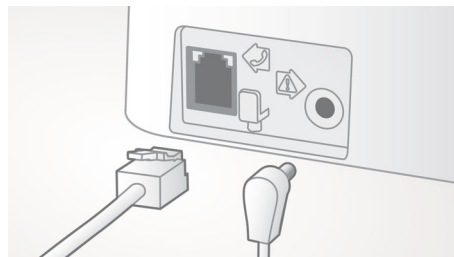

Ultimate convenience through easy set up.  
Simplified installation - Plug and Play product

## Eco-conscious product



Philips phones are energy efficient and designed to be respectful to the environment.

## Menu in local languages



Enjoy easy setup, navigation and control with intuitive menu available in local languages.

## Non-slip grip

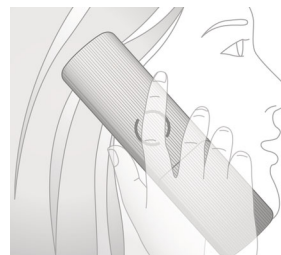

The rear of the handset is treated with a special texture for added comfort and better grip.

## Optimised antenna layout



Our optimised antenna layout ensures strong and stable reception, even in areas of the house where cordless transmission is difficult. Now you can take a call wherever you are in the house, and enjoy a long, uninterrupted conversation even as you walk around.

# Specifications

## Convenience

- Menu structure in the handset: List Menu
- Signal strength indicator: 3 bar indicator
- Battery level indicator: 3 bar battery icon
- Date/Time display
- Programmable hot keys: Key 1 and 2
- Call Management: Call Waiting\*, Caller ID\*, Microphone mute, Missed Calls, Received Calls, Dialed calls
- Keypad lock
- Key tone on/off
- Auto hang up
- Number of keys: 20
- Base Station keys: Paging key
- Up to 10 hrs' talk time
- Charge time: 8 hours
- Line cord length: 1.5 m
- Power cord length: 1.5 m
- Range: Open field <300 m; indoor <50 m
- Non-slip grip: Triangular pattern
- Up to 200 hrs standby time

## Sound

- Volume control on handset
- Ringtones on handset: 10 standard
- HQ-Sound

## Picture/Display

- Display size: 4.1 cm/1.6"
- Display type: 12 digits (Alphanumeric) + hard icons
- Backlight: Yes
- Backlight colour: Amber

## Answering Machine

- Recording time capacity: up to 25 minutes

- Pre-recorded OGM
- Answering machine control: from handset

## Memory Capacity

- Phonebook: 50 names and numbers
- Redial List Capacity: Last 10 numbers
- Call log entries: 20 entries
- Phonebook store in the base

## Power

- Battery Capacity: 300 mAh
- Battery type: AAA NiMH Rechargeable
- Mains power: AC 100-240 V ~50/60 Hz
- Power Consumption: <0.75 W

## Security

- Transmission encryption: Yes

## Network Features

- Compatible: GAP

## SAR Value

- Philips handsets: <0.1 W/kg

## Packaging dimensions

- Packaging type: Carton
- Number of products included: 1
- Type of shelf placement: Laying
- Packaging dimensions (W x H x D): 18.4 x 13.5 x 5.9 cm
- Gross weight: 0.3467 kg
- Net weight: 0.2626 kg
- Tare weight: 0.0841 kg
- EAN: 48 95229 10337 5



Issue date 2022-06-23

Version: 7.3.2

12 NC: 8670 001 63606  
EAN: 48 95229 10337 5

© 2022 Koninklijke Philips N.V.  
All Rights reserved.

Specifications are subject to change without notice.  
Trademarks are the property of Koninklijke Philips N.V.  
or their respective owners.

[www.philips.com](http://www.philips.com)

\* \*\*This feature requires additional subscription to Caller ID service.  
Please check with your local network operator for details.