

Register your product and get support at  
[www.philips.com/welcome](http://www.philips.com/welcome)

## SoundHub home cinema speakers

9000 series



# Quick start guide

**PHILIPS**

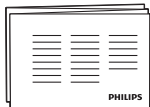

- EN** Before using your product, read all accompanying safety information
- DA** Læs alle medfølgende sikkerhedsoplysninger, inden du tager produktet i brug
- DE** Lesen Sie vor Verwendung dieses Produkts alle begleitenden Sicherheitsinformationen
- EL** Πριν χρησιμοποιήσετε το προϊόν, διαβάστε όλες τις παρεχόμενες πληροφορίες ασφάλειας
- ES** Antes de usar el producto, lea toda la información de seguridad adjunta
- FI** Lue kaikki turvallisuuksiedot ennen tuotteen käyttöä
- FR** Avant d'utiliser votre produit, lisez l'intégralité des consignes de sécurité jointes
- IT** Prima di utilizzare il prodotto, leggere tutte le relative informazioni sulla sicurezza
- NL** Lees voordat u het product gaat gebruiken eerst alle bijbehorende veiligheidsinformatie
- NO** Lees voordat u het product gaat gebruiken eerst alle bijbehorende veiligheidsinformatie
- PT** Antes de utilizar o produto, leia todas as informações de segurança que o acompanham
- SV** Innan du använder produkten ska du läsa all tillhörande säkerhetsinformation
- TR** Ürününüzü kullanmadan önce ilgili tüm güvenlik bilgilerini okuyun
- CS** Před použitím produktu si přečtěte doprovodné bezpečnostní informace
- HU** A termék használatá elött alaposan olvassa el a mellékelt biztonsági tudnivalókat
- PL** Przed rozpoczęciem korzystania z produktu należy zapoznać się z informacjami dotyczącymi bezpieczeństwa
- RO** Înainte de a utiliza acest produs, citiți toate informațiile de siguranță care îl însoțesc
- SK** Pred použitím produktu si prečítajte všetky sprievodné bezpečnostné informácie



- EN** What's in the box
- DA** Hvad følger med
- DE** Verpackungsinhalt
- EL** Περιεχόμενα συσκευασίας
- ES** Contenido de la caja
- FI** Pakkauksen sisältö
- FR** Contenu de l'emballage
- IT** Contenuto della confezione
- NL** De inhoud van de doos
- NO** Innholdet i esken
- PT** Conteúdo da embalagem
- SV** Vad finns i förpackningen?
- TR** Kutu içeriği
- CS** Obsah balení
- HU** A doboz tartalma
- PL** Zawartość opakowania
- RO** Ce se află în cutie
- SK** Obsah balenia

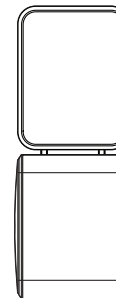
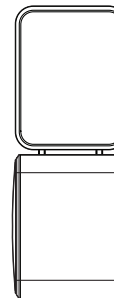
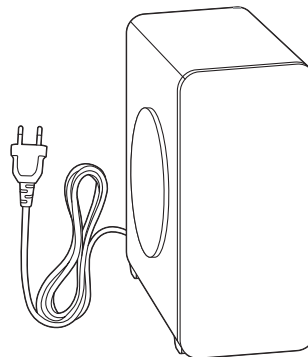
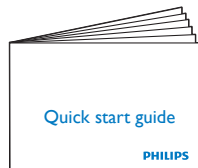
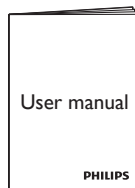
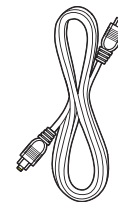
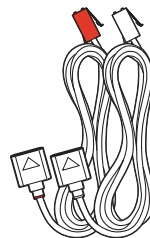
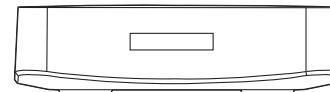
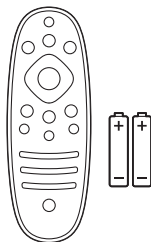

# 1

- EN** Position the SoundHub
- DA** Placer din SoundHub
- DE** SoundHub ausrichten
- EL** Τοποθετήστε το SoundHub
- ES** Posición del SoundHub
- FI** Asettele SoundHub
- FR** Installer le SoundHub
- IT** Posizionare il SoundHub
- NL** De SoundHub plaatsen
- NO** Plasser SoundHub
- PT** Posicionar o SoundHub
- SV** Placera din SoundHub
- TR** SoundHub'ı yerleştirme
- CS** Umístěte zařizení SoundHub
- HU** Helyezze el a SoundHub elosztót
- PL** Umieść zestaw SoundHub w odpowiedniej pozycji
- RO** Poziționarea dispozitivului SoundHub
- SK** Pozícia zvukového rozbočovača

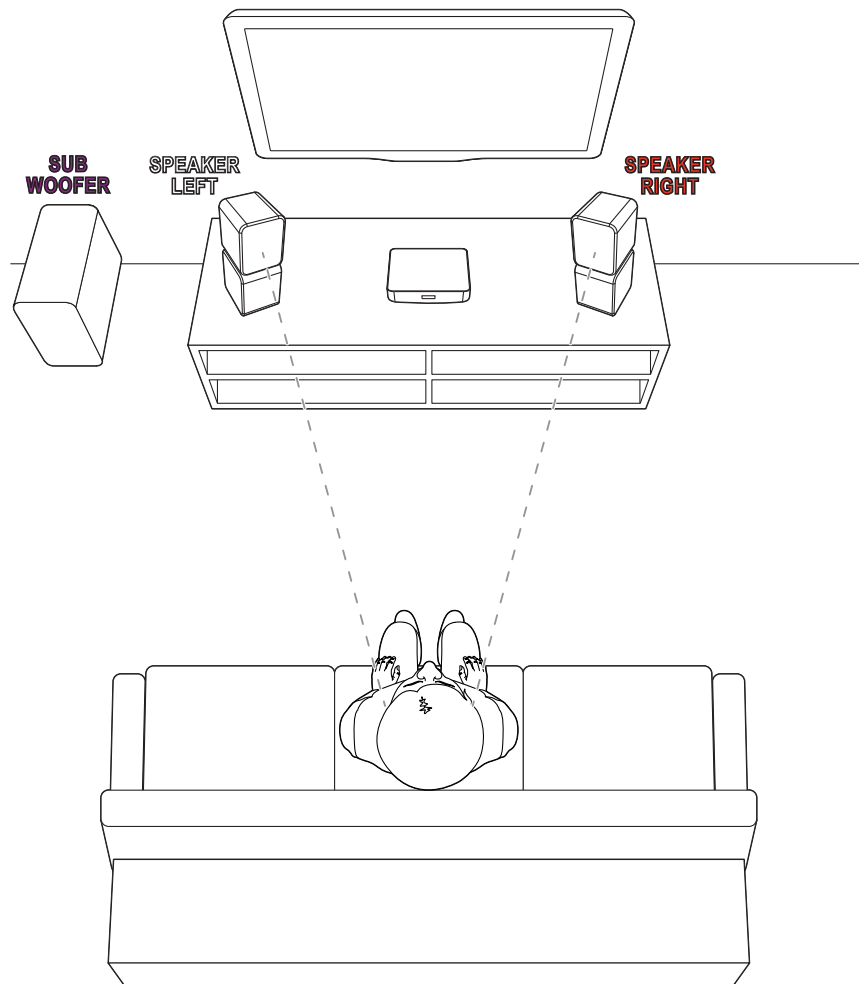

# 2

- EN** Connect the SoundHub
- DA** Tilslut din SoundHub
- DE** SoundHub verbinden
- EL** Συνδέστε το SoundHub
- ES** Conecte el SoundHub a otros dispositivos
- FI** Kytke SoundHub
- FR** Connecter le SoundHub
- IT** Collegare il SoundHub
- NL** De SoundHub aansluiten
- NO** Koble til SoundHub
- PT** Ligar o SoundHub
- SV** Anslut din SoundHub
- TR** SoundHub'i bağlama
- CS** Připojte zařízení SoundHub
- HU** Csatlakoztassa a SoundHub elosztót
- PL** Podłącz zestaw SoundHub
- RO** Conectarea dispozitivului SoundHub
- SK** Pripojenie zvukového rozbočovača

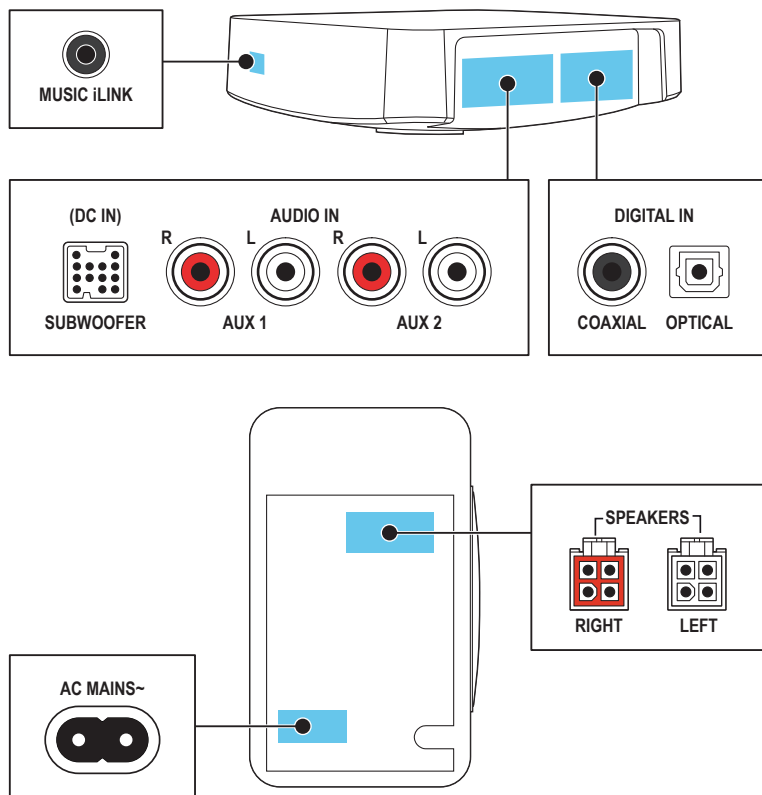

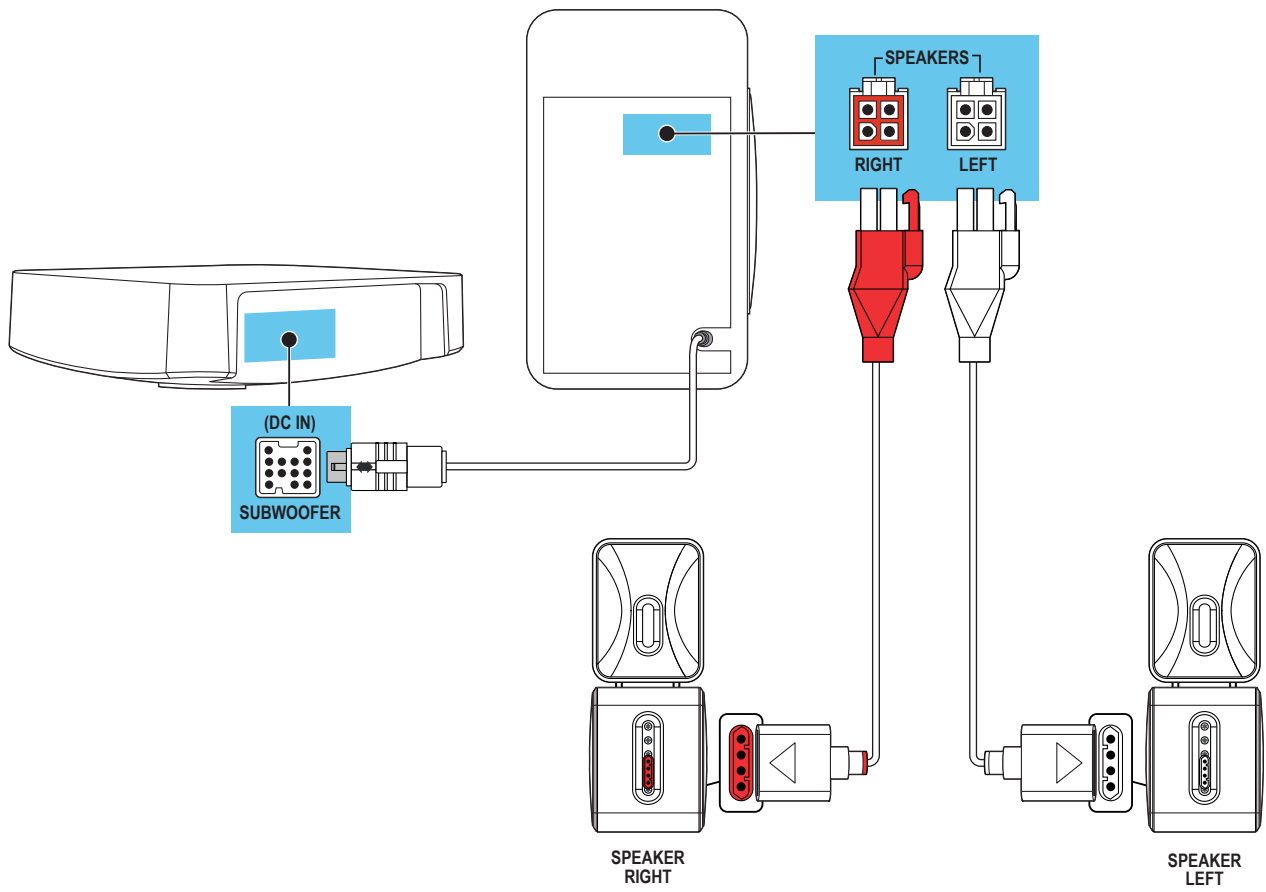

# 3

- EN** Connect the SoundHub to TV
- DA** Slut din SoundHub til tv'et
- DE** SoundHub mit dem Fernseher verbinden
- EL** Συνδέστε το SoundHub στην τηλεόραση
- ES** Conecte el SoundHub al televisor
- FI** Kytke SoundHub televisioon
- FR** Connecter le SoundHub au téléviseur
- IT** Collegare il SoundHub al televisore
- NL** De SoundHub aansluiten op de TV
- NO** Koble SoundHub til TV-en
- PT** Ligar o SoundHub ao televisor
- SV** Anslut din SoundHub till TV:n
- TR** SoundHub'ı TV'ye bağlama
- CS** Připojte zařízení SoundHub k televizoru
- HU** Csatlakoztassa a SoundHub elosztót a televíziókészülékhez
- PL** Podłącz zestaw SoundHub do telewizora
- RO** Conectarea dispozitivului SoundHub la TV
- SK** Pripojenie zvukového rozbočovača k televizoru

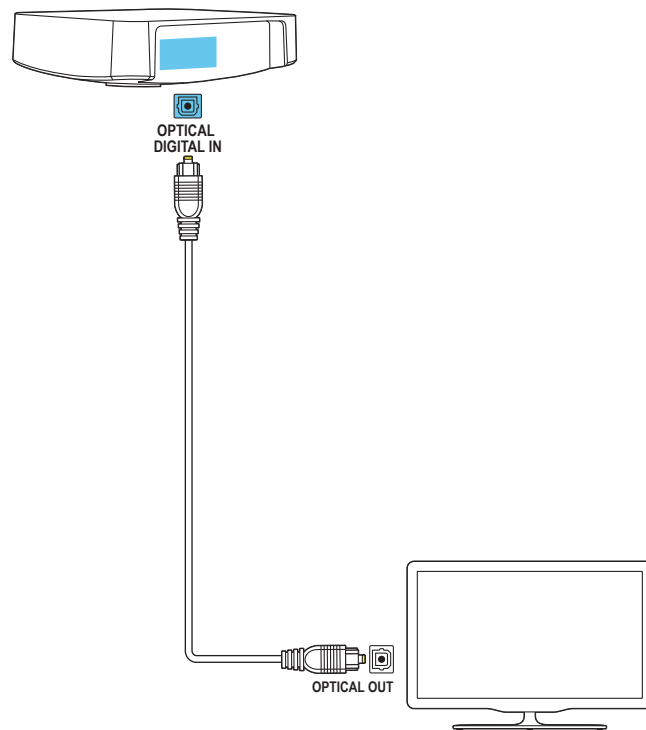

- EN** Connect the SoundHub to other devices
- DA** Slut din SoundHub til andre enheder
- DE** SoundHub mit anderen Geräten verbinden
- EL** Συνδέστε το SoundHub σε άλλες συσκευές
- ES** Conecte el SoundHub a otros dispositivos
- FI** Kytke SoundHub muihin laitteisiin
- FR** Connecter le SoundHub à d'autres périphériques
- IT** Collegare il SoundHub ad altri dispositivi
- NL** De SoundHub aansluiten op andere apparaten
- NO** Koble SoundHub til andre enheter
- PT** Ligar o SoundHub a outros dispositivos
- SV** Anslut din SoundHub till andra enheter
- TR** SoundHub'i diğer cihazlara bağlama
- CS** Připojte zařízení SoundHub k ostatním zařízením
- HU** Csatlakoztassa a SoundHub elosztót a további készülékekhez
- PL** Podłącz zestaw SoundHub do innych urządzeń
- RO** Conectarea dispozitivului SoundHub la alte dispozitive
- SK** Pripojenie zvukového rozbočovača k iným zariadeniam

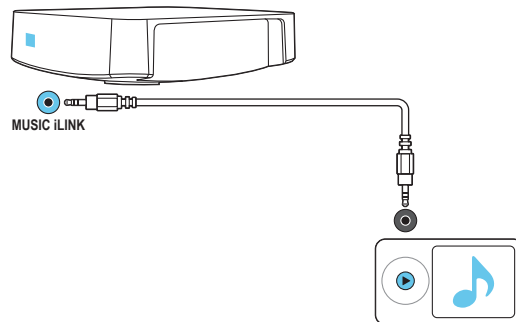
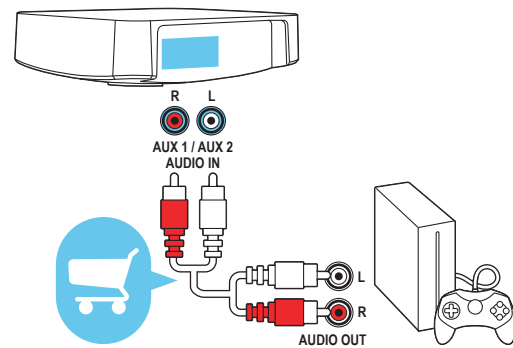
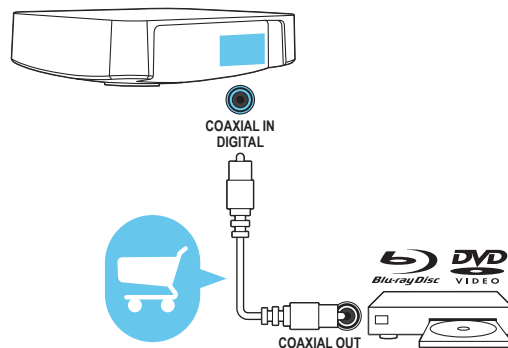



# 5

- EN** Switch on the SoundHub
- DA** Tænd for din SoundHub
- DE** SoundHub einschalten
- EL** Ενεργοποιήστε το SoundHub
- ES** Encienda el SoundHub
- FI** Käynnistä SoundHub
- FR** Allumer le SoundHub
- IT** Accendere il SoundHub
- NL** De SoundHub inschakelen
- NO** Slå på SoundHub
- PT** Acender o SoundHub
- SV** Slå på din SoundHub
- TR** SoundHub'ı açma
- CS** Zapněte zařízení SoundHub
- HU** Kapcsolja be a SoundHub elosztót
- PL** Przełącz na zestaw SoundHub
- RO** Pornirea dispozitivului SoundHub
- SK** Zapnutie zvukového rozbočovača

1

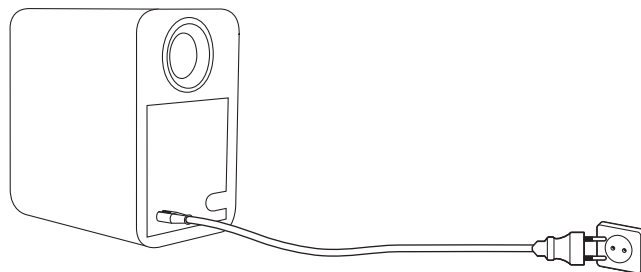

2

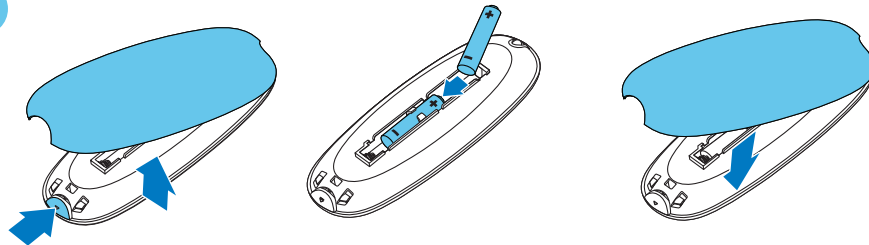

3

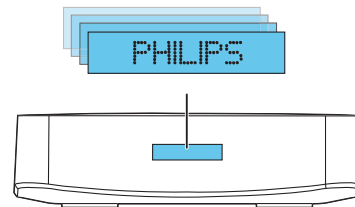
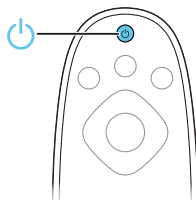

# 6

- EN** Select an audio source
- DA** Vælg en lydkilde
- DE** Auswählen einer Audioquelle
- EL** Επιλογή πηγής ήχου
- ES** Selección de una fuente de audio
- FI** Äänilähteen valitseminen
- FR** Sélectionner une source audio
- IT** Selezione di una sorgente audio
- NL** Een audiobron selecteren
- NO** Velg en lydkilde
- PT** Seleccionar uma fonte de áudio
- SV** Välja ljudkälla
- TR** Bir ses kaynağı seçin
- CS** Výběr zdroje zvuku
- HU** Egy audioforrás kiválasztása
- PL** Wybór źródła dźwięku
- RO** Selectare sursă audio
- SK** Vyberte zdroj zvuku

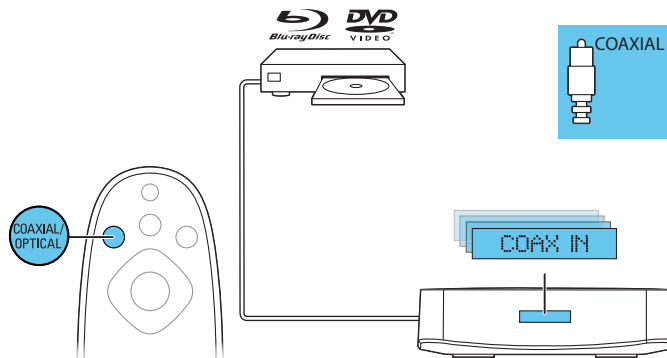
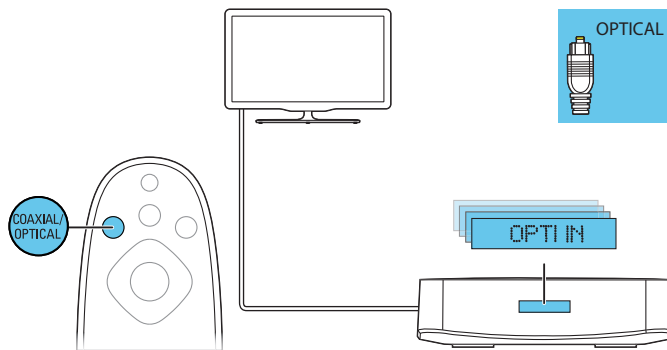

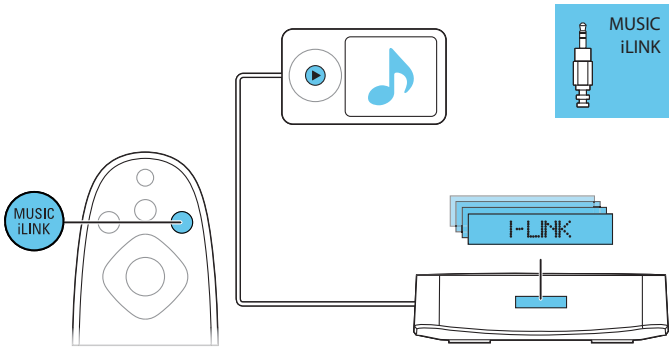
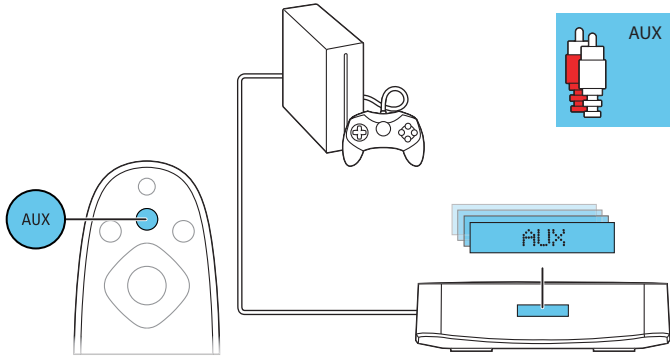



- EN** For more information about using this product, visit [www.philips.com/support](http://www.philips.com/support)
- DA** Du kan finde yderligere oplysninger om brugen af dette produkt på [www.philips.com/support](http://www.philips.com/support)
- DE** Weitere Informationen zur Verwendung dieses Produkts finden Sie unter [www.philips.com/support](http://www.philips.com/support)
- EL** Για περισσότερες πληροφορίες σχετικά με τη χρήση αυτού του προϊόντος, επισκεφθείτε το [www.philips.com/support](http://www.philips.com/support)
- ES** Para obtener más información sobre este producto, visite [www.philips.com/support](http://www.philips.com/support)
- FI** Lue lisätietoja tuotteen käytöstä osoitteessa [www.philips.com/support](http://www.philips.com/support)
- FR** Pour obtenir davantage d'informations sur l'utilisation de ce produit, rendez-vous sur [www.philips.com/support](http://www.philips.com/support)
- IT** Per ulteriori informazioni sull'uso di questo prodotto, visitare il sito [www.philips.com/support](http://www.philips.com/support)
- NL** Ga voor meer informatie over dit product naar [www.philips.com/support](http://www.philips.com/support)
- NO** Hvis du vil ha mer informasjon om bruk av dette produktet, kan du gå til [www.philips.com/support](http://www.philips.com/support)
- PT** Para mais informações sobre a utilização deste produto, visite [www.philips.com/support](http://www.philips.com/support)
- SV** Mer information om att använda den här produkten finns på [www.philips.com/support](http://www.philips.com/support)
- TR** Bu ürünün kullanımı hakkında daha fazla bilgi için [www.philips.com/support](http://www.philips.com/support) adresini ziyaret edin
- CS** Více informací o použití výrobku naleznete na stránkách [www.philips.com/support](http://www.philips.com/support)
- HU** A termék használatával kapcsolatos további információkkal kapcsolatban tekintse meg a [www.philips.com/support](http://www.philips.com/support) weboldalt
- PL** Więcej informacji na temat korzystania z tego produktu można znaleźć na stronie [www.philips.com/support](http://www.philips.com/support)
- RO** Pentru informații suplimentare despre utilizarea acestui produs, vizitați [www.philips.com/support](http://www.philips.com/support)
- SK** Ďalšie informácie o používaní tohto výrobku nájdete na stránke [www.philips.com/support](http://www.philips.com/support)



Non-contractual images. / Images non contractuelles. / Außervertragliche Bilder.  
All registered and unregistered trademarks are property of their respective owners.  
Specifications are subject to change without notice  
Trademarks are the property of Koninklijke Philips Electronics N.V. or their respective owners  
2011 © Koninklijke Philips Electronics N.V. All rights reserved

[www.philips.com](http://www.philips.com)  
sgsn\_1131/12\_v1



[www.philips.com/support](http://www.philips.com/support)

