

Philips
DVD Mini Hi-Fi System

Bluetooth® and NFC
720W

FXD58



Mega sound goes wireless

Get more from movies with the FXD58. Stream music wirelessly over Bluetooth® from any smart device, with NFC technology for instant pairing. The mini hi-fi system is also DivX certified for DivX video playback, and plays MP3 files via USB.

Enjoy your favorite movies and music

- HDMI 1080p upscales to high definition for sharper pictures
- Play DVD, DivX®, (S)VCD, MP3-CD, CD(RW) and Picture CD

Powerful sound you can hear and feel

- MAX Sound for instant power boost
- Subwoofer for powerful bass
- 720W RMS/ 9500W PMPO total output power

Multiple source MP3 music

- Enjoy MP3 music directly from your portable USB devices
- Stream music wirelessly via Bluetooth™ from your smartphone
- Audio-in for portable music playback

Convenient and easy to use

- Karaoke for endless singing entertainment
- One-Touch with NFC-enabled smartphones for Bluetooth pairing

PHILIPS

Highlights

720W RMS/ 9500W PMPO

720W RMS/ 9500W PMPO total output power

Audio-in



The Audio in connectivity allows direct playback of Audio in content from portable media players. Besides the benefit of enjoying your favorite music in the superior sound quality delivered by the audio system, the Audio in is also extremely convenient as all you have to do is to plug your portable MP3 player to the audio system.

Enjoy MP3 music directly

Enjoy MP3 music directly from your portable USB devices

HDMI 1080p



HDMI 1080p upscaling delivers images that are crystal clear. Movies in standard definition can now be enjoyed in true high definition resolution - ensuring more details and more true-to-life pictures. Progressive Scan (represented by "p" in "1080p") eliminates the line structure prevalent on TV screens, again ensuring relentlessly sharp images. To top it off, HDMI makes a direct digital connection that can carry uncompressed digital HD video as well as digital multichannel audio, without conversions to analog - delivering perfect

picture and sound quality, completely free from noise.

Karaoke



The Karaoke feature on your DVD player provides endless entertainment and maximum audio and singing enjoyment. You can enhance your performance by adding an 'echo' effect to your voice. The key controls allows you to choose the optimal key for your personal vocal range.

MAX Sound



MAX Sound technology produces an instant boost in bass, maximizing volume performance and instantly creating the most impressive listening experience with just the touch of a button. Its sophisticated electronic circuitry calibrates existing sound and volume settings, instantly boosting bass and volume to maximum levels without distortion. The end result is a noticeable amplifying of both sound spectrum and volume and a potent audio boost that will add mileage to any music.

Play DVD, DivX and MP3-CD

The Philips player is compatible with most DVD and CD discs available in the market. DVD, DivX®, (S)VCD, MP3-CD, CD(RW) and Picture CD - all of them can play on the player. SVCD stands for "Super VideoCD". The

quality of a SVCD is much better than a VCD, especially much more sharpen picture than a VCD because of the higher resolution. With DivX® support, you are able to enjoy DivX® encoded videos. The DivX media format is an MPEG4-based video compression technology that enables you to save large files like movies, trailers and music videos on media like CD-R/RW, and DVD recordable discs.

Stream music via Bluetooth™



Bluetooth is a short range wireless communication technology that is both robust and energy-efficient. The technology allows easy wireless connection to iPod/iPhone/iPad or other Bluetooth devices, such as smartphones, tablets or even laptops. So you can enjoy your favorite music, sound from video or game wireless on this speaker easily.

Subwoofer for powerful bass

Subwoofer for powerful bass

NFC technology

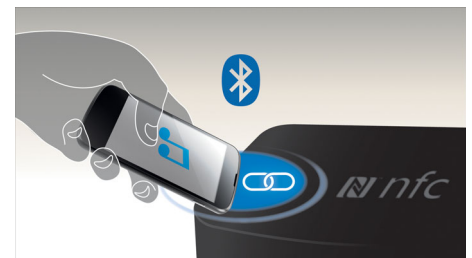

Pair Bluetooth devices easily with one-touch NFC (Near Field Communications) technology. Just tap the NFC enabled smartphone or tablet on the NFC area of a speaker to turn the speaker on, start Bluetooth pairing, and begin streaming music.

Specifications

Sound

- Total Sound Power (RMS): 720 W
- Sound Enhancement: MAX Sound
- Output Power: 9500W PMPO

Loudspeakers

- Main Speaker: 2" tweeter, 5.25" woofer
- Number of Loudspeakers: 2.1
- Subwoofer driver: 8" woofer

Audio Playback

- Number of Discs: 1
- Loader Type: Tray
- Playback Media: CD, CD-R, CD-RW, MP3-CD
- Disc Playback Modes: Repeat/one/disk/program, Shuffle Play, Fast Forward/Backward, Next/Previous Track Search, Repeat Play, 20-Track Programmable
- USB Direct Modes: Fast Backward/Fast Forward, Play/Pause, Previous/Next, Program Play, Repeat, Shuffle, Stop

Tuner/Reception/Transmission

- Tuner Bands: FM Stereo
- Auto digital tuning
- Station presets: 40

Convenience

- Alarms: CD Alarm, Sleep timer, Radio Alarm, USB alarm
- Clock: On main display
- Display Type: VFD display

Connectivity

- Audio Connections: RCA Aux in
- Bluetooth profiles: A2DP
- Audio in (3.5mm)
- NFC technology

Accessories

- Remote control: 21key
- Included accessories: User Manual, Quick start guide, Guarantee booklet

Dimensions

- Set dimensions (W x H x D): 467 x 140 x 320 mm
- Speaker Width: 204 mm
- Speaker Height: 309 mm
- Speaker Depth: 145 mm
- Packaging dimensions (W x H x D): 556 x 540 x 556 mm
- Net Weight: 12.65 kg
- Subwoofer dimensions (W x H x D): 299 x 308 x 248 mm

Power

- Power supply: 110-240V

Video Playback

- Disc Playback Modes: A-B Repeat, Disc Menu, Fast Backward, Fast Forward, Pause
- Number of Discs: 1
- Playback Media: DivX, DVD
- DVD region code: 3



Issue date 2016-12-14

Version: 2.0.3

12 NC: 8670 001 13956
EAN: 87 12581 71881 7

© 2016 Koninklijke Philips N.V.
All Rights reserved.

Specifications are subject to change without notice.
Trademarks are the property of Koninklijke Philips N.V.
or their respective owners.

www.philips.com