

Quick Start Guide



What's in the Box?

You should find these items upon opening the box.

Step A *Connect*

Step B *Setup*

Step C *Enjoy*

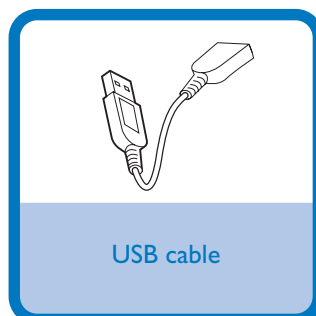
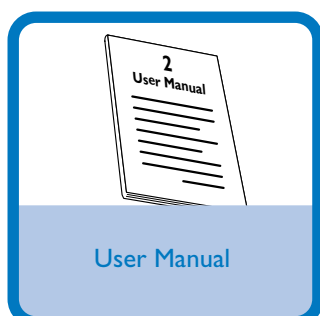
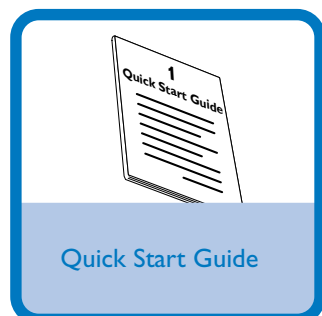
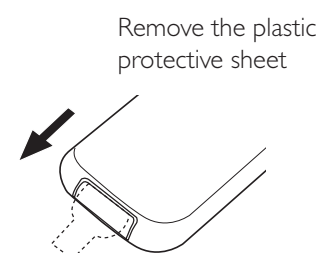
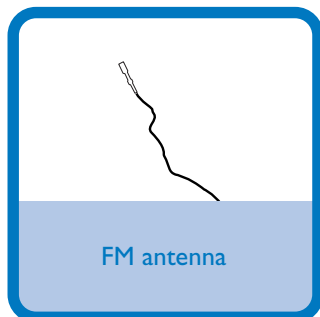
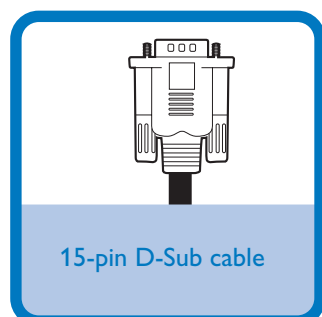
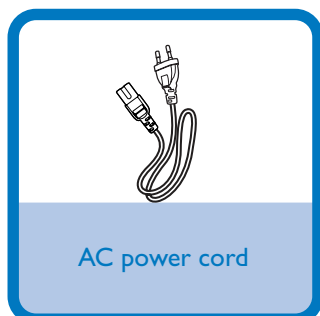
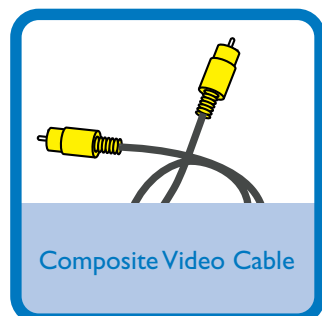

PHILIPS

Step A Connect

Tips

- See the User Manual for other TV connection options.
- Never connect the AC power cord before connection of the 15-pin D-Sub cable to avoid causing any damage to the set.

- 1 Connect the speaker (subwoofer) cables.
- 2 Connect the FM antenna.
- 3 Connect the composite video cable to a TV.
- 4 Connect the power supplies of the system and TV.

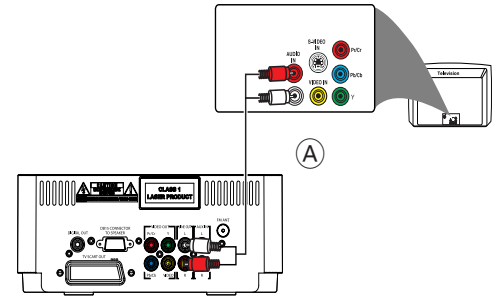
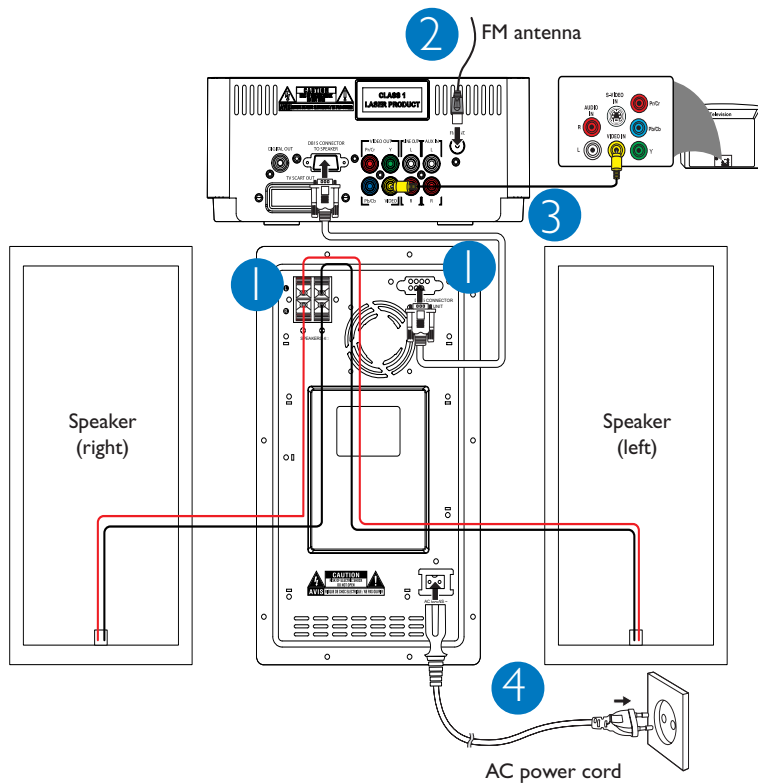

A To listen to the sound of this DVD Player through your TV, use the audio cables (white/red-not supplied) to connect **LINE OUT (L/R)** jacks of the DVD Player to the corresponding **AUDIO IN** jacks on the TV.

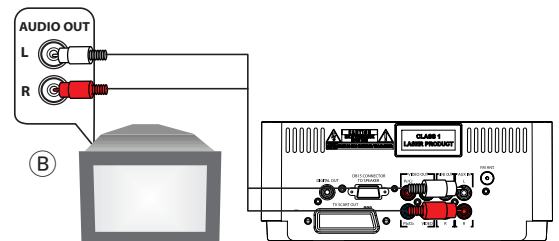

B To listen to the sound of your TV through this DVD player, use a cinch cable (not supplied) to connect **AUX IN** on the rear panel of the DVD player to the corresponding **AUDIO OUT** jacks on the TV.

Step B Setup

Setting up the TV

- 1 Press **SOURCE** (**DISC** on the remote) to select disc source.
- 2 Turn on the TV and set it to the correct Video In channel.

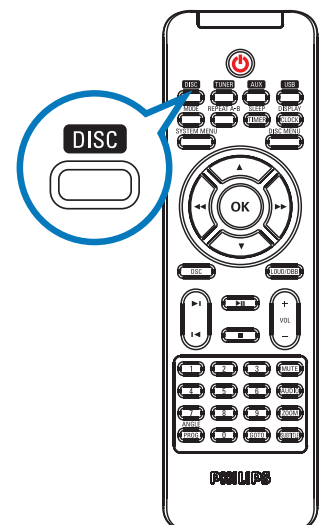

Step B Setup

Setting the clock

1

In standby mode, press and hold **DISPLAY/CLOCK** on the remote control.

2

When the hour digits flash, press **VOLUME +/-** on the front panel or **VOL +/-** on the remote to set the hours.

3

Press **DISPLAY/CLOCK** again and the minute digits flash. Then press **VOLUME +/-** on the front panel or **VOL +/-** on the remote to set the minutes.

4

Press **DISPLAY/CLOCK** again to confirm the time setting.

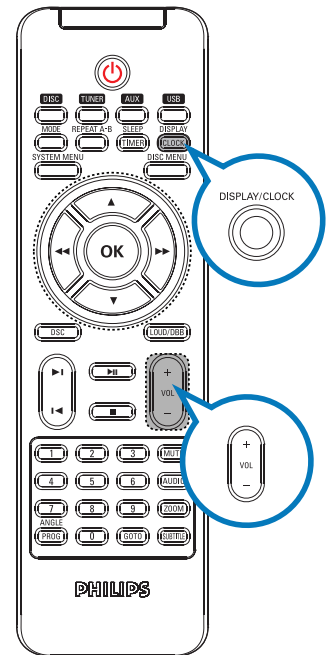

Tip

Detailed playback features and additional functions are described in the accompany owner's manual.

Setting system menu options

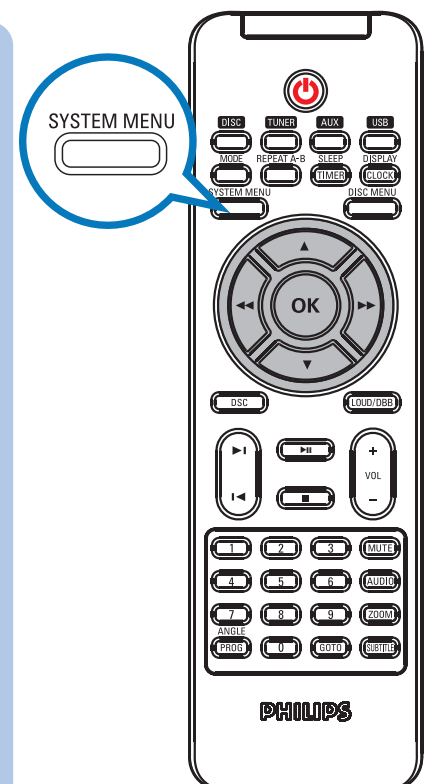
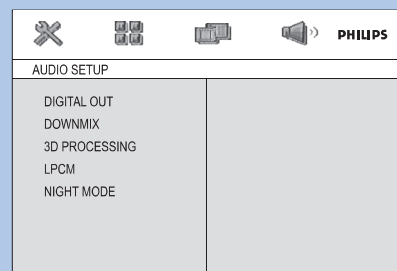
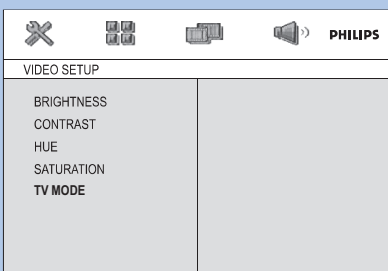
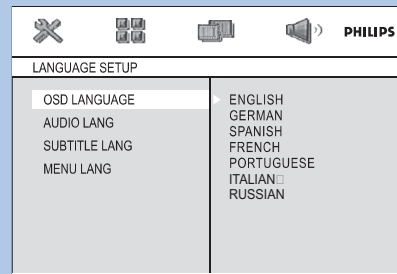
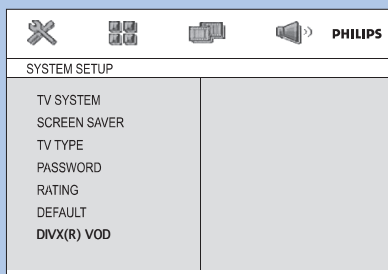



Tip

See chapters "Preparations" and "System Menu Options" in the User Manual for detailed descriptions.

Step C Enjoy

Playing a disc

- 1 Push **OPEN-CLOSE**  on the top of the system to open the disc door.
- 2 Insert a disc with the print side facing up and close the disc door.
- 3 Playback will start automatically. If not press .
- 4 To stop playback, press .

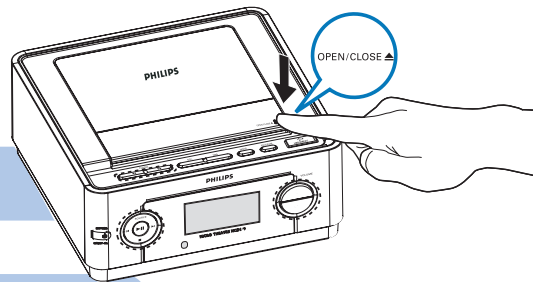

Programming and tuning to radio stations

- 1 Press **SOURCE** (**TUNER** on the remote) to select tuner source.
- 2 Press **PROG/ANGLE** for more than two seconds to program all available stations in order of waveband.
- 3 Press  until the desired preset station is displayed.

Playing a USB mass storage device

With the system, you can use USB flash memory (USB 2.0 or USB1.1), USB flash players (USB 2.0 or USB1.1), memory cards (requires an additional card reader to work with this system).

- 1 Insert the USB device's USB plug into the socket  on the front panel of the main set.
- 2 Press **SOURCE** once or more (or **USB** on the remote control) to select **USB**.
- 3 Play the USB's audio files as you do with the albums/tracks on a CD.

Tip
- In USB mode, the system supports MP3/WMA only.

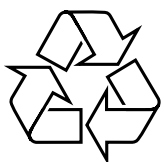

© Royal Philips Electronics N.V. 2007
All rights reserved.

<http://www.philips.com>

PDCC-LL/ZC-0737