



Kurzanleitung

Snelstartgids

Guida di avvio rapido

DE

NL

IT

**PHILIPS**

- DE** Registrieren Sie Ihr Produkt, und holen Sie sich Unterstützung unter
- NL** Ga voor registratie van uw product en ondersteuning naar
- IT** Registra il prodotto e ricevi assistenza all'indirizzo:

[www.philips.com/welcome](http://www.philips.com/welcome)

- DE** Bitte lesen und akzeptieren Sie die allgemeinen Geschäftsbedingungen für Streamium sowie die Lizenzvereinbarung für Software-Endbenutzer, die Sie im Benutzerhandbuch auf dem mitgelieferten Festplattenlaufwerk finden.
- NL** Lees onze bepalingen en voorwaarden ten aanzien van Streamium en lees de softwarelicentieovereenkomst voor eindgebruikers. Ga met beide akkoord. U vindt beide onderdelen in de gebruikershandleiding op de meegeleverde HDD.
- IT** Leggere e accettare i Termini e condizioni dei prodotti Streamium e il Contratto di licenza per l'utente finale del software inclusi in questo manuale dell'utente sull'HDD in dotazione.



DE **Verpackungsinhalt**  
 NL **Wat zit er in de doos?**  
 IT **Contenuto della confezione**

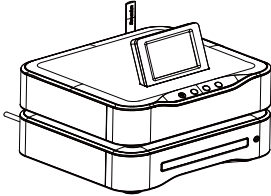

- DE MCi8080 Hauptgerät/DVD-Gerät
- NL MCi8080-apparaat/DVD-unit
- IT Unità principale MCi8080/unità DVD

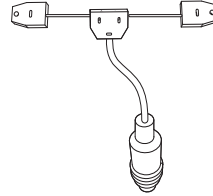

- DE UKW-Antenne
- NL FM-antenne
- IT Antenna FM

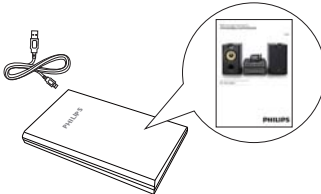

- DE Festplattenlaufwerk (HDD) mit USB-Kabel
- NL Harde schijf (HDD) met USB-kabel
- IT Hard disk (HDD) con cavo USB

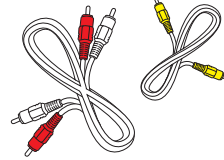

- DE Composite-Videokabel/Audiokabel
- NL Composite Video-kabel/Audiokabels
- IT Cavo Composite Video/Cavi audio

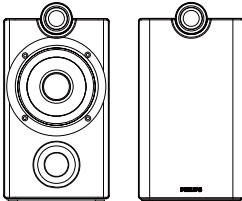

- DE 2 x Lautsprecher für das MCi8080
- NL 2 x luidsprekers voor MCi8080
- IT 2 x altoparlanti per unità MCi8080

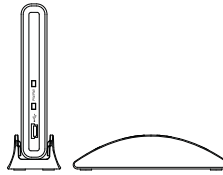

- DE Standfuß für die Festplatte
- NL Standaard voor de HDD
- IT Supporto per HDD



- DE Kurzanleitung
- NL Snelstartgids
- IT Guida di avvio rapido

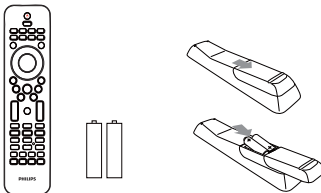

- DE Fernbedienungen (jede mit 2 AAA-Batterien)
- NL Afstandsbedieningen (elk met 2 AAA-batterijen)
- IT Telecomandi (ciascuno con 2 batterie AAA)

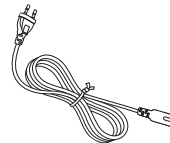

- DE Netzkabel
- NL Netsnoeren
- IT Alimentatori CA

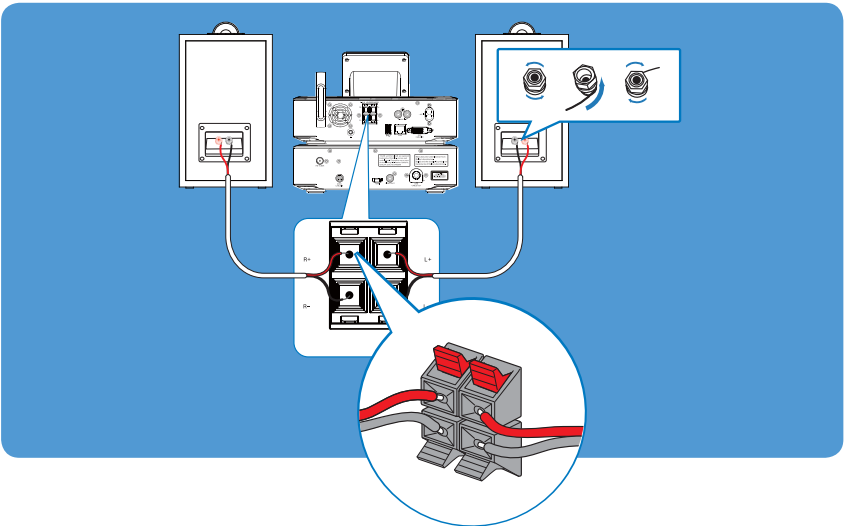
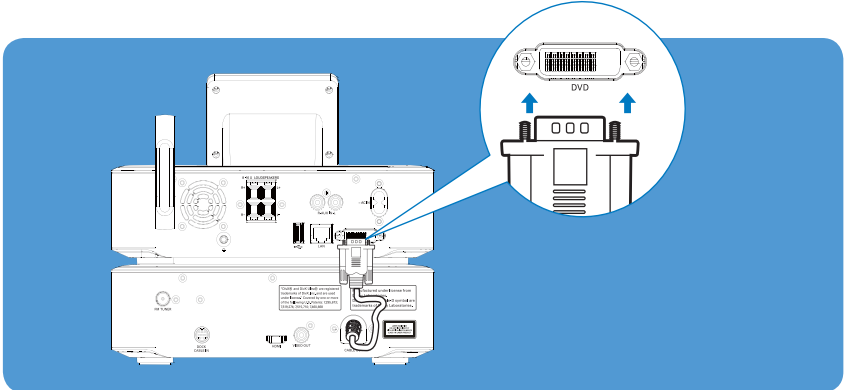
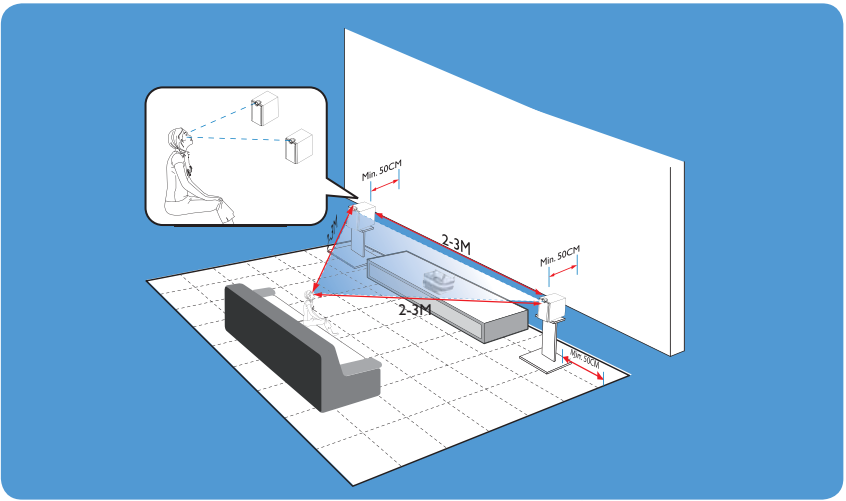



# DE Anschließen Aansluiten Collegamento



DE Anschließen der Festplatte an das MCI8080

NL HDD op een MCI8080 aansluiten

IT Collegamento dell'HDD all'unità MCI8080

DE **Erstmalige Verwendung:**

- 1 Kopieren Sie den Ordner "MCI8080" (mit Benutzerhandbuch und Softwarepaket) auf den Computer;
- 2 Kopieren Sie Mediendateien unabhängig von der Ordnerstruktur auf das Festplattenlaufwerk.

NL **Eerste gebruik:**

- 1 Kopieer de MCI8080-map (met de gebruikershandleiding en softwaresuite) naar de computer;
- 2 Kopieer mediabestanden naar de HDD, ongeacht de mapstructuur.

IT **Primo utilizzo**

- 1 Copiare la cartella MCI8080 (con il manuale dell'utente e il software incluso) sul computer;
- 2 Copiare i file multimediali sull'HDD a prescindere dalla struttura della cartella.

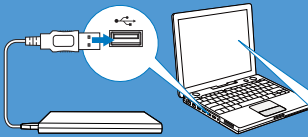

1

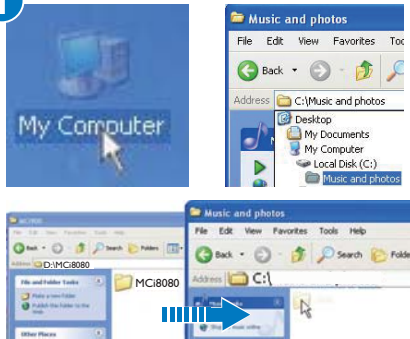

2

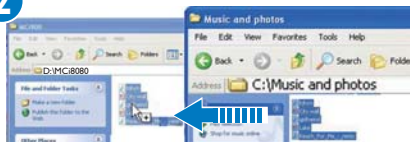

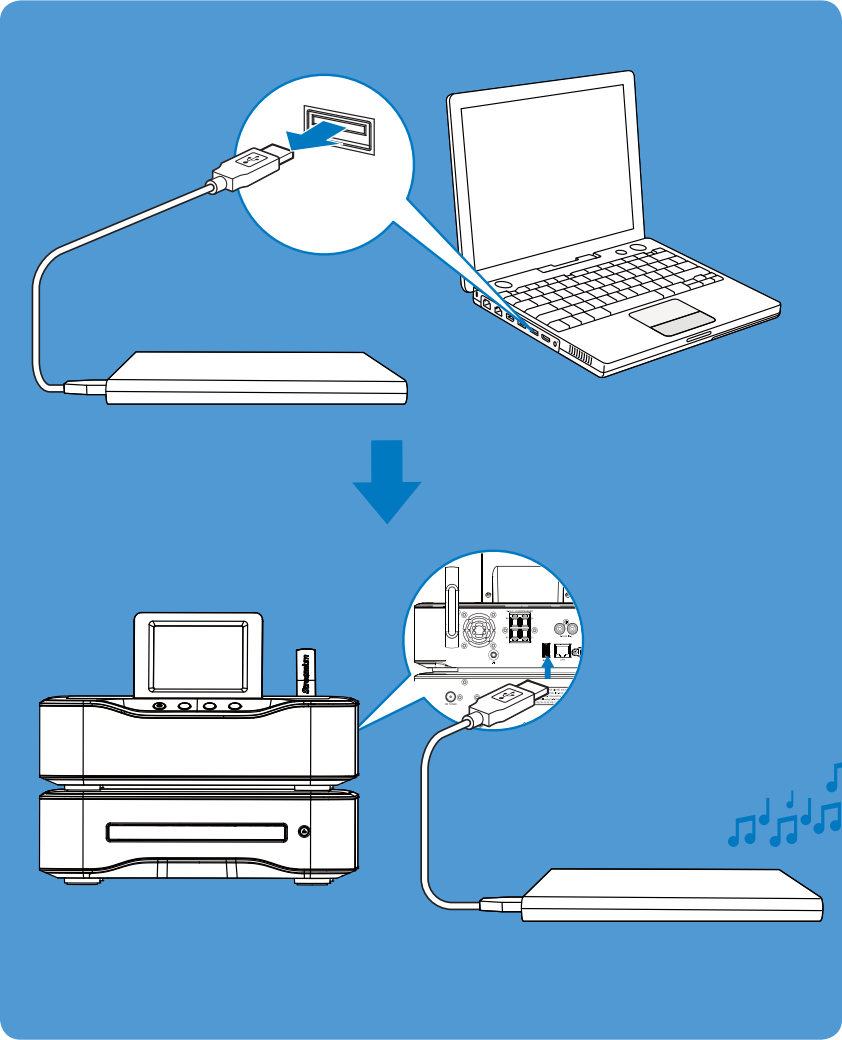



# DE Fernbedienung

# NL Afstandsbediening

# IT Telecomando



DE On/Off

NL On/Off

IT On/Off

DE Navigation

NL Navigatie

IT Navigazione

DE Source

NL Bron

IT SOURCE

DE Home

NL Startpagina

IT Home

DE Wiedergabesteuerung

NL Afspelen

IT Controllo della riproduzione

DE Tastenfeld

NL Toetsinvoer

IT Tasti di immissione



MCi8080

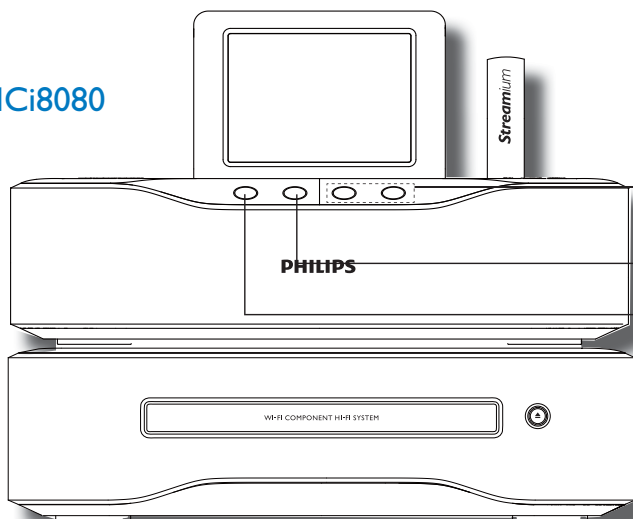

- DE Lautstärke
- NL Volume
- IT Volume
- DE Stummschaltung
- NL Dempen
- IT Disattivazione dell'audio
- DE Ein-/Aus schalten
- NL Aan/uit
- IT On/off





DE

Einschalten

NL

Inschakelen

IT

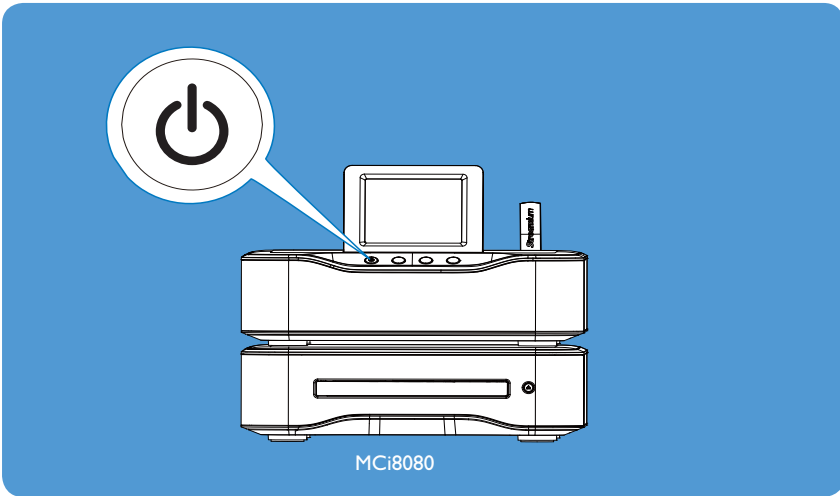
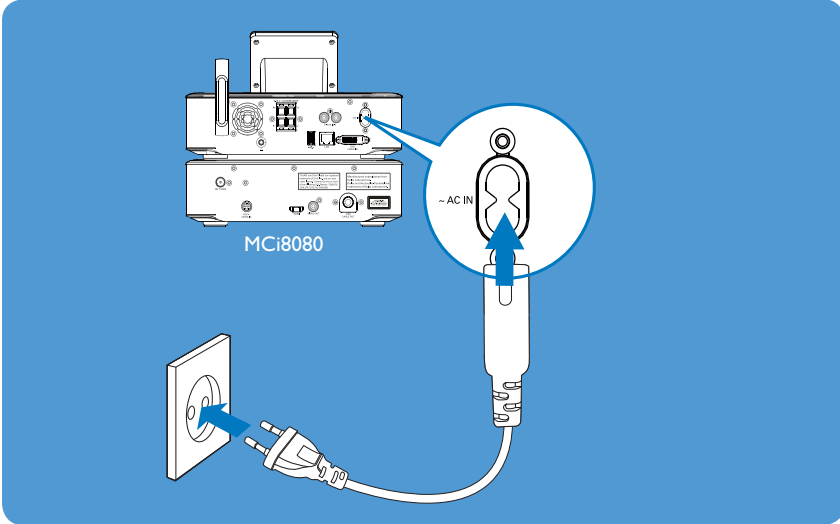

Accensione

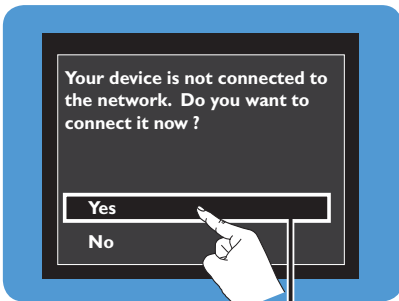
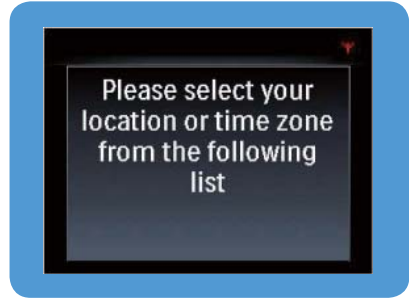



DE

#### \* Tipp

- Um das Gerät auszuschalten, drücken Sie , um in den aktiven Standbymodus zu wechseln. Die Betriebsanzeige leuchtet rot.
- Oder halten Sie  gedrückt, um in den Eco-Standbymodus (Energiesparmodus) zu wechseln.

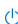

NL

#### \* Tip

- Om het apparaat uit te schakelen, drukt u op  waarna de stand-bymodus wordt geactiveerd. Het aan-uitlampje gaat rood branden.
- U kunt ook  ingedrukt houden om de energiebesparende stand-bymodus in te schakelen.

IT

#### \* Suggerimento

- Per spegnere l'unità, premere  per passare alla modalità di standby attivo. L'indicatore di alimentazione si illumina di rosso.
- In alternativa, tenere premuto  per passare alla modalità standby Eco (modalità di risparmio energetico).



DE Verbinden mit einem Netzwerk  
NL Op het netwerk aansluiten  
IT Connessione alla rete

DE Verwenden Sie Methode (A) oder (B).

NL Gebruik methode (A) of (B).

IT Usare il metodo (A) o (B).

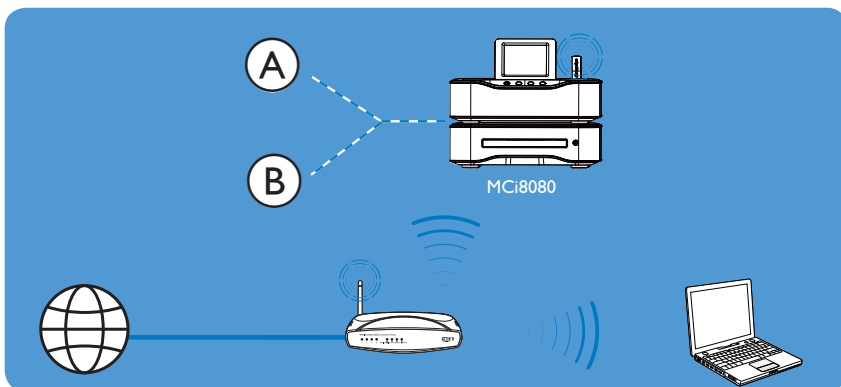

DE (A) Wireless Protected Setup (WPS)

NL (A) Wireless Protected Setup (WPS)

IT (A) WPS (Wireless Protected Setup)

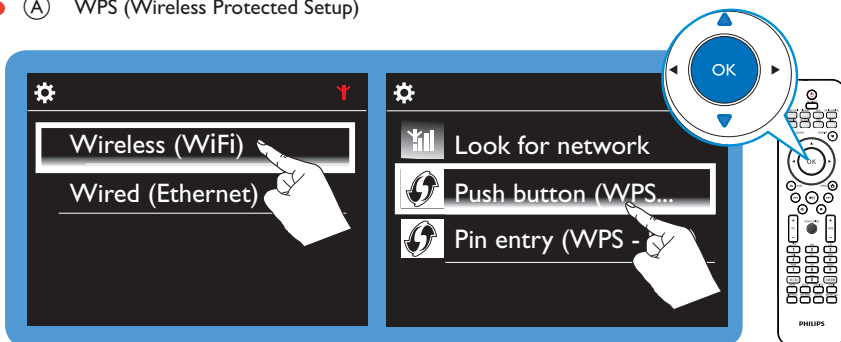



⚙️ 🔴

Activate WPS Push Button function on your access point. After that, press OK on the remote control of your Philips Streamium.

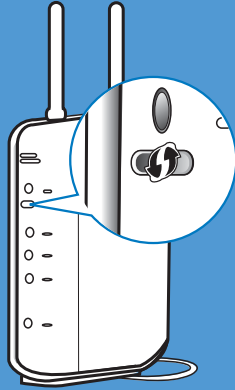

⚙️ 📶

Successfully connected to Network A

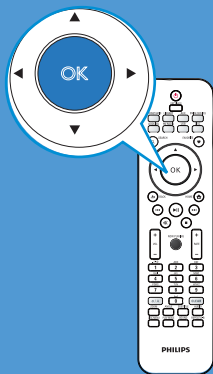

- DE B Verwenden des Netzwerkschlüssels für kabellose Verbindungen
- NL B Netwerksleutel gebruiken voor draadloze verbinding
- IT B Utilizzo della chiave di rete per la connessione wireless

DE

**Hinweis**

- Stellen Sie sicher, dass der Router mit dem Internet verbunden ist.

NL

**Opmerking**

- Zorg ervoor dat de router verbinding heeft met internet.

IT

**Nota**

- Verificare che il router si connetta a Internet.

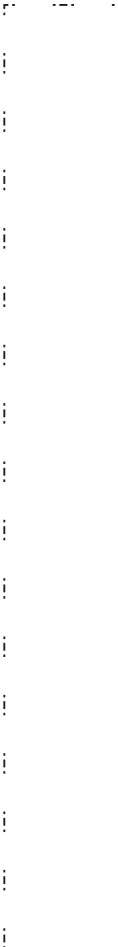
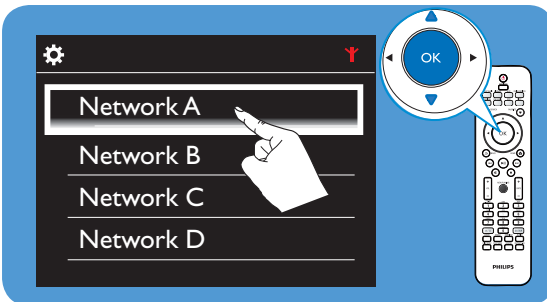
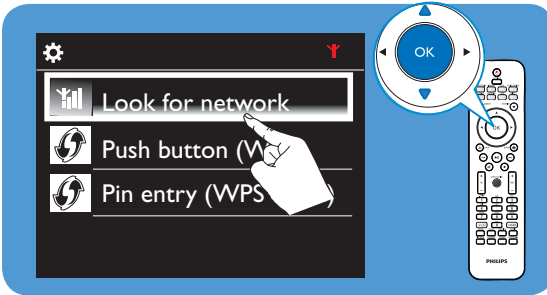
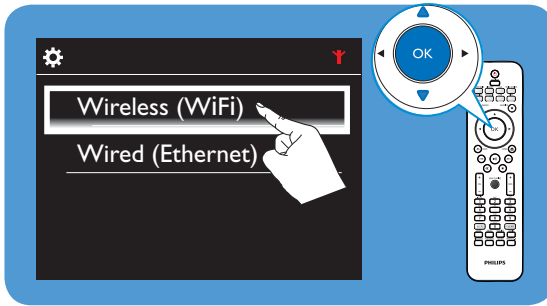

- DE Netzwerksleutel
- NL Clé réseau
- IT Chiave di rete



- DE Internetradio
- NL Internetradio
- IT Radio Internet

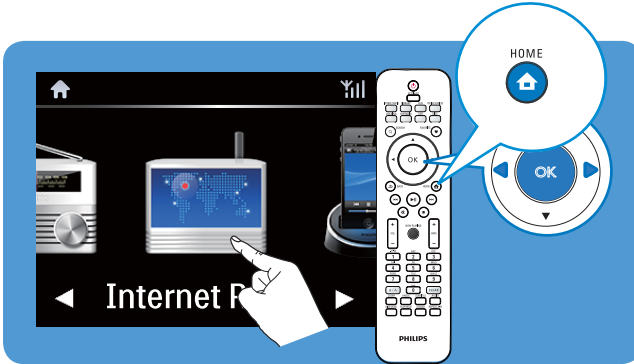

- DE Wiedergabe voreingestellter Radiosender
- NL Voorkeuzezenders luisteren
- IT Riproduzione di stazioni preimpostate

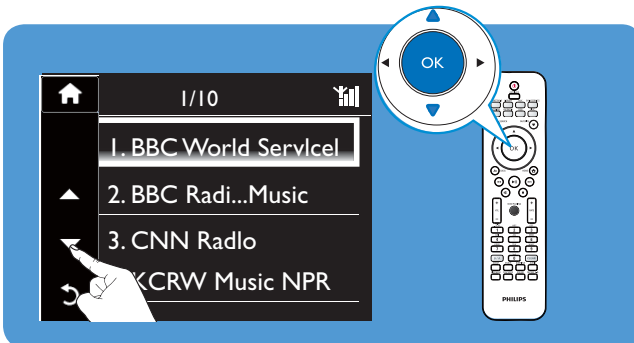
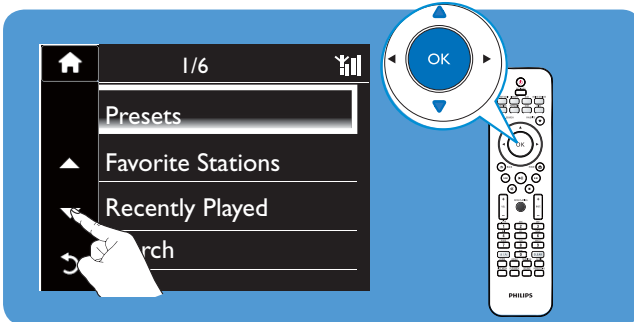



**DE** Wiedergeben eines voreingestellten Radiosenders

- Drücken Sie auf dem Wiedergabebildschirm die entsprechende Taste (0 – 9).

**Speichern voreingestellter Radiosender**

- Halten Sie auf dem Wiedergabebildschirm die entsprechende Taste (0 – 9) gedrückt.

**NL** Een voorkeuzezender beluisteren

- Druk op het afspeelscherm op de knop (0-9).

**Een voorkeuzezender opslaan**

- Houd op het afspeelscherm de knop (0-9) ingedrukt.

**IT** Riproduzione di una stazione preimpostata

- Sulla schermata di riproduzione, premere il tasto (0-9).

**Salvataggio di una stazione preimpostata**

- Sulla schermata di riproduzione, tenere premuto il tasto (0-9).

**DE** Suche nach Radiosendern

**NL** Radiozenders zoeken

**IT** Ricerca di stazioni radio

**DE** Nach Sendername

**NL** Op zendernaam

**IT** Per nome della stazione

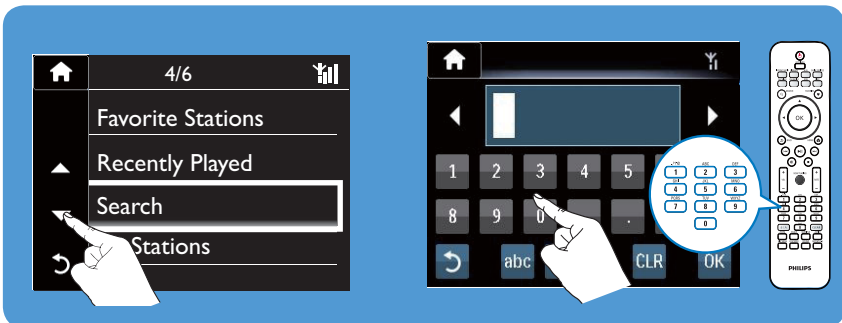





- DE Medienbibliothek
- NL Mediabibliotheek
- IT Archivio multimediale

- DE Übertragen von Musik von einem Computer
- NL Muziek van een computer streamen
- IT Riproduzione di musica in streaming dal computer

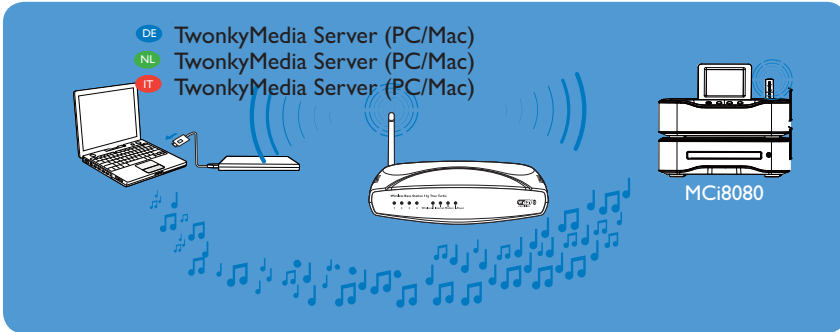

2 TwonkyMedia Server (PC/Mac)  
 Key: [xxxx]-[xxxx]-[xxxx]-[xxxx]-[xxxx]-[xxxx]-[xxxx]-[xxxx]

1

3

4 Server Settings

5 Browse...

6 Local Disk (C:)  
 Music



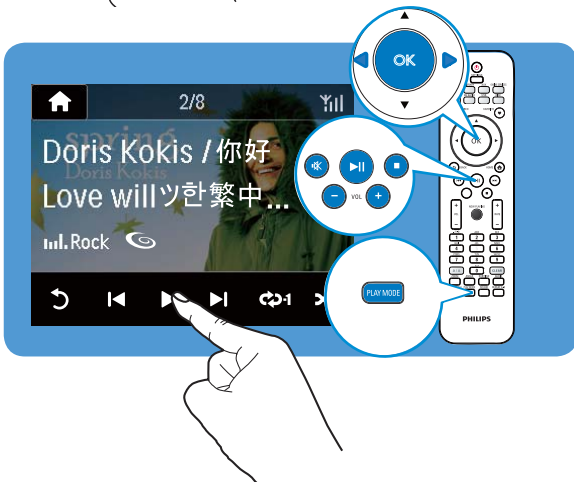
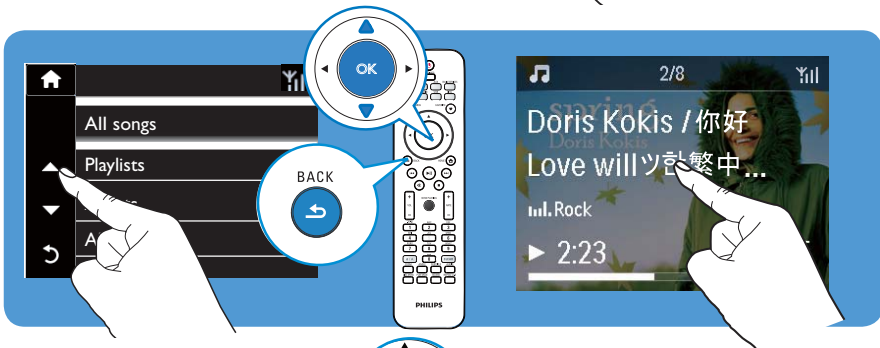
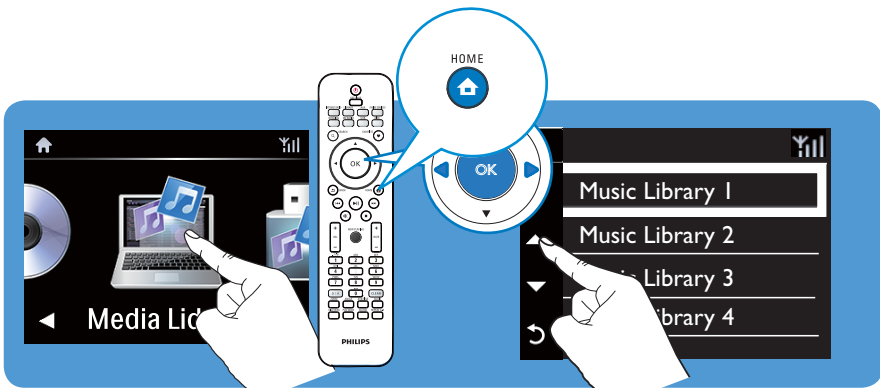



DE mit Festplatte  
NL HDD  
IT HDD

- DE Kabellose Übertragung von Mediendateien auf die Festplatte
- NL Mediabestanden draadloos overbrengen naar de HDD
- IT Trasferimento dei file multimediali sull'HDD tramite connessione wireless



DE Wiedergabe über das Festplattenlaufwerk

NL Afspelen vanaf de HDD

IT Riproduzione dall'HDD

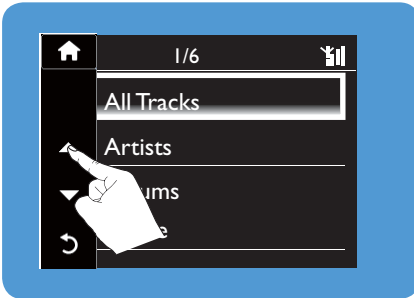
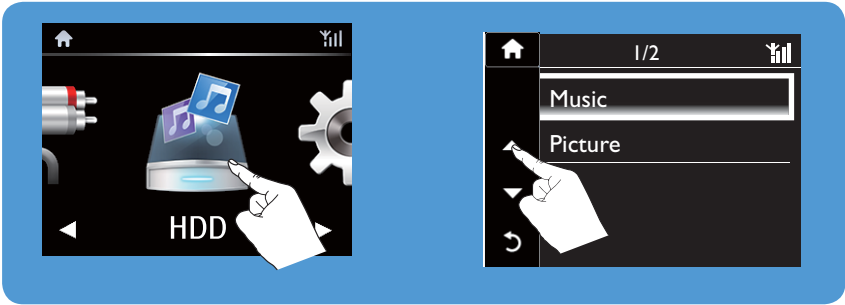



# Multiroom Music

DE

## Hinweis

Bevor Sie die Multiroom Music-Funktion aktivieren, stellen Sie folgendes sicher:

- Sowohl das MCi8080 als auch das NP3700 sind mit einem WiFi-Heimnetzwerk verbunden;
- Sie geben einen Titel von der Festplatte wieder, die an das MCi8080 angeschlossen ist.

NL

## Opmerking

Controleer voordat u de Multiroom Music-functie inschakelt of:

- Zowel de MCi8080 als de NP3700 is aangesloten op een Wi-Fi-thuisnetwerk;
- U een nummer afspeelt van de HDD die is aangesloten op de MCi8080.

IT

## Nota

Prima di abilitare la funzione Multiroom Music, verificare che:

- Le unità MCi8080 e NP3700 siano entrambe collegate a una rete Wi-Fi domestica;
- Si stia ascoltando una canzone dall'HDD collegato all'unità MCi8080.

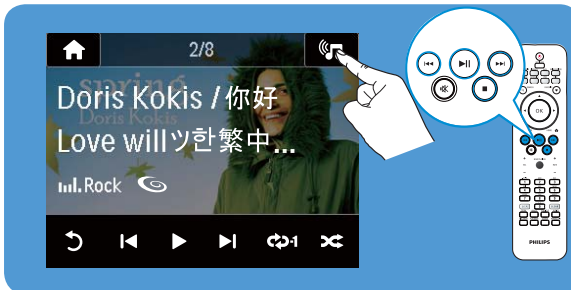

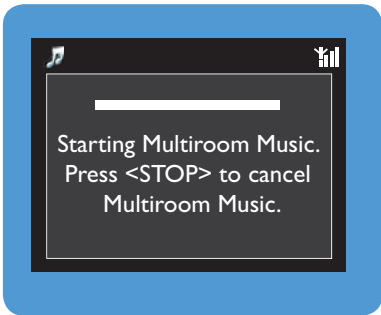

DE

Registrieren

NL

Registreren

IT

Registrazione

**DE** Registrieren Sie das MCi8080 direkt unter [www.philips.com/welcome](http://www.philips.com/welcome). Ihnen stehen folgende Funktionen zur Verfügung:

- Verwalten Ihrer persönlichen Lieblingsradiosender;
- Empfangen von Streamium-Newslettern.

**NL** Registreer uw MCi8080 direct op [www.philips.com/welcome](http://www.philips.com/welcome). U kunt:

- Uw favoriete radiozenders beheren;
- Streamium-nieuwsbrieven ontvangen.

**IT** Enregistrez directement votre MCi8080 sur [www.philips.com/welcome](http://www.philips.com/welcome). Vous pouvez effectuer les opérations suivantes :

- Gestire le stazioni radio preferite.
- Ricevere la newsletter di Streamium.

The screenshot shows the registration process on the Philips website. Step 1 highlights the URL <http://www.welcome.philips.com/> in the browser address bar. Step 2 points to the 'Choose Country/Language' dropdown menu. Step 3 highlights the 'Register my product' button. Step 4 highlights the 'Create an account' button in the 'Club Philips Login' section.

**1** <http://www.welcome.philips.com/>

**2** Choose Country/Language

**3** Register my product

**4** Create an account

philips.com

Please log in or register  
[Login or register](#)

**Step 1: Create your account**

Club Philips  
 Registered Products  
 Account

Consumer Products  
 Catalogue

**Personal Information** Items marked with a blue asterisk \* are required. Please review and accept our privacy policy; please read our privacy policy for more information.

\* First Name:

\* Last Name:

\* Surname:  (Mr. / F. / Ms.)

\* Date of Birth:  /  /

Street name:

House number:

City:

State / Province:

Postcode:

Telephone: +34

\* Country:  (United Kingdom)

**Login Information**

\* Email address:  abc@

Your Communication Preferences

Club  
**PHILIPS**

You are here: Home > Consumer Products > Philips registration

Welcome, Shuo!  
[Logout](#)

Club Philips  
**Registered Products**  
 Account

Consumer Product

**Step 2: Your product**  
 Please select the product you want to register

**Find your product**

**Model number or keyword**

[How to find the model number](#)

**CE 0560** !

Model No.: MC i 8080/12  
 220-240V~  
 50/60Hz 50W

PGC  
 AE68

Made in China

**Model No.: MC i 8080/12**

Serial No.: PT1A1031000001

**Register your product**  
 Please enter purchase information for your product.

Network music players — MC i 8080/12

**Wireless audio products**

Philips Streamium Network Music Player MCI 8080  
 Free Internet radio Full colour display with FullSound™

Date of purchase:  2009-11-25

Place of purchase:

You are about to register a Streamium device. To complete the registration and Stream configuration, please enter the Product Registration ID.

Product Registration ID:

[How to find Product Registration ID?](#)

HOME

OK

Settings

14/16

Check for software ...

Demo mode

**Device ID and infor...**

Restore factory settings ...



DE

## Hilfe

Weitere Informationen erhalten Sie im Benutzerhandbuch auf der mitgelieferten Festplatte (HDD). Unter [www.philips.com/support](http://www.philips.com/support) finden Sie außerdem Videolernprogramme, häufig gestellte Fragen (FAQs) und weitere Informationen.

DE

## Aktualisierungen zu Streamium

Besuchen Sie uns unter [www.streamiumtheblog.com](http://www.streamiumtheblog.com).

NL

## Hulp

Raadpleeg voor meer informatie de gebruikershandleiding op de meegeleverde harde schijf (HDD). Op [www.philips.com/support](http://www.philips.com/support) vindt u tevens de video-tutorials, veelgestelde vragen (FAQ's) en andere informatie.

NL

## Updates voor Streamium

Ga naar [www.streamiumtheblog.com](http://www.streamiumtheblog.com).

IT

## Aiuto

Per ulteriori informazioni fare riferimento al manuale dell'utente all'interno dell'unità disco rigido (HDD) in dotazione. È possibile trovare le guide filmate, le domande frequenti (FAQ) e altre informazioni sul sito Web [www.philips.com/support](http://www.philips.com/support).

IT

## Aggiornamenti Streamium

Visitare [www.streamiumtheblog.com](http://www.streamiumtheblog.com).

# High Fidelity Wi-Fi Multiroom System



WMS8080



MCI8080



NP3500



NP3700



NP3900



Be responsible  
Respect copyrights

Specifications are subject to change without notice.  
Trademarks are the property of Koninklijke Philips Electronics N.V. or their respective owners  
© 2011 Koninklijke Philips Electronics N.V.  
All rights reserved.  
[www.philips.com](http://www.philips.com)



Printed in China  
\_WK1104.1