

PHILIPS

Clock radio

DR402



User manual

Register your product and get support at
www.philips.com/support

Contents

1	Important	2
	Safety	2
2	Your clock radio	3
	Introduction	3
	What's in the box	3
	Overview of the clock radio	4
3	Get started	5
	Install battery	5
	Connect power	5
	Set clock	6
	Turn on	6
4	Listen to FM radio	7
	Prepare FM antenna	7
	Tune to FM radio stations	7
	Store FM radio stations automatically	7
	Store FM radio stations manually	8
	Select a preset FM radio station	8
	Adjust volume	8
5	Set alarm timer	9
	Set alarm	9
	Activate/deactivate alarm timer	9
	Snooze/ Stop the alarm	9
6	Other features	10
	Set sleep timer	10
	Adjust display brightness	10
	Night light	10
	Charging device via USB port	11
7	Product information	12
	Specifications	12
8	Troubleshooting	13
9	Notice	14
	Care of the environment	14

I Important

Safety



Warning

- Never remove the casing of this clock radio.
 - Never lubricate any part of this clock radio.
 - Never place this clock radio on other electrical equipment.
 - Keep this clock radio away from direct sunlight, naked flames or heat.
 - Make sure that you always have easy access to the power cord, plug or adaptor to disconnect the clock radio from the power.
-
- Read and follow these instructions.
 - Make sure that there is enough free space around the clock radio for ventilation.
 - Only use attachments/accessories specified by the manufacturer.
 - Use only power supplies listed in the user manual.
 - Unplug this clock radio during lightning storms or when unused for long periods of time.
 - Battery usage CAUTION – To prevent battery leakage which may result in bodily injury, property damage, or damage to the clock radio:
 - Install the battery correctly, + and - as marked on the clock radio.
 - Remove the battery when the clock radio is not used for a long time.
 - The battery shall not be exposed to excessive heat such as sunshine, fire or the like.
 - The clock radio shall not be exposed to dripping or splashing.
 - Do not place any sources of danger on the clock radio (e.g. liquid filled objects, lighted candles).

- Where the plug of the Direct Plug-in Adapter is used as the disconnect device, the disconnect device shall remain readily operable.

Risk of swallowing batteries!

- The device may contain a coin/button type battery, which can potentially be swallowed. Keep the battery out of reach of children at all times! If swallowed, the battery can cause serious injury or death. Severe internal burns can occur within two hours of ingestion.
- If you suspect that a battery has been swallowed or placed inside any part of the body, seek immediate medical attention.
- When you change the batteries, always keep all new and used batteries out of reach of children. Make sure that the battery compartment is completely secure after you replace the battery.
- If the battery compartment cannot be completely secured, discontinue use of the product. Keep out of reach of children and contact the manufacturer.



Note

- The type plate is located at the back of the apparatus

2 Your clock radio

Congratulations on your purchase, and welcome to Philips! To fully benefit from the support that Philips offers, register your product at www.philips.com/welcome.

Introduction

With this clock radio, you can:

- listen to FM radio;
- charge your mobile devices; and
- set two alarms to ring at different time.

What's in the box



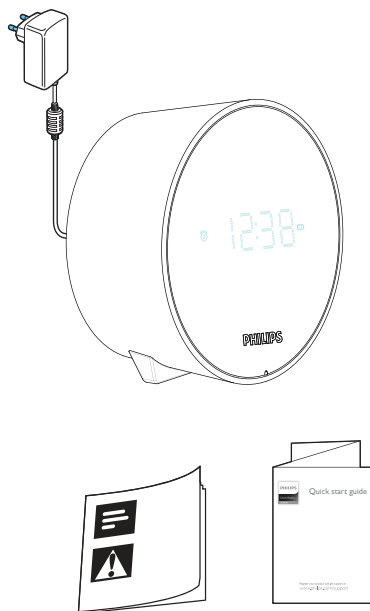

Check and identify the contents of your package:

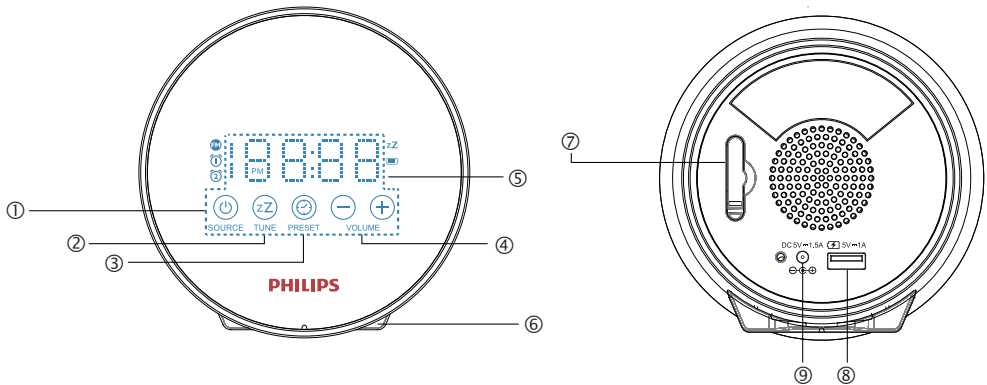

- Clock radio
- Printed materials

Overview of the clock radio



- ① **Source/** 
 - Turn the radio on or off
 - Set alarm (long press)
- ② **TUNE/** 
 - Activate radio tuning (FM mode)
 - Set sleep timer
- ③ **PRESET/** 
 - Scan and store radio stations (FM mode)
 - Adjust display brightness
- ④ **VOLUME/**  
 - Adjust volume (FM mode)
 - Tune to FM radio stations (FM mode)
 - Adjust hour and minute
 - Adjust 12/24 hour format
- ⑤ **Clock / Display panel**
 - Activate touch keys
 - Show current status
- ⑥ **Snooze**
 - Snooze the alarm
- ⑦ **Battery compartment**
- ⑧ **USB charging port**
 - Charge your mobile devices
- ⑨ **Power adapter jack**

3 Get started

Always follow the instructions in this chapter in sequence.

Install battery

! Caution

- Risk of explosion! Keep the battery away from heat, sunshine or fire. Never discard battery in fire.
- Danger of explosion if battery is incorrectly replaced. Replace only with the same or equivalent type.
- The battery contains chemical substances, so it should be disposed of properly.

≡ Note

- You can only use AC power as power supply. The lithium CR2032 battery can only back up clock and alarm settings.
- When power is disconnected, the display backlight is off.

For first-time use:

Remove the protective tab to activate the battery.

To replace the battery:

- 1 Push the clip to the left and pull out the battery tray.

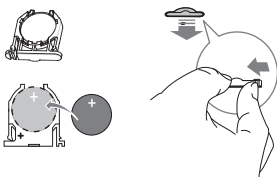
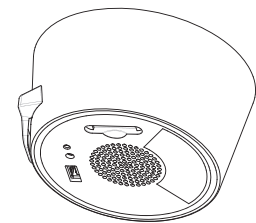

- 2 Insert 1 × CR2032 battery as illustrated.

Connect power

! Caution

- Risk of product damage! Make sure that the power voltage corresponds to the voltage printed on the back or underside of the clock radio.
- Risk of electric shock! When you unplug the AC plug, always pull the plug from the socket. Never pull the cord.

Connect the power adaptor to the wall outlet.

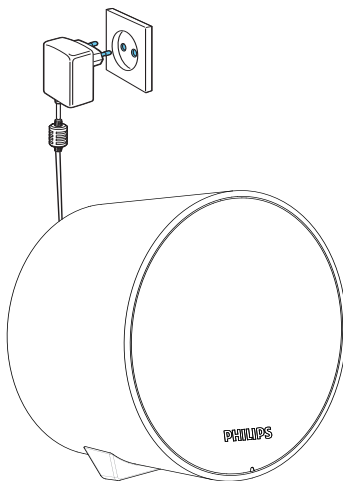

Set clock

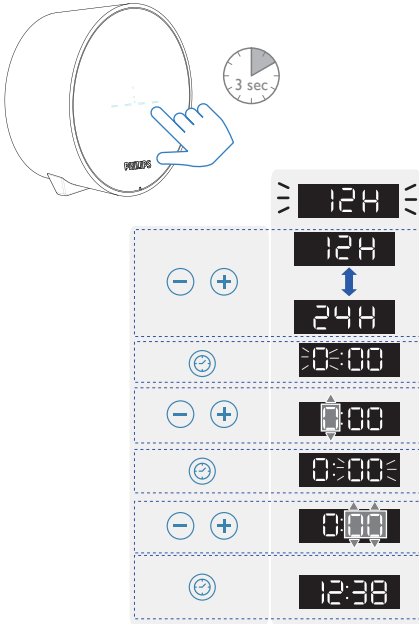

- 1 Long press clock surface for 3 seconds to activate clock setting.
↳ [12H] begins to blink.
- 2 Press to set 12/24 hour format.
- 3 Press to confirm.
- 4 Press repeatedly to set hour.
- 5 Press to confirm.
- 6 Press repeatedly to set minute.
- 7 Press to confirm.
↳ The set time is displayed.

Turn on

Press to turn on the radio.

- ↳ The product switches to FM tuner mode.

4 Listen to FM radio

Prepare FM antenna

For better reception, fully extend and adjust the position of the pig-tail antenna.

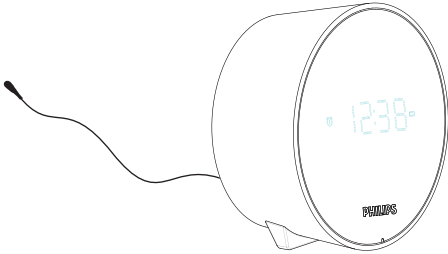

Note

- To prevent interference, position the antenna as far as possible from any other electrical appliances.

Tune to FM radio stations

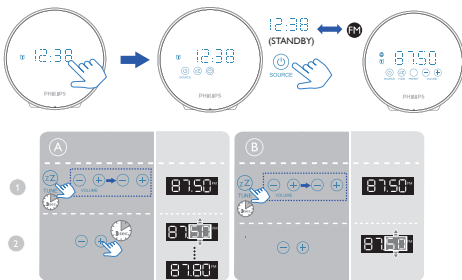

- 1 Touch clock surface to activate touch keys.
- 2 Press to turn on FM radio.
- 3 Press and hold **TUNE** for three seconds.
↳ →
- 4 Press and hold / for three seconds.

- ↳ The clock radio tunes to a station with strong reception automatically.

- 5 Repeat step 4 to tune to more radio stations.

To tune to a station manually

In tuner mode, press / repeatedly to select a frequency.

Store FM radio stations automatically

Note

- You can store a maximum of 20 FM radio stations.

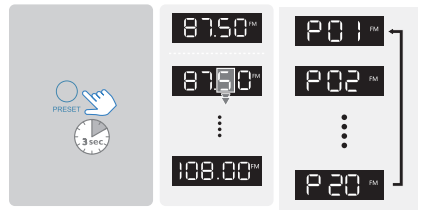

In FM tuner mode, press and hold for three seconds.





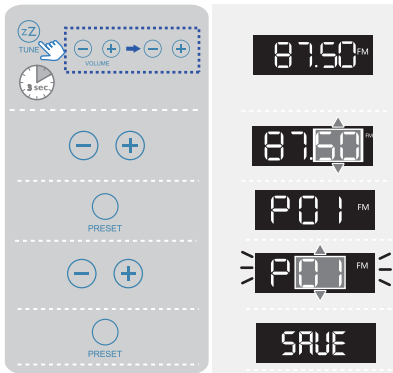

- ↳ The clock radio stores all the available FM radio stations automatically.
- ↳ The first available stations broadcasts automatically.

Store FM radio stations manually

Note

- You can store a maximum of 20 FM radio stations.





- 1** In FM tuner mode, press and hold **TUNE** for three seconds.
↳ 
- 2** Press  /  repeatedly to select a frequency.
- 3** Press  to confirm.
↳ The preset number begins to blink.
- 4** Press  /  to select a number.
- 5** Press  to confirm.
- 6** Repeat step **2** to **5** to store other stations.

Note



- To remove a pre-stored station, store another station in its place.

Select a preset FM radio station

In FM tuner mode, press .

Press  /  repeatedly to select a preset radio station.

Adjust volume

While listening to FM radio, press   repeatedly to increase or decrease volume.

5 Set alarm timer

Set alarm

You can set two alarms to ring at different time.

Note

- Make sure that you have set the clock correctly.

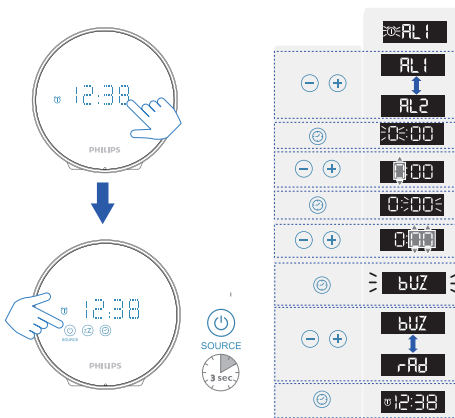

- 1 Touch clock surface to activate touch keys.
- 2 Press and hold for three seconds to activate alarm setting mode.
- 3 Press to select AL1 or AL2.
- 4 Press to confirm.
→ The hour digits begin to blink.
- 5 Press repeatedly to set the hour.
- 6 Press to confirm.
→ The minute digits begin to blink.
- 7 Press repeatedly to set the minute.
- 8 Press to confirm.
- 9 Press to select alarm source: buzzer or last listened FM station.
- 10 Press to confirm.

Activate/deactivate alarm timer

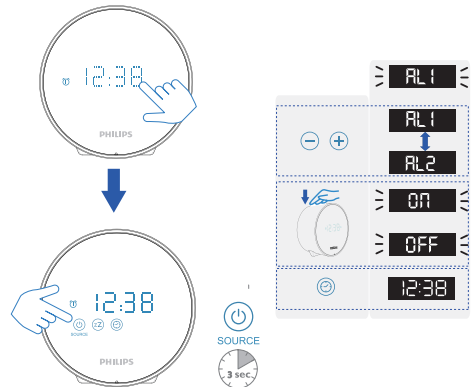

- 1 Touch clock surface to activate touch keys.
- 2 Press and hold for three seconds to activate alarm setting mode.
- 3 Press to select AL1 or AL2.
- 4 Press the top of the clock to select alarm on or off.
- 5 Press to confirm.

Snooze/ Stop the alarm

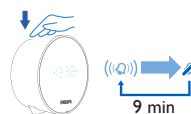

When the alarm goes off, press the top of the clock to trigger SNOOZE.

- The alarm snoozes and repeats ringing nine minutes later.



When the alarm goes off, press the clock display to stop the alarm.

- The alarm repeats ringing for the next day.

6 Other features

Set sleep timer

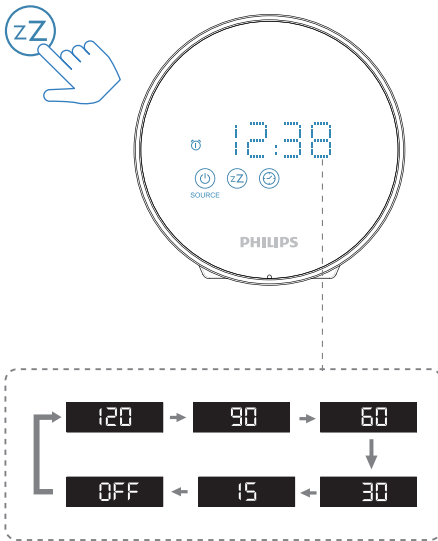

Press **zZ** repeatedly to select sleep timer period (in minutes).

→ The clock radio switches to standby mode automatically after the preset period.

To deactivate the sleep timer:

In sleep timer setting mode, press **zZ** repeatedly until **[OFF]** appears.

Adjust display brightness

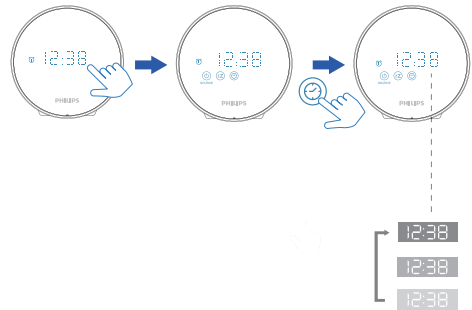

- 1 Touch clock surface to activate touch keys.
- 2 Press **☺** repeatedly to select different brightness levels:
 - High
 - Medium
 - Low

Night light



High
↓
Low
↓
Off

At standby mode, press the top of the clock repeatedly to select different brightness levels of the night light.

- High
- Low
- Off

Charging device via USB port

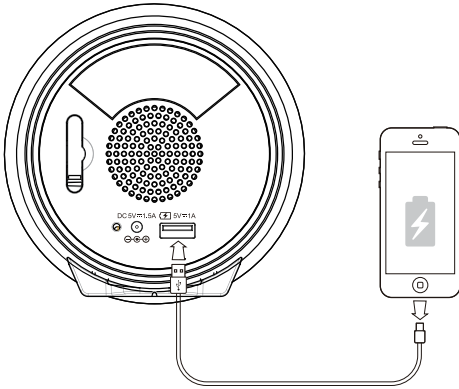

Connect the standard size end of a USB cable (not included) to the USB Port on back of the unit and connect the other end to the charging port on your device.

7 Product information



Note

- Product information is subject to change without prior notice.

Specifications

Amplifier

Total Output Power	1W RMS
--------------------	--------

Tuner (FM)

Tuning Range	87.5-108 MHz
Tuning Grid	50 KHz
Preset Station	20
USB Charging	DC 5V, 1A / Type-A socket

General information

Power supply - AC Power	Brand name: PHILIPS;
	Model: ASI50-050-AEI50
	Input: 100-240V~, 50/60Hz, 0.7A;
	Output: 5V 1.5A
Power supply - Battery (clock backup)	CR2032
Standby Power Consumption	<1 W
Dimensions - Main Unit (W x H x D)	110 x 110 x 55mm
Weight - Main Unit	0.27 kg
Weight - With Packing	0.47 kg

8 Troubleshooting



Warning

- Never remove the casing of this device.

To keep the warranty valid, never try to repair the system yourself.

If you encounter problems when using this device, check the following points before requesting service. If the problem remains unsolved, go to the Philips Web page (www.philips.com/support). When you contact Philips, make sure that the device is nearby and the model number and serial number are available.

No power

- Make sure that the AC power plug of the clock radio is connected properly.
- Make sure that there is power at the AC outlet.

No response from the clock radio

- Disconnect and reconnect the AC power plug, then turn on the clock radio again.

Poor radio reception

- Keep the clock radio away from other electronic devices to avoid radio interference.
- Fully extend and adjust the position of the pig-tail antenna.

Alarm does not work

- Set the clock/alarm correctly.

9 Notice

Any changes or modifications made to this device that are not expressly approved by MMD Hong Kong Holding Limited may void the user's authority to operate the equipment. Hereby, MMD Hong Kong Holding Limited declares that this product is in compliance with the essential requirements and other relevant provisions of Directive 2014/53/EU. You can find the Declaration of Conformity on www.philips.com/support

Care of the environment

Disposal of your old product and battery



Your product is designed and manufactured with high quality materials and components, which can be recycled and reused.



This symbol on a product means that the product is covered by European Directive 2012/19/EU.



This symbol means that the product contains batteries covered by European Directive 2013/56/EU which cannot be disposed of with normal household waste.

Inform yourself about the local separate collection system for electrical and electronic products and batteries. Follow local rules and never dispose of the product and batteries with normal household waste. Correct disposal of old

products and batteries helps prevent negative consequences for the environment and human health.

Removing the disposable batteries

To remove the disposable batteries, see battery installation section.

Environmental information

All unnecessary packaging has been omitted. We have tried to make the packaging easy to separate into three materials: cardboard (box), paper pulp (buffer) and polyethylene (bags, protective foam sheet.)

Your system consists of materials which can be recycled and reused if disassembled by a specialized company. Please observe the local regulations regarding the disposal of packaging materials, exhausted batteries and old equipment.



2019 © Philips and the Philips Shield Emblem are registered trademarks of Koninklijke Philips N.V. and are used under license. This product has been manufactured by and is sold under the responsibility of MMD Hong Kong Holding Limited or one of its affiliates, and MMD Hong Kong Holding Limited is the warrantor in relation to this product.

