

Always there to help you

Register your product and get support at
www.philips.com/support

AE5600



User manual

PHILIPS

Contents

1	Important	2
	Safety	2
	Notice	3

2	Your Portable Radio	4
	Introduction	4
	About DAB	4
	What's in the box	4
	Overview of the main unit	5

3	Get started	7
	Connect power	7
	Turn on	8

4	Listen to radio	9
	Listen to DAB radio	9
	Listen to FM radio	10
	Use system menu in FM/DAB mode	11

5	Other features	13
	Play audio from an external device	13
	Adjust the volume level	13
	Listen through a headphone	13

6	Product information	14
	Amplifier	14
	Tuner	14
	Speakers	14
	General information	14

7	Troubleshooting	15
----------	------------------------	-----------

1 Important



Safety

- Make sure that there is enough free space around the product for ventilation.
- Only use attachments or accessories specified by the manufacturer.
- Battery usage CAUTION – To prevent battery leakage which may result in bodily injury, property damage, or damage to the product:
 - Install the batteries correctly, + and - as marked on the product.
 - Do not mix batteries (old and new or carbon and alkaline, etc.).
 - Remove the batteries when the product is not used for a long time.
 - The batteries shall not be exposed to excessive heat such as sunshine, fire or the like.
- Use only power supplies listed in the user manual.
- The product shall not be exposed to dripping or splashing.
- Do not place any sources of danger on the product (e.g. liquid filled objects, lighted candles).
- Where the mains plug or an appliance coupler is used as the disconnect device, the disconnect device shall remain readily operable.

Hearing safety

A pleine puissance, l'écoute prolongée du baladeur peut endommager l'oreille de l'utilisateur.

Warning

- To prevent possible hearing damage, do not listen at high volume levels for long periods.

The maximum output voltage of headphone is not greater than 150 mV.

Listen at a moderate volume.

- Using headphones at a high volume can impair your hearing. This product can produce sounds in decibel ranges that may cause hearing loss for a normal person, even for exposure less than a minute. The higher decibel ranges are offered for those that may have already experienced some hearing loss.
- Sound can be deceiving. Over time your hearing 'comfort level' adapts to higher volumes of sound. So after prolonged listening, what sounds 'normal' can actually be loud and harmful to your hearing. To guard against this, set your volume to a safe level before your hearing adapts and leave it there.

To establish a safe volume level:

- Set your volume control at a low setting.
- Slowly increase the sound until you can hear it comfortably and clearly, without distortion.

Listen for reasonable periods of time:

- Prolonged exposure to sound, even at normally 'safe' levels, can also cause hearing loss.
- Be sure to use your equipment reasonably and take appropriate breaks.

Be sure to observe the following guidelines when using your headphones.

- Listen at reasonable volumes for reasonable periods of time.
- Be careful not to adjust the volume as your hearing adapts.
- Do not turn up the volume so high that you can't hear what's around you.
- You should use caution or temporarily discontinue use in potentially hazardous situations. Do not use headphones while operating a motorized vehicle, cycling, skateboarding, etc.; it may create a traffic hazard and is illegal in many areas.

With a lower priority than speaker output, headphone output is just an additional option.



This symbol on a product means that the product is covered by European Directive 2012/19/EU. Inform yourself about the local separate collection system for electrical and electronic products. Follow local rules and never dispose of the product with normal household waste. Correct disposal of old products helps prevent negative consequences for the environment and human health.

Class II equipment symbol



This symbol indicates that the unit has a double insulation system.

Environmental information

All unnecessary packaging has been omitted. We have tried to make the packaging easy to separate into three materials: cardboard (box), polystyrene foam (buffer) and polyethylene (bags, protective foam sheet.)

Your system consists of materials which can be recycled and reused if disassembled by a specialized company. Please observe the local regulations regarding the disposal of packaging materials, exhausted batteries and old equipment.

Notice

Any changes or modifications made to this device that are not expressly approved by WOOX Innovations may void the user's authority to operate the equipment.

Notice for the European Union



Hereby, WOOX Innovations declares that this product is in compliance with the essential requirements and other relevant provisions of Directive 1999/5/EC.

Disposal of your old product



Your product is designed and manufactured with high quality materials and components, which can be recycled and reused.

Note

- The type plate is located on the bottom of the apparatus.

2 Your Portable Radio

Congratulations on your purchase, and welcome to Philips! To fully benefit from the support that Philips offers, register your product at www.philips.com/welcome.

Introduction

With this unit, you can:

- know the time;
- enjoy both FM radio and Digital Audio Broadcasting (DAB) radio;
- enjoy audio from an external device.

About DAB

About Digital Audio Broadcasting (DAB)

DAB digital radio is a new way of broadcasting radio via a network of terrestrial transmitters. It provides listeners with more choice and information delivered in crystal clear, crackle-free sound quality.

– The technology allows the receiver to lock on to the strongest signal it can find.

– With DAB digital stations there are no frequencies to remember; and sets are tuned by station name, so there's no returning on the move.

What is a multiplex?

Digital radio operation is made up of a single block of frequencies called a multiplex. Each multiplex works within a frequency spectrum, such as Band III for DAB broadcasts.

DAB BROADCASTERS AND DLS

Each DAB broadcaster (or multiplex operator) also provides text and audio data services. Some programmes are supported by Dynamic Label Segments (DLS). This is data which you can read as scrolling text on your DAB radio display. Some stations transmit the latest news, travel, and weather; what's on now and next, website addresses and phone numbers.

For more information on digital radio coverage and services, please visit: www.drdb.org.

What's in the box

Check and identify the contents of your package:

- Main unit
- Power adapter
- Printed materials

Overview of the main unit

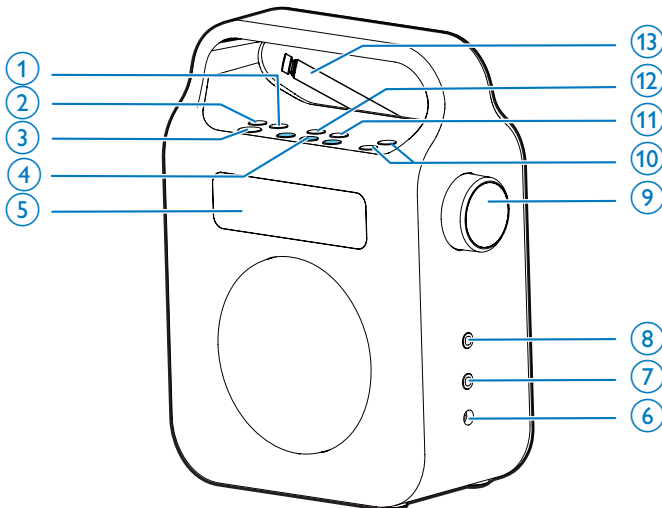

① PRESET

- In DAB/FM mode, enter programming mode.
- In DAB/FM mode, enter the preset selection menu.

② SOURCE

- Select a source: DAB Mode, FM Mode, or Auxiliary Input.

③

- Turn on the radio or switch to standby mode.

④ Numeric keys 1 - 3

- Set or select a preset radio station.

⑤ Display panel

- Display the time/radio information.

⑥ DC IN

- Power socket.

⑦ AUDIO IN

- 3.5mm audio input socket for connection of an external audio device.

⑧

- Headphone socket.

⑨ VOLUME +/- knob

- Adjust volume.

⑩ + TUNING -

- Tune to a radio station.
- Select a preset number during programming.
- Select a preset radio station in the preset selection menu.

⑪ INFO/MENU

- In DAB mode, press to display DAB station information.
- In DAB mode, press and hold to enter the DAB menu.
- In FM mode, press to display RDS station information.
- In FM mode, press and hold to enter the FM menu.

⑫ SCAN/SELECT

- Scan radio stations automatically.
- Confirm DAB station selection.
- Confirm menu selection.
- Confirm preset selection.

⑬ Antenna

- Improve radio reception.

3 Get started

! Caution

- Use of controls or adjustments or performance of procedures other than herein may result in hazardous radiation exposure or other unsafe operation.

Always follow the instructions in this chapter in sequence.

Connect power

You can use this radio on either AC power or battery power.

Battery Life (Approx. hours)

When using	FM	DAB
R14 (size C)	22	22

Option 1: AC power

! Caution

- Risk of product damage! Make sure that the power supply voltage corresponds to the voltage printed on the back or the underside of the product.
- Risk of electric shock! When you unplug the AC adapter; always pull the plug from the socket. Never pull the cord.
- Use only the AC adapter specified by the manufacturer or sold with this unit.

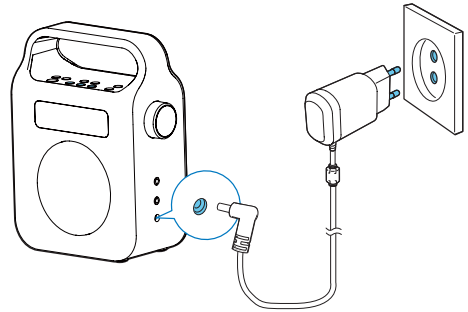

- 1 Connect one end of the AC adapter to the DC input socket on the main unit.
- 2 Connect the other end of the AC adapter to the wall outlet.

Option 2: Battery power

! Caution

- Batteries (battery pack or batteries installed) shall not be exposed to excessive heat such as sunshine, fire or the like.
- Danger of explosion if battery is incorrectly replaced. Replace only with the same equivalent type.
- Do not mix batteries (old and new or carbon and alkaline, etc.).
- Remove batteries if they are exhausted or if the unit is not to be used for a long time.

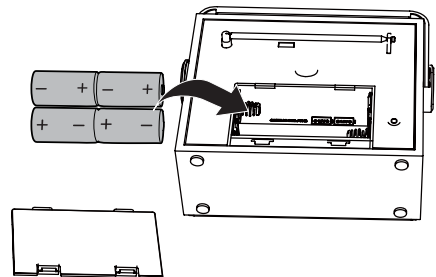

- 1 Open the battery compartment at the back of the unit.
- 2 Insert four R14/UM-2/C size batteries (not supplied) with correct polarity (+/-) as indicated, then close the battery compartment.
 - ↳ The unit is ready to operate.

Caution

- A 'Battery low' message is shown when the battery power is low. Replace batteries or connect to AC power to ensure normal operation.

Note

- Batteries contain chemical substances, so they should be disposed of properly.

Turn on

- Press \odot to turn on the radio.
 - ↳ The radio switches to the last selected source.
 - ↳ For first-time use, the unit shows a welcome message and switches to DAB mode to start automatic scanning for available DAB stations.
- Press \odot again to switch the radio to standby mode.
 - ↳ The clock and date information (if set) displays on the panel.

4 Listen to radio

Listen to DAB radio

Tune to DAB radio stations

Note

- Make sure that the antenna is fully extended.

- 1 Press **SOURCE** repeatedly to select DAB radio.
 - ↳ **[Scanning...]** (scanning) is displayed.
- 2 Press **SCAN/SELECT** to start full scan.
 - ↳ The unit stores all the DAB radio stations automatically and then broadcasts the first available station.
 - ↳ The station list is memorized in the unit. Next time when you turn on the unit, the station scan does not take place.
 - ↳ If no DAB station is found, **[No DAB Station]** (no DAB station) appears, then **[Full Scan]** (full scan) is displayed.

To tune to a station from the available station list:

- In DAB mode, press **TUNING +/-** to navigate through the available DAB stations.

Program DAB radio stations

Note

- New stations and services will be added in the DAB broadcast. To make new DAB stations and services available, perform full scan regularly.
- You can store up to 20 preset DAB radio stations.

Store DAB radio stations automatically

- In DAB mode, press **SCAN/SELECT**.
 - ↳ The unit scans all the available DAB radio stations and broadcasts the first available station.

Store DAB radio stations manually

- 1 Tune to a DAB radio station.
- 2 Press and hold **PRESET** to enter programming mode.
- 3 Press **+ TUNING -** repeatedly to select a preset number; then press **SCAN/SELECT** to confirm and save the station to the corresponding preset number.
- 4 Repeat steps 1 to 3 to store more favorite DAB stations.

Note

- To remove a preset DAB radio station, store another station in its place.
- At the above step 2, you can also press and hold a numeric key (1 -3) to save the station as one of your favorite three preset stations.

Select a preset DAB radio station

- 1 In DAB mode, press **PRESET** to enter the preset selection menu.
- 2 Press **+ TUNING -** to select a preset number.
- 3 Press **SCAN/SELECT** to confirm.

To select one of your favorite three preset DAB stations:

- Press the numeric key **1 - 3** directly.

Show DAB information

- During DAB radio broadcast, press **INFO/MENU** repeatedly to scroll through the following information (if available):
 - ↳ Station name
 - ↳ Dynamic Label Segment (DLS)

- ↳ Signal strength
- ↳ Program type (PTY)
- ↳ Ensemble Name
- ↳ Channel and frequency
- ↳ Signal error rate
- ↳ Bit rate and audio status
- ↳ Time
- ↳ Date

Use DAB menu

- 1 In DAB mode, press and hold **INFO/MENU** to access the DAB menu.
- 2 Press **TUNING +/-** to scroll through the menu options:
 - **[Full scan]**: scan all the available DAB radio stations.
 - **[Manual tune]**: tune to a specific channel/frequency manually and add it to the station list.
 - **[DRC]**: add or remove a degree of compensation for the differences in the dynamic range between radio stations.
 - **[Prune]**: Remove all the invalid stations from the station list.
 - **[System]**: Adjust system settings.
- 3 To select an option, press **SCAN/SELECT**.
- 4 Repeat steps 2 - 3 if any sub-option is available under an option.

[System]

- **[Time]**: set time and date; set date format; select 24H or 12H mode; and set time synchronization.
- **[Factory Reset]**: reset all the settings to factory default.
- **[Software Upgrade]**: update software if available.
- **[SW version]**: know the software version of the unit.

Tip

- Select **[System] > [Time] > [Auto Sync] > [DAB]** to set time synchronization. The clock radio will synchronize time with DAB signal.

Note

- If no button is pressed within 10 seconds, the menu exits.

Listen to FM radio

Tune to FM radio stations

- 1 Press **SOURCE** repeatedly to select FM radio.
- 2 Press **TUNING +/-** to tune to a radio station.
- 3 Press **SCAN/SELECT** or press and hold **TUNING +/-** to tune to the next strongest radio station.

Program FM radio stations

Note

- You can store up to 20 preset FM radio stations.

Store FM radio stations automatically

- In FM tuner mode, press and hold **SCAN/SELECT**.
 - ↳ The unit stores all the available FM radio stations and broadcasts the first station.

Store FM radio stations manually

- 1 Tune to an FM radio station.
- 2 Press and hold **PRESET** to enter programming mode.

- 3 Press **+ TUNING** - repeatedly to select a preset number; then press **SCAN/SELECT** to confirm and save the station to the corresponding preset number.
- 4 Repeat steps 1 to 3 to store more favorite FM stations.



Note

- To remove a preset FM radio station, store another station in its place.
- At the above step 2, you can also press and hold a numeric key (1 -3) to save the station as one of your favorite three preset stations.

Select a preset FM radio station

- 1 In FM mode, press **PRESET** to enter the preset selection menu.
- 2 Press **+ TUNING** - to select a preset number.
- 3 Press **SCAN/SELECT** to confirm.

To select one of your favorite three preset FM stations:

- Press the numeric key **1 - 3** directly.

Use FM menu

- 1 In FM mode, press and hold **INFO/MENU** to access the FM menu.
- 2 Press **TUNING +/-** to scroll the menu options:
 - **[Scan setting]**
 - **[Stereo setting]**
 - **[System]** (see 'Use DAB menu' on page 9)
- 3 To select an option, press **SCAN/SELECT**.
- 4 Repeat steps 2-3 if any sub-option is available under an option.

Scan setting

- **[All stations]:** scan all the available radio stations.
- **[Strong station]:** scan stations with strong signals only.

Stereo setting

- **[Stereo allowed]:** select stereo broadcast.
- **[Forced mono]:** select mono broadcast.

Show RDS information

RDS (Radio Data System) is a service that allows FM stations to show additional information.

If you listen to an FM station with RDS signal, a RDS icon and the station name are displayed.

- 1 Tune to a RDS station.
- 2 Press **INFO/MENU** repeatedly to scroll through the following information (if available):
 - ↳ Station freq (No name)
 - ↳ Stereo/MONO
 - ↳ TIME
 - ↳ DATE

Use system menu in FM/DAB mode

Reset all the settings

- 1 In DAB/FM mode, press and hold **INFO/MENU**.
- 2 Press **TUNING +/-** until **[System]** (system) is displayed.
- 3 Press **SCAN/SELECT** to confirm.
 - ↳ **[Factory Reset]** (factory reset) is displayed.

- 4 Press **SCAN/SELECT** again.
↳ **[No] [Yes]** is displayed.
- 5 Press **TUNING +/-** to select **[Yes]** or **[No]**, then press **SCAN/SELECT** to confirm.
 - **[Yes]**: reset all the settings to factory default.
 - **[No]**: cancel.

Know the software version

- 1 Enter the system setting menu.
- 2 Press **TUNING +/-** until **[SW version]** (Software version) is displayed.
- 3 Press **SCAN/SELECT** to confirm.
↳ The software version of the unit is displayed.

5 Other features

Play audio from an external device

You can listen to audio from an external device through this radio.

- 1 Connect an audio cable to:
 - the **AUDIO IN** socket on the radio.
 - the headphone socket on the external device.
- 2 Press **⏻** to turn on the radio.
- 3 Press **SOURCE** repeatedly to select the Auxiliary Input mode.
- 4 Play the external device (refer to its user manual).

Adjust the volume level

- During play, rotate the **VOLUME +/-** knob to increase/decrease the volume level.

Listen through a headphone

- Plug a headphone (not supplied) into the  socket on the unit.

6 Product information



Note

- Product information is subject to change without prior notice.

Amplifier

Rated Output Power	2.7 W
Signal to Noise Ratio	> 57dBA
Total Harmonic Distortion	< 1%
AUDIO IN	650mV RMS

Tuner

Tuning Range	DAB: 174.928 - 239.200 MHz
	FM: 87.50 - 108.00 MHz
Tuning grid	FM: 50 KHZ
Sensitivity:	
- Mono, 26dB S/N Ratio	FM: < 22 dBf
- Stereo, 46dB S/N Ratio	FM: > 43 dBf
Search Sensitivity	FM: > 28 dBf
Total Harmonic Distortion	FM: < 3%
Signal to Noise Ratio	FM: > 55dB

Speakers

Speaker Impedance	4 ohm
Speaker Driver	3"

General information

AC power	Model:AS060-059-EE100 (Philips)
	Input:100-240V~, 50/60Hz 0.15A
	Output: 5.9V == 1A
Battery	6V, 4x1.5V Size "C"/R14/UM2 CELL
Operation Power Consumption	< 5 W
Standby Power Consumption	< 1 W
Dimensions	
- Main Unit (W x H x D)	138.5 x 186 x 79 mm
Weight (Main unit, without packing)	0.56 kg

7 Troubleshooting



Warning

- Never remove the casing of this apparatus.

To keep the warranty valid, never try to repair the system yourself.

If you encounter problems when using this apparatus, check the following points before requesting service. If the problem remains unsolved, go to the Philips web site (www.philips.com/welcome). When you contact Philips, ensure that the apparatus is nearby and the model number and serial number are available.

No power

- Make sure that the Mains cord is connected securely.
- Make sure that there is power at the AC Mains.
- Make sure that the batteries are inserted correctly.
- Make sure that the batteries are not used up.
- If a 'Battery Low' message appears on the screen, replace the batteries or use the AC power instead.

No sound

- Adjust the volume.
- Adjust volume on the connected device.
- Disconnect the headphone.

No response from the unit

- Reinstall the batteries and turn on the unit again.
- Disconnect and reconnect the AC power plug, then turn on the unit again.

Poor radio reception

- Increase the distance between the unit and your TV or other radiation sources.
- Fully extend the antenna.
- Adjust the position of the antenna.



Specifications are subject to change without notice.
2014 © WOOX Innovations Limited. All rights reserved.
This product was brought to the market by WOOX
Innovations Limited or one of its affiliates, further referred
to in this document as WOOX Innovations, and is the
manufacturer of the product. WOOX Innovations is the
warrantor in relation to the product with which this booklet
was packaged. Philips and the Philips Shield Emblem are
registered trademarks of Koninklijke Philips N.V.

AE5600_UM_12_V1.0

