



Philips SoClear
Cordless phone with
answering machine

60 min answering machine
1.9" display/ white backlight
Speakerphone



XL5951C

Comfortable and simple

Visual ringer, extra loud sound

Enjoy a visual ringer, so you can see incoming calls as well as hear them. With loud sound capabilities for easy listening, oversize buttons for easy dialing, and an inbuilt answering machine, it makes it all so simple on the XL5951C/DE.

Hear everything loud and clear

- Extra loud sound for clear voice reproduction
- Handset speakerphone allows you to talk handsfree
- Hearing aid compatible - reduces unwanted noise
- Optimized antenna layout for great reception in any room

Smart, simple and easy to use

- Up to 45 min. message on your answering machine
- Large display and easy to read characters
- Visual ringer flashes to alert you of incoming calls
- Instantly call your loved ones via speed-dial keys
- Ultimate convenience through easy setup
- Up to 19 hours talk time on a single charge

Eco-conscious product

- Zero power emission when ECO+ mode is activated
- Low power consumption: < 0.65 W in stand-by mode

Cordless phone with answering machine
60 min answering machine 1.9" display/ white backlight, Speakerphone

XL5951C/DE

Highlights

Easy setup

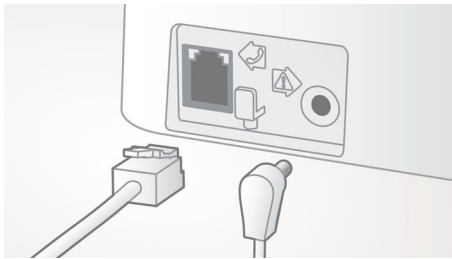

Ultimate convenience through easy set up.
Simplified installation - Plug & Play product

ECO+ mode

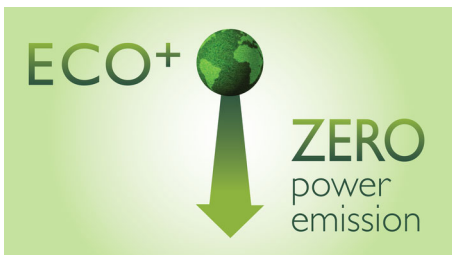

The ultimate mode to save transmitting power.

Extra loud sound



Extra loud sound for clear voice reproduction

Handset speakerphone



Handsfree mode uses a built-in loud speaker to amplify the voice of the caller, allowing you to speak and listen during a call without holding the phone to your ear. This is especially useful if you want to share the call with others or simply multitask.

Hearing aid compatible



Hearing aid compatible - reduces unwanted noise

Instant calling



Instantly call your loved ones via speed-dial keys

Large, easy to read display



Large display and easy to read characters

Optimized antenna layout

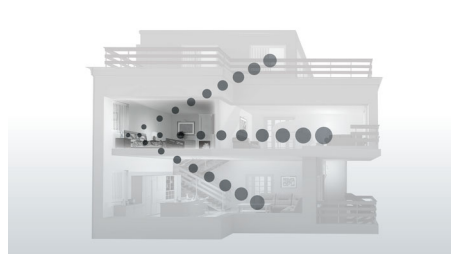

Our optimized antenna layout ensures strong and stable reception – even in areas of the house where cordless transmission is difficult. Now you can take a call wherever you are in

the house, and enjoy a long, uninterrupted conversation even as you walk around.

Up to 19 hours talk time



Up to 19 hours talk time on a single charge

Up to 45 min. recording



With up to 45 minutes recording time, you'll never miss an important message.



asimpleswitch.com

Philips Green Logo

Philips Green Products can reduce costs, energy consumption and CO2 emissions. How? They offer a significant environmental improvement in one or more of the Philips Green Focal Areas – Energy efficiency, Packaging, Hazardous substances, Weight, Recycling and disposal and Lifetime reliability.

Specifications

Sound

- Hearing Aid Compatible
- Volume control on handset
- Ringtones on handset: 10 polyphonic with progressive ringtone volume

Picture/Display

- Display size: 4.8 cm / 1.9"
- Display type: FSTN - dot matrix
- Backlight: Yes
- Backlight color: White

Answering Machine

- Recording time capacity: up to 60 minutes
- Pre-recorded OGM
- Message counter on base: Amber counter (2 x 7 segments)
- Answering machine control: from base & handset
- Loud speaker on base

Convenience

- Menu structure in the handset: List Menu
- Speakerphone - talk handsfree
- Personalization: Silence mode
- Personalization (ringtone): VIP ringtones for M1, M2 and M3
- Signal strength indicator: 3- bar indicator
- Battery level indicator: 3- bar battery icon
- Intercom - multiple handsets
- Date / Time display
- Alarm Clock
- Battery charge indication
- Programmable hot keys: Key 1 and 2, and M1/2/3
- Call Management: Call Waiting*, Caller ID*, Microphone mute, Missed Calls, Received Calls
- Key tone on/off
- Auto Registration
- Auto hang up
- Multi base capability: 1

- Multi handset capability: Up to 4
- Number of keys: 23
- Backlit keypad: White (flashing when the phone rings)
- Base Station keys: Paging key
- Up to 19 hrs talk time
- Up to 300 hrs standby time
- Charge time: 8 hours
- Line cord length: 1.8m
- Power cord length: 1.8m
- Range: Open field <300m; in door <50m

Memory Capacity

- VIP Caller Identification
- Phonebook: 200 names and numbers + 2 direct access memories
- Redial List Capacity: 40 entries
- Call log entries: 100 entries
- Phonebook store in the base

Power

- Battery Capacity: 650 mAh
- Battery type: AAA NiMH Rechargeable
- Mains power: AC 100-240V ~50/60Hz
- Power Consumption: < 0.65 W

Security

- Transmission encryption : Yes

Network Features

- Compatible: GAP

SAR Value

- Philips handsets: <0.1 W/kg

Eco Design

- EcoMode: automatic & manual
- Full ECO Mode (NEMO)



Issue date 2019-06-02

Version: 4.1.4

12 NC: 8670 000 80047
EAN: 87 12581 61421 8

© 2019 Koninklijke Philips N.V.
All Rights reserved.

Specifications are subject to change without notice.
Trademarks are the property of Koninklijke Philips N.V.
or their respective owners.

www.philips.com