

# PHILIPS

Conference  
Speaker

8000 Series

AECS8100



## User manual

Register your product and get support at:  
[www.philips.com/support](http://www.philips.com/support)

# Contents

---

<b>1</b>	<b>Important safety instructions</b>	<b>3</b>
	Safety	3
	Care for your product	4
	Care of the environment	4
	Declaration of conformity	4
	Trademarks	4
	FCC information	5
	FCC & IC Radiation Exposure Statement	5

---

<b>2</b>	<b>Your conference speaker</b>	<b>7</b>
	Introduction	7
	What's in the box	7
	Overview of the speaker	7

---

<b>3</b>	<b>Get started</b>	<b>8</b>
	Charge the built-in battery	8
	Turn on and off	9
	Adjust the volume	9
	Trigger voice assistant of your mobile device	9
	Control playback	9

---

<b>4</b>	<b>Connect your conference speaker</b>	<b>10</b>
	Connect via USB-C dongle	10
	Connect the speaker to your Bluetooth device	10
	Clear Bluetooth connection history	11
	Connect via USB-C charging cable	11

---

<b>5</b>	<b>Use your conference speaker</b>	<b>11</b>
	Use as a speakerphone	11
	Pairing for stereo mode	12

---

<b>6</b>	<b>Product specifications</b>	<b>13</b>
----------	-------------------------------	-----------

---

<b>7</b>	<b>Troubleshooting</b>	<b>14</b>
	General	14
	Bluetooth	14

# 1 Important safety instructions

Read and understand all instructions before you use your speaker. If damage is caused by failure to follow instructions, the warranty does not apply.

Be sure to include all documents when passing this product on to others.

Keep these instructions for use for future reference.

---

## Safety

### Important safety instructions

- Make sure that the power supply voltage corresponds to the voltage of the unit.
- The speaker shall not be exposed to dripping or splashing.
- Do not place any source of danger on the speaker (e.g. liquid filled objects, lit candles).
- Make sure that there is enough free space around the speaker for ventilation.
- Please use the speaker safely in an environment with temperature between 0°C and 45°C.
- Only use attachments and accessories specified by the manufacturer.

### Battery safety precautions

- Danger of explosion if a battery is incorrectly replaced. Replace only with the same or equivalent type.
- A battery (battery pack or battery installed) shall not be exposed to excessive heat such as sunshine, fire, or the like.

- A battery in extreme high or low temperatures during use, storage or transportation, and low air pressure at high altitude can pose safety hazards.
- Do not replace a battery with an incorrect type that can defeat a safeguard (for example, some lithium battery types).
- Disposing a battery into fire or a hot oven, mechanically crushing or cutting a battery can result in an explosion.
- Leaving a battery in an extremely high temperature surrounding, or an extremely low air pressure environment may result in an explosion or leakage of flammable liquid or gas.

### Warning

- Never leave children unsupervised with the packaging material. The packaging material poses a suffocation hazard. Children frequently underestimate dangers.
- Always keep children and pets away from the product.
- Never remove the casing of this speaker.
- Never lubricate any part of this speaker.
- Place this speaker on a flat, hard and stable surface.
- Never place this speaker on other electrical equipment.
- Only use this speaker indoors. Keep this speaker away from water, moisture and liquid-filled objects.
- Keep this speaker away from direct sunlight, naked flames or heat.
- Risk of explosion if a battery is replaced by an incorrect type.

---

## Care for your product

Only use a dry microfiber cloth to clean the product.

---

## Care of the environment

### Disposal of your old product and battery



Your product is designed and manufactured with high quality materials and components, which can be recycled and reused.



This symbol on a product means that the product is covered by European Directive 2012/19/EU.



This symbol means that the product contains batteries covered by European Directive 2013/56/EU which cannot be disposed of with normal household waste. Inform yourself about the local separate collection system for electrical and electronic products and batteries. Follow local rules and never dispose of the product and batteries with normal household waste. Correct disposal of old products and batteries helps prevent negative consequences for the environment and human health.

All unnecessary packaging has been omitted. We have tried to make the packaging easy to separate into three materials: cardboard (box), polystyrene foam (buffer) and polyethylene (bags and protective foam sheet).

Your product consists of materials which can be recycled and reused if disassembled by a specialized company. Please observe the local regulations regarding disposal of packaging materials, exhausted batteries and old equipment.

---

## Declaration of conformity

This product complies with the radio interference requirements of the European community. Hereby, MMD Hong Kong Holding Limited declares that the product is in compliance with the essential requirements and other relevant provisions of RED Directive 2014/53/EU and UK Radio Equipment Regulations SI 2017 No 1206. You can find the Declaration of Conformity on [www.philips.com/support](http://www.philips.com/support).

---

## Trademarks



The Bluetooth® word mark and logos are registered trademarks owned by Bluetooth SIG, Inc. and any use of such marks by MMD Hong Kong Holding Limited is under license. Other trademarks and trade names are those of their respective owners.

---

## FCC information

This device complies with part 15 of the FCC Rules. Operation is subject to the following two conditions:

- 1 This device may not cause harmful interference, and
- 2 This device must accept any interference received, including interference that may cause undesired operation.

**NOTE:** This equipment has been tested and found to comply with the limits for a Class B digital device, pursuant to Part 15 of the FCC Rules. These limits are designed to provide reasonable protection against harmful interference in a residential installation. This equipment generates, uses and can radiate radio frequency energy and, if not installed and used in accordance with the instructions, may cause harmful interference to radio communications. However, there is no guarantee that interference will not occur in a particular installation. If this equipment does cause harmful interference to radio or television reception, which can be determined by turning the equipment off and on, the user is encouraged to try to correct the interference by one or more of the following measures:

- Reorient or relocate the receiving antenna.
- Increase the separation between the equipment and receiver.
- Connect the equipment into an outlet on a circuit different from that to which the receiver is connected.
- Consult the dealer or an experienced radio / TV technician for help.

---

## IC-Canada:

### CAN ICES-003(B)/NMB-003(B)

This device contains license-exempt transmitter(s)/receiver(s) that comply with Innovation, Science and Economic Development Canada's license-exempt RSS(s). Operation is subject to the following two conditions:

- 1 This device may not cause interference.
- 2 This device must accept any interference, including interference that may cause undesired operation of the device.

---

## FCC & IC Radiation Exposure Statement

- This equipment complies with FCC and Canada radiation exposure limits set forth for an uncontrolled environment.
- This equipment should be installed and operated with minimum distance 20cm between the radiator and your body.
- This transmitter must not be co-located or operated in conjunction with any other antenna or transmitter.

### WARNING

Changes or modifications to this unit not expressly approved by the party responsible for compliance could void the user's authority to operate the equipment.

---

## Informations de la FCC

Cet appareil est conforme à la partie 15 des règles de la FCC. Son fonctionnement est soumis aux deux conditions suivantes :

- 1 ce dispositif ne peut pas causer d'interférences nuisibles et
- 2 cet appareil doit accepter toute interférence reçue, y compris les interférences qui peuvent causer un mauvais fonctionnement.

**Remarque :** cet équipement a été soumis à des essais et a été déclaré conforme aux limites stipulées pour un appareil numérique de classe B, conformément aux spécifications de la partie 15 du règlement de la FCC. Ces limites ont pour but d'assurer une protection raisonnable contre le brouillage nuisible dans une installation résidentielle. Cet équipement produit, utilise et peut émettre de l'énergie en radio fréquence et, s'il n'est pas installé et utilisé conformément aux directives, il peut causer un brouillage nuisible dans les communications radio. Cependant, il est impossible de garantir qu'aucun brouillage ne se produira dans une installation particulière. Si cet équipement cause un brouillage de la réception de radio ou de télévision, ce qu'il est possible de déterminer en éteignant puis en rallumant l'équipement, l'utilisateur est prié d'essayer de corriger le brouillage au moyen de l'une ou de plusieurs des mesures suivantes :

- Réorienter ou déplacer l'antenne de réception.
- Augmenter la distance entre l'appareil et le récepteur.
- Brancher l'appareil à une prise sur un circuit différent de celui sur lequel le récepteur est branché.
- Consulter le revendeur ou un technicien radio/TV expérimenté.

---

## IC-Canada :

### CAN ICES-003(B)/NMB-003(B)

L'émetteur/récepteur exempt de licence contenu dans le présent appareil est conforme aux CNR d'Innovation, Sciences et Développement économique Canada applicables aux appareils radio exempts de licence. L'exploitation est autorisée aux deux conditions suivantes :

- 1 L'appareil ne doit pas produire de brouillage;
- 2 L'appareil doit accepter tout brouillage radioélectrique subi, même si le brouillage est susceptible d'en compromettre le fonctionnement.

---

## Déclaration de la FCC et IC sur l'exposition aux rayonnements

- Cet équipement est conforme aux limites d'exposition aux rayonnements de la FCC et du Canada établies pour un environnement non contrôlé.
- Pour rester en conformité avec les consignes d'exposition aux RF, placez le produit à au moins 20 cm des personnes proches.
- Cet émetteur ne doit pas coexister ou fonctionner avec une autre antenne ou un autre émetteur.

## AVERTISSEMENT

Les changements ou modifications de cet appareil non expressément approuvées par la partie responsable de la conformité pourraient annuler l'autorisation de l'utilisateur à utiliser l'équipement.

## 2 Your conference speaker

Congratulations on your purchase, and welcome to Philips! To fully benefit from the support that Philips offers, register your conference speaker at [www.philips.com/support](http://www.philips.com/support).

### Introduction

With this conference speaker you can:

- make conference calls or play music from a phone which is connected to the speaker via Bluetooth;
- make conference calls or play music from a PC which is connected to the speaker via the supplied USB-C dongle;
- make conference calls or play music from a PC which is connected to the speaker via the supplied USB-C charging cable.

### What's in the box

Check and identify the items in the package:

- Conference speaker
- USB-C charging cable
- USB-C to USB-A converter
- USB-C dongle
- Pouch
- Quick start guide
- Safety sheet
- Global warranty

### Overview of the speaker

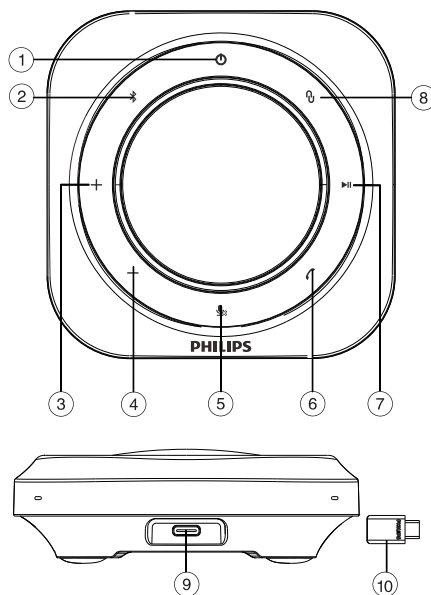

- ① **On/Off key**  
Press and hold to turn the unit on and off.
- ② **Bluetooth key**  
Press and hold to disconnect the connected Bluetooth device.
- ③ **+ (Volume) key**  
Increase the volume.
- ④ **- (Volume) key**  
Decrease the volume.
- ⑤ **Mute key**  
Mute or restore volume.
- ⑥ **Answer/Reject key**  
Press to answer a call; press and hold to reject a call.
- ⑦ **Play/Pause key**  
Start or pause play.
- ⑧ **Music mode**  
Stereo Pairing key

- ⑨  USB-C charging port
- ⑩ **USB-C dongle**

## 3 Get started

### Charge the built-in battery

- In "power on" mode, if the battery level is less than 10%, a prompt tone is heard every three minutes and the backlights of the 8 keys blink red, until the speaker is charged or turns off.
- Connect the supplied USB-C charging cable to the charging port of the speaker and the USB wall outlet (5V  $\rightleftharpoons$  2A).

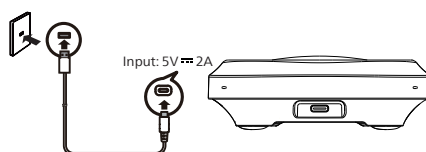



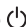

#### Warning!

- If you are not going to use the speaker for a long time, turn it off and be sure to unplug its USB-C charging cable from the power outlet.
- When charging the speaker in "power off" mode, the backlights of all keys blink red three times (once every second) and then turn off. After that, the backlight of the  **On/Off key** turns solid red, and then turns off when fully charged.
- When charging the speaker in "power on" mode, the backlights of all keys blink red three times (once every second) and then turn off. After that, the backlight of the  **On/Off key** blinks white and red alternately, and then returns to the current status when fully charged.



---

## Turn on and off

- Press and hold  for 3 seconds to turn on the speaker. A prompt tone is heard and the backlight of the  **On/Off key** turns solid, while the backlights of the other keys turn solid white and after 3 seconds dim. In "power on" mode, press and hold  for 3 seconds to turn off the speaker. A prompt tone is heard and the backlight of the  **On/Off key** turns off.





### Tip

- The speaker turns off automatically if there is no audio signal from Bluetooth or no Bluetooth device is connected for 15 minutes.

---

## Control playback

- Press  on the speaker to pause and resume playback.
- Press and hold  on the speaker to skip to next track.

---

## Adjust the volume

- Press **Volume +/- keys** to increase or decrease the volume.
- Press and hold **Volume +/- keys** to continuously increase or decrease the volume. A prompt tone will be heard when the volume reaches its maximum or minimum level.

---

## Trigger voice assistant of your mobile device

- Press and hold  on the speaker for 3 seconds to activate the voice assistant on the mobile device connected to the speaker via Bluetooth.

## 4 Connect your conference speaker

### Connect via USB-C dongle

- Press and hold  for 3 seconds to turn on the speaker. Plug the USB-C dongle into the USB port of your PC.
- After the driver is installed on your PC, the PC will automatically be connected to the Philips AECS8100 speaker via the USB-C dongle.
- On your computer, select **"Philips AECS8100"** from the speaker list, the music will be played through this speaker.

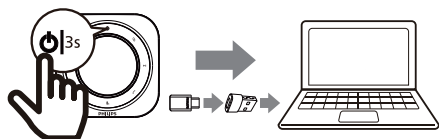

### Connect the speaker to your Bluetooth device

- Press and hold  for 3 seconds to turn on the speaker, the speaker automatically enters Bluetooth mode, and the backlight of the **Bluetooth key** blinks white. On the Bluetooth device, turn on Bluetooth, search for and select **"Philips AECS8100"** to connect (enter password "0000" if prompted). Once the Bluetooth connection is successful, the backlight of the **Bluetooth key** turns solid white and a prompt tone is heard. Play audio on your Bluetooth device to start music streaming.
- To disconnect the Bluetooth connection, press and hold the **Bluetooth key** for 3 seconds until the backlight of the **Bluetooth key** blinks white and a prompt tone is heard.
- When the speaker is restarted, it will automatically be reconnected to the last connected Bluetooth device.

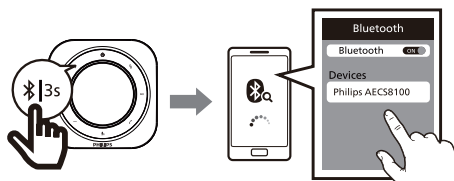

#### Note

- The maximum operational range between the speaker and a Bluetooth device is approximately 20 meters.
- In Bluetooth mode, the **Play/Pause**, **Volume +/-** and **Answer/Reject** keys are effective.



---

## Clear Bluetooth connection history

- Press and hold  for 8 seconds until a prompt tone is heard. After all records are cleared, the speaker returns to the pairing mode, and the backlight of the  key blinks white.

---

## Connect via USB-C charging cable

- Connect the supplied USB-C charging cable to the USB-C to USB-A converter, then plug the converter end into the USB port of your PC, and connect the charging cable end to the charging port of the speaker.
- Once connected successfully, the sound comes out of the speaker when you play music and movies from your PC.

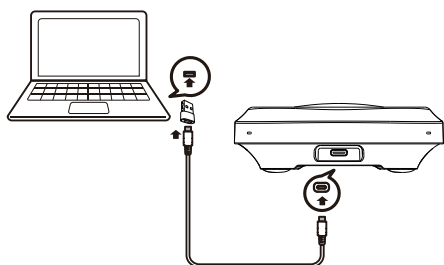

# 5 Use your conference speaker

---

## Use as a speakerphone

- 1 Ensure the speaker is connected to your mobile phone.
  - 2 Use the speaker as a conference speakerphone:
- When a call comes in, you will hear a ringtone on the speaker. Press  on the speaker to answer the call. The backlight of the key will light up in white for 3 seconds. During a call press the **Volume +/- keys** to increase or decrease the volume.

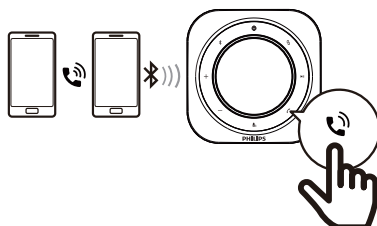

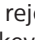
- When a call comes in, you will hear a ringtone on the speaker. Press and hold  on the speaker to reject the call. The backlight of the key will light up in red for 3 seconds.

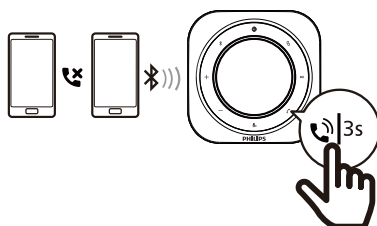



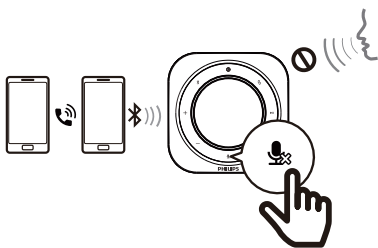





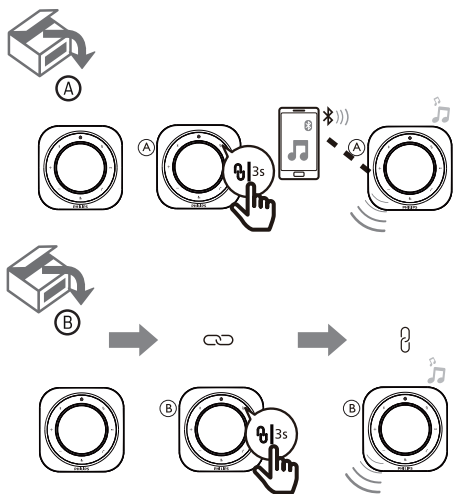

- When the speaker is used as a conference speakerphone, press  to mute the microphone of the speaker. The backlights of all keys on the speaker turn solid red, but you can still hear the caller through the speaker.



## Pairing for stereo mode

Two identical conference speakers (Philips AECS8100) can pair with each other for stereo sound.



- Press and hold  on both speakers simultaneously to enter the Stereo Pairing mode. The backlight of the  **Stereo Pairing key** blinks white.
- Once successfully paired, a prompt tone will be heard from the speaker. The backlight of the  **Stereo Pairing key** on both the master and slave speakers turns solid. The backlight of the  **Bluetooth key** on the master speaker turns white. The backlight of the  **Bluetooth key** on the slave speaker turns solid red.
- After stereo pairing is successful, press and hold  on either speaker to exit the stereo mode. The backlight of the  **Stereo Pairing key** blinks red and white alternately three times and then returns to the current status.
- Operations on the slave speaker are the same as on the master speaker:
  - Press  to pause and resume playback.
  - Press **Volume +/-** to increase or decrease the volume.
  - Press and hold  to skip to next track.
- In Stereo Pairing mode, when the master speaker or the slave speaker is used as a conference speakerphone, the backlight of the  **Mute key** on the slave speaker remains in red.

### Note

- The speaker will exit Stereo Pairing mode if not successfully paired in 60 seconds.



# 6 Product specifications



## Note

- Specifications are subject to change without notice.

### General information

Model	AECS8100YW
Category	AECS8100/00
Power supply	5V  2A
Rated capacity of lithium battery	3.7V  1880mAh
Dimensions of main unit (WxHxD)	115x38x115mm
Weight (main unit)	0.24kg

### Amplifier

Output power	3W
Frequency response	20-20000Hz
Signal to noise ratio	>70dB

### Speaker

Speaker impedance	4Ω
Max. input power of speaker	5W
Speaker dimensions	53.2x53.2mm

### Bluetooth

Bluetooth version	5.2
Frequency range	2400MHz-2483.5MHz
Max. transmission power	≤20dBm (EIRP)
Bluetooth range	Up to 20m
Compatible Bluetooth profiles	A2DP, AVRCP, HFP

# 7 Troubleshooting



## Warning!

- Never remove the casing of the product.

To keep the warranty valid, never try to repair the speaker yourself. If you encounter problems when using this speaker, please check the following before requesting repair service. If the problem remains unsolved, go to the Philips website ([www.philips.com/support](http://www.philips.com/support)). When you contact Philips, ensure that your unit is nearby and the model number and serial number are available.

## General

### No power

- When only the built-in battery is used, make sure there is enough battery power.
- When only the AC power supply is used, make sure the USB plug is properly connected.
- This speaker will automatically turn off when no audio device is connected or an audio device is connected but not playing within 15 minutes.

### No sound

- Adjust the volume of the speaker.
- Adjust the volume of the connected device.
- Make sure your Bluetooth device is within the operational range.

### The speaker does not respond

- Restart the speaker.

## Bluetooth

### The sound quality is poor after the speaker connects to a Bluetooth device

- Bluetooth reception is poor. Move the device closer to the speaker or remove any obstacles between the device and the speaker.

### Cannot find [Philips AECS8100] from the Bluetooth device list for pairing

- Press and hold  for 3 seconds to enter the Bluetooth pairing mode and try again.

### Cannot connect with the Bluetooth device

- The Bluetooth function of the device is not enabled. Refer to the user manual of the device for how to enable the function.
- The speaker is not in pairing mode.
- The speaker has been connected to another Bluetooth device. Disconnect the device or all other connected devices and try again.





Specifications are subject to change without notice. Please visit [www.philips.com/support](http://www.philips.com/support) for the latest updates and documents.

Philips and the Philips Shield Emblem are registered trademarks of Koninklijke Philips N.V. and are used under license.

This product has been manufactured by and is sold under the responsibility of MMD Hong Kong Holding Limited or one of its affiliates, and MMD Hong Kong Holding Limited is the warrantor in relation to this product.