

# Quick Start Guide



Step A *Connect*

Step B *Setup*

Step C *Enjoy*

## What's in the Box?

You should find these items upon opening the box.



Remote Control

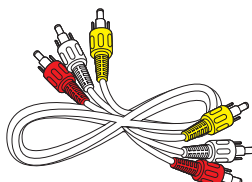

Audio/video cable

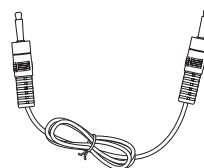

MP3 link cable



Quick Start Guide

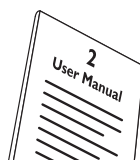

User Manual

**PHILIPS**

## Step A *Connect*

1

Connect the speaker cables.

2

Connect the AC power cord to the wall socket.

### Tip

See the User Manual for how to connect other equipment to this apparatus.

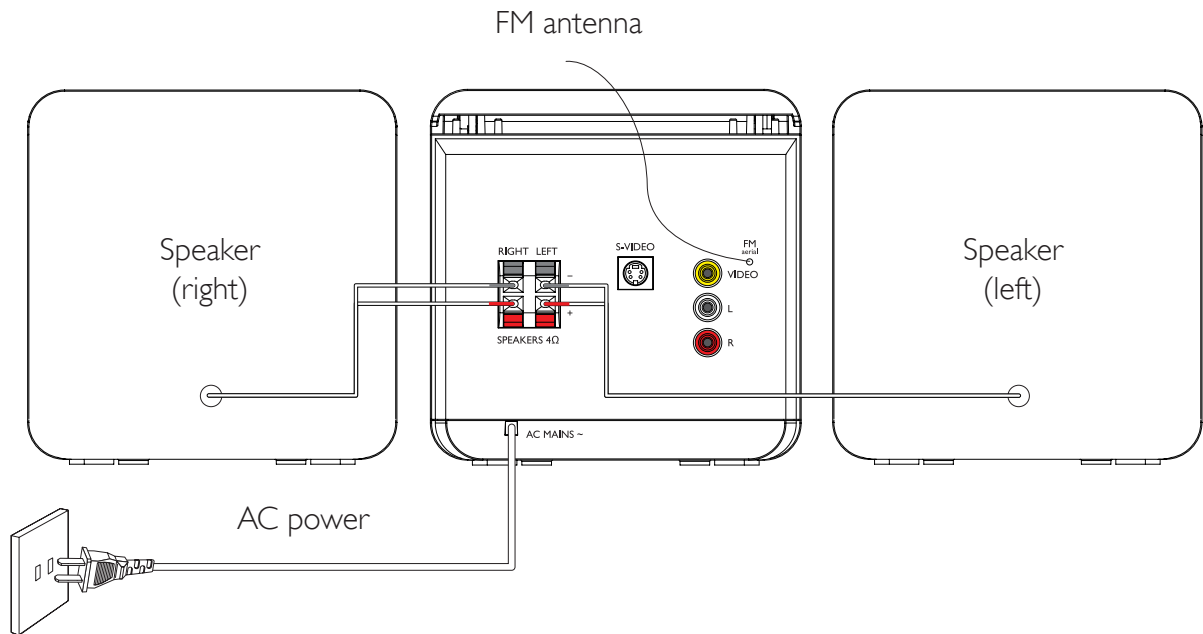

## Step B *Setup*

### Set clock

1

In standby mode, press and hold **CLOCK/DISPLAY** to activate the clock setting mode.

→ The 12 hour or 24 hour format is displayed.

2

Press **PROG** repeatedly to select 12 hour or 24 hour format.

3

Press **CLOCK/DISPLAY** to confirm.

→ The hour digits are displayed and begin to blink.

4

Press **◀▶** to set the hour.

5

Press **CLOCK/DISPLAY** to confirm.

→ The minute digits are displayed and begin to blink.

6

Press **◀▶** to set the minute.

7

Press **CLOCK/DISPLAY** to confirm.

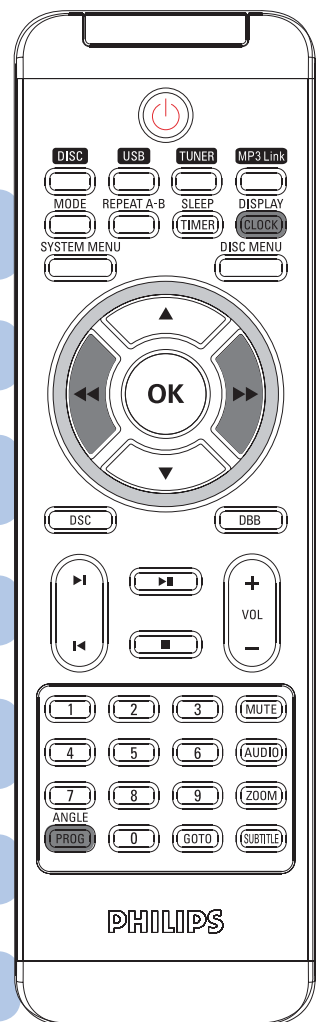

## Play discs

1

Press **DISC** to select the disc source.

2

Press **▲** to open the disc compartment.

3

Insert a disc with the printed side facing up, then close the disc door.

↳ Play starts automatically.

- To stop play, press **■**.

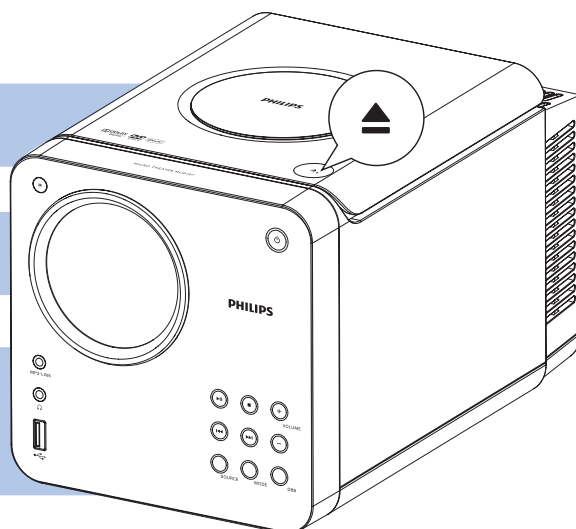

## Play from USB devices

With the apparatus, you can use USB flash memory (USB 2.0 or USB1.1), USB flash players (USB 2.0 or USB1.1), memory cards (requires an additional card reader to work with this apparatus).

1

Insert the USB plug of a USB device into the  socket.

2

Press **USB**.

↳ Play starts automatically. If not, press **▶||**.

## Programming and tuning to radio stations

1

Press **TUNER** to select FM.

2

Press and hold **PROG/ANGLE** for more than 2 seconds.

- All available stations are programmed in the order of waveband reception strength.
- The first programmed radio station is broadcast automatically.

3

Press **◀** or **▶** until the desired preset station is displayed.

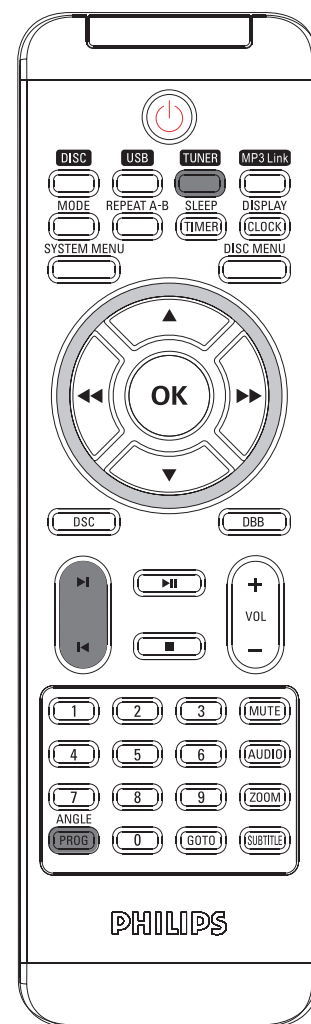

### Tip

Detailed playback features and additional functions are described in the accompanied owner's manual.



© Royal Philips Electronics N.V. 2009  
All rights reserved.

<http://www.philips.com>

