

Register your product and get support at

[www.philips.com/welcome](http://www.philips.com/welcome)

User manual

使用説明

Manual de usuario



# PHILIPS

**Manufactured under license from Dolby Laboratories.**

"Dolby", "Pro Logic" and the double-D symbol are trademarks of Dolby Laboratories.

## HDMI

HDMI (High Definition Multimedia Interface) is a digital interface that allows pure HD digital video transmission without the loss of image quality. The integrated control bus allows system control between the TV set and connected devices like a digital set top box.

This product incorporates copyright protection technology that is protected by method claims of certain U.S. patents and other intellectual property rights owned by Macrovision Corporation and other rights owners. Use of this copyright protection technology must be authorized by Macrovision Corporation, and is intended for home and other limited viewing uses only unless otherwise authorized by Macrovision Corporation. Reverse engineering or disassembly is prohibited.

**DivX, DivX Certified, and associated logos are trademarks of DivX Networks, Inc and are used under license.**



**Windows Media is a trademark of Microsoft Corporation.**

### **CAUTION**

***Use of controls or adjustments or performance of procedures other than herein may result in hazardous radiation exposure or other unsafe operation.***

English ..... 7

中文 ..... 30

Español ..... 56

English

中文

Español

## DEMO MODE

To turn ON

Press



button

To turn OFF

Press



button again

# Contents

## General Information

Supplied accessories .....	6
Environmental information .....	6
Installation .....	6
Maintenance .....	6
Hearing Safety .....	7

## Connections

Step 1: Placing speakers .....	8
Step 2: Connecting speakers .....	8
Step 3: Connecting the control cable .....	8
Step 4: Connecting TV .....	8
Using Composite Video jack .....	8
Using Component Video jacks (Y Pb Pr) .....	9
Using S-Video jack .....	9
Connecting to a TV with HDMI Jack .....	9
Using an accessory RF modulator .....	10
Step 5: Connecting FM antenna .....	10
Step 6: Connecting the power cord .....	10
Additional: Connecting additional equipment ...	11
Additional connection: Connecting a USB device or memory card .....	11

## Functional Overview

DVD player and power amplifier .....	12
Remote control .....	13

## Getting Started

Step 1: Inserting batteries into the Remote Control .....	15
Using the Remote Control to operate the Player .....	15
Step 2: Setting the clock .....	15
Step 3: Setting up the TV .....	15
Setting up Progressive Scan feature .....	15
To deactivate Progressive manually .....	16
Step 4: Setting language preference .....	16

## Basic Functions

Switching the system on/off .....	17
Power-saving automatic standby .....	17
Volume control .....	17
Sound control .....	17
Bass enhancement (user-defined) .....	17
Treble adjustment (user-defined) .....	17
DBB (Dynamic Bass Boost) .....	17
DSC (Digital Sound Control) .....	17
LOUDNESS .....	17
Dimming the display screen .....	17
Demonstration mode .....	17

## Disc Operations

Region Codes .....	18
Playing discs .....	18
Using the Disc Menu .....	18
Basic playback controls .....	18
Pausing playback .....	18
Selecting a track/chapter/title .....	18
Resuming playback from the last stopped point ...	18
Zoom .....	18
Repeat .....	19
Repeat A-B .....	19
Slow Motion .....	19
Program .....	19
Forward/Reverse Searching .....	19
Time search & search by chapter/track number ...	19
Information display during playback .....	19
Special disc features .....	19
Playing a Title .....	19
Camera Angle .....	19
Changing the Audio Language .....	19
Changing the Audio Channel .....	20
Subtitles .....	20
Playing MP3/WMA/JPEG Picture CD .....	20
Special JPEG features .....	20
Preview function .....	20
Zoom picture .....	20
Slide show playback modes .....	20
Playback with multi-angles .....	20
Playing a DivX disc .....	20

## System Menu Options

Basic operations .....	21
General Setup Page .....	21
TV DISPLAY .....	21
OSD LANG .....	21
SCREEN SAVER .....	21
DIVX(R) VOD .....	21
Audio Setup Page .....	21
SPDIF SETUP .....	21
DOLBY DIGITAL SETUP .....	21
3D PROCESSING .....	22
HDCD .....	22
NIGHT MODE .....	22
AUDIO SYNC .....	22
Video Setup Page .....	22
COMPONENT .....	22
TV MODE .....	22
QUALITY .....	22
HDMI SETUP .....	23
Preference Page .....	23
PARENTAL .....	23
DEFAULT .....	23
PASSWORD SETUP .....	23

## Other Functions

Radio Reception .....	24
Tuning to radio stations .....	24
Presetting radio stations .....	24
Listening to preset radio stations .....	24
Setting sleep/wake-up timer .....	24
Sleep timer setting .....	24
Wake-up timer setting .....	24
Using a USB mass storage device .....	25

## Specifications ..... 26

## Troubleshooting ..... 27

# General Information

Congratulations on your purchase and welcome to Philips!

To fully benefit from the support that Philips offers, register your product at [www.philips.com/welcome](http://www.philips.com/welcome).

## Supplied accessories

- Remote control with two AAA batteries
- FM wire antenna
- Composite video (yellow) cable
- Control cable
- This instruction booklet and a Quick Start Guide

***If any item is damaged or missing, contact your retailer or Philips.***

## Environmental information

All unnecessary packaging has been omitted. We have tried to make the packaging easy to separate into three materials: cardboard (box), polystyrene foam (buffer) and polyethylene (bags, protective foam sheet).

Your system consists of materials which can be recycled and reused if disassembled by a specialised company. Please observe the local regulations regarding the disposal of packaging materials, exhausted batteries and old equipment.

## Installation

- Place the player on a flat, hard, and stable surface.
- In a cabinet, allow about 10cm (4 inches) of free space all around the player for adequate ventilation.

- Do not expose your player to extreme temperatures or humidity.
- The apparatus shall not be exposed to dripping or splashing.
- No objects filled with liquids, such as vases, shall be placed on the apparatus.
- No naked flame sources, such as lighted candles, shall be placed on the apparatus.
- Install this unit near the AC outlet and where the AC power plug can be reached easily.
- The ventilation should not be impeded by covering the ventilation openings with items, such as newspapers, table-cloths, curtains, etc.

## Maintenance

- When a disc becomes dirty, clean it with a cleaning cloth. Wipe the disc from the center out, in a straight line.
- Do not expose the player, batteries or discs to humidity, rain, sand or excessive heat (caused by heating equipment or direct sunlight). Always keep the disc tray closed to avoid dust on the lens.
- Do not use solvents such as benzene, thinner, commercially available cleaners, or anti-static spray intended for colour discs.
- The lens may cloud over when the player is suddenly moved from cold to warm surroundings, making it impossible to play a disc. Leave the player in the warm environment until the moisture evaporates.



## Hearing Safety

### **Listen at a moderate volume.**

- Using headphones at a high volume can impair your hearing. This product can produce sounds in decibel ranges that may cause hearing loss for a normal person, even for exposure less than a minute. The higher decibel ranges are offered for those that may have already experienced some hearing loss.
- Sound can be deceiving. Over time your hearing "comfort level" adapts to higher volumes of sound. So after prolonged listening, what sounds "normal" can actually be loud and harmful to your hearing. To guard against this, set your volume to a safe level before your hearing adapts and leave it there.

### **To establish a safe volume level:**

- Set your volume control at a low setting.
- Slowly increase the sound until you can hear it comfortably and clearly, without distortion.

### **Listen for reasonable periods of time:**

- Prolonged exposure to sound, even at normally "safe" levels, can also cause hearing loss.
- Be sure to use your equipment reasonably and take appropriate breaks.

### **Be sure to observe the following guidelines when using your headphones.**

- Listen at reasonable volumes for reasonable periods of time.
- Be careful not to adjust the volume as your hearing adapts.
- Do not turn up the volume so high that you can't hear what's around you.
- You should use caution or temporarily discontinue use in potentially hazardous situations.
- Do not use headphones while operating a motorized vehicle, cycling, skateboarding, etc.; it may create a traffic hazard and is illegal in many areas.

# Connections

## IMPORTANT!

- The type plate is located at the bottom of the system.
- Before connecting the AC power cord to the wall outlet, ensure that all other connections have been made.
- Never make or change any connections with the power switched on.

### Note:

– The DEMO jack is only applicable to the demo unit that is not included in the audio system. Do not attempt to connect any other device to the audio system through this jack.

## Step 1: Placing speakers

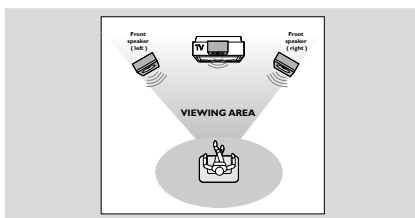

Place the front left and right speakers at equal distances from the TV set and at an angle of approximately 45 degrees from the listening position.

### Notes:

- To avoid magnetic interference, do not position the front speakers too close to your TV set.
- Allow adequate ventilation around the DVD System.

## Step 2: Connecting speakers

Connect the speaker wires to the SPEAKERS terminals, right speaker to "R" and left speaker to "L", coloured (marked) wire to "+" and black (unmarked) wire to "-". Fully insert the stripped portion of the speaker wire into the terminal as shown.

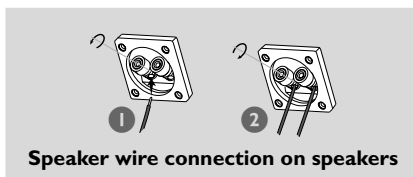
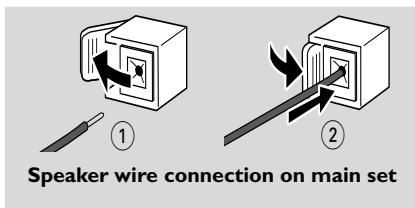

### Notes:

- Ensure that the speaker cables are correctly connected. Improper connections may damage the system due to short-circuit.
- For optimal sound performance, use the supplied speakers.
- Do not connect more than one speaker to any one pair of +/- speaker jacks.
- Do not connect speakers with an impedance lower than the speakers supplied. Please refer to the SPECIFICATIONS section of this manual.

## Step 3: Connecting the control cable

- Connect the serial port marked **CABLE** at the rear of the DVD player to the same port at the rear of the power amplifier with the supplied flat control cable.

## Step 4: Connecting TV

### IMPORTANT!

- You only need to make one video connection from the following options, depending on the capabilities of your TV.
- Connect the DVD system directly to the TV.

### Using Composite Video jack

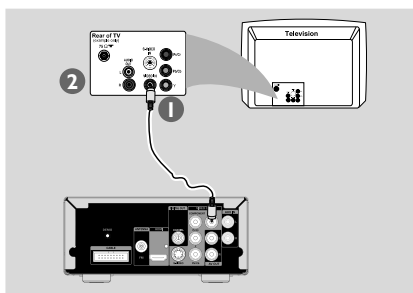



- 1 Use the supplied composite video cable (yellow) to connect the DVD system's **VIDEO** jack to the video input jack (or labeled as A/V In, CVBS, Composite or Baseband) on the TV.
- 2 To hear the TV channels through this DVD system, use the audio cables (white/red) to connect **AUX IN** jacks to the corresponding AUDIO OUT jacks on the TV.

## Using Component Video jacks (Y Pb Pr)

### IMPORTANT!

- The progressive scan video quality is only possible when using **Y Pb Pr**, and a progressive scan TV is required.

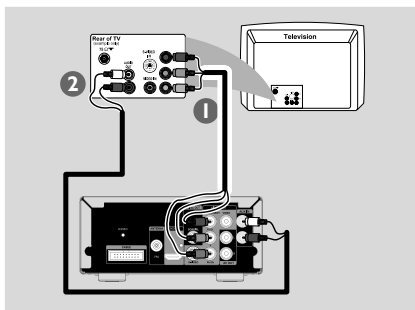

- 1 Use component video cables (red/blue/green - not supplied) to connect the DVD system's **COMPONENT (Pr/Cr Y Pb/Cb)** jacks to the corresponding Component video input jacks (or labeled as Y Pb/Cb Pr/Cr or YUV) on the TV.
- 2 To hear the TV channels through this DVD system, use the audio cables (white/red) to connect **AUX IN** jacks to the corresponding AUDIO OUT jacks on the TV.
- 3 If you are using a Progressive Scan TV (TV must indicate Progressive Scan or ProScan capability), to activate TV Progressive Scan, please refer to your TV user manual. For DVD system Progressive Scan function, see "Getting Started-Setting up Progressive Scan feature".

### Note:

- If your TV does not support Progressive Scan, you will not be able to view the picture. Press **SYSTEM MENU** on the remote to exit the system menu and then **DISC** and "1" to exit progressive scan.

## Using S-Video jack

### IMPORTANT!

- If S-Video is used for DVD playback connection, the system's **COMPONENT** setting will need to be changed accordingly.

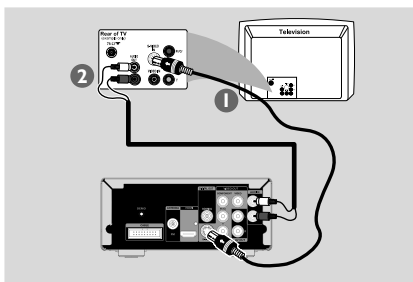

- 1 Use an S-Video cable (not supplied) to connect the DVD system's **S-VIDEO** jack to the S-Video input jack (or labeled as Y/C or S-VHS) on the TV.
- 2 To hear the TV channels through this DVD system, use the audio cables (white/red) to connect **AUX IN** jacks to the corresponding AUDIO OUT jacks on the TV.

## Connecting to a TV with HDMI Jack

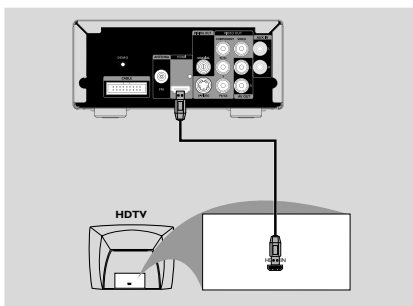

- Use a HDMI cable (not supplied) to connect the **HDMI** jack on the DVD Player to **HDMI IN** on a HDMI compatible device (e.g.; TV, Projector, Adaptor).
  - ➔ It may take a while for the DVD player and input device to communicate and initialise.
  - ➔ Playback starts automatically.

# Connections

## Notes:

- Proceed to "Setup Menu Options" → "VIDEO SETUP PAGE" → "HDMI SETUP" for detailed HDMI setup.
- If you are using the HDMI as audio source make sure that "DIGITAL OUTPUT" is set to "SPDIF/PCM" (see "Setup Menu Options" → "AUDIO SETUP PAGE" → "SPDIF SETUP").
- To stop sound output from your TV after making the HDMI connection, make sure that "DIGITAL OUTPUT" is set to "OFF" (see "Setup Menu Options" → "AUDIO SETUP PAGE" → "SPDIF SETUP").

## Using an accessory RF modulator

### IMPORTANT!

– If your TV only has a single Antenna In jack (labeled as 75 ohm or RF In), you will need an RF modulator in order to view DVD playback on the TV. See your electronics retailer or contact Philips for details on RF modulator availability and operations.

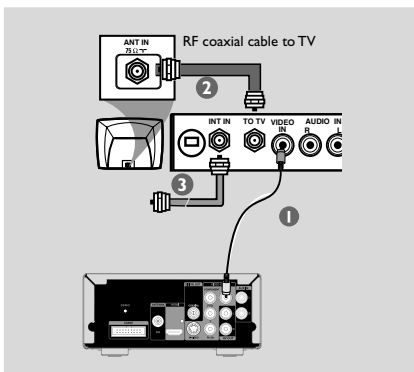

- 1 Use the composite video cable (yellow) to connect the DVD system's **VIDEO** jack to the video input jack on the RF modulator.
- 2 Use an RF coaxial cable (not supplied) to connect ANTENNA OUT or TO TV jack on the RF modulator to the Antenna IN jack on the TV.
- 3 Connect the Antenna or Cable TV service signal to the ANTENNA IN or RF IN jack on the RF modulator: (It may have been connected to your TV previously. Disconnect it from the TV.)

## Step 5: Connecting FM antenna

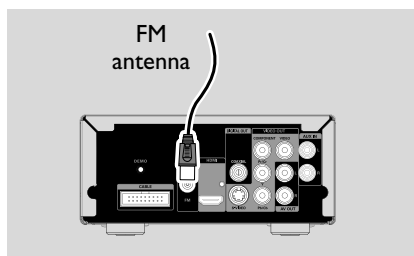

- Connect the supplied FM antenna to the **FM ANTENNA** (75  $\Omega$ ) jack. Extend the FM antenna and fix its end to the wall. For better FM stereo reception, connect an external FM antenna (not supplied).

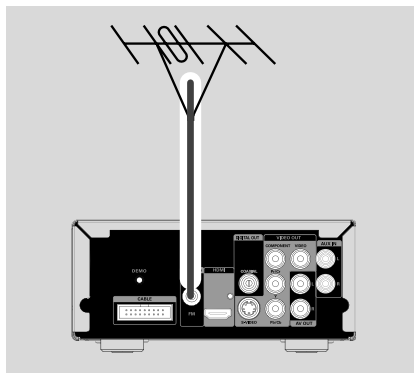

## Note:

- Adjust the position of the antenna for optimal reception.
- Position the antennas as far as possible from your TV, VCR or other radiation source to prevent unwanted interference.

## Step 6: Connecting the power cord

**After everything is connected properly, plug in the AC power cord to the power outlet.**

Never make or change any connection with the power switched on.

## Additional: Connecting additional equipment

### IMPORTANT!

- Some discs are **copy-protected**. You cannot record the disc through a VCR or digital recording device.
- When making connections, make sure the colour of cables matches the colour of jacks.
- Always refer to the owner's manual of the other equipment for complete connection and usage details.

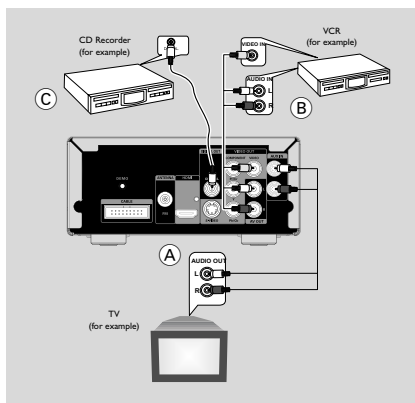

## Viewing and listening to the playback of other equipment (A)

- Connect the system's **AUX IN** jacks to the **AUDIO OUT** jacks on the other audio/visual device (such as a TV, VCR, Laser Disc player or cassette deck).  
Before starting operation, turn the **SOURCE** knob on the front panel to select **AUX** or press **AUX** on the remote control in order to activate the input source.

## Using the VCR for recording DVDs (B)

- Connect one of the system's **VIDEO** jacks to the corresponding **VIDEO IN** jack and **AV OUT (L/R)** jacks to the **AUDIO IN** jacks on the VCR. This will allow you to make analogue stereo (two channel, right and left) recordings.

## Recording (digital) (C)

- Connect the system's **DIGITAL OUT (COAXIAL)** jack to the **DIGITAL IN** jack on a digital recording device.  
Before starting operation, select an option in "AUDIO SETUP PAGE - SPDIF SETUP" according to the audio connection.

## Additional connection:

### Connecting a USB device or memory card

By connecting a USB mass storage device (including USB flash memory, USB flash players or memory cards) to the Hi-Fi system, you can enjoy the device's stored music through the powerful speakers of Hi-Fi system.

- Insert the USB device's USB plug into the  socket on the set.

### for the devices with USB cables:

- 1 Insert one plug of the USB cable (not supplied) to the  socket on the set.
- 2 Insert the other plug of the USB cable to the USB output terminal of the USB device.

### for the memory card:

- 1 Insert the memory card into a card reader (not supplied).
- 2 Use a USB cable (not supplied) to connect the card reader into the  socket on the set.

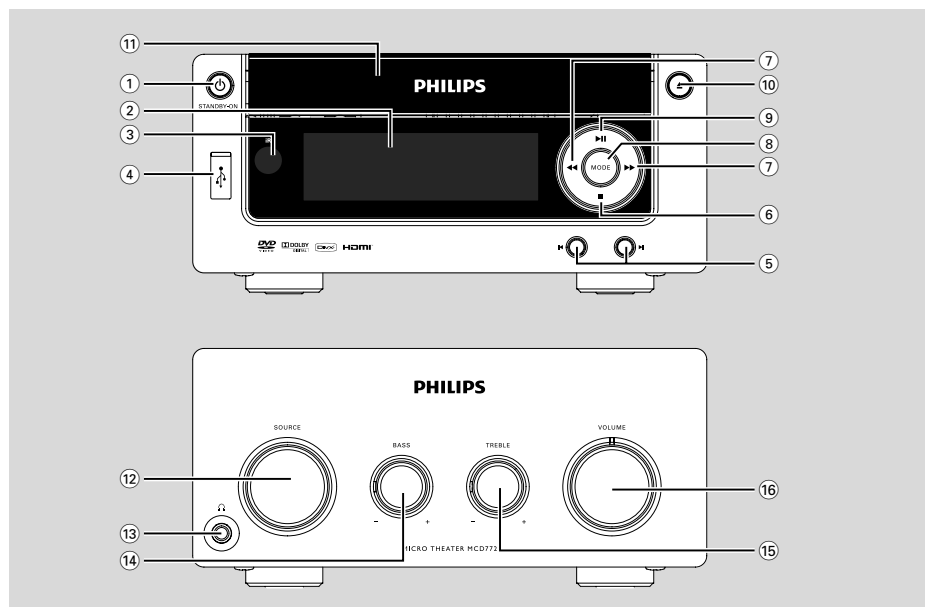

## DVD player and power amplifier

- ① **STANDBY-ON**
- switches the system on or to standby mode.
- ② **Display**
- shows the current status of the DVD player.
- ③ **IR SENSOR**
- point the remote control towards this sensor.
- ④ **USB DIRECT**
- is the jack for the external USB mass storage device.
- ⑤
- Disc:**
- skips to the previous/next chapter/title/track.
- Tuner:**
- selects a preset radio station.
- ⑥
- stops disc playback or erases a program.
- in Demo mode (*on the system only*), activates/deactivates the demonstration.
- ⑦
- Tuner**
- press to tune to a lower/higher radio frequency gradually.
- press and hold, then release the key to start automatic search for a radio frequency downward/upward.

- Disc/USB
- searches fast backward/forward.
- ⑧ **MODE**
- selects various repeat modes or the shuffle play mode for a disc.
- ⑨
- starts or interrupts disc playback.
- ⑩
- opens or closes the disc tray.
- ⑪ **Disc tray**
- loads a disc.
- ⑫ **SOURCE**
- to select the respective sound source :TUNER, DISC, USB or AUX.
- ⑬
- connects a headphone.
- ⑭ **BASS -/+**
- to adjust the bass boost level.
- ⑮ **TREBLE -/+**
- to adjust the treble (high tone) level.
- ⑯ **VOLUME**
- adjusts the volume upward/downward.
- adjusts the hours and minutes in clock/timer setting mode.
- switches the set timer ON or OFF.

## Remote control

### ① **STANDBY-ON**

- switches the system on or to standby mode.

### ② **Numeric Keypad (0-9)**

- inputs a track/title/chapter number of the disc.

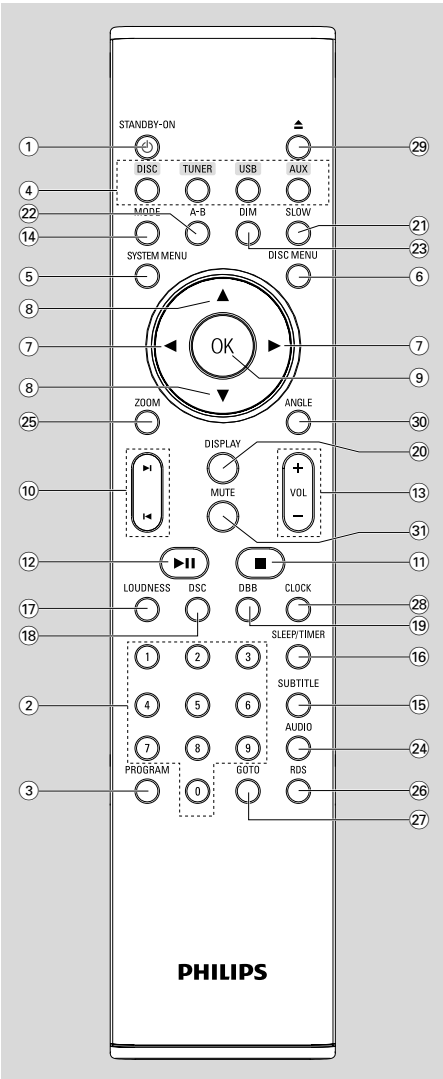

### ③ **PROGRAM**

- DVD/VCD/CD/MP3-CD/USB: enters the program menu.
- Picture CD: during playback, to select a slide show mode.
- Tuner: programs preset radio stations.

### ④ **SOURCE**

- to select the respective sound source :TUNER, DISC, USB or AUX.

### ⑤ **SYSTEM MENU** (disc mode only)

- to enter or exit the system menu bar:

### ⑥ **DISC MENU** (disc mode only)

- DVD/VCD: enters or exits the disc contents menu.
- VCD2.0: switches the playback control mode on or off.

### ⑦

Tuner

- press to tune to a lower/higher radio frequency gradually.
- press and hold, then release the key to start automatic search for a radio frequency downward/upward.
- Disc/USB
- searches fast backward/forward.
- In DISC mode, to select a movement direction in the disc menu or system menu bar:

### ⑧

- In DISC mode, to select a movement direction in the disc menu or system menu bar:

### ⑨ **OK**

- to exit or confirm the selection.

### ⑩

- Disc: skips to the previous/next chapter/title/track.
- Tuner: selects a preset radio station.

### ⑪

- In DISC/USB mode, to stop playback or clear a program.

### ⑫

- In DISC/USB mode, to start or interrupt playback.

# Functional Overview

## ⑬ VOL +/-

- adjusts the volume upward/downward.
- adjusts the hours and minutes in clock/timer setting mode.
- selects a source in timer setting mode.

## ⑭ MODE

- selects various repeat modes or the shuffle play mode for a disc.

## ⑮ SUBTITLE

- selects a subtitle language.

## ⑯ SLEEP/TIMER

### Standby mode

- sets time for switching on the system automatically.

### Power-on mode

- sets the sleep timer function (auto off).

## ⑰ LOUDNESS

- enables or disables automatic loudness adjustment.

## ⑱ DSC

- selects different types of preset sound equalizer settings (CLASSIC, JAZZ, ROCK, POP or CUSTOMER).

## ⑲ DBB

- enables or disables bass enhancement.

## ⑳ DISPLAY

- displays information on TV screen during playback.

## ㉑ SLOW

- selects different slow playback modes for a VCD/ SVCD/DVD.

## ㉒ A-B

- for VCD/CD/USB: to repeat a specific section within the same track.
- for DVD: to repeat a specific section in a disc.

## ㉓ DIM

- selects different levels of brightness for the display screen.

## ㉔ AUDIO

for VCD

- sets Stereo, Mono-Left or Mono-Right sound mode.

for DVD

- selects an audio language.

## ㉕ ZOOM

- DVD/VCD/Picture CD: enlarges or reduces a picture or active image on the TV screen.

## ㉖ RDS (unavailable for this version)

## ㉗ GOTO

- In DISC mode, to fast search in a disc by entering a time, title, chapter or track.

## ㉘ CLOCK

Standby mode

- \*– sets the system clock.

Playback mode

- displays the system clock.

## ㉙ ▲

- opens or closes the disc tray.

## ㉚ ANGLE

- selects a DVD camera angle.

## ㉛ MUTE

- to interrupt or resume sound reproduction.

### Notes for remote control:

- **First, select the source you wish to control by pressing one of the source select keys on the remote control (DISC or TUNER, for example).**
- **Then select the desired function (▶||, ◀, ▶ for example).**

## Step 1: Inserting batteries into the Remote Control

- 1 Open the battery compartment.
- 2 Insert two AAA batteries following the indications (+/-) inside the compartment.
- 3 Close the cover.

### Using the Remote Control to operate the Player

- 1 Aim the Remote Control directly at the remote sensor (IR) on the front panel.
- 2 Do not put any objects between the Remote Control and the DVD Player while operating the DVD Player.

## Step 2: Setting the clock

- 1 In Standby mode, press and hold **CLOCK** on the remote control until the time flashes on the display.  
→ "CLOCK SET" is displayed briefly. Then, the hour digits flash on the display screen.
- 2 Turn **VOLUME** clockwise or anticlockwise or press **VOL +/-** on the remote control to set the hours.
- 3 Press **CLOCK** to confirm.  
→ The minute digits flash on the display screen.
- 4 Turn **VOLUME** clockwise or anticlockwise or press **VOL +/-** on the remote control to set the minutes.
- 5 Press **CLOCK** again to confirm the clock setting.

#### Notes:

- This system only supports 24-hour mode.
- The clock setting will be erased when the system is disconnected from the power supply.
- The system will exit clock setting mode if no button is pressed within 30 seconds.

## Step 3: Setting up the TV

### IMPORTANT!

**Make sure you have completed all the necessary connections. (See "Connecting TV").**

- 1 Switch the DVD system on and then select DISC source. (See "Switching the system on/off").
- 2 Turn on the TV and set to the correct video-in channel. You should see the blue Philips DVD background screen on the TV.

### Setting up Progressive Scan feature (for Progressive Scan TV only)

#### IMPORTANT!

**Before enabling the progressive scan feature, you must ensure:**

- 1) Your TV can accept progressive signals, a progressive scan TV is required.
- 2) You have connected the DVD player to your TV using Y Pb Pr (see "Connections-Step 4: Connecting TV- Using Component Video jacks").

- 1 Turn on your TV.
- 2 Turn off your TV progressive scan mode or turn on interlaced mode (refer to your TV user manual).
- 3 Press **STANDBY-ON** to turn on the DVD player.
- 4 Select the correct Video Input channel.  
→ The DVD background screen appears on the TV.
- 5 Press **SYSTEM MENU**.
- 6 Press **◀ ▶** repeatedly to select "VIDEO SETUP PAGE".
- 7 Select "TV MODE" to "P - SCAN", then press **OK** to confirm.  
→ The instruction menu appears on the TV.

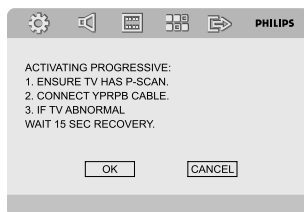

- 8 Press **◀ ▶** to highlight OK in the menu and press **OK** to confirm.

# Getting Started

**There will be a distorted picture on your TV at this state until you turn on the progressive scan mode on your TV.**

- 9 Turn on your TV progressive scan mode (refer to your TV user manual).  
→ The below menu appears on the TV.

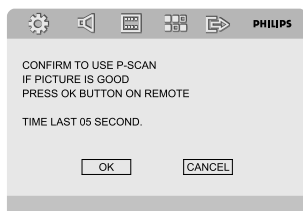

- 10 Press ◀▶ to highlight OK in the menu and press **OK** to confirm.  
→ The setup is complete now and you can start enjoy the high quality picture.

## To deactivate Progressive manually

- 1 **When the distorted sign still appears on the TV**, it may be due to the connected TV does not accept progressive signals, and progressive is set by mistake. You must reset the unit to interlace format.
- 1 Turn off your TV progressive scan mode or turn on to interlaced mode (refer to your TV user manual).
- 2 Press **SYSTEM MENU** on the remote to exit the system menu and then **DISC** and "1" to exit progressive scan.  
→ The DVD blue background screen will appear on the TV.

### Note:

– During normal playback in the progressive scan mode, pressing **DISC** button and "1" will exit the progressive scan mode.

## Step 4: Setting language preference

- 1 In stop mode or during playback, press **SYSTEM MENU**.
- 2 Press ◀▶/▲/▼ on the remote control to select your preferred option.

→ Move to **GENERAL SETUP PAGE** or **PREFERENCE PAGE** and press ▼.  
→ Move to one of the following and press ▶.

### OSD LANG (On-Screen Display)

Switches the display language on the TV screen. Select the language from the displayed list.

### AUDIO (DVD only)

Switches the display language of the sound track. Select the language from the displayed list.

### SUBTITLE (DVD only)

Switches the display language of the subtitle. Select the language from the displayed list.

### DISC MENU (DVD only)

Select the language for the DVD menu.

When the selected language is not recorded in the DVD, one of the recorded languages will be selected automatically (except for OSD). You can reset all the DVD settings except for Rating.

If the language selected is not available on the disc, the original language designated by each disc will be selected.

- 3 Press ▲/▼ to select a language and press **OK**.
- 4 Repeat **steps 2~3** for other settings.

### To exit the menu

Press **SYSTEM MENU** again.

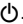

## Switching the system on/off

- Press **STANDBY-ON** .  
→ "H.E.L.L.O." is displayed briefly. The system will switch to the last selected source.
- Press **DISC, TUNER, USB** or **AUX** on the remote control.  
→ The system will switch to the selected source.

## To switch the system to standby mode

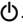
- Press **STANDBY-ON** .  
→ The volume level (up to a maximum volume level of 12), interactive sound settings, last selected mode, source and tuner presets will be retained in the player's memory.

## Power-saving automatic standby

As a power-saving feature, the system will automatically switch to Standby mode if you do not press any buttons within 15 minutes after a disc has stopped playing.

## Volume control

Turn **VOLUME** clockwise or anticlockwise (or press **VOL +/-** on the remote control) to increase or decrease the volume level.

## To switch off the volume temporarily

- Press **MUTE** on the remote.  
→ Playback will continue without sound and "MUTING" flashes.
- To activate sound reproduction, you can:
  - press **MUTE** again;
  - adjust the volume controls;
  - change source.

## Sound control

**DBB, DSC and LOUDNESS** sound features cannot be activated at the same time.

### Bass enhancement (user-defined)

- Turn the **BASS -/+** knob on the system to adjust the bass level between -14 and +14.

### Treble adjustment (user-defined)

- Turn the **TREBLE -/+** knob on the system to adjust the treble (high tone) level between -14 and +14.

### DBB (Dynamic Bass Boost)

- Press **DBB** on the remote control to enable/disable DBB feature.

### DSC (Digital Sound Control)

- Press **DSC** on the remote control repeatedly to select: CUSTOMER, POPS, JAZZ, CLASSIC or ROCK.  
When "CUSTOMER" is selected, the user-defined bass and treble settings will be applied.

### LOUDNESS

- Press **LOUDNESS** on the remote control to enable or disable LOUDNESS feature.

## Dimming the display screen

- Press **DIM** on the remote control repeatedly to select different levels of brightness for the display screen.

## Demonstration mode

The system has a demonstration mode that shows the various features offered by the system.

### To activate the demonstration

- In standby mode, press  on the system to activate the demo mode.  
→ Demonstration will begin.

### To deactivate the demonstration

- Press  on the system again.  
→ "DEMO OFF" is displayed.

Note:

- Even if you remove the AC power cord and reconnect it to the wall socket, the demonstration will remain off until you activate it again.

# Disc Operations

## Region Codes

DVDs must be labeled as shown below in order to play on this DVD system. You cannot play discs that are labeled for other regions.



**Note:**

– If you are having trouble playing a certain disc, remove the disc and try a different one. Improperly formatted disc will not play on this DVD Player.

## Playing discs

- 1 Connect the power cords of the system and TV (or any optional stereo or AV receiver) to a power outlet.
- 2 Turn on the TV power and set to the correct Video In channel. (See "Setting up the TV").
- 3 Press **STANDBY-ON** .  
→ You should see the blue Philips DVD background screen on the TV.
- 4 Press to open the disc tray and load in a disc, then press the same button again to close the disc tray.  
→ Make sure the label side is facing up.
- 5 Playback will start automatically (depending on the disc type).  
→ If a disc menu appears on the TV, see "Using the Disc Menu".  
→ If the disc is locked by parental control, you must enter your four-digit password. (See "PASSWORD SETUP PAGE").
- 6 At any time, simply press to stop playback.

## Using the Disc Menu

Depending on the disc, a menu may appear on the TV screen once you load the disc.

### To select a playback feature or item

- Use and **OK** or **Numeric Keypad (0-9)** on the remote control.  
→ Playback will start automatically.

### To access or exit from the menu

- Press **DISC MENU** on the remote control.

### For VCD with Playback Control (PBC) feature (version 2.0 only)

PBC playback allows you to play Video CDs interactively, following the menu on the display.

- During playback, press **DISC MENU**.  
→ If PBC was ON, it will switch to OFF and continue playback.  
→ If PBC was OFF, it will switch to ON and return to menu screen.

## Basic playback controls

### Pausing playback (DVD/VCD/CD/MP3/DivX/WMA)

- 1 During playback, press .  
→ Playback will pause and sound will be muted.
- 2 Press again to resume.

### Selecting a track/chapter/title (DVD/VCD/DivX/CD)

- 1 Press during playback to go to the next chapter/track.
- 2 Press to go to the previous chapter/track.
- 3 To go directly to any chapter/track/title, enter the chapter/track/title number using the **Numeric Keypad (0-9)**.

### Resuming playback from the last stopped point (DVD/VCD/CD)

- In stop mode and when a disc has not been removed, press .

### To cancel resume mode

- In stop mode, press again.

### Zoom (DVD/VCD/DivX/JPEG)

Zooming allows you to enlarge or reduce the video image during playback.

- 1 Press **ZOOM** repeatedly to enlarge or reduce the playback video image.
- 2 Press to pan across the TV screen.

## Repeat (DVD/VCD/CD/MP3/DivX/WMA)

- Press **MODE** repeatedly to choose a repeat mode during playback.

## Repeat A-B (DVD/VCD/CD/MP3/DivX/WMA)

- 1 Press **A-B** at your chosen starting point.
- 2 Press **A-B** again at your chosen end point.
  - The section A and B can be set only within the same chapter/track.
  - The section will now repeat continuously.
- 3 To exit the sequence, press **A-B** again.

## Slow Motion (DVD/VCD)

- 1 Press **SLOW** on the remote control during playback to select the required speed: 1/2, 1/4, 1/8 or 1/16 (backward or forward).
  - Sound will be muted.
- 2 To return to normal speed, press **▶ II**.

### Note:

- *Slow backward is not possible on VCDs.*

## Program (not for Picture CD)

To select favourite tracks/chapters for playback in preferred sequence.

- 1 Press **PROGRAM** on the remote control to enter the program mode.
- 2 Use the **Numerical Keypad (0-9)** to directly input the tracks or chapters (single track number with digit "0" in front, for example "05").
- 3 Move the cursor by pressing **◀▶▲▼** to select START.
- 4 Press **OK** to start playback.

### For MP3/WMA

- 1 In Stop mode, press **DISC MENU** to switch the menu between Album and Filelist.
- 2 When Filelist is on the screen, press **▲▼** to select the files and press **PROGRAM** to add the files to the program list.
- 3 Press **DISC MENU** to display the program list.

- 4 Press **PROGRAM** to delete unwanted files from the program list.

## Forward/Reverse Searching (DVD/VCD/DivX/CD/MP3/WMA)

- 1 Press **◀◀▶▶** (or **◀▶** on the remote control) during playback to select the required speed: 2X, 4X, 8X, 16X or 32X (backward or forward).
- 2 To return to normal speed, press **▶ II**.

## Time search & search by chapter/track number (DVD/VCD/CD/MP3/WMA)

- 1 Press **GOTO** until the time or chapter/track edit box appears.
- 2 Enter hours, minutes and seconds from left to right in the time edit box using remote control numerical keypad.

### OR

Enter your desired chapter/track number in the chapter/track edit box using remote control numerical keypad.

## Information display during playback (not for Picture CD)

- During playback, press **DISPLAY** to show disc information on the TV screen.

## Special disc features

### Playing a Title (DVD)

- 1 Press **DISC MENU**.
  - The disc title menu appears on the TV screen.
- 2 Use **◀▶▲▼** or **Numeric Keypad (0-9)** to select a play option.
- 3 Press **OK** to confirm.

### Camera Angle (DVD)

- Press **ANGLE** repeatedly to select different desired angle.

## Changing the Audio Language (for DVD recorded with multiple languages)

- Press **AUDIO** repeatedly to select different audio languages.

# Disc Operations

## Changing the Audio Channel (for VCD /DivX only)

- Press **AUDIO** to select the available audio channels provided by the disc (Mono Left, Mono Right or Stereo).

## Subtitles (DVD)

- Press **SUBTITLE** repeatedly to select different subtitle languages.

## Playing MP3/WMA/JPEG Picture CD

- 1 Load an MP3/WMA/JPEG disc.  
→ The data disc menu appears on the TV screen.
- 2 Use **▲ ▼** to select an album (folder) and press **OK** to open the album (folder).
- 3 Press **▲ ▼** or use the **Numeric Keypad (0-9)** to highlight a track. (file)
- 4 Press **OK** to confirm.  
→ The playback will start from the selected track (file) to the end of the album (folder).

## Special JPEG features

### Preview function (JPEG)

This function shows the content of the current folder or the whole disc.

- 1 Press **■** during playback.  
→ Thumbnails of 12 pictures appears on the TV screen.
- 2 Use **◀ ▶ ▲ ▼** to highlight one of the pictures/ "Slide Show" and press **OK** to start playback/ slide show.

### To enter the remote key function menu

- 2 Use **◀ ▶ ▲ ▼** to highlight "Menu" and press **OK**.

### To display the other pictures on the previous/next page

- Press **◀ / ▶**.
- 2 Use **◀ ▶ ▲ ▼** to highlight "Prev" or "Next" and press **OK**.

## Zoom picture (JPEG)

- During playback, press **ZOOM** repeatedly to display the picture with different scales.
- 2 Use **◀ ▶ ▲ ▼** to view the zoomed picture.

## Slide show playback modes (JPEG)

- During playback, press **PROGRAM** on the remote control repeatedly to select different slide-show playback modes.

## Playback with multi-angles (JPEG)

- During playback, press **◀ ▶ ▲ ▼** to rotate the picture on the TV screen.

## Playing a DivX disc

This DVD player supports the DivX movie playback that you download from your computer onto a CD-R/RW (see "System Menu Options-DIVX(R) VOD registration code" for more information).

- 1 Load a DivX disc.  
→ Playback will start automatically. If not press **▶ II**.
- 2 If the DivX movie contains external subtitles, the subtitle menu will appear on the TV screen for your selection.
- In this case, pressing **SUBTITLE** on the remote control will turn on or off the subtitle.
- If multilingual subtitles are embedded on the DivX disc, pressing **SUBTITLE** will change the subtitle language during playback.

### Note:

- Subtitle files with the following filename extensions (*.srt, .smi, .sub, .ssa, .ass*) are supported but do not appear on the file navigation menu.
- The subtitle filename have to be the same as the filename of the movie.

# System Menu Options

## Basic operations

- 1 Press **SYSTEM MENU** to enter the Setup Menu.
- 2 Press **◀▶** to select a page to be set.
- 3 Press **▲▼** to highlight an option.
- 4 Enter its submenu by pressing **▶** or **OK**.
- 5 Move the cursor by pressing **▲▼** to highlight the selected item.  
→ In cases of value setting, press **◀▶** to adjust values.
- 6 Press **OK** to confirm.

### To return to the upper-level menu

- Press **◀** or **OK** (in cases of value adjustment).

### To exit from the menu

- Press **SYSTEM MENU** again.  
→ The settings will be stored in the player's memory even if the player is switched off.

#### Note:

— Some of the features in the System Menu Options are described in "Getting Started".

## GENERAL SETUP PAGE

### TV DISPLAY

Set the aspect ratio of the DVD Player according to the TV you have connected.

→ **NORMAL/PS**: If you have a normal TV and want both sides of the picture to be trimmed or formatted to fit your TV screen.

→ **NORMAL/LB**: If you have a normal TV. In this case, a wide picture with black bands on the upper and lower portions of the TV screen will be displayed.

→ **WIDE**: If you have a wide-screen TV.

### OSD LANG

See "Getting Started-Step 4: Setting language preference".

### SCREEN SAVER

This function is used to turn the screen saver on or off.

→ **ON**: In STOP, PAUSE or No DISC mode, if no actions are performed about 3 minutes, the screen saver will be activated.

→ **OFF**: Screen saver is disabled.

### DIVX(R) VOD

Philips provides you the DivX® VOD (Video On Demand) registration code that allows you to rent and purchase videos using the DivX® VOD service.

For more information, visit us at [www.divx.com/vod](http://www.divx.com/vod).

- 1 In **GENERAL SETUP PAGE**, press **▲▼** to highlight DIVX(R) VOD, then press **▶** or **OK** to enter its submenu and press **OK** again to confirm.

→ The registration code will appear.

- 2 Press **OK** to exit.
- 3 Use the registration code to purchase or rent the videos from DivX® VOD service at [www.divx.com/vod](http://www.divx.com/vod). Follow the instructions and download the video onto a CD-R for playback on this DVD player.

#### Notes:

- All the downloaded videos from DivX® VOD can only be played back on this DVD player.
- Time search feature is not available during DivX movie playback.

## AUDIO SETUP PAGE

### SPDIF SETUP

→ **OFF**: Turns off the SPDIF output.

→ **SPDIF/RAW**: If you have connected your DIGITAL OUT (COAXIAL) to a multi-channel decoder/receiver.

→ **SPDIF/PCM**: Only if your receiver is not capable of decoding multi-channel audio.

### DOLBY DIGITAL SETUP

Select the setting that matches the number of speakers you have connected.

# System Menu Options

→ **STEREO**: Left mono sound will send output signals to Left speaker and Right mono sound will send output signals to Right speaker.

→ **L-MONO**: Left mono sound will send output signals to Left speaker and Right speaker.

→ **R-MONO**: Right mono sound will send output signals to Left speaker and Right speaker.

## 3D PROCESSING

Provides a virtual surround sound experience using just two speakers.

→ **OFF, CONCERT, LIVING ROOM, HALL, BATHROOM, CAVE, ARENA and CHURCH**.

## HDCCD

Sets the audio output cutoff frequency point when playing an HDCCD disc.

→ **OFF, 44.1K and 88.2K**.

## NIGHT MODE

In this mode, the high volume outputs are softened and low volume outputs are brought upward to an audible level. It is useful for watching your favourite action movie without disturbing others at night.

→ **ON**: Select this to level out the volume. This feature is only available for movies with Dolby Digital mode.

→ **OFF**: Select this when you want to enjoy the surround sound with its full dynamic range.

## AUDIO SYNC

Sets the audio output delay time if the video playback is slower than the audio output.

● Select this option and then use ◀▶ keys on the remote control to set the delay time for the audio output between 0~200ms.

## VIDEO SETUP PAGE

### COMPONENT

Sets the video output according to your video connection. This setting is not required if you are using the **VIDEO** jack (yellow) to connect the DVD micro system to your TV.

→ **S-VIDEO**: Select this if you have connected the DVD micro system to your TV using S-Video jack.

→ **Pr/Cr Pb/Cb Y**: Select this if you have connected the DVD micro system to your TV using Component video jacks.

## TV MODE

Selects interlace or P-SCAN video output mode when **Pr/Cr Pb/Cb Y** is selected.

→ **P-SCAN** and **INTERLACE**.

In the progressive scan mode, you can enjoy the high quality picture with less flickers. It only works when you have connected the DVD player's Y Pb Pr jacks to your TV that supports the progressive video input. Otherwise, a distorted picture will appear on the TV. For proper progressive scan set up, see "Getting started-Setting up Progressive Scan feature".

## QUALITY

This menu helps you to set the video quality.

### SHARPNESS

Adjusts the sharpness level.

→ **HIGH, MEDIUM** and **LOW**.

### BRIGHTNESS

Adjusts the brightness level. Range: -20~+20.

### CONTRAST

Adjusts the contrast level. Range: -16~+16.

### GAMMA

Adjusts the gamma level.

→ **HIGH, MEDIUM, LOW** and **NONE**.

### HUE

Adjusts the hue level. Range: -9~+9.

### SATURATION

Adjusts the saturation level. Range: -9~+9.

### LUMA DELAY

Adjusts the luma delay.

→ **0T** and **1T**.

## HDMI SETUP

### HDMI

This option is used to enable/disable HDMI output.

- **AUTO**: enables HDMI output automatically when an HDMI cable is connected.
- **OFF**: Disables HDMI output.

### RESOLUTION

The resolution options include 480p (60Hz), 720p (60Hz), 1080i (60Hz), 576p (50Hz), 720p (50Hz), 1080i (50Hz) and 1080p (50Hz).

#### Notes:

- This option is available only when the "HDMI" is set to "AUTO".
- If no display appears on the TV screen due to unsupported resolution, reconnect any available interlace video output to your display and re-adjust the resolution settings to 480p/576p.

## PREFERENCE PAGE

### IMPORTANT!

- Preference features can be selected only during "No Disc" condition or full STOP mode.

## PARENTAL

- 1 Press ▲▼ to highlight "PARENTAL".
- 2 Enter its submenu by pressing ►.
- 3 Use ▲▼ to highlight a rating level for the disc inserted.
  - DVDs that are rated above the level you selected will not play unless you enter your four-digit password and choose a higher level rating.

#### Note:

- Some DVDs are not encoded with a rating though the movie rating may be printed on the Disc cover. The rating level feature does not work for such Discs.

## DEFAULT

Setting the "DEFAULT" function will reset all options and your personal settings to the factory defaults and all your personal settings will be erased.

### Caution!

- When this function is activated, all settings will be reset to factory defaults.

## PASSWORD SETUP

### PASSWORD MODE

This feature is used to enable/disable password by selecting "ON"/"OFF".







### PASSWORD

Enter your four digit password when a hint is displayed on the screen. The default password is 1234.

# Other Functions

## Radio Reception

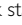
### Tuning to radio stations

- 1 Press **STANDBY-ON**  to switch on the last selected source.
- 2 Turn the **SOURCE** knob on the system (or press **TUNER** on the remote control) to select TUNER (FM) mode.
- 3 Press and hold   (or  on the remote control) until the frequency indication starts to change, then release.  
→ The system automatically tunes to the next strong radio station.
- To tune to a weak station, press   (or  on the remote control) briefly and repeatedly until an optimal reception is found.
- 4 Repeat Step 3 if necessary until you find the desired radio station.



### Presetting radio stations

You can preset up to 20 stations regardless of the reception.



### Automatic programming

- Press **PROGRAM** on the remote control for more than two seconds to activate programming.  
→ All available stations are programmed.

### Manual programming

- 1 Tune to your desired radio station (refer to "Tuning to radio stations").
- 2 Press **PROGRAM** on the remote control.  
→ "AUTO" icon flashes.
- 3 Press   to select the desired preset number:  
→ If "AUTO" icon goes off before you select the desired preset number, press **PROGRAM** on the remote control.
- 4 Press **PROGRAM** on the remote control again to store the radio station.
- Repeat steps 1-4 to store other radio stations.

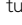
### Listening to preset radio stations

- In tuner mode, press   to select the desired preset number.  
→ The preset number, radio frequency, and waveband are displayed.

## Setting sleep/wake-up timer

### Sleep timer setting

In power-on mode, the sleep setting enables the system to switch to standby mode automatically at a preset time.

- 1 In power-on mode, press **SLEEP/TIMER** on the remote repeatedly to select a preset time.
- 2 When you reach the desired length of time, stop pressing **SLEEP/TIMER**.  
→ "SLEEP" appears.

### To deactivate the sleep timer

- Press **SLEEP/TIMER** repeatedly until "00" is displayed, or press **STANDBY-ON** .

In standby mode, the timer setting enables the system to switch on automatically at a set time.

### Wake-up timer setting

#### IMPORTANT!

– Before setting the timer, ensure that the clock is set correctly.

- 1 Press and hold **SLEEP/TIMER** until the time flashes on the display.  
→ "TIME SET" scrolls. Then, the hour digits flash on the display screen.
- 2 Turn **VOLUME** clockwise or anticlockwise or press **VOL +/-** on the remote control to set the hours.
- 3 Press **SLEEP/TIMER** to confirm.  
→ The minute digits flash on the display screen.
- 4 Turn **VOLUME** clockwise or anticlockwise or press **VOL +/-** on the remote control to set the minutes.
- 5 Press **SLEEP/TIMER** to confirm the time setting.  
→ "OFF" flashes on the display screen.
- 6 Turn **VOLUME** clockwise or anticlockwise or press **VOL +/-** on the remote control to select "ON".  
→  icon appears on the display screen.

### To deactivate the timer

- Select "OFF" at Step 6.



## Using a USB mass storage device

By connecting a USB mass storage device to the Hi-Fi system, you can enjoy the device's stored music through the powerful speakers of Hi-Fi system.

### Playing a USB mass storage device Compatible USB mass storage devices

With the Hi-Fi system, you can use:

- USB flash memory (USB 2.0 or USB1.1)
- USB flash players (USB 2.0 or USB1.1)
- memory cards (requires an additional card reader to work with this Hi-Fi system)

**Note:**

– *In some USB flash players (or memory devices), the stored contents are recorded using copyright protection technology. Such protected contents will be unplayable on any other devices (such as this Hi-Fi system).*

### Supported formats:

- USB or memory file format FAT12, FAT16, FAT32 (sector size: 512 bytes)
- MP3 bit rate (data rate): 32-320 Kbps and variable bit rate
- WMA v9 or earlier
- Directory nesting up to a maximum of 8 levels
- Number of albums/ folders: maximum 99
- Number of tracks/titles: maximum 999
- ID3 tag v2.0 or later
- File name in Unicode UTF8 (maximum length: 128 bytes)

### The system will not play or support the following:

- Empty albums
- Non-supported file formats are skipped.
- AAC, WAV, PCM audio files
- DRM protected WMA files
- WMA files in Lossless format

## How to organize your MP3/WMA files on the USB mass storage device

This Hi-Fi system will browse the MP3/WMA files in the folders/sub-folders/titles order.

Organize your MP3/WMA files in different folders or subfolders as required.

**Notes:**

- *If you have not organized MP3/WMA files into any albums on your disc, an album "00" will be automatically assigned for all those files.*
- *Make sure that the file names of MP3 files end with .mp3. and the file names of WMA files end with .wma.*
- *For DRM protected WMA files, use Windows Media Player 10 (or later) for conversion. Visit [www.microsoft.com](http://www.microsoft.com) for details about Windows Media Player and WM DRM (Windows Media Digital Rights Management).*

- ① Check the USB device has been properly connected. (See Installation: Connecting an additional appliance).
- ② Turn the **SOURCE** knob (or press **USB** on the remote control) to select USB. **NO AUDIO** appears if no audio file is found in the USB device.
- ③ Play the USB's audio files as you do with the albums/tracks on a CD (See Disc Operations).

**Notes:**

- *For compatibility reasons, the album/track information may differ from what it is displayed through flash players' music management software.*
- *File names or ID3 tags will be displayed as — if they are not in English.*

# Specifications

## Amplifier

Rated output power ..... 2 × 50W RMS  
 Frequency response ..... 20 - 20000Hz, - 3dB  
 Signal to noise ratio ..... > 65dB  
 Aux input ..... 1V RMS 20kohm

## Disc

Laser type ..... Semiconductor  
 Disc diameter ..... 12cm/8cm  
 Video decoding ..... MPEG-1 / MPEG-2 / Divx  
 Video DAC ..... 12Bits  
 Signal system ..... PAL / NTSC  
 Video format ..... 4:3 / 16:9  
 Video S/N ..... > 48dB  
 Audio DAC ..... 24Bits / 96kHz  
 Total harmonic distortion ..... < 1%  
 Frequency response ..... 40Hz - 20kHz  
 S/N ratio ..... > 65dBA

## Tuner

FM tuning range ..... 87.5 - 108MHz  
 Tuning grid ..... 50KHz  
 Sensitivity  
 – Mono, 26dB S/N ratio ..... 5uV  
 – Stereo, 46dB S/N ratio ..... 100uV  
 Selectivity ..... > 28dB  
 Image rejection ..... > 25dB  
 Total harmonic distortion ..... < 3%  
 Signal to noise ratio ..... > 50dBA

## Speakers

Speaker impedance ..... 4 ohm  
 Speaker driver ..... 5" full range  
 Frequency response ..... 20 - 20000 Hz

## General information

AC power ..... 220 – 230V, 50 Hz  
 Operation power consumption ..... 50W  
 Standby power consumption ..... < 4W  
 Composite video output ..... 1.0Vp-p, 75ohm  
 Coaxial output ..... 0.5Vpp ± 0.1Vpp 75ohm  
 Headphone output ..... 2 × 15mW, 32ohm  
 USB direct ..... Version 2.0  
 Dimensions  
 – Main unit (W × H × D) .....  
 ..... 160 × 150 × 280mm  
 – Speaker box (W × H × D) .....  
 ..... 130 × 180 × 215mm  
 Weight  
 – With packing ..... 9kg  
 – Main unit ..... 3kg  
 – Speaker box ..... 2X1.65kg

**Specifications subject to change without prior notice**

## WARNING

Under no circumstances should you try to repair the system yourself, as this will invalidate the warranty. Do not open the system as there is a risk of electric shock.

*If a fault occurs, first check the points listed below before taking the system for repair. If you are unable to remedy a problem by following these hints, consult your dealer or Philips for help.*

Problem	Solution
<b>No power.</b>	<ul style="list-style-type: none"> <li>✓ Check if the AC power cord is properly connected.</li> <li>✓ Press <b>STANDBY-ON</b>  to turn on the power.</li> </ul>
<b>No picture.</b>	<ul style="list-style-type: none"> <li>✓ Check if the TV is switched on.</li> <li>✓ Check the video connection.</li> <li>✓ Press the <b>SOURCE</b> knob to select "DVD" or press <b>DISC</b> on the remote control.</li> <li>✓ Set your TV to the correct Video In channel. This channel is usually near channel 00. Or; you may have a button on the TV remote control that selects Auxiliary or AV IN channel. See your TV owner's manual for details. Or; change channels at the TV until you see DVD screen on the TV.</li> <li>✓ If the progressive scan feature is activated but the connected TV does not support progressive signals or the cables are not connected accordingly, see "Getting started-Setting up Progressive Scan feature" for proper progressive scan setup or deactivate the progressive scan feature as below:               <ol style="list-style-type: none"> <li>1) Turn off your TV progressive scan mode or turn on to interlaced mode.</li> <li>2) Press <b>SYSTEM MENU</b> on the remote control to exit the system menu and then <b>DISC</b> and "1" to exit progressive scan.</li> </ol> </li> </ul>
<b>Distorted or poor picture.</b>	<ul style="list-style-type: none"> <li>✓ Sometimes a small amount of picture distortion may appear. This is not a malfunction.</li> <li>✓ Clean the disc.</li> </ul>
<b>Completely distorted picture or black/white picture.</b>	<ul style="list-style-type: none"> <li>✓ TV has a colour system standard. If the disc's or DVD system's colour system is different than your TV's colour system, the picture may be distorted or colourless.</li> </ul>

# Troubleshooting

**The aspect ratio of the screen cannot be changed even though you have set the TV shape.**

**No sound or distorted sound.**

**The micro DVD player does not start playback.**

**The DVD micro system does not respond when the buttons are pressed.**

**Cannot activate some features, such as Angles, Subtitles, or multi-language Audio.**

**Considerable noise in radio broadcasts.**

- ✓ The aspect ratio is fixed on the DVD disc.
- ✓ Depending on the TV, it may not be possible to change the aspect ratio.
- ✓ Adjust the volume.
- ✓ Check that the speakers are connected correctly.
- ✓ Replace the speaker cables.
- ✓ Disconnect the headphones.
- ✓ The system is in pause, slow motion or fast forward/reverse mode, press ► || to resume normal play mode.
- ✓ Insert a readable disc with the playback side facing down.
- ✓ Check the disc type, colour system and regional code. Check for any scratches or smudges on the disc.
- ✓ Press SYSTEM MENU to turn off the setup menu screen.
- ✓ Cancel the parental control rating function or change the rating level.
- ✓ Moisture has condensed inside the system. Remove the disc and leave the system turned on for about an hour.
- ✓ Disconnect the power plug from the outlet and insert again.
- ✓ Multi-language sound or subtitle is not recorded on the DVD.
- ✓ Changing the language for the sound or subtitle is prohibited on the DVD.
- ✓ The features may not be available on the disc.
- ✓ Tune in to the correct frequency.
- ✓ Connect the antennas.
- ✓ Fully extend the FM wire antenna. Position for best reception and secure to a wall.
- ✓ Connect an outdoor FM antenna.
- ✓ Adjust the direction and position for best reception.
- ✓ Place the antenna farther away from any equipment that may be causing the noise.
- ✓ Increase the distance between the system and your TV or other equipment.

## The remote control does not function.

- ✓ Select the correct source (DISC or TUNER, for example) before pressing the function button.
- ✓ Point the remote control at the remote sensor of the unit.
- ✓ Reduce the distance to the player.
- ✓ Remove any possible obstacles.
- ✓ Replace the batteries with new ones.
- ✓ Check that the batteries are loaded correctly.

## The display is dark.

- ✓ Press DIM again.

## Low hum or buzz sound.

- ✓ Place the DVD micro system as far away as possible from electrical devices that may be causing interference.

## Low bass response.

- ✓ Check all speakers for correct polarity.

## Unable to select Progressive Scan

- ✓ Check that the output of the video signal is switched to 'Pr/Cr Pb/Cb Y'.

## Some files on the USB device are not displayed.

- ✓ Check if the number of folders exceeds 99 or the number of titles exceeds 999.

## "DEVICE NOT SUPPORTED" scrolls on the display.

- ✓ Remove the USB mass storage device or select another source.

## No sound is output from the HDMI jack.

- ✓ Check the connection between the TV and the HDMI jack of the DVD player.
- ✓ See if the TV supports this 480p/576p/720p/1080i DVD player.
- ✓ Check your TV system setup correctly.

Meet Philips at the Internet  
<http://www.philips.com>

English

中文

Español

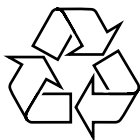

MCD772



© 2010 Koninklijke Philips Electronics N.V.  
All rights reserved.



Printed in China

MCD772\_73\_UM\_V2.0