

PHILIPS

CD Soundmachine

AZB500



www.philips.com/welcome

- 
- 
- 

Before using your product, read all accompanying safety information.

---

6X1.5V R14/UM2/C CELL

To play with the device, you can use either alkaline battery (R14) or AC power.

AUDIO-IN/CD RADIO OFF

+ VOLUME -

**DBB**

DBB

AUDIO-IN/CD RADIO OFF

AUDIO IN



2021 © MMD Hong Kong Holding Limited. All rights reserved. Specifications are subject to change without notice.

Philips and the Philips Shield Emblem are registered trademarks of Koninklijke Philips NV. and are used under license. This product has been manufactured by and is sold under the responsibility of MMD Hong Kong Holding Limited or one of its affiliates, and MMD Hong Kong Holding Limited is the warrantor in relation to this product.



AZB500\_79\_Short User Manual\_V6.0

**DAB**

For first time use

- 
- 
- 
- 

**Use DAB menu**

- In DAB mode, press MENU to access the DAB menus.
- Press / to toggle through the menus.
- Press OK to enter the menu.

/ MENU

/

DAB FULLSCAN

DAB MANUAL

DAB DRC

DAB PRUNE

DAB SYSTEM

DAB DRC OFF

**PHILIPS**

Warranty against Defects

In this warranty:  
 We or us means MMD Hong Kong Holding limited ABN 531 651 059 75, and our contact details are set out at the end of this warranty.  
 You means the purchaser or the original end-user of the Goods.  
 Supplier means the authorised distributor or retailer of the Goods that sold you the Goods in Australia or New Zealand; and  
 Goods means the product or equipment which was accompanied by this warranty and purchased in Australia or New Zealand.

If you require assistance with the operation of the product, its features or specifications please call the Philips Consumer Care Centre on +61 3 9358 5999 in Australia or +64 6 8737095 in New Zealand.

**Australia:** Our Goods come with guarantees that cannot be excluded under the Australian Consumer Law. You are entitled to a replacement or refund for a major failure and for compensation for any other reasonably foreseeable loss or damage. You are also entitled to have the Goods repaired or replaced if the goods fail to be of acceptable quality and the failure does not amount to a major failure. This is not a complete statement of your legal rights as a consumer.

**New Zealand:** Our Goods come with guarantees that cannot be excluded under the Consumer Guarantees Act 1993. This guarantee applies in addition to the conditions and guarantees implied by that legislation.

**Additional Warranty:**  
 In addition to the rights and remedies that you have under the Australian Consumer Law, Consumer Guarantees Act of New Zealand or any other applicable law, we provide the following warranty against defects:

- If, during the first 12 months from their date of purchase from the Supplier (Warranty Period), the Goods prove defective by reason of improper workmanship or materials and none of your statutory rights or remedies apply, we will repair or replace the Goods without charge.
- We do not have to repair or replace the Goods under this Additional Warranty if the Goods have been used for a commercial purpose, misused, improperly or inappropriately installed, operated or repaired; abused; damaged; or not maintained in accordance with the manufacturer's instructions.
- Even when we do not have to repair or replace the Goods, we may decide to do so anyway. In some cases, we may decide to substitute the Goods with a similar alternative product of our choosing. All such decisions are at our absolute discretion.
- All such repaired, replaced or substituted Goods continue to receive the benefit of this Additional Warranty for the time remaining on the original Warranty Period.
- This Additional Warranty is limited to repair, replacement or substitution only. As far as the law permits, we will not be liable for any loss or damage caused to property or persons arising from any cause whatsoever.
- In order to claim under this Additional Warranty you must telephone us on +61 3 9358 5999 in Australia or +64 6 8737095 in New Zealand within the Warranty Period. You will be asked for details of the Goods, a description of the defect and your personal details. Upon accepting your claim, we shall assess you with either returning the Goods to the Supplier for replacement or to the most convenient Philips Authorised Service Centre for your Goods to be repaired. In some cases we may require that you return to the Goods to us (at the address below) for repair, replacement or substitution.

All returned Goods must be accompanied by satisfactory proof of purchase which clearly indicates the name and address of the Supplier, the date and place of purchase and identifies product. It is best to provide a legible and unmodified receipt or sales invoice.

You must bear any expense for return of the Goods or otherwise associated with making your claim under this Additional Warranty.

- This warranty is only valid and enforceable in Australia and New Zealand. Contact us or the place of purchase for further details.

Australia  
 Powermove Distribution Pty Ltd  
 28 The Gateway, Broadmeadows, 3047  
 www.powermove.com.au

New Zealand  
 Direct Imports NZ Ltd  
 203 Nelson Street South Hastings 4122 New Zealand

Consumer Care: +61 3 9358 5999  
 Email: support@powermove.com.au  
 Website: www.philips.com/support

Consumer Care: +64 6 8737095  
 Email: service@direct-imports.co.nz  
 Website: www.philips.com/support

www.philips.com/support

User Manual

Tune to a radio station

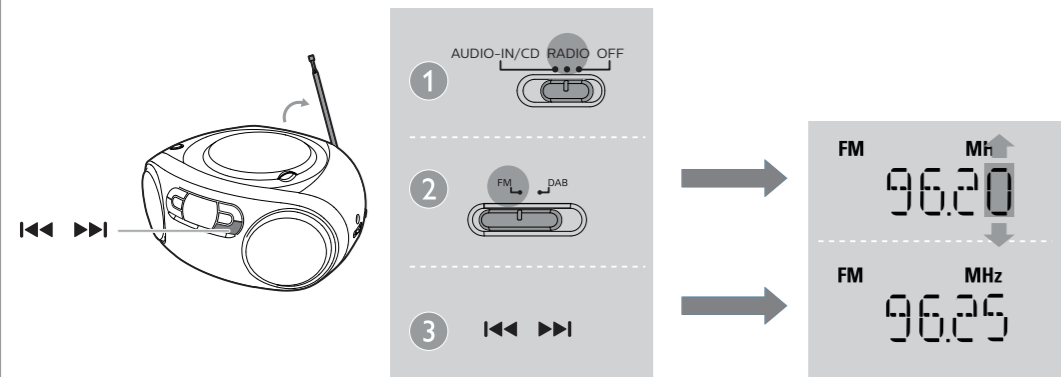

Program FM radio stations automatically

Press and hold PROG for 2 seconds to activate automatic programming.  
 ↳ All available radio stations are stored automatically, then the first stored radio station is broadcast.

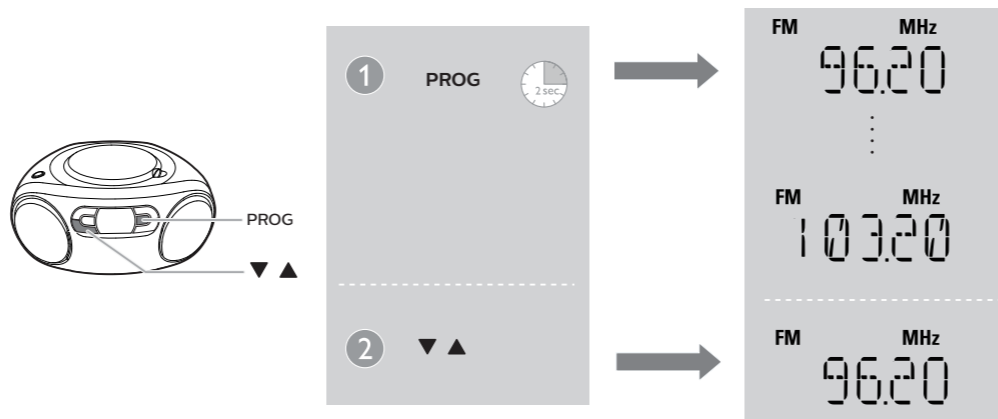

Specifications

<b>Amplifier</b>	
Rated Output Power	2 x 1W RMS
Frequency Response	125 - 16000 Hz, -3dB
Signal to Noise Ratio	>55 dBA
Audio-in Input	650 mV RMS

<b>Disc</b>	
Laser Type	Semiconductor
Disc Diameter	12cm/8cm
Support Disc	CD-DA, CD-R, CD-RW
Frequency Response	125-16000 Hz, -3dB
S/N Ratio	>55 dBA

<b>Tuner</b>	
Tuning Range	FM: 87.5 - 108 MHz DAB: 174.928 - 239.200 MHz

Sensitivity:	
Mono, 26dB S/N Ratio	<22 dBf
Stereo, 46dB S/N Ratio	<43 dBf

Search Selectivity	50KHZ(FM)
Total Harmonic Distortion	<3%
Signal to Noise Ratio	>50 dBA

General

Power supply	220-240V~, 50/60 Hz;
-AC Power	DC 9V, 6x1.5V type;
-Battery	R14/UM2/C CELL
Operation Power Consumption	10W
Standby Power Consumption	<0.5W
Dimensions	
-Main Unit (W x H x D)	300 x 134 x 240mm
Weight (Main Unit)	1.4kg

1 Important

Safety

- Read these instructions.
- Follow all instructions.
- Do not block any ventilation openings. Install in accordance with the manufacturer's instructions.
- Do not install near any heat sources such as radiators, heat registers, stoves, or other apparatus (including amplifiers) that produce heat.
- Protect the power cord from being walked on or pinched, particularly at plugs, convenience receptacles, and the point where they exit from the unit.
- Only use attachments/accessories specified by the manufacturer.
- Unplug this unit during lightning storms or when unused for long periods of time.
- Recording is permissible insofar as copyright or other rights of third parties are not infringed upon.
- Refer all servicing to qualified service personnel. Servicing is required when the unit has been damaged in any way, such as power-supply cord or plug is damaged, liquid has been spilled or objects have fallen into the apparatus, the unit has been exposed to rain or moisture, does not operate normally, or has been dropped.
- Battery usage CAUTION - To prevent battery leakage which may result in bodily injury, property damage, or damage to the unit:
  - Install all batteries correctly, + and - as marked on the unit.
  - Do not mix batteries (old and new or carbon and alkaline, etc.).
  - Remove batteries when the unit is not used for a long time.

- Batteries (battery pack or batteries installed) shall not be exposed to excessive heat such as sunshine, fire or the like.
- CAUTION: Danger of explosion if battery is incorrectly replaced. Replace only with the same or equivalent type.
- The unit shall not be exposed to dripping or splashing.
- Do not place any sources of danger on the unit (e.g. liquid filled objects, lighted candles).
- Where the MAINS plug or an appliance coupler is used as the disconnect device, the disconnect device shall remain readily operable.

Warning

- Never remove the casing of this apparatus.
- Never place this apparatus on other electrical equipment.
- Never look into the laser beam inside this apparatus.

Caution

- Use of controls or adjustments or performance of procedures other than herein may result in hazardous radiation exposure or other unsafe operation.

Notice

Any changes or modifications made to this device that are not expressly approved by MMD Hong Kong Holding Limited may void the user's authority to operate the product. Hereby, TP Vision Europe B.V. declares that this product is in compliance with the essential requirements and other relevant provisions of Directive 2014/53/EU. You can find the Declaration of Conformity on [www.philips.com/support](http://www.philips.com/support).

Disposal of your old product

Your product is designed and manufactured with high quality materials and components, which can be recycled and reused.

This symbol on a product means that the product is covered by European Directive 2012/19/EU. Inform yourself about the local separate collection system for electrical and electronic products. Follow local rules and never dispose of the product with normal household waste. Correct disposal of old products helps prevent negative consequences for the environment and human health.

Environmental information

All unnecessary packaging has been omitted. We have tried to make the packaging easy to separate into three materials: cardboard (box), paper pulp (buffer) and polyethylene (bags, protective foam sheet). Your system consists of materials which can be recycled and reused if disassembled by a specialized company. Please observe the local regulations regarding the disposal of packaging materials, exhausted batteries and old equipment.

This apparatus includes these labels:



Class II equipment symbol

This symbol indicates that the apparatus has a double insulation system.

The making of unauthorized copies of copy-protected material, including computer programs, files, broadcasts and sound recordings, files, broadcasts and sound recordings, may be an infringement of copyrights and constitute a criminal offence. This equipment should not be used for such purposes.

Be responsible  
Respect copyrights

Note

- The type plate is located on the bottom of the apparatus.

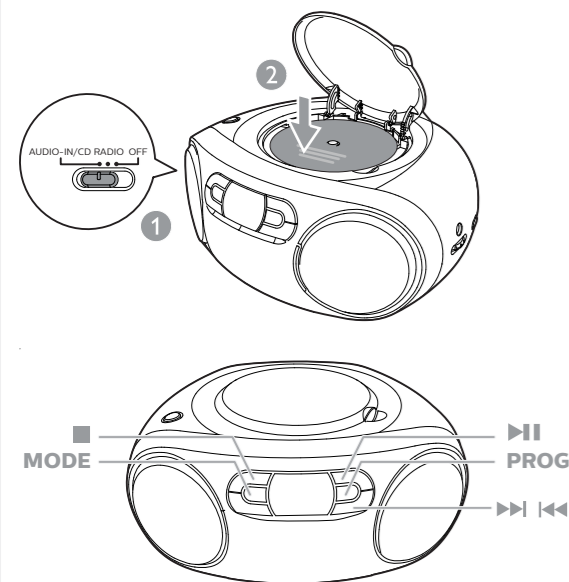

⏮ / ⏭	Press to skip to the previous/next track. Press and hold to search within play, then release to resume play.
⏸	Start of pause play.
■	Stop play or erase a program.
PROG	Program the sequence of tracks.
MODE	Select a play mode.

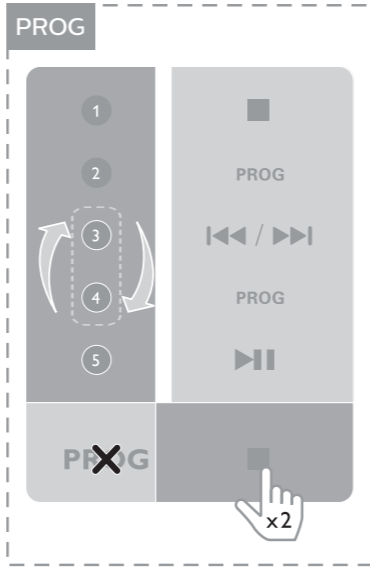

Program tracks

- Press ■ to stop playback.
- Press PROG to activate the program mode.
- Press ⏮ / ⏭ to select a track, then press PROG to confirm.
- Repeat steps 3 to program more tracks.
- Press ⏸ to play the programmed tracks.
  - To erase the program, press ■ twice.

Note:

- In CD mode, the CD sound machine switches to standby mode automatically if there is no audio signal detected for over 15 minutes.
- Press ⏸ to wake up the CD sound machine from standby mode.