

What's in the box?

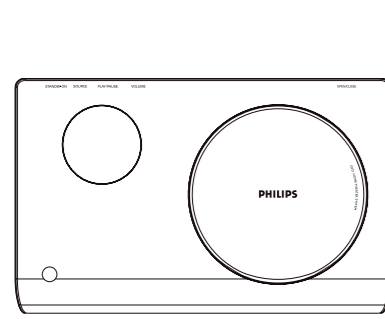

DVD Home Theatre (main unit)

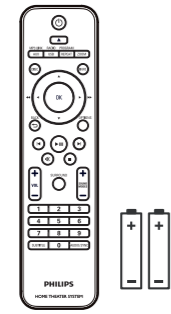

Remote Control and 2 batteries

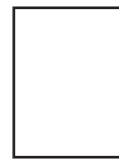

User Manual

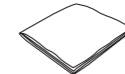

Micro fibre cleaning cloth

Optional cables:

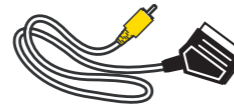

Scart converter cable

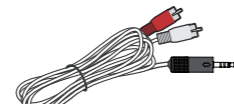

Audio cables



FM wire antenna

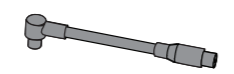

FM extension cable



3.5mm stereo audio cable (for MP3 LINK)



Mounting guide

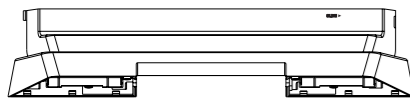
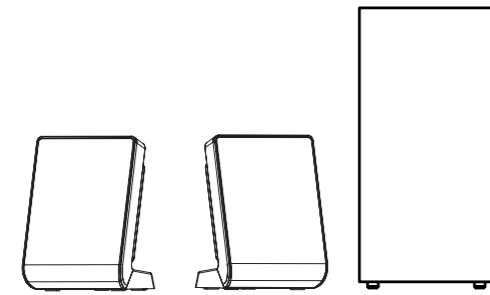
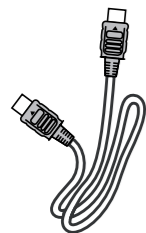

Table stand (for main unit)



2 speakers and subwoofer



HDMI cable

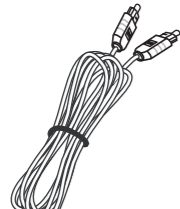

Optical cable

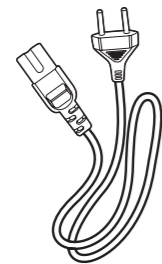

Power cable



Interconnect cable

Placement

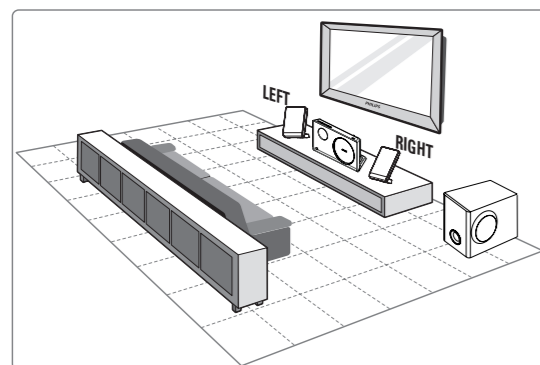

Proper speakers system placement is important to ensure optimum sound performance.

- 1 Place the speakers at the normal listening ear level, equal distance from the TV and face it straight ahead towards the listening area.
- 2 Place the subwoofer on the floor, at least one metre away from the TV.

Need help? User Manual

See the user manual that came with your Philips DVD Home Theatre System.

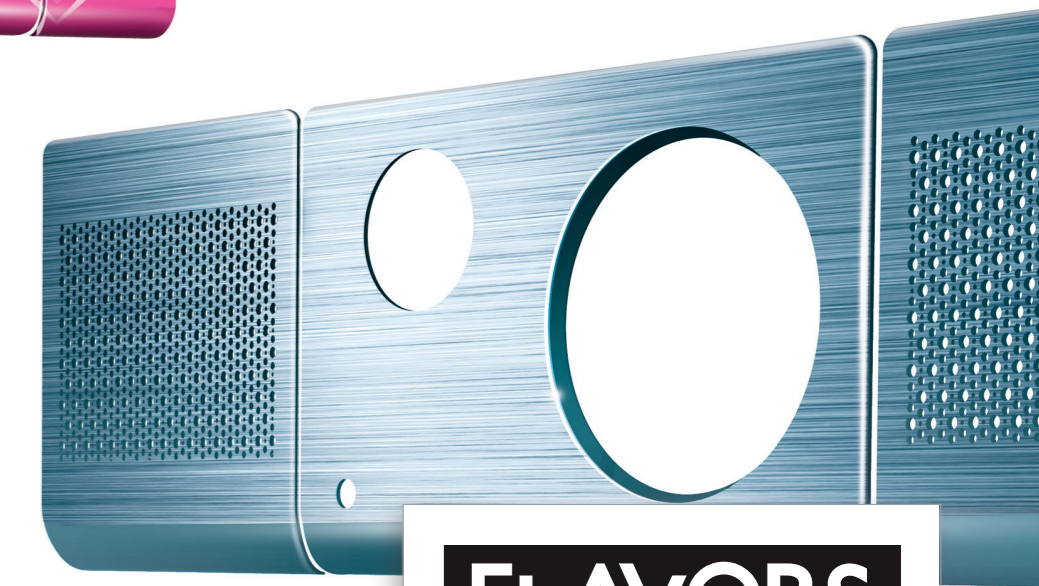
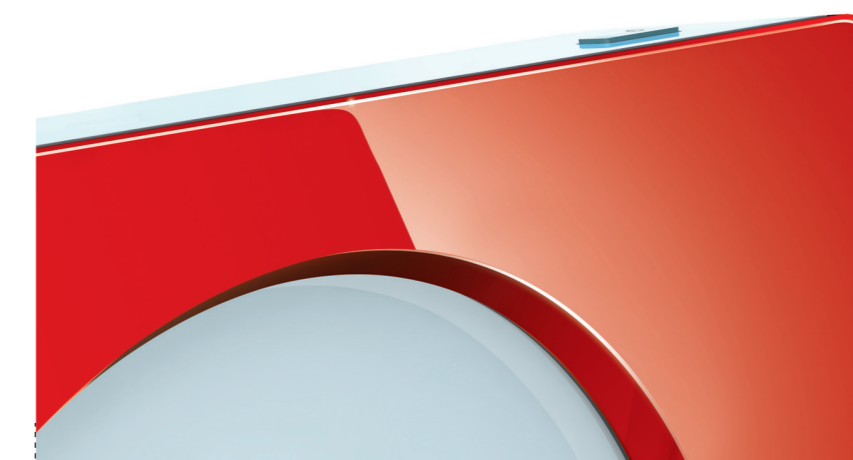
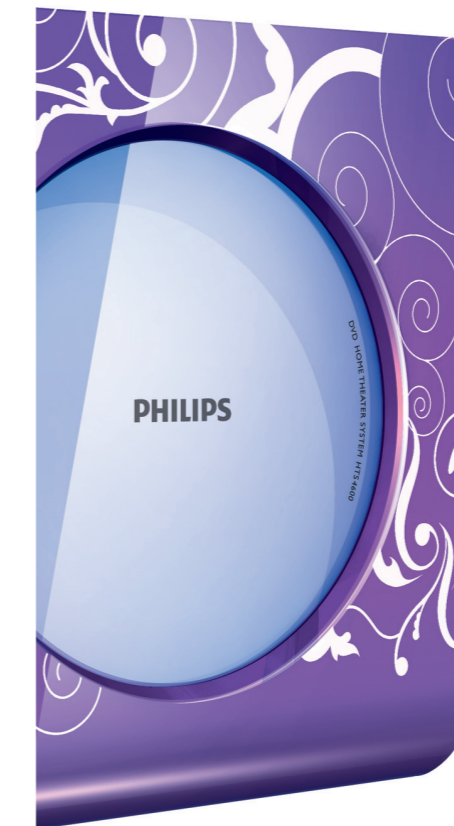

FLAVORS

Quick start guide

FTS6000

Register your product and get support at
www.philips.com/flavors

EN Home Theatre System



2008 © Koninklijke Philips N.V.
All rights reserved.
www.philips.com
sgpjy-837-eng

Be responsible
Respect copyrights

1 Connect

A Connect to TV

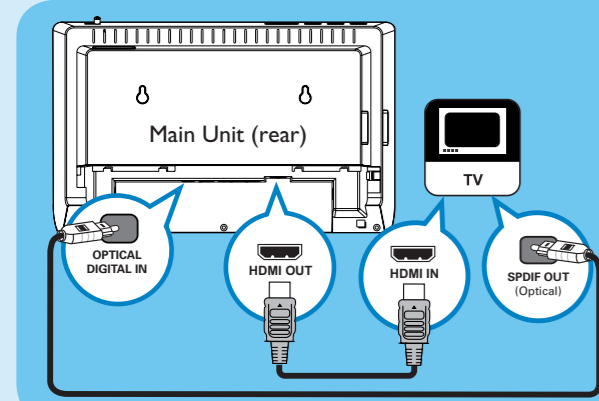

- 1 Connect a HDMI cable (supplied) from the HDMI OUT socket to the HDMI IN socket on your TV.
- 2 Connect an optical cable (supplied) from the DIGITAL IN-OPTICAL socket to the SPDIF OUT/OPTICAL OUT sockets on your TV.

Note

- If your TV does not support HDMI, connect a scart converter cable from the CVBS socket to the SCART socket on your TV.
- To listen to the audio output from this connection, press **AUX/MP3 LINK** repeatedly until 'DI' is displayed on the display panel.

B Connect speakers

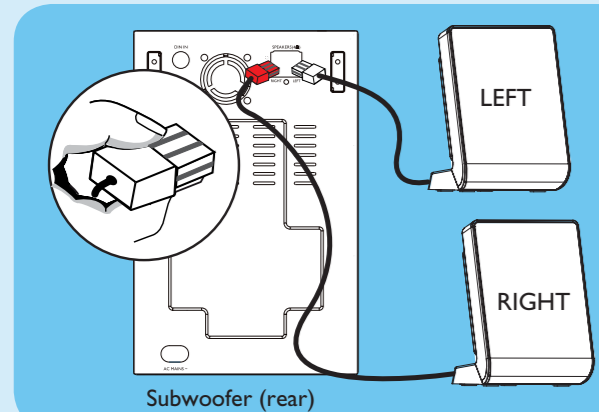

- Connect the left and right speakers to the matching sockets on the subwoofer.

C Connect subwoofer and power cable

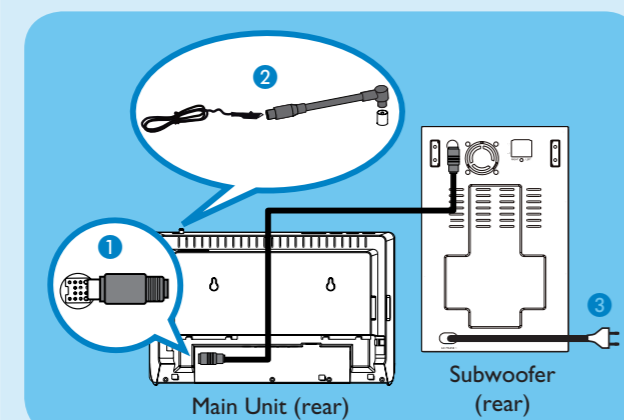

- 1 Connect the interconnect cable between TO MAIN UNIT socket on the subwoofer and TO SUBWOOFER socket on the main unit.
- 2 Connect the FM extension cable and FM antenna to the inner pin of the FM 75 Ω socket. Extend the wire for optimum reception.
- 3 Connect the power cable from subwoofer to the AC power outlet.

D Attach table stand and Flavors frames

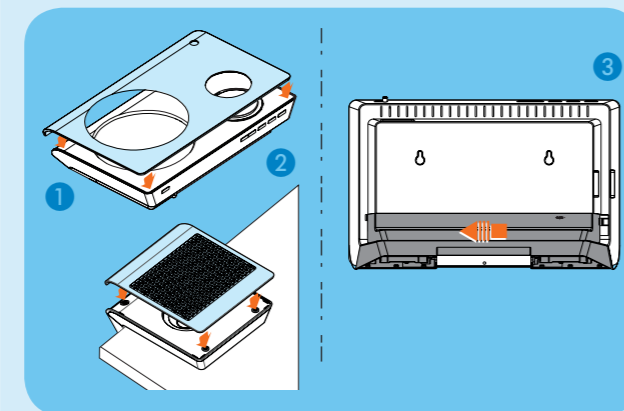

- 1 Place the main unit/speakers on a flat surface with the front panel facing up.
- 2 Attach the frames to the front panels of the unit and speakers.
- 3 Attach the table stand to the rear of the main unit and slide it to the left to lock into position.

2 Set up

A Find the viewing channel

- 1 Press **POWER** to turn on this DVD Home Theatre unit.
- 2 Turn on the TV. Use the TV's remote control to select the correct viewing channel.

Note To search for the correct viewing channel, press the Channel Down button on the TV's remote control repeatedly (or AV, SELECT, **CH-** button) until you see the Video In channel.

B Select on-screen display language

- 1 Press **OPTIONS**. [General Setup] menu is displayed.
- 2 Press **RIGHT**.

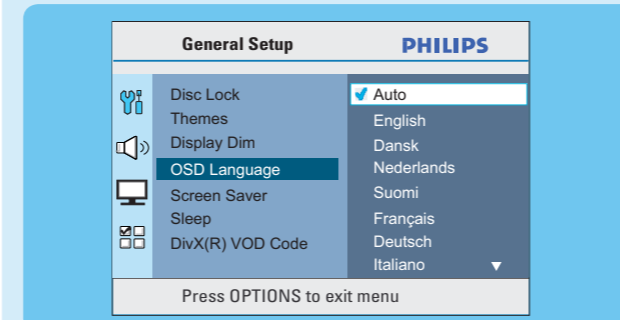

- 3 Press **DOWN** to select [OSD Language], then press **RIGHT**.
- 4 Press **UP/DOWN** to select a language option, then press **OK**.
- 5 Press **OPTIONS** to exit.

Note The language set here is only for the menus that are shown on the TV while operating this DVD Home Theatre unit, not for the DVD disc menu.

C Apply a menu theme

You can change the appearances of your wallpaper and mp3 browser.

- 1 Press **OPTIONS**. [General Setup] menu is displayed.
- 2 Press **RIGHT**.

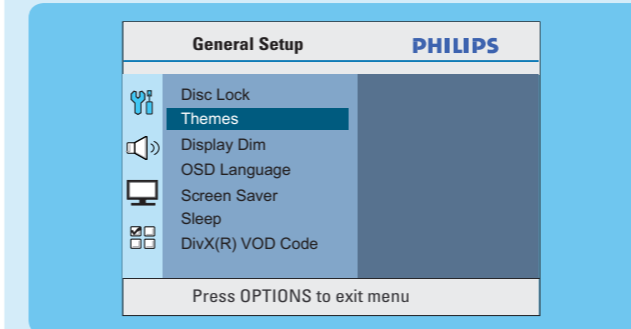

- 3 Press **DOWN** to select [Themes], then press **RIGHT**.

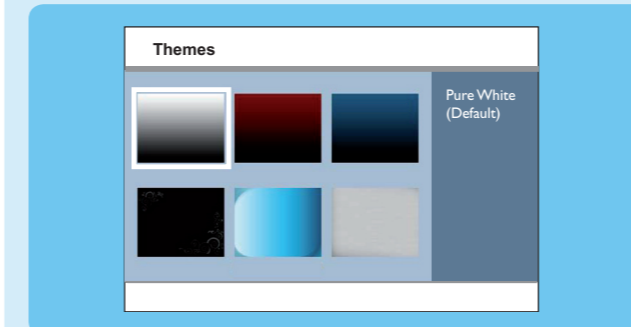

- 4 Press **LEFT/RIGHT** to select a theme, then press **OK**. A message appears.
- 5 Select [Yes] to confirm, then press **OK**.

There are various setup options (Audio Setup, Video Setup, Preferences) available on this DVD Home Theatre unit. Refer to the user manual for more information.

3 Enjoy

A Start disc play

- 1 Press **OPEN/CLOSE** to open the disc compartment.

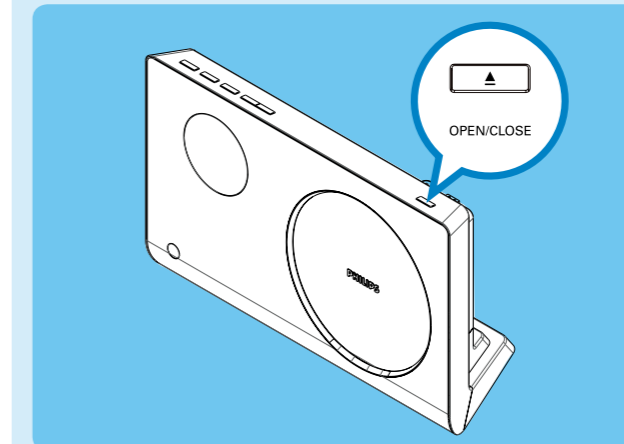

- 2 Place a disc with the disc label facing out.

- 3 Press **OPEN/CLOSE** to close the disc compartment and start disc play.

- If the disc menu is displayed on the TV, use cursor buttons to select an option in the menu, then press **OK**.

- To enjoy powerful surround sound, press **SURROUND** to turn on the multi-channel surround mode.

- 4 Press **STOP** to stop play.

Note When you press **PAUSE**, playback resumes from where it was last stopped. To start playback from the beginning, press **LEFT** while the message is displayed.



B Play other supported devices

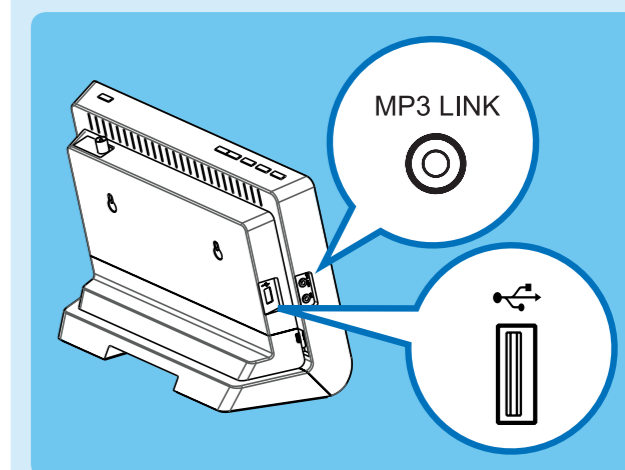

USB device

- 1 Insert your USB device to the USB socket.
- 2 Press **USB/RADIO** repeatedly to switch to 'USB' mode.
- 3 Select a file to play, then press **PAUSE**.
- 4 To stop play, press **STOP** or remove the USB device.

Other portable media player

- 1 Connect a 3.5mm stereo audio cable (supplied) from the MP3 LINK socket to the headphone output socket on your portable media player.
- 2 Press **AUX/MP3 LINK** repeatedly until 'MP3 LINK' is displayed.
- 3 Press **PLAY** on your portable media player.