

.....	108
.....	108
.....	108
.....	108
.....	108

.....	109
.....	110-112
.....	112

.....	113-117
.....	113
.....	114
.....	114
S-Video	114
.....	115
HDMI	115
.....	116
FM AMMW	117
.....	117
.....	118
.....	118
/ VCR	118

.....	119-123
.....	119
.....	119
.....	120
(OSD)	120
DVD	120-121
.....	121
.....	122
.....	123

.....	124-132
.....	124
.....	124
.....	125
/	125
.....	126
(DVD/VCD/SVCD)	126-129
.....	126
.....	127
/	127
.....	127
.....	127
.....	127
.....	128
.....	128

(VCD	128
(VCD/SVCD	129
MP3/WMA	130
JPEG ()	131
	131
/	131
MP3/WMA JPEG	132
DvX	132

- USB	133
USB USB	133
-	134
	134
- CK	135
CK	135

	136-143
	136
	137
	138 139
	140 141
	142 143

	144-145
	144
	144
	144 145
	144
	145
	145
	145
	145

	146
	146
	146
	146
	147
	147
	148-150
(USB)	151
	152-153
	154

=====

-
-
)
(CD) AC
- AC

-
10 (4) 5
(2)

-
()

=====

- 1
- 2
- 2
- 1
- 1 ()
- 1 ()
- 1 FM
- 1 AMMW
- 1 MP3 LINE-IN ()
- 1
-

=====

=====

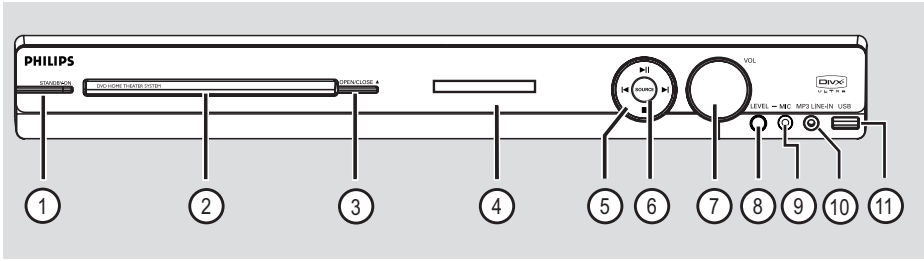

a **STANDBY-ON**

-

b

c **OPEN/CLOSE ▲**

- /

d

e **▶▶ (/)**

- DISC /

- RADIO

◀▶ (/)

- DISC /

- /

- DISC

- RADIO

■ ()

-

- DISC

- RADIO

f **SOURCE**

-

DISC FM AMMW TV AUX DI
MP3 LINE-IN

g **VOL**

-

h **LEVEL**

-

i **MIC**

-

j **MP3 LINE-IN**

-

k **USB**

- USB USB

中文(繁體)

中文 (繁體)

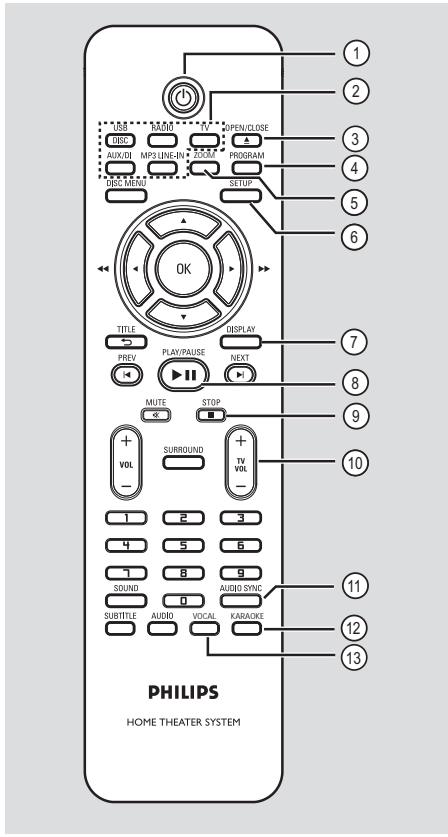

c **OPEN/CLOSE ▲**

- /

d **PROGRAM**

- DISC /
- RADIO

e **ZOOM**

-

f **SETUP**

-

g **DISPLAY**

-
- DVD (

h **PLAY/PAUSE ►||**

- DISC /
- RADIO

i **STOP ■**

-
- DISC
- RADIO

a **⏻**

-

b

- DISC/USB DISC USB

RADIO FM AMMW
TV

AUX/DI AUXI DIGITAL IN

MP3 LINE-IN
MP3 LINE-IN

j **TV VOL +/-**

- (

k **AUDIO SYNC**

-

l **KARAOKE**

-

m **VOCAL**

-

n **DISC MENU**

- DVD
- VCD/SVCD

o **OK**

-

p **▲▼◀▶**

- DISC
- DISC
- RADIO

- RADIO

q **TITLE C**

- DVD
- VCD 2.0

r **PREV ◀ / NEXT ▶**

- DISC /
- RADIO

s **MUTE ㄨ**

-

t **VOL +/-**

-

u **SURROUND**

-

v 0-9

-

-

w **SOUND**

-

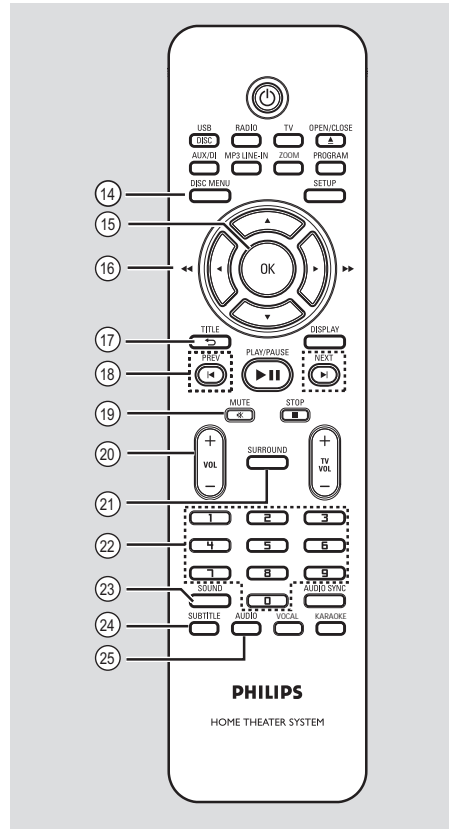

中文 (繁體)

x **SUBTITLE**

- DVD

y **AUDIO**

- DISC /

()

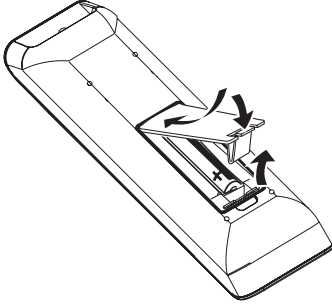

-
-) (
-

中文(繁體)

A

B (+ -) R03

AAA

C

D

()

E

DISC/USB RADIO
TV AUX/DI MP3 LINE-IN

F

(
◀, ▶)

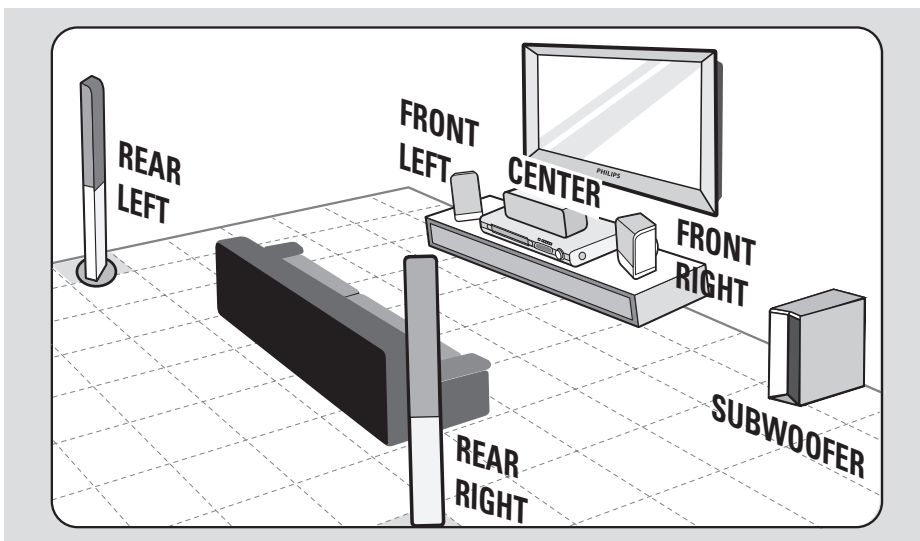

中文(繁體)



A

45

REARLEFT
 () REAR RIGHT ()
 FRONTLEFT(
) FRONT RIGHT ()

B

C

D

()

中文 (繁體)

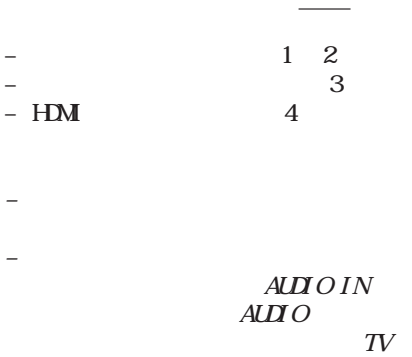
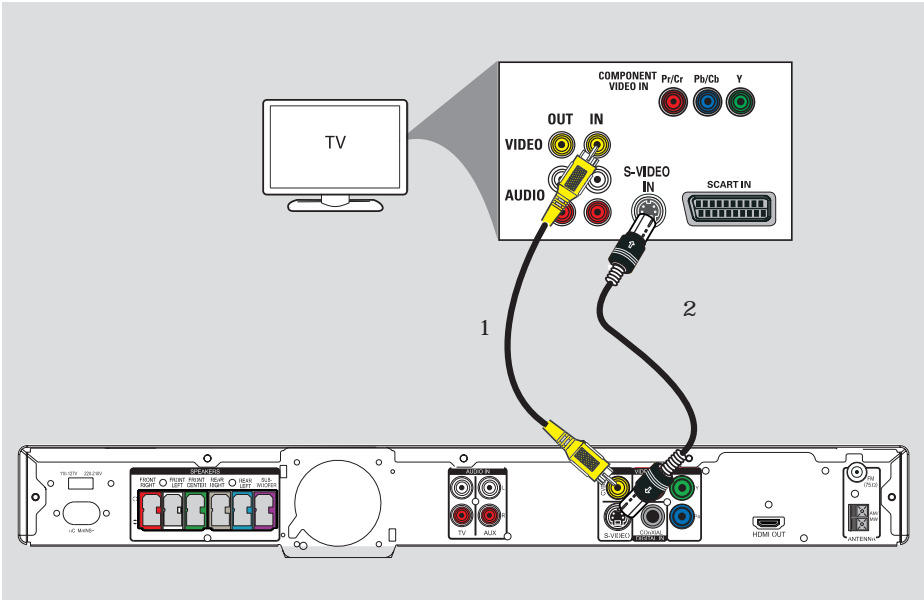

CVBS
(A/V In Video In
Composite Baseband)



S-Video ()
S-VIDEO
S-Video ()
Y/C S-VIDEO

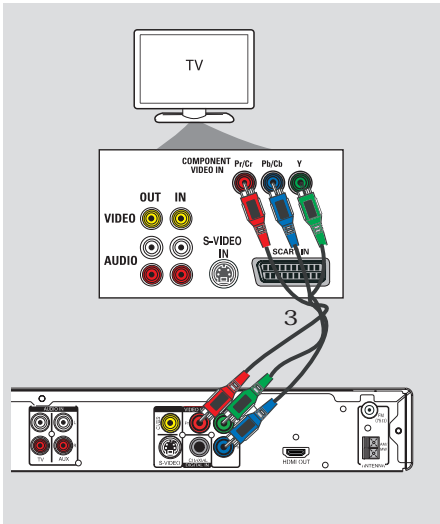

Y Pb Pr

DVD

A) (/ / -
Y Pb Pr ()
Y Pb/Cb Pr/Cr YU)

B

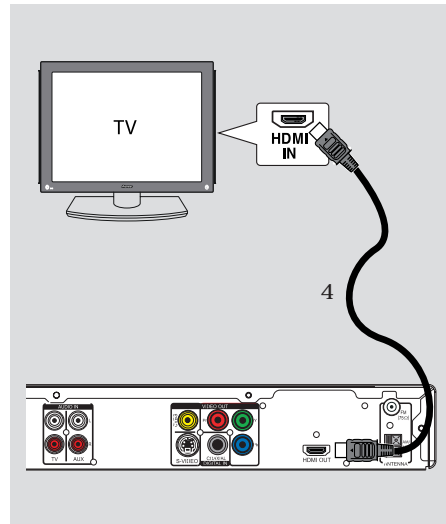

HDMI

(HDMI)

A HDM () HDM OUT
HDM (HDM HDM
HDCP DM) HDCP
IN HDM

B

HDM

- DM
- HDM
DM

中文(繁體)

()

中文(繁體)

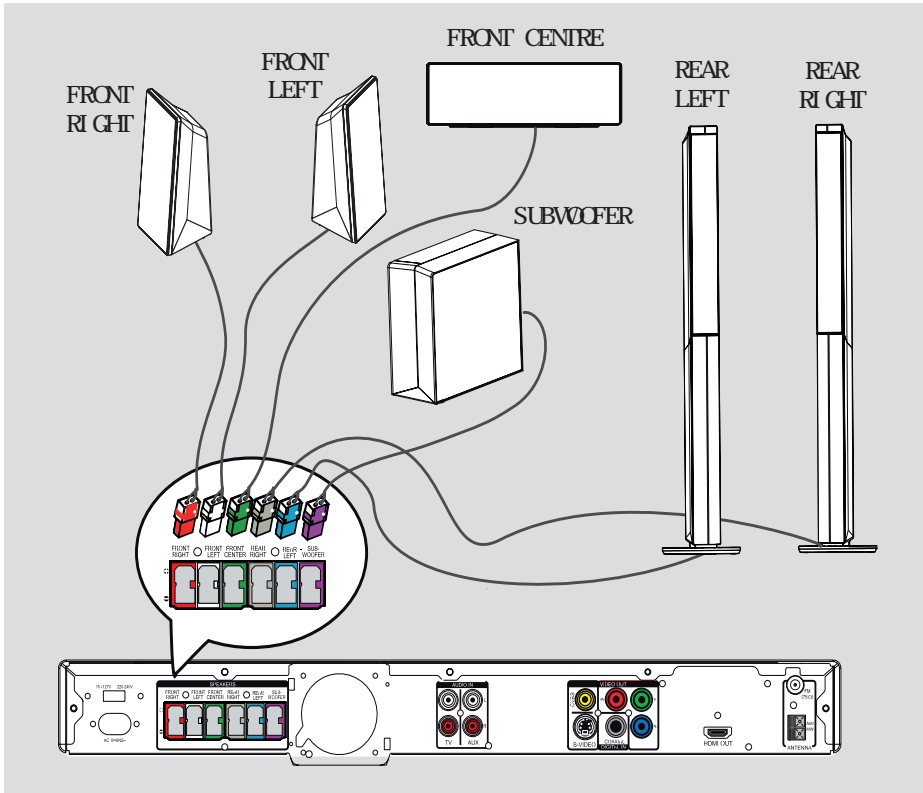

AC

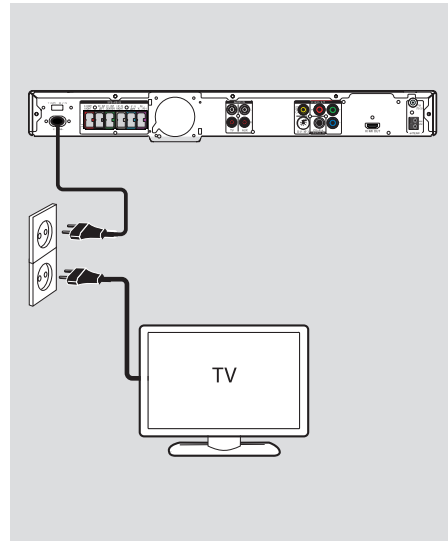
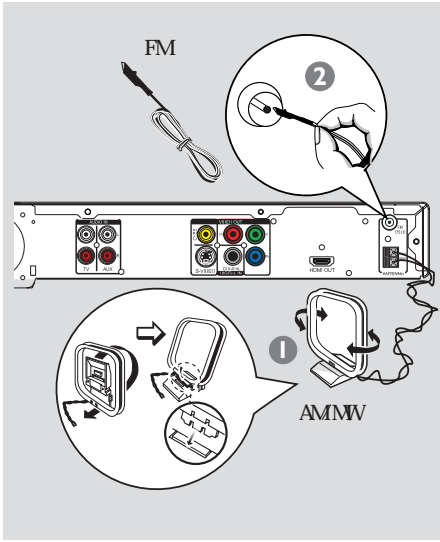

中文(繁體)

FM AMMW

A AMMW AMMW
 AMMW

B FM FM75 Ω
 FM

 FM
 FM ()

-
 - VCR

A

110-127V 220-240V

B AC
 è

LED

-

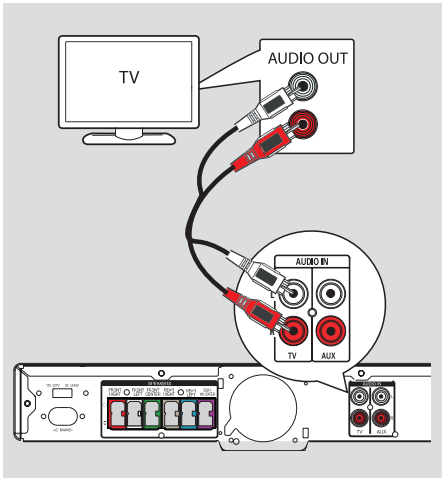

(/ -)
AUDIO IN-TV
AUDIO OUT

TV

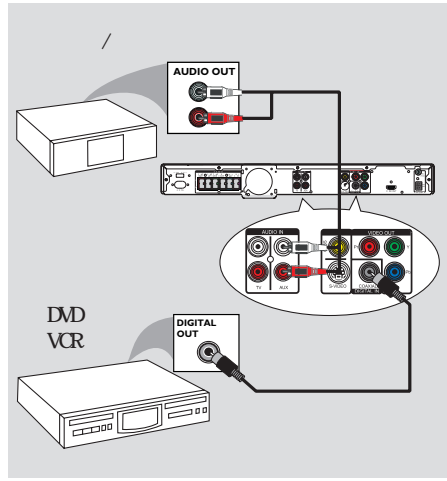

/ VCR / (DVD)

(/ -)
AUDIO IN-AUX
AUDIO OUT

AUX () AUX/DI

()
COAXIAL DIGITAL IN
DIGITAL ()

DI AUX/DI

A SOURCE
 " DISC ()
 (DISC/USB

B

è

Channel Down
 Video In

è



è

FRONT A/V IN

VIDEO

è

SOURCE

DISC → FM → AM/MW → TV → AUX
 → DISC → MP3 LINE-IN → DISC

.....

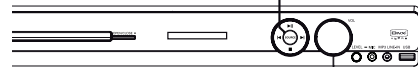

中文(繁體)

DISC/USB RADIO
 TV AUX/DI MP3 LINE-IN
 è DISC/USB DISC
 USB (USB)
 è RADIO FM AM/MW

è

TV
 è AUX/DI
 AUDIO IN AUX COAXIAL DIGITAL
 IN

è MP3 LINE-IN
 MP3 LINE-IN

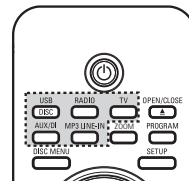

()

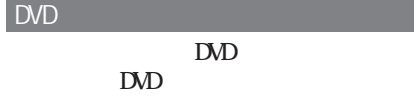

- A ■ ()
- SETUP
- B i { }
- C d e i

中文 (繁體)

- A SETUP
- è { }
- B e { }
- i

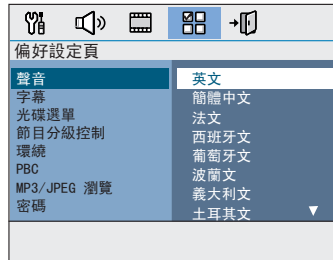

- C d e
- OK

- { }
- DVD
- { }
- DVD
- { }
- DVD

- D d e
- OK

()

{ } 0-9

() OK

E C ~ D

- DVD
AUDIO SUBTITLE

- DVD / / DVD

A
SETUP

B i { }

C e i { }

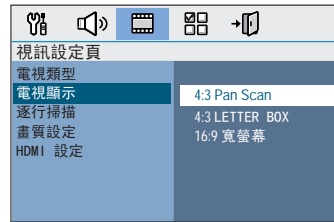

{ 4:3 Pan Scan }



{ 4:3 Letter Box }



{ 16:9 }



D

OK

中文(繁體)

()



()

()

... Y Pb Pr ()
3

A

è ()

B

DI SC/USB

C

SETUP

D

i { }

E

{ } { } >
{ } CK

F

OK

OK

G

) (

è

H

OK

OK

è

中文(繁體)

A

OPEN/CLOSE ▲

B

h

C

AUDI O

-

/

15

-

DVD

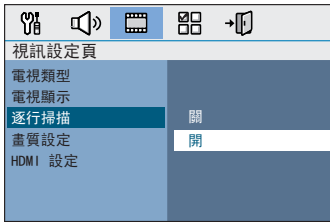



) (

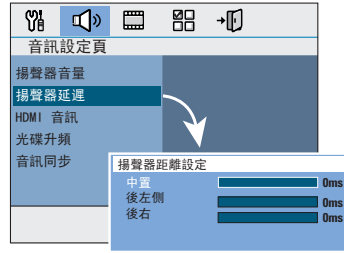

STOP

F hi
(0 ~ 15)

A
SETUP

G OK

B i { }

- / 1

C e { }
i

30
-

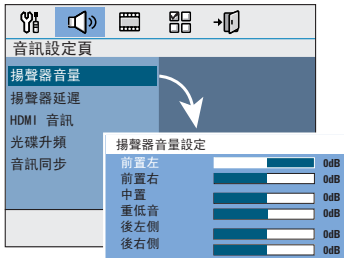

D hi
(-6dB ~ +6dB) OK

E de { }
i

中文(繁體)



中文 (繁體)

- DVD (DVD)
- Video CDs (VCD)
- Super Video CDs (SVCD)
- DVD (DVD±R) DVD (DVD±RW)
- Audio Compact Discs (CD)
- MP3/Windows Media Audio discs CD-R(W) (Kodak, JPEG)
 - ISO 9660/UDF
 - JPEG 3072 x 2048
 - 32 kHz
 - 44.1kHz 48 kHz
 - 32~256(kbps) (128 kbps)
- CD-R(W)/DVD±R(W) DivX
 - DivX 3/4/5/6, DivX Ultra

DVD
DVD

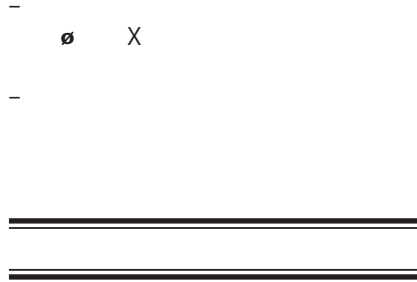

- A SOURCE " DISC (DISC/USB
- B è DVD
- C OPEN/CLOSE ▲
- D OPEN/CLOSE ▲
- è
- E è
-
-

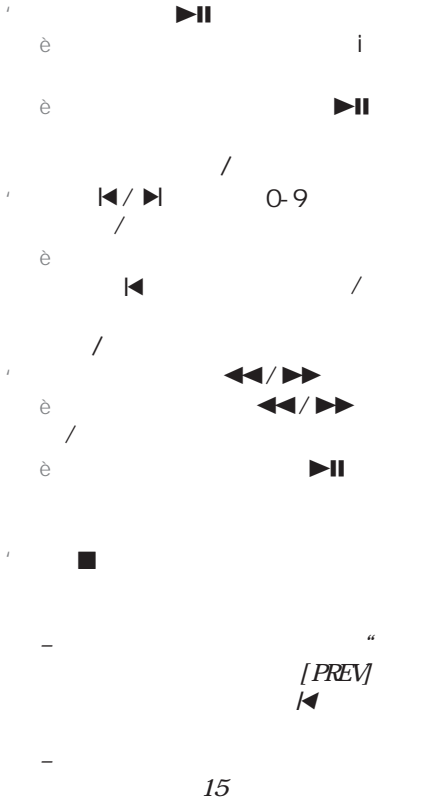

DVD/SVCD/VCD

A DI SPLAY

è

B e

C i

DI SPLAY

DVD

- " RPT ONE ()
- " RPT TT ()
- " SHUFFLE ()
- " RPT SHF ()
- " RPT OFF ()

VCD/SVCD/CD

- " RPT ONE ()
- " RPT ALL ()
- " SHUFFLE ()
- " RPT SHF ()
- " RPT OFF ()

MP3/DivX/Windows Media™

- " RPT ONE ()
- " RPT ALL/FLD ()
- " SHUFFLE ()
- " RPT OFF ()

中文(繁體)

()

(Picture CD/MP3)

(DVD/VCD/SVCD)

A PROGRAM



編程: 曲目 (01-16)	
1 04	6 --
2 10	7 --
3 12	8 --
4 --	9 --
5 --	10 --
退出 開始 下頁 ▶	

B 0-9 /

C h i d e

{ } 10 OK

/ OK

D OK { } 0-9 h i d e OK

è

E { } OK DISC MENU

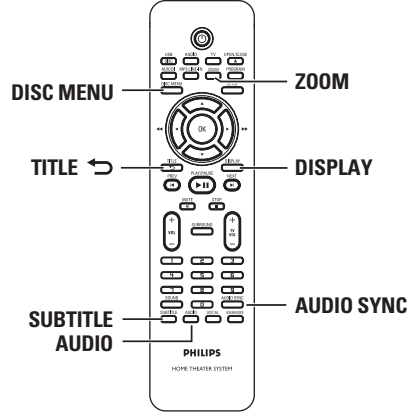

()



(/)

A ZOOM

A è

DI SPLAY

è

B h i d e

DVD

C ZOOM



DVD DVD

VCD/SVCD

SUBTITLE



DVD

中文(繁體)

B d e
OK

A DI SPLAY

è

C 0-9 /
d e

B e

D OK / /
è

C i

()



DVD

VCD

(PBC)

(PBC)

AUDI O

PBC

VCD-

AUDI O

(PBC)

VCD

(2.0)

()

TITLE C



- PBC
- { }

中文(繁體)

A AUDI O SYNC

B 5 VCL + -
(0 ~ 200)
è 5

- AUDI O SYNC
- { }

(VCD/SVCD)
VCD/SVCD



A DISC MENU

{ }

OK

OK

選擇摘要類型:

- 曲目摘要
- 光碟間隔
- 曲目間隔

C

{ }

OK

B de

OK

{ }

{ }

{ }

01 A	02 B	03 C
04 D	05 E	06 F
退出		選單

中文(繁體)

()

MP3/VMA

CD MP3 Windows
Media Audio



d
OK

DI SPLAY

D

中文(繁體)

A

MP3/VMA

è

30

è

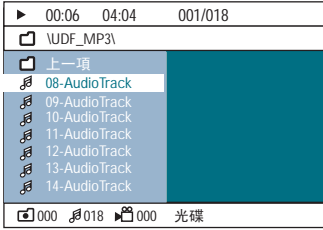

- MP3/JPEG

JPEG NAV { }

MP3/

MP3/VMA

- MP3/VMA

(ID3)

B

d e

OK

C

d e

OK

è

JPEG ()

...

JPEG (Kodak Picture
CD JPEG)
Kodak
JPEG



- /

- *.JPG
- *.JPEG

JPEG EXIF

JPEG
JPEG

JPEG
JPEG

A 12

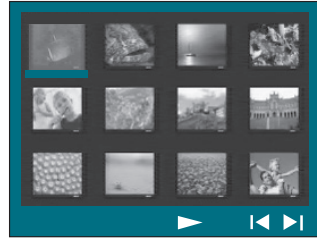

B /

C h i d e
OK

D D I S C M E N U

A ZOOM

B h i d e

/ h i d e

d
e
h
i

中文(繁體)

()

MP3/VMA	
JPEG	
MP3/VMA	JPEG

DivX	
DivX	
- DivX(R)	- {
	}

A VMA

B CK

C de CK

è

è

D ■ DISC MENU

A DivX
B hide

C CK

DivX

SUBTITLE

DivX

AUDIO

◀ / ▶

/
DISPLAY

è

-
(.srt, .smi, .sub, .ssa,
.ass)

-
45

中文(繁體)

USB USB

USB

USB
(JPEG MP3 Windows Media
Audio DivX)

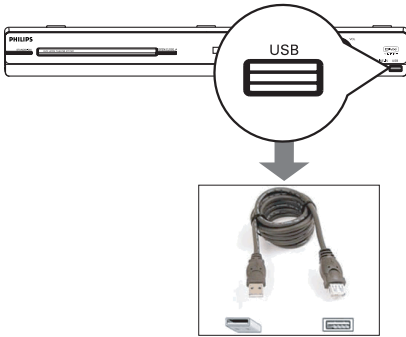

A USB / USB
() USB

B 5



C DISC/USB

è

è

D

MP3/WMA
()

JPEG
DivX

DISC/USB

E USB
DISC/USB

- USB USB
- / USB
- USB USB
- USB
- USB

中文(繁體)

中文 (繁體)

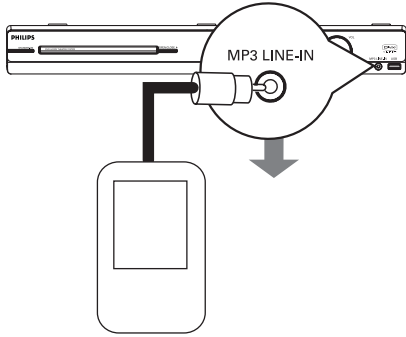

A MP3 LINE-IN

MP3 LINE-IN

B MP3 LINE-IN

C è

D

RADIO (DISC/USB

OK

A () () MIC

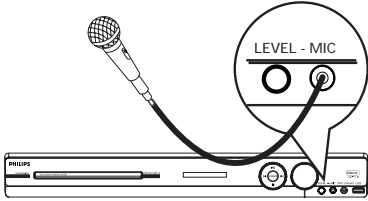

A KARACKE

麥克風設定	
麥克風	開
麥克風音量	關
迴音級數	
音調	
得分	

B d e

OK

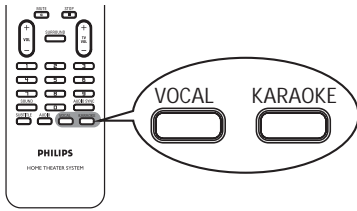

B OK

d e

OK

C

OK

VOCAL

D

OK

LEVEL

{ }	OK
{ } - -	(0 ~ 20) 10
{ } - -	(0 ~ 20) 10
{ } - - -	(- 10~ +10) - 10 +10
{ } - - -	∞
{ } - - -	OK { }

中文(繁體)

中文(繁體)

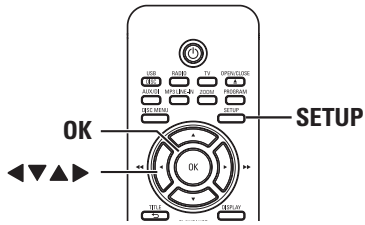

A
SETUP

B h i

OK



SETUP { }
STOP ■ SETUP

C d e
i

D OK

è

è

E SETUP

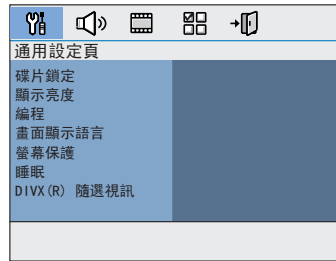

137

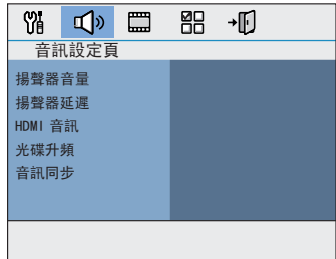

138-139

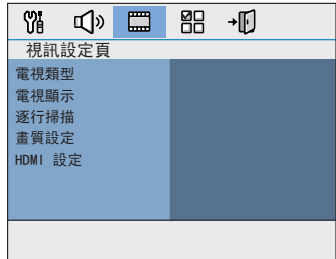

140-141

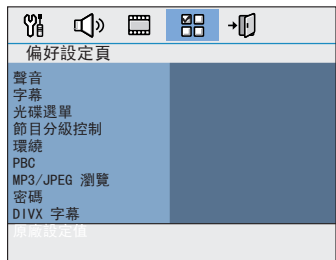

142-143

()

()

[Redacted]

{ } -

6
136900 ({
- })

{ } -

[Redacted]

{ 100% } -

{ 70% } -

{ 40% } -

LED

[Redacted]

[Redacted]

[Redacted]

{ } -

5

{ } -

[Redacted]

{ 15/30/45/60 } -

{ } -

Di vX(R) [Redacted]

Di vX®

Di vX®
(www.di.vx.com/vod)

Di vX®

i

OK

中文(繁體)

()

()

h i
-6dB +6dB

h i

/ 1 (1)

中文(繁體)

HDMI

HDMI CUT
(

4

HDMI

)

{ } - HDMI

{ } - HDMI

PCM

{ _____ PCM } - PCM(2)

-

- HDMI SACD
DVD Audio CPPM()

()

()

{ _ } -
{ 88.2 kHz (X2) } -

-

-

SURROUND

hi
0-200

中文(繁體)

()

()

(PAL NISC)

{ PAL } - PAL
 { NTSC } - NISC
 { _____ } - PAL NISC

中文(繁體)

{ 4:3 Pan Scan } -



{ 4:3 Letter Box } -



{ 16:9 } - (16:9)



() Y PB PR

{ } -
 { _ } - CK

{ _____ } -
 { _____ } -
 { _____ } -
 { _____ } - h i



CK { 0 }

HMI

()

()

HDMI

HDMI /

{ } -

{ 16:9 }

{ }

{ }

(4:3

{ 4:3 Pillar Box }

4:3

{ _ }

720p 1080i

{ }

{ HDMI } -

/

HDMI

{ 480p }

NISC

480

{ 576p }

PAL

576

{ 720p }-

720

HDMI

{ 1080i }-

1080

HDMI

{ _ }

480p/576p

()

()

DVD

DVD

DVD

DVD

/ /

DVD

1) d e 1 8 CK
2) 0-9 6

- / (1 8
)
8

- DVD VCD

SVCD CD

- DVD
6

{ ____ } -
{ } -

PBC

VCD/SVCD
Video CDs (2 0)

{ __ } - VCD/SVCD
()

{ } - VCD/SVCD

()

()

MP3/JPEG

MP3/JPEG

{ } - MP3/
{ } - MP3/

650 /

136900

1) OK

變更密碼

舊密碼	<input type="text"/>
新密碼	<input type="text"/>
確認密碼	<input type="text"/>
<input type="button" value="確認"/>	

2) 0-9 { }
6

136900

3) { } 6
4) { } 6
5) OK

DivX

DivX

{ } -
{ } -
{ } -
{ } -
{ } -
{ } -
{ } -

OK

中文(繁體)

FM ... AMMW

A SOURCE
FM (

RADI O

B h / i

C B

D d / e

20 AMMW 40 FM

()

20

5

(AMMW/ FM
9 kHz/ 50 kHz
10 kHz/ 100 kHz)

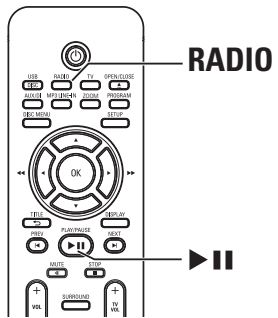

A SOURCE
FM AMMW

B >

C ►|| 10 9

A RADI O

è " AUTO I INSTALL
... PRESS PLAY (...
PLAY)

B ►||

è AMMW

è FM

è

()

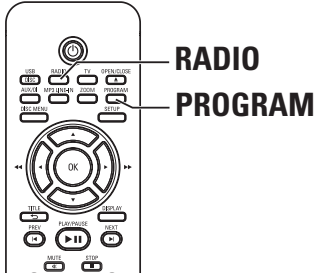

A RADIO FM AMWX

B ◀ / ▶ ()
è



A RADIO FM AMWX

A ◀ / ▶

B PROGRAM
“ START ... (...)
è

B ■ “ FMAMWX
DELETED ()
è X
è

è



A ()

B PROGRAM

C ◀ / ▶

D PROGRAM

中文(繁體)

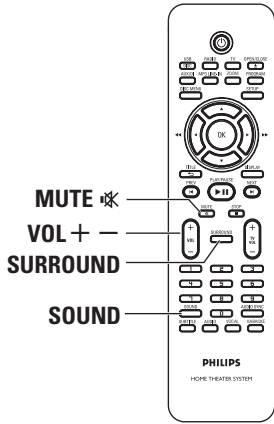

VOL +/-
 è VOL MIN ()
 VOL MAX ()

MUTE 静音
 è MUTE ()
 è MUTE 静音

SURROUND

è

è DIS ()
 II

è ()

SOUND

CONCERT	CLASSIC	DVD
DRAMA	JAZZ	
ACTION	ROCK	/
MTV	RnB	R&B
GAMING	PARTY	
CARTOON	LOUNGE	
SPORTS	SPORTS	
NEWS	NEWS	/
NIGHT	NIGHT	

A

OPEN/CLOSE ▲

B

è

DI SPLAY

C

con/support

www.philips.

CD R

D

è

CD R

E

è

CD R

F

中文(繁體)

()

-
 - AC
 -
 - DVD
 - DISC/USB
 - 15
 1) OPEN/CLOSE ▲
 2) h
 3) AUDIO
 -
 -
 -
 -
 -
 -
 -
 -
 -
 - SOURCE
 (TV AUX/DI)
 -
 - SURROUND
 - (DIS
)
 - i , ◀ / ▶
 (DISC/USB RADIO)
 -
 -
 -

-	CD R		DVD+R/
-	SETUP		
-			
-	DVD		
-		DVD	
-	DVD		
-			STOP
-			
-	Di vX	Di vX	
-	Di vX		
-			
-		VCR	
-			
-			

/
Di vX

中文(繁體)

()

(USB/HDMI)

USB

- USB

-

(NIFS)

USB

-

USB

HDMI

-

DM /HDCP (

) HDMI

- HDMI

SACD

DVD Audi o

-

- { - HDMI }

HDMI

-

HDMI HDCP (

) HDMI

HDCP) DM

HDMI)

(DM

-

HDMI - HDMI } - { HDMI

HDMI - HDMI }



(USB)

USB
 - /) (500 " Good Bye. jpg"
 (" Good_B-1. jpg") (FAT16)
 1MB) - 8
 - / -
) (USB USB
) USB

USB HDD
 USB EXIF
 HDD EXIF
 (jpg) (mp3)
 USB
) ((MP)

FAT16 FAT32
 NIFS

中文(繁體)



_____ Dbl by Laborat ori es

_____ AUDIO LEFT/RI GHT _____) (_____ II

_____ 4 3 _____

_____ 16 9 Letter box _____ II

_____ 4 3 _____

_____) (_____ II

_____) (_____

_____ (kbps) _____ DTS _____ DIS

_____ HDM _____ (HDM)

_____ DMD _____ HDM DM

_____ HDCP (_____) HDM

_____ DM _____

_____ (CVBS) _____

_____ DMD _____ HDCP (_____)

_____ Di vX Di vX _____

_____ MPEG 4 _____ Di vX _____

_____ Networks Inc. _____

_____ JPEG _____

_____ Joi nt Phot ographi c Expert Group _____

_____ JPG _____ JPEG _____

MP3

MP3
3 (Motion Picture Experts
Group 1 (MPEG 1) Audio Layer 3)
MP3 CD R CD RW
CD 10

MPEG

_____ DVD

PBC

VCD/ VCD

()

_____ DVD

WMA Windows Media Audio
Microsoft Corporation
Windows Media
Player 9 Windows Media
Player for Windows XP WMA
WMA



