

Listen to messages recorded on the answering machine (for SE365 only)

- Start/Stop playback: Press play/stop.
- Adjust the volume: Press **+** / **-**.
- Skip backward:
During message playback, press **◀** to play the message from the beginning.
During the first second of the current message, press **◀** to play the previous message.
- Skip forward: Press **▶** to skip to the next message.
- Delete the current message: Press erase.

Note

- For more information, see the Telephone answering machine section in the user manual.

Troubleshooting

No dialing tone

- Check your phone connections.
The handset is out of range. Move it closer to the base station.

The signal icon flashes.

- The handset is out of range. Move it closer to the base station.
If the handset displays **[UNREGISTERED]**, register the handset.

The caller ID does not display.

- The service is not activated. Check with your service provider.
The caller's information is withheld or unavailable.
For more information, see the User Manual.

Welcome to Philips

Register your product at www.philips.com/welcome

Need help?

User Manual

Refer to the User Manual that came with your new phone.

Online help

www.philips.com/support

© 2009 Koninklijke Philips Electronics N.V. All rights reserved. Reproduction in whole or in part is prohibited without the written consent of the copyright owner. Trademarks are the property of Koninklijke Philips Electronics N.V. or their respective owners.



Register your product and get support at www.philips.com/welcome

SE360
SE365



Quick Start Guide

- 1** Connect
- 2** Install
- 3** Enjoy



CE 0168

Printed in China

SE360-365_37_QSG_EN_V2.0

PHILIPS

What's in the box



Handset

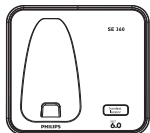

Base station with
bracket for SE360
OR



SE365

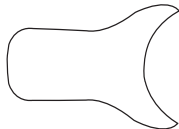

Belt clip

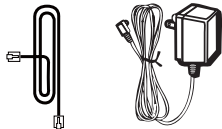

Line cord*

Power supply



User manual



Guarantee



Quick Start Guide

Note

- In some countries, you have to connect the line adaptor to the line cord, then plug the line cord to the line socket.
- In multi-handset packs, there are additional handsets and chargers with power supply units.

Caution

- Use only the supplied batteries and adaptor

1

Connect

Connect the base station

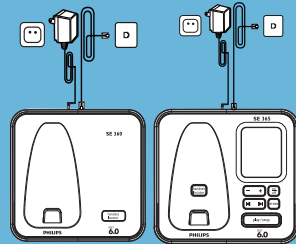
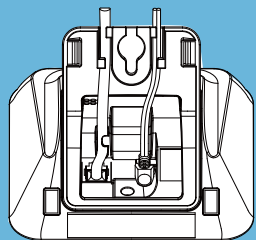

- 1 Connect the output plug of the power plug to the bottom of the base station.
- 2 Connect the power socket to a standard wall outlet.
- 3 Connect the telephone line cord to the phone socket at the bottom of the base station and the wall phone socket.

2

Install

Install the handset



- 1 The batteries are pre-installed in the handset. Pull the battery tape off from the battery door before charging.
- 2 Place the handset on the base station to power up.

Note: Charge the batteries for 24 hours before first use.

For more information on the battery icon status, see the User Manual.

3

Enjoy

Make a call

- 1 Press **TALK** and dial the phone number; or
- 2 Dial the phone number and press **TALK** to dial out the call.

Answer a call

When the phone rings, press **TALK** or **END** to answer the call.

End a call

Press **END**.

Adjust the earpiece volume

Press **UP** or **DOWN** to adjust the volume during a call.

Set the handset's ringtone

- 1 Press menu.
- 2 Select **[PERSONAL SET] > [HANDSET TONES] > [RING TONES]**, then press **[OK]** to confirm.
- 3 Select a ringtone, then press **[OK]** to confirm.
↳ The setting is saved.

Add a record

- 1 Press menu.
- 2 Select **[PHONEBOOK] > [NEW ENTRY]**, then press **[OK]** to confirm.
- 3 Enter the name then press **[OK]** to confirm.
- 4 Enter the number, then press **[OK]** to confirm.

Call from the phonebook

- 1 Press **DOWN** to access the phonebook.
- 2 Select a contact in the phonebook list.
- 3 Press **TALK** to make the call.