



Philips CarStudio  
Car audio system

- CD
- 6 x 9"
- 300W Peak

**CarStudio**

**CMB1102**

# Experience live music in car

Obsessed with sound

Philips CMB1102 lets you seamlessly enjoy multiple source music from CD & portable MP3 players with the by-packed 6x9" 300W car speakers. It features detachable front panel for anti-theft and anti-shock protection for smooth grooves.

## Enjoy superior sound

- MAX Sound for instant power boost
- Music Zone for adjustable sweet spots
- Dynamic Bass Boost electronically enhances the low tones
- 2-band parametric equalizer with 8 presets
- Super anti-shock protection for smooth music enjoyment
- Built-in 50W x 4 amplifiers for excellent sound quality

## Easy to use

- MP3 Link for portable music playback
- Browse by folder or song for instant search or quick access

## Vivid sound on the road

- Oval polypropylene cone enriched, deep bass boost
- Soft PEI dome tweeter for warm and textured tones
- Butyl rubber surround for maximum smooth response

**PHILIPS**

# Highlights

## Music Zone

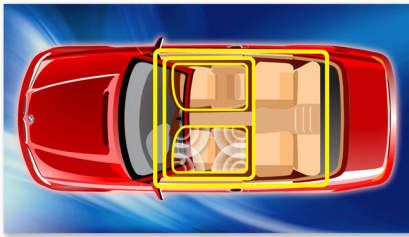

Philips' innovative Music Zone technology lets the driver and the passengers enjoy their music with more vivid spatial effect, just as the artist intended it to be heard. Users can easily switch the music listening zones from the driver to the passengers and back again to get the best sonic focus in the car. A dedicated zone control button provides three pre-defined settings - Left, Right and Front (and All) - so you can best match your listening needs easily and dynamically alone or with your passengers.

## DBB Dynamic Bass Boost



Activate the Dynamic Bass Boost (DBB), and the low-end bass frequencies are electronically enhanced to achieve consistent sound reproduction, especially when the speaker

volume is set at a low level. You hear impressive bass at all times.

## MP3 Link



The MP3 link connectivity allows direct playback of MP3 content from portable media players. Besides the benefit of enjoying your favorite music in the superior sound quality delivered by the audio system, the MP3 link is also extremely convenient as all you have to do is to plug your portable MP3 player to the audio system.

## Browse by folder or song

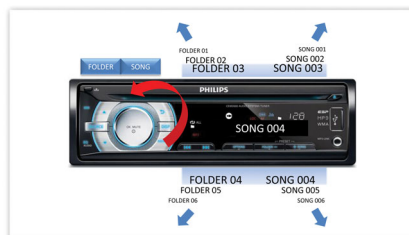

This function allows you to find a track or album much faster by letting you browse through songs and folders, which are the usual contents of USB/SDHC devices. With the dedicated folder/song button, only three

simple steps are needed to make a search – press folder/song, rotate the volume knob and push to select. This simple process lets you search through your music quickly and easily, letting you to focus on your driving.

## MAX Sound



MAX Sound technology produces an instant boost in bass and treble, maximizing volume performance and instantly creating the most impressive listening experience with just the touch of a button. Its sophisticated electronic circuitry calibrates existing sound and volume settings, instantly boosting bass, treble and volume beyond original maximum levels without distortion. The end result is a noticeable amplifying of both sound spectrum and volume and a potent audio boost that will add mileage to any music.



# Specifications

## Display

- Type: High contrast B/W LCD (9 characters)
- Key illumination: Red
- Diffused light in disc slot: Red

## Playback media

- Disc: CD, CD-R, CD-RW, MP3-CD, WMA-CD, WMA
- MP3 Link: for portable MP3 music playback
- Music devices via Rear Aux

## Audio Playback

- Compression format: MP3, WMA
- Disc Playback Modes: Fast Forward/Backward, Next/Previous Album Search, Next/Previous Track Search
- ID3 Tag support: Song title, artist, album
- MP3 bit rates: 32-320kbps and variable bit rate

## Tuner/Reception/Transmission

- Tuner Bands: AM, FM Stereo
- Auto digital tuning
- Tuner Enhancements: Auto search and store
- No. of preset stations: 18(FM), 12(AM)

## Connectivity

- Preamp output: 2 pairs RCA(L/R)
- Rear Aux input
- Hard-wired audio mute
- Hard-wired remote input

## Security/Anti-theft

- Front panel: Detachable

## Sound

- Equalizer: 2-bands
- Equalizer settings: Classic, Jazz, Pop, Rock, Flat, Optimal, Techno, User defined
- Sound Enhancement: MAX Sound, Dynamic Bass Boost, Music zone
- Output power (MAX): Car radio: 50Wx4 channels; Car speaker: 300W (one pair)
- Output power (RMS): Car radio: 22Wx4 channels (4 ohms, 10% T.H.D.); Car speaker: 50W x 2
- Frequency response: Car speaker: 28-32k Hz

- Impedance: Car speaker: 4 Ohms
- Sensitivity: Car speaker: 90dB

## Loudspeakers

- Number of Loudspeakers: 2
- Number of ways: 3-way
- Speaker size: 16x24cm (6x9")
- Speaker type: Coaxial speaker

## Woofers

- Damper: Conex
- Diaphragm: Cone
- Diaphragm material: Polypropylene
- Magnet: Ferrite
- Magnet mass: 12.6 Oz
- Surround: Rubber
- Voice coil: Single
- Voice coil material: Copper

## Mid-range

- Diaphragm: Cone
- Diaphragm material: Paper
- Magnet: Neodymium
- Size: 54 mm (2-1/8")

## Tweeter

- Diaphragm: Dome
- Diaphragm material: PEI
- Magnet: Neodymium
- Size: 15mm (3/5" )

## Accessories

- Remote control: Slim remote with battery
- User Manual: Brazilian Portuguese, English, Spanish
- Cables: Speaker wires
- Speaker grille: With metal net

## Power

- Power supply: 12V DC

## Dimensions

- Chassis: 1 Din
- Product dimensions (car radio): 188 x 190 x 58mm ( W x D x H )
- Product dimensions (speaker): 263 x 192 x 104mm ( W x D x H )



Issue date 2013-08-13

Version: 1.0.3

12 NC: 8670 001 06289  
EAN: 87 12581 69696 2

© 2013 Koninklijke Philips N.V.  
All Rights reserved.

Specifications are subject to change without notice.  
Trademarks are the property of Koninklijke Philips N.V.  
or their respective owners.

[www.philips.com](http://www.philips.com)