

Register your product and get support at
www.philips.com/welcome

AS140



EN User manual

PHILIPS

Contents

Charge Android-powered phone 22

1 Important 3

- Safety 3
- Know these safety symbols 3

2 Your Docking System for Android™ 4

- Introduction 4
- What's in the box 4
- Overview of the docking system 5

3 Get started 6

- Connect power 6
- Turn on 7
 - Switch to standby mode 7
- Select a source 7

4 Play and charge 7

- Compatible with Android™ 7
- Play audio through manual Bluetooth connection 7
- Play audio through auto Bluetooth connection with Fidelio app 9
 - Install "Fidelio app" onto Android-powered device 9
 - Activate Bluetooth with Fidelio app 13
 - Sync time automatically 15
- Install "Songbird app" to enjoy music 15
 - Install Songbird app on Android-powered device 15
 - Install Songbird on your computer 17
 - Sync music from PC to Android-powered device 17
- Use more features with Fidelio app 18
 - Set alarm timer 18
 - Set sleep timer 19
 - Listen to Internet radio 20
- Dock and charge Android-powered phone 21
 - Dock Android-powered phone 21
 - Use dock extension 21

5 Listen to FM radio 22

- Tune to FM radio stations 22
- Store FM radio stations automatically 22
- Store FM radio stations manually 23
- Select a preset radio station 23

6 Other features 23

- Set time 23
- Set alarm timer 23
 - Set alarm 23
 - Select alarm source 24
 - Activate/deactivate alarm timer 24
 - Snooze alarm 24
- Set sleep timer 24
- Play audio from an external device 24
- Adjust display brightness 24

7 Product information 25

- Specifications 25
 - Amplifier 25
 - Tuner 25
 - General information 25

8 Troubleshooting 25

9 Notice 26

- Disposal of your old product 26

1 Important

Safety

- Read these instructions.
- Heed all warnings.
- Follow all instructions.
- Do not block any ventilation openings. Install in accordance with the manufacturer's instructions.
- Do not install near any heat sources such as radiators, heat registers, stoves, or other apparatus (including amplifiers) that produce heat.
- Protect the power cord from being walked on or pinched, particularly at plugs, convenience receptacles, and the point where they exit from the unit.
- Only use attachments/accessories specified by the manufacturer.
- Unplug this unit during lightning storms or when unused for long periods of time.
- Refer all servicing to qualified service personnel. Servicing is required when the unit has been damaged in any way, such as power-supply cord or plug is damaged, liquid has been spilled or objects have fallen into the unit, the unit has been exposed to rain or moisture, does not operate normally, or has been dropped.
- This unit shall not be exposed to dripping or splashing.
- Do not place any sources of danger on the unit (e.g. liquid filled objects, lighted candles).
- Where the plug of the Direct Plug-in Adapter is used as the disconnect device, the disconnect device shall remain readily operable.

Know these safety symbols



This 'bolt of lightning' indicates uninsulated material within your unit may cause an electrical shock. For the safety of everyone in your household, please do not remove product covering.

The 'exclamation point' calls attention to features for which you should read the enclosed literature closely to prevent operating and maintenance problems.

WARNING: To reduce the risk of fire or electric shock, this apparatus should not be exposed to rain or moisture and objects filled with liquids, such as vases, should not be placed on this apparatus.

CAUTION: To prevent electric shock, match wide blade of plug to wide slot, fully insert.

2 Your Docking System for Android™

Congratulations on your purchase, and welcome to Philips! To fully benefit from the support that Philips offers, register your product at www.philips.com/welcome.

Introduction

With this docking system, you can:

- enjoy audio from your Android-powered device;
- charge your phone through micro USB connector;
- listen to FM radio;
- wake up to buzzer alarm, radio, or audio in your device; and
- experience a variety of features brought by Philips Fidelio and Songbird app.

What's in the box

Check and identify the contents of your package:

- Main unit
- Power adapter
- Dock extension
- MP3 link cable x 1
- Quick start guide
- Safety sheet

Overview of the docking system

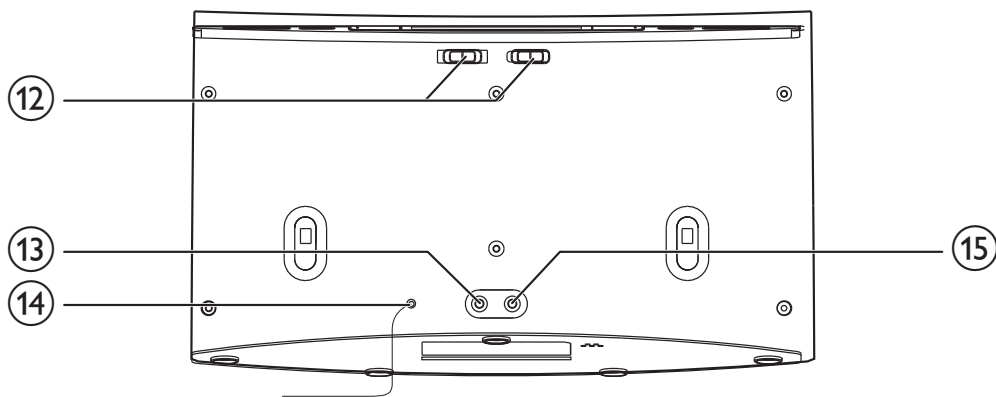
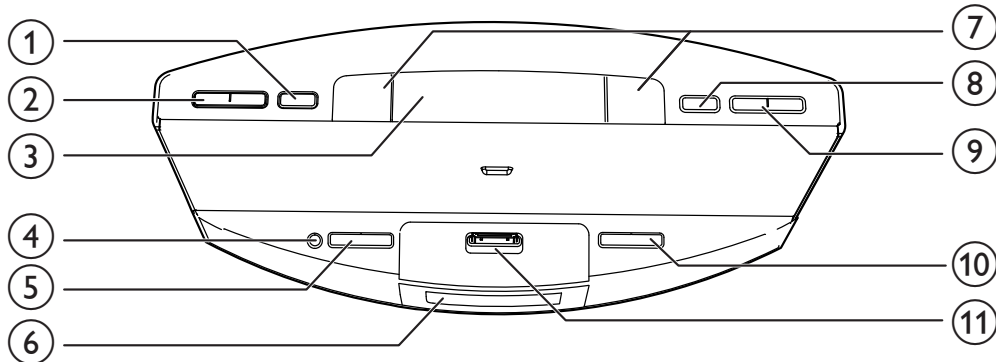

① SET TIME/PROG

- Set clock.
- Store FM radio stations.

② PRESET ▲ / ▼

- Select a preset radio station.
- Adjust hour and hour format.

③ SNOOZE/BRIGHTNESS

- Snooze alarm.
- Adjust display brightness.

④

- Turn the docking system on or off.
- Switch the system to standby mode.

⑤ SOURCE

- Select a source: FM tuner, Bluetooth device, or MP3 link.

⑥ Display panel

- Show current information.

⑦ AL1/AL2

- Set alarm.
- View alarm settings.
- Activate or deactivate alarm timer.

⑧ SLEEP

- Set sleep timer.

⑨ TUNING

- Tune to FM radio stations.
- Adjust minute.

⑩ VOLUME +/-

- Adjust volume.

⑪ Dock for Android phone

- Dock your Android-powered phone.

- ⑫ **AL1/AL2 RADIO BUZZ DOCK**
 - Select alarm source for Alarm 1 or Alarm 2.
- ⑬ **MP3 LINK**
 - Connect an external audio device.
- ⑭ **FM ANTENNA**
 - Improve FM reception.
- ⑮ **DC IN**
 - Power supply socket.

3 Get started

Always follow the instructions in this chapter in sequence.



Caution

- Use of controls or adjustments or performance of procedures other than herein may result in hazardous radiation exposure or other unsafe operation.

Connect power



Caution

- Risk of product damage! Ensure that the power voltage corresponds to the voltage printed on the back or underside of the device.
- Risk of electric shock! When you unplug the power adapter, always pull the plug from the socket. Never pull the cord.



Note

- The type plate is located on the bottom of the docking system.

Connect the power adapter to:

- the **DC IN** socket of the docking system.
- the wall socket.

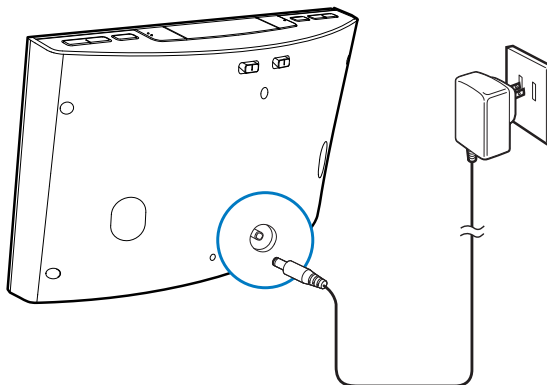

Turn on

Press .

- ↳ The docking system switches to the last selected source.

Switch to standby mode

Press  again to switch the docking system to standby mode.

- ↳ **[OFF]** appears, and then the clock (if set) is displayed.

Select a source

Press **SOURCE** repeatedly to select a source: Bluetooth, FM tuner, or MP3 link.



Note

- When an android-powered device is docked, the system automatically switches to Bluetooth mode.

4 Play and charge

With this docking system, you can enjoy audio in two ways:

- through manual Bluetooth connection;
- through automatic Bluetooth connection with Philips Fidelio app.

Compatible with Android™

To make full use of your docking system, your Android-powered device should satisfy the following requirements:

- With Android operation system (Version 2.1 or above);
- With Bluetooth software (Version 2.1 or above); and
- With a micro USB connector.

For other devices with micro USB connector and Bluetooth, you can still use the docking system to do the the following:

- Charge your device through the USB connector;
- Enjoy audio through Bluetooth.



Tip



- For more details, go to www.philips.com/flexidock.

Play audio through manual Bluetooth connection

The docking system uses Bluetooth wireless technology to stream music from your portable device to the system.

Note

- Before you connect a Bluetooth device to this docking system, familiarize yourself with the Bluetooth capabilities of the device.
- Keep this docking system away from other electronic devices that may cause interference.

- 1 Press  to turn on Bluetooth function of the docking system.
↳ The Bluetooth indicator  blinks on the display panel.
- 2 On your portable device, go to **[Settings]** (Settings)> **[Wireless and networks]** (Wireless and networks)> **[Bluetooth settings]** (Bluetooth settings).
 - Different devices may have different way to activate Bluetooth.
- 3 Tap **[Bluetooth]** (Bluetooth) to activate Bluetooth on your device.

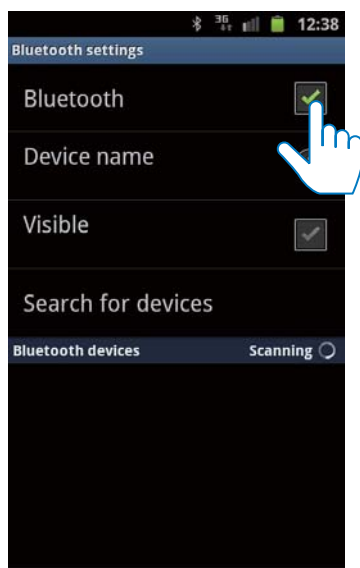

- 4 Tap **[Search for devices]** (Search for devices).

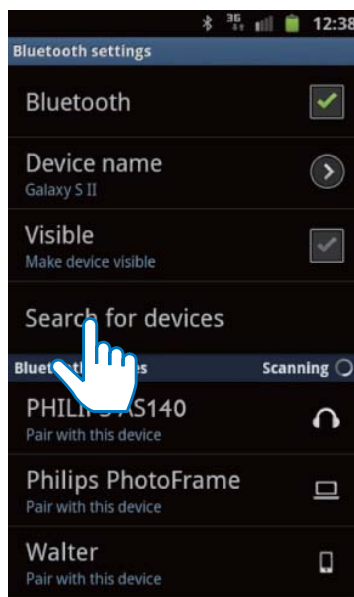

- 5 Tap **[PHILIPS AS140]**.

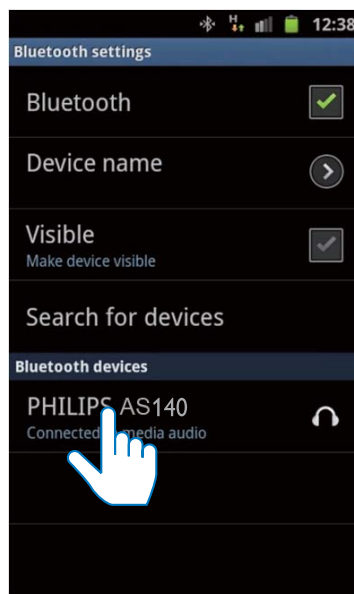

↳ A Bluetooth pairing request appears.

- 6 Tap **[Accept]** (Accept) to start pairing your device with the docking system.

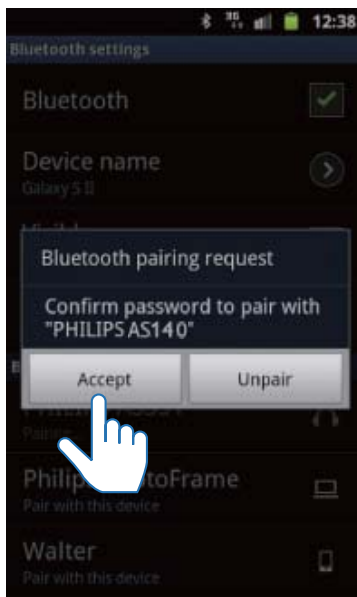

- ↳ After Bluetooth connection, a different Bluetooth icon can be found on the top of the screen.

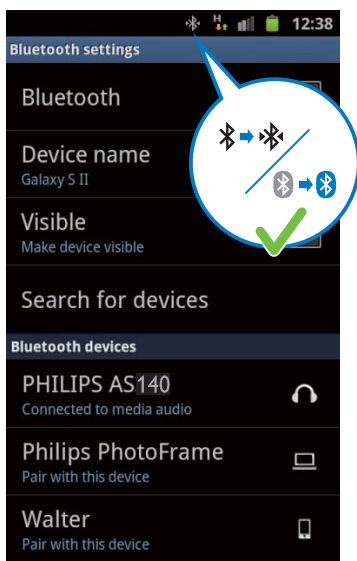

- 7 Play audio with the media player of your portable device.

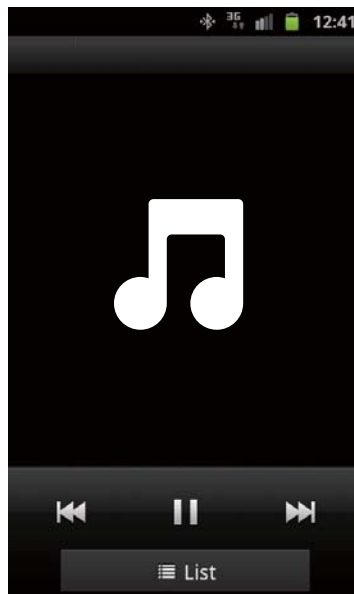

- ↳ The audio comes out through the docking system.

Note

- The effective operation range between the docking system and the paired device is approximately 10 meters (30 feet).
- Any obstacle between the system and the device can reduce the operational range.

Play audio through auto Bluetooth connection with Fidelio app

Philips Fidelio app brings a suite of new features to your docking system, including automatic Bluetooth connection, Songbird music player, Internet radio and a multi-function alarm clock. To enjoy more features, you are recommended to download and install free "Fidelio app".

Install "Fidelio app" onto Android-powered device

You have two ways to install "Fidelio app" on your Android-powered device.

Install "Fidelio app" through QR code

Note

- Make sure that your Android-powered device is connected to the internet.
- Make sure that your device has a barcode scanner such as "QR Droid". If not, download one from the Android market.

- 1 Use the barcode scanner to scan the QR code.

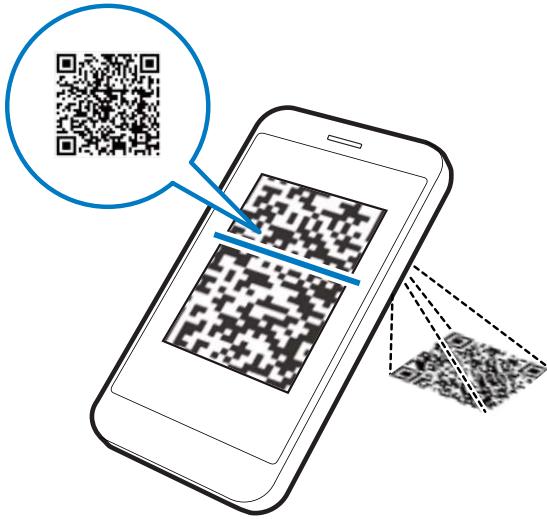

- 2 Tap [Install] (install).

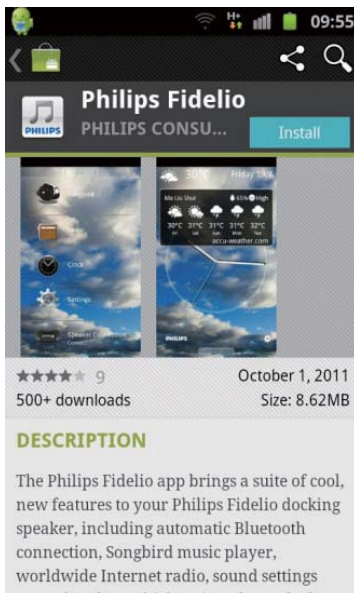

- 3 Tap [Accept & download] (accept and download) to start downloading "Fidelio app".

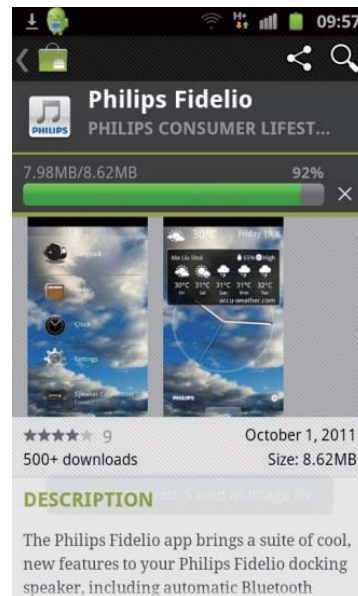
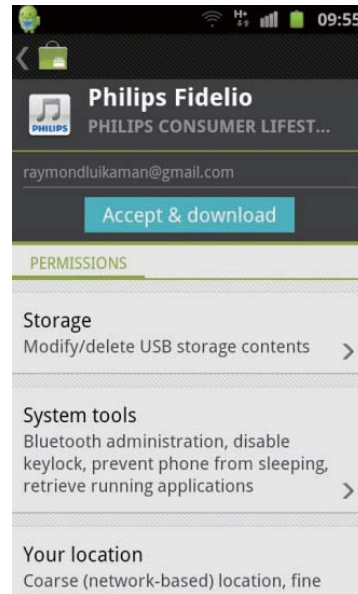

➡ Fidelio app is installed.

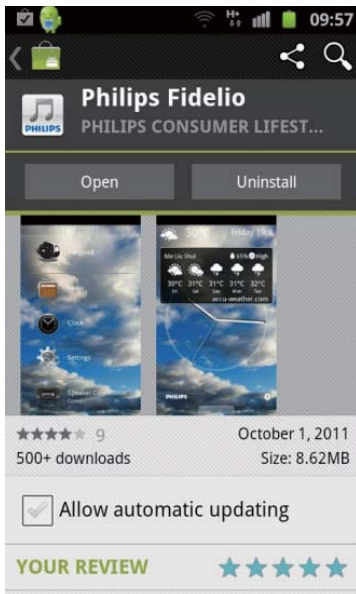

➡ Fidelio icon is displayed on the home screen.

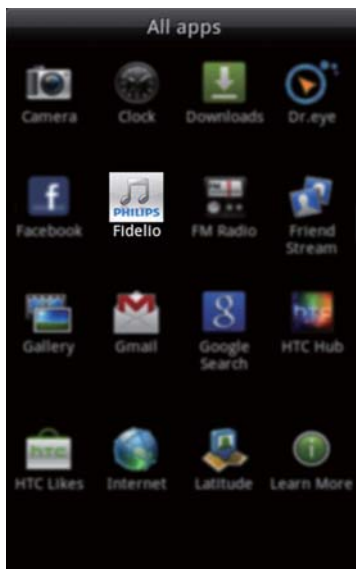

Install "Fidelio app" through Android Market

You can also search "Fidelio app" software in the Android Market directly, and then download and install "Fidelio".

Note

- Make sure that your Android-powered device is connected to the internet.
- Make sure that Android Market is available on your Android-powered device.

1 Tap the "Android Market" icon on your phone screen.



2 Tap the search icon on the screen to access search bar.

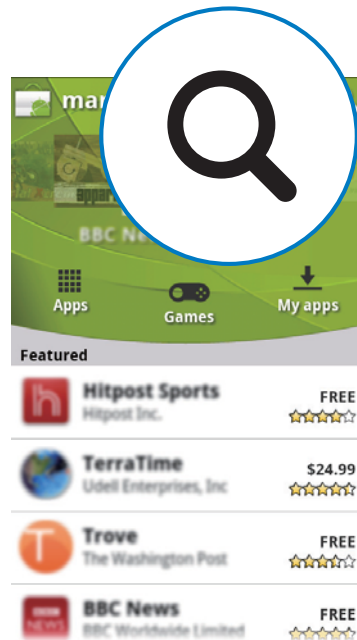

- 3 In the search bar, type in "Philips Fidelio" to search "Fidelio app".



- 4 From the search result list, find and tap "Philips Fidelio" to start downloading Fidelio app.

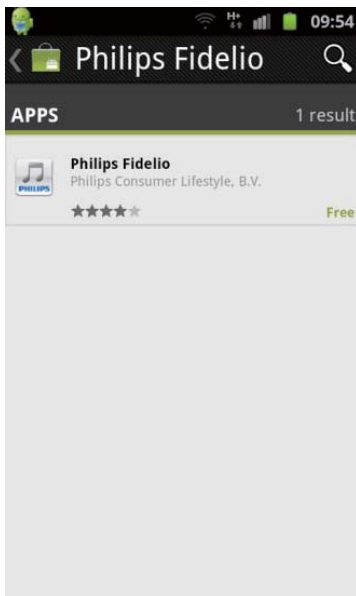

- 5 Tap [Install] (Install).



- 6 Tap [Accept & download] (Accept and download).

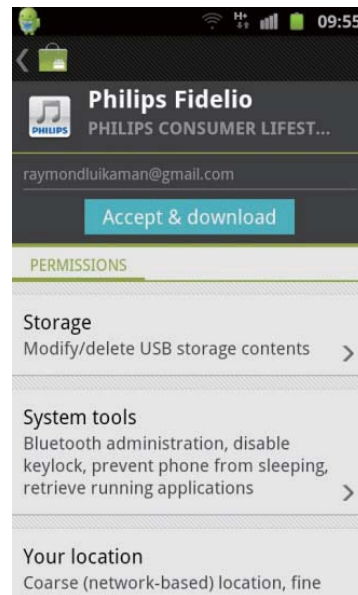

➡ Fidelio is installed.

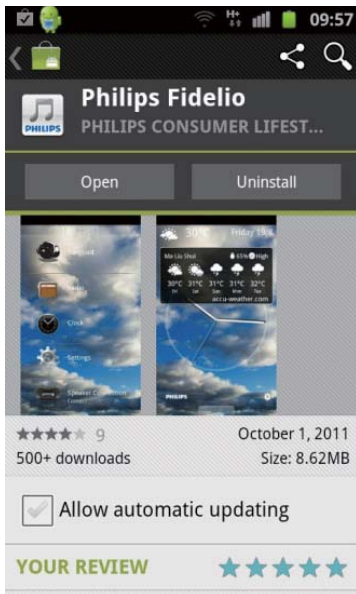

↳ Fidelio icon is displayed on the home screen.

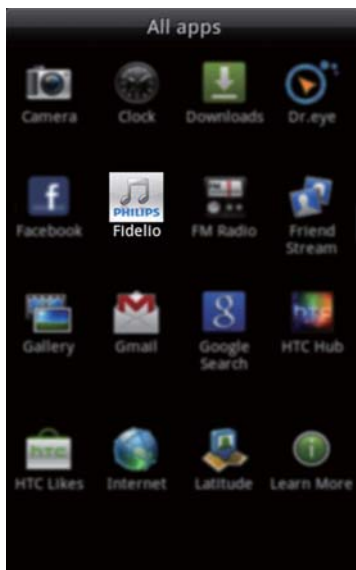

Activate Bluetooth with Fidelio app

Philips Fidelio app helps to connect your Android-powered device and docking system through Bluetooth automatically.

1 Press  repeatedly to select Bluetooth source.

↳  blinks on the display panel.

2 On the home screen of your device, tap the Fidelio icon to launch Fidelio app.



↳ Fidelio menu is displayed.

3 Tap **[Speaker Connection]** (Speaker Connection) to activate automatic Bluetooth connection.

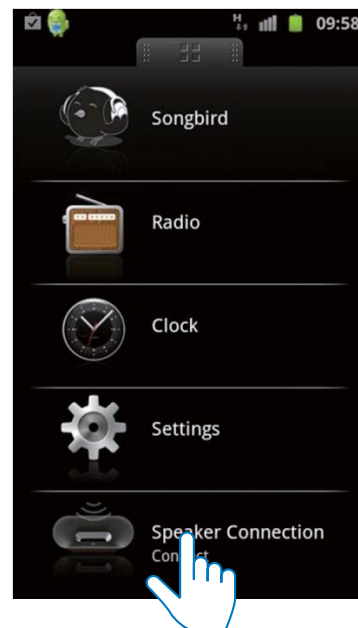

↳ It may take a few seconds to complete the connection.



➔ After Bluetooth connection, a different Bluetooth icon can be found on the top of the screen.

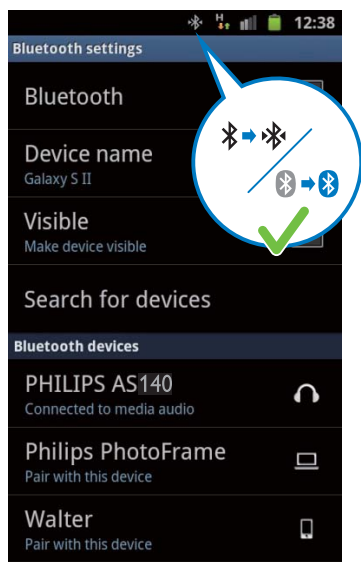



- 4 Play audio with the media player of your portable device.

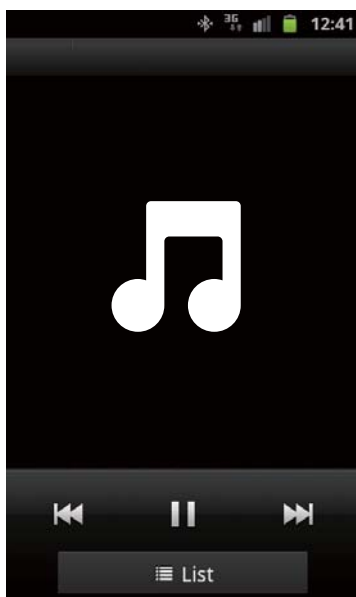

- ➡ The audio comes out through the docking system.

Sync time automatically

After you activate Bluetooth connection through Fidelio app, the docking system synchronizes time with your Bluetooth-enabled device automatically.

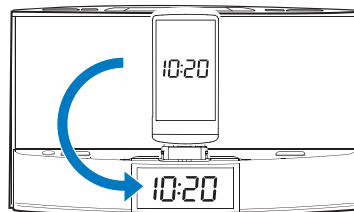

Install "Songbird app" to enjoy music

Philips Songbird is a simple, easy-to-use PC program and Android app. It lets you discover, play and sync your media from PC to your Android-powered devices seamlessly.

Install Songbird app on Android-powered device

- 1 Tap the Fidelio icon on your Android-powered device to launch Fidelio.

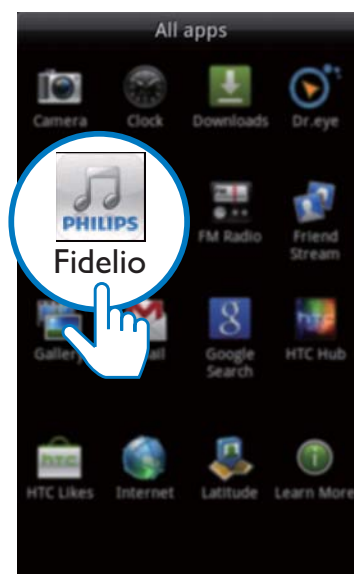

- 2 Tap **[songbird]** on the Fidelio menu.

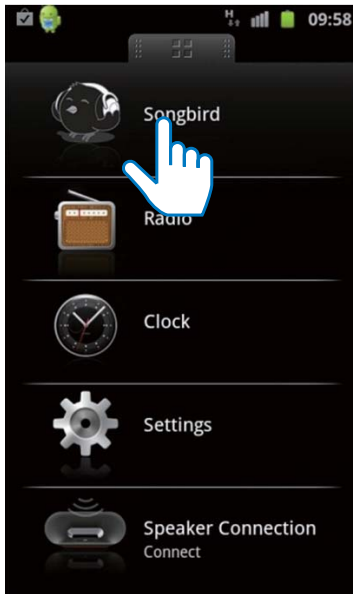

↳ You are requested to download Songbird.

- 3 Tap **[download]** (download).
↳ Songbird is downloaded automatically.

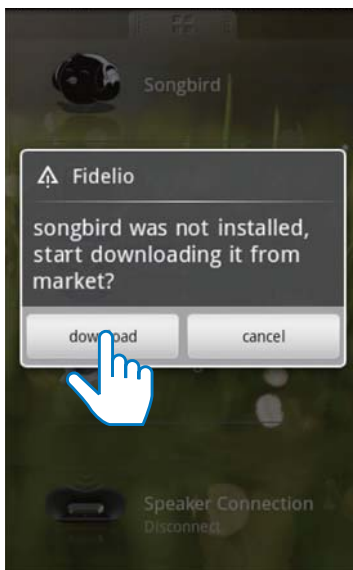

- 4 Tap the downloaded Songbird application.
↳ The system asks whether you want to install songbird.

- 5 Tap **[Install]** (Install).
↳ Songbird is installed on your device.



- 6 Tap **[Open]** (Open) to access Songbird menu.



- 7 Select a track, and then tap ► to play music.

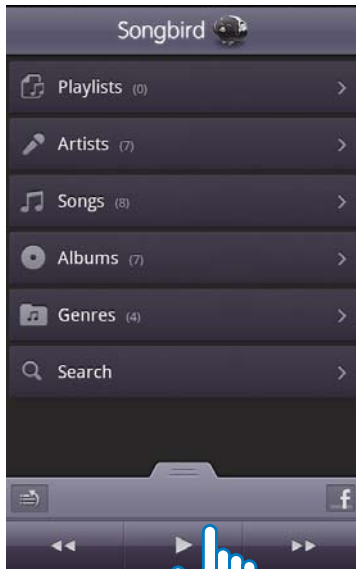

Install Songbird on your computer

- 1 Go to www.philips.com/songbird.
- 2 Download the latest Songbird application.
- 3 Follow on-screen instructions to install Songbird on your computer.

Sync music from PC to Android-powered device

Note

- Make sure that both your computer and Android-powered device are installed with Songbird application.

- 1 Connect your Android-powered device to the computer with a USB cable.
↳ A prompt window appears.
- 2 Select **[Managing device using Philips Songbird]** (Managing device using Philips Songbird).



- ↳ The Songbird user interface is displayed.

- 3 Select **[Auto Sync Music]** (Auto Sync Music) and **[Sync all music and playlists]** (Sync all music and playlists).
- 4 Click **[Sync]** (Sync) on the top right of the interface.
↳ The music on your computer is synchronized into your Android-powered device.



Note

- Next time when your Android-powered device is connected to this computer, music is synchronized from PC to the device automatically.

Use more features with Fidelio app

With Fidelio app, you can also listen to Internet radio, set alarm timer and sleep timer.

Set alarm timer

With Fidelio app, you can set multiple alarms and know the latest weather. It even alerts you when weather conditions are suitable for your favorite outdoors activity.

- 1 Launch Fidelio application.

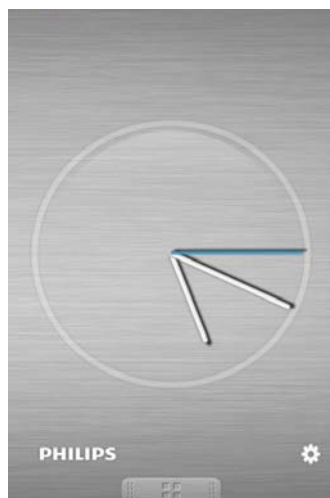

- 2 Tap the icon  to access clock setting Menu.

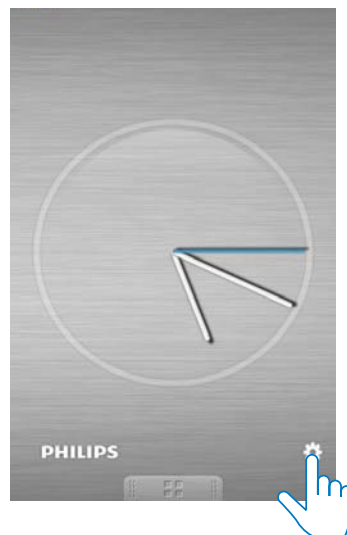

- 3 Tap **[Alarm settings]** (Alarm settings).

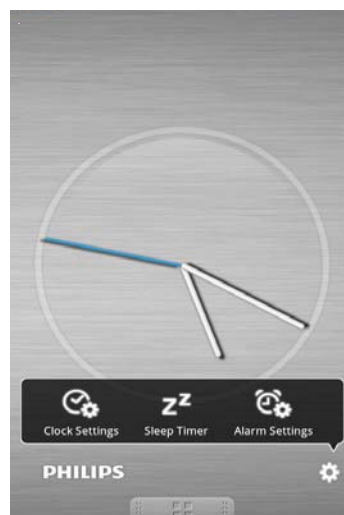

- 4 Tap **+** to access alarm setting menu.



- 5 Set the alarm, and tap **[Save]** (Save) on the top right of the screen.
↳ The new alarm is saved and displayed on the screen.

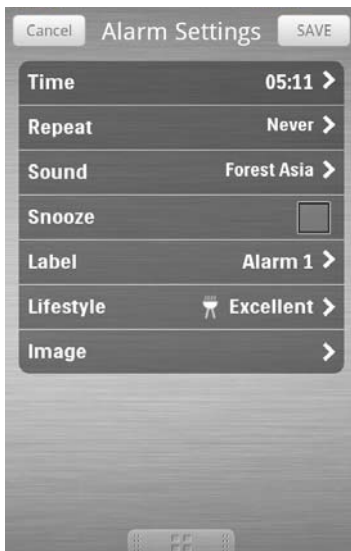

Note

- From the **[Lifestyle]** (Lifestyle) tab, you can select your preferred sport and weather (excellent, good, or fair). The alarm will not ring if the weather is not good enough.

Set sleep timer

- 1 Launch Fidelio app.

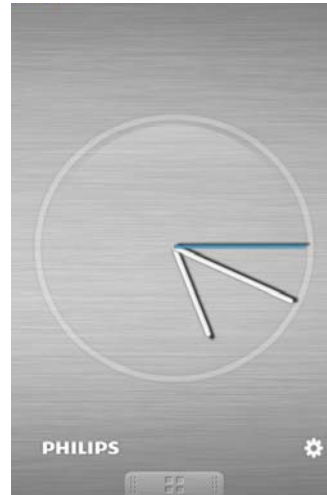

- 2 Tap the icon **⚙** to access clock setting Menu.

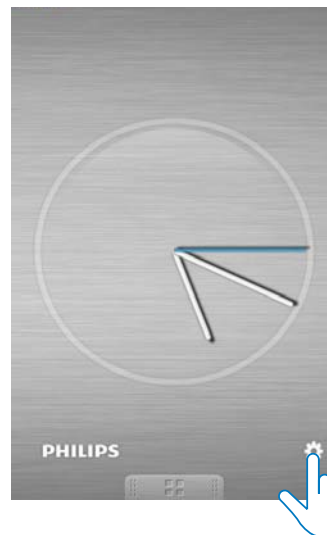

- 3 Tap **[Sleep Timer]** (Sleep timer).

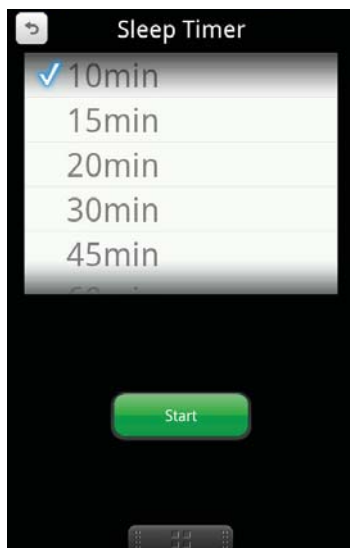

- 4 Select the sleep timer period, and then tap **[Start]** (Start).

Note

- This function only works with Songbird app.

Listen to Internet radio

- 1 Connect your Android-powered device and the docking system through Bluetooth.
- 2 Open Fidelio app to go to the main menu.

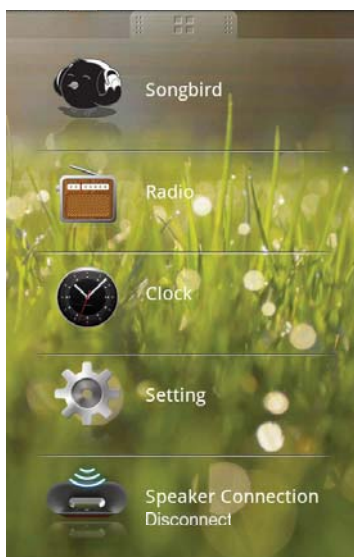

- 3 Tap **[Radio]** (Radio) on the main menu.

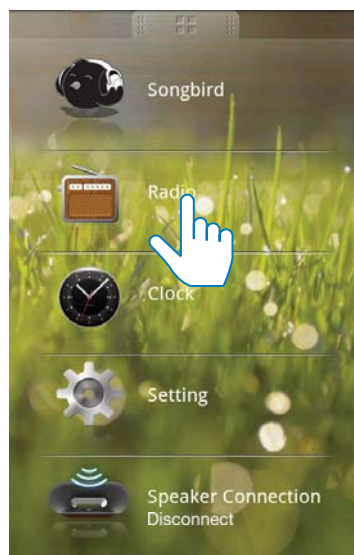

- 4 Search a radio station in the search bar.



- 5 Select a radio station from the search result list.
 ↳ The radio station begins to broadcast.

Dock and charge Android-powered phone

Dock Android-powered phone

To charge your Android-powered phone, you need to dock it in the docking system first.

- 1 Check the orientation of the micro USB connector on your Android-powered phone.

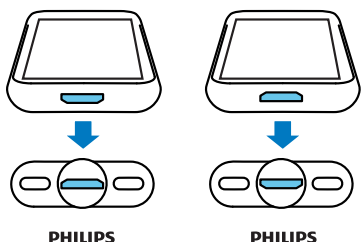

➡ If your USB connector has a cover, flip it outwards.

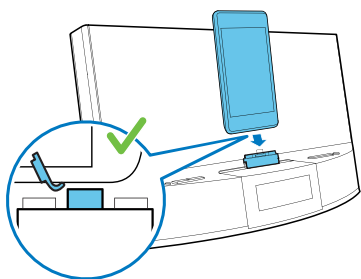

- 2 If necessary, rotate the USB connector on the docking system, and then place your Android-powered phone into the dock.

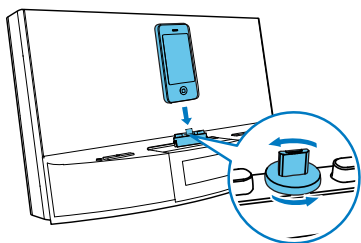

- 3 Adjust the bumpers on both sides of the connector to stabilize the phone.

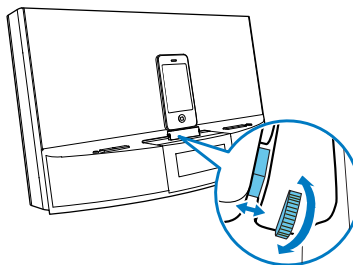

- 4 Slide the connector to place your phone in the middle of the docking system.

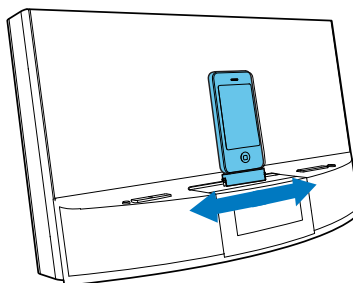

Note

- If the micro USB connector is located at the top, and you are using Android system of version 2.3 or above, screen auto-rotation is available.

Use dock extension

If the USB connector on your phone is close to the edge, the supplied dock extension can balance the docked phone, as illustrated.

- 1 Adjust the slide knobs to make both bumpers at the lowest position.

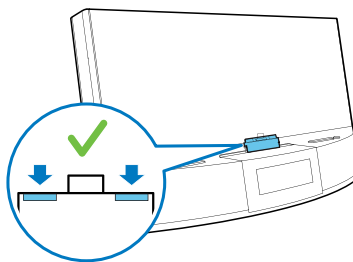

- 2 Place the dock extension onto the dock.

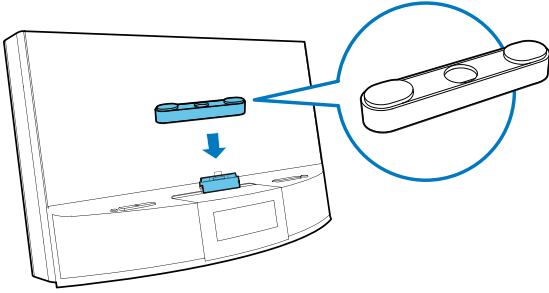

- 3 Dock your phone.

Charge Android-powered phone

When the docking system is connected to power, your docked phone starts charging automatically even in standby mode.

5 Listen to FM radio

Tune to FM radio stations



Tip

- Position the antenna as far as possible from TV, VCR, or other radiation source.
- For better reception, fully extend and adjust the position of the antenna.

- 1 Press **SOURCE** repeatedly to select FM tuner source.
- 2 Press and hold **◀◀ / ▶▶** for two seconds.
↳ The docking system tunes to a station with strong reception automatically.
- 3 Repeat step 2 to tune to more radio stations.

To tune to a station manually:

- 1 Press **◀◀ / ▶▶** repeatedly until you find optimal reception.

Store FM radio stations automatically



Note

- You can store a maximum of 20 FM radio stations.

In tuner mode, press and hold **PROG** for two seconds.

- ↳ The docking system stores all the available FM radio stations and broadcasts the first available station automatically.

Store FM radio stations manually

- 1 Tune to an FM radio station.
- 2 Press **PROG**.
↳ The preset number begins to blink.
- 3 Press **▲** / **▼** repeatedly to select a number.
- 4 Press **PROG** again to confirm.
- 5 Repeat steps 1 to 4 to store other stations.



Note

- To remove a pre-stored station, store another station in its place.

Select a preset radio station

In tuner mode, press **▲** / **▼** repeatedly to select a preset number.

6 Other features

Set time

- 1 Press **⏻** to switch the docking system to standby mode.
- 2 Press and hold **SET TIME** for two seconds.
↳ The hour and minute digits begin to blink.
- 3 Press **▲** / **▼** and **⏮** / **⏭** repeatedly to set the hour and minute.
- 4 Press **SET TIME** to confirm.
↳ **[12H]** or **[24H]** begins to blink.
- 5 Press **▲** / **▼** to select 12/24 hour format.
- 6 Press **SET TIME** to confirm.
↳ The set time is displayed.

Set alarm timer

Set alarm

In standby mode, you can set two alarms to ring at different time.



Note

- Make sure that you have set the clock correctly.

- 1 Press and hold **AL1/AL2** for two seconds to activate alarm setting mode.
↳ The hour and minute digits begin to blink.
- 2 Press **▲** / **▼** and **⏮** / **⏭** repeatedly to set the hour and minute.
- 3 Press **AL1/AL2** to confirm.

Select alarm source



Note

- For alarm sound, you can select buzzer; your last listened radio channel, or the latest played track in your Android-powered device.

Adjust **AL1/AL2 RADIO ·BUZZ ·DOCK** control to select alarm source for both alarms.



Note

- If **DOCK** is selected as alarm source, make sure that you have docked your device into the docking system.

Activate/deactivate alarm timer

- 1 Press **AL1/AL2** to view alarm settings.
- 2 Press **AL1/AL2** again to activate or deactivate the alarm timer.
 - ↳ The alarm icon appears if alarm timer is on and disappears if it is off.
 - To stop the ringing alarm, press the corresponding **AL1/AL2**.
 - ↳ The alarm repeats ringing for the next day.

Snooze alarm

When alarm sounds, press **SNOOZE**.

- ↳ The alarm snoozes and repeats ringing nine minutes later.

Set sleep timer

This docking system can switch to standby mode automatically after a preset period. Press **SLEEP** repeatedly to select the sleep timer period (in minutes).

- ↳ When the sleep timer is activated, **zZ** appears.

To deactivate the sleep timer

Press **SLEEP** repeatedly until **[OFF]** (off) appears.

Play audio from an external device

You can listen to audio from an external device through this device.

- 1 Connect the MP3 link cable to:
 - the **MP3 LINK** socket.
 - the headphone socket of an external device.
- 2 Press **SOURCE** repeatedly to select MP3 link source.
 - ↳  is displayed.
- 3 Play audio in the external device (see the device's user manual).

Adjust display brightness

Press **BRIGHTNESS** repeatedly to select different brightness levels.

7 Product information



Note

- Product information is subject to change without prior notice.

Specifications

Amplifier

| | |
|--------------------|------------|
| Rated Output Power | 2 X 5W RMS |
|--------------------|------------|

Tuner

| | |
|---------------------------|--------------------|
| Tuning Range | FM: 87.5 - 108 MHz |
| Sensitivity | |
| - Mono, 26dB S/N Ratio | FM: <22 dBf |
| Search Selectivity | FM: <28 dBf |
| Total Harmonic Distortion | FM: <2% |
| Signal to Noise Ratio | FM: >55 dB |

General information

| | |
|-----------------------------|---|
| AC Power | Model: AS180-070-AB250; Input: 100-240 V ~, 50/60Hz, 0.7A; Output: 7V == 2.5A |
| Operation Power Consumption | <35 W |
| Standby Power Consumption | <1 W |
| Max. load of Android output | 5V == 1A |
| Dimensions | |
| - Main Unit (W x H x D) | 290 x 160 x 113 mm |
| Weight | |
| - With Packing | 2.0 kg |
| - Main Unit | 1.4 kg |

8 Troubleshooting



Warning

- Never remove the casing of this apparatus.

To keep the warranty valid, never try to repair the system yourself.

If you encounter problems when using this apparatus, check the following points before requesting service. If the problem remains unsolved, go to the Philips web site (www.philips.com/welcome). When you contact Philips, ensure that the apparatus is nearby and the model number and serial number are available.

No power

- Ensure that the AC power plug of the unit is connected properly.
- Ensure that there is power at the AC outlet.

No sound or poor sound

- Adjust the volume of your docking system and Android-powered device.
- Make sure that your Android-powered device is connected to the docking system through Bluetooth.

Poor radio reception

- Increase the distance between the unit and your TV or VCR.
- Fully extend the FM antenna.

Clock/timer setting erased

- Power has been interrupted or the power plug has been disconnected.
- Reset the clock/timer.

Alarm does not work

- Set the clock/alarm correctly.

9 Notice

Any changes or modifications made to this device that are not expressly approved by Philips Consumer Lifestyle may void the user's authority to operate the equipment.

Disposal of your old product

Your product is designed and manufactured with high quality materials and components, which can be recycled and reused.

Never dispose of your product with other household waste. Please inform yourself about the local rules on the separate collection of electrical and electronic products and batteries. The correct disposal of these products helps prevent potentially negative consequences on the environment and human health.

Please visit www.recycle.philips.com for additional information on a recycling center in your area.

Environmental information

All unnecessary packaging has been omitted.

We have tried to make the packaging easy to separate into three materials: cardboard (box), polystyrene foam (buffer) and polyethylene (bags, protective foam sheet.)

Your system consists of materials which can be recycled and reused if disassembled by a specialized company. Please observe the local regulations regarding the disposal of packaging materials, exhausted batteries and old equipment.



Specifications are subject to change without notice
© 2011 Koninklijke Philips Electronics N.V.
All rights reserved.

AS140_93_UM_V1.0

