

Always there to help you
Register your product and get support at
www.philips.com/support



EN Quick start guide

ZH-CN 快速使用指南

PHILIPS



2016 © Gibson Innovations Limited. All rights reserved.
This product has been manufactured by, and is sold under the responsibility of WOOX Innovations (Shanghai) Commercial Company Ltd., and WOOX Innovations (Shanghai) Commercial Company Ltd., is the warrantor in relation to this product.
Philips and the Philips Shield Emblem are registered trademarks of Koninklijke Philips N.V. and are used under license.



AZ127_93_QSG_V6.0

AZ127

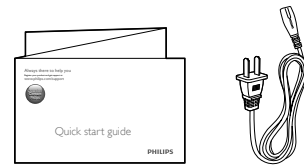
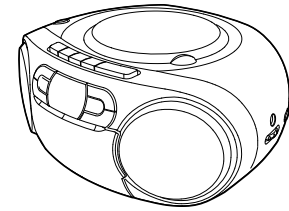

Before using your product, read all accompanying safety information.
在使用您的产品之前, 阅读所有相关的安全信息。

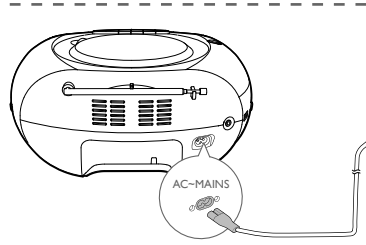
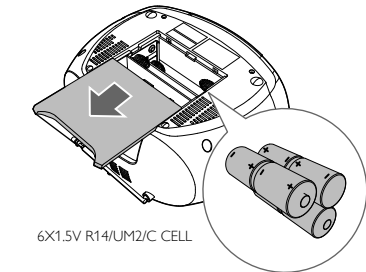

To play with the device, you can use either alkaline battery (R14) or AC power.
要播放的设备, 您可以使用碱性电池 (R14) 或AC电源。

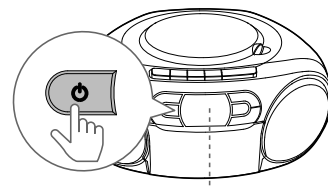

* In CD/FM/AUDIO IN mode, press to power on the device.
* There is no message shown on the display panel in FM or TAPE mode.
* In CD mode, the device switches to standby mode automatically if there is no playback for over 15 minutes.

* 在 CD/FM/AUDIO IN 模式下, 按 可启动设备。
* 在 FM 或 TAPE 模式下, 显示面板未显示任何消息。
* 在 CD 模式下, 如果 15 秒钟内没有播放, 设备将自动切换至待机模式。

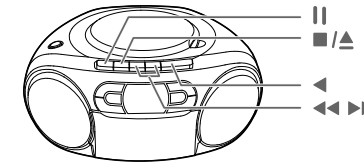
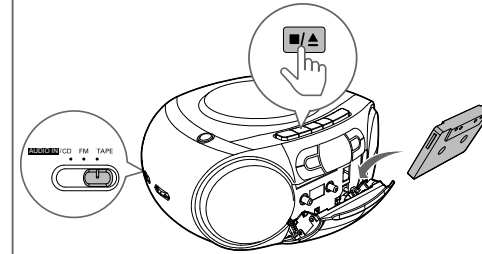

	Pause	暂停
	Press to open the tape door	按下打开磁带门
	Start to play	开始播放
	Search within play	播放中搜索

Make sure that all the buttons are ejected when you close the tape door with a tape inside.
确保关闭磁带仓 (内有磁带) 时所有按钮均弹起。
In playback mode, cassette will be stopped automatically when playback reaches the end.
播放模式中, 磁带播放到底时即会自动停止。

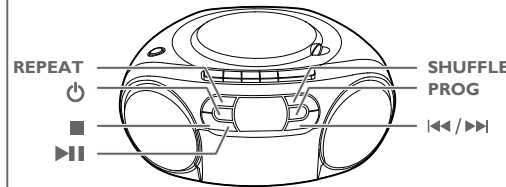
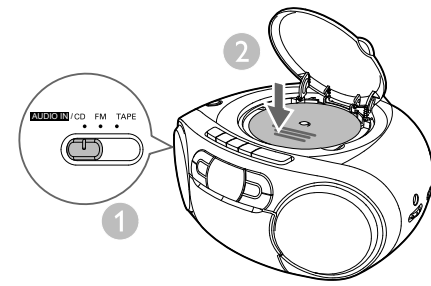
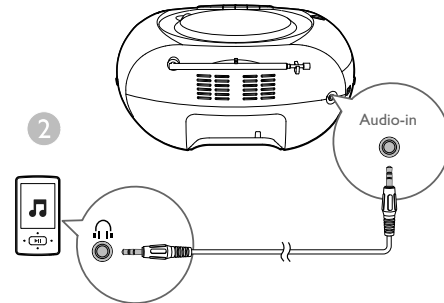
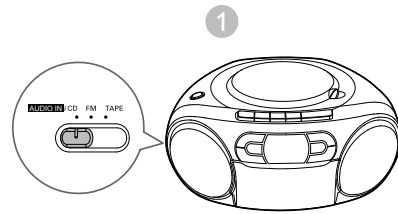

REPEAT	Play a track or all tracks repeatedly
	Turn on/off the unit
	Stop play or erase a program
	Pause or start play
SHUFFLE	Play tracks randomly
PROG	Program the play sequence of tracks
	Skip to the previous/next track or search within play

Program tracks

- 1 In CD mode, press to stop playback.
- 2 Press **PROG** to activate programming.
- 3 Press repeatedly to select a track, then press **PROG** to confirm.
- 4 Repeat steps 3 to program more tracks.
- 5 Press to play the programmed tracks.
- 6 To cancel the program, press twice.

REPEAT	反复播放当前或所有曲目
	开机/关机。
	停止播放或清除存台
	暂停或开始播放
SHUFFLE	随机播放曲目
PROG	对曲目进行设定
	跳至上一、下一曲目或在播放中搜索

编辑曲目

- 1 在CD模式, 按 停止播放。
- 2 按 **PROG** 开始编辑。
- 3 反复按 选择一个曲目, 然后按 **PROG** 确认。
- 4 重复第三个步骤编辑更多曲目。
- 5 按 播放已编辑的曲目。
- 6 按两次 取消编辑。

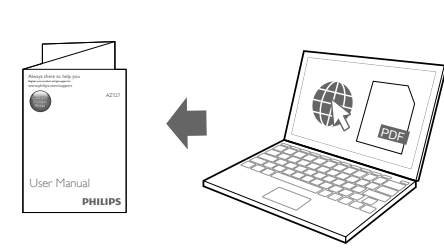
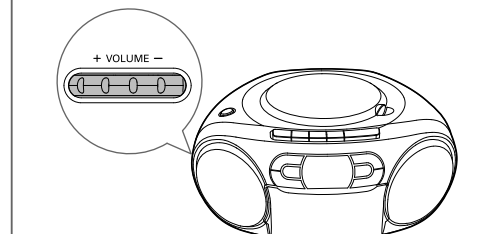
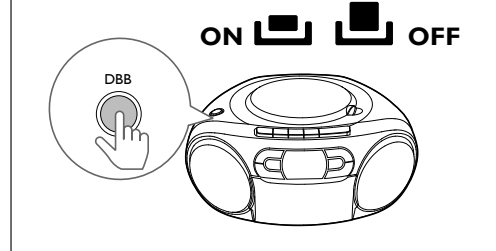
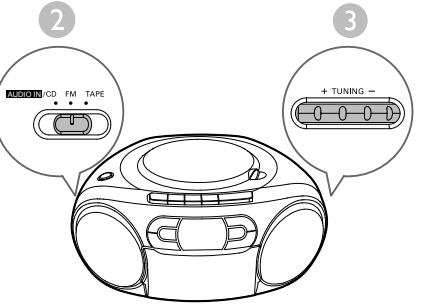
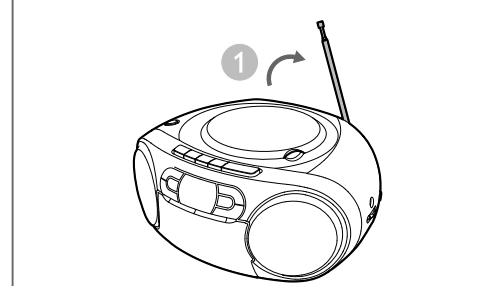

To get the detailed instructions for use, visit
www.philips.com/support.
要获得详细的使用说明, 请访问
www.philips.com/support

English

Safety

- Read these instructions.
- Follow all instructions.
- Do not block any ventilation openings. Install in accordance with the manufacturer's instructions.
- Do not install near any heat sources such as radiators, heat registers, stoves, or other apparatus (including amplifiers) that produce heat.
- Protect the power cord from being walked on or pinched, particularly at plugs, convenience receptacles, and the point where they exit from the unit.
- Only use attachments/accessories specified by the manufacturer.
- Unplug this unit during lightning storms or when unused for long periods of time.
- Recording is permissible insofar as copyright or other rights of third parties are not infringed upon.
- Refer all servicing to qualified service personnel. Servicing is required when the unit has been damaged in any way, such as power-supply cord or plug is damaged, liquid has been spilled or objects have fallen into the apparatus, the unit has been exposed to rain or moisture, does not operate normally, or has been dropped.
- Battery usage CAUTION – To prevent battery leakage which may result in bodily injury, property damage, or damage to the unit:
 - Install all batteries correctly, + and - as marked on the unit.
 - Do not mix batteries (old and new or carbon and alkaline, etc.).
 - Remove batteries when the unit is not used for a long time.
- Batteries (battery pack or batteries installed) shall not be exposed to excessive heat such as sunshine, fire or the like.
- CAUTION: Danger of explosion if battery is incorrectly replaced. Replace only with the same or equivalent type.
- The unit shall not be exposed to dripping or splashing.
- Do not place any sources of danger on the unit (e.g. liquid filled objects, lighted candles).
- Where the MAINS plug or an appliance coupler is used as the disconnect device, the disconnect device shall remain readily operable.

Warning

- Never remove the casing of this apparatus.
- Never place this apparatus on other electrical equipment.
- Never look into the laser beam inside this apparatus.

Caution

- Use of controls or adjustments or performance of procedures other than herein may result in hazardous radiation exposure or other unsafe operation.

Notice

Any changes or modifications made to this device that are not expressly approved by Gibson Innovations may void the user's authority to operate the equipment.

Disposal of your old product



Your product is designed and manufactured with high quality materials and components, which can be recycled and reused. Do not throw away the product with the normal household waste at the end of its life, but hand it in at an official collection point or recycling. By doing this, you help to preserve the environment.

Environmental information

All unnecessary packaging has been omitted. We have tried to make the packaging easy to separate into three materials: cardboard (box), paper pulp (buffer) and polyethylene (bags, protective foam sheet.) Your system consists of materials which can be recycled and reused if disassembled by a specialized company. Please observe the local regulations regarding the disposal of packaging materials, exhausted batteries and old equipment

This apparatus includes these labels:



Class II equipment symbol



This symbol indicates that the apparatus has a double insulation system.



The making of unauthorized copies of copy-protected material, including computer programs, files, broadcasts and sound recordings, may be an infringement of copyrights and constitute a criminal offence. This equipment should not be used for such purposes.

Note

- The type plate is located on the bottom of the apparatus.

简体中文

注意事项

- 阅读这些说明。
- 遵循所有说明。
- 不要堵塞任何通风口。 按照制造商的说明进行安装。
- 不要在任何热源附近安装，如散热器、 散热器、 炉具或其它发热设备（包括功放器）。
- 防止电源线被踩踏或挤夹， 特别是在插头、 电源插座和装置电源线出口位置。
- 仅使用制造商指定的附件/配件。
- 在雷电天气期间或长期不用的情况下， 请拔下本装置的电源插头。
- 录音只许在不违反第三方版权或其他权利 的范围内进行。
- 所有维修均应由合格的维修人员来执行。 本装置有任何损坏时， 如电源线或插头损坏， 液体泼溅到或物体跌落到装置上， 装置淋雨或受潮， 无法正常运行， 或者跌落， 均需要进行维修。
- 电池使用注意事项 – 为防止电池泄漏而造成人身伤害、 财产损失或装置损坏， 请：
 - 按照装置上标明的 + 极和 - 极， 正确安装所有电池。
 - 请勿混合使用电池（旧电池与新电池或碳电池与碱性电池， 等等）。
 - 若打算长期不用本装置， 应取出电池。
- 不可将电池（电池组或安装的电池）置于高温环境， 如阳光直射处、 明火或类似环境。
- 注意： 电池安装不正确会有爆炸危险。 只能用相同或相当的型号更换。
- 切勿将装置暴露在漏水或溅水环境下。
- 不要将任何危险源放在本装置上（例如装有液体的物体、 点燃的蜡烛）。
- 将电源插头或产品耦合器用作断开设备时， 该断开设备应可以随时使用。

警告

- 切勿拆下本产品的外壳。
- 切勿将本装置放在其它电器设备上。
- 切勿直视本装置内部的激光束。

注意

- 不按此处说明的操作流程来使用控件或进行调整可能导致危险的激光辐射或其它不安全 的操作。

公告

如果用户未经 Gibson Innovations 的明确许可而擅自对此设备进行更改或修改， 则可能导致其无权操作此设备。
弃置旧产品



本产品采用可回收利用的高性能材料和组件制造而成。
弃置产品时， 请不要将其与一般生活垃圾一同丢弃， 应将其交给政府指定的回收中心或回收。 这样做有利于环保。
环境信息
为使包装尽量简化， 已省去所有不必要的包装材料。 包装材料分为三类： 纸板（盒）、 纸浆（缓冲物）和聚乙烯（袋、 保护膜）。 本系统的所有材料均可回收和再利用（如果由专业公司拆卸）。 请遵守当地有关包装材料、 废电池和旧设备的处理的规定。

本装置具有以下标签:



II 类设备符号



此符号表示本装置具有双层绝缘系统。



进行受版权保护材料（包括计算机程序、 文件、 广播和录音）的未授权复制可能会侵犯版权并构成犯罪。 不得将此设备用于这些目的。

注

- 铭牌（铭牌上的信息包括工作电压， 消耗功率）位于主机底部， 使用前请先了解铭牌上的相关信息。

规格

最大输出功率	总计 2 x1瓦 RMS
频率响应	63 -16000 赫兹, -3 分贝
信噪比	>50 dBA
总谐波失真	<1 %
音频输入	650 毫伏 RMS
调谐范围	87.5 - 108 兆赫
电源	
- 交流电源	220 -240 伏~, 50/60 赫兹;
- 电池	直流9V, 6 节 1.5 伏（类型: R14/UM2/C） 电池
操作功耗	10 瓦
待机功耗	< 0.5 瓦
尺寸	
- 主装置（宽 x 高 x 深）	300 x 134 x 240 毫米
重量（主装置）	1.5 千克

产品中有害物质的名称及含量
Names and Contents of Hazardous Substances

部件名称 Name of the Parts	有害物质 Hazardous Substances					
	铅 (Pb, Lead)	汞 (Hg, Mercury)	镉 (Cd, cadmium)	六价铬(Chromium (VI))	多溴联苯 (PBB)	多溴二苯醚 (PBDE)
Housing 外壳	○	○	○	○	○	○
Loudspeakers 喇叭单元	○	○	○	○	○	○
PWBs 电路板组件	×	○	○	○	○	○
Accessories (Cables) 附件 (电源线, 连接线)	×	○	○	○	○	○

本表格依据SJ/T 11364的规定编制。
The table is compiled according to SJ/T 11364.

- : 表示该有害物质在该部件所有均质材料中的含量均在 GB/T 26572 标准规定的限量要求以下。
○: Indicates that this hazardous substance contained in all of the homogeneous materials for this part is below the limit requirement in GB/T 26572.
- ×: 表示该有害物质至少在该部件的某一均质材料中的含量超出 GB/T 26572 标准规定的限量要求。
X: Indicates that this hazardous substance contained in at least one of the homogeneous materials used for this part is above the limit requirement in GB/T 26572.

环保使用期限 Environmental Protection Use Period

这标志表示的期间（10年）是电子电气产品中有有害物质在正常使用的条件下不会发生外泄或突变， 电子电气产品用户使用该电子电气产品不会对环境造成严重污染或对其人身、 财产造成严重损害的期限。

This logo refers to the period (10 years) during which the hazardous substances in electronic and electrical products will not leak or mutate so that the use of these [substances] will not result in any severe environmental pollution, any bodily injury or damage to any assets.