

# Mini Hi-Fi System

FWM377

User manual



# PHILIPS

## Important notes for users in the U.K.

### Mains plug

This apparatus is fitted with an approved 13 Amp plug. To change a fuse in this type of plug proceed as follows:

- 1** Remove fuse cover and fuse.
- 2** Fix new fuse which should be a BS1362 5 Amp, A.S.T.A. or BSI approved type.
- 3** Refit the fuse cover:

If the fitted plug is not suitable for your socket outlets, it should be cut off and an appropriate plug fitted in its place.

If the mains plug contains a fuse, this should have a value of 5 Amp. If a plug without a fuse is used, the fuse at the distribution board should not be greater than 5 Amp.

**Note:** *The severed plug must be disposed of to avoid a possible shock hazard should it be inserted into a 13 Amp socket elsewhere.*

### How to connect a plug

The wires in the mains lead are coloured with the following code: blue = neutral (N), brown = live (L).

- As these colours may not correspond with the colour markings identifying the terminals in your plug, proceed as follows:
  - Connect the blue wire to the terminal marked N or coloured black.
  - Connect the brown wire to the terminal marked L or coloured red.
  - Do not connect either wire to the earth terminal in the plug, marked E (or  $\perp$ ) or coloured green (or green and yellow).

Before replacing the plug cover, make certain that the cord grip is clamped over the sheath of the lead - not simply over the two wires.

### Copyright in the U.K.

Recording and playback of material may require consent. See Copyright Act 1956 and The Performer's Protection Acts 1958 to 1972.

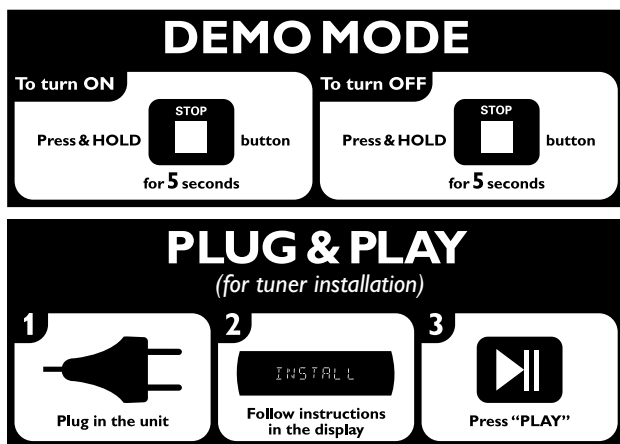



## General Information

Supplied accessories .....	5
Environmental information .....	5
Safety information .....	5
Hearing Safety .....	6

## Preparations

Rear connections .....	7~8
Power	
Antennas connection	
Speakers connection	
Optional connection .....	8
Connecting other equipment to your system	
Inserting batteries into the remote control .....	9

## Controls

Controls on the system and remote control .....	10~11
---	-------

## Basic Functions

Plug and Play .....	12
Demonstration mode .....	13
Switching the system to standby mode .....	13
Power-saving automatic standby .....	13
Dim mode .....	13
Volume control .....	13
Sound control .....	14
MAX Sound	
DSC (Digital Sound Control)	
DBB (Dynamic Bass Boost)	
Incredible Surround	
Karaoke .....	14

## CD/MP3/WMA-CD Operations

Discs for playback .....	15
About MP3/WMA disc .....	15
Loading discs .....	15
Playing discs .....	16
Replacing discs during playback .....	16
Selecting a desired track/passage .....	16
Selecting a desired Album/Title (MP3/WMA disc only) .....	16
Different play modes: SHUFFLE and REPEAT ... ..	17
Programming the disc tracks .....	17
Erasing the programme .....	17

## Radio Reception

Tuning to radio stations .....	18
Storing preset radio stations .....	18~19
Automatic preset programming	
Manual preset programming	
Tuning to preset radio stations .....	19
RDS .....	19~20
Setting the RDS clock	
NEWS .....	20

## Tape Operation/Recording

Tape playback .....	21
General information on recording .....	22
Preparation for recording .....	22
One touch recording .....	22
CD/USB Synchronised start recording .....	22
Maintenance .....	23

## External Sources

Using a non-USB device .....	24
Using a USB mass storage device .....	24~25
Ripping function .....	26
Tuner record timer setting .....	27

## Clock/Timer

Clock setting .....	28
Timer setting .....	28~29
To deactivate the TIMER	
To activate the TIMER	
Sleep timer setting .....	29

## Specifications

## Troubleshooting

## Supplied accessories

- 2 speaker boxes
- Remote control with two AA batteries
- MW loop antenna
- FM wire antenna

## Acknowledgement

### Energy Star

As an ENERGY STAR®

Partner, Philips has

determined that this

product meets the ENERGY

STAR® guidelines for energy efficiency.



## Environmental information

All unnecessary packaging has been omitted. We have tried to make the packaging easy to separate into three materials: cardboard (box), polystyrene foam (buffer) and polyethylene (bags, protective foam sheet).

Your system consists of materials which can be recycled and reused if disassembled by a specialised company. Please observe the local regulations regarding the disposal of packaging materials, exhausted batteries and old equipment.

## Safety information

- Before operating the system, check that the operating voltage indicated on the typeplate (or the voltage indication beside the voltage selector) of your system is identical with the voltage of your local power supply. If not, please consult your dealer.
- Place the system on a flat, hard and stable surface.
- Place the system in a location with adequate ventilation to prevent internal heat build-up in your system. Allow at least 10 cm (4 inches) clearance from the rear and the top of the unit and 5 cm (2 inches) from each side.
- The ventilation should not be impeded by covering the ventilation openings with items, such as newspapers, table-cloths, curtains, etc.

- Do not expose the system, batteries or discs to excessive moisture, rain, sand or heat sources caused by heating equipment or direct sunlight.
- No naked flame sources, such as lighted candles, should be placed on the apparatus.
- No objects filled with liquids, such as vases, shall be placed on the apparatus.
- Don't expose the system to dripping or splashing.
- Install this unit near the AC outlet and where the AC power plug can be reached easily.
- The lens may cloud over when the system is suddenly moved from cold to warm surroundings, making it impossible to play a disc. Leave the system in the warm environment until the moisture evaporates.
- The mechanical parts of the set contain self-lubricating bearings and must not be oiled or lubricated.
- **When the system is switched to Standby mode, it is still consuming some power. To disconnect the system from the power supply completely, remove the AC power plug from the wall socket.**

### Disposal of your old product

Your product is designed and manufactured with high quality materials and components, which can be recycled and reused.

When this crossed-out wheeled bin symbol is attached to a product it means the product is covered by the European Directive 2002/96/EC

Please inform yourself about the local separate collection system for electrical and electronic products.

Please act according to your local rules and do not dispose of your old products with your normal household waste. The correct disposal of your old product will help prevent potential negative consequences for the environment and human health.



## Hearing Safety

### Listen at a moderate volume.

- Using headphones at a high volume can impair your hearing. This product can produce sounds in decibel ranges that may cause hearing loss for a normal person, even for exposure less than a minute. The higher decibel ranges are offered for those that may have already experienced some hearing loss.
- Sound can be deceiving. Over time your hearing "comfort level" adapts to higher volumes of sound. So after prolonged listening, what sounds "normal" can actually be loud and harmful to your hearing. To guard against this, set your volume to a safe level before your hearing adapts and leave it there.

### To establish a safe volume level:

- Set your volume control at a low setting.
- Slowly increase the sound until you can hear it comfortably and clearly, without distortion.

### Listen for reasonable periods of time:

- Prolonged exposure to sound, even at normally "safe" levels, can also cause hearing loss.
- Be sure to use your equipment reasonably and take appropriate breaks.

### Be sure to observe the following guidelines when using your headphones.

- Listen at reasonable volumes for reasonable periods of time.
- Be careful not to adjust the volume as your hearing adapts.
- Do not turn up the volume so high that you can't hear what's around you.
- You should use caution or temporarily discontinue use in potentially hazardous situations.

- Do not use headphones while operating a motorized vehicle, cycling, skateboarding, etc.; it may create a traffic hazard and is illegal in many areas.

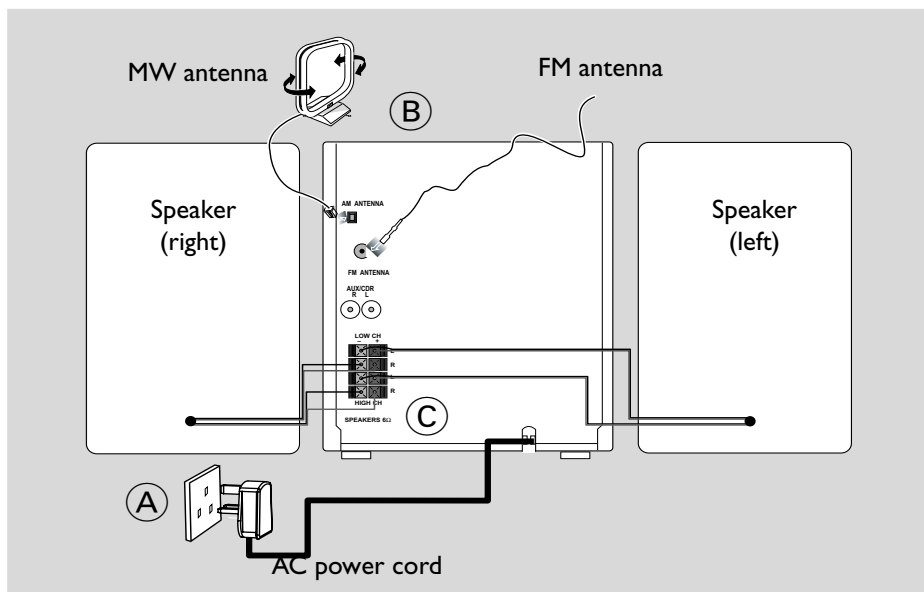

## Rear connections

The type plate is located at the rear of the system.

### A Power

Before connecting the AC power cord to the wall outlet, ensure that all other connections have been made.

If your system is equipped with a Voltage Selector, set the VOLTAGE SELECTOR to the local power line voltage.

#### WARNING!

- For optimal performance, use only the original power cable.
- Never make or change any connections with the power switched on.
- High voltage! Do not open. You run the risk of getting an electric shock.
- The machine does not contain any user-serviceable parts.
- Modification of the product could result in hazardous radiation of EMC or other unsafe operation.

To avoid overheating of the system, a safety circuit has been built in. Therefore, your system may switch to Standby mode

automatically under extreme conditions. If this happens, let the system cool down before reusing it (not available for all versions).

### B Antennas Connection

Connect the supplied MW loop antenna and FM antenna to the respective terminals. Adjust the position of the antenna for optimal reception.

#### MW Antenna

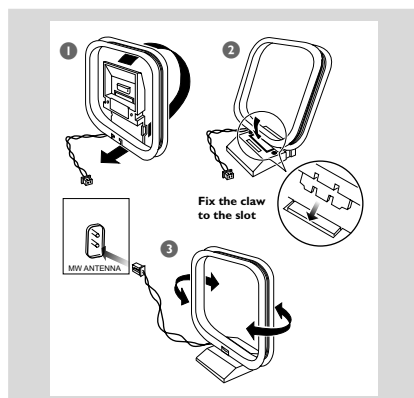

- Position the antenna as far as possible from a TV, VCR or other radiation source.

# Preparations

## FM Antenna

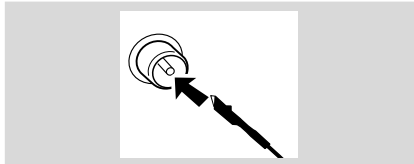

- For better FM stereo reception, connect an outdoor FM antenna to the FM ANTENNA terminal.

## Speakers Connection

### Front Speakers

Connect the speaker wires to the SPEAKERS terminals, right speaker to "R" and left speaker to "L", red wires to "+" and black wires to "-" of the woofer connection terminals, blue wires to "+" and black wires to "-" of the tweeter connection terminals.

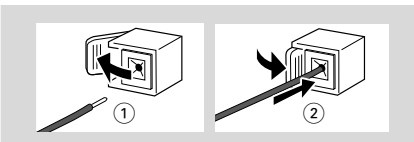

- Fully insert the stripped portion of the speaker wire into the terminal as shown.

### Notes:

- For optimal sound performance, use the supplied speakers.
- Do not connect more than one speaker to any one pair of + / - speaker terminals.
- Do not connect speakers with an impedance lower than the speakers supplied. Please refer to the SPECIFICATIONS section of this manual.

## Optional connection

The optional equipment and connecting cords are not supplied. Refer to the operating instructions of the connected equipment for details.

### Connecting a USB device or memory card

By connecting a USB mass storage device (including USB flash memory, USB flash players or memory cards) to the Hi-Fi system, you can enjoy the device's stored music through the powerful speakers of Hi-Fi system.

- Insert the USB device's USB plug into the  socket on the set.

OR

#### for the devices with USB cables:

- 1 Insert one plug of the USB cable (not supplied) to the  socket on the set.
- 2 Insert the other plug of the USB cable to the USB output terminal of the USB device.

OR

#### for the memory card:

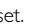
- 1 Insert the memory card into a card reader (not supplied).
- 2 Use a USB cable (not supplied) to connect the card reader into the  socket on the set.

### Connecting a non-USB device

Use a cinch cable to connect **AUX** to the analogue audio out terminals of an external equipment (TV,VCR, Laser Disc player; DVD player or CD Recorder).

### Note:

- If you are connecting equipment with a mono output (a single audio out terminal), connect it to the AUX left terminal. Alternatively, you can use a "single to double" cinch cable (the output sound still remain mono).



## Inserting batteries into the remote control

Insert two batteries (Type R06 or AA) into the remote control with the correct polarity as indicated by the "+" and "-" symbols inside the battery compartment.

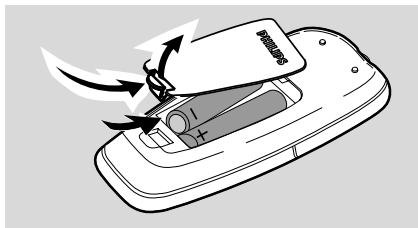

### CAUTION!

- Remove batteries if they are exhausted or will not be used for a long time.
- Do not use old and new or different types of batteries in combination.
- Batteries contain chemical substances, so they should be disposed of properly.

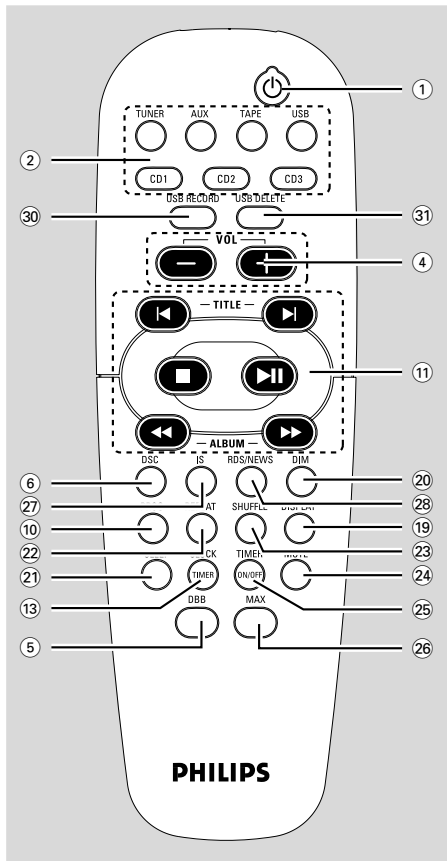

## Controls on the system and remote control

### ① **STANDBY-ON/ ECO POWER (⏻)**

- switches the system on or to Eco Power standby/normal standby with clock display.

### ② **Source selection** – to select the following:

#### **DISC (CD 1/2/3 on the remote control)**

- to select disc tray 1, 2 or 3.

#### **TUNER**

- to select waveband: FM or MW.

#### **TAPE (on the remote control only)**

- to select tape deck.

#### **AUX (on the remote control only)**

- to select the input for an additional appliance: AUX.

#### **AUX•TAPE (on the system only)**

- to switch between AUX and tape sources.

#### **USB**

- to select USB source.

### ③ **iR SENSOR**

- infrared sensor for remote control.

### ④ **MASTER VOLUME (VOL +/-)**

- to increase or decrease the volume.

### ⑤ **DBB**

- to select the desired bass boost level. (DBB 1, DBB 2, DBB 3 or DBB OFF).

### ⑥ **DSC**

- Selects different types of preset sound equaliser settings (OPTIMAL, TECHNIO, ROCK or JAZZ).

### ⑦ **DISC 1/2/3**

- to select a disc tray for playback.

### ⑧ **Display screen**

- to view the current status of the system.

### ⑨ **OPEN•CLOSE**

- to open or close the disc tray.

### ⑩ **PROG**

for CD/ MP3-CD/WMA

to programme disc tracks.

for Tuner ..... to programme preset radio stations.

### ⑪ **Mode Selection**

**ALBUM (-/+) ◀▶▶**

**SEARCH•TUNING**

for MP3-CD/USB/WMA

to select previous/next album.

for CD/MP3-CD/USB/WMA

(press and hold) to search backward/forward.

for Tuner ..... to tune to a lower or higher radio frequency.

for Clock ..... to set the hour.

## STOP ■

for CD/ MP3-CD/WMA

to stop playback or to clear a programme.

for Tuner ..... *(on the system only)* to stop programming.

for Demo ..... *(on the system only)* to activate/deactivate the demonstration.

for Clock ..... to exit clock setting.

for Plug&Play ..... *(on the system only)* to exit plug&play mode.

## PLAY•PAUSE ► II

for CD/ MP3-CD/WMA

to start or interrupt playback.

## PRESET ◀/▶ (TITLE -/+)

for MP3-CD/WMA

to select previous/next title.

for CD ..... to skip to the beginning of the current, previous, or next track.

for Tuner ..... to select a preset radio station.

for Clock ..... to set the minute.

## 12 DISC CHANGE

- to change disc(s).

## 13 CLOCK•TIMER

- to view the clock.
- set the clock or set the timer.

## 14

- to connect headphones.

## 15 MIC IN

- to connect microphone

## 16 MIC VOLUME

- to adjust the mixing level for Karaoke

## 17 Tape Deck Operation

**RECORD ●** ... starts recording.

**PLAY ►** ..... starts playback.

**SEARCH ◀◀/▶▶** fast rewinds/winds the tape.

**STOP•OPEN ■ ▲**

..... stops the tape; opens the tape compartment.

**PAUSE II** ..... interrupts recording or playback.

## 18 Disc tray

## 19 DISPLAY

- to select disc information display mode.

## 20 DIM

- to select different brightness for the display screen : DIM 1, DIM 2, DIM 3 or DIM OFF.

## 21 SLEEP

- to activate/deactivate or set the sleep timer.

## 22 REPEAT

- to playback track(s)/disc(s)/programme repeatedly.

## 23 SHUFFLE

- turns on/off the random play mode.

## 24 MUTE

- mutes or restores the volume.

## 25 TIMER ON/OFF

- activates/deactivates the timer function.

## 26 MAX SOUND (MAX)

- to activate or deactivate the optimal mix of various sound features.

## 27 IS (Incredible Surround)

- to activate or deactivate the surround sound effect.

## 28 RDS/NEWS

- to select RDS information.
- to hear News automatically.

## 29 USB DIRECT

- jack for the external USB mass storage device.

## 30 USB RECORD

- copies music to an external portable USB storage device.

## 31 USB DELETE

- deletes music stored on the external USB device.

### Notes for remote control:

- First, select the source you wish to control by pressing one of the source select keys on the remote control (CD 1/2/3 or TUNER, for example).
- Then select the desired function (► II, ◀, ▶, for example).

# Basic Functions

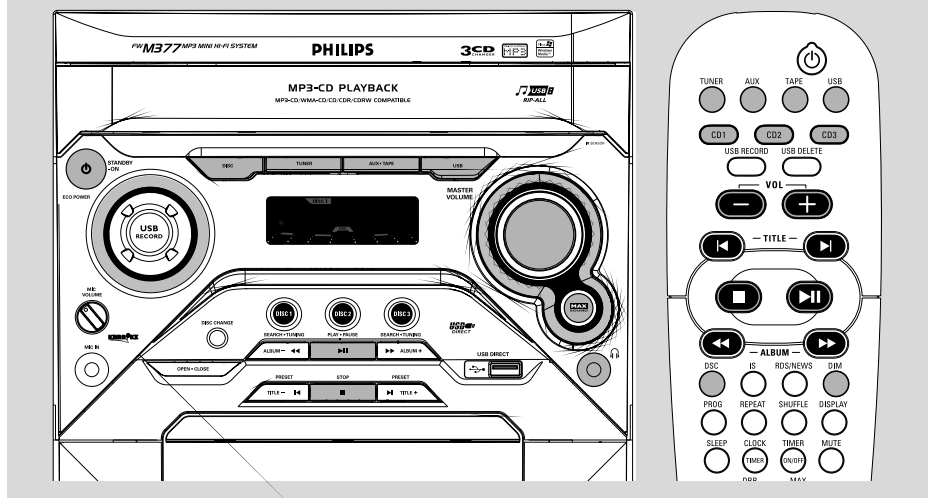

## IMPORTANT!

**Before you operate the system, complete the preparation procedures.**

## Plug and Play (for tuner installation)

Plug and Play allows you to store all available radio stations automatically.

### First time setup/power up

- 1 When you turn on the main supply, "AUTO INSTALL - PRESS PLAY" is displayed.
- 2 Press ►|| to start installation.
  - "PLUG AND PLAY" .... "INSTALL" is displayed, followed by "AUTO".
  - All available radio stations with sufficient signal strength will be stored automatically, starting from FM and followed by MW band.
  - When all the available radio stations are stored or the memory for 40 presets are used, the first preset radio station will be played.

### To reinstall Plug and Play

- 1 In standby or demonstration mode, press and hold ►|| until "AUTO INSTALL - PRESS PLAY" is displayed.

- 2 Press ►|| again to start installation.
  - All previously stored radio stations will be replaced.

## To exit without storing the Plug and Play

- Press ■ on the system.
  - If you do not complete the Plug and Play installation, the function will be restarted when you next turn on the main supply again.

### Notes:

- When the power is turned on, the disc tray may open and close to initialise the system.
- If no stereo frequency is detected during Plug and Play, "CHECK ANTENNA" will be displayed.
- During Plug and Play, if no button is pressed within 15 seconds, the system will exit Plug and Play mode.

## Demonstration mode

The system has a demonstration mode that shows the various features offered by the system.

### To activate the demonstration

- In **standby mode**, press and hold **STOP ■** on the system for 5 seconds to switch to demonstration.

### To deactivate the demonstration

- Press and hold **STOP ■** on the system for 5 seconds to switch to standby mode.

## Switching the system on

- Press **ECO POWER/STANDBY-ON ⏻**.  
→ The system will switch to the last selected source.
- Press **DISC (or DISC 1/2/3, CD 1/2/3), TUNER, AUX • TAPE (or AUX, TAPE) or USB**.  
→ The system will switch to the selected source.
- Press **OPEN • CLOSE** or **DISC CHANGE**.  
→ The system will switch to the disc source and the disc tray will open.

### In Eco Power standby mode

- Press **ECO POWER/STANDBY ON/⏻** to switch on the last selected source.
- Press **DISC (or DISC 1/2/3, CD 1/2/3), TUNER, AUX • TAPE (or AUX, TAPE) or USB**.

## Switching the system to standby mode

### In demonstration mode

- Press and hold **■** on the system.

### In any other source mode

- Press **ECO POWER/STANDBY ON ⏻**.  
→ The clock will appear on the display when the system is in standby mode.

## Switching the system to Eco Power mode (< 1 Watt)

- Press and hold **ECO POWER/STANDBY ON/⏻** until "ECO POWER" is displayed.  
→ The display screen will go blank.  
→ The low power ECO POWER LED will be lighted.

### Note:

– If you have not deactivated the demonstration, it will resume five seconds after the system switches to Eco Power standby or standby mode.

## Power-saving automatic standby

As a power-saving feature, the system will automatically switch to Standby mode if you do not press any buttons within 15 minutes after a disc has stopped playing.

## Dim mode

You can select the desired brightness for the display.

- In any source mode (except standby mode), press **DIM** repeatedly to select DIM 1, DIM 2, DIM 3 or DIM OFF display mode.  
→ **DIM** is shown, except for DIM OFF mode.

DIM mode	Brightness	Spectrum Analyser
1	normal	off
2	half	on
3	half	off
OFF	normal	on

## Volume control

Adjust **MASTER VOLUME** to increase (turn knob clockwise or press **VOL +** on the remote) or decrease (turn knob anti-clockwise or press **VOL -** on the remote) the sound level.

### To listen through the headphones

- Connect the headphones plug to the  socket at the front of the system.  
→ The speakers will be muted.



### To switch off the volume temporarily

- Press **MUTE** on the remote control.  
→ Playback will continue without sound and "MUTE" is displayed.
- To restore the volume, press **MUTE** again or increase the volume level.

# Basic Functions

## Sound control

**For optimal sound listening, select only one of the following navigation sound controls at a time : MAX or DSC.**

### MAX Sound

MAX sound provides the best mixture of various sound features (DSC, DBB, for example).

- Press **MAX SOUND** (or **MAX** on the remote control) repeatedly.
  - If activated, "MAX ON" is shown and the MAX SOUND button lights up.
  - If deactivated, "MAX OFF" is displayed and the MAX button blacks out.

**Note:**

- When MAX sound is selected, DBB 3 will switch on.

### DSC (Digital Sound Control)

The DSC feature enables you to enjoy special sound effects that have preset equaliser settings, providing the best music reproduction.

- ① Press **DSC** to select : OPTIMAL, TECHNO, ROCK or JAZZ.
  - The selected DSC is shown.

### DBB (Dynamic Bass Boost)

There are three DBB settings to enhance the bass response.

- ① Press **DBB** to select : DBB 1, DBB 2, DBB 3 or DBB OFF.
  - The selected **DBB** is shown, except for DBB OFF mode.

**Note:**

- Some discs or tapes might be recorded in high modulation, which causes a distortion at high volume. If this occurs, switch off DBB or reduce the volume.

## Automatic DSC-DBB selection

The best DBB setting is generated automatically for each DSC selection. You can manually select the DBB setting that best suits your listening environment.

DSC	DBB
JAZZ	off
ROCK	on (2)
TECHNO	on (3)
OPTIMAL	on (1)

## Incredible Surround

The Incredible Surround magnifies the virtual distance between the front speakers for an incredibly wide, enveloping stereo effect.

- Press **IS** on the remote control.
  - If activated, "IS ON" is displayed.
  - If deactivated, "IS OFF" is displayed.

## Karaoke

Connect a microphone (not supplied) to the system allowing you to sing along with the music source.

- ① Connect a microphone to the **MIC** jack.
- Before connecting the microphone, set the microphone **MIC VOLUME** to the minimum level to prevent howling sound.
- ② Press **DISC (or DISC 1/2/3, CD 1/2/3), TUNER, AUX-TAPE (or AUX, TAPE)** or **USB** to select the source to be mixed and start playback.
- ③ Adjust the volume level of the source with **MASTER VOLUME** control.
- ④ Adjust the microphone volume with the microphone **MIC VOLUME** control.

**Note:**

- Keep the microphone away from the speakers to prevent howling.

**For Recording, please refer to "Tape Operation/Recording".**

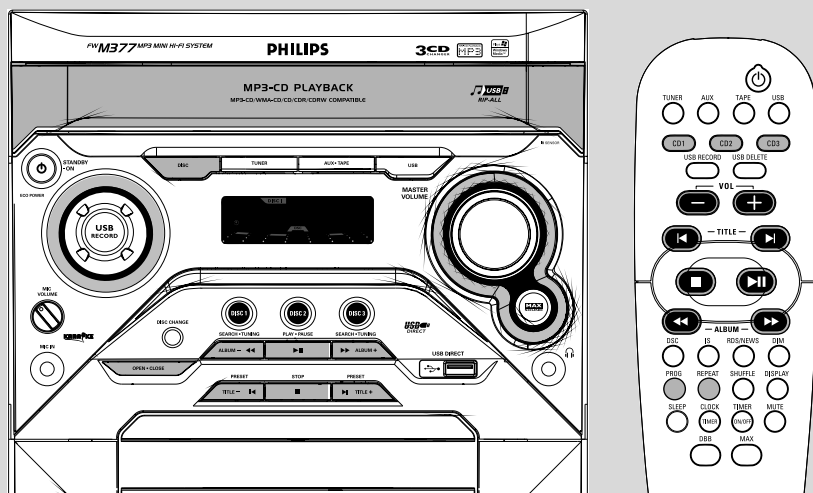

## IMPORTANT!

- This system is designed for regular discs. Therefore, do not use any accessories such as disc stabiliser rings or disc treatment sheets, etc., as offered on the market, because they may jam the changer mechanism.
- Do not load more than one disc into each tray.

## Discs for playback

This system can playback all digital audio CD, finalised digital audio CD-Recordable (CDR) discs and finalised digital audio CD-Rewritable (CDRW) discs.  
MP3-CDs (CD-ROMs with MP3 tracks)  
WMA

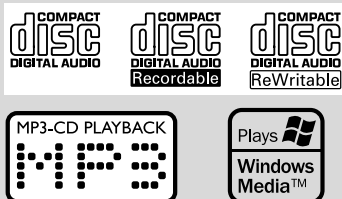

## About MP3 disc

### Supported formats

- ISO9660, Joliet, Multisession
- Max. track number plus album is 512
- The max. MP3 program track number is 40
- Supported VBR bit-rate
- Supported sampling frequencies for MP3 disc are: 32 kHz, 44.1 kHz, 48 kHz
- Supported Bit-rates of MP3 disc are: 32, 64, 96, 128, 192, 256 (kbps)

## Loading discs

- 1 Press **OPEN-CLOSE** to open the disc tray.
- 2 Load up to two discs on the individual disc trays.  
To load the third disc, press **DISC CHANGE**.  
→ The disc tray will rotate until the empty tray is ready for loading.

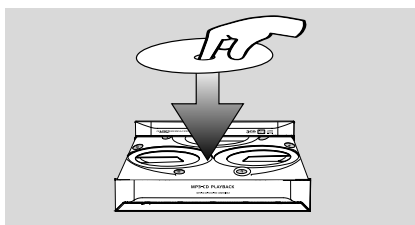

# CD/MP3-CD/WMA Operations

- 3 Press **OPEN•CLOSE** to close the disc tray.  
 → **READING** is displayed as the CD player scans the contents of a disc, and then the total number of tracks and playing time (or the total number of albums and tracks for MP3/WMA disc) are shown.

## Notes:

- Load the discs with the label side facing up.
- To ensure good system performance, wait until the disc tray completely reads the disc(s) before proceeding.
- For MP3 disc, the disc reading time may exceed 10 seconds due to the large number of songs compiled into one disc.

## Playing discs

### To play current disc on the disc tray

- Press **PLAY•PAUSE ►II**.  
 → All loaded discs will play once, then stop.  
 → During playback, the selected disc tray, track number and elapsed playing time of the current track are displayed.  
 → For mixed mode discs, only one mode will be selected for playback depending on the recording format.

## Note:

– When playing a mixed mode disc, you may find a very short mute track inserted into the total number of tracks available in your disc.

### To play the selected disc only

- In CD mode, press **DISC 1/2/3** (or **CD 1/2/3** on the remote control).  
 → The current disc will play once, then stop.

### To interrupt playback

- Press **PLAY•PAUSE ►II**.  
 → The display freezes and the elapsed playing time flashes when playback is interrupted.
- To resume playback, press **PLAY•PAUSE ►II** again.

### To stop playback

- Press **STOP ■**.

## Text display during playback

### In CD mode

- Press **DISPLAY** to show the current track number and remaining playback time.

### In MP3-CD/WMA mode

- Press **DISPLAY** repeatedly to show the current album and track numbers followed by ID3 information (if available).

## Replacing discs during playback

- 1 Press **DISC CHANGE**.  
 → The disc tray will open without interrupting current playback.
- 2 To change the inner disc, press **DISC CHANGE** again.  
 → "OPEN" is displayed and the disc will stop playing.  
 → The disc tray will close to retrieve the inner disc, then reopen with the inner disc accessible.

## Selecting a desired track/passage

### To search for a particular passage during playback

- Press and hold **◀◀** or **▶▶** and release it when the desired passage is located.  
 → During searching, the volume will be reduced.

### To select a desired track

- Press **◀** or **▶** repeatedly until the desired track is displayed.
- If playback is stopped, press **PLAY•PAUSE ►II** to start playback.

## Selecting a desired Album/Title (MP3/WMA disc only)

### To select a desired album

- Press **ALBUM -/+ (◀◀ or ▶▶)** repeatedly.

### To select a desired title

- Press **TITLE -/+ (◀ / ▶)** repeatedly.



## Different play modes: SHUFFLE and REPEAT

You can select and change the various play modes before or during playback. The play modes can also be combined with PROGRAMME.

- SHUF .....tracks of the entire disc are played in random order
- SHUF REP ALL...repeats the entire disc continuously in random order
- REP ALL .....repeats the entire disc/ programme
- REP .....plays the current track continuously

- 1 To select your play mode, press the **SHUFFLE** or **REPEAT** button before or during playback until the display shows the desired function.
- 2 Press **PLAY/PAUSE** **II** to start playback if in the STOP position.  
→ If you have selected SHUFFLE, playback starts automatically.
- 3 To return to normal playback, press the respective **SHUFFLE** or **REPEAT** button until the various SHUFFLE/ REPEAT modes are no longer displayed.
- You can also press **STOP** **■** to cancel your play mode.

### Note:

– The **SHUFFLE** function can be used simultaneously with **PROGRAM**.

## Programming the disc tracks

Programming tracks is possible when playback is stopped. Up to 40 tracks can be stored in the memory in any order.

- 1 Load the desired discs on the disc tray (refer to "Loading discs").
- 2 Press **DISC 1/2/3** (or **CD 1/2/3** on the remote control) to select a disc.
- 3 In stop mode, press **PROG** on the remote control to start programming.  
→ **PROG** starts flashing.
- 4 Press **◀** or **▶** repeatedly to select the desired track.

- For MP3/WMA disc, press **ALBUM** **–/+** and **TITLE** **–/+** to select the desired album and title for programming.
- 5 Press **PROG** to store the track.
- 6 To end programming, press **STOP** **■** once.  
→ **PROG** stays and the programme mode remains active.
- 7 To start programme play, press **PLAY/PAUSE** **II**

### Notes:

- It is not possible to create a programme with MP3 tracks from multiple CDs, or combined with normal audio tracks.
- If you attempt to programme more than 40 tracks, "PROGRAM FULL" is displayed.
- During programming, if no button is pressed within 30 seconds, the system will exit the programme mode automatically.

## To review the programme

- Stop playback and press **◀** or **▶** repeatedly.
- To exit review mode, press **STOP** **■**.

## Erasing the programme

- Press **STOP** **■** once when playback is stopped or **twice** during playback.  
→ **PROG** disappears and "PROGRAM CLEAR" is displayed.

### Note:

– The programme will be erased when the system is disconnected from the power supply or when the disc tray is opened.

**For Recording, please refer to "Tape Operation/Recording".**

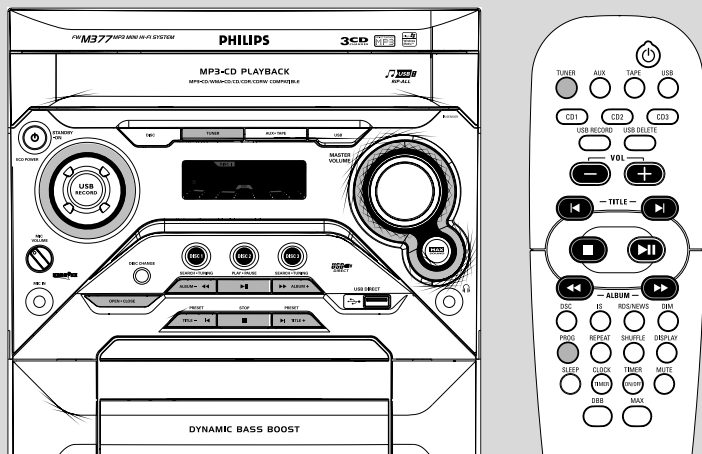

## Tuning to radio stations

- 1 Press **TUNER** to select TUNER mode.  
→ "FM" or "MW" is displayed. A few seconds later, the current radio frequency will appear on the display.
- 2 Press **TUNER** again to select the desired waveband : FM or MW.
- 3 Press and hold **◀** or **▶** until the frequency indication starts to change, then release.  
→ The display will show "SEARCH" until a radio station with sufficient signal strength is found.
- 4 Repeat step 3 if necessary until you find the desired radio station.
- To tune to a weak station, press **◀** or **▶** briefly and repeatedly until optimal reception found.

## Storing preset radio stations

You can store up to 40 preset radio stations in the memory.

### Automatic Preset Programming

- 1 Press **TUNER** to select TUNER mode.  
**To begin automatic preset from a desired preset number**
- Press **◀** or **▶** to select the desired preset number.

→ If a radio station has been stored in one of the presets, it will not be stored again under another preset number.

- 2 Press and hold **PROG** on the remote control until "AUTO" is displayed.  
→ **PROG** starts flashing.  
→ **AUTO** is displayed and available stations are programmed in order of waveband reception strength. The first preset automatically stored will then be played.  
→ When all the available radio stations are stored or the memory for 40 presets are used, the last preset radio station will be played.

### To stop storing the automatic preset

- Press **STOP** ■ on the system.

#### Note:

– If no preset number is selected, automatic preset will begin from preset (1) and all your former presets will be overridden.

## Manual Preset Programming

- 1 Tune to your desired radio station (refer to "Tuning to radio stations").
- 2 Press **PROGR** on the remote control.
  - **PROG** starts flashing.
  - The next available preset number is displayed for selection.

### To store the radio station to another preset number

- Press **◀** or **▶** to select the desired preset number.
- 3 Press **PROG** again to store the radio station.
  - **PROG** disappears.
- Repeat **steps 1–3** to store other radio stations.

### To exit manual preset mode

- Press **STOP** **■** on the system.

#### Notes:

- If you attempt to store more than 40 preset radio stations, "PROGRAM FULL" is displayed.
- During programming, if no key is pressed within 25 seconds, the system will exit the programme mode automatically.

## Tuning to preset radio stations

- Once you've programmed the radio stations, press **◀** or **▶** to select the desired preset number.
  - The preset number, radio frequency, and waveband are displayed.

**For Recording, please refer to "Tape Operation/Recording".**

## RDS

RDS (**R**adio **D**ata **S**ystem) is a broadcasting service that allows FM stations to send additional information along with the regular FM radio signal. This additional information can contain:

**Station name:** The radio station name is displayed.

**Programme type:** The following programme types exist and can be received by your tuner: News, Affairs, Info, Sport, Educate, Drama, Culture, Science, Varied, Pop M, Rock M, M.O.R. (middle of the road music), Light M, Classics, Other M, No type.

**Radio text (RT):** text messages appear on the display.

### To receive RDS Radio Stations

- Tuned to a radio station from FM band.
  - If the radio station is transmitting RDS signal, the RDS logo (**RDS**) and the radio station name will appear on the display.

### To Check the RDS information

- Press **RDS/NEWS** repeatedly to scroll through the following information (if available) :  
STATION NAME → PROGRAMME TYPE →  
RADIO TEXT → TUNED FREQUENCY →  
STATION NAME ....

#### Notes:

- If the tuned radio station does not transmit RDS signal or is a non RDS station, "NO RDS" is displayed.
- If the RDS text message is not available at the RDS station, "NO RDS TEXT" is displayed.

# Radio Reception

## Setting the RDS clock

Some RDS radio station may be transmitting a real clock time at an interval of every minute. It is possible to set the clock by using a time signal which is broadcast together with the RDS signal.

- ① Press **CLOCK•TIMER** and **RDS/NEWS**.  
→ If the RDS radio station does not transmit RDS time within 90 seconds, "NO RDS TIME" is displayed.

*Note:*

– Some RDS radio station may be transmitting a real time clock at a minute interval. The accuracy of the transmitted time depends on the transmitting RDS radio station.

## NEWS (only available in RDS radio station)

Once the News PTY (Programme Type) is detected in a RDS radio station, it will switch to TUNER mode automatically.

### IMPORTANT!

**You can activate NEWS function in standby, demonstration or any source mode except Tuner and Eco Power standby mode.**

### To activate NEWS function

- ① Press **RDS/NEWS** until "NEWS" is displayed.  
→ **NEWS** is shown.  
→ It will scan the radio stations stored in the first 5 preset and wait for the News Programme Type data to be available in any of these RDS radio stations.  
→ While searching NEWS in progress, the current source activity will remain uninterrupted.
- ② When NEWS transmission is detected, the system will switch to Tuner mode automatically.  
→ **NEWS** starts flashing.

*Notes:*

- You have to exit Tuner mode before selecting NEWS function.
- Before you activate the NEWS feature, ensure that the first five presets have RDS stations.
- The NEWS works only once for each activation.
- The NEWS will not start if a recording is in progress.
- If no RDS station is detected, "NO RDS NEWS" is displayed.

### To cancel NEWS function

- Press **TUNER** to select tuner mode.
- During news bulletin, press any other available source keys to execute the relevant source mode.

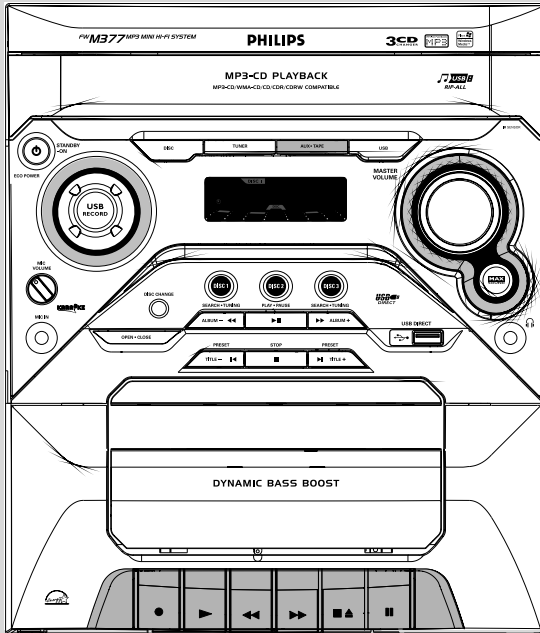

## IMPORTANT!

- Before playing a tape, check and tighten slack tape with a pencil. Slack tape may get jammed or may burst in the mechanism.
- C-120 tape is extremely thin and is easily deformed or damaged. It is not recommended for use in this system.
- Store the tapes at room temperature and do not put them too close to a magnetic field (for example, a transformer, TV or speaker).

## Tape playback

- 1 Select **TAPE** source.
- 2 Open the tape key flap marked "**OPEN ►**" on the front panel.
- 3 Press **STOP•OPEN ■▲** to open the tape door.
- 4 Insert a recorded tape and close the tape door.
- Load the tape with the open side downward and the full spool to the left.

- 5 Press **PLAY ►** to start playback.
- The key is automatically released at the end of a tape, except if **PAUSE■** has been activated.
- 6 To pause, press **PAUSE■**. Press again to resume.
- 7 By pressing **◀◀** or **▶▶** on the system fast winding of tape is possible in both directions.
- 8 To stop the tape, press **STOP•OPEN ■▲**.

### Note:

- The sound source cannot be changed while playing or recording a tape.

# Tape Operation/Recording

## General information on recording

- If you do not intend to record via the microphone, unplug the microphone to avoid accidental mixing with other recording source.
- Recording is permissible insofar as copyright or other rights of third parties are not infringed.
- For recording, use only NORMAL (IEC type I) tapes on which the tabs have not yet been broken. This deck is not suited for recording on METAL (IEC IV) type tapes.
- The recording level is set automatically, regardless of the position of the Volume, DBB, DSC and so forth.
- The recording sound quality might differ depending on the quality of your recording source and the recording tape.
- The tape is secured at both ends with leader tape. At the beginning and end of the tape, nothing will be recorded for six to seven seconds.
- To protect a tape from accidental erasure, have the tape in front of you and break out the left tab. Recording on this side is no longer possible. If, however, you wish to record over this side again, cover the tabs with a piece of adhesive tape.

### IMPORTANT!

– **Recording is permissible if copyright or other rights of third parties are not infringed upon.**

## Preparation for recording

- 1 Press **TAPE** to select TAPE source.
- 2 Load a recordable tape into the tape deck with full spool to the left.
- 3 Prepare the source to be recorded.  
**DISC** – load the disc(s).  
**TUNER** – tune to the desired radio station.  
**TAPE** – load the prerecorded tape into the tape deck with the full spool to the left.  
**AUX** – connect external equipment.  
**USB** – connect a USB mass storage device.

### When recording is in progress

→ **REC** is displayed.

## One touch recording

- 1 Press **DISC** (or **DISC 1/2/3**, **CD 1/2/3**), **TUNER**, **AUX** or **TAPE** (or **AUX**, **TAPE**) or **USB** to select the source.
- 2 Start playback of the selected source.
- 3 Press **RECORD** to start recording.

### To stop recording

- Press **STOP** or **OPEN** on the system.

## CD/USB Synchronised start recording

- 1 Select CD or USB source.
- Press **PRESET** (left/right) (**TITLE** -/+) to select the desired track, then press **RECORD** to start recording.
- You can programme the tracks in the order you want them to be recorded (refer to "CD/MP3-CD/WMA Operation - Programming the disc tracks").
- 2 Press **RECORD** to start recording.  
 → The disc will start playback automatically.

### To stop recording

- Press **STOP** or **OPEN** on the system.

*The making of unauthorized copies of copy-protected material, including computer programmes, files, broadcasts and sound recordings, may be an infringement of copyrights and constitute a criminal offence. This equipment should not be used for such purposes.*



Be responsible  
Respect copyrights

## Maintenance

### Cleaning the Cabinet

- Use a soft cloth slightly moistened with a mild detergent solution. Do not use a solution containing alcohol, spirits, ammonia or abrasives.

### Cleaning Discs

- When a disc becomes dirty, clean it with a cleaning cloth. Wipe the disc from the centre out.
- Do not use solvents such as benzene, thinner; commercially available cleaners, or antistatic spray intended for analogue records.

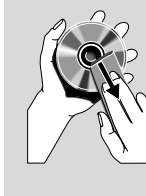

### Cleaning the disc lens

- After prolonged use, dirt or dust may accumulate at the disc lens. To ensure good playback quality, clean the disc lens with Philips CD Lens Cleaner or any commercially available cleaner. Follow the instructions supplied with cleaner.

### Cleaning the Heads and the Tape Paths

- To ensure good recording and playback quality, clean the heads (A), the capstan(s) (B), and pressure roller(s) (C) after every 50 hours of tape operation.
- Use a cotton swab slightly moistened with cleaning fluid or alcohol.
- You can also clean the heads by playing a cleaning tape once.

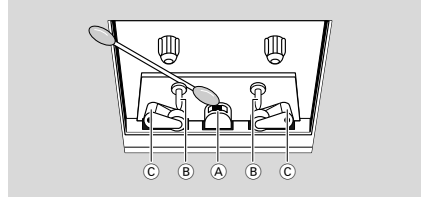

### Demagnetising the heads

- Use a demagnetising tape available at your dealer.

## Using a non-USB device

- 1 Connect the audio out terminals of the external equipment (TV,VCR, Laser Disc player, DVD player or CD Recorder) to the AUX terminals of your system.
- 2 Press **AUX+TAPE** once (or press **AUX** on the remote control) to select external equipment.

### Note:

- All the sound control features (DSC or DBB, for example) are available for selection.
- Refer to the operating instructions for the connected equipment for details.

## Using a USB mass storage device

By connecting a USB mass storage device to the Hi-Fi system, you can enjoy the device's stored music through the powerful speakers of Hi-Fi system.

### Playing a USB mass storage device Compatible USB mass storage devices

With the Hi-Fi system, you can use:

- USB flash memory (USB 2.0 or USB1.1)
- USB flash players (USB 2.0 or USB1.1)
- memory cards (requires an additional card reader to work with this Hi-Fi system)

### Note:

- In some USB flash players (or memory devices), the stored contents are recorded using copyright protection technology. Such protected contents will be unplayable on any other devices (such as this Hi-Fi system).

– Compatibility of the USB connection on this micro system:

- a) This micro system supports most USB Mass storage devices (MSD) that are compliant to the USB MSD standards.
  - i) Most common Mass storage class devices are flash drives, memory sticks, jump drives and etc.
  - ii) If you see a "Disc Drive" show up on your computer after you plugged the mass storage device into your computer, most likely it is MSD compliant and it will work with this micro system.
- b) If your Mass storage device required a battery/ power source. Please make sure you have a fresh battery in it or charge the USB device first and then plug it into the micro system again.

– Supported Music type:

a) This device only supports unprotected music with the following file extension:

.mp3

.wma

b) Music bought from on-line music stores are not supported because they are secured by Digital Rights Management protection (DRM).

c) File name extensions that end with the following are not supported:

.wav; .m4a; .m4p; .mp4; .aac and etc.

- No Direct connection can be made from Computer USB port to the micro system even you have either or both mp3 or wma files in your computer.

### Supported formats:

- USB or memory file format FAT12, FAT16, FAT32 (sector size: 512 bytes)
- MP3 bit rate (data rate): 32-320 Kbps and variable bit rate
- WMA v9 or earlier
- Directory nesting up to a maximum of 8 levels
- Number of albums/ folders: maximum 99
- Number of tracks/titles: maximum 500
- ID3 tag v2.0 or later
- File name in Unicode UTF8 (maximum length: 128 bytes)

### The system will not play or support the following:

- Empty albums: an empty album is an album that does not contain MP3/WMA files, and will not be shown in the display.
- Non-supported file formats are skipped. This means that e.g.: Word documents .doc or MP3 files with extension .dlf are ignored and will not be played.
- AAC, WAV, PCM audio files
- DRM protected WMA files
- WMA files in Lossless format

### How to transfer music files from PC to a USB mass storage device

By dragging and dropping music files, you can easily transfer your favorite music from PC to a USB mass storage device.

For the flash player, you can also use its music management software for the music transfer.

**However, those WMA files may be unplayable for compatibility reasons.**



## How to organize your MP3/WMA files on the USB mass storage device

This Hi-Fi system will browse the MP3/WMA files in the folders/sub-folders/titles order:

Example:

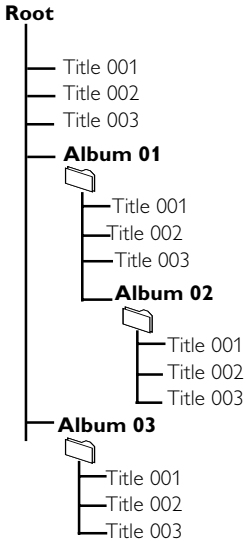

Organize your MP3/WMA files in different folders or subfolders as required.

Notes:

- If you have not organized MP3/WMA files into any albums on your disc, an album "01" will be automatically assigned for all those files.
- Make sure that the file names of MP3 files end with .mp3. and the file names of WMA files end with .wma.
- For DRM protected WMA files, use Windows Media Player 10 (or later) for conversion. Visit [www.microsoft.com](http://www.microsoft.com) for details about Windows Media Player and WM DRM (Windows Media Digital Rights Management).

- 1 Check the USB device has been properly connected. (See "Preparations: Connecting a USB device or memory card").
- 2 Press **USB** to select USB.
  - **NO SONG** appears if no audio file is found in the USB device.





- 3 Play the USB's audio files as you do with the albums/tracks on a CD (See CD/MP3 Operations).

Notes:

- For compatibility reasons, the album/track information may differ from what it is displayed through flash players' music management software.
- File names or ID3 tags will be displayed as — if they are not in English.

## Ripping function

This function enables you to record music to a connected USB mass storage device from any other source (i.e., DISC, TUNER, AUX or TAPE) without interrupting your enjoyment of the music.

- ❶ Insert a USB mass device with sufficient free space to the **USB DIRECT**  socket on the set. (See "Preparations: Connecting a USB device or memory card").
- ❷ Prepare the source to record from.  
**DISC** - load the disc(s). Select the disc to record from. Then, select a track where ripping will start (See "CD/MP3-CD Operations": "Selecting a desired track/passage" and "Selecting a desired Album/Title (MP3 disc only)").  
**TUNER** - tune to the desired radio station (See "Radio Reception": "Tuning to radio stations" and "Tuning to preset radio stations").  
**TAPE** - load the prerecorded tape into the tape deck with the full spool to the left. Press the fast forward tape key () to find the starting point of ripping if necessary. Press **PLAY**  to start playback.  
**AUX** - connect external equipment.
- ❸ Press **USB RECORD** to start ripping.  
→ "USB REC" will start flashing on the display.  
→ In the DISC mode, "RIPPING ONE" will scroll once.
- In the DISC mode, to record all tracks starting from the one you selected, press USB RECORD again.  
→ "RIPPING ALL" will scroll once. "ALL" and "USB REC" will start flashing on the display.
- ❹ At any moment, simply press **STOP**  to stop ripping.

### Notes:

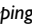
- This function can also be combined with the programme function. In this case, selection of "RIPPING ALL" in DISC mode will record all programmed tracks from the starting point to the USB mass storage device.
- It is impossible to rip from "MIC IN".
- Never unplug the USB mass storage device before pressing **STOP**  to stop ripping.
- In the DISC mode, when you stop ripping or the free space is insufficient, the current track being ripped will not be recorded to your USB mass storage device and the playback will stop at the same time.
- During ripping, it is impossible to select any other source or track (radio station) or even switch the set to standby mode.

### To delete a track/album from your USB mass storage device

- ❶ Plug in the USB mass storage device.
- ❷ Select the track to be deleted during playback.
- ❸ Press **USB DELETE** on the remote control.  
→ "DEL TRK" appears.
- ❹ Press **USB DELETE** again before "DEL TRK" disappears to confirm the deletion.

## Tuner record timer setting

This function enables you to set a timer for starting and stopping ripping from the tuner source automatically.

### IMPORTANT!

– **Before setting the timer, ensure that the clock is set correctly.**

- ① Tune to the station you desire to record from. (See "Radio Reception": "Tuning to radio stations" and "Tuning to preset radio stations".)
- ② Go to the standby mode. Then, Press and hold **CLOCK•TIMER** on the remote control for more than two seconds to select timer mode.
  - The last timer setting starts flashing.
  - The selected source will be lighted.
- ③ Press **TUNER** to select TUNER mode.
- ④ Press **USB RECORD** to enable USB recording.
  - "ST" appears. "USB REC" and the hour and minute digits for the start timer start flashing.
- To cancel USB record setting, press **USB RECORD** again until "ST" and "USB REC" disappear.
  - In this case, you can only continue to set the system switch-on timer. (See "Clock/Timer": "Timer setting".)
- ⑤ Press ◀ or ▶ repeatedly to set the hour for the timer to start.
- ⑥ Press ◀ or ▶ repeatedly to set the minute for the timer to start.
  - "ET" appears. „z and the hour and minute digits for the sleep timer (12 hours later than the start timer by default) start flashing.
- ⑦ Press ◀ or ▶ repeatedly to set the hour for the timer to stop.
- ⑧ Press ◀ or ▶ repeatedly to set the minute for the timer to stop.
- ⑨ Press **CLOCK•TIMER** to store the set tuner record timer.
  - The ripping will start at the set start time and end at the set stop time.
  - The speakers will be muted.

Notes:

- *It is impossible to set a sleep timer more than 12 hours later than the start timer.*
- *During timer setting, if no button is pressed within 60 seconds, the system will exit timer setting mode automatically.*

### To deactivate the TIMER

- Press **TIMER ON/OFF** on the remote control.
  - ⏸ disappears from the display.

### To activate the TIMER

- Press **TIMER ON/OFF** on the remote control.
  - ⏸ appears on the display.

### To view the set record timer

- ① In the standby mode, press and hold **CLOCK•TIMER** on the remote control to view the start timer setting.
- ② Press **CLOCK•TIMER** on the remote control again to view the sleep timer setting.

### To view remaining time during ripping

- After the tuner record timer starts, press **SLEEP** on the remote control to view the remaining time of ripping.
- To cancel the sleep timer, press **SLEEP** repeatedly until "00" appears.

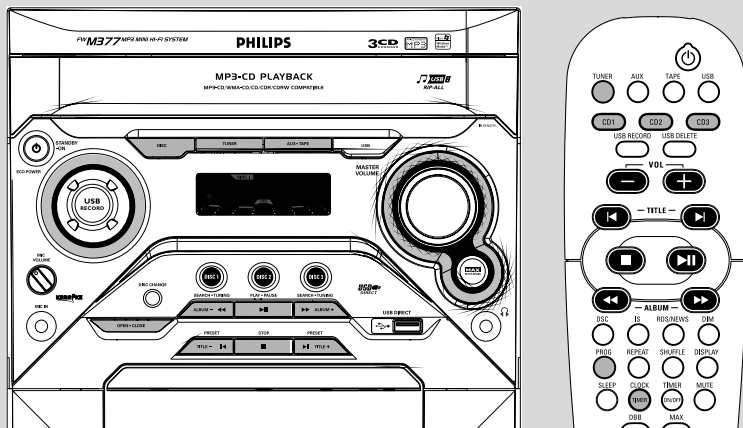

## Clock setting

The system only supports 24-hour time mode.

- 1 In standby or view clock mode, press **CLOCK•TIMER** on the remote control **once**. In other source mode, press **CLOCK•TIMER** **twice**.
- 2 Press **◀◀** or **▶▶** repeatedly to set the hour.
- 3 Press **◀** or **▶** repeatedly to set the minute.
- 4 Press **CLOCK•TIMER** again to store the setting.  
→ The clock starts working.

### To exit without storing the setting

- Press **STOP** ■ on the system.

#### Notes:

- The clock setting will be cancelled when the power cord is disconnected or if a power failure occurs.
- During clock setting, if no button is pressed within 30 seconds, the system will exit clock setting mode automatically.

## Timer setting

The system can switch on to CD, TUNER or USB mode automatically at a preset time, serving as an alarm to wake you up.

### IMPORTANT!

– Before setting the timer, ensure that the clock is set correctly.

- 1 Press and hold **CLOCK•TIMER** on the remote control for more than **two seconds** to select timer mode.  
→ The last timer setting starts flashing.  
→ The selected source will be lighted.
- 2 Press **DISC** (or **DISC 1/2/3**, **CD 1/2/3**), **TUNER** or **USB** to select the desired source.  
● Before setting timer, make sure the music source has been prepared.  
**CD** – Load the disc(s). To start from a specific track, make a programme (refer to “CD Operation - Programming the disc tracks”).  
**TUNER** – tune to the desired radio station.  
**USB** – connect a USB mass storage device.
- 3 Press **◀◀** or **▶▶** repeatedly to set the hour for the timer to start.

- 4 Press **◀** or **▶** repeatedly to set the minute for the timer to start.
- 5 Press **CLOCK•TIMER** to store the start time.
- At the preset time, the selected source will play.

## To exit without storing the setting

- Press **STOP ■** on the system.

### Notes:

- When the preset time is reached and the selected disc tray is empty, the next available disc will be selected. If all the disc trays are not available, Tuner will be selected automatically.
- During timer setting, if no button is pressed within 60 seconds, the system will exit timer setting mode automatically.

## To deactivate the TIMER

- Press **TIMER ON/OFF** on the remote control.
-  will disappear from the display.

## To activate the TIMER

- Press **TIMER ON/OFF** on the remote control.
-  will appear on the display.

## Sleep timer setting

The sleep timer enables the system to switch to standby mode automatically at a preset time.

- 1 Press **SLEEP** on the remote control repeatedly to select a preset time.
  - The selections are as follows (time in minutes):  
15 → 30 → 45 → 60 → 90 → 15 ...
- 2 When you reach the desired length of time, stop pressing the **SLEEP** button.
  - **ZZZ** is shown, except for "00" mode.
  - The sleep timer is now set.

## To check the remaining length of time after sleep timer is activated

- Press **SLEEP** on the remote control once.

## To change the preset sleep timer

- Press **SLEEP** again while the remaining sleep timer is shown.
  - The display will show the next sleep timer options.

## To deactivate the sleep timer

- Press **SLEEP** repeatedly until "00" is displayed, or press **STANDBY-ON (⏻)**.

### Note:

- **ZZZ** will start flashing when the remaining length of time after activation of the sleep timer is less than 1 minute.

# Specifications

## AMPLIFIER

RMS output power	
1KHz (Low channel-both channels driven) .....	60 W per channel
10KHz (High channel-both channels driven) ....	60 W per channel
Total output power .....	240 W
Signal-to-noise ratio .....	67 dB A (IEC)
Frequency response .....	50 – 16000 Hz
Input sensitivity	
AUX .....	1500mV/2000mV
Output	
Speakers .....	6 $\Omega$
Headphones .....	32 $\Omega$
(1) (8 $\Omega$ , 1 kHz, 10%THD)	

## CD/MP3-CD PLAYER

Number of programmable tracks .....	40
Frequency response .....	50 – 20000 Hz -3dB
Signal-to-noise ratio .....	75 dB A
Channel separation .....	50 dB (1 kHz)
Total harmonic distortion .....	< 1.5%
MPEG 1 Layer 3 (MP3-CD) .....	MPEG AUDIO
MP3-CD bit rate .....	32-256 kbps
	(128 kbps advised)
Sampling frequencies .....	32, 44.1, 48 kHz

## TUNER

FM wave range .....	87.5 – 108 MHz
MW wave range .....	531 – 1602 kHz
Number of presets .....	40
Antenna	
FM .....	75 $\Omega$ wire
MW .....	Loop antenna

## USB PLAYER

USB .....	12Mb/s,V1.1
.....	support MP3 and WMA files
Number of albums/folders .....	maximum 99
Number of tracks/titles .....	maximum 400

## TAPE PLAYER

Frequency response	
Normal tape (type I) .....	125 – 8000 Hz (8 dB)
Signal-to-noise ratio	
Normal tape (type I) .....	48 dB A
Wow and flutter .....	$\leq$ 0.4% DIN

## SPEAKERS

System 2-way; double port bass reflex	
Impedance .....	6 $\Omega$
Woofer .....	1 x 13cm
Tweeter .....	1 x 5cm
Dimensions (w x h x d) ....	27.3 x 31 x 20.4 (cm)
Weight .....	3.65 kg each

## GENERAL

Material/finish .....	Polystyrene/Metal
AC Power .....	220 – 230 V / 50 Hz
Power Consumption	
Active .....	120 W
Standby .....	$\leq$ 15 W
Eco Power standby .....	$\leq$ 1 W
Dimensions (w x h x d) ....	26.5 x 31 x 38.4 (cm)
Weight (without speakers) .....	9.1 kg

**Specifications and external appearance are subject to change without notice.**

## WARNING

**Under no circumstances should you try to repair the system yourself, as this will invalidate the warranty. Do not open the system as there is a risk of electric shock.**

**If a fault occurs, first check the points listed below before taking the system for repair. If you are unable to remedy a problem by following these hints, consult your dealer or Philips for help.**

Problem	Solution
<b>"NO DISC" is displayed.</b>	<ul style="list-style-type: none"> <li>✓ Insert a disc.</li> <li>✓ Check if the disc is inserted upside down.</li> <li>✓ Wait until the moisture condensation at the lens has cleared.</li> <li>✓ Replace or clean the disc, see "Maintenance".</li> <li>✓ Use a finalized CD-RW or a correct MP3-CD format disc.</li> </ul>
<b>"DISC NOT FINALIZED" is displayed.</b>	<ul style="list-style-type: none"> <li>✓ Use a finalised CD-RW or CD-R.</li> </ul>
<b>Radio reception is poor.</b>	<ul style="list-style-type: none"> <li>✓ If the signal is too weak, adjust the antenna or connect an external antenna for better reception.</li> <li>✓ Increase the distance between the Mini HiFi System and your TV or VCR.</li> </ul>
<b>Recording or playback cannot be made.</b>	<ul style="list-style-type: none"> <li>✓ Clean deck parts, see "Maintenance".</li> <li>✓ Use only NORMAL (IEC I) tape.</li> <li>✓ Apply a piece of adhesive tape over the missing tab space.</li> </ul>
<b>The system does not react when buttons are pressed.</b>	<ul style="list-style-type: none"> <li>✓ Remove and reconnect the AC power plug and switch on the system again.</li> </ul>
<b>Sound cannot be heard or is of poor quality.</b>	<ul style="list-style-type: none"> <li>✓ Adjust the volume.</li> <li>✓ Disconnect the headphones.</li> <li>✓ Check that the speakers are connected correctly.</li> <li>✓ Check if the stripped speaker wire is clamped.</li> <li>✓ Make sure the MP3-CD was recorded within 32-256 kbps bit rate with sampling frequencies at 48 kHz, 44.1 kHz or 32 kHz.</li> </ul>
<b>The left and right sound outputs are reversed.</b>	<ul style="list-style-type: none"> <li>✓ Check the speaker connections and location.</li> </ul>

**The remote control does not function properly.**

- ✓ Select the source (CD or TUNER, for example) before pressing the function button (▶, ◀, ▶, ▶).
- ✓ Reduce the distance between the remote control and the system.
- ✓ Insert the batteries with their polarities (+/- signs) aligned as indicated.
- ✓ Replace the batteries.
- ✓ Point the remote control directly towards the IR sensor.

**The time is not working.**

- ✓ Set the clock correctly.
- ✓ Press and hold TIMER ON/OFF to switch on the timer.
- ✓ If recording is in progress, stop recording.

**Not all lighted buttons are showing light.**

- ✓ Press DIM to select DIM OFF display mode.

**The Clock/Timer setting is erased.**

- ✓ Power has been interrupted or the power cord has been disconnected. Reset the clock/timer.

**Some files on the USB device are not displayed.**

- ✓ Check if the number of folders exceeds 99 or the number of titles exceeds 400.

**"DEVICE NOT SUPPORTED" scrolls on the display.**

- ✓ Remove the USB mass storage device or select another source.



Meet Philips at the Internet  
<http://www.philips.com>

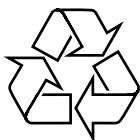

FWM377

**CLASS 1  
LASER PRODUCT**

