

Philips BeNear  
Cordless phone

15 min answering machine

1.6" display/ amber backlight  
Speakerphone  
3 handsets



CD1963B

## Bringing people closer

### Talk handsfree

Great sound reproduction, without having to hold the CD1963B/DE cordless phone to your ear – so you can talk handsfree. With simple installation, a user-friendly menu and an inbuilt answering machine, a great chat has never been easier.

#### Crystal clear sound

- Advanced sound testing & tuning for superb voice quality
- Parametric Equalizer delivers pure and clear sound
- Acoustic echo cancellation keeps your conversation echo-free
- Optimized antenna layout for great reception in any room
- Handset speakerphone allows you to talk handsfree

#### Nice and simple

- Up to 15 min. message on your answering machine
- Easy to read, 4.1cm (1.6") dot-matrix display
- Ultimate convenience through easy setup
- Up to 16 hours of talk time
- 50-name phonebook

#### Eco-conscious product

- Zero power emission when ECO+ mode is activated
- Low power consumption: < 0.65 W in stand-by mode

# PHILIPS

Cordless phone  
15 min answering machine 1.6" display/ amber backlight, Speakerphone, 3 handsets

CD1963B/DE

# Highlights

## 4.1cm(1.6") dot-matrix display

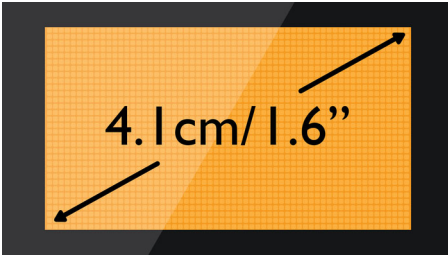

Easy to read, 4.1cm (1.6") dot-matrix display

## Acoustic echo cancellation

No more of those annoying echoes when you are talking on the phone. With our acoustic echo cancellation, you always get a clear, undisturbed connection.

## Advanced sound testing



We test the sound quality of our DECT phones the same way as high-end headphone manufacturers do. Using an advanced ear simulator, we can accurately re-create the way people actually hear. This helps our acoustic engineers to measure and fine-tune things like frequency response, distortion and overall hearing perception, to create perfect voice reproduction for both handset and handsfree modes.

## Easy setup

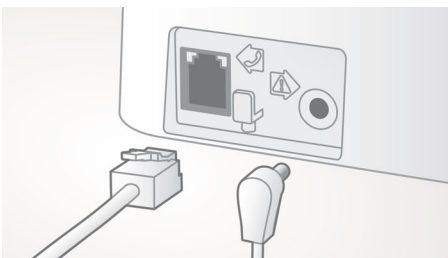

Ultimate convenience through easy set up.  
Simplified installation - Plug & Play product

## ECO+ mode



The ultimate mode to save transmitting power.

## Handset speakerphone



Handsfree mode uses a built-in loud speaker to amplify the voice of the caller, allowing you to speak and listen during a call without holding the phone to your ear. This is especially useful if you want to share the call with others or simply multitask.

## Less radiation while charging



Up to 95% reduction of emitted radiation in charging mode

## Low power consumption: < 0.65 W



Philips phones are energy efficient and are designed to be respectful to the environment. Now the power consumed in stand-by mode is less than < 0.65 W.

## Optimized antenna layout



Our optimized antenna layout ensures strong and stable reception – even in areas of the house where cordless transmission is difficult. Now you can take a call wherever you are in the house, and enjoy a long, uninterrupted conversation even as you walk around.

## Parametric Equalizer



Our telephones use parametric equalization in the digital sound processing to fine-tune the sound response back to the intended linear frequency response curve, delivering sound that is pure and clear, for each conversation.

# Specifications

## Sound

- Volume control on handset
- Ringtones on handset: 10 polyphonic

## Picture/Display

- Display size: 4.1 cm / 1.6"
- Backlight: Yes
- Backlight color: Amber
- Display type: 1-line dot matrix + 2 line icons

## Answering Machine

- Recording time capacity: up to 15 minutes
- Pre-recorded OGM
- Message counter on base: LED ( Soft Amber )
- Loud speaker on base
- Answering Machine control: from base and handset

## Convenience

- Menu structure in the handset: List Menu
- Signal strength indicator: 3- bar indicator
- Battery level indicator: 3- bar battery icon
- Date / Time display
- Base Station keys: Paging key
- Battery charge indication
- Charge time: 8 hours
- Signal strength indication
- Programmable hot keys: Key 1 and 2
- Call Management: Call Waiting\*, Caller ID\*, Microphone mute, Missed Calls, Received Calls
- Key tone on/off
- Auto hang up
- Multi base capability: 1
- Multi handset capability: Up to 4
- Speakerphone - talk handsfree
- Range: Open field <300m; in door <50m
- Up to 16 hrs talk time
- Up to 250 hrs standby time
- Line cord length: 1.8m
- Power cord length: 1.8m

## Memory Capacity

- Phonebook: 50 names and numbers
- Redial List Capacity: 10 entries
- Call log entries: 20 entries
- Phonebook store in the base

## Power

- Battery Capacity: 650 mAh
- Battery type: AAA NiMH Rechargeable
- Mains power: AC 100-240V ~50/60Hz
- Power Consumption: < 0.65 W

## Security

- Transmission encryption : Yes

## Network Features

- Compatible: GAP

## SAR Value

- Philips handsets: <0.1 W/kg

## Eco Design

- EcoMode: automatic
- Full ECO Mode (NEMO)

## Packaging dimensions

- Packaging dimensions (W x H x D): 25 x 13.6 x 11.6 cm
- Packaging dimensions (W x H x D): 9.8 x 5.4 x 4.6 inch
- EAN: 87 12581 61633 5
- Gross weight: 1.031 kg
- Gross weight: 2.273 lb
- Nett weight: 1.874 lb
- Nett weight: 0.85 kg
- Number of products included: 1
- Packaging type: Carton
- Tare weight: 0.399 lb
- Tare weight: 0.181 kg
- Type of shelf placement: Laying



Issue date 2019-05-30

Version: 3.1.5

12 NC: 8670 000 80425  
EAN: 87 12581 61633 5

© 2019 Koninklijke Philips N.V.  
All Rights reserved.

Specifications are subject to change without notice.  
Trademarks are the property of Koninklijke Philips N.V.  
or their respective owners.

[www.philips.com](http://www.philips.com)