

# Always there to help you

Register your product and get support at  
[www.philips.com/welcome](http://www.philips.com/welcome)

AJ5300D



# User manual

# PHILIPS



# Contents

---

<b>1 Important</b>	2
Safety	2

---

<b>2 Your Docking Entertainment System</b>	3
Introduction	3
What's in the box	3
Overview of the main unit	4

---

<b>3 Get started</b>	5
Connect power	5
Turn on	5
Set time and date	6

---

<b>4 Play</b>	6
Play from iPod/iPhone	6
Listen to radio	7
Play from an external device	8
Adjust volume	8

---

<b>5 Other features</b>	8
Set alarm timer	8
Set sleep timer	9
Adjust display brightness	9

---

<b>6 Product information</b>	9
Specifications	9

---

<b>7 Troubleshooting</b>	10
--------------------------	----

---

<b>8 Notice</b>	11
-----------------	----

# 1 Important

---

## Safety

- Heed all warnings, and follow all instructions.
- Do not block any ventilation openings. Install in accordance with the manufacturer's instructions.
- Do not install near any heat sources such as radiators, heat registers, stoves, or other devices (including amplifiers) that produce heat.
- Protect the power cord from being walked on or pinched, particularly at plugs, convenience receptacles, and the point where they exit from the device.
- Only use attachments/accessories specified by the manufacturer.
- Unplug the device during lightning storms or when unused for long periods of time.
- Refer all servicing to qualified service personnel. Servicing is required when the device has been damaged in any way, such as power-supply cord or plug is damaged, liquid has been spilled or objects have fallen into the device, the device has been exposed to rain or moisture, does not operate normally, or has been dropped.
- The device shall not be exposed to dripping or splashing.
- Do not place any sources of danger on the device (e.g. liquid filled objects, lighted candles).
- Where the plug of the Direct Plug-in Adapter is used as the disconnect device, the disconnect device shall remain readily operable.



### Warning

- Never remove the casing of this device.
- Never place this device on other electrical equipment.
- Keep this device away from direct sunlight, naked flames or heat.
- To reduce the risk of fire or electric shock, do not expose this device to rain or moisture.
- Make sure that you always have easy access to the power cord, plug or adapter to disconnect this device from the power.

## 2 Your Docking Entertainment System

Congratulations on your purchase, and welcome to Philips! To fully benefit from the support that Philips offers, register your product at [www.philips.com/welcome](http://www.philips.com/welcome).

If you contact Philips, you will be asked for the model and serial number of this apparatus. The model number and serial number are on the bottom of the apparatus. Write the numbers here:

Model No. \_\_\_\_\_

Serial No. \_\_\_\_\_

---

### Introduction

With this clock radio, you can

- listen to FM radio;
- enjoy audio from iPod/iPhone or an external device;
- set alarms to ring at different time;
- choose buzzer, radio, or audio in iPod/iPhone as your alarm source;
- experience various features brought by **HomeStudio** app.

---

### What's in the box

Check and identify the contents of your package:

- Main unit
- AC/DC power adaptor
- User manual

---

## Overview of the main unit

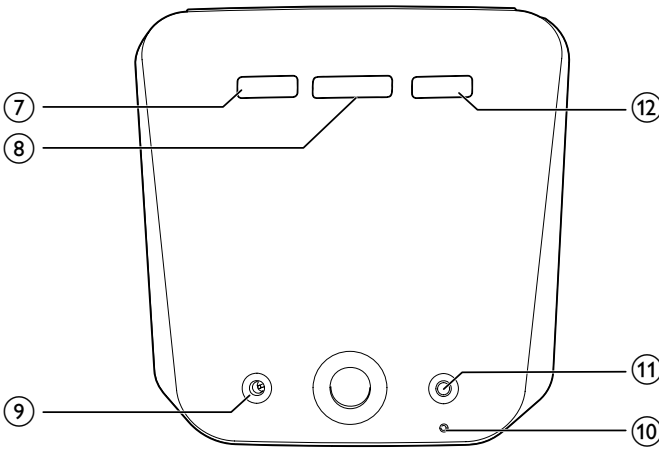
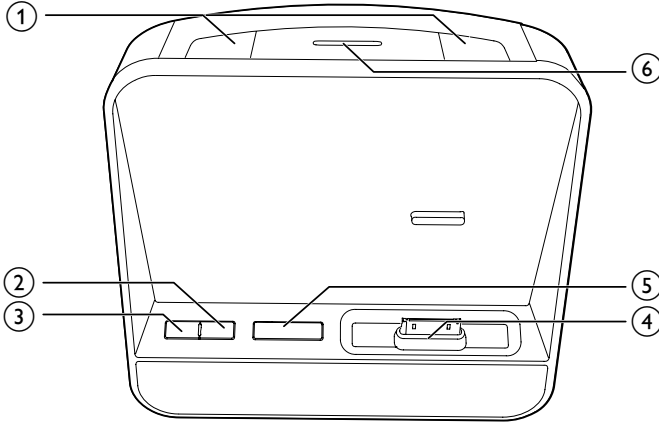

**① AL1/AL2**

- Set alarm.
- View alarm settings.
- Activate/deactivate alarm timer.

**② SOURCE**

- Select source.

**③  $\text{\textcircled{O}}$**

- Turn on/off the clock radio.

**④ DOCK**

- Dock for iPod/iPhone.

**⑤ - VOLUME +**

- Adjust volume.

**⑥ SNOOZE/BRIGHTNESS**

- Snooze alarm.
- Adjust display brightness.

**⑦ TIME SET**

- Set the time.

**⑧  $\llcorner$ TUNING $\lrcorner$**

- Tune or scan to an FM radio station.

- ⑨ **DC IN**
  - Power supply socket.
- ⑩ **FM ANTENNA**
  - Improve FM reception.
- ⑪ **MP3-LINK**
  - Connect an external audio device.
- ⑫ **SLEEP**
  - Set sleep timer.

## 3 Get started

Always follow the instructions in this chapter in sequence.

### Connect power



#### Caution

- Risk of product damage! Make sure that the power voltage corresponds to the voltage printed on the back or underside of the unit.
- Risk of electric shock! When you unplug the power adapter, always pull the plug from the socket. Never pull the cord.
- Before connecting the power adapter, make sure that you have completed all other connections.
- Use the supplied power adapter only.

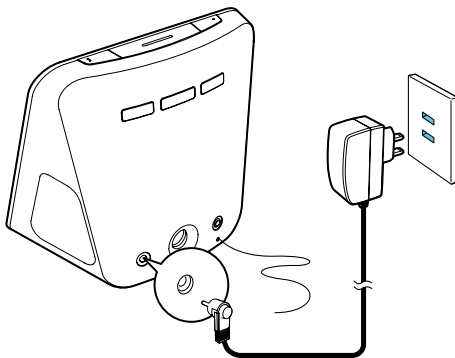

### Turn on

Press **⏻**.

- ↳ The clock radio switches to the last selected source.

### Switch to standby mode

Press **⏻** to switch the clock radio to standby mode.

- ↳ The clock (if set) is displayed.

---

## Set time and date

- 1 In standby mode, press and hold **TIME SET** on the back of your clock radio for more than two seconds.  
↳ [12H] or [24H] begins to blink.
- 2 Press **◀▶** / **▶▶** repeatedly to select 12/24 hour format.
- 3 Press **TIME SET** to confirm.  
↳ The hour digits begin to blink.
- 4 Repeat steps 2-3 to set hour and minute.

### Note

- If clock is not manually set, when iPod/iPhone is connected, the unit synchronizes time from the iPod/iPhone automatically.

### Tip

- The accuracy of the transmitted time depends on the docked iPod/iPhone that transmits the time signal.

## 4 Play

---

### Play from iPod/iPhone

You can enjoy audio from iPod/iPhone through this clock radio.

---

### Compatible iPod/iPhone

The unit supports the following iPod, iPhone models:

Made for:

- iPod classic
- iPod touch (1st, 2nd, 3rd, and 4th generation)
- iPod nano (1st, 2nd, 3rd, 4th, 5th, and 6th generation)
- iPhone 4S
- iPhone 4
- iPhone 3GS
- iPhone 3G
- iPhone

---

### Install HomeStudio App

Philips **HomeStudio** app brings a suite of new features to your clock radio, including FM radio programming and a multi-function alarm clock. To enjoy more features, you are recommended to install this free **HomeStudio** app.

### Note

- Make sure that your iPod/iPhone is connected to the Internet.

- 1 Press **SOURCE** repeatedly to select **DOCK** mode.



- 2 Insert your iPod/iPhone into the dock. ©

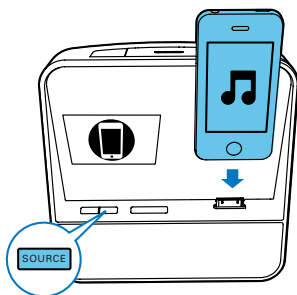

- 3 For the first-time use, you will be asked to install the **HomeStudio** app on your iPod/iPhone.
- 4 Tap **[Yes]** (yes) to accept the installation request.
- 5 Follow the on-screen instructions to complete the installation. ©

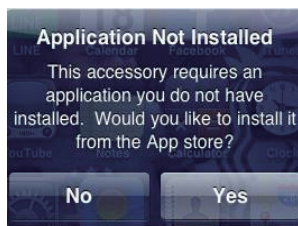

Philips **HomeStudio** app only can be installed in the following iPod, iPhone models:

- iPod touch (1st, 2nd, 3rd, and 4th generation)
- iPhone 4S
- iPhone 4
- iPhone 3GS
- iPhone 3G
- iPhone

## Play music in the iPod/iPhone

Select a track from your iPod/iPhone playlist, and then press ►.

- ↳ Music streams from your iPod/iPhone to the clock radio.

## Charge the iPod/iPhone

When your clock radio is connected to power, the docked iPod/iPhone begins to charge automatically.

## Remove the iPod/iPhone

Pull the iPod/iPhone out of the dock.

## Listen to radio

### Note

- Keep the unit away from other electronic devices to avoid radio interference.
- For better reception, do not place iPod/iPhone into the dock when you listen to the radio. Fully extend and adjust the position of the FM antenna.

## Tune to FM radio stations

You also can tune to radio stations from your clock radio.

- 1 Press **SOURCE** repeatedly to select FM tuner.
- 2 Press and hold **◀◀ / ▶▶** on the back of your clock radio for more than two seconds.
  - ↳ The radio tunes to a station with strong reception automatically.
- 3 Repeat step 2 to tune to more stations.

### To tune to a station manually:

Press **◀◀ / ▶▶** repeatedly until you find optimal reception.

---

## Play from an external device

You can also listen to an external audio device through this clock radio.

- 1 Press **SOURCE** to select the **AUX** source.
- 2 Connect the MP3 link cable (not supplied) to:
  - the **MP3-LINK** socket (3.5mm) at the back of your clock radio.
  - the headphone socket of an external device.
- 3 Start to play the device (see the user manual of the device).

---

## Adjust volume

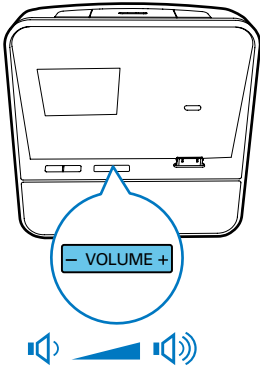

---

# 5 Other features

---

## Set alarm timer

---

### Set alarm

You can set two alarms to ring at different time. Buzzer, FM radio, or your last listened audio in the iPod/iPhone can be selected as alarm sound.

---

#### Note

- Make sure that you have set the clock correctly.

- 1 Press and hold **AL1/AL2** for more than two seconds to activate alarm setting mode.
  - ↳ The hour digits and alarm icon begin to blink.
- 2 Press **◀◀ / ▶▶** repeatedly set the hour.
- 3 press **AL1/AL2** to confirm.
  - ↳ The minute digits begin to blink.
- 4 Repeat steps 2-3 to set the minute, select an alarm source (buzzer, FM radio, or dock), and adjust volume.

---

#### Tip

- If iPod/iPhone is selected as alarm source, but no iPod/iPhone is connected, the clock radio switches to buzzer source instead.
- For the alarm(s) set through the clock radio, you can also select the nature sounds stored in the **HomeStudio** app as alarm sound.

---

## Activate/deactivate alarm timer

- 1 Press **AL1/AL2**.
  - ↳ The alarm settings are displayed.

- 2 Press **AL1/AL2** repeatedly to activate or deactivate the alarm timer:
- ↳ **[AL1]** or **[AL2]** is displayed if the alarm timer is on and disappears if it is off.
  - To stop the ringing alarm, press the corresponding **AL1/AL2**.
  - ↳ The alarm repeats ringing for the next day.

---

## Snooze alarm

When alarm sounds, press **SNOOZE**.

- ↳ The alarm snoozes and repeats ringing nine minutes later.

---

## Set sleep timer

This clock radio can switch to standby mode automatically after a preset period.

Press **SLEEP** repeatedly to select the sleep timer period (in minutes).

- ↳ When the sleep timer is activated, **zZ** appears.

To deactivate the sleep timer, press **SLEEP** repeatedly until **OFF** appears.

---

## Adjust display brightness

Press **BRIGHTNESS** repeatedly to select different brightness levels.

# 6 Product information



### Note

- Product information is subject to change without prior notice.

---

## Specifications

---

### Amplifier

Rated Output Power	2 X 2 W RMS
Frequency Response	40-20000 Hz
Signal to Noise Ratio	>65 dB
Total Harmonic Distortion	<1%
Aux Input (MP3 link)	0.6 V RMS 10 k ohm

---

### Tuner (FM)

Tuning range	87.5-108 MHz
Tuning grid	50 KHz
Sensitivity	
- Mono, 26 dB S/N Ratio	<22 dBf
- Stereo, 46 dB S/N Ratio	<46 dBf
Search Selectivity	30 dBf

---

### Speakers

Speaker Impedance	4 ohm
Sensitivity	>82 dB/m/W

---

## General information

---

AC/DC power adapter	Brand name: Philips; Model: Y12FE-050-2000C; Input: 100-240 V~, 50-60 Hz; 0.35 A; Output: 5 V $\equiv$ 2000 mA
Operation Power Consumption	<10 W
Standby Power Consumption	<1 W
Dimensions: Main Unit (W x H x D)	283 x 118 x 112 mm
Weight: Main Unit	0.6 kg

---

# 7 Troubleshooting



### Warning

- Never remove the casing of this device.

To keep the warranty valid, never try to repair the system yourself.

If you encounter problems when using this device, check the following points before requesting service. If the problem remains unsolved, go to the Philips Web page ([www.philips.com/support](http://www.philips.com/support)). When you contact Philips, make sure that the device is nearby and the model number and serial number are available.

### No power

- Make sure that the power plug of the unit is connected properly.
- Make sure that there is power at the AC outlet.

### No sound

- Adjust the volume.

### No response from the unit

- Disconnect and reconnect the power plug, and then turn on the unit again.

### Poor radio reception

- Increase the distance between the unit and your TV or VCR.
- Fully extend the FM antenna.

### Alarm does not work

- Set the clock/alarm correctly.

### Clock/alarm setting erased

- Power has been interrupted or the power plug has been disconnected.
- Reset the clock/alarm.

## 8 Notice

Any changes or modifications made to this device that are not expressly approved by Philips Consumer Lifestyle may void the user's authority to operate the equipment.

Your product is designed and manufactured with high quality materials and components, which can be recycled and reused.

Never dispose of your product with other household waste. Please inform yourself about the local rules on the separate collection of electrical and electronic products and batteries. The correct disposal of these products helps prevent potentially negative consequences on the environment and human health.

Your product contains batteries, which cannot be disposed of with normal household waste. Please inform yourself about the local rules on separate collection of batteries. The correct disposal of batteries helps prevent potentially negative consequences on the environment and human health.

Please visit [www.recycle.philips.com](http://www.recycle.philips.com) for additional information on a recycling center in your area.

### Environmental information

All unnecessary packaging has been omitted. We have tried to make the packaging easy to separate into three materials: cardboard (box), polystyrene foam (buffer) and polyethylene (bags, protective foam sheet.)

Your system consists of materials which can be recycled and reused if disassembled by a specialized company. Please observe the local regulations regarding the disposal of packaging materials, exhausted batteries and old equipment.



"Made for iPod" and "Made for iPhone" mean that an electronic accessory has been

designed to connect specifically to iPod or iPhone respectively, and has been certified by the developer to meet Apple performance standards. Apple is not responsible for the operation of this device or its compliance with safety and regulatory standards. Please note that the use of this accessory with iPod or iPhone may affect wireless performance.

iPod and iPhone are trademarks of Apple Inc., registered in the U.S. and other countries.

2012 © Koninklijke Philips Electronics N.V. All rights reserved.

Specifications are subject to change without notice. Trademarks are the property of Koninklijke Philips Electronics N.V. or their respective owners. Philips reserves the right to change products at any time without being obliged to adjust earlier supplies accordingly.

### Note

- The type plate is located on the bottom of the apparatus.



Specifications are subject to change without notice  
© 2011 Koninklijke Philips Electronics N.V.  
All rights reserved.

AJ3500D\_93\_UM\_V1.0

